

TIMBER SALE MAP

This information provided by authority of Part 525, 1994 PA 451, as amended.

Sale Number

63-812-25

Date

08/12/2025

| | | | | | |
|------------------------|--------------|--|---------|------|----|
| Forest Management Unit | County | Mapped By: Lewis | Scale | Page | Of |
| Cadillac Mgt Unit | Newaygo | Cruised By: Lewis, Park, Mickevich | 1:8,500 | 1 | 1 |
| Township 16N | Range 14W | Section(s) and Subdivision(s) Sec. 3 SWSW; Sec. 4 S1/2NE,E1/2SW,SE; Sec. 9 NENW,NWNE; | | | |

Cover Type

| | | | |
|---------------------|-------------------------|-------------------------|------------------------|
| A = Aspen | J = Jack Pine | O = Oak | U = Upland Brush |
| B = Paper Birch | K = Rock | P = Lowland Poplar | UM = Upland Mix Forest |
| C = Cedar | L = Lowland Brush | Q = Mixed Swamp Conifer | V = Bog or Marsh |
| D = Treed Bog | LM = Lowland Mix Forest | R = Red Pine | W = White Pine |
| E = Swamp Hardwoods | M = Maple, Beech, Birch | S = Black Spruce | X = Non Stocked |
| F = Spruce/Fir | MC = Mixed Conifer | T = Tamarack | Y = Sand |
| G = Grass | MD = Mixed Deciduous | | Z = Water |
| H = Hemlock | N = Marsh | | |

Density

| | |
|-----------------------------|------------------------|
| 0 = Non Stocked | 5 = Pole Timber Medium |
| 1 = Seedling Sapling Poor | 6 = Pole Timber Well |
| 2 = Seedling Sapling Medium | 7 = Saw Timber Poor |
| 3 = Seedling Sapling Well | 8 = Saw Timber Medium |
| 4 = Pole Timber Poor | 9 = Saw Timber Well |

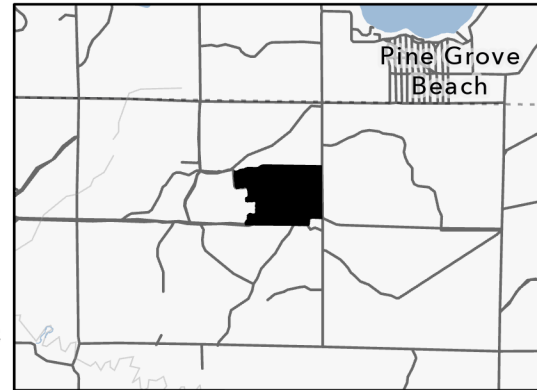
Locator Map 1:100,000

| Payment Unit Number | Acres |
|------------------------|-------|
| 1 | 59 |
| 2 | 57.3 |
| 3 | 45.3 |
| 4 | 39.6 |

**GNA2 Back in
Black****201.3 Acres**

0 0.13 0.25 0.5 Miles

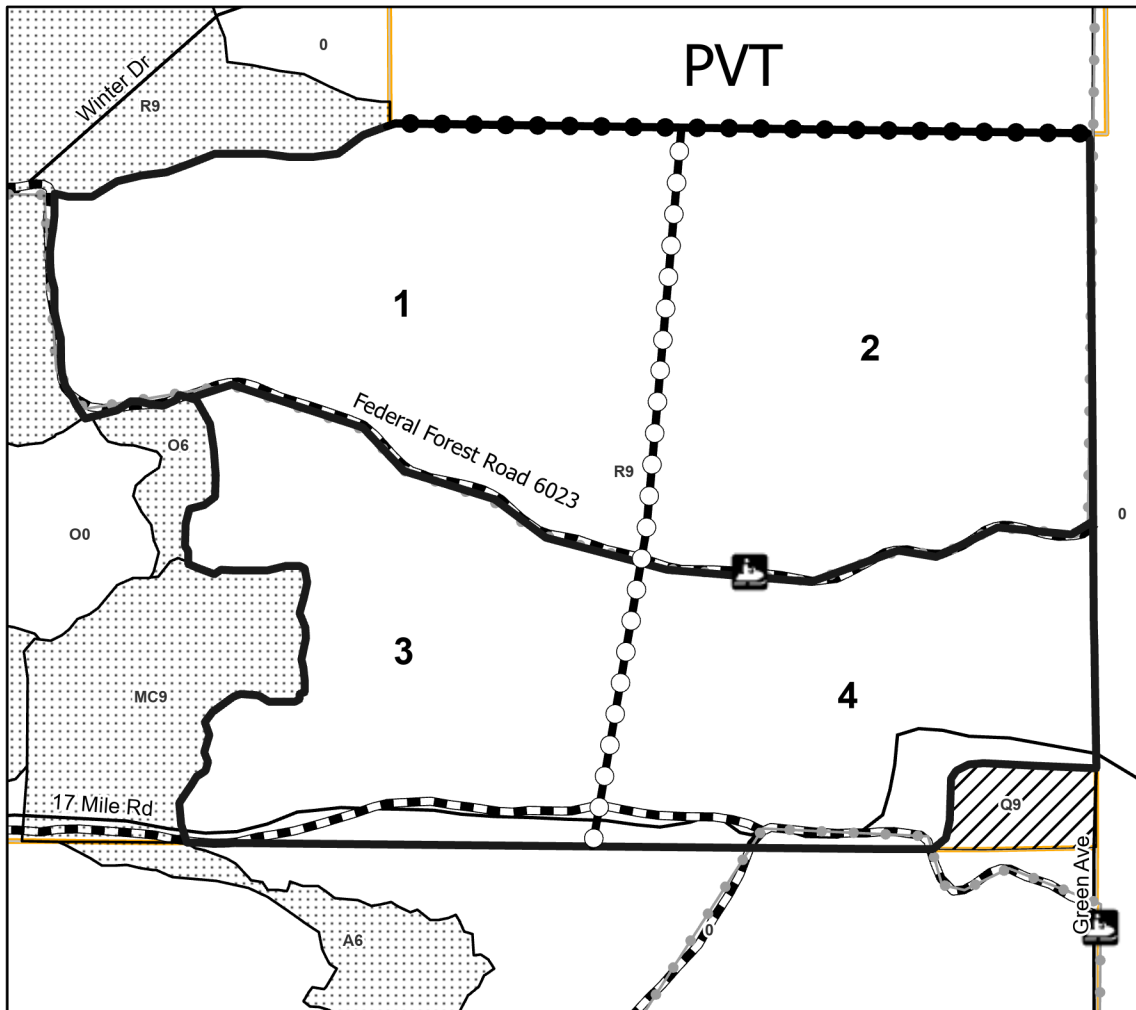
**Legend**

- Payment Unit
- Private Line (Orange)
- Payment Unit (Orange)
- Paved Road
- Government Gravel/Dirt
- Recreational Trails

