

**TIMBER SALE MAP**

This information provided by authority of Part 525, 1994 PA 451, as amended.

Sale Number

**32-001-24**

Date

**09/30/2024**

Forest Management Unit

Gwinn Mgt Unit

County

Marquette

Mapped By: Siler

Cruised By: Contractor &amp; Gwinn Unit

Scale

1:15,840

Page

1

Of

4

Township  
44N / 45NRange  
24WSection(s) and  
Subdivision(s)

Sec. 14 NESW,S1/2SW,SE; Sec. 24 NW,NE,N1/2SW,SWSW,NWSE; Sec. 25 NWNW; Sec. 3 NESW,NWSE;

**Cover Type**

A = Aspen	J = Jack Pine	O = Oak	U = Upland Brush
B = Paper Birch	K = Rock	P = Lowland Poplar	UM = Upland Mix Forest
C = Cedar	L = Lowland Brush	Q = Mixed Swamp Conifer	V = Bog or Marsh
D = Treed Bog	LM = Lowland Mix Forest	R = Red Pine	W = White Pine
E = Swamp Hardwoods	M = Maple, Beech, Birch	S = Black Spruce	X = Non Stocked
F = Spruce/Fir	MC = Mixed Conifer	T = Tamarack	Y = Sand
G = Grass	MD = Mixed Deciduous		Z = Water
H = Hemlock	N = Marsh		

**Density**

0 = Non Stocked	5 = Pole Timber Medium
1 = Seedling Sapling Poor	6 = Pole Timber Well
2 = Seedling Sapling Medium	7 = Saw Timber Poor
3 = Seedling Sapling Well	8 = Saw Timber Medium
4 = Pole Timber Poor	9 = Saw Timber Well

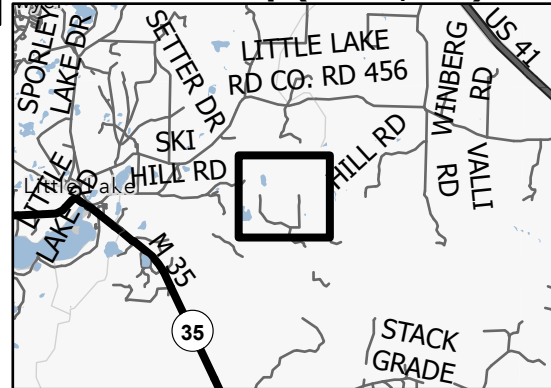
**Locator Map (1:200,000)**

PU #	Acres	PU #	Acres	PU #	Acres	PU #	Acres
1	18.6	6	36.1	11	29.4	16	26.4
2	13.8	7	13.6	12	22	17	3.5
3	9.2	8	37.9	13	30.7	18	4.1
4	3.7	9	30.6	14	21.6	19	0.8
5	20.3	10	12.9	15	25.5	20	0.1

Acres: 360.8

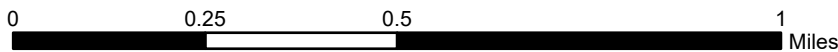
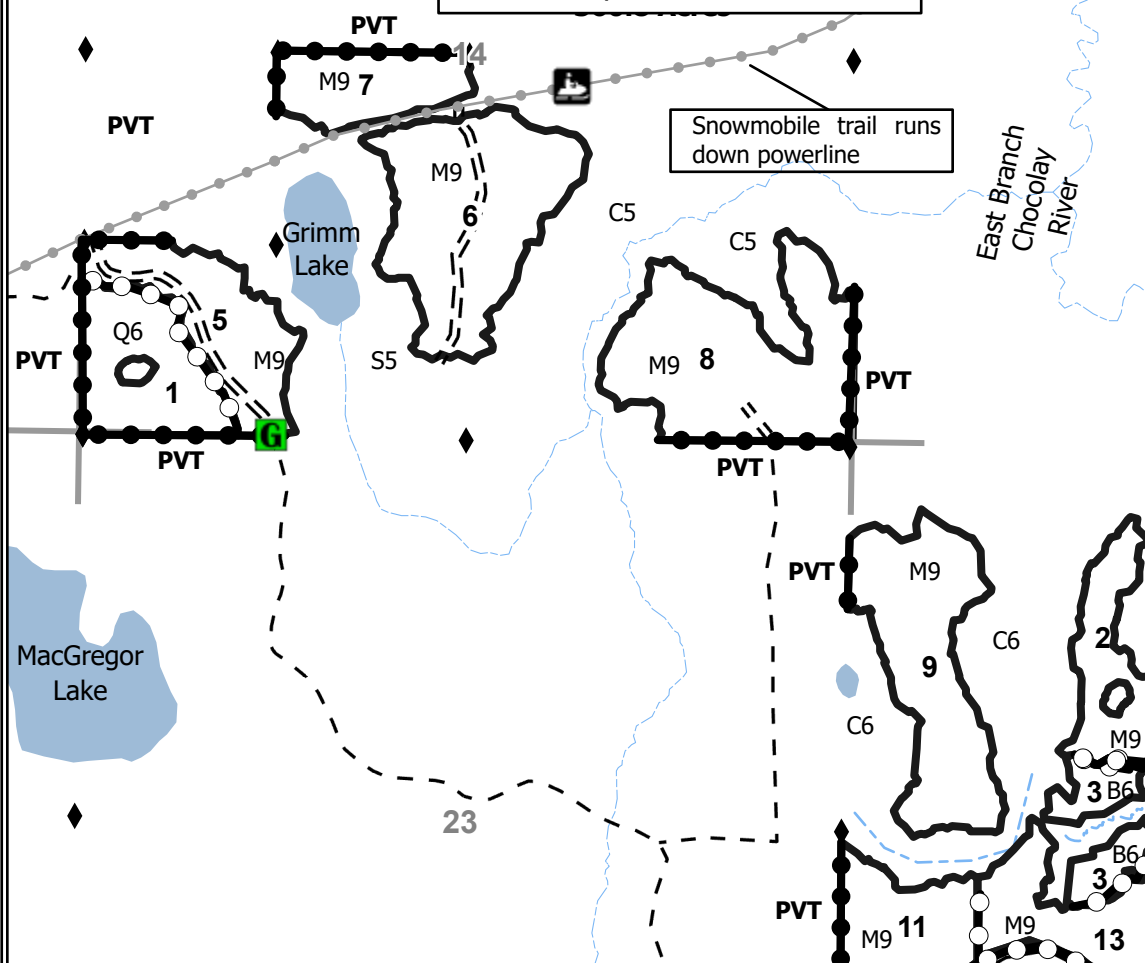
**Rifle Maple and Cedar CRP****Legend**

- Against State (Red)
- Payment Unit (Yellow)
- Private Line (Blue)
- Snowmobile Trail
- Intermittent Stream
- Lakes and Rivers
- Forest Access Route
- Private Gravel/Dirt
- Survey Grade Corner
- Gate
- Section Corner

Use QR Code to open Map in App

