

**TIMBER SALE MAP**

This information provided by authority of Part 525, 1994 PA 451, as amended.

Sale Number

32-008-26

Date

05/22/2025

| | | | | | |
|------------------------|--------------|---|----------|------|----|
| Forest Management Unit | County | Mapped By: Rosten | Scale | Page | Of |
| Gwinn Mgt Unit | Alger | Cruised By: | 1:10,000 | 2 | 2 |
| Township 44N | Range 22W | Section(s) and Subdivision(s) Sec. 19 SESW,SWSE; Sec. 30 E1/2NW,NE,NESW,NWSE; Sec. 31 E1/2SW,N1/2SE,SWSE; | | | |

Cover Type

| | | | |
|---------------------|-------------------------|-------------------------|------------------------|
| A = Aspen | J = Jack Pine | O = Oak | U = Upland Brush |
| B = Paper Birch | K = Rock | P = Lowland Poplar | UM = Upland Mix Forest |
| C = Cedar | L = Lowland Brush | Q = Mixed Swamp Conifer | V = Bog or Marsh |
| D = Treed Bog | LM = Lowland Mix Forest | R = Red Pine | W = White Pine |
| E = Swamp Hardwoods | M = Maple, Beech, Birch | S = Black Spruce | X = Non Stocked |
| F = Spruce/Fir | MC = Mixed Conifer | T = Tamarack | Y = Sand |
| G = Grass | MD = Mixed Deciduous | | Z = Water |
| H = Hemlock | N = Marsh | | |

Density

| | |
|-----------------------------|------------------------|
| 0 = Non Stocked | 5 = Pole Timber Medium |
| 1 = Seedling Sapling Poor | 6 = Pole Timber Well |
| 2 = Seedling Sapling Medium | 7 = Saw Timber Poor |
| 3 = Seedling Sapling Well | 8 = Saw Timber Medium |
| 4 = Pole Timber Poor | 9 = Saw Timber Well |

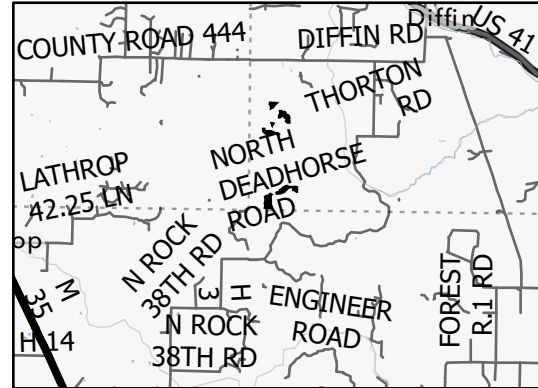
Locator Map 1:244,141

| Payment Unit Number | Acres | Payment Unit Number | Acres |
|---------------------|-------|---------------------|-------|
| 1 | 14 | 4 | 19.7 |
| 2 | 27.5 | 5 | 32.3 |
| 3 | 4.6 | 6 | 32.9 |

Comp 90 Contract Marking**131.0 Acres**

0 0.15 0.3 0.6 Miles

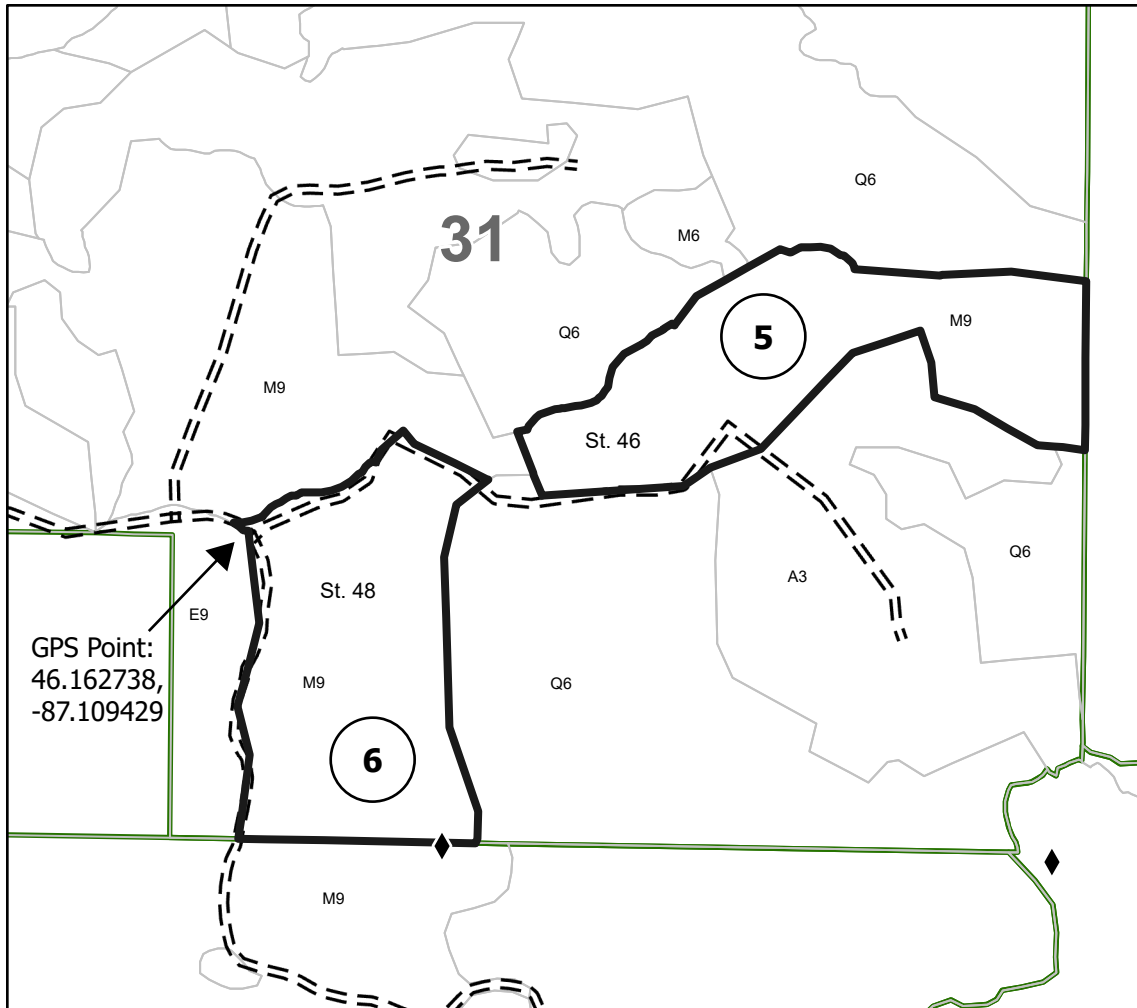
**Legend**

- Payment Unit
- Forest Access Route
- Field Grade Corner
- Survey Grade Corner
- Payment Unit Number

Use QR Code to open Map in App

