

T. 14 N.
R. 11 W.

MANISTEE NATIONAL FOREST

T. 14 N., R. 11 W., Mich. Mer.

MICHIGAN
NEWAYGO COUNTY

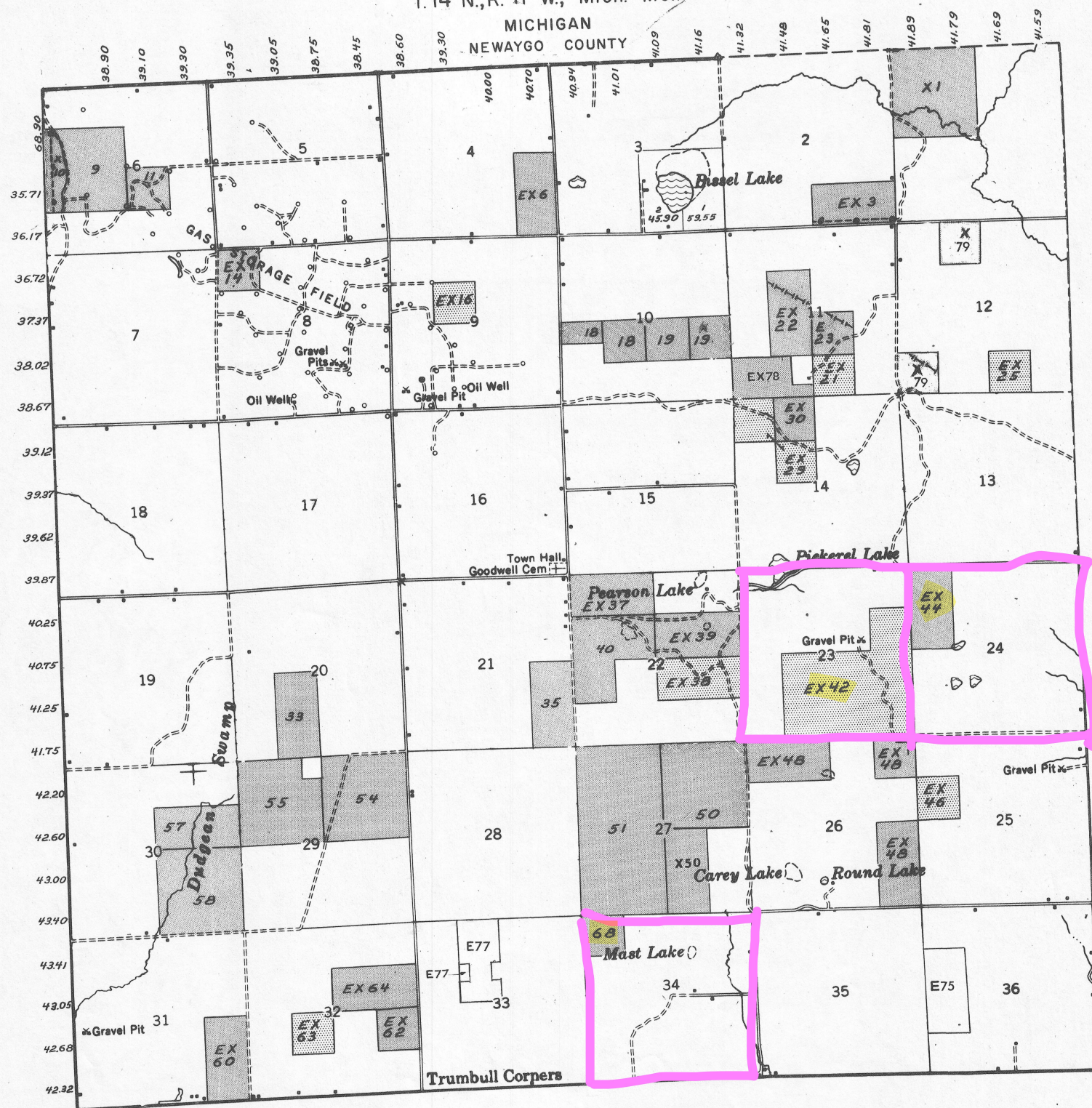

TITLE & ENCUMBRANCE MAP

MANISTEE NATIONAL FOREST
T. 14 N., R. 11 W. MICHIGAN MERIDIAN

NEWAYGO COUNTY
WHITE CLOUD RANGER DISTRICT
GOODWELL TOWNSHIP

MAP SYMBOLS

- National Forest boundary
- Purchase Unit boundary
- County boundary
- Political Township boundary
- Ranger District boundary
- Tract boundary
- Monumented corner
- Railroad
- Double-track railroad
- Abandoned railroad grade
- Hard surfaced road
- Stabilized, graded, and drained road
- Improved and maintained dirt road
- Unimproved dirt road
- Route Numbers
- U.S., State or Co., F.S.
- Abandoned logging road or other man way
- Telephone line
- Powerline
- Pipeline
- Drainage

OWNERSHIP

- Weeks Law - F.S. Administered - U.S.
- Public Domain - F.S. Administered - U.S.
- Other Status - F.S. Administered - U.S.
- Released by Exchange, etc.
- Other Federal
- Non Federal
- Tabular Record Form Line Number

METHOD OF ACQUISITION

- R - Reserved from Public Domain (Symbol shown only where stippling is not obvious)
- P - Acquired by Purchase (Symbol not shown for Weeks Law purchase cases)
- E - Exchange
- D - Donation
- T - Transfer

ENCUMBRANCES

- X - Minerals Outstanding
- * - Expansion provided

EASEMENTS

OF RECORD 3rd PARTY	TO/FROM U.S.F.S.	TYPE
See Road	R/w Atlas	Highway or Road
		Railroad
		Pipeline
		Powerline
		Telephone or Telegraph

TOWNSHIP ACREAGE SUMMARY

Acreage		Ranger District	Ranger District
County	Net National Forest	3,628.85	
	Gross National Forest	23,045.12	
		Ranger District	Ranger District
County	Net National Forest		
	Gross National Forest		
Township Acreage			
Net National Forest		3,628.85	Original G.L.O. Survey
Gross National Forest		23,045.12	Revised G.L.O. Survey
Extra National Forest			Revised G.L.O. Survey
Posted To		1/ 21 / 99	Revised G.L.O. Survey

SCALE

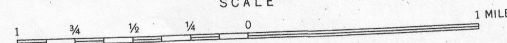

STATUS MAP TABULAR RECORD	Date Surveyed	1837	County	NEWAYGO	Forest	MANISTEE	MICHIGAN MERIDIAN	Township	14 NORTH
	Status Posted To	7/1/85	State	MICHIGAN	Ranger District	WHITE CLOUD		Range	11 WEST
								Sheet	1 of 2

TITLE AND ENCUMBRANCES										REMARKS		
AUTHORITY	ENTRY METHOD	DATE	CASE NAME AND NUMBER	SECTION	SUBDIVISION	ACRES	OWNER STATUS	LINE NO.	ENCUMBRANCES			
									INTEREST		VESTED IN	EXPIRATION DATE
									GOV.	OTHER		
										John Hepinstall 1961	9-25-2011	Third party reserves oil and gas, and minerals. See abs. entry 48.
Weeks Act	Ex.	10-30-61	Gillies, Richard #1411-1	1	NW	163.68	N.F.	1				+C/P shows trail roads and fences traversing description.
Wk	Ex.	2-28-62	Gillard, William B. #1915-3	2	S½ SE	80.00	N.F.	3		State across any for same.	Unlimited	State of Michigan reserves all mineral, coal, oil and gas; right of ingress and egress along any watercourse, and all aboriginal antiquities and right to explore and excavate
										Consumers Power Co.		Easement for 40' powerline R/W. See abs. entry #14. Line to be located N of and not more than 300' from the centerline of highway on S boundary.
										Michigan-Wisconsin Co. to Michigan		Easement for 30' pipeline R/W. Correspondence in case folder shows option dated 7-25-44 Gas Co. (abs. entry #13) was exercised, and payment made for pipeline R/W. There is no indication of how the pipeline passed to Michigan-Wisconsin Company. (Exact location not given)
										Consolidated		+C/P shows 33' county road on tract.
Wk	Ex.	10-14-61	Schram, Everett M. #1411-6	4	E½ SE	80.00	N.F.	6		Mich.Consolidated Gas Co. 1958	Unlimited	Natural gas rights and right to store dry natural gas down to and including the Marshall formation outstanding of record in Mich. Consolidated Gas Co.
										B. H. Smith, et al 1960	Unlimited	All mineral rights not outstanding reserved by Benjamin H. Smith, et al. Abs.entry 25.
												+33' county road R/W. C/P shows boundary fences owned by vendor.
Wk	P	11-19-40	Davenport Home for Female Orphan Children #1411-202	6	SE NW, NE SW, Part of SW NW and Part of NW SW lying E of county road. See deed, abs. Exhibit F **	114.43	N.F.	9	*	Vendor	12-31-59	Reserves oil and gas, and metallic minerals. **Part of SW NW and Part of NW SW contains 34.425 acres.
Wk	P	6-22-48	Davenport Home for Female Orphan Children #1411-202A	6	Part of SW NW and Part of NW SW lying W of county road. Exhibit F.	35.74	N.F.	10	*	Vendor	1-1-63	Reserves oil and mineral rights. Gas rights outstanding of record in Michigan Consolidated Gas Company. See abs. entries 50-100.
										Mich.Consolidated Gas Co. 1943	Unlimited	Easement for 40' powerline R/W on W line of tract. See abs. entry 37.
										Consumers Power Co. County		Easement for 33' county road on W line. G.L.O. acreage is 35.735. Deed reads 36.11 acres.
												Reserves oil and gas, and metallic minerals (except on NW NW SE) subject to renewal if developed. Reservation has expired. See letter of 7-16-51 in abs.
ERA 4-8-35	P	3-24-37	Marsh, Frank B. #1411-2	6	NW SE	40.00	N.F. 3/	11	*	Vendor	7-30-51	Purchased with \$2,700,000 E.R.A. money. Given National Forest status by P.L.O. #1304 on 6-1-56.
Bankhead-Jones Ex.		4-12-45	State of Michigan #41	8	NW NW	40.00	N.F. 2/	14		State across any for same.	Unlimited	State of Michigan reserves all mineral, coal, oil and gas; right of ingress and egress along any watercourse, and all aboriginal antiquities and right to explore and excavate
												+C/P shows 33' county road on N and W boundaries.
State of Mich. Ex. 7-31-12		6-20-41	State of Michigan #22 (GLO-07758)	9	SE NW	40.00	N.F.P.D.	16		State	Unlimited	Same as line 14.
Wk	P	4-7-38	Cole, Nelson #1411-55	10	NE SW, N½ NW SW	60.00	N.F.	18	*	Vendor	4-7-58	Reserves oil and gas, and metallic minerals, subject to renewal if developed. Reservation has expired. See Ranger's Report in abs.
										County		Easement for 33' county road on W boundary N½ NW SW.
										County		Easement for 33' county road on E boundary.
Wk	P	7-17-40	Rohland, Adolph #1411-173	10	N½ SE	80.00	N.F.	19		State	Unlimited	Same as line 14.
State of Mich. Ex. 7-31-12		6-20-41	State of Michigan #22 (GLO-07758)	11	SW SE	40.00	N.F.P.D.	21		State	Unlimited	Same as line 14.
BJ	Ex.	4-12-45	State of Michigan #41	11	SE NW, NE SW	80.00	N.F. 2/	22		State Consumers Power Co.	Unlimited	Easement for 25' pipeline R/W running northwesterly across SE NW. For exact location see abs. p. 152.
Wk	Ex.	10-18-48	Zake, Louis R. #1411-13	11	NW SE	40.00	N.F.	23	*	Vendor	1-1-79	Reserves oil and gas, and mineral rights. Easement for 30' pipeline R/W. Right to lay and maintain gas mains. C/P shows a gas main across NE corner. See abs. entry 33 for exact location.
										Consumers Power Co. 1944		Same as line 14.
State of Mich. Ex. 7-31-12		6-20-41	State of Michigan #22 (GLO-07758)	12	SW SE	40.00	N.F.P.D.	25		State	Unlimited	Same as line 14.
BJ	Ex.	4-12-45	State of Michigan #41	12	NE NW, SW SW	80.00	N.F. 2/	26		State Consumers Power Co.	Unlimited	Easement for 25' pipeline R/W running northwesterly across N½ SW SW. For exact location see abs. p. 151.
												+C/P shows 33' county road on N boundary.
												+C/P shows 33' county road on N boundary.
State of Mich. Ex. 7-31-12		6-20-41	State of Michigan #22 (GLO-07758)	14	NW NW, SE NW	80.00	N.F.P.D.	29		State	Unlimited	Same as line 14.
Wk	Ex.	10-18-48	Zake, Louis R. #1411-13	14	NE NW	40.00	N.F.	30		State 1919	Unlimited	Minerals, coal, oil and gas outstanding in State. See abs. entry 51.
Wk	P	6-4-40	Card, Frank I. #1411-33 by G. A. Howarth, D. D. Alton, W. H. Barnum, Trustees.	20	E½ SW	80.00	N.F.	33	*	Vendor	12-31-59	Reserves oil and gas, and metallic minerals.
												+C/P shows 33' county road on E boundary.
Wk	P	10-16-40	Muskegon Trust Co. #1411-156	21	E½ SE	80.00	N.F.	35		State	Unlimited	Same as line 14.
BJ	Ex.	4-19-50	State of Michigan #21	22	N½ NW	80.00	N.F. 2/	37		State	Unlimited	+C/P shows 33' county road on W line. See abs. Vol. II, p. D-2.
State of Mich. Ex. 7-31-12		6-20-41	State of Michigan #22	22	N½ SE	80.00	N.F.P.D.	38		State	Unlimited	Same as line 14.
BJ	Ex.	4-12-45	State of Michigan #41	22	S½ NE	80.00	N.F. 2/	39		State	Unlimited	Same as line 14.
Wk	P	8-23-41	Schenck, Robert F. #1411-3	22	S½ NW, NW SW	120.00	N.F.	40	*	Vendor	12-31-60	Reserves oil and gas, and metallic minerals.
												+C/P shows 33' county road on W boundary.
State of Mich. Ex. 7-31-12		6-20-41	State of Michigan #22 (GLO-07758)	23	SE NE, E½ SW, SE	280.00	N.F.P.D.	42		State	Unlimited	Same as line 14.
BJ	Ex.	4-12-45	State of Michigan #41	24	W½ NW	80.00	N.F. 2/	44		State	Unlimited	Same as line 14. Subject to outstanding oil and gas lease at p. 90 of abs.
State of Mich. Ex. 7-31-12		6-20-41	State of Michigan #22	25	SW NW	40.00	N.F.P.D.	46		State	Unlimited	+C/P shows 33' county road on N boundary.
BJ	Ex.	4-12-45	State of Michigan #41	26	NE NE, N½ NW, E½ SE	200.00	N.F. 2/	48		State	Unlimited	Same as line 14.
Wk	P	8-12-40	Comstock, William A. #1411-206	27	NE, W½ SE	240.00	N.F.	50		D. D. Battjes 1938	Unlimited	NE NE, S boundary SE SE, and crossing NE SE. Third party reserves oil and gas and minerals on W½ SE. See abs. part 2, entry 46.
										County		Easement for 33' county road on N and E boundaries NE, **
Wk	P	6-28-40	Riblet, S. K. #1411-218	27	W½	320.00	N.F.	51	*	Vendor	12-31-59	Reserves oil and gas until 12-31-59. Deed is subject to oil and gas lease on NW SW. See deed, abs. entry 48.
												+C/P shows 33' county road on E boundary.
Wk	P	8-19-41	Muskegon Trust Co. #1411-156	29	NE	160.00	N.F.	54				
Wk	P	10-16-40	Muskegon Trust Co. #1411-156	29	NW except NE NE NW	150.00	N.F.	55				
Wk	P	7-12-47	Knowles-Lee Lumber Co. #1411-5	30	S½ NE	80.00	N.F.	57				C/P shows a tar paper logging shack owned by vendor located on S line SE NE.

1/ National Forest land with Weeks Act status unless otherwise indicated.

2/ Given Weeks Law status by Proc. #2591 dated 7-29-43.

3/ Given Weeks Law status by Act of September 2, 1958.

* Subject to Secretary of Agriculture rules attached to deed.
+ Subject to established or existing roads and utilities in deed and certificate of possession but no easement of record.

R9-5490-7
2-6-65

T
R

STATUS MAP TABULAR RECORD

Date Surveyed	1837
Status Posted To	7/30/

County	NEWAYGO
State	MICHIGAN

Forest	MANISTEE
Ranger District	WHITE CLOUD

MICHIGAN MERIDIAN

Township	14 NORTH
Range	11 WEST

Sheet 2 of 2

[illegible]

1/ National Forest land with Weeks Act status unless otherwise indicated.
2/ Given Weeks Law status by Proc. #2591 dated 7-29-43.

* Subject to Secretary of Agriculture rules attached to deed, R
+ Subject to established or existing roads and utilities in deed and certificate of possession but no easement of record,

R9-5490-7
2-6-65
TIAN
RUW

THIS INDENTURE, Made this 20th day of June in the year of our Lord, one thousand nine hundred and forty-one

BY AND BETWEEN the DEPARTMENT OF CONSERVATION of the STATE OF MICHIGAN, the successor in office and trust by virtue of Act No. 17, Public Acts of 1921, Legislature of Michigan, to the Public Domain Commission of Michigan, which was the successor in office and trust to the Commissioner of the State Land Office, party of the first part, and the UNITED STATES OF AMERICA, party of the second part.

WITNESSETH, That

WHEREAS, The party of the first part, by virtue of the authority in said Department vested, as successor to the Public Domain Commission, by Act No. 280 of the Public Acts of 1909, Legislature of Michigan, as amended by Act No. 333 of the Public Acts of 1913, Legislature of Michigan, in consideration of the conveyance by the said party of the second part to the State of Michigan, as in exchange of acreage of an approximate equal value as hereby conveyed, the title of the second party to the lands to be exchanged passing to the State of Michigan by patent or deed, the receipt whereof is hereby acknowledged, does by these presents grant, bargain, sell, convey and release unto the said party of the second part, the United States of America, its successors and assigns forever all of the following described premises situated in the Counties of MASON and NEWAYGO, in the State of Michigan, to-wit:

NEWAYGO COUNTY

Township 12 North, Range 11 West

Northwest quarter (NW $\frac{1}{4}$) of Northwest quarter (NW $\frac{1}{4}$), Section Eleven (11).
Northeast quarter (NE $\frac{1}{4}$) of Southwest quarter (SW $\frac{1}{4}$), Section Sixteen (16).
subject to easement of Consumers Power Company to construct, maintain and operate an electric transmission line.

Township 12 North, Range 12 West

Southwest quarter (SW $\frac{1}{4}$) of Northeast quarter (NE $\frac{1}{4}$); Southwest quarter (SW $\frac{1}{4}$) of Northwest quarter (NW $\frac{1}{4}$) of Northwest quarter (NW $\frac{1}{4}$); South half (S $\frac{1}{2}$) of Northwest quarter (NW $\frac{1}{4}$); South half (S $\frac{1}{2}$) of North half (N $\frac{1}{2}$) of Northwest quarter (NW $\frac{1}{4}$) of Southwest quarter (SW $\frac{1}{4}$); South half (S $\frac{1}{2}$) of South half (S $\frac{1}{2}$) of Northwest quarter (NW $\frac{1}{4}$) of Southwest quarter (SW $\frac{1}{4}$); North half (N $\frac{1}{2}$) of North half (N $\frac{1}{2}$) of Southwest quarter (SW $\frac{1}{4}$) of Southwest quarter (SW $\frac{1}{4}$); Southwest quarter (SW $\frac{1}{4}$) of Southeast quarter (SE $\frac{1}{4}$), Section One (1). North $\frac{3}{4}$ of South half (S $\frac{1}{2}$) of Southeast quarter (SE $\frac{1}{4}$) of Northeast quarter (NE $\frac{1}{4}$); North half (N $\frac{1}{2}$) of Northeast quarter (NE $\frac{1}{4}$) of Southeast quarter (SE $\frac{1}{4}$); South $\frac{1}{4}$ of Northeast quarter (NE $\frac{1}{4}$) of Southeast quarter (SE $\frac{1}{4}$); North half (N $\frac{1}{2}$) of North half (N $\frac{1}{2}$) of Southeast quarter (SE $\frac{1}{4}$) of Southeast quarter (SE $\frac{1}{4}$); Southeast quarter (SE $\frac{1}{4}$) of Southeast quarter (SE $\frac{1}{4}$) of Southeast quarter (SE $\frac{1}{4}$), Section Two (2). East half (E $\frac{1}{2}$) of East half (E $\frac{1}{2}$) of Northeast quarter (NE $\frac{1}{4}$) of Southeast quarter (SE $\frac{1}{4}$), Section Twenty-three (23). North half (N $\frac{1}{2}$) of Northwest quarter (NW $\frac{1}{4}$) of Southwest quarter (SW $\frac{1}{4}$); East half (E $\frac{1}{2}$) of Southwest quarter (SW $\frac{1}{4}$) of Southwest quarter (SW $\frac{1}{4}$); Southwest quarter (SW $\frac{1}{4}$) of Southwest quarter (SW $\frac{1}{4}$) of Southwest quarter (SW $\frac{1}{4}$), Section Twenty-six (26). East half (E $\frac{1}{2}$) of Southwest quarter (SW $\frac{1}{4}$); West half (W $\frac{1}{2}$) of West half (W $\frac{1}{2}$) of Southwest quarter (SW $\frac{1}{4}$) of Southeast quarter (SE $\frac{1}{4}$); West half (W $\frac{1}{2}$) of East half (E $\frac{1}{2}$) of Southeast quarter (SE $\frac{1}{4}$) of Southeast quarter (SE $\frac{1}{4}$); East half (E $\frac{1}{2}$) of West half (W $\frac{1}{2}$) of Southeast quarter (SE $\frac{1}{4}$) of Southeast quarter (SE $\frac{1}{4}$), Section Twenty-seven (27). East half (E $\frac{1}{2}$) of East half (E $\frac{1}{2}$) of Southwest quarter (SW $\frac{1}{4}$) of Northeast quarter (NE $\frac{1}{4}$); Southeast quarter (SE $\frac{1}{4}$) of Northeast quarter (NE $\frac{1}{4}$); South half (S $\frac{1}{2}$) of South half (S $\frac{1}{2}$) of Northeast quarter (NE $\frac{1}{4}$) of Southwest quarter (SW $\frac{1}{4}$); Southeast quarter (SE $\frac{1}{4}$) of Southwest quarter (SW $\frac{1}{4}$); Northeast quarter (NE $\frac{1}{4}$) of Southeast quarter (SE $\frac{1}{4}$), Section Thirty-four (34). Northwest quarter (NW $\frac{1}{4}$) of Northwest quarter (NW $\frac{1}{4}$); Southeast quarter (SE $\frac{1}{4}$) of Southwest quarter (SW $\frac{1}{4}$), subject to easement for pipe line of American Michigan Pipe Line Company; East Two (2) rods of East half (E $\frac{1}{2}$) of Southeast quarter (SE $\frac{1}{4}$), subject to easement for pipe line of American Michigan Pipe Line Company; West Seventy-four (74) rods of East half (E $\frac{1}{2}$) of Southeast quarter (SE $\frac{1}{4}$), subject to easement for pipe line of American Michigan Pipe Line Company; West half (W $\frac{1}{2}$) of Southeast quarter (SE $\frac{1}{4}$), subject to easement for pipe line of American Michigan Pipe Line Company; Section Thirty-five (35). Northwest quarter (NW $\frac{1}{4}$) of Northeast quarter (NE $\frac{1}{4}$), subject to easement for pipe line of American Michigan Pipe Line Company; South half (S $\frac{1}{2}$) of Northeast quarter (NE $\frac{1}{4}$); Northwest quarter (NW $\frac{1}{4}$) of Northwest quarter (NW $\frac{1}{4}$); South half (S $\frac{1}{2}$) of Northwest quarter (NW $\frac{1}{4}$), subject to easement for pipe line of American Michigan Pipe Line Company; West half (W $\frac{1}{2}$) of Southeast quarter (SE $\frac{1}{4}$), Section Thirty-six (36).

Township 13 North, Range 11 West

West half (W $\frac{1}{2}$) of Northeast quarter (NE $\frac{1}{4}$); East half (E $\frac{1}{2}$) of Northwest quarter (NW $\frac{1}{4}$); Southwest quarter (SW $\frac{1}{4}$), Section Thirty-five (35).

#22-1

Dec. 22

Township 13 North, Range 12 West

Northeast quarter (NE $\frac{1}{4}$) of Northwest quarter (NW $\frac{1}{4}$) of Northeast quarter (NE $\frac{1}{4}$); West half (W $\frac{1}{2}$) of Northeast quarter (NE $\frac{1}{4}$) of Northwest quarter (NW $\frac{1}{4}$), Section Thirty-one (31).

Township 14 North, Range 11 West

Southeast quarter (SE $\frac{1}{4}$) of Northwest quarter (NW $\frac{1}{4}$), Section Nine (9).
Southwest quarter (SW $\frac{1}{4}$) of Southeast quarter (SE $\frac{1}{4}$), Section Eleven (11).
Southwest quarter (SW $\frac{1}{4}$) of Southeast quarter (SE $\frac{1}{4}$), Section Twelve (12).
Northwest quarter (NW $\frac{1}{4}$) of Northwest quarter (NW $\frac{1}{4}$); Southeast quarter (SE $\frac{1}{4}$) of Northwest quarter (NW $\frac{1}{4}$), Section Fourteen (14). North half (N $\frac{1}{2}$) of Southeast quarter (SE $\frac{1}{4}$), Section Twenty-two (22). Southeast quarter (SE $\frac{1}{4}$) of Northeast quarter (NE $\frac{1}{4}$); East half (E $\frac{1}{2}$) of Southwest quarter (SW $\frac{1}{4}$); Southeast quarter (SE $\frac{1}{4}$), Section Twenty-three (23). Southwest quarter (SW $\frac{1}{4}$) of Northwest quarter (NW $\frac{1}{4}$), Section Twenty-five (25). Northeast quarter (NE $\frac{1}{4}$) of Southwest quarter (SW $\frac{1}{4}$), Section Thirty-two (32).

Township 14 North, Range 12 West

Southeast quarter (SE $\frac{1}{4}$); East half (E $\frac{1}{2}$) of Southwest quarter (SW $\frac{1}{4}$), Section Eleven (11). North half (N $\frac{1}{2}$) of Southwest quarter (SW $\frac{1}{4}$), subject to easement for State Highway, designated as M-20, Section Fourteen (14).

Township 14 North, Range 13 West

Southwest quarter (SW $\frac{1}{4}$) of Northwest quarter (NW $\frac{1}{4}$), Section Six (6). East half (E $\frac{1}{2}$) of Southeast quarter (SE $\frac{1}{4}$), Section Nine (9). South half (S $\frac{1}{2}$) of Southwest quarter (SW $\frac{1}{4}$), Section Ten (10). Northwest quarter (NW $\frac{1}{4}$) of Southwest quarter (SW $\frac{1}{4}$), Section Fourteen (14). Northwest quarter (NW $\frac{1}{4}$) of Northeast quarter (NE $\frac{1}{4}$), Section Sixteen (16). Northeast quarter (NE $\frac{1}{4}$), Section Twenty (20). Southeast quarter (SE $\frac{1}{4}$) of Southeast quarter (SE $\frac{1}{4}$), Section Twenty-one (21). Southwest quarter (SW $\frac{1}{4}$), Section Twenty-two (22). Northeast quarter (NE $\frac{1}{4}$) of Southwest quarter (SW $\frac{1}{4}$), Section Twenty-six (26).

Township 14 North, Range 14 West

X Southeast quarter (SE $\frac{1}{4}$) of Southeast quarter (SE $\frac{1}{4}$), Section Ten (10). Northeast quarter (NE $\frac{1}{4}$) of Northeast quarter (NE $\frac{1}{4}$), Section Eleven (11). Northeast quarter (NE $\frac{1}{4}$) of Southwest quarter (SW $\frac{1}{4}$); Southwest quarter (SW $\frac{1}{4}$) of Northeast quarter (NE $\frac{1}{4}$), Section Thirteen (13). Southeast quarter (SE $\frac{1}{4}$) of Northeast quarter (NE $\frac{1}{4}$); Northwest quarter (NW $\frac{1}{4}$) of Northwest quarter (NW $\frac{1}{4}$); North half (N $\frac{1}{2}$) of Northeast quarter (NE $\frac{1}{4}$) of Southeast quarter (SE $\frac{1}{4}$); South quarter (S $\frac{1}{2}$) of Northwest quarter (NW $\frac{1}{4}$) of Southeast quarter (SE $\frac{1}{4}$), Section Fourteen (14).

Township 15 North, Range 11 West

X East half (E $\frac{1}{2}$); East half (E $\frac{1}{2}$) of Northwest quarter (NW $\frac{1}{4}$); East Thirty (30) acres of Southwest quarter (SW $\frac{1}{4}$), Section Two (2). North half (N $\frac{1}{2}$) of Southwest quarter (SW $\frac{1}{4}$), Section Eleven (11). Northeast quarter (NE $\frac{1}{4}$) of Southeast quarter (SE $\frac{1}{4}$); West half (W $\frac{1}{2}$) of Northwest quarter (NW $\frac{1}{4}$) of Southeast quarter (SE $\frac{1}{4}$), Section Twenty-three (23). Southeast quarter (SE $\frac{1}{4}$), Section Twenty-four (24). Southeast quarter (SE $\frac{1}{4}$) of Southwest quarter (SW $\frac{1}{4}$), Section Twenty-eight (28).

Township 15 North, Range 12 West

X Southeast quarter (SE $\frac{1}{4}$) of Northeast quarter (NE $\frac{1}{4}$); Southeast quarter (SE $\frac{1}{4}$) of Southwest quarter (SW $\frac{1}{4}$); Southwest quarter (SW $\frac{1}{4}$) of Southeast quarter (SE $\frac{1}{4}$), Section Five (5). South half (S $\frac{1}{2}$), Section Six (6).

MASON COUNTY

Township 20 North, Range 16 West

X West half (W $\frac{1}{2}$) of Lot number Eight (8), Section Three (3).

containing in the aggregate Four thousand six hundred sixty-nine and forty-eight hundredths (4,669.48) Acres, according to the returns of the Surveyor General, AND SUBJECT TO all easements and rights of user held or enjoyed by any Governmental unit or agency for purposes of public roads or highways, but intending, however, to convey any and all rights of remainder and/or reversion in and to the lands affected thereby.

And the said party of the first part hereby represents that at the time of the sealing and delivery of these presents, the said party of the first part had title to the lands granted to the said party of the second part by virtue of the laws of said State of Michigan, as follows:- That the lands herein conveyed to the party of the second part were State Tax Reverted Lands, so-called, by virtue of the deeds issued by the Auditor General of the State of Michigan to the said State of Michigan, under the provisions of Section 127 of Act No. 206 of the Public Acts of 1893, as amended by Act 107 of the Public Acts of 1899, and that the said lands were made exchangeable for other lands held by the United States of America by virtue of Act 193 of the Public Acts of 1911; and that the said Department of Conservation by resolution dated August 12, 1938, authorized the exchange of said lands to and with the said party of the second part for other lands of approximately equal value to be decided by the said party of the second part to the State of Michigan.

SAVING AND EXCEPTING out of this conveyance and always reserving unto the said State of Michigan, all mineral, coal, oil and gas, lying and being on, within or under the said lands hereby conveyed, with full and free liberty and power to the State of Michigan, its duly authorized officers, representatives and assigns, and its or their lessees, agents, workmen, and all other persons by its or their authority or permission, whether already given or hereafter to be given, at any time and from time to time, to enter upon said lands and take all usual, necessary or convenient means for exploring, mining, working, piping, getting, laying up, storing, dressing, making merchantable and taking away the said mineral, coal, oil and gas, pursuant to the provisions of Section 3 of Act 230, Public Acts of 1909; and also reserving to the People of the State of Michigan the rights of ingress and egress over and across any of said lands lying along any watercourse or stream, as also provided in said Section 3 of Act 230, Public Acts of 1909; Further, excepting and reserving to the State of Michigan all aboriginal antiquities, including mounds, earth-works, forts, burial and village sites, mines or other relics and also reserving the right to explore and excavate for the same, by and through its duly authorized agents and employees, pursuant to the provisions of Act 173, Public Acts of 1929.

IN WITNESS WHEREOF, The said party of the first part, by its Director, acting under the authority delegated in him by the said Department of Conservation, by resolution adopted September 1, 1921, under the provisions of Section 2, Act 17, of the Public Acts of 1921, Legislature of Michigan, has hereunto subscribed its name and affixed the seal of the Department of Conservation the day and year first herein above written.

Signed, Sealed and Delivered in Presence of:

DEPARTMENT OF CONSERVATION FOR THE
STATE OF MICHIGAN

M. Irene Gorsline
M. Irene Gorsline

Alice L. Alexander
Alice L. Alexander

By P. J. Hoffmaster
P. J. Hoffmaster

STATE OF MICHIGAN)
) SS
County of Ingham)

On this 20th day of June A. D. 1941, before me, a Notary Public in and for said county personally appeared P. J. Hoffmaster, Director of the Department of Conservation of the State of Michigan, to me known to be the same person who executed the foregoing instrument, and who acknowledged the same to be his free act and deed and the free act and deed of the Department of Conservation of the State of Michigan in whose behalf he acts for the purpose of complying with the provisions of Act 193 of the Public Acts of 1911.

Alice L. Alexander
Alice L. Alexander

Notary Public, Ingham County, Michigan
My Commission Expires, Sept 30, 1944

DEED under Act 193, Public Acts of 1911, Legislature of Michigan

THIS INDENTURE, Made this 12th day of April in the year of our Lord, One thousand nine hundred and forty- five

BY AND BETWEEN the DEPARTMENT OF CONSERVATION for the STATE OF MICHIGAN, the successor in office and trust by virtue of Act No. 17, Public Acts of 1921, Legislature of Michigan, to the Public Domain Commission of Michigan, which was the successor in office and trust to the Commission of the State Land Office, party of the first part, and the UNITED STATES OF AMERICA, party of the second part.

WITNESSETH, That

WHEREAS, The party of the first part, by virtue of the authority in said Department vested, as successor to the Public Domain Commission, by act No. 280 of the Public Acts of 1909, Legislature of Michigan, as amended by Act No. 333 of the Public Acts of 1913, Legislature of Michigan, in consideration of the conveyance by the said party of the second part to the State of Michigan, as in exchange of acreage of an approximate equal value as hereby conveyed, the title of the second party to the lands to be exchanged passing to the State of Michigan by patent or deed, the receipt whereof is hereby acknowledged, does by these presents grant, bargain, sell, convey and release unto the said party of the second part, the United States of America, and its assigns forever, all of the following described premises situated in the County of NEWAYGO, in the State of Michigan, to-wit:

Township 12 North, Range 11 West

West half ($W\frac{1}{2}$) of Southwest quarter ($SW\frac{1}{4}$), Section One (1). Southeast quarter ($SE\frac{1}{4}$) of Southwest quarter ($SW\frac{1}{4}$), Section Two (2). Southeast quarter ($SE\frac{1}{4}$) of Southeast quarter ($SE\frac{1}{4}$) of Southeast quarter ($SE\frac{1}{4}$), Section Four (4). Southwest quarter ($SW\frac{1}{4}$) of Southwest quarter ($SW\frac{1}{4}$), Section Eleven (11). Northwest quarter ($NW\frac{1}{4}$) of Northwest quarter ($NW\frac{1}{4}$), Southwest quarter ($SW\frac{1}{4}$) of Northwest quarter ($NW\frac{1}{4}$), Section Eighteen (18). Northeast quarter ($NE\frac{1}{4}$) of Northwest quarter ($NW\frac{1}{4}$), Section Twenty-four (24). Northwest quarter ($NW\frac{1}{4}$) of Southwest quarter ($SW\frac{1}{4}$), South half ($S\frac{1}{2}$) of Southwest quarter ($SW\frac{1}{4}$), Section Thirty (30). West half ($W\frac{1}{2}$) of Northwest quarter ($NW\frac{1}{4}$), Section Thirty-one (31).

Township 12 North, Range 12 West

East half ($E\frac{1}{2}$) of Southwest quarter ($SW\frac{1}{4}$), North half ($N\frac{1}{2}$) of North half ($N\frac{1}{2}$) of Northwest quarter ($NW\frac{1}{4}$) of Southwest quarter ($SW\frac{1}{4}$), West half ($W\frac{1}{2}$) of South half ($S\frac{1}{2}$) of North half ($N\frac{1}{2}$) of Northeast quarter ($NE\frac{1}{4}$) of Southeast quarter ($SE\frac{1}{4}$), Section One (1). West half ($W\frac{1}{2}$) of Northwest quarter ($NW\frac{1}{4}$) of Northeast quarter ($NE\frac{1}{4}$), Southwest quarter ($SW\frac{1}{4}$) of Northwest quarter ($NW\frac{1}{4}$), Section Two (2). South half ($S\frac{1}{2}$) of Southwest quarter ($SW\frac{1}{4}$) of Northwest quarter ($NW\frac{1}{4}$), Section Three (3). South half ($S\frac{1}{2}$) of South half ($S\frac{1}{2}$) of Southwest quarter ($SW\frac{1}{4}$) of Northeast quarter ($NE\frac{1}{4}$), North half ($N\frac{1}{2}$) of North half ($N\frac{1}{2}$) of Southeast quarter ($SE\frac{1}{4}$) of Northeast quarter ($NE\frac{1}{4}$), North Twenty-nine and eighty-three hundredths (29.83) acres of Northwest quarter ($NW\frac{1}{4}$) of Northwest quarter ($NW\frac{1}{4}$), South half ($S\frac{1}{2}$) of South half ($S\frac{1}{2}$) of Northeast quarter ($NE\frac{1}{4}$) of Southwest quarter ($SW\frac{1}{4}$), West half ($W\frac{1}{2}$) of West half ($W\frac{1}{2}$) of Southeast quarter ($SE\frac{1}{4}$) of Southwest quarter ($SW\frac{1}{4}$), Northeast quarter ($NE\frac{1}{4}$) of Southeast quarter ($SE\frac{1}{4}$), Section Four (4). Northwest quarter ($NW\frac{1}{4}$) of Northwest quarter ($NW\frac{1}{4}$) of Northwest quarter ($NW\frac{1}{4}$), Section Six (6). East half ($E\frac{1}{2}$) of Southwest quarter ($SW\frac{1}{4}$), South half ($S\frac{1}{2}$) of North half ($N\frac{1}{2}$) of Southwest quarter ($SW\frac{1}{4}$) of Southwest quarter ($SW\frac{1}{4}$), North half ($N\frac{1}{2}$) of North half ($N\frac{1}{2}$) of Northwest quarter ($NW\frac{1}{4}$) of Southeast quarter ($SE\frac{1}{4}$), Section Eight (8). Southeast quarter ($SE\frac{1}{4}$) of Northwest quarter ($NW\frac{1}{4}$) of Southwest quarter ($SW\frac{1}{4}$), Section Nine (9). West half ($W\frac{1}{2}$) of West half ($W\frac{1}{2}$) of East half ($E\frac{1}{2}$) of Southwest quarter ($SW\frac{1}{4}$) of Northwest quarter ($NW\frac{1}{4}$), West half ($W\frac{1}{2}$) of West half ($W\frac{1}{2}$) of Southwest quarter ($SW\frac{1}{4}$) of Northwest quarter ($NW\frac{1}{4}$), Section Sixteen (16). West half ($W\frac{1}{2}$) of East half ($E\frac{1}{2}$) of Northeast quarter ($NE\frac{1}{4}$) of Southeast quarter ($SE\frac{1}{4}$), Section Twenty-three (23). South half ($S\frac{1}{2}$) of Northwest quarter ($NW\frac{1}{4}$) of Southwest quarter ($SW\frac{1}{4}$), Section Twenty-four (24). East half ($E\frac{1}{2}$) of Southwest quarter ($SW\frac{1}{4}$), Section Twenty-five (25). East half ($E\frac{1}{2}$) of Southwest quarter ($SW\frac{1}{4}$), Northwest quarter ($NW\frac{1}{4}$) of Southwest quarter ($SW\frac{1}{4}$), East quarter ($E\frac{1}{4}$) of Southwest quarter ($SW\frac{1}{4}$), except the East Two (2) rods, Section Twenty-six (26). South half ($S\frac{1}{2}$) of North half ($N\frac{1}{2}$) of Northeast quarter ($NE\frac{1}{4}$) of Southeast quarter ($SE\frac{1}{4}$), South half ($S\frac{1}{2}$) of Northeast quarter ($NE\frac{1}{4}$) of Southeast quarter ($SE\frac{1}{4}$), East half ($E\frac{1}{2}$) of Northwest quarter ($NW\frac{1}{4}$) of Southeast quarter ($SE\frac{1}{4}$), East half ($E\frac{1}{2}$) of West half ($W\frac{1}{2}$) of Southwest quarter ($SW\frac{1}{4}$) of Southeast quarter ($SE\frac{1}{4}$), East half ($E\frac{1}{2}$) of East half ($E\frac{1}{2}$) of Southeast quarter ($SE\frac{1}{4}$) of Southeast quarter ($SE\frac{1}{4}$), Section Twenty-seven (27). West half ($W\frac{1}{2}$) of West half ($W\frac{1}{2}$) of North half ($N\frac{1}{2}$) of Northwest quarter ($NW\frac{1}{4}$) of Northeast quarter ($NE\frac{1}{4}$), West half ($W\frac{1}{2}$) of East half ($E\frac{1}{2}$) of Southeast quarter ($SE\frac{1}{4}$) of Northwest quarter ($NW\frac{1}{4}$), Section Twenty-nine (29). West half ($W\frac{1}{2}$) of East half ($E\frac{1}{2}$) of Southeast quarter ($SE\frac{1}{4}$) of Northeast quarter ($NE\frac{1}{4}$), Section Thirty (30). North half ($N\frac{1}{2}$) of Northeast quarter ($NE\frac{1}{4}$), West half ($W\frac{1}{2}$) of Southwest quarter ($SW\frac{1}{4}$) of Northeast quarter ($NE\frac{1}{4}$), West half ($W\frac{1}{2}$) of East half ($E\frac{1}{2}$) of Southwest quarter ($SW\frac{1}{4}$) of Northeast quarter ($NE\frac{1}{4}$), Southeast quarter ($SE\frac{1}{4}$) of Northwest quarter ($NW\frac{1}{4}$), North half ($N\frac{1}{2}$) of Northeast quarter ($NE\frac{1}{4}$) of Southwest quarter ($SW\frac{1}{4}$), North half ($N\frac{1}{2}$) of South half ($S\frac{1}{2}$) of Northeast quarter ($NE\frac{1}{4}$) of Southwest quarter ($SW\frac{1}{4}$), North half ($N\frac{1}{2}$) of South half ($S\frac{1}{2}$) of Northwest quarter ($NW\frac{1}{4}$) of Southeast quarter ($SE\frac{1}{4}$), South half ($S\frac{1}{2}$) of Southeast quarter ($SE\frac{1}{4}$), Section Thirty-four (34).

Township 13 North, Range 11 West

Northwest quarter ($NW\frac{1}{4}$) of Northeast quarter ($NE\frac{1}{4}$), Southeast quarter ($SE\frac{1}{4}$) of Northwest quarter ($NW\frac{1}{4}$), Northeast quarter ($NE\frac{1}{4}$) of Southwest quarter ($SW\frac{1}{4}$), Section Eighteen (18). Northeast quarter ($NE\frac{1}{4}$) of Northeast quarter ($NE\frac{1}{4}$), Northeast quarter ($NE\frac{1}{4}$) of Southwest quarter ($SW\frac{1}{4}$), Section Nineteen (19). West half ($W\frac{1}{2}$) of Southwest quarter ($SW\frac{1}{4}$), Section Twenty (20).

CONSIDERATION, ACREAGE, DESCRIPTIONS CHECKED
RESERVATION, EXCEPTION, EASEMENT CHECKED

West half ($W\frac{1}{2}$) of Northwest quarter ($NW\frac{1}{4}$), Section Six (6). South half ($S\frac{1}{2}$) of Northwest quarter ($NW\frac{1}{4}$), Northwest quarter ($NW\frac{1}{4}$) of Southwest quarter ($SW\frac{1}{4}$), South half ($S\frac{1}{2}$) of Southwest quarter ($SW\frac{1}{4}$), Section Seven (7). Northwest quarter ($NW\frac{1}{4}$) of Northeast quarter ($NE\frac{1}{4}$), West of Pere Marquette Railroad, East half ($E\frac{1}{2}$) of Northwest quarter ($NW\frac{1}{4}$), Northeast quarter ($NE\frac{1}{4}$) of Southeast quarter ($SE\frac{1}{4}$), Southeast quarter ($SE\frac{1}{4}$) of Southeast quarter ($SE\frac{1}{4}$), Section Eight (8). North half ($N\frac{1}{2}$) of Southwest quarter ($SW\frac{1}{4}$), Southwest quarter ($SW\frac{1}{4}$) of Southwest quarter ($SW\frac{1}{4}$), Northwest quarter ($NW\frac{1}{4}$) of Southeast quarter ($SE\frac{1}{4}$), Section Sixteen (16). Northeast quarter ($NE\frac{1}{4}$) of Northeast quarter ($NE\frac{1}{4}$), Northwest quarter ($NW\frac{1}{4}$) of Southeast quarter ($SE\frac{1}{4}$), Section Eighteen (18). Northwest quarter ($NW\frac{1}{4}$), Southwest quarter ($SW\frac{1}{4}$) of Southeast quarter ($SE\frac{1}{4}$), Section Nineteen (19). Southwest quarter ($SW\frac{1}{4}$) of Northwest quarter ($NW\frac{1}{4}$), Section Twenty (20). Northeast quarter ($NE\frac{1}{4}$) of Southwest quarter ($SW\frac{1}{4}$), North half ($N\frac{1}{2}$) of Southeast quarter ($SE\frac{1}{4}$), Southwest quarter ($SW\frac{1}{4}$) of Southeast quarter ($SE\frac{1}{4}$), Section Twenty-two (22). West half ($W\frac{1}{2}$) of Northeast quarter ($NE\frac{1}{4}$), Northeast quarter ($NE\frac{1}{4}$) of Southeast quarter ($SE\frac{1}{4}$), West half ($W\frac{1}{2}$) of Southeast quarter ($SE\frac{1}{4}$) of Southeast quarter ($SE\frac{1}{4}$), Section Twenty-three (23). Northeast quarter ($NE\frac{1}{4}$) of Northeast quarter ($NE\frac{1}{4}$), Section Twenty-five (25). Northeast quarter ($NE\frac{1}{4}$), Southeast quarter ($SE\frac{1}{4}$) of Northeast quarter ($NE\frac{1}{4}$) of Northwest quarter ($NW\frac{1}{4}$), Section Twenty-seven (27). Northwest quarter ($NW\frac{1}{4}$), Section Twenty-nine (29). North half ($N\frac{1}{2}$) of Northwest quarter ($NW\frac{1}{4}$) of Northwest quarter ($NW\frac{1}{4}$), Northwest quarter ($NW\frac{1}{4}$) of Southwest quarter ($SW\frac{1}{4}$), North half ($N\frac{1}{2}$) of Southwest quarter ($SW\frac{1}{4}$) of Southwest quarter ($SW\frac{1}{4}$), Northeast quarter ($NE\frac{1}{4}$) of Southeast quarter ($SE\frac{1}{4}$) of Southwest quarter ($SW\frac{1}{4}$), West half ($W\frac{1}{2}$) of Southeast quarter ($SE\frac{1}{4}$) of Southwest quarter ($SW\frac{1}{4}$), West half ($W\frac{1}{2}$) of Northwest quarter ($NW\frac{1}{4}$) of Southeast quarter ($SE\frac{1}{4}$), Section Thirty (30). East half ($E\frac{1}{2}$) of Northeast quarter ($NE\frac{1}{4}$) of Northwest quarter ($NW\frac{1}{4}$), South half ($S\frac{1}{2}$) of Northwest quarter ($NW\frac{1}{4}$) of Southwest quarter ($SW\frac{1}{4}$), South half ($S\frac{1}{2}$) of Southwest quarter ($SW\frac{1}{4}$) of Southwest quarter ($SW\frac{1}{4}$), North half ($N\frac{1}{2}$) of Southeast quarter ($SE\frac{1}{4}$) of Southwest quarter ($SW\frac{1}{4}$), Section Thirty-one (31). South half ($S\frac{1}{2}$) of Northeast quarter ($NE\frac{1}{4}$) of Northwest quarter ($NW\frac{1}{4}$), North half ($N\frac{1}{2}$) of Southeast quarter ($SE\frac{1}{4}$) of Northwest quarter ($NW\frac{1}{4}$), Southeast quarter ($SE\frac{1}{4}$) of Southeast quarter ($SE\frac{1}{4}$), West of Pere Marquette Railroad, Section Thirty-two (32). 227

Township 13 North, Range 13 West

North half ($N\frac{1}{2}$) of Northwest quarter ($NW\frac{1}{4}$), Section One (1). North half ($N\frac{1}{2}$) of Northeast quarter ($NE\frac{1}{4}$), Southwest quarter ($SW\frac{1}{4}$) of Northeast quarter ($NE\frac{1}{4}$), Section Two (2). East half ($E\frac{1}{2}$) of Northeast quarter ($NE\frac{1}{4}$), Southwest quarter ($SW\frac{1}{4}$) of Southwest quarter ($SW\frac{1}{4}$), Southeast quarter ($SE\frac{1}{4}$) of Southwest quarter ($SW\frac{1}{4}$), North of Railroad, North half ($N\frac{1}{2}$) of Southeast quarter ($SE\frac{1}{4}$), North of Railroad, Section Eleven (11). South half ($S\frac{1}{2}$) of Northeast quarter ($NE\frac{1}{4}$), Northeast quarter ($NE\frac{1}{4}$) of Northwest quarter ($NW\frac{1}{4}$), South of Railroad, Southeast quarter ($SE\frac{1}{4}$) of Northwest quarter ($NW\frac{1}{4}$), North half ($N\frac{1}{2}$) of Southwest quarter ($SW\frac{1}{4}$), East half ($E\frac{1}{2}$) of Southeast quarter ($SE\frac{1}{4}$), Section Twelve (12). North half ($N\frac{1}{2}$) of Northwest quarter ($NW\frac{1}{4}$), Southeast quarter ($SE\frac{1}{4}$) of Northwest quarter ($NW\frac{1}{4}$), Northeast quarter ($NE\frac{1}{4}$) of Southwest quarter ($SW\frac{1}{4}$), Southwest quarter ($SW\frac{1}{4}$) of Southwest quarter ($SW\frac{1}{4}$), Section Thirteen (13). Northeast quarter ($NE\frac{1}{4}$) of Southwest quarter ($SW\frac{1}{4}$), Section Fourteen (14). North half ($N\frac{1}{2}$) of Southeast quarter ($SE\frac{1}{4}$), Southwest quarter ($SW\frac{1}{4}$) of Southeast quarter ($SE\frac{1}{4}$), Section Fifteen (15). North half ($N\frac{1}{2}$) of Northeast quarter ($NE\frac{1}{4}$), Northwest quarter ($NW\frac{1}{4}$) of Northwest quarter ($NW\frac{1}{4}$), Northeast quarter ($NE\frac{1}{4}$) of Southwest quarter ($SW\frac{1}{4}$) of Southwest quarter ($SW\frac{1}{4}$) of Northwest quarter ($NW\frac{1}{4}$), South half ($S\frac{1}{2}$) of Southwest quarter ($SW\frac{1}{4}$) of Northwest quarter ($NW\frac{1}{4}$), Section Twenty-three (23). Northeast quarter ($NE\frac{1}{4}$) of Southeast quarter ($SE\frac{1}{4}$), Section Twenty-four (24). South half ($S\frac{1}{2}$) of Northeast quarter ($NE\frac{1}{4}$) of Southeast quarter ($SE\frac{1}{4}$), Section Thirty-six (36). 134

Township 14 North, Range 11 West

Southeast quarter ($SE\frac{1}{4}$) of Northwest quarter ($NW\frac{1}{4}$) subject to easement to the Consumers Power Company, Jackson, Michigan, to construct and maintain a pipe line right of way over and across said premises, Northeast quarter ($NE\frac{1}{4}$) of Southwest quarter ($SW\frac{1}{4}$), Section Eleven (11). Northeast quarter ($NE\frac{1}{4}$) of Northwest quarter ($NW\frac{1}{4}$), Southwest quarter ($SW\frac{1}{4}$) of Southwest quarter ($SW\frac{1}{4}$), subject to easement to the Consumers Power Company, Jackson, Michigan, to construct and maintain a pipe line right of way over and across said premises, Section Twelve (12). South half ($S\frac{1}{2}$) of Northeast quarter ($NE\frac{1}{4}$), Section Twenty-two (22). West half ($W\frac{1}{2}$) of Northwest quarter ($NW\frac{1}{4}$), Section Twenty-four (24). Northeast quarter ($NE\frac{1}{4}$) of Northeast quarter ($NE\frac{1}{4}$), North half ($N\frac{1}{2}$) of Northwest quarter ($NW\frac{1}{4}$), East half ($E\frac{1}{2}$) of Southeast quarter ($SE\frac{1}{4}$), Section Twenty-six (26). East half ($E\frac{1}{2}$) of Southeast quarter ($SE\frac{1}{4}$), Section Thirty-one (31). South half ($S\frac{1}{2}$) of Northeast quarter ($NE\frac{1}{4}$), Section Thirty-two (32). Northeast quarter ($NE\frac{1}{4}$) of Northwest quarter ($NW\frac{1}{4}$), West half ($W\frac{1}{2}$) of Northeast quarter ($NE\frac{1}{4}$) of Southeast quarter ($SE\frac{1}{4}$) of Northwest quarter ($NW\frac{1}{4}$), East half ($E\frac{1}{2}$) of Northwest quarter ($NW\frac{1}{4}$) of Southeast quarter ($SE\frac{1}{4}$) of Northwest quarter ($NW\frac{1}{4}$), South half ($S\frac{1}{2}$) of Southeast quarter ($SE\frac{1}{4}$) of Northwest quarter ($NW\frac{1}{4}$), Section Thirty-three (33). Northwest quarter ($NW\frac{1}{4}$) of Northwest quarter ($NW\frac{1}{4}$), Section Eight (8). 338

Township 14 North, Range 12 West

Northeast quarter ($NE\frac{1}{4}$) of Northeast quarter ($NE\frac{1}{4}$), South half ($S\frac{1}{2}$) of Northeast quarter ($NE\frac{1}{4}$), South half ($S\frac{1}{2}$) of Northwest quarter ($NW\frac{1}{4}$), South half ($S\frac{1}{2}$), Section Six (6). North half ($N\frac{1}{2}$) of Southwest quarter ($SW\frac{1}{4}$), Section Eight (8). East half ($E\frac{1}{2}$) of Northwest quarter ($NW\frac{1}{4}$), Section Eleven (11). North half ($N\frac{1}{2}$) of Northeast quarter ($NE\frac{1}{4}$), Southeast quarter ($SE\frac{1}{4}$) of Northeast quarter ($NE\frac{1}{4}$), Northwest quarter ($NW\frac{1}{4}$), Section Fourteen (14). North half ($N\frac{1}{2}$) of Northeast quarter ($NE\frac{1}{4}$), Northwest quarter ($NW\frac{1}{4}$) of Southeast quarter ($SE\frac{1}{4}$), Section Seventeen (17). Southeast quarter ($SE\frac{1}{4}$) of Northeast quarter ($NE\frac{1}{4}$), Section Nineteen (19). North half ($N\frac{1}{2}$) of Northwest quarter ($NW\frac{1}{4}$), Section Twenty-two (22). North half ($N\frac{1}{2}$) of Northwest quarter ($NW\frac{1}{4}$), Southwest quarter ($SW\frac{1}{4}$) of Southeast quarter ($SE\frac{1}{4}$), Section Twenty-four (24). Northwest quarter ($NW\frac{1}{4}$) of Northeast quarter ($NE\frac{1}{4}$), Section Twenty-five (25). West half ($W\frac{1}{2}$) of Southwest quarter ($SW\frac{1}{4}$), Section Thirty-one (31). 287

SAVING AND EXCEPTING out of this conveyance, and always reserving unto the said State of Michigan all mineral, coal, oil and gas, lying and being on, within or under the said lands hereby conveyed, with full and free liberty and power to the State of Michigan, its duly authorized officers, representatives and assigns, and its or their lessees, agents, workmen, and all other persons by its or their authority or permission, whether already given or hereafter to be given, at any time and from time to time to enter upon said lands and take all usual, necessary or convenient means for exploring, mining, working, piping, getting, laying up, storing, dressing, making merchantable and taking away the said mineral, coal, oil and gas, pursuant to the provisions of Section 8 of Act 280, Public Acts of 1909, and also reserving to the People of the State of Michigan the rights of ingress and egress over and across any of said lands lying along any watercourse or stream, as also provided in said Section 8 of Act 280, Public Acts of 1909; Further, excepting and reserving to the State of Michigan all aboriginal antiquities including mounds, earth-works, forts, burial and village sites, mines or other relics and also reserving the right to explore and excavate for the same, by and through its duly authorized agents and employes, pursuant to the provisions of Act 173, Public Acts of 1929.

IN WITNESS WHEREOF, The said party of the first part, by its Director, acting under the authority delegated in him by the said Department of Conservation by resolution adopted September 1, 1921, under the provisions of Section 2, Act 17 of the Public Acts of 1921, Legislature of Michigan, has hereunto subscribed its name and affixed the seal of the Department of Conservation the day and year first herein above written.

Signed, Sealed and Delivered in Presence of:

Rhea Arndt
Rhea Arndt
Mary Kokinakis
Mary Kokinakis

DEPARTMENT OF CONSERVATION FOR THE
STATE OF MICHIGAN

P. J. Hoffmaster
P. J. Hoffmaster, Director

STATE OF MICHIGAN)
County of Ingham) ss

On this 12th day of April A. D. 1945, before me, a Notary Public in and for said county personally appeared P. J. Hoffmaster, Director of the Department of Conservation for the State of Michigan, to me known to be the same person who executed the foregoing instrument, and who acknowledged the same to be his free act and deed and the free act and deed of the Department of Conservation for the State of Michigan in whose behalf he acts for the purpose of complying with the provisions of Act 193 of the Public Acts of 1911, Legislature of Michigan.

M. Irene Gorsline
M. Irene Gorsline
Notary Public, Ingham County, Michigan
My Commission expires, June 1, 1947

Recorded in Liber 40 of Deeds, Page 672

RECEIVED
APR 30 1945
LANDS DIVISION

Recorded: Sept. 8, 1941
at 4:30 P.M.

Liber 181, Deeds, page 21

55¢ in documentary stamps
affixed and cancelled.

WARRANTY DEED

GETTY L. ROSENBERG and ZELLA M. ROSENBERG, his wife, of
White Cloud, County of Newaygo, State of Michigan, grantors,
hereby CONVEY and WARRANT to UNITED STATES OF AMERICA, grantee,
and its assigns, for the sum of ONE HUNDRED EIGHT AND NO/100
DOLLARS (\$108.00), all that certain tract of land situated in
Newaygo County, Michigan, and described as follows:

TOWNSHIP FOURTEEN (14) NORTH, RANGE ELEVEN (11)
WEST OF THE MICHIGAN MERIDIAN,

SECTION THIRTY-FOUR (34):

Northwest Quarter of Northwest Quarter (NW¹/₄ NW¹/₄):

containing forty (40) acres, more or less.

RESERVING unto the grantors herein, their heirs, executors,
administrators or assigns, all oil, gas and metallic mineral rights
until December 31, 1959; provided, however, that said operations
shall be done and carried on in accordance with the rules and regu-
lations prescribed by the Secretary of Agriculture of the United
States of America, pertaining thereto, dated January 23, 1937, the
text of which rules and regulations is attached hereto as "EXHIBIT
I" and made a part hereof.

SUBJECT, HOWEVER, to an undivided one-half (1/2) interest
in the oil, gas and mineral rights until December 31, 1959, as
said rights appear from the records of Newaygo County, Michigan
to be outstanding in third parties.

IN WITNESS WHEREOF, the said grantors have hereunto set
their hands this 6th day of September,
A. D. 1941.

In the presence of:

S. K. Riblet
S. K. Riblet

Getty L. Rosenberg
Getty L. Rosenberg

Erna L. Nelson
Erna L. Nelson

Zella M. Rosenberg
Zella M. Rosenberg

* RECORDED IN 1941 SEP 12/2/41
BY THE CLERK OF THE COURT
1941 SEP 12/2/41

STATE OF MICHIGAN)
COUNTY OF NEWAYGO) SS

On this 6th day of Sept. A. D. 1941,
before me, a Notary Public, personally appeared GETTY L. ROSENBERG
and ELLA M. ROSENBERG, his wife, to me known to be the persons
described in and who executed the foregoing instrument and acknowl-
edged that they executed the same as their free act and deed.

S. K. Riblet
S. K. Riblet
Notary Public, County of Newaygo,
State of Michigan.

(NOTARIAL SEAL)
affixed

My commission expires: March 13, 1942