



Michigan Department of Natural Resources
Forest Resources Division

SURVEY PROJECT NO.:

--	--	--	--	--	--	--	--	--	--

SURVEY REQUEST

Requesting Agency MDNR-FRD			
County Cheboygan	Township 37N	Range 02W	Section(s) 6/7
Location Sec. 6 SE 1/16, Sec. 7 NE 1/16		Priority High	
Survey Purpose Pending timber sale boundary		Desired Completion Date ASAP	

Requirements (specify lines or attach map)

Establish 1/16 survey corner to verify 1/2 mile of property ownership for timber sale boundary.

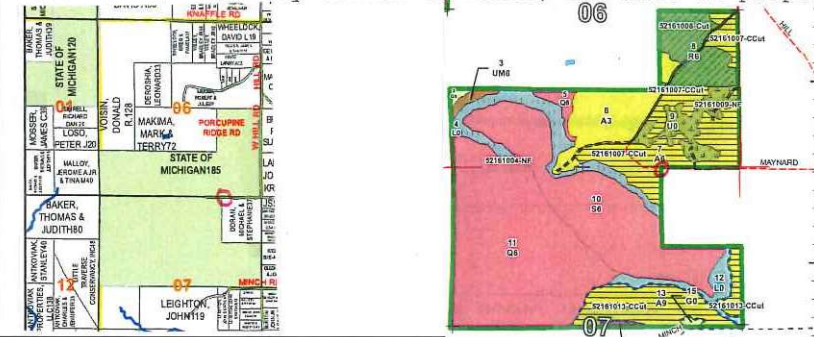

Requested By	Date
--------------	------

SURVEY PROJECT ESTABLISHMENT

Assigned Priority	Expected Completion Date
Assigned To	Supervisor's Signature

COMPLETION REPORT

Miles of Boundary Line	Date Completed
Number of Corners Set	Number of Corners Upgraded
Maps To	LCRC's To

SURVEY PRIORITY JUSTIFICATION

1. Is litigation involved now or being threatened? Explain:

No.

2. If trespass is on state land, is the survey likely to prevent further trespass and harm, or is it to prove trespass? Explain:

N/A

3. Is prevention of access to a significant area of state land involved? Explain:

N/A

4. Will a survey allow harvest of timber that is being held from the market due to survey problems? What is the value of the proposed sale? Explain (i.e., give the compartment, year of entry, timber condition, etc.):

Pending timber sale (Lafleur Aspen, 52-102-24). Requested corner placement will verify location of property lines.

5. Are there reasonable alternatives to a survey that will allow at least a partial or temporary solution? (Example: Reduce size of the sale, agreement with or notification of adjacent landowner until proper survey can be done, establish line yourself, etc.) Explain:

Approximate location of requested corner was determined by measuring from existing 1/4 corners with GPS.

6. Other: