



**DEPARTMENT OF NATURAL RESOURCES
STATE OF MICHIGAN**

TIMBER SALE PROSPECTUS #6019

SCHEDULED SALE DATE AND TIME: 3:00 p.m. (local time) on October 26, 2017.

LOCATION: GAYLORD FIELD OFFICE, 1732 WEST M-32, GAYLORD, MI 49735.

PROSPECTUS NOTE: The bidder is advised to inspect the sale area and review the location, estimated volumes, operating costs and contract terms of proposed sales. Please be aware that some landowners may request 60 days or more notice for access across their land.

Notice is hereby given that bids will be received by the Unit Manager, GAYLORD MANAGEMENT UNIT, for certain timber on the following described lands:

Two Moves Mix (52-011-17)

Antrim County, Advertised Price \$47,886.00, 29.6 Acres, Hardwood, Red Pine.

SALE NOTE: Access to Class "A" roads, no timing restrictions on cutting. Red Pine of decent quality and size.

A recreation site such as a trail, pathway, or campground is within the sale area or the vicinity. Certain restrictions/specifications may be applicable including time restrictions.

Little Crago Lake Jack Pine (52-021-17)

Otsego County, Advertised Price \$18,580.85, 54.1 Acres, Jack Pine, Red Pine.

SALE NOTE: Predominantly jack pine with some red pine, aspen, and oak. Mostly flat topography. Snowmobile trail and ORV trail within the vicinity.

Oak wilt restrictions are in place for 150 feet of the western boundaries of Payment Units 1 and 3. In addition, great care must be taken to avoid damage to undesignated oak trees along sale boundaries, retention islands, skid trails, and haul routes during April 15th through July 15th.

Private property access through Consumer's Energy property would be the easiest way to access Payment Unit 1. The Purchaser must obtain permission, or additional access through State land can also be arranged.

A recreation site such as a trail, pathway, or campground is within the sale area or the vicinity. Certain restrictions/specifications may be applicable including time restrictions. Access may be through private land.

Highline Jack Pine (52-022-17)

Otsego County, Advertised Price \$13,470.55, 49.3 Acres, Hardwood, Jack Pine.

SALE NOTE: Predominantly jack pine with some oak, aspen, and red maple. Mostly flat topography. Snowmobile trail and ORV trail within the vicinity.

Payment Units 1 and 3-5 must be chip harvested.

Oak wilt restrictions are in place for Payment Units 1 and 2. In addition, great care must be taken to avoid damage to undesignated oak trees along sale boundaries, retention islands, skid trails, and haul routes during April 15th through July 15th.

A recreation site such as a trail, pathway, or campground is within the sale area or the vicinity. Certain restrictions/specifications may be applicable including time restrictions. Access may be through private land.

St. Anna's Swamp Mix (52-023-17)

Charlevoix County, Advertised Price \$36,811.75, 48.3 Acres, Hardwood, N White Cedar.

SALE NOTE: Payment Unit 1 is an upland unit and Payment Unit 2 is a lowland unit. Payment Unit 2 consists of three small stands, which may only be harvested during frozen winter or dry summer conditions. This treatment is intended to improve wildlife habitat within the lowland cover type.

BID INSTRUCTIONS (VER. 09/02/2016):

1. Scheduled Bid Location, Date, and Time (2/11)

Bids must be received by the Unit Manager, GAYLORD OFFICE, 1732 WEST M-32, GAYLORD, MI 49735, no later than 3:00 p.m. (local time) on October 26, 2017. For further information concerning this sale, contact Joyce Angel at 989-732-3541 extension 5440.

2. Bidder's Qualifications (5/16)

Purchaser shall obtain workers compensation insurance to cover claims under Michigan's Worker's Disability Compensation Act of 1969 or similar employee benefit act of any other state applicable to an employee. If all or part of a timber sale was prepared by a private contractor, the contractor and that contractor's company are not permitted to bid on the timber sale contract. Bids will not be accepted from individuals or companies appearing on the DNR/FRD No-Bid List. This list contains the names of purchasers who previously failed to execute a contract within 21-days or who have a history of poor performance.

3. Preparation of Sealed Bids (5/16)

Bid Forms may be completed online thru Michigan DNR Timber Sale Online Bidding (OLB) at www.michigan.gov/timberbidding or by completing the hardcopy Bid Form found in the Timber Sale Prospectus. Hardcopy Bid Forms shall be manually signed in ink. Registration in OLB is considered your 'signature' for all bids submitted thru that system. Bid prices must be entered for each species and product in the Bid Price column for all material subject to bidding and all fill-in blanks must be completed. If erasures or other changes appear on the hardcopy Bid Form, each erasure or change must be initialed by the person signing the bid.

4. Submission of Sealed Bids (5/16)

Bid forms may be obtained from the Unit Manager or thru OLB. Bids may be submitted hardcopy or thru OLB. All hardcopy bids must be submitted on the bid form and in an envelope clearly identified as described in this section. NOTE: Only one bid form per bid envelope. Sealed bids must be submitted to the Unit office designated in the prospectus and must be submitted at or prior to the time established in the prospectus. The envelope should show on the outside (a) the sale name or number and (b) the date and time of bid opening, as shown in the prospectus. Bids received after the time specified in the sale prospectus are late bids and will be rejected.

It is possible for a bidder to submit multiple bids on a single sale. For example, a bid may be submitted hardcopy and a bid may be submitted thru OLB. Or, two bidders from the same company could both submit bids on the same sale. If this were to happen, the State would accept all bids received and award the contract accordingly. All bidding and contractual requirements would apply to all bids received.

5. Public Opening of Sealed Bids (7/16)

If conditions permit, the sealed bids will be publicly opened and posted at the time and place set in the prospectus.

If a bidder, present at a bid opening, has submitted bids on more than one sale, that bidder may withdraw their unopened bid envelopes or announce the withdrawal of their online bid after being declared the successful bidder on one sale.

6. Award of Contract (1/11)

Award of the contract will be made to the Bidder whose bid, conforming to the prospectus, is most advantageous to the State of Michigan on the basis of total value at rates bid for the estimated quantities. The State reserves the right to reject any bid or waive any minor irregularity in bids received. A written award mailed (or otherwise furnished) to the successful Bidder shall be deemed to result in a binding contract without further action by either party.

7. Down Payment (1/11)

The Bidder to whom award is made must make a down payment within 21 days of the sale award. The amount of the down payment will be calculated as shown in the Bond and Payment Schedule of this prospectus. Only cash may be used to meet this requirement.

8. Performance Security (1/11)

As guarantee of faithful performance, a cash bond, certificate of deposit, surety bond or irrevocable letter of credit (LOC) is required within 21 days of the sale award. The amount of the performance security is shown in the Bond and

Payment Schedule of this prospectus. If an LOC or surety is used, the coverage must extend for at least 6 months beyond the contract expiration.

9. Timber Sale Contract (9/14)

Additional conditions and requirements common to all timber sales are listed on the timber sale contract (R4031) and are available on line at www.michigan.gov/timber. Contact the Unit Manager for additional information or a sample contract. Within 21 days of the date of the award letter, the bidder must sign the contract and provide the required down payment, performance security, and verification of worker's disability compensation. The down payment and performance security shall be in accordance with the provisions of the timber sale contract, in the sums stated in this prospectus. If these actions are not taken, then the Bidder, the Bidder's corporation, and the corporation's principals may not be permitted to bid on State timber sales for a period of 1 year. In addition, the Bidder certifies that if awarded this contract, the Bidder will complete the timber sale contract in accordance with its terms and any modifications thereof including requirements to purchase, cut, and remove the included timber by the expiration date.

10. Disclaimer of Estimates and Bidder's Warranty of Inspection (7/16)

Before submitting this bid, the Bidder is advised and cautioned to inspect the sale area, review the requirements of the sale contract, and take other steps as may be reasonably necessary to ascertain the location, estimated volumes, construction estimates, and operating costs of the proposed sale. Failure to do so will not relieve the Bidder from responsibility for completing the contract.

The Bidder warrants that this bid is submitted solely on the basis of the Bidder's examination and inspection of the quality and quantity of the timber offered for sale and the Bidder's opinion of the value thereof and the costs of recovery. No reliance should be placed on the State of Michigan's estimates of timber quality, quantity or costs of recovery. Bidder further acknowledges that the State of Michigan: (i) expressly disclaims any warranty of fitness of timber for any purpose; (ii) offers this timber as is without any warranty of quality (merchantability) or quantity and (iii) expressly disclaims any warranty as to the quantity or quality of timber sold.

11. Certification and Chain-of-Custody (10/14)

Unless otherwise indicated in the contract under section 7 – Other Conditions of the Sale Specific Conditions & Requirements, the area encompassed by this timber sale is certified to the standards of the Forest Stewardship Council (FSC) - Certificate #SCS-FM/COC-00090N and the Sustainable Forestry Initiative (SFI) - Certificate #NSF-SFIS-5Y031-SF5. Forest products from this sale may be delivered to the mill as "FSC 100% and / or SFI certified" as long as the contractor hauling the forest products is chain-of-custody (COC) certified or covered under a COC certificate from the destination mill. The purchaser is responsible for maintaining COC after leaving the sale area.

12. Good Neighbor Authority (GNA) Requirements (7/16)

If the name of this timber sales contains the acronym GNA, it is authorized by the Good Neighbor Authority (GNA) and covered by various agreements between the U.S. Forest Service and the State. The timber sale occurs on federal land and the following conditions apply:

GNA contracts on US Forest Service land will not be awarded to purchasers on the Federal list of excluded parties. The System for Award Management (SAM) will be checked for active excluded parties prior to award of contract. In addition, the Bidder to whom award is made must complete an Assurance Regarding Felony Conviction or Tax Delinquent Status for Corporate Applicants (AD-3031).

13. Good Neighbor Authority (GNA) Requirements, con't (9/16)

Bidder certifies, by signing this bid form, that to the best of Bidder's knowledge that the following representations are accurate and complete.

- a. That the Bidder and its principals are not presently debarred, suspended, proposed for debarment, declared ineligible, or voluntary excluded from timber sales (covered transactions) by any Federal department or agency.
- b. That the Bidder and its principals have not within a 3-year period preceding this bid been convicted of or had a civil judgment rendered against them for commission of fraud or a criminal offense in connection with obtaining, attempting to obtain, or performing a public (Federal, State, or local) transaction or contract under a public transaction; violation of Federal or State antitrust statutes or commission of embezzlement, theft, forgery, bribery, falsification or destruction of records, making false statements, or receiving stolen property.

c. That the Bidder and its principals are not presently indicted for or otherwise criminally or civilly charged by a governmental entity (Federal, State, or local) with commission of any of the offenses enumerated in paragraph b of this certification.

d. That the Bidder and its principals have not within a 3-year period preceding this bid had one or more public transactions (Federal, State, or local) terminated for breach or default of a timber or forest product contract.

Bidders that cannot certify this requirement, in whole or in part, shall submit an explanation with their bid.

KEITH CREAGH

Director

TIMBER SALE INFORMATION

Two Moves Mix (52-011-17)

Antrim County (Advertised Price \$47,886.00)

SALE NOTE: Access to Class "A" roads, no timing restrictions on cutting. Red Pine of decent quality and size.

A recreation site such as a trail, pathway, or campground is within the sale area or the vicinity. Certain restrictions/specifications may be applicable including time restrictions.

A timber sale contract for this lump sum, sealed bid timber sale will be awarded to the responsible bidder offering the highest sealed bid price. Bids must be at or above the following advertised price for each species:

<u>PRODUCTS & SPECIES</u>	<u>ESTIMATED UNITS*</u>	<u>ADVERTISED PRICE</u>
Sawtimber		
B. T. Aspen	4.90 MBF	\$ 53.00 / MBF
Quaking Aspen	1.90 MBF	\$ 53.00 / MBF
Red Maple	36.70 MBF	\$ 160.00 / MBF
Red Pine	116.20 MBF	\$ 124.00 / MBF
Pulpwood		
Mixed Aspen	24.00 Cords	\$ 18.90 / Cord
Mixed Hardwood	318.00 Cords	\$ 21.60 / Cord
Red Maple	24.00 Cords	\$ 21.60 / Cord
Red Pine	385.00 Cords	\$ 50.40 / Cord

* The total volume is statistically estimated within plus (+) or minus (-) 16.07 percent. The estimated units are final and not subject to adjustment. Prospective bidders are urged to examine this timber and to make their own estimates of quantity and quality.

BOND AND PAYMENT SCHEDULE:

1. A bond in the amount of \$2,394.00 to insure faithful performance of the conditions of the contract will be deposited by the successful bidder within 21 days of the sale award.
2. Cutting in any sale or unit without the required advance payment would be considered a trespass.
3. Total payment must be paid in advance or according to the following schedule:
 - (a) Ten percent (10%) of the sale value must be paid within 21 days of the sale award.
 - (b) The 10% down payment will be credited towards the first unit cut.
4. If no cutting takes place, the 10% down payment will not be refunded.
5. Operations on the contract issued will terminate on 04/01/2021.

Description of Timber by Payment Unit (PU)

PU	MARKET GROUP	PRODUCT	QUANTITY	UNIT	ACRES	ADVERTISE PRICE
1	Red Maple	Sawtimber	4.1	MBF	15.2	\$32,906.40
	Red Pine		109.0	MBF		
	Mixed Hardwood	Pulpwood	25.0	Cords		
	<i>Red Maple</i>		25.0	<i>Cords</i>		
	Red Pine		361.0	Cords		
2	B. T. Aspen	Sawtimber	4.9	MBF	14.4	\$14,979.60
	Quaking Aspen		1.9	MBF		
	Red Maple		32.6	MBF		
	Red Pine		7.2	MBF		
	Mixed Aspen	Pulpwood	24.0	Cords		
	<i>B. T. Aspen</i>		8.0	<i>Cords</i>		
	<i>Quaking Aspen</i>		16.0	<i>Cords</i>		
	Mixed Hardwood		317.0	Cords		
	<i>Beech</i>		9.0	<i>Cords</i>		
	<i>Red Maple</i>		280.0	<i>Cords</i>		
	<i>Sugar Maple</i>		28.0	<i>Cords</i>		
	Red Pine		24.0	Cords		
	TOTAL:			159.7		
TOTAL:			751.0	Cords		

Sale Specific Conditions & Requirements

Sale Name: Two Moves Mix

Sale Number: 52-011-17 Seq#: 1

1 - Sale Area

1.2 - Boundaries

1.2.1 - Painted boundaries (1/14)

The sale boundary and Payment Unit boundaries are marked and identified by teal, red and yellow paint. Exterior sale boundary lines against state are marked with red paint. Interior Payment Unit boundaries are marked with yellow paint. Retention boundaries are marked with teal paint and are not to be entered by equipment. The painted boundary line trees are not Included Timber and are to be protected. Yellow painted trees designating an interior Payment Unit boundary are only to be cut when all surrounding Payment Units have been paid.

2 - Timber Specifications

2.1 - Included Timber

2.1.1 - Clearcut unit(s) with unmerchantable trees (6/14)

Within Payment Unit(s) 1 and 2, cut all trees that are two (2) inches or more at DBH.

2.1.11 - Description of timber note (2/04)

Note that Mixed hardwood includes sugar maple, red maple, and beech. Also, Mixed Aspen includes big tooth and quaking aspen.

3 - Payments

3.3 - Pre-measured Sales

3.3.4 - Dividing payment units (7/14)

Payment Unit(s) 1 and 2 may be divided at the request of the Purchaser and upon approval of the Unit Manager. Dividing Payment Units is a contract modification which requires a Timber Sale Contract Supplement. There will be only one division per Payment Unit.

3.4 - Damaged Timber

3.4.1 - Damaged timber (6/14)

General Condition and Requirement 3.4 Damaged Timber, defines liquidated damages for undesignated live merchantable trees which are cut or injured. No damage is acceptable to merchantable trees. Within the sale area, if more than 5% of trees (> 4.5" DBH) within a specified area of the sale are damaged, liquidated damages will be assessed for all trees damaged. Rates will be in accordance with General Condition and Requirement 3.4 Damaged Timber.

4 - Transportation

4.1 - Construction

4.1.3 - Slash and earthen piles (8/04)

Piles or windrows of earth along roads and landings that have been widened or constructed shall be leveled. Slash from road maintenance or construction, including stumps, shall be dispersed throughout the sale.

4.1.12 - No new roads (1/12)

No new roads will be permitted in any Payment Unit. All operations are limited to existing roads. Skid trails only will be allowed.

4.2 - Maintenance

4.2.4 - Grading (10/16)

For completion of the sale, state forest roads must be graded. In general, this will require a road grader or bull dozer to shape up the roads after forest products have been hauled off site. This includes cleaning of drainage areas, grading, crowning and filling with gravel, if necessary. The grading equipment to be used must be approved by the Unit Manager or his/her representative.

4.2.5 - Two wheel drive condition (2/04)

All existing trail roads on and adjacent to the sale area must be passable by two-wheel drive traffic for the duration of the sale.

5 - Operations

5.1 - Notification

5.1.3 - Well heads and natural gas pipelines (11/15)

The Purchaser is responsible for contacting the gas or pipeline company 30 days prior to operating equipment in the vicinity of well heads or natural gas pipelines.

5.2 - Conduct of Operations

5.2.1 - Slash

5.2.1.8 - Slash height (12/08)

No slash or tree tops may exceed 24 inches in height.

5.2.2 - Hazard Trees/Snags

5.2.2.1 - Den trees (10/16)

Obvious hollow and/or den trees shall be protected and left standing unless they are a safety hazard.

5.2.3 - Operating Restrictions

5.2.3.11 - Coppice regeneration protection (4/10)

Timber harvesting in any Payment Unit must be completed before significant sprouting occurs in that Payment Unit so as to minimize damage to the new regeneration. Any post harvest operations, such as chipping, must be completed before sprouting of regeneration occurs. If it is anticipated that chipping will be delayed, then tops shall be carried to one central location or left unchipped. The Unit Manager or his/her representative may cease such operations if sprouting occurs before the operation is complete.

5.2.29 - Shrub protection (9/07)

Do not cut or damage hawthorn, witch-hazel, dogwood or junberry. These woody-shrub plants are highly beneficial to various wildlife species.

5.2.32 - Decking/landing restoration (9/13)

All decking and landing areas must have the surface area restored to a condition equal to or better than before. This is to ensure the proper regeneration of the stand. Wood debris, chips and "cookies" from trimmings must be removed or scattered away from landing and loading areas and may not be windrowed on the edge.

5.2.39 - ORV trail/route protection (12/12)

The ORV trail route is shown on the Timber Sale Map. Trees with orange ORV markers shall be cut off above the markers and at least 5 feet above ground. All stumps within 5 feet of the trail must be cut flush with the ground. Maintain a 20 foot wide slash, debris, and rut free zone daily using the ORV trail or route as the centerline. Do not run equipment down the ORV trail or route. Skidding across the trail or route may only occur in locations approved by the sale administrator.

5.4 - Soil Protection

5.4.1 - Rutting restriction, general (7/16)

Operations are to cease immediately if equipment and weather conditions result in rutting of roads and/or skid trails which is 12 inches or greater in depth and 50 feet in length. The Unit Manager or his/her representative may restrict hauling and/or skidding if ruts exceed the specified depth. With the Unit Manager or his/her representative's approval, the Purchaser may return to the area when the risk of rutting has decreased.

5.8 - Protection of Endangered Species

5.8.5 - Protection of raptor nests (3/13)

All trees with raptor nests will be protected if found during harvesting operations. Notification will be made to the Unit Manager or his/her representative who will notify the Wildlife Biologist so an on-site evaluation and recommendation can be

made, if necessary.

6 - Safety and Fire Prevention

6.2 - Signing

6.2.1 - Road posting (9/09)

The Purchaser is responsible for posting and maintaining caution signs on the haul route prior to beginning operations. The road must be posted at appropriate distances from the sale area to warn of logging activity and truck traffic. Signs must be removed when harvest operations are suspended or completed. The Purchaser will provide these signs.

6.2.3 - Recreational trail posting (2/10)

The Purchaser is responsible for posting and maintaining caution signs on the ORV trail prior to beginning operations. The trail must be posted at appropriate distances from the sale area to warn of logging activity and truck traffic at both ends of the trail. Signs must be removed when harvest operations are suspended or completed. The Purchaser will provide these signs.



TIMBER SALE MAP

This information provided by authority of Part 525, 1994 PA 451, as amended.

Forest Management Unit Gaylord		County Antrim	Mapped By Zachary Crew	Date 02/24/17	Page 1	of 1
Township 29N	Range 05W	Section(s) and Subdivision(s) 23 - SE1/4; 26 - NW/NE		Scale 1:15,840		

Cover Type				Density			
A = Aspen	H = Hemlock	N = Marsh	U = Upland Brush	0 = Non Stocked	5 = Pole Timber Medium		
B = Paper Birch	J = Jack Pine	O = Oak	UM = Upland Mixed	1 = Seedling Sapling Poor	6 = Pole Timber Well		
C = Cedar	L = Lowland Brush	P = Lowland Poplar	V = Bog or Marsh	2 = Seedling Sapling Medium	7 = Saw Timber Poor		
D = Tread Bog	LM = Lowland Mixed	Q = Mixed Swamp Conifer	W = White Pine	3 = Seedling Sapling Well	8 = Saw Timber Medium		
E = Swamp Hdwoods	M = Mpl, Bch, Brch	R = Red Pine	X = Non Stocked	4 = Pole Timber Poor	9 = Saw Timber Well		
F = Spruce Fir	MC = Mixed Conifer	S = Black Spruce	Z = Water				
G = Grass	MD = Mixed Deciduous	T = Tamarack					

PU	Acres
1	15.2
2	14.4

Two Moves Mix

Compartment 064

29.6 Acres

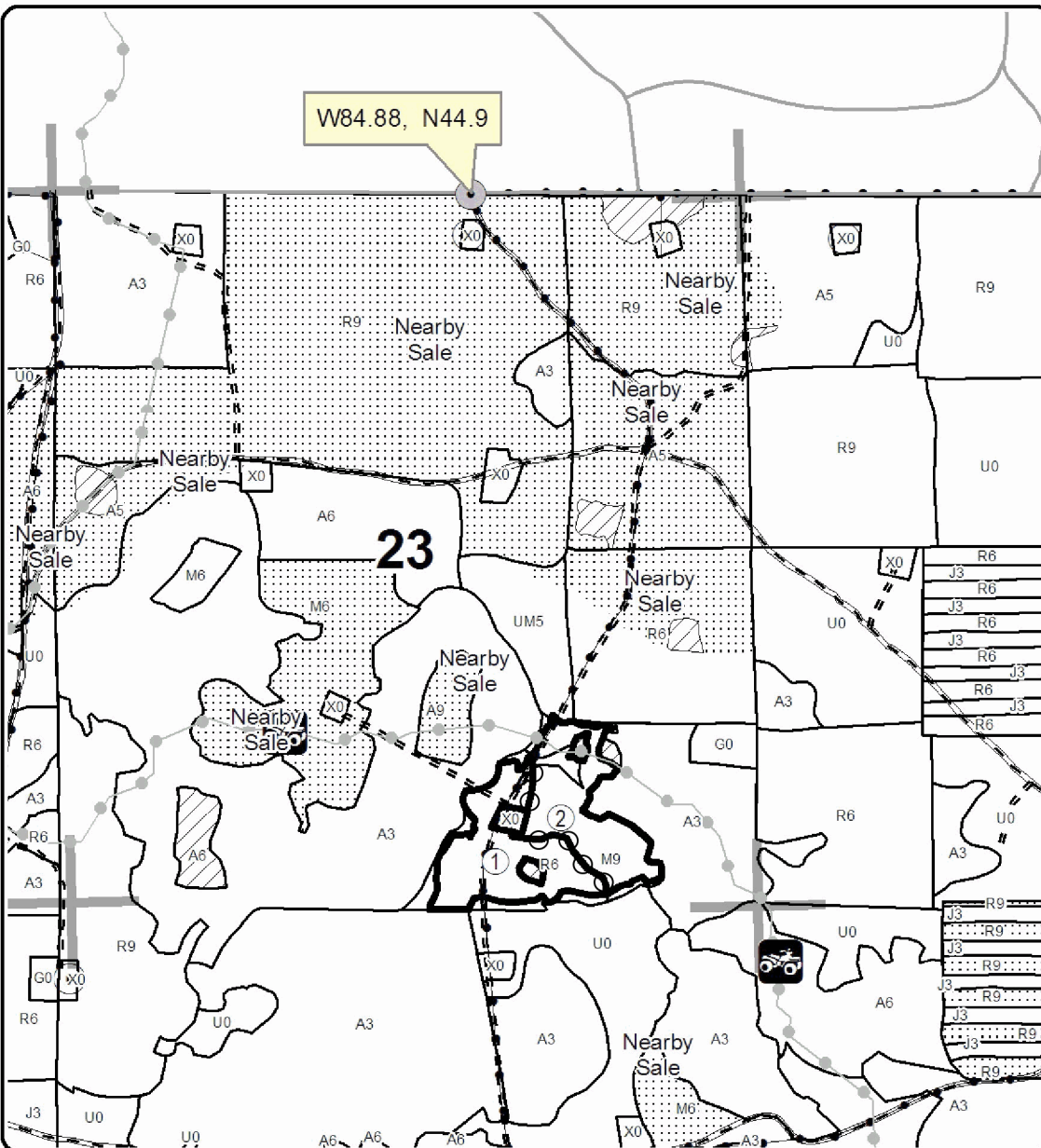
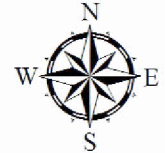

Legend

- Against State (Red)
- Payment Unit (Yellow)
- Retention Area (Teal)
- Stand Boundaries
- Section Corners
- Paved Roads
- Gravel Roads
- Poor Dirt Roads
- Pipeline; Powerline
- Recreational Trail
- Oil & Gas Well
- Surface Locations

Locator Map
1:200,000

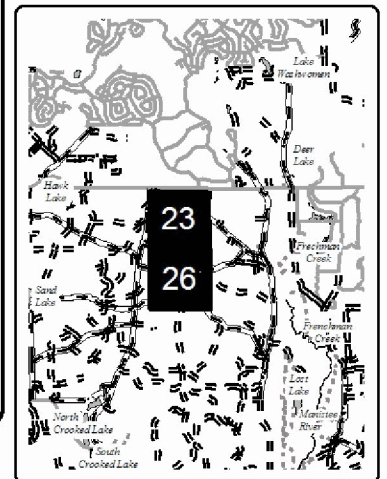

TIMBER SALE INFORMATION

Little Crapo Lake Jack Pine (52-021-17)

Otsego County (Advertised Price \$18,580.85)

SALE NOTE: Predominantly jack pine with some red pine, aspen, and oak. Mostly flat topography. Snowmobile trail and ORV trail within the vicinity.

Oak wilt restrictions are in place for 150 feet of the western boundaries of Payment Units 1 and 3. In addition, great care must be taken to avoid damage to undesignated oak trees along sale boundaries, retention islands, skid trails, and haul routes during April 15th through July 15th.

Private property access through Consumer's Energy property would be the easiest way to access Payment Unit 1. The Purchaser must obtain permission, or additional access through State land can also be arranged.

A recreation site such as a trail, pathway, or campground is within the sale area or the vicinity. Certain restrictions/specifications may be applicable including time restrictions. Access may be through private land.

A timber sale contract for this lump sum, sealed bid timber sale will be awarded to the responsible bidder offering the highest sealed bid price. Bids must be at or above the following advertised price for each species:

<u>PRODUCTS & SPECIES</u>	<u>ESTIMATED UNITS*</u>	<u>ADVERTISED PRICE</u>
Sawtimber		
BI/R/Hybrid Oak	3.50 MBF	\$ 114.00 / MBF
Jack Pine	38.40 MBF	\$ 48.00 / MBF
Mixed Aspen	0.40 MBF	\$ 48.00 / MBF
Red Pine	20.60 MBF	\$ 113.00 / MBF
White Oak	0.60 MBF	\$ 113.00 / MBF
Pulpwood		
BI/R/Hybrid Oak	10.00 Cords	\$ 24.10 / Cord
Jack Pine	448.00 Cords	\$ 24.25 / Cord
Mixed Aspen	17.00 Cords	\$ 17.25 / Cord
Red Maple	2.00 Cords	\$ 19.70 / Cord
Red Pine	53.00 Cords	\$ 46.00 / Cord
White Oak	2.00 Cords	\$ 24.10 / Cord

* The total volume is statistically estimated within plus (+) or minus (-) 17.74 percent. The estimated units are final and not subject to adjustment. Prospective bidders are urged to examine this timber and to make their own estimates of quantity and quality.

BOND AND PAYMENT SCHEDULE:

1. A bond in the amount of \$1,858.00 to insure faithful performance of the conditions of the contract will be deposited by the successful bidder within 21 days of the sale award.
2. Cutting in any sale or unit without the required advance payment would be considered a trespass.
3. Total payment must be paid in advance or according to the following schedule:
 - (a) Ten percent (10%) of the sale value must be paid within 21 days of the sale award.
 - (b) The 10% down payment will be credited towards the first unit cut.
4. If no cutting takes place, the 10% down payment will not be refunded.
5. Operations on the contract issued will terminate on 12/31/2020.

Description of Timber by Payment Unit (PU)

PU	MARKET GROUP	PRODUCT	QUANTITY	UNIT	ACRES	ADVERTISE PRICE
1	BI/R/Hybrid Oak	Sawtimber	1.0	MBF	9.4	\$3,889.70
	Jack Pine		3.7	MBF		
	Red Pine		9.3	MBF		
	White Oak		0.6	MBF		
	BI/R/Hybrid Oak		Pulpwood	3.0		
	<i>BI/R/Hybrid Oak</i>	3.0		<i>Cords</i>		
	Jack Pine	57.0		Cords		
	Mixed Aspen	1.0		Cords		
	<i>Quaking Aspen</i>	1.0		<i>Cords</i>		
	Red Maple	2.0		Cords		
	Red Pine	20.0		Cords		
	White Oak	2.0		Cords		
	2	BI/R/Hybrid Oak	Sawtimber	1.5		
Jack Pine		20.4		MBF		
Mixed Aspen		0.2		MBF		
<i>Quaking Aspen</i>		0.2		<i>MBF</i>		
Red Pine		6.6		MBF		
BI/R/Hybrid Oak		Pulpwood	4.0	Cords		
<i>BI/R/Hybrid Oak</i>			4.0	<i>Cords</i>		
Jack Pine			230.0	Cords		
Mixed Aspen			9.0	Cords		
<i>Quaking Aspen</i>			9.0	<i>Cords</i>		
Red Pine			19.0	Cords		
3	BI/R/Hybrid Oak	Sawtimber	1.0	MBF	18.4	\$6,082.40
	Jack Pine		14.3	MBF		
	Mixed Aspen		0.2	MBF		
	<i>Quaking Aspen</i>		0.2	<i>MBF</i>		
	Red Pine		4.7	MBF		
	BI/R/Hybrid Oak	Pulpwood	3.0	Cords		
	<i>BI/R/Hybrid Oak</i>		3.0	<i>Cords</i>		
	Jack Pine		161.0	Cords		
	Mixed Aspen		7.0	Cords		
	<i>Quaking Aspen</i>		7.0	<i>Cords</i>		
Red Pine	14.0	Cords				
TOTAL:			63.5	MBF		
TOTAL:			532.0	Cords		

Sale Specific Conditions & Requirements

Sale Name: Little Crapo Lake Jack Pine

Sale Number: 52-021-17 Seq#: 1

1 - Sale Area

1.2 - Boundaries

1.2.1 - Painted boundaries (1/14)

The sale boundary and Payment Unit boundaries are marked and identified by blue, red and yellow paint. Exterior sale boundary lines against private property are marked with blue paint. Exterior sale boundary lines against state are marked with red paint. Interior Payment Unit boundaries are marked with yellow paint. The blue and red painted boundary line trees are not Included Timber and are to be protected. Yellow painted trees designating an interior Payment Unit boundary are only to be cut when all surrounding Payment Units have been paid.

2 - Timber Specifications

2.1 - Included Timber

2.1.1 - Clearcut unit(s) with unmerchantable trees (6/14)

Within Payment Unit(s) 1, 2, & 3, cut all trees that are two (2) inches or more at DBH, except DO NOT CUT any legacy red pine marked with pink paint, or any other red pine or white pine 26" DBH or larger. Special protection trees identified in accordance with condition 3.4.2, within clearcutting unit boundaries, are not Included Timber and are to be protected.

2.1.15 - Hazard trees near roads (7/13)

Cut and remove all standing dead trees within 50 feet of the cleared portion of Little Crapo Lake Road. These trees may be utilized or must be scattered back into the sale area.

2.2 - Utilization

2.2.11 - Chipping restriction (9/14)

If chipping occurs on this sale, then no woody debris present on the ground at the start of the sale may be chipped. In addition, brush or chips may not be stored or stockpiled on-site for more than 30 days.

3 - Payments

3.3 - Pre-measured Sales

3.3.4 - Dividing payment units (7/14)

Payment Unit(s) may be divided at the request of the Purchaser and upon approval of the Unit Manager. Dividing Payment Units is a contract modification which requires a Timber Sale Contract Supplement. There will be only one division per Payment Unit.

3.4 - Damaged Timber

3.4.2 - Special Protection Trees (4/14)

The Purchaser shall not cut live or dead special protection trees within cutting units or clearings. Special protection trees are marked with pink paint. If the Purchaser's operations have cut or damaged special protection trees through carelessness, the Purchaser shall pay \$100.00 as fixed, agreed and liquidated damages for each special protection tree cut or damaged. Such payment does not constitute ownership of the undesignated timber.

4 - Transportation

4.1 - Construction

4.1.3 - Slash and earthen piles (8/04)

Piles or windrows of earth along roads and landings that have been widened or constructed shall be leveled. Slash from road maintenance or construction, including stumps, shall be dispersed throughout the sale.

4.1.4 - Timber removed for construction (12/09)

Trees cut or damaged in the process of pre-approved road, landing or skid trail construction will be decked in an area separate from other Designated Timber and not removed until measured by the sale administrator. Payment will be made at the

specified Purchase Unit Price.

4.1.6 - Road construction (1/09)

Construction of new roads or improvements of existing roads shall be done in such a way as to minimize the environmental and visual impacts. Merchantable trees shall be cut and utilized unless otherwise directed. Non-merchantable trees shall be severed and laid flat on the ground. Slash shall be scattered, and not left in windrows and kept a minimum of 10 feet back from the road edge. Stumps shall be set upright, not left on edge, and be moved at least 10 feet away from the road edge. Disturbed soil shall be feathered into the woods and not left in berms or windrows. If road construction damages any oak trees between April 15th and July 15th, the Unit Manager or his/her representative must be notified immediately to determine mitigation steps.

4.1.7 - Road closure (10/11)

All new roads built into the sale must be blocked to vehicle traffic upon completion of the sale. Overgrown roads that are reopened shall be considered new roads. In general, this will require constructing a four (4') foot high berm of stumps and logs covered with earth. Stumps and brush must be placed along the remainder of the trail. These roads must be rendered impassable to cars and trucks. All stumps from road building and landing construction must be reserved to block any newly constructed roads upon completion of the sale. These stumps must be scattered along the road system to prohibit vehicular movement. Contact the sale administrator for specific details of design and placement.

4.2 - Maintenance

4.2.5 - Two wheel drive condition (2/04)

All existing trail roads on and adjacent to the sale area must be passable by two-wheel drive traffic for the duration of the sale.

4.4 - Access

4.4.1 - Private property access (3/11)

Permission for access across private land is the responsibility of the Purchaser. Should the Purchaser desire to cross private land, a copy of the written permission from the private landowner may be required by the DNR. This applies if the Consumer's Power line property is utilized for access to Payment Unit 1. Alternative access through State land can be arranged with permission from the Unit Manager or his/her representative, which may require some road construction or a long skid trail.

5 - Operations

5.1 - Notification

5.1.1 - Pre-sale conference (10/16)

A pre-sale conference on site between the Purchaser and sale administrator is required prior to beginning any operations to determine landing and road locations. The Unit Manager or his/her representative must be contacted at least 5 days in advance to schedule the conference.

5.1.3 - Well heads and natural gas pipelines (11/15)

The Purchaser is responsible for contacting the gas or pipeline company prior to operating equipment in the vicinity of well heads or natural gas pipelines.

5.1.6 - Utility R.O.W. (1/15)

It is the responsibility of the Purchaser to obtain permission from the utility company to utilize the power line R.O.W. for operations. This condition applies for Payment Unit 1 if the Consumer's Energy Power line property is utilized for harvesting operations. There may be some additional trees to harvest on Consumer's Energy property adjacent to the sale. Contact Samuel E. Chansler with Consumer's Energy at 269-207-8797.

5.2 - Conduct of Operations

5.2.1 - Slash

5.2.1.8 - Slash height (12/08)

No slash or tree tops may exceed 24 inches in height.

5.2.1.10 - No slash in openings (5/10)

No brush or logging debris is to be left in the maintained wildlife opening or well pads which are indicated by G0 on the Timber Sale Map. Any damage to the opening shall be repaired according to specifications of the Unit Manager or his/her representative.

5.2.1.13 - Dispose of slash as directed (12/05)

Slash is to be disposed of as directed by the Unit Manager or his/her representative.

5.2.2 - Hazard Trees/Snags

5.2.2.1 - Den trees (10/16)

Obvious hollow and/or den trees shall be protected and left standing unless they are a safety hazard.

5.2.3 - Operating Restrictions

5.2.3.4 - Oak wilt restriction (4/17)

Within Payment Unit(s) 1 and 3, unless changed by written agreement, cutting, skidding, and hauling are not permitted during the period of April 15 to July 15. This only applies to 150 feet of the western boundary of Payment Units 1 and 3. This is necessary to reduce the spread of oak wilt. For more information, contact the Unit Manager or his/her representative.

5.2.29 - Shrub protection (9/07)

Do not cut or damage hawthorn, witch-hazel, dogwood or juneberry. These woody-shrub plants are highly beneficial to various wildlife species.

5.2.32 - Decking/landing restoration (9/13)

All decking and landing areas must have the surface area restored to a condition equal to or better than before. This is to ensure the proper regeneration of the stand. Wood debris, chips and "cookies" from trimmings must be removed or scattered away from landing and loading areas and may not be windrowed on the edge.

5.2.38 - No decking against live trees (2/04)

Cut products may not be decked against unmarked or designated leave trees.

5.2.39 - ORV trail/route protection (12/12)

The Crapo Creek Trail is an ORV trail or route and is shown on the Timber Sale Map. Do not cut or damage posts with orange ORV markers. Trees in the sale area with orange ORV markers shall be cut off above the markers and at least 5 feet above ground. All stumps within 5 feet of the trail must be cut flush with the ground. Maintain a 20 foot wide slash, debris, and rut free zone daily using the ORV trail or route as the centerline. Do not run equipment down the ORV trail or route. Skidding across the trail or route may only occur in locations approved by the sale administrator. Only one or two locations should be necessary.

5.2.41 - Snowmobile trail protection (9/11)

The North Branch Route is a snowmobile trail and is shown on the Timber Sale Map. Do not cut or damage posts with orange trail markers or traffic control signs. If the trail is used, it must be maintained and restored to a condition equal to or better than before the sale. The road maintenance/restoration must be done prior to December 1. If the trail is used for hauling, it must be graded to the satisfaction of the Unit Manager or his/her representative prior to December 1st. The snowmobile trail may not be used for any timber sale operations from December 1 to March 31, without prior approval from the Unit Manager or his/her representative. If the trail is to be used for hauling during the snowmobile season, then a snow covered base must be left on the trail, and the trail must not be blocked by logging trucks at any time. Maintain a 20 foot wide slash, debris, and rut free zone daily using the snowmobile trail as the centerline. All stumps within 20 feet of the snowmobile trail must be cut at ground level. In addition, any trees cut within 5 feet of the trail must have the stumps removed and be disposed of according to the direction of the Unit Manager or his/her representative.

5.4 - Soil Protection

5.4.1 - Rutting restriction, general (7/16)

Operations are to cease immediately if equipment and weather conditions result in rutting of roads and/or skid trails which is 12 inches or greater in depth and 50 feet in length. The Unit Manager or his/her representative may restrict hauling and/or skidding if ruts exceed the specified depth. With the Unit Manager or his/her representative's approval, the Purchaser may return to the area when the risk of rutting has decreased.

5.8 - Protection of Endangered Species

5.8.3 - Red shoulder hawk or goshawk (2/16)

In the event that an active red shoulder hawk or goshawk nest is found, the contract may be amended to protect the nest site until the nest is determined to be inactive. The value of the trees in this excluded area will be refunded or credited to the Purchaser. The nest will be buffered with a five-chain radius (eight acre) protection area, centered on the nest tree, in which there will be no cutting or new roads constructed. Avoid human disturbance, including loading and skidding, in the protection area.

An additional zone of five chains (ten chains centered on the active nest tree) will be established in which there is no management activity from March 15 to July 15. Limit biomass harvesting and chipping operations within this ten-chain zone, retain the maximum one-third of residues per the Woody Biomass Harvesting Guidelines (Michigan DNR 2010). Nests determined to be inactive will be protected with a one-chain no-harvest buffer.

5.8.5 - Protection of raptor nests (3/13)

All trees with raptor nests will be protected if found during harvesting operations. Notification will be made to the Unit Manager or his/her representative who will notify the Wildlife Biologist so an on-site evaluation and recommendation can be made, if necessary.

6 - Safety and Fire Prevention

6.2 - Signing

6.2.1 - Road posting (9/09)

The Purchaser is responsible for posting and maintaining caution signs on Little Crapo Lake Road prior to beginning operations. The road must be posted at appropriate distances from the sale area to warn of logging activity and truck traffic. Signs must be removed when harvest operations are suspended or completed. The Purchaser will provide these signs.

6.2.2 - Snowmobile trail posting (8/09)

The Purchaser is responsible for posting and maintaining caution signs on North Branch Route prior to beginning operations during the snowmobile season (approximately December 1 to March 31). The trail must be posted at appropriate distances from the sale area to warn of logging activity and truck traffic. Signs must be removed when harvest operations are suspended or completed. The Purchaser will provide these signs. This condition applies if harvesting and hauling operations are permitted during snowmobile season in Payment Unit(s) 2 & 3.

6.2.3 - Recreational trail posting (2/10)

The Purchaser is responsible for posting and maintaining caution signs on Crapo Creek Trail prior to beginning operations. The trail must be posted at appropriate distances from the sale area to warn of logging activity and truck traffic at both ends of the trail. Signs must be removed when harvest operations are suspended or completed. The Purchaser will provide these signs.



TIMBER SALE MAP

This information provided by authority of Part 525, 1994 PA 451, as amended.

Sale Number	Year
52-021	17

Forest Management Unit Gaylord (South)	County Otsego	Mapped By Gilner	Date 06/19/2017	Page 1	of 1
Township 29N	Range 01W	Section(s) and Subdivision(s) SE, SW, NE, NW, SE, & SW, Sec 18	Scale 1:7,920		

Cover Type				Density	
A = Aspen	H = Hemlock	N = Marsh	U = Upland Brush	0 = Non Stocked	5 = Pole Timber Medium
B = Paper Birch	J = Jack Pine	O = Oak	UM = Upland Mixed	1 = Seedling Sapling Poor	6 = Pole Timber Well
C = Cedar	L = Lowland Brush	P = Lowland Poplar	V = Bog or Marsh	2 = Seedling Sapling Medium	7 = Saw Timber Poor
D = Treed Bog	LM = Lowland Mixed	Q = Mixed Swamp Conifer	W = White Pine	3 = Seedling Sapling Well	8 = Saw Timber Medium
E = Swamp Hdwoods	M = Mpl, Bch, Brch	R = Red Pine	X = Non Stocked	4 = Pole Timber Poor	9 = Saw Timber Well
F = Spruce Fir	MC = Mixed Conifer	S = Black Spruce	Z = Water		
G = Grass	MD = Mixed Deciduous	T = Tamarack			



Little Crapo Jacko Pine Compartment 004 54.1 Acres

PU	Acres
1	9.4
2	26.3
3	18.4

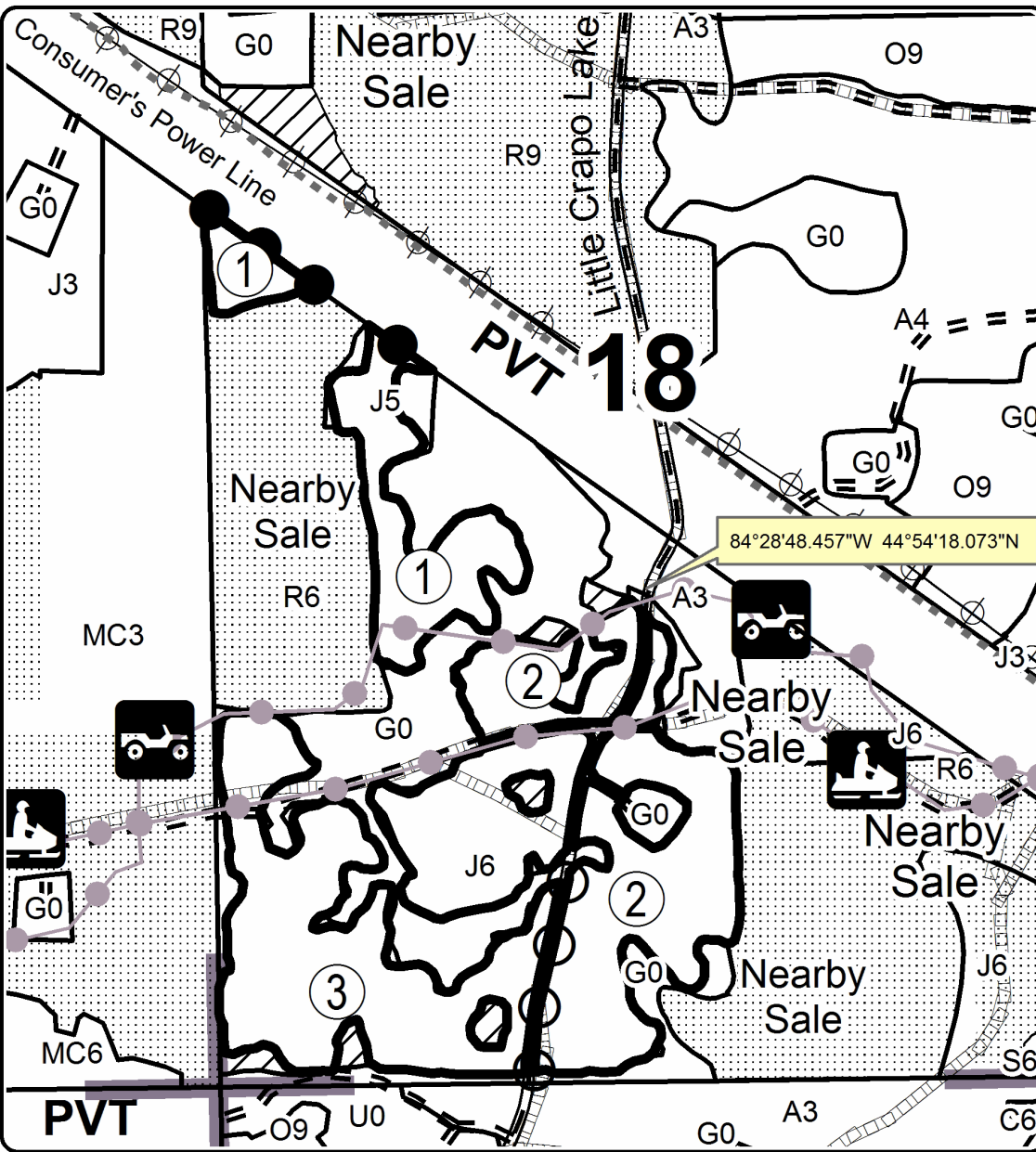

Legend

- Highway
- Paved Roads
- Gravel Roads
- Poor Dirt Roads
- Closed Roads
- Recreational Trail
- Pipeline
- Powerline
- Section Corners
- Retention Area
- Lakes and Rivers
- Stand Boundaries
- Nearby Timber Sale
- PU_Label

Sale Boundary

- Against State (Red)
- Against Private (Blue)
- Payment Unit (Yellow)

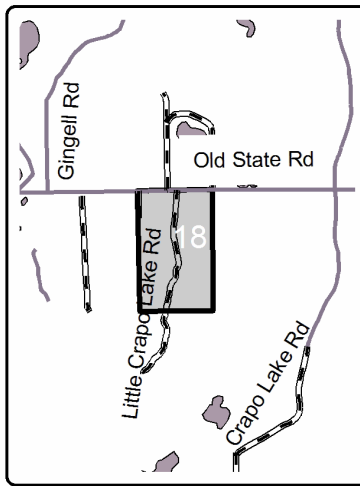

Locator Map 1:100,000

TIMBER SALE INFORMATION

Highline Jack Pine (52-022-17)

Otsego County (Advertised Price \$13,470.55)

SALE NOTE: Predominantly jack pine with some oak, aspen, and red maple. Mostly flat topography. Snowmobile trail and ORV trail within the vicinity.

Payment Units 1 and 3-5 must be chip harvested.

Oak wilt restrictions are in place for Payment Units 1 and 2. In addition, great care must be taken to avoid damage to undesignated oak trees along sale boundaries, retention islands, skid trails, and haul routes during April 15th through July 15th.

A recreation site such as a trail, pathway, or campground is within the sale area or the vicinity. Certain restrictions/specifications may be applicable including time restrictions. Access may be through private land.

A timber sale contract for this lump sum, sealed bid timber sale will be awarded to the responsible bidder offering the highest sealed bid price. Bids must be at or above the following advertised price for each species:

<u>PRODUCTS & SPECIES</u>	<u>ESTIMATED UNITS*</u>	<u>ADVERTISED PRICE</u>
Sawtimber		
B. T. Aspen	0.30 MBF	\$ 48.00 / MBF
BI/R/Hybrid Oak	6.80 MBF	\$ 114.00 / MBF
Jack Pine	30.40 MBF	\$ 48.00 / MBF
Red Maple	2.60 MBF	\$ 146.00 / MBF
Red Pine	7.30 MBF	\$ 113.00 / MBF
Pulpwood		
Balsam Fir	12.00 Cords	\$ 21.50 / Cord
BI/R/Hybrid Oak	37.00 Cords	\$ 24.10 / Cord
Black Spruce	2.00 Cords	\$ 35.20 / Cord
Jack Pine	316.00 Cords	\$ 24.25 / Cord
Mixed Aspen	25.00 Cords	\$ 17.25 / Cord
Red Maple	17.00 Cords	\$ 19.70 / Cord
Red Pine	8.00 Cords	\$ 46.00 / Cord

* The total volume is statistically estimated within plus (+) or minus (-) 15.48 percent. The estimated units are final and not subject to adjustment. Prospective bidders are urged to examine this timber and to make their own estimates of quantity and quality.

BOND AND PAYMENT SCHEDULE:

1. A bond in the amount of \$1,347.00 to insure faithful performance of the conditions of the contract will be deposited by the successful bidder within 21 days of the sale award.
2. Cutting in any sale or unit without the required advance payment would be considered a trespass.
3. Total payment must be paid in advance or according to the following schedule:
 - (a) Ten percent (10%) of the sale value must be paid within 21 days of the sale award.
 - (b) The 10% down payment will be credited towards the first unit cut.
4. If no cutting takes place, the 10% down payment will not be refunded.
5. Operations on the contract issued will terminate on 12/31/2020.

Description of Timber by Payment Unit (PU)

PU	MARKET GROUP	PRODUCT	QUANTITY	UNIT	ACRES	ADVERTISE PRICE
1	Jack Pine	Sawtimber	5.0	MBF	5.8	\$1,370.95
	Jack Pine	Pulpwood	38.0	Cords		
	Mixed Aspen		11.0	Cords		
	<i>Quaking Aspen</i>		11.0	<i>Cords</i>		
	Red Maple		1.0	Cords		
2	B. T. Aspen	Sawtimber	0.3	MBF	7.8	\$1,931.55
	BI/R/Hybrid Oak		5.8	MBF		
	Jack Pine		0.4	MBF		
	Red Maple		1.3	MBF		
	BI/R/Hybrid Oak	Pulpwood	23.0	Cords		
	<i>BI/R/Hybrid Oak</i>		23.0	<i>Cords</i>		
	Jack Pine		13.0	Cords		
	Mixed Aspen		8.0	Cords		
	<i>B. T. Aspen</i>		8.0	<i>Cords</i>		
	Red Maple		2.0	Cords		
3	BI/R/Hybrid Oak	Sawtimber	0.6	MBF	13.0	\$5,208.75
	Jack Pine		8.1	MBF		
	Red Maple		1.3	MBF		
	Red Pine		6.8	MBF		
	Balsam Fir	Pulpwood	3.0	Cords		
	<i>Balsam Fir</i>		3.0	<i>Cords</i>		
	BI/R/Hybrid Oak		9.0	Cords		
	<i>BI/R/Hybrid Oak</i>		9.0	<i>Cords</i>		
	Black Spruce		2.0	Cords		
	Jack Pine		113.0	Cords		
	Mixed Aspen		6.0	Cords		
	<i>Quaking Aspen</i>		6.0	<i>Cords</i>		
	Red Maple		14.0	Cords		
	Red Pine		7.0	Cords		
4	Jack Pine	Sawtimber	11.3	MBF	9.8	\$2,398.20
	Red Pine		0.5	MBF		
	Balsam Fir	Pulpwood	6.0	Cords		
	<i>Balsam Fir</i>	<i>Sawtimber</i>	0.4	<i>MBF</i>		
	<i>Balsam Fir</i>	<i>Pulpwood</i>	5.0	<i>Cords</i>		
	BI/R/Hybrid Oak		3.0	Cords		
	<i>Northern Pin Oak</i>		3.0	<i>Cords</i>		
	Jack Pine		64.0	Cords		
	Red Pine		1.0	Cords		
5	BI/R/Hybrid Oak	Sawtimber	0.4	MBF	12.9	\$2,561.10
	Jack Pine		5.6	MBF		
	Balsam Fir	Pulpwood	3.0	Cords		
	<i>Balsam Fir</i>		3.0	<i>Cords</i>		
	BI/R/Hybrid Oak		2.0	Cords		
	<i>BI/R/Hybrid Oak</i>		2.0	<i>Cords</i>		
Jack Pine		88.0	Cords			
TOTAL:			47.4	MBF		
TOTAL:			417.0	Cords		

Sale Specific Conditions & Requirements

Sale Name: Highline Jack Pine

Sale Number: 52-022-17 Seq#: 1

1 - Sale Area

1.2 - Boundaries

1.2.1 - Painted boundaries (1/14)

The sale boundary and Payment Unit boundaries are marked and identified by blue, red and yellow paint. Exterior sale boundary lines against private property are marked with blue paint. Exterior sale boundary lines against state are marked with red paint. Interior Payment Unit boundaries are marked with yellow paint. The painted boundary line trees are not Included Timber and are to be protected. Yellow painted trees designating an interior Payment Unit boundary are only to be cut when all surrounding Payment Units have been paid.

2 - Timber Specifications

2.1 - Included Timber

2.1.1 - Clearcut unit(s) with unmerchantable trees (6/14)

Within Payment Unit(s) 1, 2, 3, 4, & 5, cut all trees that are two (2) inches or more at DBH, with the following exceptions:

Within Payment Unit 1, do not cut red pine and white oak.

Within Payment Unit 2, do not cut red oak marked with green paint, any red pine, and any white oak.

Within Payment Unit 3, do not cut red pine marked with pink paint.

Within Payment Unit 5, do not cut white oak marked with pink paint.

Special protection trees identified in accordance with condition 3.4.2, within clearcutting unit boundaries, are not Included Timber and are to be protected.

2.1.11 - Description of timber note (2/04)

Note that Mixed Aspen includes both quaking and big-tooth.

2.1.15 - Hazard trees near roads (7/13)

Cut and remove all standing dead trees within 50 feet of the cleared portion of Crapo Lake Road. These trees may be utilized or must be scattered back into the sale area.

2.2 - Utilization

2.2.2 - Chipping required (5/14)

Payment Units 1, 3, 4, & 5 must be chip harvested to facilitate subsequent planting operations. The Purchaser has the option to produce sawlogs or pulpwood bolts, but the remaining portion of the trees must be chipped and hauled. Products may be produced as roundwood and forwarded to decking areas in final product length, but the tops must be left intact and skidded to the landing for chipping in order to minimize the amount of residual slash left. Do not chip 1/6 to 1/3 of the slash from harvested trees (tree tops and limbs less than four inches in diameter). Payment Unit 2 does not require chipping. If whole tree skidding occurs in this unit, great care must be taken to avoid damaging residual timber.

2.2.3 - Stump heights (4/07)

Stump heights within Payment Units 1, 3, 4, & 5 shall not exceed 6 inches for all trees. This is in order to facilitate planting operations.

2.2.4 - Skidding length (2/14)

Skidding of lengths over 17 feet is permissible as long as the timber sale administrator approves the method and machinery used. If at any point damage exceeds specification 3.4.1, all of the remaining wood must be skid in lengths less than 17 feet.

3 - Payments

3.3 - Pre-measured Sales

3.3.4 - Dividing payment units (7/14)

Payment Unit(s) may be divided at the request of the Purchaser and upon approval of the Unit Manager. Dividing Payment

Units is a contract modification which requires a Timber Sale Contract Supplement. There will be only one division per Payment Unit.

3.4 - Damaged Timber

3.4.1 - Damaged timber (6/14)

General Condition and Requirement 3.4 Damaged Timber, defines liquidated damages for undesignated live merchantable trees which are cut or injured.

No damage is acceptable to merchantable trees. Within the sale area, if more than 5% of trees (> 4.5" DBH) within a specified area of the sale are damaged, liquidated damages will be assessed for all trees damaged. Rates will be in accordance with General Condition and Requirement 3.4 Damaged Timber.

3.4.2 - Special Protection Trees (4/14)

The Purchaser shall not cut live or dead special protection trees within cutting units or clearings. Special protection trees are marked with pink paint, and also all red pine and white oak in Payment Unit(s) 1 & 2. If the Purchaser's operations have cut or damaged special protection trees through carelessness, the Purchaser shall pay \$100 as fixed, agreed and liquidated damages for each special protection tree cut or damaged. Such payment does not constitute ownership of the undesignated timber.

4 - Transportation

4.1 - Construction

4.1.3 - Slash and earthen piles (8/04)

Piles or windrows of earth along roads and landings that have been widened or constructed shall be leveled. Slash from road maintenance or construction, including stumps, shall be chipped, utilized or otherwise removed from the sale.

4.1.4 - Timber removed for construction (12/09)

Trees cut or damaged in the process of pre-approved road, landing or skid trail construction will be decked in an area separate from other Designated Timber and not removed until measured by the sale administrator. Payment will be made at the specified Purchase Unit Price.

4.1.6 - Road construction (1/09)

Construction of new roads or improvements of existing roads shall be done in such a way as to minimize the environmental and visual impacts. Merchantable trees shall be cut and utilized unless otherwise directed. Non-merchantable trees shall be severed and laid flat on the ground. Slash shall be scattered, and not left in windrows and kept a minimum of 10 feet back from the road edge. Stumps shall be set upright, not left on edge, and be moved at least 10 feet away from the road edge. Disturbed soil shall be feathered into the woods and not left in berms or windrows.

4.1.7 - Road closure (10/11)

All new roads built into the sale must be blocked to vehicle traffic upon completion of the sale. Overgrown roads that are reopened shall be considered new roads. In general, this will require constructing a four (4') foot high berm of stumps and logs covered with earth. Stumps and brush must be placed along the remainder of the trail. These roads must be rendered impassable to cars and trucks. All stumps from road building and landing construction must be reserved to block any newly constructed roads upon completion of the sale. These stumps must be scattered along the road system to prohibit vehicular movement. Contact the sale administrator for specific details of design and placement.

4.2 - Maintenance

4.2.4 - Grading (10/16)

For completion of the sale, state forest roads must be graded. In general, this will require a road grader or bull dozer to shape up the roads after forest products have been hauled off site. This includes cleaning of drainage areas, grading, crowning and filling with gravel, if necessary. The grading equipment to be used must be approved by the Unit Manager or his/her representative.

4.2.5 - Two wheel drive condition (2/04)

All existing trail roads on and adjacent to the sale area must be passable by two-wheel drive traffic for the duration of the sale.

4.4 - Access

4.4.1 - Private property access (3/11)

Permission for access across private land is the responsibility of the Purchaser. Should the Purchaser desire to cross private land, a copy of the written permission from the private land-owner may be required by the DNR. This applies if the Consumer's Power line property is utilized for access to Payment Units 3 & 4. Alternative access through state land is available to avoid access through private land.

5 - Operations

5.1 - Notification

5.1.1 - Pre-sale conference (10/16)

A pre-sale conference on site between the Purchaser and sale administrator is required prior to beginning any operations to determine landing and road locations. The Unit Manager or his/her representative must be contacted at least 5 days in advance to schedule the conference.

5.1.3 - Well heads and natural gas pipelines (11/15)

The Purchaser is responsible for contacting the gas or pipeline company prior to operating equipment in the vicinity of well heads or natural gas pipelines.

5.1.6 - Utility R.O.W. (1/15)

It is the responsibility of the Purchaser to obtain permission from the utility company to utilize the power line R.O.W. for operations. This condition applies for Payment Unit(s) 3 & 4 if the Consumer's Energy power line property is utilized for harvesting operations. There may also be additional acreage available to harvest on Consumer's Energy property adjacent to the sale. Contact Samuel E. Chansler with Consumer's Energy at 269-207-8797.

5.2 - Conduct of Operations

5.2.1 - Slash

5.2.1.8 - Slash height (12/08)

No slash or tree tops may exceed 24 inches in height.

5.2.1.10 - No slash in openings (5/10)

No brush or logging debris is to be left in the maintained wildlife openings or well pads which are indicated by G0 on the Timber Sale Map. Any damage to the opening shall be repaired according to specifications of the Unit Manager or his/her representative.

5.2.1.13 - Dispose of slash as directed (12/05)

Slash is to be disposed of as directed by the Unit Manager or his/her representative.

5.2.2 - Hazard Trees/Snags

5.2.2.1 - Den trees (10/16)

Obvious hollow and/or den trees shall be protected and left standing unless they are a safety hazard.

5.2.3 - Operating Restrictions

5.2.3.4 - Oak wilt restriction (4/17)

Within Payment Unit(s) 1 and 2, unless changed by written agreement, cutting, skidding, and hauling are not permitted during the period of April 15 to July 15. This is necessary to reduce the spread of oak wilt. For more information, contact the Unit Manager or his/her representative.

5.2.29 - Shrub protection (9/07)

Do not cut or damage hawthorn, witch-hazel, dogwood or junberry. These woody-shrub plants are highly beneficial to various wildlife species.

5.2.32 - Decking/landing restoration (9/13)

All decking and landing areas must have the surface area restored to a condition equal to or better than before. This is to ensure the proper regeneration of the stand. Wood debris, chips and "cookies" from trimmings must be removed or scattered

away from landing and loading areas and may not be windrowed on the edge.

5.2.38 - No decking against live trees (2/04)

Cut products may not be decked against unmarked or designated leave trees.

5.2.39 - ORV trail/route protection (12/12)

The Crapo Creek Trail is an ORV trail or route and is shown on the Timber Sale Map. Do not cut or damage posts with orange ORV markers. Trees in the sale area with orange ORV markers shall be cut off above the markers and at least 5 feet above ground. All stumps within 5 feet of the trail must be cut flush with the ground. Maintain a 20 foot wide slash, debris, and rut free zone daily using the ORV trail or route as the centerline. Do not run equipment down the ORV trail or route. Skidding across the trail or route may only occur in locations approved by the sale administrator. Only two or three locations should be necessary. This condition applies to Payment Unit 3.

5.2.41 - Snowmobile trail protection (9/11)

The North Branch Route is a snowmobile trail and is shown on the Timber Sale Map. Do not cut or damage posts with orange trail markers or traffic control signs. If the trail is used, it must be maintained and restored to a condition equal to or better than before the sale, prior to December 1. If the trail is used for hauling, it must be graded to the satisfaction of the Unit Manager or his/her representative prior to December 1st. The snowmobile trail may not be used for any timber sale operations from December 1 to March 31, without prior approval from the Unit Manager or his/her representative. If the trail is to be used for hauling during the snowmobile season, then a snow covered base must be left on the trail, and the trail must not be blocked by logging trucks at any time. Maintain a 20 foot wide slash, debris, and rut free zone daily using the snowmobile trail as the centerline. All stumps within 20 feet of the snowmobile trail must be cut at ground level. In addition, any trees cut within 5 feet of the trail must have the stumps removed and be disposed of according to the direction of the Unit Manager or his/her representative. This condition applies to Payment Unit(s) 1, 2, & 3.

5.4 - Soil Protection

5.4.1 - Rutting restriction, general (7/16)

Operations are to cease immediately if equipment and weather conditions result in rutting of roads and/or skid trails which is 12 inches or greater in depth and 50 feet in length. The Unit Manager or his/her representative may restrict hauling and/or skidding if ruts exceed the specified depth. With the Unit Manager or his/her representative's approval, the Purchaser may return to the area when the risk of rutting has decreased.

5.4.6 - Wet area protection (5/10)

No harvesting operations, including skidding and felling, are to take place within the vernal pond areas or drainages. When harvesting occurs, there should be no disturbance to the vernal pond depression. All equipment, trees and tops should be kept out of this area. Care must be taken by the Purchaser to identify and avoid operating in these areas of the timber sale. There is a known vernal pond within the retention area of Payment Unit 2.

5.8 - Protection of Endangered Species

5.8.1 - Kirtland's warbler (1) (10/12)

This sale is adjacent to a young jack pine stand which may be used by the endangered Kirtland's Warbler. The Department reserves the right to temporarily restrict all harvesting operations in a buffer zone of up to 500 feet if it is determined that Warbler territory has been established in the adjacent stand. The restricted period, if put into effect, would apply from May 1st to August 15th.

5.8.3 - Red shoulder hawk or goshawk (2/16)

In the event that an active red shoulder hawk or goshawk nest is found, the contract may be amended to protect the nest site until the nest is determined to be inactive. The value of the trees in this excluded area will be refunded or credited to the Purchaser. The nest will be buffered with a five-chain radius (eight acre) protection area, centered on the nest tree, in which there will be no cutting or new roads constructed. Avoid human disturbance, including loading and skidding, in the protection area.

An additional zone of five chains (ten chains centered on the active nest tree) will be established in which there is no management activity from March 15 to July 15. Limit biomass harvesting and chipping operations within this ten-chain zone, retain the maximum one-third of residues per the Woody Biomass Harvesting Guidelines (Michigan DNR 2010). Nests determined to be inactive will be protected with a one-chain no-harvest buffer.

5.8.5 - Protection of raptor nests (3/13)

All trees with raptor nests will be protected if found during harvesting operations. Notification will be made to the Unit Manager or his/her representative who will notify the Wildlife Biologist so an on-site evaluation and recommendation can be made, if necessary.

6 - Safety and Fire Prevention

6.2 - Signing

6.2.1 - Road posting (9/09)

The Purchaser is responsible for posting and maintaining caution signs on Crapo Lake Road and Little Crapo Lake Road prior to beginning operations. The road must be posted at appropriate distances from the sale area to warn of logging activity and truck traffic. Signs must be removed when harvest operations are suspended or completed. The Purchaser will provide these signs.

6.2.2 - Snowmobile trail posting (8/09)

The Purchaser is responsible for posting and maintaining caution signs on North Branch Route prior to beginning operations during the snowmobile season (approximately December 1 to March 31). The trail must be posted at appropriate distances from the sale area to warn of logging activity and truck traffic. Signs must be removed when harvest operations are suspended or completed. The Purchaser will provide these signs. This condition applies if harvesting and hauling operations are permitted during snowmobile season in Payment Unit(s) 1, 2, & 3.

6.2.3 - Recreational trail posting (2/10)

The Purchaser is responsible for posting and maintaining caution signs on Crapo Creek Trail prior to beginning operations. The trail must be posted at appropriate distances from the sale area to warn of logging activity and truck traffic at both ends of the trail. Signs must be removed when harvest operations are suspended or completed. The Purchaser will provide these signs. This condition applies for Payment Unit 3.

7 - Other Conditions

7.2 - Extensions

7.2.4 - Limited extensions (4/17)

Given justification, only one, 1 year extension may be granted if the contract has been paid in full.

8 - Performance and Settlement

8.3 - Uncompleted or Terminated Contracts

8.3.1 - Completion of contract, chipping (1/16)

In addition to cutting, all chipping must be completed by the contract expiration date. If chipping has not been completed, an extension fee or damages may be charged per General Condition & Requirement 7.2 and 8.3.



TIMBER SALE MAP

This information provided by authority of Part 525, 1994 PA 451, as amended.

Sale Number	Year
52-022	17

Forest Management Unit Gaylord (South)	County Otsego	Mapped By Gilner	Date 06/12/2017	Page 1	of 2
Township 29N	Range 01W	Section(s) and Subdivision(s) NWNW, SWNW, SWSW, SESW, SWSE, Sec. 17	Scale 1:15,840		

Cover Type

A = Aspen	H = Hemlock	N = Marsh	U = Upland Brush
B = Paper Birch	J = Jack Pine	O = Oak	UM = Upland Mixed
C = Cedar	L = Lowland Brush	P = Lowland Poplar	V = Bog or Marsh
D = Treed Bog	LM = Lowland Mixed	Q = Mixed Swamp Conifer	W = White Pine
E = Swamp Hdwoods	M = Mpl, Bch, Brch	R = Red Pine	X = Non Stocked
F = Spruce Fir	MC = Mixed Conifer	S = Black Spruce	Z = Water
G = Grass	MD = Mixed Deciduous	T = Tamarack	

Density

0 = Non Stocked	5 = Pole Timber Medium
1 = Seedling Sapling Poor	6 = Pole Timber Well
2 = Seedling Sapling Medium	7 = Saw Timber Poor
3 = Seedling Sapling Well	8 = Saw Timber Medium
4 = Pole Timber Poor	9 = Saw Timber Well

PU Acres

1	5.8
2	7.8
3	13.0
4	9.8
5	12.9

Highline Jack Pine

Compartment 004

49.3 Acres



84°27'49.058"W 44°54'51.41"N

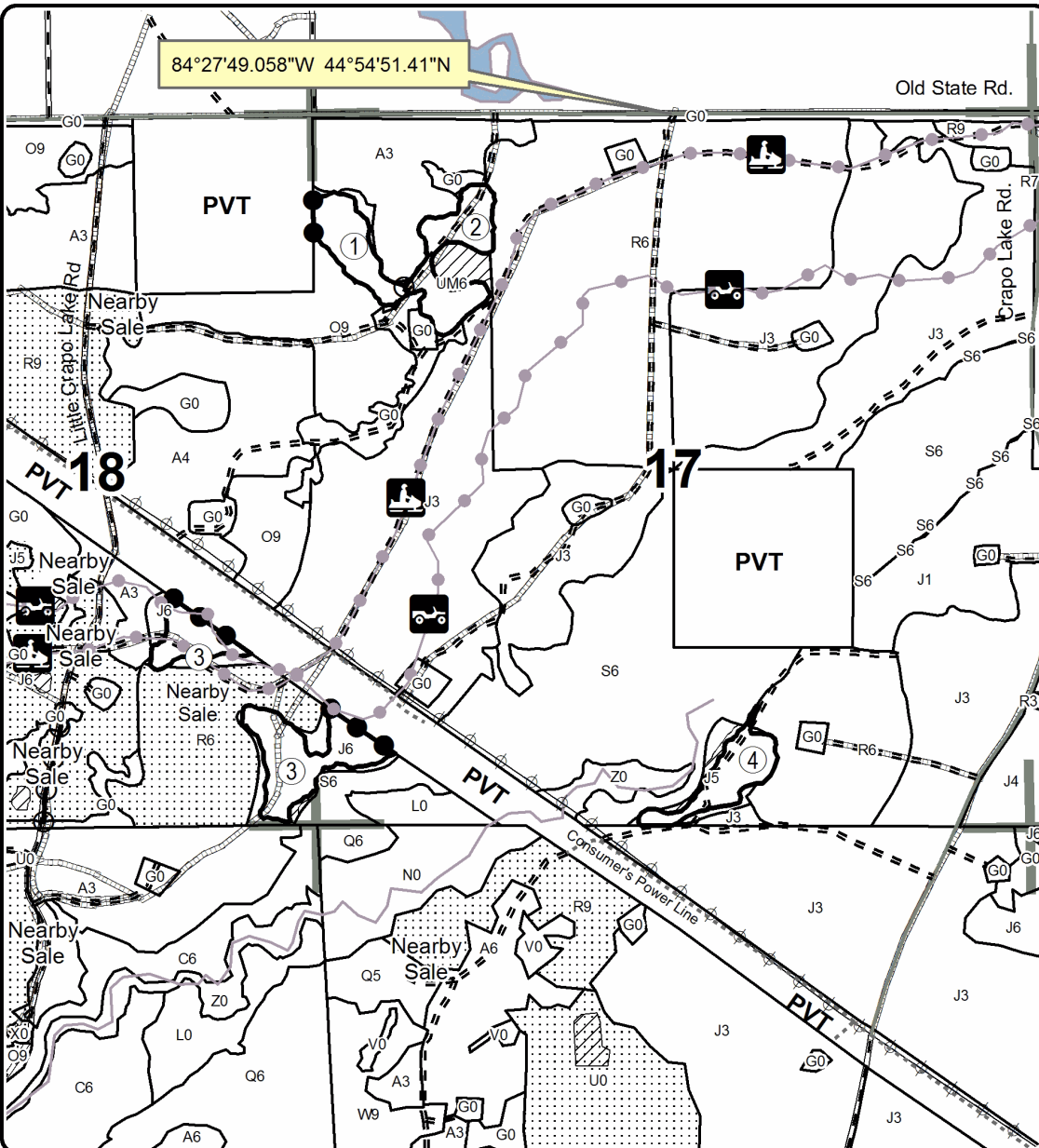

Legend

- Highway
- Paved Roads
- Gravel Roads
- Poor Dirt Roads
- Closed Roads
- Recreational Trail
- Pipeline
- Powerline
- Section Corners
- Retention Area
- Lake and Rivers
- Stand Boundaries
- Nearby Timber Sale
- PU_Label
- Sale Boundary**
- Against State (Red)
- Against Private (Blue)
- Payment Unit (Yellow)

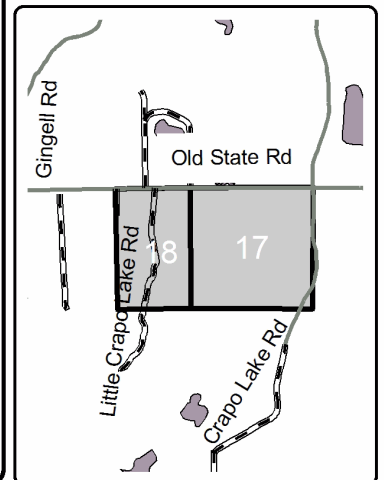

Locator Map 1:100,000



TIMBER SALE MAP

This information provided by authority of Part 525, 1994 PA 451, as amended.

Forest Management Unit Gaylord (South)	County Otsego	Mapped By Gilner	Date 06/12/2017	Page 2	of 2
		Cruised By Gilner			

Township 29N	Range 01W	Section(s) and Subdivision(s) SESW, SWSE Sec. 17, & NWSW, SWSW Sec. 16	Scale 1:15,840
-----------------	--------------	---	-------------------

Cover Type				Density			
A = Aspen	H = Hemlock	N = Marsh	U = Upland Brush	0 = Non Stocked	5 = Pole Timber Medium		
B = Paper Birch	J = Jack Pine	O = Oak	UM = Upland Mixed	1 = Seedling Sapling Poor	6 = Pole Timber Well		
C = Cedar	L = Lowland Brush	P = Lowland Poplar	V = Bog or Marsh	2 = Seedling Sapling Medium	7 = Saw Timber Poor		
D = Treed Bog	LM = Lowland Mixed	Q = Mixed Swamp Conifer	W = White Pine	3 = Seedling Sapling Well	8 = Saw Timber Medium		
E = Swamp Hdwoods	M = Mpl, Bch, Brch	R = Red Pine	X = Non Stocked	4 = Pole Timber Poor	9 = Saw Timber Well		
F = Spruce Fir	MC = Mixed Conifer	S = Black Spruce	Z = Water				
G = Grass	MD = Mixed Deciduous	T = Tamarack					

PU	Acres
1	5.8
2	7.8
3	13.0
4	9.8
5	12.9

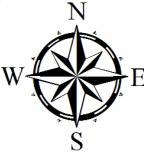

Highline Jack Pine

Compartment 004

49.3 Acres

84°27'49.058"W 44°54'51.41"N

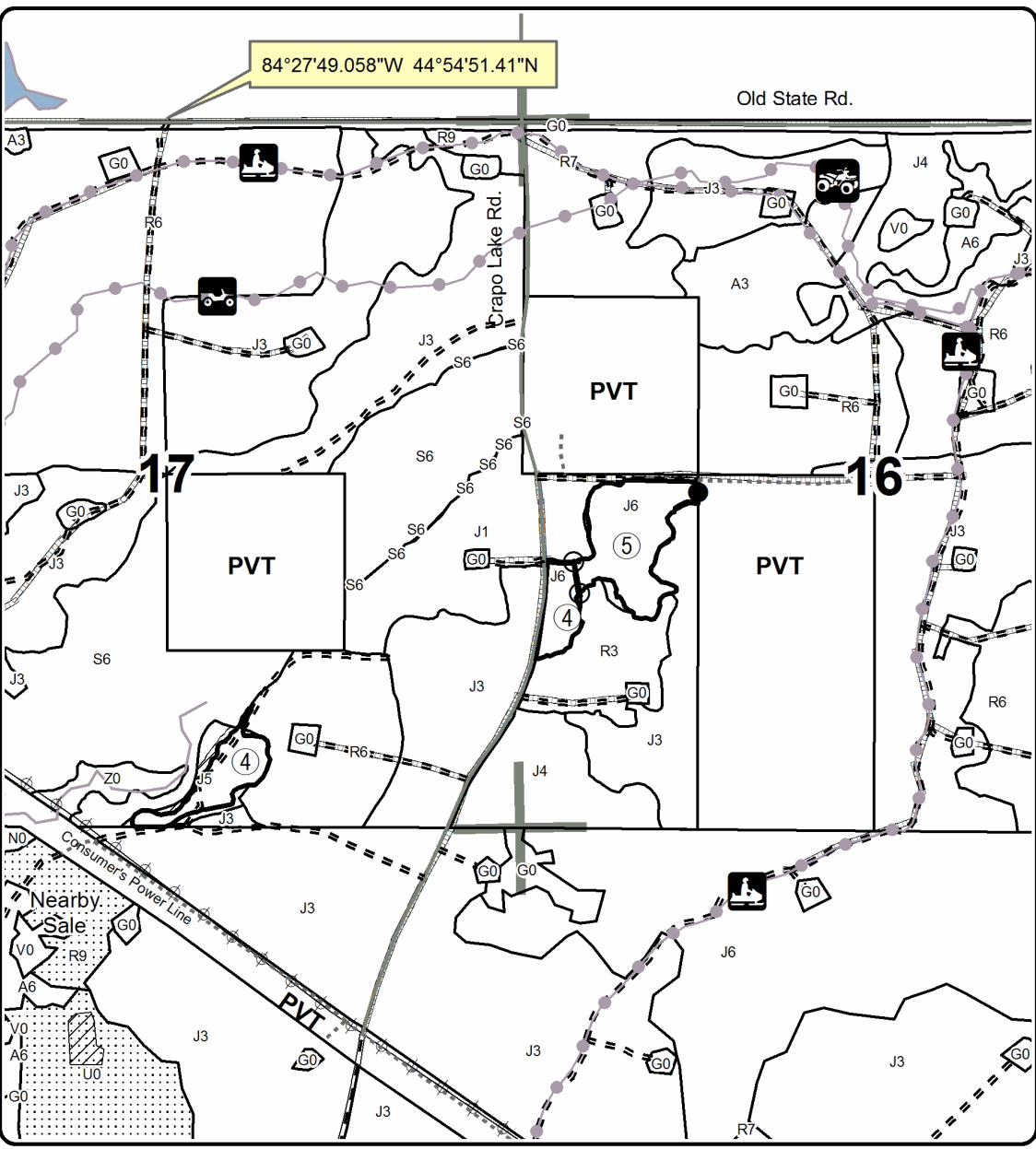

Legend

- Highway
- Paved Roads
- Gravel Roads
- Poor Dirt Roads
- Closed Roads
- Recreational Trail
- Pipeline
- Powerline
- Section Corners
- Retention Area
- Lake and Rivers
- Stand Boundaries
- Nearby Timber Sale
- PU_Label

Sale Boundary

- Against State (Red)
- Against Private (Blue)
- Payment Unit (Yellow)

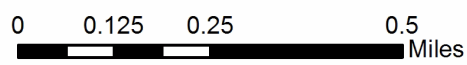
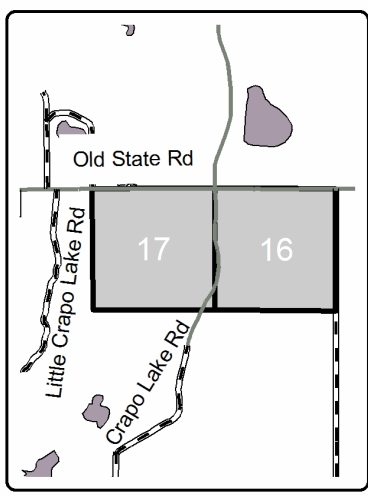

Locator Map 1:100,000

TIMBER SALE INFORMATION

St. Anna's Swamp Mix (52-023-17)

Charlevoix County (Advertised Price \$36,811.75)

SALE NOTE: Payment Unit 1 is an upland unit and Payment Unit 2 is a lowland unit. Payment Unit 2 consists of three small stands, which may only be harvested during frozen winter or dry summer conditions. This treatment is intended to improve wildlife habitat within the lowland cover type.

A timber sale contract for this lump sum, sealed bid timber sale will be awarded to the responsible bidder offering the highest sealed bid price. Bids must be at or above the following advertised price for each species:

<u>PRODUCTS & SPECIES</u>	<u>ESTIMATED UNITS*</u>		<u>ADVERTISED PRICE</u>
Sawtimber			
American Elm	2.20	MBF	\$ 35.00 / MBF
Balsam Fir	1.60	MBF	\$ 39.00 / MBF
Basswood	12.80	MBF	\$ 49.00 / MBF
Mixed Aspen	15.90	MBF	\$ 43.00 / MBF
N. White Cedar	19.70	MBF	\$ 35.00 / MBF
Red Maple	10.00	MBF	\$ 130.00 / MBF
Sugar Maple	71.70	MBF	\$ 240.00 / MBF
White Pine	1.40	MBF	\$ 61.00 / MBF
White Spruce	1.90	MBF	\$ 42.00 / MBF
Yellow Birch	1.40	MBF	\$ 131.00 / MBF
Pulpwood			
Balsam Fir	129.00	Cords	\$ 19.15 / Cord
Basswood	24.00	Cords	\$ 5.65 / Cord
Mixed Aspen	84.00	Cords	\$ 15.35 / Cord
Mixed Hardwood	461.00	Cords	\$ 17.55 / Cord
Mixed Spruce	37.00	Cords	\$ 31.35 / Cord
N. White Cedar	149.00	Cords	\$ 17.50 / Cord
White Pine	2.00	Cords	\$ 31.00 / Cord

* The total volume is statistically estimated within plus (+) or minus (-) 16.17 percent. The estimated units are final and not subject to adjustment. Prospective bidders are urged to examine this timber and to make their own estimates of quantity and quality.

BOND AND PAYMENT SCHEDULE:

1. A bond in the amount of \$1,841.00 to insure faithful performance of the conditions of the contract will be deposited by the successful bidder within 21 days of the sale award.
2. Cutting in any sale or unit without the required advance payment would be considered a trespass.
3. Total payment must be paid in advance or according to the following schedule:
 - (a) Ten percent (10%) of the sale value must be paid within 21 days of the sale award.
 - (b) The 10% down payment will be credited towards the first unit cut.
4. If no cutting takes place, the 10% down payment will not be refunded.
5. Operations on the contract issued will terminate on 12/31/2020.

Description of Timber by Payment Unit (PU)

PU	MARKET GROUP	PRODUCT	QUANTITY	UNIT	ACRES	ADVERTISE PRICE	
1	American Elm	Sawtimber	2.2	MBF	27.3	\$24,141.25	
	Basswood		12.8	MBF			
	Mixed Aspen		6.4	MBF			
	<i>Quaking Aspen</i>		6.4	<i>MBF</i>			
	Sugar Maple		71.7	MBF			
	Basswood		Pulpwood	14.0			Cords
	Mixed Aspen			18.0			Cords
	<i>Quaking Aspen</i>			18.0			<i>Cords</i>
	Mixed Hardwood			319.0			Cords
	<i>American Elm</i>			3.0			<i>Cords</i>
	<i>Beech</i>			9.0			<i>Cords</i>
	<i>Ironwood</i>			11.0			<i>Cords</i>
	<i>Sugar Maple</i>			296.0			<i>Cords</i>
	2		Balsam Fir	Sawtimber			1.6
Mixed Aspen		9.5	MBF				
<i>B. T. Aspen</i>		1.9	<i>MBF</i>				
<i>Balsam Poplar</i>		1.4	<i>MBF</i>				
<i>Quaking Aspen</i>		6.2	<i>MBF</i>				
N. White Cedar		19.7	MBF				
Red Maple		10.0	MBF				
White Pine		1.4	MBF				
White Spruce		1.9	MBF				
Yellow Birch		1.4	MBF				
Balsam Fir		Pulpwood	129.0		Cords		
Basswood			10.0		Cords		
Mixed Aspen			66.0		Cords		
<i>B. T. Aspen</i>			35.0		<i>Cords</i>		
<i>Balsam Poplar</i>			2.0		<i>Cords</i>		
<i>Quaking Aspen</i>			29.0		<i>Cords</i>		
Mixed Hardwood			142.0		Cords		
<i>Black Ash</i>			3.0		<i>Cords</i>		
<i>Red Maple</i>			129.0		<i>Cords</i>		
<i>Yellow Birch</i>			10.0		<i>Cords</i>		
Mixed Spruce			37.0		Cords		
<i>Black Spruce</i>			15.0		<i>Cords</i>		
<i>White Spruce</i>			22.0		<i>Cords</i>		
N. White Cedar			149.0		Cords		
White Pine			2.0		Cords		
TOTAL:			138.6		MBF		
TOTAL:			886.0	Cords			

Sale Specific Conditions & Requirements

Sale Name: St. Anna's Swamp Mix

Sale Number: 52-023-17 Seq#: 1

1 - Sale Area

1.2 - Boundaries

1.2.1 - Painted boundaries (1/14)

The sale boundary and Payment Unit boundaries are marked and identified by red paint. Exterior sale boundary lines against state are marked with red paint. Retention islands are marked with red paint. Within Payment Unit 1, the painted boundary line trees are not Included Timber and are to be protected. Within Payment Unit 2, the boundary line trees are to be left until all merchantable timber has been cut and taken to the landing. At which time, they are to be cut, felled, and left on the ground.

2 - Timber Specifications

2.1 - Included Timber

2.1.2 - Clearcut unit(s) w/o unmerchantable trees (8/11)

Within Payment Unit(s) 1 and 2, cut all trees which meet minimum piece specifications in 2.2 Utilization except hemlock and any trees marked with teal paint. In addition, within Payment Unit 2, trees painted with 'DROP' and all boundary line trees are to be cut and left within the sale as nurse logs. See spec 5.2.4.1 for instructions.

2.2 - Utilization

2.2.10 - No chipping tops and limbs (8/16)

Within Payment Unit(s) 1 and 2, chipping of the bole, 4-inches in diameter or greater, is allowed. Chipping of limbs or portions of the tree less than 4-inches in diameter is not permitted. Limbs and the remaining top must be left on site and scattered.

3 - Payments

3.3 - Pre-measured Sales

3.3.4 - Dividing payment units (7/14)

Payment Unit(s) 1 and 2 may be divided at the request of the Purchaser and upon approval of the Unit Manager. Dividing Payment Units is a contract modification which requires a Timber Sale Contract Supplement.

3.4 - Damaged Timber

3.4.1 - Damaged timber (6/14)

General Condition and Requirement 3.4 Damaged Timber, defines liquidated damages for undesignated live merchantable trees which are cut or injured. In addition, extreme care should be taken to avoid damage to tree seedlings and saplings.

Within the sale area, if more than 30% of the tree seedlings or saplings (1/4" to 4.5" DBH) within a specified portion of the sale area are damaged, liquidated damages will be assessed at \$500 per acre for all acreage within that specified portion of the sale area that was damaged.

No damage is acceptable to merchantable trees. Within the sale area, if more than 5% of trees (>4.5" DBH) within a specified area of the sale are damaged, liquidated damages will be assessed for all trees damaged. Rates will be in accordance with General Condition and Requirement 3.4 Damaged Timber.

4 - Transportation

4.1 - Construction

4.1.3 - Slash and earthen piles (8/04)

Piles or windrows of earth along roads and landings that have been widened or constructed shall be leveled. Slash from road maintenance or construction, including stumps, shall be dispersed throughout the sale.

4.1.6 - Road construction (1/09)

Construction of new roads or improvements of existing roads shall be done in such a way as to minimize the environmental and visual impacts. Merchantable trees shall be cut and utilized unless otherwise directed. Non-merchantable trees shall be severed and laid flat on the ground. Slash shall be scattered, and not left in windrows and kept a minimum of 10 feet back from the road edge. Stumps shall be set upright, not left on edge, and be moved at least 10 feet away from the road edge. Disturbed soil shall be feathered into the woods and not left in berms or windrows.

4.2 - Maintenance

4.2.5 - Two wheel drive condition (2/04)

All existing trail roads on and adjacent to the sale area must be passable by two-wheel drive traffic for the duration of the sale.

5 - Operations

5.2 - Conduct of Operations

5.2.2 - Hazard Trees/Snags

5.2.2.1 - Den trees (10/16)

Obvious hollow and/or den trees shall be protected and left standing unless they are a safety hazard.

5.2.3 - Operating Restrictions

5.2.3.1 - Operating restrictions (9/11)

Within Payment Unit(s) 2, unless changed by written agreement, cutting, skidding, and hauling are limited to snow on and frozen conditions or dry summer conditions. This restriction is because of the wet nature of the soils and to avoid as much rutting as possible.

5.2.4 - Dead and Down Creation

5.2.4.1 - Dead and down creation, marked trees (10/13)

Within Payment Unit 2, all trees marked with "DROP" and all boundary line trees must be left until all merchantable timber has been cut and taken to the landing. At which time, they are to be cut, felled, and left on the ground.

5.2.17 - Crane Mats/Timber Mats (10/14)

Some roads or skid trails may require extra protection such as that afforded by Crane Mats/Timber Mats. If available, Crane Mats/Timber Mats may be borrowed from the DNR and are located at the Marquette ICC and the Grayling Field Office. Contact the sale administrator for specific details. A Timber Sale Contract Supplement will be used to document the Purchaser's use of the DNR's Crane Mats/Timber Mats. It is the responsibility of the Purchaser to contact the sale administrator to schedule pick up and drop off. In addition, all mats must be cleaned prior to drop off. A charge of \$350.00 will be assessed for all damaged or non-returned mats. Damage is defined as misuse resulting in three or more broken cants.

5.2.40 - Pathway protection (10/10)

The Springbrook Pathway and North Country Trail are shown on the Timber Sale Map. Do not cut trees or damage posts with blue pathway markers. Do not run equipment down the pathways. Crossing the trail may only occur in locations approved by the sale administrator.

5.2.41 - Snowmobile trail protection (9/11)

A snowmobile trail is shown on the Timber Sale Map. Do not cut or damage posts with orange trail markers or traffic control signs. If the trail is used, it must be maintained and restored to a condition equal to or better than before the sale. The road maintenance/restoration must be done prior to December 1. The snowmobile trail may not be used for any timber sale operations from December 1 to March 31. No decking of forest products will be permitted along the snowmobile trail. All stumps within 20 feet of the snowmobile trail must be cut at ground level.

5.4 - Soil Protection

5.4.1 - Rutting restriction, general (7/16)

Operations are to cease immediately if equipment and weather conditions result in rutting of roads and/or skid trails which is 12 inches or greater in depth and 50 feet in length. The Unit Manager or his/her representative may restrict hauling and/or skidding if ruts exceed the specified depth. With the Unit Manager or his/her representative's approval, the Purchaser may return to the area when the risk of rutting has decreased.

5.8 - Protection of Endangered Species

5.8.5 - Protection of raptor nests (3/13)

All trees with raptor nests will be protected if found during harvesting operations. Notification will be made to the Unit Manager or his/her representative who will notify the Wildlife Biologist so an on-site evaluation and recommendation can be made, if necessary.

6 - Safety and Fire Prevention

6.2 - Signing

6.2.1 - Road posting (9/09)

The Purchaser is responsible for posting and maintaining caution signs on Chandler Hill Road prior to beginning operations. The road must be posted at appropriate distances from the sale area to warn of logging activity and truck traffic. Signs must be removed when harvest operations are suspended or completed. The Purchaser will provide these signs.

7 - Other Conditions

7.2 - Extensions

7.2.5 - Weather related extension (1/13)

If weather conditions during the operating period of this contract prevent harvesting, this sale may qualify for a weather related extension. If approved, the normal extension fee would be waived. To qualify, there must be a documented attempt each year to harvest in the difficult portion of the sale.



TIMBER SALE MAP

This information provided by authority of Part 525, 1994 PA 451, as amended.

Sale Number	Year
52-023	17

Forest Management Unit Gaylord Management Unit	County Charlevoix	Mapped By Wells	Date 5/25/2017	Page 1	of 1
Cruised By Wells, Kubitskey					

Township 33N	Range 02W	Section(s) and Subdivision(s) Sec. 32 E 1/2 NW, W 1/2 NE, NENE Sec. 33 W 1/2 NW, NWSW	Scale 1:15,840
-----------------	--------------	--	-------------------

Cover Type				Density	
A = Aspen	H = Hemlock	N = Marsh	U = Upland Brush	0 = Non Stocked	5 = Pole Timber Medium
B = Paper Birch	J = Jack Pine	O = Oak	UM = Upland Mixed	1 = Seedling Sapling Poor	6 = Pole Timber Well
C = Cedar	L = Lowland Brush	P = Lowland Poplar	V = Bog or Marsh	2 = Seedling Sapling Medium	7 = Saw Timber Poor
D = Treed Bog	LM = Lowland Mixed	Q = Mixed Swamp Conifer	W = White Pine	3 = Seedling Sapling Well	8 = Saw Timber Medium
E = Swamp Hdwoods	M = Mpl, Bch, Brch	R = Red Pine	X = Non Stocked	4 = Pole Timber Poor	9 = Saw Timber Well
F = Spruce Fir	MC = Mixed Conifer	S = Black Spruce	Z = Water		
G = Grass	MD = Mixed Deciduous	T = Tamarack			

PU	Acres
1	27.3
2	21

St. Anna's Swamp Mix Compartment 41 48.3 Acres

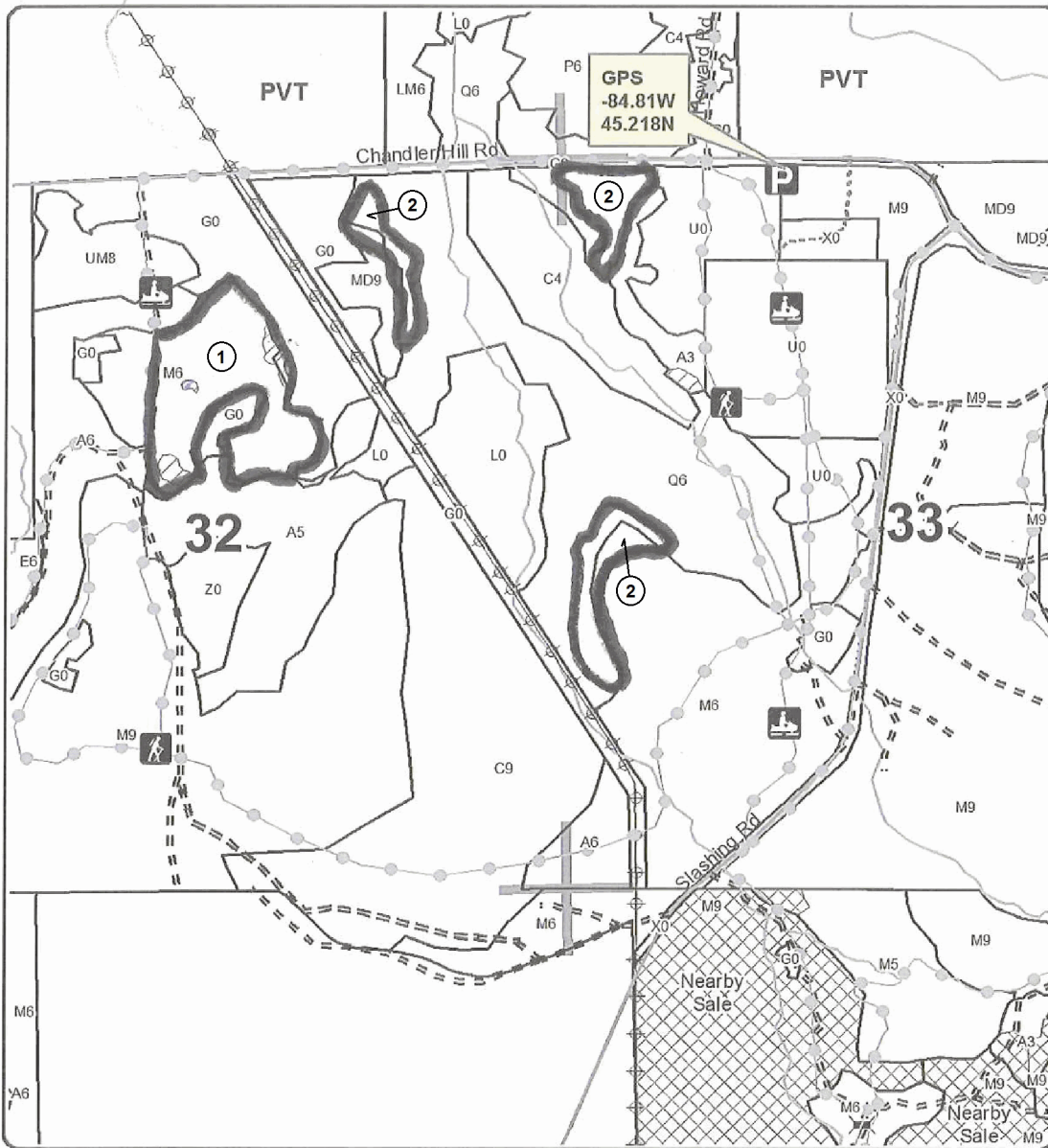

Legend

- Against State (Red)
- 1 PU number
- Stand Boundaries
- Section Corners
- Retention Area (Red)
- Nearby Timber Sale
- Highway
- Paved Roads
- Gravel Roads
- Poor Dirt Roads
- Closed Roads
- Oil & Gas Well
- Surface Locations
- Recreational Trail
- Pipeline
- Powerline
- Streams
- Snowmobile Trail
- Hiking Trail
- P Parking Lot

Locator Map
1:200,000

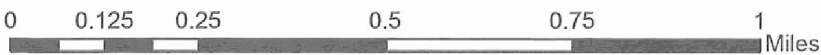
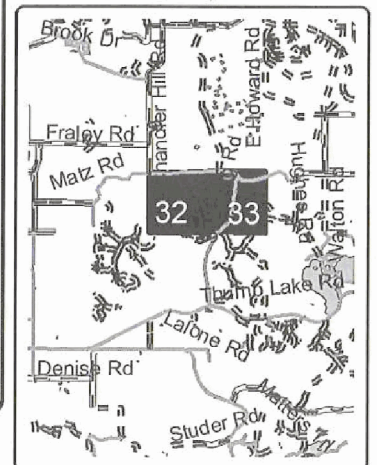

Two Moves Mix (52-011-17)
; Antrim COUNTY

In response to the notice of sale to be held 3:00 p.m. (local time) on October 26, 2017, I am hereby submitting my sealed bid (firm offer) for the following forest products to be cut. Bids for individual species must be at or above the advertised price. All non-responsive bid forms may be rejected.

<u>PRODUCTS & SPECIES</u>	<u>ESTIMATED VOLUME*</u>	<u>ADVERTISED PRICE</u>	<u>BID PRICE/UNIT</u>
Sawtimber			
B. T. Aspen	4.90 MBF	\$ 53.00/MBF	\$ _____
Quaking Aspen	1.90 MBF	\$ 53.00/MBF	\$ _____
Red Maple	36.70 MBF	\$ 160.00/MBF	\$ _____
Red Pine	116.20 MBF	\$ 124.00/MBF	\$ _____
Pulpwood			
Mixed Aspen	24.00 Cords	\$ 18.90/Cord	\$ _____
Mixed Hardwood	318.00 Cords	\$ 21.60/Cord	\$ _____
Red Maple	24.00 Cords	\$ 21.60/Cord	\$ _____
Red Pine	385.00 Cords	\$ 50.40/Cord	\$ _____

*The volumes are statistically estimated within plus (+) or minus (-) 16.07 percent. These estimated volumes are final and not subject to adjustment. Prospective bidders are urged to examine this timber and to make their own estimates of quantity and quality.

I understand that any or all bids may be rejected. All bids must be signed and all bid items must be bid or the bid form may be rejected. I also understand that consideration and awarding a contract will be based upon my past performance and ability to complete the contract based upon equipment and staffing subject to my control.

FEDERAL ID: _____ or SOCIAL SECURITY NUMBER: _____

Company or individual bidding: _____

Company representative's name: _____

Address: _____

City: _____ State: _____ Zip: _____

IF AVAILABLE, PLEASE PLACE THE PERSONALIZED LABEL FROM YOUR PROSPECTUS IN THE ABOVE BOX.

Individual or company representative's signature: _____ Date: _____

Phone number : _____ Email (optional): _____

THE WINNING BIDDER MUST COMPLETE THE VERIFICATION OF WORKER'S DISABILITY COMPENSATION ACT COMPLIANCE (ON REVERSE SIDE IF DOUBLE SIDED) WITHIN 21 DAYS OF SALE AWARD DATE



FOR DEPARTMENT USE ONLY
Sale Number (XX – XXX – XX – XX)
Forest Management Unit:

TIMBER SALE VERIFICATION OF WORKER'S DISABILITY COMPENSATION ACT COMPLIANCE

*As required by Act 317, P.A. 1969 (Worker's Compensation) and
Part 5 of Act 451 of 1994, as amended.*

VERIFICATION OF WORKER'S DISABILITY COMPENSATION ACT COMPLIANCE

- This verification must be completed and submitted within 21 days of contract award and prior to the issuance of the timber sale contract.
- In addition, if boxes 2B or 2C are checked, then Notice of Exclusion or Certificate of Insurance must be submitted within twenty-one (21) days of the contract award and prior to the issuance of the timber sale contract.
- All information must be typed or printed except for written signatures.

Please Check Appropriate Categories:

1. My business is organized as (you **must** check one of the boxes below):
 - A. Sole Proprietorship (individual)
 - B. Partnership
 - C. Corporation
2. You **must** check one of the boxes below:
 - A. I certify my business is a sole proprietorship and it has no employees but the sole proprietor. I am not subject to the Worker's Compensation Laws.
 - B. I certify my business has satisfied its obligation to the Worker's Compensation Act through the use of an approved Notice of Exclusion (BWC-337, Rev. 5/96). I will provide a copy of the Notice of Exclusion within 21 days of the contract award. (For questions or a copy of the BWC-337, please call the Worker's Compensation Bureau at 517-322-1195).
 - C. I certify my business has a Worker's Compensation Policy. I will provide an original Certificate of Insurance within twenty-one (21) days of the contract award.
3. If you have checked item 2(A) or 2(B), you **must** indicate the number of **both** full-time and part-time employees, other than yourself, including family members and active partners (if none, you must enter "0").

_____ Full-time Employees

_____ Part-time Employees

Name of Business		Federal ID (or) Social Security No.	
Address		Telephone ()	
City	State	ZIP	

I hereby certify that the above information is true and correct. I agree to notify the Michigan DNR of any changes that occur in factors affecting my coverage during any of my present and future operations.

Signature of Owner or Authorized Representative

Title

Date

Please complete the "SEALED BID" information on the next page

Little Crapo Lake Jack Pine (52-021-17)
; Otsego COUNTY

In response to the notice of sale to be held 3:00 p.m. (local time) on October 26, 2017, I am hereby submitting my sealed bid (firm offer) for the following forest products to be cut. Bids for individual species must be at or above the advertised price. All non-responsive bid forms may be rejected.

<u>PRODUCTS & SPECIES</u>	<u>ESTIMATED VOLUME*</u>	<u>ADVERTISED PRICE</u>	<u>BID PRICE/UNIT</u>
Sawtimber			
Bl/R/Hybrid Oak	3.50 MBF	\$ 114.00/MBF	\$ _____
Jack Pine	38.40 MBF	\$ 48.00/MBF	\$ _____
Mixed Aspen	0.40 MBF	\$ 48.00/MBF	\$ _____
Red Pine	20.60 MBF	\$ 113.00/MBF	\$ _____
White Oak	0.60 MBF	\$ 113.00/MBF	\$ _____
Pulpwood			
Bl/R/Hybrid Oak	10.00 Cords	\$ 24.10/Cord	\$ _____
Jack Pine	448.00 Cords	\$ 24.25/Cord	\$ _____
Mixed Aspen	17.00 Cords	\$ 17.25/Cord	\$ _____
Red Maple	2.00 Cords	\$ 19.70/Cord	\$ _____
Red Pine	53.00 Cords	\$ 46.00/Cord	\$ _____
White Oak	2.00 Cords	\$ 24.10/Cord	\$ _____

*The volumes are statistically estimated within plus (+) or minus (-) 17.74 percent. These estimated volumes are final and not subject to adjustment. Prospective bidders are urged to examine this timber and to make their own estimates of quantity and quality.

I understand that any or all bids may be rejected. All bids must be signed and all bid items must be bid or the bid form may be rejected. I also understand that consideration and awarding a contract will be based upon my past performance and ability to complete the contract based upon equipment and staffing subject to my control.

FEDERAL ID: _____ or SOCIAL SECURITY NUMBER: _____

Company or individual bidding: _____

Company representative's name: _____

Address: _____

City: _____ State: _____ Zip: _____

IF AVAILABLE, PLEASE PLACE THE PERSONALIZED LABEL FROM YOUR PROSPECTUS IN THE ABOVE BOX.

Individual or company representative's signature: _____ Date: _____

Phone number : _____ Email (optional): _____

THE WINNING BIDDER MUST COMPLETE THE VERIFICATION OF WORKER'S DISABILITY COMPENSATION ACT COMPLIANCE (ON REVERSE SIDE IF DOUBLE SIDED) WITHIN 21 DAYS OF SALE AWARD DATE

Highline Jack Pine (52-022-17)
; Otsego COUNTY

In response to the notice of sale to be held 3:00 p.m. (local time) on October 26, 2017, I am hereby submitting my sealed bid (firm offer) for the following forest products to be cut. Bids for individual species must be at or above the advertised price. All non-responsive bid forms may be rejected.

<u>PRODUCTS & SPECIES</u>	<u>ESTIMATED VOLUME*</u>	<u>ADVERTISED PRICE</u>	<u>BID PRICE/UNIT</u>
Sawtimber			
B. T. Aspen	0.30 MBF	\$ 48.00/MBF	\$ _____
Bl/R/Hybrid Oak	6.80 MBF	\$ 114.00/MBF	\$ _____
Jack Pine	30.40 MBF	\$ 48.00/MBF	\$ _____
Red Maple	2.60 MBF	\$ 146.00/MBF	\$ _____
Red Pine	7.30 MBF	\$ 113.00/MBF	\$ _____
Pulpwood			
Balsam Fir	12.00 Cords	\$ 21.50/Cord	\$ _____
Bl/R/Hybrid Oak	37.00 Cords	\$ 24.10/Cord	\$ _____
Black Spruce	2.00 Cords	\$ 35.20/Cord	\$ _____
Jack Pine	316.00 Cords	\$ 24.25/Cord	\$ _____
Mixed Aspen	25.00 Cords	\$ 17.25/Cord	\$ _____
Red Maple	17.00 Cords	\$ 19.70/Cord	\$ _____
Red Pine	8.00 Cords	\$ 46.00/Cord	\$ _____

*The volumes are statistically estimated within plus (+) or minus (-) 15.48 percent. These estimated volumes are final and not subject to adjustment. Prospective bidders are urged to examine this timber and to make their own estimates of quantity and quality.

I understand that any or all bids may be rejected. All bids must be signed and all bid items must be bid or the bid form may be rejected. I also understand that consideration and awarding a contract will be based upon my past performance and ability to complete the contract based upon equipment and staffing subject to my control.

FEDERAL ID: ____ - ____ - ____ or SOCIAL SECURITY NUMBER: ____ - ____ - ____

Company or individual bidding: _____

Company representative's name: _____

Address: _____

City: _____ State: _____ Zip: _____

IF AVAILABLE, PLEASE PLACE THE PERSONALIZED LABEL FROM YOUR PROSPECTUS IN THE ABOVE BOX.

Individual or company representative's signature: _____ Date: _____

Phone number : _____ Email (optional): _____

THE WINNING BIDDER MUST COMPLETE THE VERIFICATION OF WORKER'S DISABILITY COMPENSATION ACT COMPLIANCE (ON REVERSE SIDE IF DOUBLE SIDED) WITHIN 21 DAYS OF SALE AWARD DATE



FOR DEPARTMENT USE ONLY
Sale Number (XX - XXX - XX - XX)
Forest Management Unit:

TIMBER SALE VERIFICATION OF WORKER'S DISABILITY COMPENSATION ACT COMPLIANCE

*As required by Act 317, P.A. 1969 (Worker's Compensation) and
Part 5 of Act 451 of 1994, as amended.*

VERIFICATION OF WORKER'S DISABILITY COMPENSATION ACT COMPLIANCE

- This verification must be completed and submitted within 21 days of contract award and prior to the issuance of the timber sale contract.
- In addition, if boxes 2B or 2C are checked, then Notice of Exclusion or Certificate of Insurance must be submitted within twenty-one (21) days of the contract award and prior to the issuance of the timber sale contract.
- All information must be typed or printed except for written signatures.

Please Check Appropriate Categories:

1. My business is organized as (you **must** check one of the boxes below):
 - A. Sole Proprietorship (individual)
 - B. Partnership
 - C. Corporation

2. You **must** check one of the boxes below:
 - A. I certify my business is a sole proprietorship and it has no employees but the sole proprietor. I am not subject to the Worker's Compensation Laws.
 - B. I certify my business has satisfied its obligation to the Worker's Compensation Act through the use of an approved Notice of Exclusion (BWC-337, Rev. 5/96). I will provide a copy of the Notice of Exclusion within 21 days of the contract award. (For questions or a copy of the BWC-337, please call the Worker's Compensation Bureau at 517-322-1195).
 - C. I certify my business has a Worker's Compensation Policy. I will provide an original Certificate of Insurance within twenty-one (21) days of the contract award.

3. If you have checked item 2(A) or 2(B), you **must** indicate the number of **both** full-time and part-time employees, other than yourself, including family members and active partners (if none, you must enter "0").

_____ Full-time Employees

_____ Part-time Employees

Name of Business		Federal ID (or) Social Security No.	
Address		Telephone ()	
City	State	ZIP	

I hereby certify that the above information is true and correct. I agree to notify the Michigan DNR of any changes that occur in factors affecting my coverage during any of my present and future operations.

Signature of Owner or Authorized Representative

Title

Date

Please complete the "SEALED BID" information on the next page

St. Anna's Swamp Mix (52-023-17)
; Charlevoix COUNTY

In response to the notice of sale to be held 3:00 p.m. (local time) on October 26, 2017, I am hereby submitting my sealed bid (firm offer) for the following forest products to be cut. Bids for individual species must be at or above the advertised price. All non-responsive bid forms may be rejected.

<u>PRODUCTS & SPECIES</u>	<u>ESTIMATED VOLUME*</u>	<u>ADVERTISED PRICE</u>	<u>BID PRICE/UNIT</u>
Sawtimber			
American Elm	2.20 MBF	\$ 35.00/MBF	\$ _____
Balsam Fir	1.60 MBF	\$ 39.00/MBF	\$ _____
Basswood	12.80 MBF	\$ 49.00/MBF	\$ _____
Mixed Aspen	15.90 MBF	\$ 43.00/MBF	\$ _____
N. White Cedar	19.70 MBF	\$ 35.00/MBF	\$ _____
Red Maple	10.00 MBF	\$ 130.00/MBF	\$ _____
Sugar Maple	71.70 MBF	\$ 240.00/MBF	\$ _____
White Pine	1.40 MBF	\$ 61.00/MBF	\$ _____
White Spruce	1.90 MBF	\$ 42.00/MBF	\$ _____
Yellow Birch	1.40 MBF	\$ 131.00/MBF	\$ _____
Pulpwood			
Balsam Fir	129.00 Cords	\$ 19.15/Cord	\$ _____
Basswood	24.00 Cords	\$ 5.65/Cord	\$ _____
Mixed Aspen	84.00 Cords	\$ 15.35/Cord	\$ _____
Mixed Hardwood	461.00 Cords	\$ 17.55/Cord	\$ _____
Mixed Spruce	37.00 Cords	\$ 31.35/Cord	\$ _____
N. White Cedar	149.00 Cords	\$ 17.50/Cord	\$ _____
White Pine	2.00 Cords	\$ 31.00/Cord	\$ _____

*The volumes are statistically estimated within plus (+) or minus (-) 16.17 percent. These estimated volumes are final and not subject to adjustment. Prospective bidders are urged to examine this timber and to make their own estimates of quantity and quality.

I understand that any or all bids may be rejected. All bids must be signed and all bid items must be bid or the bid form may be rejected. I also understand that consideration and awarding a contract will be based upon my past performance and ability to complete the contract based upon equipment and staffing subject to my control.

FEDERAL ID: _____ or SOCIAL SECURITY NUMBER: _____

Company or individual bidding: _____

Company representative's name: _____

Address: _____

City: _____ State: _____ Zip: _____

IF AVAILABLE, PLEASE PLACE THE PERSONALIZED LABEL FROM YOUR PROSPECTUS IN THE ABOVE BOX.

Individual or company representative's signature: _____ Date: _____

Phone number : _____ Email (optional): _____

THE WINNING BIDDER MUST COMPLETE THE VERIFICATION OF WORKER'S DISABILITY COMPENSATION ACT COMPLIANCE (ON REVERSE SIDE IF DOUBLE SIDED) WITHIN 21 DAYS OF SALE AWARD DATE



FOR DEPARTMENT USE ONLY
Sale Number (XX - XXX - XX - XX)
Forest Management Unit:

TIMBER SALE VERIFICATION OF WORKER'S DISABILITY COMPENSATION ACT COMPLIANCE

*As required by Act 317, P.A. 1969 (Worker's Compensation) and
Part 5 of Act 451 of 1994, as amended.*

VERIFICATION OF WORKER'S DISABILITY COMPENSATION ACT COMPLIANCE

- This verification must be completed and submitted within 21 days of contract award and prior to the issuance of the timber sale contract.
- In addition, if boxes 2B or 2C are checked, then Notice of Exclusion or Certificate of Insurance must be submitted within twenty-one (21) days of the contract award and prior to the issuance of the timber sale contract.
- All information must be typed or printed except for written signatures.

Please Check Appropriate Categories:

1. My business is organized as (you **must** check one of the boxes below):
 - A. Sole Proprietorship (individual)
 - B. Partnership
 - C. Corporation
2. You **must** check one of the boxes below:
 - A. I certify my business is a sole proprietorship and it has no employees but the sole proprietor. I am not subject to the Worker's Compensation Laws.
 - B. I certify my business has satisfied its obligation to the Worker's Compensation Act through the use of an approved Notice of Exclusion (BWC-337, Rev. 5/96). I will provide a copy of the Notice of Exclusion within 21 days of the contract award. (For questions or a copy of the BWC-337, please call the Worker's Compensation Bureau at 517-322-1195).
 - C. I certify my business has a Worker's Compensation Policy. I will provide an original Certificate of Insurance within twenty-one (21) days of the contract award.
3. If you have checked item 2(A) or 2(B), you **must** indicate the number of **both** full-time and part-time employees, other than yourself, including family members and active partners (if none, you must enter "0").

_____ Full-time Employees _____ Part-time Employees

Name of Business		Federal ID (or) Social Security No.	
Address		Telephone ()	
City	State	ZIP	

I hereby certify that the above information is true and correct. I agree to notify the Michigan DNR of any changes that occur in factors affecting my coverage during any of my present and future operations.

Signature of Owner or Authorized Representative

_____ _____
Title Date

Please complete the "SEALED BID" information on the next page