



**DEPARTMENT OF NATURAL RESOURCES
STATE OF MICHIGAN**

TIMBER SALE PROSPECTUS #6034

SCHEDULED SALE DATE AND TIME: 4:00 p.m. (local time) on November 20, 2017.

LOCATION: KALKASKA FIELD OFFICE, 2089 N BIRCH ST, KALKASKA, MI 49646.

PROSPECTUS NOTE: The bidder is advised to inspect the sale area and review the location, estimated volumes, operating costs and contract terms of proposed sales. Please be aware that some landowners may request 60 days or more notice for access across their land.

Notice is hereby given that bids will be received by the Unit Manager, TRAVERSE CITY MANAGEMENT UNIT, for certain timber on the following described lands:

Marji Aspen (61-128-17)

Kalkaska County, Advertised Price \$52,483.70, 98.4 Acres, Aspen, Hardwood.

SALE NOTE: Units 2 and 3 have areas of wet ground and will need to be cut in dry or frozen conditions.

Monster Stump Rally (61-135-17)

Kalkaska County, Advertised Price \$83,166.35, 295.1 Acres, Aspen, White Pine.

SALE NOTE: Note that parts of the sale are being converted from aspen to red pine so chipping and low stumps are required. Also note that Payment Units 1 and 4 must be cut during dry or frozen conditions, at the discretion of the Sale Administrator.

A recreation site such as a trail, pathway, or campground is within the sale area or the vicinity. Certain restrictions/specifications may be applicable including time restrictions.

Trees and Trails (61-139-17)

Kalkaska County, Advertised Price \$57,902.00, 103.8 Acres, Hardwood, Red Oak.

SALE NOTE: Please note that there are multiple recreational trails in and near this sale. Operations may be restricted for brief periods for permitted recreational events. The sale, however, does have the possibility for Class A access onto M72.

A recreation site such as a trail, pathway, or campground is within the sale area or the vicinity. Certain restrictions/specifications may be applicable including time restrictions.

Goose Creek Flooding Mix (61-150-17)

Kalkaska County, Advertised Price \$52,572.55, 74.0 Acres, Hardwood, Red Oak.

SALE NOTE: A recreation site such as a trail, pathway, or campground is within the sale area or the vicinity. Certain restrictions/specifications may be applicable including time restrictions.

Flowing Well Mix (61-166-17)

Kalkaska County, Advertised Price \$51,383.80, 135.0 Acres, Aspen, Hardwood.

SALE NOTE: Unit 4 must be chip harvested. Units 5, 6, and 7 must be cut in dry or frozen weather conditions. Crane mats might be needed in various location for skidding across areas of wet ground.

BID INSTRUCTIONS (VER. 09/02/2016):

1. Scheduled Bid Location, Date, and Time (2/11)

Bids must be received by the Unit Manager, KALKASKA OFFICE, 2089 N BIRCH ST, KALKASKA, MI 49646, no later than 4:00 p.m. (local time) on November 20, 2017. For further information concerning this sale, contact David Lemmien at 231-922-5280 extension 6840.

2. Bidder's Qualifications (5/16)

Purchaser shall obtain workers compensation insurance to cover claims under Michigan's Worker's Disability Compensation Act of 1969 or similar employee benefit act of any other state applicable to an employee. If all or part of a timber sale was prepared by a private contractor, the contractor and that contractor's company are not permitted to bid on the timber sale contract. Bids will not be accepted from individuals or companies appearing on the DNR/FRD No-Bid List. This list contains the names of purchasers who previously failed to execute a contract within 21-days or who have a history of poor performance.

3. Preparation of Sealed Bids (5/16)

Bid Forms may be completed online thru Michigan DNR Timber Sale Online Bidding (OLB) at www.michigan.gov/timberbidding or by completing the hardcopy Bid Form found in the Timber Sale Prospectus. Hardcopy Bid Forms shall be manually signed in ink. Registration in OLB is considered your 'signature' for all bids submitted thru that system. Bid prices must be entered for each species and product in the Bid Price column for all material subject to bidding and all fill-in blanks must be completed. If erasures or other changes appear on the hardcopy Bid Form, each erasure or change must be initialed by the person signing the bid.

4. Submission of Sealed Bids (5/16)

Bid forms may be obtained from the Unit Manager or thru OLB. Bids may be submitted hardcopy or thru OLB. All hardcopy bids must be submitted on the bid form and in an envelope clearly identified as described in this section. NOTE: Only one bid form per bid envelope. Sealed bids must be submitted to the Unit office designated in the prospectus and must be submitted at or prior to the time established in the prospectus. The envelope should show on the outside (a) the sale name or number and (b) the date and time of bid opening, as shown in the prospectus. Bids received after the time specified in the sale prospectus are late bids and will be rejected.

It is possible for a bidder to submit multiple bids on a single sale. For example, a bid may be submitted hardcopy and a bid may be submitted thru OLB. Or, two bidders from the same company could both submit bids on the same sale. If this were to happen, the State would accept all bids received and award the contract accordingly. All bidding and contractual requirements would apply to all bids received.

5. Public Opening of Sealed Bids (7/16)

If conditions permit, the sealed bids will be publicly opened and posted at the time and place set in the prospectus.

If a bidder, present at a bid opening, has submitted bids on more than one sale, that bidder may withdraw their unopened bid envelopes or announce the withdrawal of their online bid after being declared the successful bidder on one sale.

6. Award of Contract (1/11)

Award of the contract will be made to the Bidder whose bid, conforming to the prospectus, is most advantageous to the State of Michigan on the basis of total value at rates bid for the estimated quantities. The State reserves the right to reject any bid or waive any minor irregularity in bids received. A written award mailed (or otherwise furnished) to the successful Bidder shall be deemed to result in a binding contract without further action by either party.

7. Down Payment (1/11)

The Bidder to whom award is made must make a down payment within 21 days of the sale award. The amount of the down payment will be calculated as shown in the Bond and Payment Schedule of this prospectus. Only cash may be used to meet this requirement.

8. Performance Security (1/11)

As guarantee of faithful performance, a cash bond, certificate of deposit, surety bond or irrevocable letter of credit (LOC) is required within 21 days of the sale award. The amount of the performance security is shown in the Bond and

Payment Schedule of this prospectus. If an LOC or surety is used, the coverage must extend for at least 6 months beyond the contract expiration.

9. Timber Sale Contract (9/14)

Additional conditions and requirements common to all timber sales are listed on the timber sale contract (R4031) and are available on line at www.michigan.gov/timber. Contact the Unit Manager for additional information or a sample contract. Within 21 days of the date of the award letter, the bidder must sign the contract and provide the required down payment, performance security, and verification of worker's disability compensation. The down payment and performance security shall be in accordance with the provisions of the timber sale contract, in the sums stated in this prospectus. If these actions are not taken, then the Bidder, the Bidder's corporation, and the corporation's principals may not be permitted to bid on State timber sales for a period of 1 year. In addition, the Bidder certifies that if awarded this contract, the Bidder will complete the timber sale contract in accordance with its terms and any modifications thereof including requirements to purchase, cut, and remove the included timber by the expiration date.

10. Disclaimer of Estimates and Bidder's Warranty of Inspection (7/16)

Before submitting this bid, the Bidder is advised and cautioned to inspect the sale area, review the requirements of the sale contract, and take other steps as may be reasonably necessary to ascertain the location, estimated volumes, construction estimates, and operating costs of the proposed sale. Failure to do so will not relieve the Bidder from responsibility for completing the contract.

The Bidder warrants that this bid is submitted solely on the basis of the Bidder's examination and inspection of the quality and quantity of the timber offered for sale and the Bidder's opinion of the value thereof and the costs of recovery. No reliance should be placed on the State of Michigan's estimates of timber quality, quantity or costs of recovery. Bidder further acknowledges that the State of Michigan: (i) expressly disclaims any warranty of fitness of timber for any purpose; (ii) offers this timber as is without any warranty of quality (merchantability) or quantity and (iii) expressly disclaims any warranty as to the quantity or quality of timber sold.

11. Certification and Chain-of-Custody (10/14)

Unless otherwise indicated in the contract under section 7 – Other Conditions of the Sale Specific Conditions & Requirements, the area encompassed by this timber sale is certified to the standards of the Forest Stewardship Council (FSC) - Certificate #SCS-FM/COC-00090N and the Sustainable Forestry Initiative (SFI) - Certificate #NSF-SFIS-5Y031-SF5. Forest products from this sale may be delivered to the mill as "FSC 100% and / or SFI certified" as long as the contractor hauling the forest products is chain-of-custody (COC) certified or covered under a COC certificate from the destination mill. The purchaser is responsible for maintaining COC after leaving the sale area.

12. Good Neighbor Authority (GNA) Requirements (7/16)

If the name of this timber sales contains the acronym GNA, it is authorized by the Good Neighbor Authority (GNA) and covered by various agreements between the U.S. Forest Service and the State. The timber sale occurs on federal land and the following conditions apply:

GNA contracts on US Forest Service land will not be awarded to purchasers on the Federal list of excluded parties. The System for Award Management (SAM) will be checked for active excluded parties prior to award of contract. In addition, the Bidder to whom award is made must complete an Assurance Regarding Felony Conviction or Tax Delinquent Status for Corporate Applicants (AD-3031).

13. Good Neighbor Authority (GNA) Requirements, con't (9/16)

Bidder certifies, by signing this bid form, that to the best of Bidder's knowledge that the following representations are accurate and complete.

- a. That the Bidder and its principals are not presently debarred, suspended, proposed for debarment, declared ineligible, or voluntary excluded from timber sales (covered transactions) by any Federal department or agency.
- b. That the Bidder and its principals have not within a 3-year period preceding this bid been convicted of or had a civil judgment rendered against them for commission of fraud or a criminal offense in connection with obtaining, attempting to obtain, or performing a public (Federal, State, or local) transaction or contract under a public transaction; violation of Federal or State antitrust statutes or commission of embezzlement, theft, forgery, bribery, falsification or destruction of records, making false statements, or receiving stolen property.

c. That the Bidder and its principals are not presently indicted for or otherwise criminally or civilly charged by a governmental entity (Federal, State, or local) with commission of any of the offenses enumerated in paragraph b of this certification.

d. That the Bidder and its principals have not within a 3-year period preceding this bid had one or more public transactions (Federal, State, or local) terminated for breach or default of a timber or forest product contract.

Bidders that cannot certify this requirement, in whole or in part, shall submit an explanation with their bid.

KEITH CREAGH

Director

TIMBER SALE INFORMATION

Marji Aspen (61-128-17)

Kalkaska County (Advertised Price \$52,483.70)

SALE NOTE: Units 2 and 3 have areas of wet ground and will need to be cut in dry or frozen conditions.

A timber sale contract for this lump sum, sealed bid timber sale will be awarded to the responsible bidder offering the highest sealed bid price. Bids must be at or above the following advertised price for each species:

<u>PRODUCTS & SPECIES</u>	<u>ESTIMATED UNITS*</u>	<u>ADVERTISED PRICE</u>
Sawtimber		
Black Cherry	15.20 MBF	\$ 208.00 / MBF
Mixed Aspen	52.10 MBF	\$ 116.00 / MBF
Red Maple	55.20 MBF	\$ 138.00 / MBF
White Pine	1.40 MBF	\$ 71.00 / MBF
Pulpwood		
Balsam Fir	370.00 Cords	\$ 14.70 / Cord
Mixed Aspen	639.00 Cords	\$ 21.00 / Cord
Mixed Hardwood	802.00 Cords	\$ 19.45 / Cord
Paper Birch	20.00 Cords	\$ 19.85 / Cord
Red Oak	4.00 Cords	\$ 13.15 / Cord
White Pine	20.00 Cords	\$ 14.20 / Cord
White Spruce	14.00 Cords	\$ 26.50 / Cord

* The total volume is statistically estimated within plus (+) or minus (-) 12.30 percent. The estimated units are final and not subject to adjustment. Prospective bidders are urged to examine this timber and to make their own estimates of quantity and quality.

BOND AND PAYMENT SCHEDULE:

1. A bond in the amount of \$2,624.00 to insure faithful performance of the conditions of the contract will be deposited by the successful bidder within 21 days of the sale award.
2. Cutting in any sale or unit without the required advance payment would be considered a trespass.
3. Total payment must be paid in advance or according to the following schedule:
 - (a) Ten percent (10%) of the sale value must be paid within 21 days of the sale award.
 - (b) The 10% down payment will be credited towards the first unit cut.
4. If no cutting takes place, the 10% down payment will not be refunded.
5. Operations on the contract issued will terminate on 12/31/2019.

Description of Timber by Payment Unit (PU)

PU	MARKET GROUP	PRODUCT	QUANTITY	UNIT	ACRES	ADVERTISE PRICE	
1	Black Cherry	Sawtimber	2.4	MBF	54.2	\$23,623.45	
	Mixed Aspen		41.0	MBF			
	<i>B. T. Aspen</i>		30.1	<i>MBF</i>			
	<i>Quaking Aspen</i>		10.9	<i>MBF</i>			
	Red Maple		3.8	MBF			
	White Pine		1.4	MBF			
	Balsam Fir		Pulpwood	273.0			Cords
	Mixed Aspen			434.0			Cords
	<i>B. T. Aspen</i>			256.0			<i>Cords</i>
	<i>Quaking Aspen</i>			178.0			<i>Cords</i>
	Mixed Hardwood			200.0			Cords
	<i>Black Cherry</i>			74.0			<i>Cords</i>
	<i>Red Maple</i>			126.0			<i>Cords</i>
	Paper Birch			5.0			Cords
	Red Oak			4.0			Cords
	White Pine			20.0			Cords
	White Spruce		11.0	Cords			
2	Black Cherry	Sawtimber	12.8	MBF	27.1	\$21,849.20	
	Mixed Aspen		9.8	MBF			
	<i>B. T. Aspen</i>		7.2	<i>MBF</i>			
	<i>Quaking Aspen</i>		2.6	<i>MBF</i>			
	Red Maple		44.8	MBF			
	Balsam Fir		Pulpwood	89.0			Cords
	Mixed Aspen			69.0			Cords
	<i>B. T. Aspen</i>			32.0			<i>Cords</i>
	<i>Quaking Aspen</i>			37.0			<i>Cords</i>
	Mixed Hardwood			449.0			Cords
	<i>Black Cherry</i>			95.0			<i>Cords</i>
	<i>Red Maple</i>			354.0			<i>Cords</i>
	Paper Birch			15.0			Cords
	White Spruce			3.0			Cords
3	Mixed Aspen	Sawtimber		1.3	MBF	10.5	\$5,131.75
	<i>Quaking Aspen</i>		1.3	<i>MBF</i>			
	Red Maple		6.6	MBF			
	Balsam Fir		Pulpwood	5.0	Cords		
	Mixed Aspen			119.0	Cords		
	<i>Quaking Aspen</i>			119.0	<i>Cords</i>		
	Mixed Hardwood			77.0	Cords		
	<i>Black Cherry</i>			9.0	<i>Cords</i>		
<i>Red Maple</i>	68.0	<i>Cords</i>					
4	Balsam Fir	Pulpwood	3.0	Cords	6.6	\$1,879.30	
	Mixed Aspen		17.0	Cords			
	<i>Quaking Aspen</i>		17.0	<i>Cords</i>			
	Mixed Hardwood		76.0	Cords			
	<i>Black Cherry</i>		40.0	<i>Cords</i>			
	<i>Red Maple</i>		36.0	<i>Cords</i>			
TOTAL:			123.9	MBF			
TOTAL:			1,869.0	Cords			

Sale Specific Conditions & Requirements

Sale Name: Marji Aspen

Sale Number: 61-128-17 Seq#: 1

1 - Sale Area

1.2 - Boundaries

1.2.1 - Painted boundaries (1/14)

The sale boundary and Payment Unit boundaries are marked and identified by blue, red and yellow paint. Exterior sale boundary lines against private property are marked with blue paint. Exterior sale boundary lines against state are marked with red paint. Interior Payment Unit boundaries are marked with yellow paint. The painted boundary line trees are not Included Timber and are to be protected. Yellow painted trees designating an interior Payment Unit boundary are only to be cut when all surrounding Payment Units have been paid.

2 - Timber Specifications

2.1 - Included Timber

2.1.1 - Clearcut unit(s) with unmerchantable trees (6/14)

Within Payment Unit(s) 1, cut all trees that are two (2) inches or more at DBH except do not cut trees with green paint.

2.1.3 - Cut tree marked unit(s) (12/08)

Within Payment Unit(s) 4, all trees are designated for cutting when marked with orange paint above and below stump height, regardless of merchantability. In addition cut all aspen and balsam fir.

2.1.7 - Leave tree marked unit(s) (6/14)

Within Payment Unit(s) 2 and 3, cut all trees that are two (2) inches or more at DBH except do not cut cedar, hemlock, oak, white pine and trees marked with green paint above and below stump height. Also, do not cut balsam fir less than 4" in diameter.

3 - Payments

3.4 - Damaged Timber

3.4.1 - Damaged timber (6/14)

General Condition and Requirement 3.4 Damaged Timber, defines liquidated damages for undesignated live merchantable trees which are cut or injured.

No damage is acceptable to merchantable trees. Within the sale area, if more than 10% of trees (> 4.5" DBH) within a specified area of the sale are damaged, liquidated damages will be assessed for all trees damaged. Rates will be in accordance with General Condition and Requirement 3.4 Damaged Timber.

4 - Transportation

4.1 - Construction

4.1.6 - Road construction (1/09)

Construction of new roads or improvements of existing roads shall be done in such a way as to minimize the environmental and visual impacts. Merchantable trees shall be cut and utilized unless otherwise directed. Non-merchantable trees shall be severed and laid flat on the ground. Slash shall be scattered, and not left in windrows and kept a minimum of 10 feet back from the road edge. Stumps shall be set upright, not left on edge, and be moved at least 10 feet away from the road edge. Disturbed soil shall be feathered into the woods and not left in berms or windrows.

4.1.7 - Road closure (10/11)

All new roads built into the sale must be blocked to vehicle traffic within 30 days of completion of hauling. Overgrown roads that are reopened shall be considered new roads. In general, this will require constructing a four (4') foot high berm of stumps and logs covered with earth. Stumps and brush must be placed along the remainder of the trail. These roads must be rendered impassable to cars and trucks. Contact the sale administrator for specific details of design and placement.

5 - Operations

5.1 - Notification

5.1.3 - Well heads and natural gas pipelines (11/15)

The Purchaser is responsible for contacting the gas or pipeline company prior to operating equipment in the vicinity of well heads or natural gas pipelines.

5.2 - Conduct of Operations

5.2.1 - Slash

5.2.1.8 - Slash height (12/08)

No slash or tree tops may exceed 36 inches in height.

5.2.2 - Hazard Trees/Snags

5.2.2.1 - Den trees (10/16)

Obvious hollow and/or den trees shall be protected and left standing unless they are a safety hazard.

5.2.3 - Operating Restrictions

5.2.3.1 - Operating restrictions (9/11)

Within Payment Unit(s) 2 and 3, cutting and skidding are limited to the period of dry or frozen conditions. Operations must be pre-approved by the sale administrator. This restriction is because of wet ground conditions.

5.2.3.3 - Bark slippage restriction (3/09)

Within Payment Unit(s) 4, cutting and skidding are not permitted during the period of April 15 to July 15. This restriction is because of bark slippage.

5.2.3.11 - Coppice regeneration protection (4/10)

Any post harvest operations, such as chipping, must be completed before sprouting of regeneration occurs. If it is anticipated that chipping will be delayed, then tops shall be carried to one central location or left unchipped. The Unit Manager or his/her representative may cease such operations if sprouting occurs before the operation is complete.

5.2.4 - Dead and Down Creation

5.2.4.2 - Dead and down creation, hare and grouse (1/14)

To improve habitat for snowshoe hare, grouse, and other species, the Purchaser is to leave one brush pile (about 8' x 8' x 5') on the ground for every two acres. These should be scattered throughout the sale or positioned per the sale administrator's instructions. This requirement only applies to Payment Units 1 and 2.

5.2.32 - Decking/landing restoration (9/13)

All decking and landing areas must have the surface area restored to a condition equal to or better than before. This is to ensure the proper regeneration of the stand.

5.4 - Soil Protection

5.4.1 - Rutting restriction, general (7/16)

Operations are to cease immediately if equipment and weather conditions result in rutting of roads and/or skid trails which is 12 inches or greater in depth and 50 feet in length. The Unit Manager or his/her representative may restrict hauling and/or skidding if ruts exceed the specified depth. With the Unit Manager or his/her representative's approval, the Purchaser may return to the area when the risk of rutting has decreased.

5.4.6 - Wet area protection (5/10)

No harvesting operations, including skidding and felling, are to take place within the vernal ponds areas or drainages. These areas are within Payment Units 2 and 3. When harvesting occurs, there should be no disturbance to the vernal pond depressions. All equipment, trees and tops should be kept out of this area. Within 100 feet of the pond, equipment should only be used when the soil is in a dry or frozen condition. Care must be taken by the Purchaser to identify and avoid operating in these areas of the timber sale. Sale administrator can help identify these area at the time of harvesting.

6 - Safety and Fire Prevention

6.2 - Signing

6.2.1 - Road posting (9/09)

The Purchaser is responsible for posting and maintaining caution signs on Sunset Trail and Kniss Road prior to beginning operations. The road must be posted at appropriate distances from the sale area to warn of logging activity and truck traffic. Signs must be removed when harvest operations are suspended or completed. The Purchaser will provide these signs.



TIMBER SALE MAP

This information provided by authority of Part 525, 1994 PA 451, as amended.

Forest Management Unit Traverse City		County Kalkaska	Mapped By Crigier	Date 09/26/2017	Page 1	of 1
Township 26N	Range 06W	Section(s) and Subdivision(s) 1: W1/2NE, NWSE, SW1/4 2: W1/2SE, SESE	Cruised By Crigier, Peterson, Roell, Standerfer	Scale 1:15,840		

Cover Type				Density	
A = Aspen	H = Hemlock	N = Marsh	U = Upland Brush	0 = Non Stocked	5 = Pole Timber Medium
B = Paper Birch	J = Jack Pine	O = Oak	UM = Upland Mixed	1 = Seedling Sapling Poor	6 = Pole Timber Well
C = Cedar	L = Lowland Brush	P = Lowland Poplar	V = Bog or Marsh	2 = Seedling Sapling Medium	7 = Saw Timber Poor
D = Treed Bog	LM = Lowland Mixed	Q = Mixed Swamp Conifer	W = White Pine	3 = Seedling Sapling Well	8 = Saw Timber Medium
E = Swamp Hdwoods	M = Mpl, Bch, Brch	R = Red Pine	X = Non Stocked	4 = Pole Timber Poor	9 = Saw Timber Well
F = Spruce Fir	MC = Mixed Conifer	S = Black Spruce	Z = Water		
G = Grass	MD = Mixed Deciduous	T = Tamarack			

PU	Acres	PU	Acres
1	54.2	4	6.6
2	27.1		
3	10.5		

Marji Aspen

Compartment 120

98.4 Acres

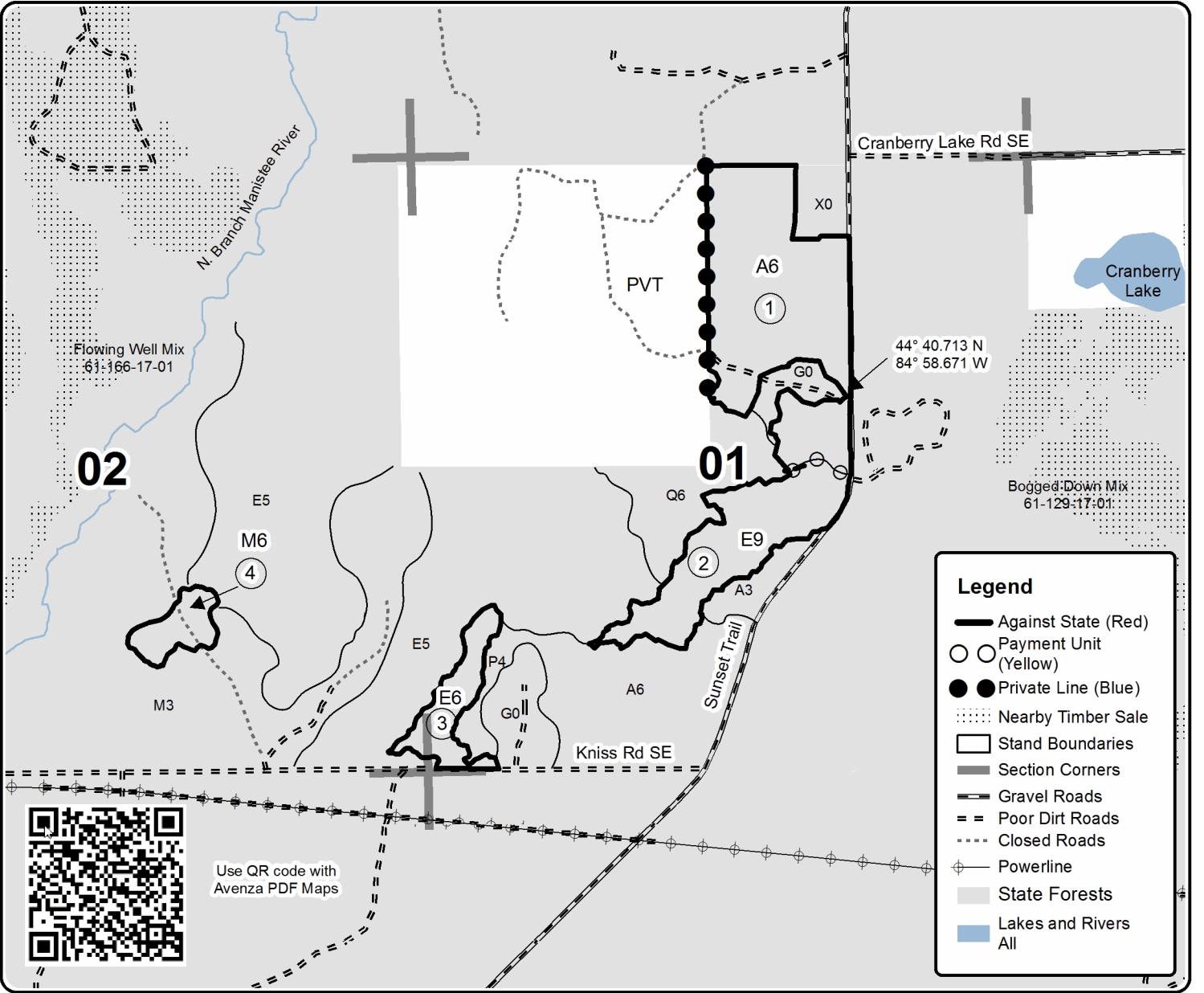

Legend

- Against State (Red)
- ○ Payment Unit (Yellow)
- ● Private Line (Blue)
- ⋯ Nearby Timber Sale
- Stand Boundaries
- Section Corners
- Gravel Roads
- - - Poor Dirt Roads
- ⋯ Closed Roads
- ⊕ Powerline
- State Forests
- Lakes and Rivers
- All



Use QR code with Avenza PDF Maps

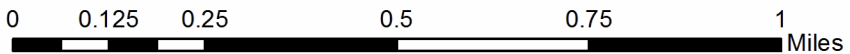

TIMBER SALE INFORMATION

Monster Stump Rally (61-135-17)

Kalkaska County (Advertised Price \$83,166.35)

SALE NOTE: Note that parts of the sale are being converted from aspen to red pine so chipping and low stumps are required. Also note that Payment Units 1 and 4 must be cut during dry or frozen conditions, at the discretion of the Sale Administrator.

A recreation site such as a trail, pathway, or campground is within the sale area or the vicinity. Certain restrictions/specifications may be applicable including time restrictions.

A timber sale contract for this lump sum, sealed bid timber sale will be awarded to the responsible bidder offering the highest sealed bid price. Bids must be at or above the following advertised price for each species:

<u>PRODUCTS & SPECIES</u>	<u>ESTIMATED UNITS*</u>	<u>ADVERTISED PRICE</u>
Sawtimber		
Red Pine	70.20 MBF	\$ 122.00 / MBF
White Pine	51.30 MBF	\$ 71.00 / MBF
Pulpwood		
Balsam Fir	51.00 Cords	\$ 14.70 / Cord
Black Spruce	23.00 Cords	\$ 26.50 / Cord
Jack Pine	60.00 Cords	\$ 14.55 / Cord
Mixed Aspen	2,532.00 Cords	\$ 21.00 / Cord
Mixed Hardwood	312.00 Cords	\$ 19.45 / Cord
Red Oak	12.00 Cords	\$ 13.15 / Cord
Red Pine	93.00 Cords	\$ 40.15 / Cord
Tamarack	10.00 Cords	\$ 35.55 / Cord
White Pine	369.00 Cords	\$ 14.20 / Cord

* The total volume is statistically estimated within plus (+) or minus (-) 10.16 percent. The estimated units are final and not subject to adjustment. Prospective bidders are urged to examine this timber and to make their own estimates of quantity and quality.

BOND AND PAYMENT SCHEDULE:

1. A bond in the amount of \$8,317.00 to insure faithful performance of the conditions of the contract will be deposited by the successful bidder within 21 days of the sale award.
2. Cutting in any sale or unit without the required advance payment would be considered a trespass.
3. Total payment must be paid in advance or according to the following schedule:
 - (a) Ten percent (10%) of the sale value must be paid within 21 days of the sale award.
 - (b) The 10% down payment will be credited towards the first unit cut.
4. If no cutting takes place, the 10% down payment will not be refunded.
5. Operations on the contract issued will terminate on 12/31/2019.

Description of Timber by Payment Unit (PU)

PU	MARKET GROUP	PRODUCT	QUANTITY	UNIT	ACRES	ADVERTISE PRICE
1	Red Pine	Sawtimber	1.3	MBF	27.4	\$13,217.75
	Balsam Fir	Pulpwood	2.0	Cords		
	Black Spruce		1.0	Cords		
	Mixed Aspen		551.0	Cords		
	<i>Quaking Aspen</i>		551.0	<i>Cords</i>		
	Mixed Hardwood		60.0	Cords		
	<i>Black Cherry</i>		37.0	<i>Cords</i>		
	<i>Red Maple</i>		23.0	<i>Cords</i>		
	Red Oak		2.0	Cords		
	Red Pine		1.0	Cords		
White Pine		14.0	Cords			
2	White Pine	Sawtimber	3.4	MBF	11.5	\$3,492.50
	Black Spruce	Pulpwood	1.0	Cords		
	Mixed Aspen		130.0	Cords		
	<i>Quaking Aspen</i>	<i>Sawtimber</i>	3.0	<i>MBF</i>		
	<i>Quaking Aspen</i>	<i>Pulpwood</i>	124.0	<i>Cords</i>		
	Mixed Hardwood		14.0	Cords		
	<i>Red Maple</i>	<i>Sawtimber</i>	0.4	<i>MBF</i>		
	<i>Paper Birch</i>	<i>Pulpwood</i>	6.0	<i>Cords</i>		
	<i>Red Maple</i>		7.0	<i>Cords</i>		
	Red Pine		2.0	Cords		
White Pine		10.0	Cords			
3	Red Pine	Sawtimber	4.5	MBF	19.1	\$9,990.55
	White Pine		19.4	MBF		
	Mixed Aspen	Pulpwood	194.0	Cords		
	<i>B. T. Aspen</i>	<i>Sawtimber</i>	2.8	<i>MBF</i>		
	<i>Quaking Aspen</i>		1.6	<i>MBF</i>		
	<i>B. T. Aspen</i>	<i>Pulpwood</i>	47.0	<i>Cords</i>		
	<i>Quaking Aspen</i>		138.0	<i>Cords</i>		
	Mixed Hardwood		54.0	Cords		
	<i>Red Maple</i>	<i>Sawtimber</i>	4.7	<i>MBF</i>		
	<i>Red Maple</i>	<i>Pulpwood</i>	45.0	<i>Cords</i>		
Red Pine		23.0	Cords			
White Pine		142.0	Cords			
4	Red Pine	Sawtimber	36.3	MBF	12.7	\$8,434.30
	White Pine		16.6	MBF		
	Jack Pine	Pulpwood	17.0	Cords		
	<i>Jack Pine</i>		17.0	<i>Cords</i>		
	Mixed Aspen		48.0	Cords		
	<i>Quaking Aspen</i>		48.0	<i>Cords</i>		
	Red Pine		25.0	Cords		
White Pine		40.0	Cords			
5	Red Pine	Sawtimber	11.2	MBF	3.0	\$1,808.05
	Red Pine	Pulpwood	11.0	Cords		
6	White Pine	Sawtimber	0.9	MBF	61.5	\$22,015.30
	Mixed Aspen	Pulpwood	912.0	Cords		
	<i>B. T. Aspen</i>	<i>Sawtimber</i>	58.2	<i>MBF</i>		
	<i>Quaking Aspen</i>		7.2	<i>MBF</i>		
	<i>B. T. Aspen</i>	<i>Pulpwood</i>	690.0	<i>Cords</i>		
	<i>Quaking Aspen</i>		92.0	<i>Cords</i>		
	Mixed Hardwood		126.0	Cords		
	<i>Basswood</i>	<i>Sawtimber</i>	1.1	<i>MBF</i>		
	<i>Black Cherry</i>		0.5	<i>MBF</i>		
	<i>Red Maple</i>		5.3	<i>MBF</i>		
<i>Basswood</i>	<i>Pulpwood</i>	2.0	<i>Cords</i>			
<i>Black Cherry</i>		20.0	<i>Cords</i>			

Description of Timber by Payment Unit (PU), con't

PU	MARKET GROUP	PRODUCT	QUANTITY	UNIT	ACRES	ADVERTISE PRICE			
6 con't	<i>Ironwood</i>	<i>Pulpwood</i>	5.0	<i>Cords</i>					
	<i>Red Maple</i>		82.0	<i>Cords</i>					
	<i>Sugar Maple</i>		3.0	<i>Cords</i>					
	Red Oak		6.0	<i>Cords</i>					
	White Pine		19.0	<i>Cords</i>					
7	Red Pine	Sawtimber	12.6	MBF	95.6	\$16,201.55			
	White Pine		10.9	MBF					
	Balsam Fir	Pulpwood	4.0	<i>Cords</i>					
	Black Spruce		3.0	<i>Cords</i>					
	Jack Pine		42.0	<i>Cords</i>					
	<i>Jack Pine</i>	<i>Sawtimber</i>	0.9	<i>MBF</i>					
	<i>Jack Pine</i>	<i>Pulpwood</i>	40.0	<i>Cords</i>					
	Mixed Aspen		452.0	<i>Cords</i>					
	<i>Quaking Aspen</i>	<i>Sawtimber</i>	0.7	<i>MBF</i>					
	<i>B. T. Aspen</i>	<i>Pulpwood</i>	16.0	<i>Cords</i>					
	<i>Quaking Aspen</i>		435.0	<i>Cords</i>					
	Mixed Hardwood		44.0	<i>Cords</i>					
	<i>Red Maple</i>	<i>Sawtimber</i>	0.2	<i>MBF</i>					
	<i>Black Cherry</i>	<i>Pulpwood</i>	24.0	<i>Cords</i>					
	<i>Red Maple</i>		20.0	<i>Cords</i>					
	Red Pine		22.0	<i>Cords</i>					
	Tamarack		1.0	<i>Cords</i>					
	White Pine		132.0	<i>Cords</i>					
	8	Red Pine	Sawtimber	4.3			MBF	64.3	\$8,006.35
		White Pine		0.1			MBF		
Balsam Fir		Pulpwood	45.0	<i>Cords</i>					
Black Spruce			18.0	<i>Cords</i>					
Jack Pine			1.0	<i>Cords</i>					
<i>Jack Pine</i>			1.0	<i>Cords</i>					
Mixed Aspen			245.0	<i>Cords</i>					
<i>Quaking Aspen</i>			245.0	<i>Cords</i>					
Mixed Hardwood			14.0	<i>Cords</i>					
<i>Red Maple</i>		<i>Sawtimber</i>	2.0	<i>MBF</i>					
<i>Black Cherry</i>		<i>Pulpwood</i>	3.0	<i>Cords</i>					
<i>Red Maple</i>			7.0	<i>Cords</i>					
Red Oak			4.0	<i>Cords</i>					
Red Pine			9.0	<i>Cords</i>					
Tamarack			9.0	<i>Cords</i>					
White Pine			12.0	<i>Cords</i>					
TOTAL:			121.5	MBF					
TOTAL:			3,462.0	<i>Cords</i>					

Sale Specific Conditions & Requirements

Sale Name: Monster Stump Rally

Sale Number: 61-135-17 Seq#: 1

1 - Sale Area

1.2 - Boundaries

1.2.1 - Painted boundaries (1/14)

The sale boundary and Payment Unit boundaries are marked and identified by red and yellow paint, along with an ORV trail. Exterior sale boundary lines against state are marked with red paint. Interior Payment Unit boundaries are marked with yellow paint, with the exception of the boundary between Payment Units 7 and 8, which is unpainted and identified by the ORV trail. The painted boundary line trees are not Included Timber and are to be protected unless marked with orange paint.

2 - Timber Specifications

2.1 - Included Timber

2.1.1 - Clearcut unit(s) with unmerchantable trees (6/14)

Within Payment Unit(s) 6, 7, and 8, cut all trees that are one (1) inch or more at DBH except trees marked with green paint (only scattered trees in the north part of Payment Unit 6).

2.1.3 - Cut tree marked unit(s) (12/08)

Within Payment Unit(s) 4 and 5, all trees are designated for cutting when marked with orange paint above and below stump height, regardless of merchantability.

2.1.7 - Leave tree marked unit(s) (6/14)

Within Payment Unit(s) 1, 2, and 3, cut all trees that are two (2) inches or more at DBH except trees marked with green paint above and below stump height. In addition, within Payment Unit 3, leave all white pine less than six (6) inches at DBH.

2.2 - Utilization

2.2.2 - Chipping required (5/14)

Payment Units 7 and 8 must be chip harvested to facilitate subsequent planting operations. The Purchaser has the option to produce sawlogs or pulpwood bolts, but the remaining portion of the trees must be chipped and hauled. Do not chip 1/6 to 1/3 of the slash from harvested trees (tree tops and limbs less than four inches in diameter). The unchipped tops should mostly be left in the southeast part of Payment Unit 8.

2.2.3 - Stump heights (4/07)

Stump heights within Payment Unit(s) 7 and 8 shall not exceed 6 inches for all trees. This is in order to facilitate planting operations.

3 - Payments

3.3 - Pre-measured Sales

3.3.4 - Dividing payment units (7/14)

Payment Unit(s) greater than \$15,000 may be divided at the request of the Purchaser and upon approval of the Unit Manager. Dividing Payment Units is a contract modification which requires a Timber Sale Contract Supplement. There will be only one division per Payment Unit.

4 - Transportation

4.1 - Construction

4.1.6 - Road construction (1/09)

Construction of new roads or improvements of existing roads shall be done in such a way as to minimize the environmental and visual impacts. Merchantable trees shall be cut and utilized unless otherwise directed. Non-merchantable trees shall be severed and laid flat on the ground. Slash shall be chipped, scattered, and not left in windrows and kept a minimum of 10 feet back from the road edge. Stumps shall be set upright, not left on edge, and be moved at least 10 feet away from the road edge. Disturbed soil shall be feathered into the woods and not left in berms or windrows.

4.1.7 - Road closure (10/11)

All new roads built into the sale must be blocked to vehicle traffic within 30 days of completion of hauling. Overgrown roads that are reopened or roads that are currently bermed will also need to be blocked. In general, this will require constructing a four (4') foot high berm of stumps and logs covered with earth. These roads must be rendered impassable to cars and trucks. All stumps from road building and landing construction must be reserved to block roads upon completion of the sale. Temporary berms may be required if no sale activity occurs for 30 or more consecutive days. Contact the sale administrator for specific details of design and placement.

4.1.11 - Permits (2/12)

The Purchaser will secure any necessary Kaskaska County Road Commission driveway permits that may be required.

4.2 - Maintenance

4.2.1 - Hauling restriction (12/08)

Hauling may be restricted on forest roads by the Unit Manager or sale administrator. The restriction may occur during wet weather conditions.

5 - Operations

5.1 - Notification

5.1.1 - Pre-sale conference (10/16)

A pre-sale conference on site between the Purchaser and sale administrator is required prior to beginning any operations to determine landing and road locations. The sale administrator be contacted at least 5 days in advance to schedule the conference.

5.1.4 - Post-sale conference (10/16)

A post-sale conference on site between the Purchaser and sale administrator is required 3 days prior to the completion of active logging operations to determine clean-up and repair of landings, road edges, and the fulfillment of other contract specifications.

5.2 - Conduct of Operations

5.2.1 - Slash

5.2.1.8 - Slash height (12/08)

No slash or tree tops may exceed 36 inches in height.

5.2.1.10 - No slash in openings (5/10)

No brush or logging debris is to be left in the maintained wildlife openings which are indicated by G0 or U0 on the Timber Sale Map. Any damage to the opening shall be repaired according to specifications of the Unit Manager or his/her representative.

5.2.2 - Hazard Trees/Snags

5.2.2.1 - Den trees (10/16)

Obvious hollow and/or den trees shall be protected and left standing unless they are a safety hazard.

5.2.3 - Operating Restrictions

5.2.3.1 - Operating restrictions (9/11)

Within Payment Unit(s) 1 and 4, unless changed by written agreement, cutting, skidding, and hauling are limited to very dry or frozen conditions. Permission to operate in these Payment Units must be obtained from the sale administrator before cutting. This restriction is because of wet ground.

5.2.3.11 - Coppice regeneration protection (4/10)

Within Payment Units 1, 2, 3, 4 and 6, any post-harvest operations, such as chipping, must be completed before sprouting of regeneration occurs. If it is anticipated that chipping will be delayed, then tops shall be carried to one central location or left unchipped. The Unit Manager or sale administrator may cease such operations if sprouting occurs before the operation is complete.

5.2.32 - Decking/landing restoration (9/13)

All decking and landing areas must have the surface area restored to a condition equal to or better than before. This is to ensure the proper regeneration of the stand. Wood debris, chips and "cookies" from trimmings must be removed or scattered away from landing and loading areas and may not be windrowed on the edge.

5.2.38 - No decking against live trees (2/04)

Cut products may not be decked against unmarked or designated leave trees.

5.2.39 - ORV trail/route protection (12/12)

There is an ORV trail and route shown on the Timber Sale Map. Do not cut trees or damage posts with orange ORV markers. All stumps within 5 feet of the trail must be cut flush with the ground. Maintain a 20 foot wide slash, debris, and rut free zone daily using the ORV trail or route as the centerline. Do not run equipment down the ORV trail or route. The Purchaser shall work with the sale administrator to identify landing locations that minimize the need to skid across recreational trails.

5.2.41 - Snowmobile trail protection (9/11)

There is a snowmobile trail shown on the Timber Sale Map. Do not cut or damage posts with orange trail markers or traffic control signs. If the trail is used for hauling, it must be graded to the satisfaction of the Unit Manager or sale administrator prior to December 1. From December 1 to March 31, the snowmobile trail may be crossed to harvest wood on the north side, but may not be used for other timber sale operations during the snowmobile season. Maintain a 20 foot wide slash, debris, and rut-free zone daily using the snowmobile trail as the centerline. No decking of forest products will be permitted along the snowmobile trail. All stumps within 20 feet of the snowmobile trail must be cut at ground level.

5.2.43 - Opening protection (12/08)

No activities are permitted in openings marked on the Timber Sale Map with the letter "G". Any damage to the openings shall be repaired according to specifications of the Unit Manager or his/her representative.

5.4 - Soil Protection

5.4.1 - Rutting restriction, general (7/16)

Operations are to cease immediately if equipment and weather conditions result in rutting of roads or skid trails which is 12 inches or greater in depth and 50 feet in length. The Unit Manager or his/her representative may restrict hauling and/or skidding if ruts exceed the specified depth. With the Unit Manager or his/her representative's approval, the Purchaser may return to the area when the risk of rutting has decreased.

5.8 - Protection of Endangered Species

5.8.5 - Protection of raptor nests (3/13)

All trees with raptor nests will be protected if found during harvesting operations. Notification will be made to the Unit Manager or his/her representative who will notify the Wildlife Biologist so an on-site evaluation and recommendation can be made, if necessary.

6 - Safety and Fire Prevention

6.2 - Signing

6.2.1 - Road posting (9/09)

The Purchaser is responsible for posting and maintaining caution signs on Riverview Road prior to beginning operations. The road must be posted approximately 200 feet from both ends of the sale area to warn of logging activity and truck traffic. Signs must be removed when harvest operations are suspended or completed. The Purchaser will provide these signs.

6.2.2 - Snowmobile trail posting (8/09)

The Purchaser is responsible for posting and maintaining caution signs on the snowmobile trail prior to beginning operations during the snowmobile season (approximately December 1 to March 31). The trail must be posted at appropriate distances from both sides the sale area to warn of logging activity and truck traffic. Signs must be removed when harvest operations are suspended or completed. The Purchaser will provide these signs.

6.2.3 - Recreational trail posting (2/10)

The Purchaser is responsible for posting and maintaining caution signs on the ORV trail prior to beginning operations. The trail must be posted approximately 200 feet from both ends of the sale area to warn of logging activity and truck traffic at both

ends of the trail. Signs must be removed when harvest operations are suspended or completed. The Purchaser will provide these signs.



TIMBER SALE MAP

This information provided by authority of Part 525, 1994 PA 451, as amended.

Forest Management Unit Traverse City		County Kalkaska		Mapped By Armstrong		Date 5/24/2017		Page 1 of 1	
Township 26N		Range 5W		Section(s) and Subdivision(s) Sec. 17, 18, 19: See proposal Sec. 24: See proposal		Scale 1:15,840			
26N		6W							

Cover Type

A = Aspen	H = Hemlock	N = Marsh	U = Upland Brush
B = Paper Birch	J = Jack Pine	O = Oak	UM = Upland Mixed
C = Cedar	L = Lowland Brush	P = Lowland Poplar	V = Bog or Marsh
D = Treed Bog	LM = Lowland Mixed	Q = Mixed Swamp Conifer	W = White Pine
E = Swamp Hdwoods	M = Mpl, Bch, Brch	R = Red Pine	X = Non Stocked
F = Spruce Fir	MC = Mixed Conifer	S = Black Spruce	Z = Water
G = Grass	MD = Mixed Deciduous	T = Tamarack	

Density

0 = Non Stocked	5 = Pole Timber Medium
1 = Seedling Sapling Poor	6 = Pole Timber Well
2 = Seedling Sapling Medium	7 = Saw Timber Poor
3 = Seedling Sapling Well	8 = Saw Timber Medium
4 = Pole Timber Poor	9 = Saw Timber Well

Unit	Acres
1	27.4
2	11.5
3	19.1
4	12.7
5	3.0
6	61.5
7	95.6
8	64.3

Monster Stump Rally

Compartments 126 & 128

295.1 acres

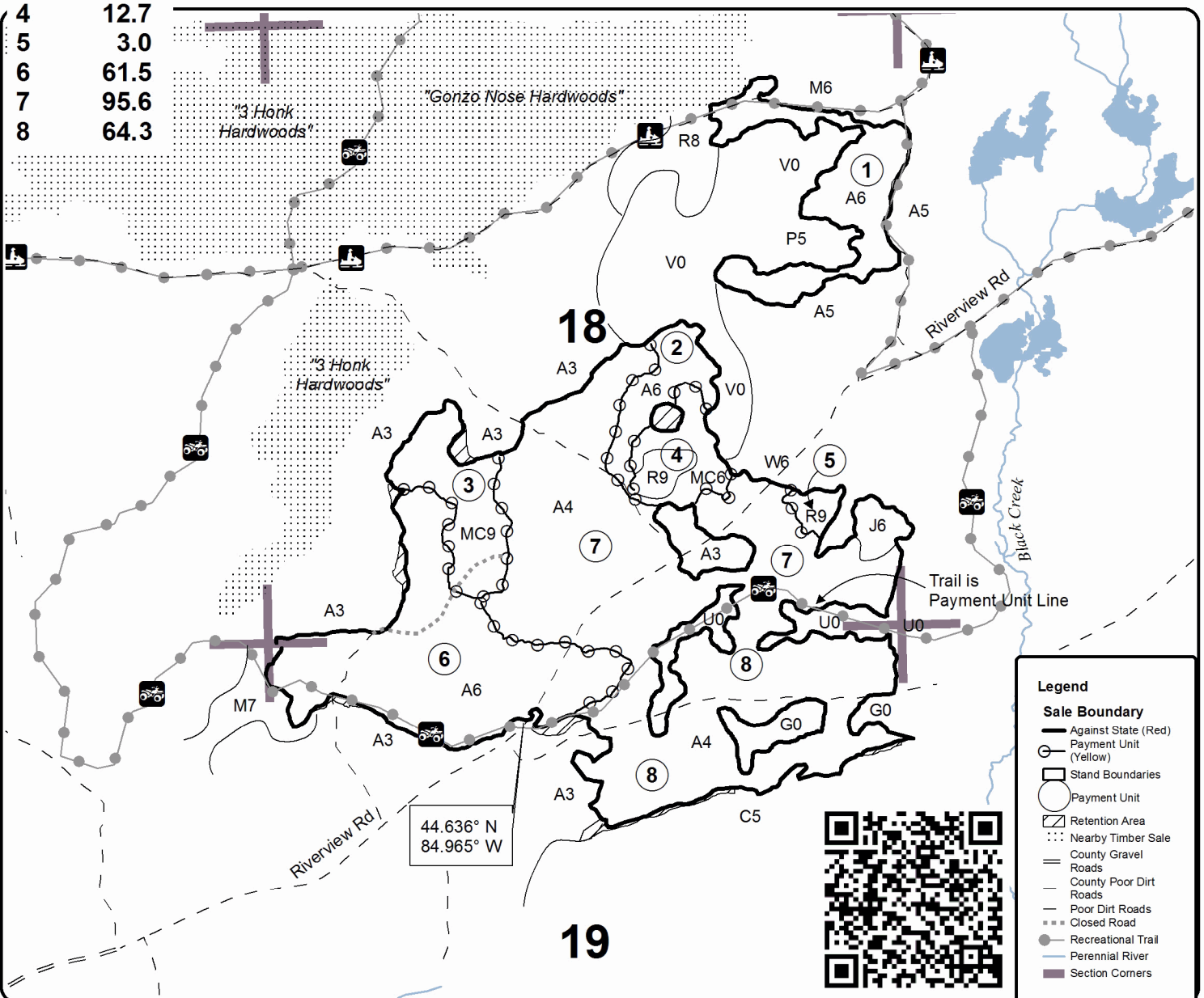

44.636° N
84.965° W

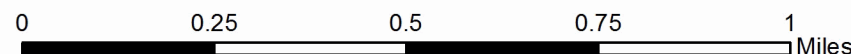

TIMBER SALE INFORMATION

Trees and Trails (61-139-17)

Kalkaska County (Advertised Price \$57,902.00)

SALE NOTE: Please note that there are multiple recreational trails in and near this sale. Operations may be restricted for brief periods for permitted recreational events. The sale, however, does have the possibility for Class A access onto M72.

A recreation site such as a trail, pathway, or campground is within the sale area or the vicinity. Certain restrictions/specifications may be applicable including time restrictions.

A timber sale contract for this lump sum, sealed bid timber sale will be awarded to the responsible bidder offering the highest sealed bid price. Bids must be at or above the following advertised price for each species:

<u>PRODUCTS & SPECIES</u>	<u>ESTIMATED UNITS*</u>	<u>ADVERTISED PRICE</u>
Sawtimber		
Red Maple	6.50 MBF	\$ 110.00 / MBF
Red Oak	335.50 MBF	\$ 140.00 / MBF
Red Pine	11.40 MBF	\$ 98.00 / MBF
Pulpwood		
B. T. Aspen	8.00 Cords	\$ 16.80 / Cord
Jack Pine	14.00 Cords	\$ 11.60 / Cord
Misc. Species 1	14.00 Cords	\$ 3.00 / Cord
Mixed Hardwood	83.00 Cords	\$ 15.60 / Cord
Red Oak	667.00 Cords	\$ 10.50 / Cord
Red Pine	13.00 Cords	\$ 32.10 / Cord
White Pine	4.00 Cords	\$ 11.35 / Cord

* The total volume is statistically estimated within plus (+) or minus (-) 12.21 percent. The estimated units are final and not subject to adjustment. Prospective bidders are urged to examine this timber and to make their own estimates of quantity and quality.

BOND AND PAYMENT SCHEDULE:

1. A bond in the amount of \$2,895.00 to insure faithful performance of the conditions of the contract will be deposited by the successful bidder within 21 days of the sale award.
2. Cutting in any sale or unit without the required advance payment would be considered a trespass.
3. Total payment must be paid in advance or according to the following schedule:
 - (a) Ten percent (10%) of the sale value must be paid within 21 days of the sale award.
 - (b) The 10% down payment will be credited towards the first unit cut.
4. If no cutting takes place, the 10% down payment will not be refunded.
5. Operations on the contract issued will terminate on 04/15/2020.

Description of Timber by Payment Unit (PU)

PU	MARKET GROUP	PRODUCT	QUANTITY	UNIT	ACRES	ADVERTISE PRICE
1	Red Oak	Sawtimber	106.5	MBF	36.9	\$17,376.00
	B. T. Aspen	Pulpwood	8.0	Cords		
	Misc. Species 1		3.0	Cords		
	Mixed Hardwood		21.0	Cords		
	<i>Red Maple</i>		21.0	<i>Cords</i>		
	Red Oak		190.0	Cords		
2	Red Oak	Sawtimber	45.9	MBF	15.4	\$7,955.50
	Red Pine		1.4	MBF		
	Misc. Species 1	Pulpwood	9.0	Cords		
	Mixed Hardwood		2.0	Cords		
	<i>Black Cherry</i>		2.0	<i>Cords</i>		
	Red Oak		124.0	Cords		
	Red Pine		1.0	Cords		
3	Red Maple	Sawtimber	1.1	MBF	17.0	\$12,254.50
	Red Oak		72.6	MBF		
	Red Pine		2.1	MBF		
	Misc. Species 1	Pulpwood	2.0	Cords		
	Mixed Hardwood		11.0	Cords		
	<i>Red Maple</i>		11.0	<i>Cords</i>		
	Red Oak		148.0	Cords		
	Red Pine		1.0	Cords		
	4	Red Maple	Sawtimber	5.4		
Red Oak			110.5	MBF		
Red Pine			7.9	MBF		
Jack Pine		Pulpwood	14.0	Cords		
Mixed Hardwood			49.0	Cords		
<i>Red Maple</i>			49.0	<i>Cords</i>		
Red Oak			205.0	Cords		
Red Pine			11.0	Cords		
White Pine			4.0	Cords		
TOTAL:			353.4	MBF		
TOTAL:			803.0	Cords		

Sale Specific Conditions & Requirements

Sale Name: Trees and Trails

Sale Number: 61-139-17 Seq#: 1

1 - Sale Area

1.2 - Boundaries

1.2.1 - Painted boundaries (1/14)

The sale boundary is marked and identified by red paint. Exterior sale boundary lines against state are marked with red paint. The painted boundary line trees are not Included Timber and are to be protected.

2 - Timber Specifications

2.1 - Included Timber

2.1.7 - Leave tree marked unit(s) (6/14)

Within Payment Unit(s) 1 and 2, cut all trees that are two (2) inches or more at DBH except white oak, white pine, and trees marked with green paint above and below stump height.

Within Payment Unit(s) 3 and 4, cut all trees that are two (2) inches or more at DBH except white pine and red pine less than 10" at DBH, all white oak and trees marked with green paint above and below stump height.

2.1.11 - Description of timber note (2/04)

Note that Misc. Species 1 is dead oak, which may be cut throughout the sale.

3 - Payments

3.3 - Pre-measured Sales

3.3.4 - Dividing payment units (7/14)

Payment Unit(s) greater than \$15,000 may be divided at the request of the Purchaser and upon approval of the Unit Manager. Dividing Payment Units is a contract modification which requires a Timber Sale Contract Supplement. There will be only one division per Payment Unit.

3.4 - Damaged Timber

3.4.1 - Damaged timber (6/14)

General Condition and Requirement 3.4 Damaged Timber, defines liquidated damages for undesignated live merchantable trees which are cut or injured. In addition, extreme care should be taken to avoid damage to tree seedlings and saplings.

Within the sale area, if more than 25% of the desirable tree seedlings or saplings (1/4" to 4.5" DBH) within a specified portion of the sale area are damaged, liquidated damages will be assessed at \$300 per acre for all acreage within that specified portion of the sale area that was damaged.

No damage is acceptable to merchantable trees. Within the sale area, if more than 10% of trees (> 4.5" DBH) within a specified area of the sale are damaged, liquidated damages will be assessed for all trees damaged. Rates will be in accordance with General Condition and Requirement 3.4 Damaged Timber.

3.6 - Payment Unit Cutting Schedule

3.6.1 - Order of cutting (1/09)

Payment Units shall be cut in any order, but once operations have commenced on a Payment Unit, cutting on that Unit must be completed before another Unit may be opened, unless approved by the Unit Manager or his/her representative.

4 - Transportation

4.1 - Construction

4.1.6 - Road construction (1/09)

Improvements of existing roads shall be done in such a way as to minimize the environmental and visual impacts.

Merchantable trees shall be cut and utilized unless otherwise directed. Non-merchantable trees shall be severed and laid flat on the ground. Slash shall be scattered, and not left in windrows and kept a minimum of 10 feet back from the road edge. Stumps shall be set upright, not left on edge, and be moved at least 10 feet away from the road edge. Disturbed soil shall be feathered into the woods and not left in berms or windrows.

4.1.8 - Road work (1) (8/07)

The following road work is required: upon completion of the sale, the Purchaser must construct two berms at locations specified by the sale administrator. The locations are approximately: 1) near the southwest corner of Payment Unit 2, and 2) adjacent to the west end of Payment Units 3 and 4.

4.1.11 - Permits (2/12)

The Purchaser will secure any necessary Kaskaska County Road Commission driveway permits that may be required. If access onto M72 is desired, please notify the Sale Administrator at least 30 days in advance so that he/she can secure an MDOT right-of-way permit.

4.1.12 - No new roads (1/12)

No new roads will be permitted. All operation are limited to existing roads.

4.2 - Maintenance

4.2.1 - Hauling restriction (12/08)

Hauling on forest roads may be restricted by the Unit Manager or sale administrator. The restriction may occur on or in advance of the dates of several permitted recreational events. These events include the Iceman Cometh mountain bike race (first Saturday in November) and Kaskaska Winterfest dogsled race (one weekend in January, February or March).

4.2.5 - Two wheel drive condition (2/04)

All existing trail roads on and adjacent to the sale area must be passable by two-wheel drive traffic for the duration of the sale.

5 - Operations

5.1 - Notification

5.1.1 - Pre-sale conference (10/16)

A pre-sale conference on site between the Purchaser and sale administrator is required prior to beginning any operations to determine landing locations and review recreational trail locations. The Unit Manager or Sale Administrator must be contacted at least 3 days in advance to schedule the conference.

5.1.3 - Well heads and natural gas pipelines (11/15)

The Purchaser is responsible for contacting the gas or pipeline company prior to operating equipment in the vicinity of well heads or natural gas pipelines. Contact BreitBurn at 888-250-1681. There is an active facility within Payment Unit 1 ("X0" on the Timber Sale Map). Pipelines run along both sides of Smith Lake Road and through multiple locations in Payment Unit 1.

5.2 - Conduct of Operations

5.2.1 - Slash

5.2.1.8 - Slash height (12/08)

No slash or tree tops may exceed 36 inches in height.

5.2.2 - Hazard Trees/Snags

5.2.2.1 - Den trees (10/16)

Obvious hollow and/or den trees shall be protected and left standing unless they are a safety hazard.

5.2.3 - Operating Restrictions

5.2.3.1 - Operating restrictions (9/11)

Within Payment Unit(s) 1, 2, 3, and 4, timber sale operations may be restricted by the Unit Manager or sale administrator. The Purchaser may be asked to limit operations to areas away from recreational trails or temporarily cease operations, if necessary. This restriction is due to permitted recreational events including the Iceman Cometh mountain bike race (first

Saturday in November) and Kalkaska Winterfest dogsled race (one weekend in January, February or March).

5.2.3.4 - Oak wilt restriction (4/17)

Within Payment Unit(s) 1, 2, 3, and 4, cutting, skidding, and hauling are not permitted during the period of April 15 to July 15. This is necessary to reduce the spread of oak wilt. For more information, contact the Unit Manager or his/her representative. Hauling from certain landings may be permitted from April 15 to July 15 only if roads are brushed out before April 15 and the route is pre-approved by the Sale Administrator. This would require a Timber Sale Contract Supplement.

5.2.38 - No decking against live trees (2/04)

Cut products may not be decked against unmarked or designated leave trees.

5.2.40 - Pathway protection (10/10)

There are multiple pathways (hiking, biking and winter dogsled) in and near the sale area, as shown on the Timber Sale Map. If the trails are not visible enough, please ask the Sale Administrator to flag the trails before beginning operations. Do not cut trees or damage posts with blue pathway markers. At the end of every working day, remove cut forest products and slash from the area within 10 feet of both sides of the trails. Do not run equipment down the narrow pathways or the area between Payment Units 3 and 4. Some recreational events also use poor dirt roads. These roads will be considered as part of the pathways during the events. Please contact the sale administrator for additional details.

5.4 - Soil Protection

5.4.1 - Rutting restriction, general (7/16)

Operations are to cease immediately if equipment and weather conditions result in rutting of roads and/or skid trails which is 12 inches or greater in depth and 50 feet in length. The Unit Manager or his/her representative may restrict hauling and/or skidding if ruts exceed the specified depth. With the Unit Manager or his/her representative's approval, the Purchaser may return to the area when the risk of rutting has decreased.

6 - Safety and Fire Prevention

6.2 - Signing

6.2.3 - Recreational trail posting (2/10)

The Purchaser is responsible for posting and maintaining caution signs on recreational trails prior to beginning operations. The trail must be posted 200 feet from both ends of the sale area to warn of logging activity and truck traffic at both ends of the trail. Signs must be removed when harvest operations are suspended or completed. The Purchaser will provide these signs.

7 - Other Conditions

7.3 - Contract Modifications

7.3.2 - Modification for oak wilt (2/05)

Within the sale area, there may be patches of oak wilt. If oak wilt is identified within the sale area, this contract may be modified. The following modifications could occur: time of cutting, species to cut, volume to harvest, or various others dealing with the treatment of oak wilt. If a species is not specified in this contract, it shall be paid for at the average price received for that species and product.

99 - Unique

SKIP

99.1 - Supplement for Oak Wilt Treatment Area (6/17)

2.1.10 - Supplement for Oak Wilt Treatment Area

A small area adjacent to Payment Unit 2 was treated for oak wilt in the winter of 2016-2017. Oak within a half-to-one acre area was cut and left. If this wood is still merchantable when this sale is cut, the oak in this area may be included at contract prices but must be scaled by the Sale Administrator before being hauled. If the Purchaser chooses to utilize this wood, a Timber Sale Contract Supplement will specify details of the additional timber.



TIMBER SALE MAP

This information provided by authority of Part 525, 1994 PA 451, as amended.

Sale Number	Year
61-139	2017

Forest Management Unit Traverse City	County Kalkaska	Mapped By Armstrong	Date 6/22/2017	Page 1	of 1
Township 27N	Range 8W	Section(s) and Subdivision(s) Section 12: SWSE; Section 13: N1/2	Scale 1:15,840		

Cover Type

A = Aspen	H = Hemlock	N = Marsh	U = Upland Brush
B = Paper Birch	J = Jack Pine	O = Oak	UM = Upland Mixed
C = Cedar	L = Lowland Brush	P = Lowland Poplar	V = Bog or Marsh
D = Treed Bog	LM = Lowland Mixed	Q = Mixed Swamp Conifer	W = White Pine
E = Swamp Hdwoods	M = Mpl, Bch, Brch	R = Red Pine	X = Non Stocked
F = Spruce Fir	MC = Mixed Conifer	S = Black Spruce	Z = Water
G = Grass	MD = Mixed Deciduous	T = Tamarack	

Density

0 = Non Stocked	5 = Pole Timber Medium
1 = Seedling Sapling Poor	6 = Pole Timber Well
2 = Seedling Sapling Medium	7 = Saw Timber Poor
3 = Seedling Sapling Well	8 = Saw Timber Medium
4 = Pole Timber Poor	9 = Saw Timber Well

Unit	Acres	Unit	Acres
1	36.9	3	17.0
2	15.4	4	34.5

Trees and Trails

Compartment 164

103.8 acres

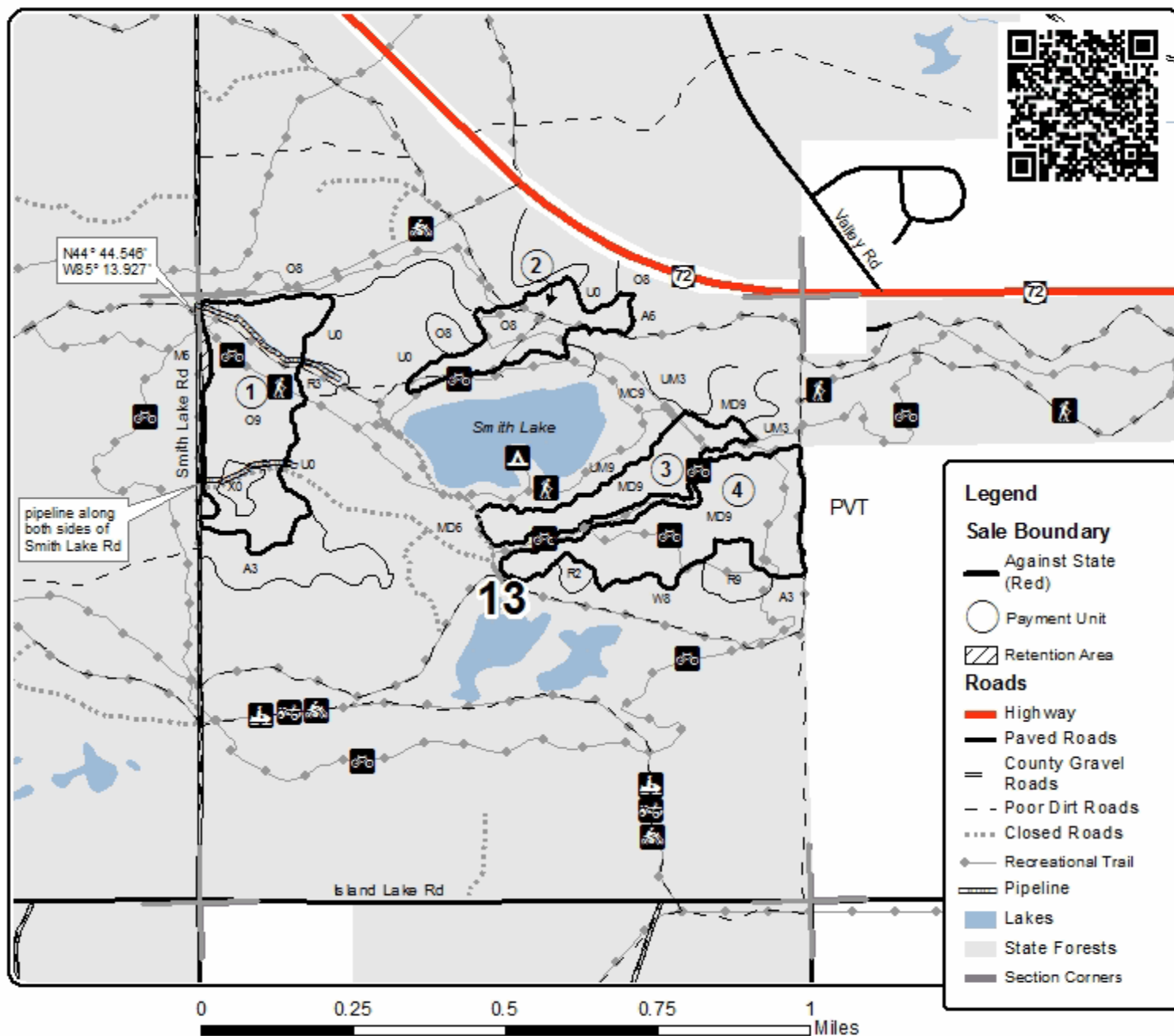

TIMBER SALE INFORMATION

Goose Creek Flooding Mix (61-150-17)

Kalkaska County (Advertised Price \$52,572.55)

SALE NOTE: A recreation site such as a trail, pathway, or campground is within the sale area or the vicinity. Certain restrictions/specifications may be applicable including time restrictions.

A timber sale contract for this lump sum, sealed bid timber sale will be awarded to the responsible bidder offering the highest sealed bid price. Bids must be at or above the following advertised price for each species:

<u>PRODUCTS & SPECIES</u>	<u>ESTIMATED UNITS*</u>	<u>ADVERTISED PRICE</u>
Sawtimber		
BI/R/Hybrid Oak	2.20 MBF	\$ 104.00 / MBF
Mixed Aspen	10.50 MBF	\$ 108.00 / MBF
Red Maple	3.10 MBF	\$ 129.00 / MBF
Red Oak	157.40 MBF	\$ 163.00 / MBF
Red Pine	65.00 MBF	\$ 114.00 / MBF
White Oak	1.60 MBF	\$ 56.00 / MBF
White Pine	16.50 MBF	\$ 67.00 / MBF
Pulpwood		
Jack Pine	2.00 Cords	\$ 13.55 / Cord
Mixed Aspen	174.00 Cords	\$ 19.60 / Cord
Mixed Hardwood	183.00 Cords	\$ 18.15 / Cord
Mixed Oak	380.00 Cords	\$ 12.25 / Cord
Red Pine	118.00 Cords	\$ 37.45 / Cord
White Pine	54.00 Cords	\$ 13.25 / Cord

* The total volume is statistically estimated within plus (+) or minus (-) 11.73 percent. The estimated units are final and not subject to adjustment. Prospective bidders are urged to examine this timber and to make their own estimates of quantity and quality.

BOND AND PAYMENT SCHEDULE:

1. A bond in the amount of \$2,629.00 to insure faithful performance of the conditions of the contract will be deposited by the successful bidder within 21 days of the sale award.
2. Cutting in any sale or unit without the required advance payment would be considered a trespass.
3. Total payment must be paid in advance or according to the following schedule:
 - (a) Ten percent (10%) of the sale value must be paid within 21 days of the sale award.
 - (b) The 10% down payment will be credited towards the first unit cut.
4. If no cutting takes place, the 10% down payment will not be refunded.
5. Operations on the contract issued will terminate on 12/31/2019.

Description of Timber by Payment Unit (PU)

PU	MARKET GROUP	PRODUCT	QUANTITY	UNIT	ACRES	ADVERTISE PRICE
1	Red Pine	Sawtimber	18.7	MBF	3.9	\$3,629.80
	Red Pine	Pulpwood	40.0	Cords		
2	Mixed Aspen	Sawtimber	0.7	MBF	13.0	\$12,735.10
	<i>B. T. Aspen</i>		0.7	<i>MBF</i>		
	Red Maple		0.8	MBF		
	Red Oak		55.8	MBF		
	Mixed Aspen	Pulpwood	24.0	Cords		
	<i>B. T. Aspen</i>		21.0	<i>Cords</i>		
	<i>Quaking Aspen</i>		3.0	<i>Cords</i>		
	Mixed Hardwood		75.0	Cords		
	<i>Paper Birch</i>	<i>Sawtimber</i>	0.5	<i>MBF</i>		
	<i>Beech</i>	<i>Pulpwood</i>	4.0	<i>Cords</i>		
	<i>Paper Birch</i>		15.0	<i>Cords</i>		
	<i>Red Maple</i>		55.0	<i>Cords</i>		
	Mixed Oak		133.0	Cords		
	<i>Red Oak</i>		133.0	<i>Cords</i>		
3	Red Pine	Sawtimber	28.5	MBF	4.9	\$5,008.90
	White Pine		1.0	MBF		
	Mixed Aspen	Pulpwood	1.0	Cords		
	<i>B. T. Aspen</i>		1.0	<i>Cords</i>		
	Mixed Oak		1.0	Cords		
	<i>White Oak</i>		1.0	<i>Cords</i>		
	Red Pine		44.0	Cords		
	White Pine		1.0	Cords		
4	Red Oak	Sawtimber	99.9	MBF	29.4	\$19,451.00
	Red Pine		0.5	MBF		
	White Oak		1.6	MBF		
	Mixed Aspen	Pulpwood	3.0	Cords		
	<i>B. T. Aspen</i>		3.0	<i>Cords</i>		
	Mixed Hardwood		3.0	Cords		
	<i>Misc. Species 2</i>	<i>Sawtimber</i>	1.0	<i>MBF</i>		
	<i>Misc. Species 2</i>	<i>Pulpwood</i>	1.0	<i>Cords</i>		
	Mixed Oak		219.0	Cords		
	<i>Red Oak</i>		202.0	<i>Cords</i>		
	<i>White Oak</i>		17.0	<i>Cords</i>		
Red Pine		6.0	Cords			
5	BI/R/Hybrid Oak	Sawtimber	2.2	MBF	22.8	\$11,747.75
	Mixed Aspen		9.8	MBF		
	<i>B. T. Aspen</i>		5.2	<i>MBF</i>		
	<i>Quaking Aspen</i>		4.6	<i>MBF</i>		
	Red Maple		2.3	MBF		
	Red Oak		1.7	MBF		
	Red Pine		17.3	MBF		
	White Pine		15.5	MBF		
	Jack Pine	Pulpwood	2.0	Cords		
	Mixed Aspen		146.0	Cords		
	<i>B. T. Aspen</i>		41.0	<i>Cords</i>		
	<i>Quaking Aspen</i>		105.0	<i>Cords</i>		
	Mixed Hardwood		105.0	Cords		
	<i>Black Cherry</i>		1.0	<i>Cords</i>		
	<i>Red Maple</i>		104.0	<i>Cords</i>		
	Mixed Oak		27.0	Cords		
	<i>BI/R/Hybrid Oak</i>		23.0	<i>Cords</i>		
	<i>Red Oak</i>		4.0	<i>Cords</i>		
	Red Pine		28.0	Cords		
	White Pine		53.0	Cords		

TOTAL:	256.3	MBF
--------	-------	-----

TOTAL:	911.0	Cords
--------	-------	-------

Sale Specific Conditions & Requirements

Sale Name: Goose Creek Flooding Mix

Sale Number: 61-150-17 Seq#: 1

1 - Sale Area

1.2 - Boundaries

1.2.1 - Painted boundaries (1/14)

The sale boundary and Payment Unit boundaries are marked and identified by blue, red and yellow paint. Exterior sale boundary lines against private property are marked with blue paint. Exterior sale boundary lines against state are marked with red paint. Interior Payment Unit boundaries are marked with yellow paint. The painted boundary line trees are not Included Timber and are to be protected.

2 - Timber Specifications

2.1 - Included Timber

2.1.1 - Clearcut unit(s) with unmerchantable trees (6/14)

Within Payment Unit(s) 2, cut all trees that are two (2) inches or more at DBH except do not cut white pine, red pine and sugar maple.

2.1.7 - Leave tree marked unit(s) (6/14)

Within Payment Unit(s) 4, cut all trees that are four (4) inches or more at DBH except do not cut white pine, trees marked with green paint, and red pine less than ten (10) inches in diameter.

Within Payment Unit(s) 5, cut all trees that are two (2) inches or more at DBH except do not cut white oak, trees marked with green paint, and white pine less than four (4) inches in diameter.

2.1.8 - Designated plantation row unit(s) (12/08)

Within Payment Unit(s) 1 and 3, all trees which meet minimum piece specifications in 2.2 Utilization, within designated plantation rows are designated for cutting. In addition, cut all jack pine. Designated plantation rows are every third row. Begin with the third row in from the outside of the plantation, then continue every third row. Because of the variability of row direction, it shall be the responsibility of the producer to maintain the third row sequence.

3 - Payments

3.3 - Pre-measured Sales

3.3.4 - Dividing payment units (7/14)

Payment Unit(s) with a value over \$10,000 may be divided at the request of the Purchaser and upon approval of the Unit Manager. Dividing Payment Units is a contract modification which requires a Timber Sale Contract Supplement. There will be only one division per Payment Unit.

3.4 - Damaged Timber

3.4.1 - Damaged timber (6/14)

General Condition and Requirement 3.4 Damaged Timber, defines liquidated damages for undesignated live merchantable trees which are cut or injured. In addition, extreme care should be taken to avoid damage to tree seedlings and saplings.

Within the sale area, if more than 25% of the tree seedlings or saplings (1/4" to 4.5" DBH) within a specified portion of the sale area are damaged, liquidated damages will be assessed at \$200 per acre for all acreage within that specified portion of the sale area that was damaged.

No damage is acceptable to merchantable trees. Within the sale area, if more than 10 of trees (> 4.5" DBH) within a specified area of the sale are damaged, liquidated damages will be assessed for all trees damaged. Rates will be in accordance with General Condition and Requirement 3.4 Damaged Timber.

4 - Transportation

4.1 - Construction

4.1.6 - Road construction (1/09)

Construction of new roads or improvements of existing roads shall be done in such a way as to minimize the environmental and visual impacts. Merchantable trees shall be cut and utilized unless otherwise directed. Non-merchantable trees shall be severed and laid flat on the ground. Slash shall be scattered, and not left in windrows and kept a minimum of 10 feet back from the road edge. Stumps shall be set upright, not left on edge, and be moved at least 10 feet away from the road edge. Disturbed soil shall be feathered into the woods and not left in berms or windrows.

4.1.7 - Road closure (10/11)

All new roads built into the sale must be blocked to vehicle traffic within 30 days of completion of hauling. In general, this will require constructing a four (4') foot high berm of stumps and logs covered with earth. Stumps and brush must be placed along the remainder of the trail. These roads must be rendered impassable to cars and trucks. Contact the sale administrator for specific details of design and placement.

4.1.11 - Permits (2/12)

The Purchaser will secure any necessary county driveway permits that may be required.

5 - Operations

5.1 - Notification

5.1.1 - Pre-sale conference (10/16)

A pre-sale conference on site between the Purchaser and sale administrator is required prior to beginning any operations to determine landing and road locations. The Unit Manager or his/her representative must be contacted at least 3 days in advance to schedule the conference.

5.1.3 - Well heads and natural gas pipelines (11/15)

The Purchaser is responsible for contacting the pipeline company prior to operating equipment in the vicinity of well heads or natural gas pipelines. Contact Lee Able with Merit Energy at 231-258-6404.

5.2 - Conduct of Operations

5.2.3 - Operating Restrictions

5.2.3.4 - Oak wilt restriction (4/17)

Within Payment Unit(s) 4 and 5, cutting, skidding, and hauling are not permitted during the period of April 15 to July 15. This is necessary to reduce the spread of oak wilt. For more information, contact the Unit Manager or his/her representative.

5.2.3.6 - Bark beetle restriction (12/08)

In the event drought creates a high risk of pine bark beetle infestation, pine is not to be cut during the period March 1 through July 1, unless all portions of trees greater than two inches in diameter are removed from the sale area, reduced to chips, or treated to the satisfaction of the Unit Manager or his/her representative, within fifteen days of being severed from the stump. Pine log decks, pulpwood piles and treetops that are piled for chipping in the fall or winter within a 1/4 mile of susceptible sites must be removed before March 15. Residual slash must not be placed in piles or rows and must be spread over the site for quick drying. The Department of Natural Resources will exercise this specification if the risk of damage warrants.

5.2.4 - Dead and Down Creation

5.2.4.4 - Dead and down creation, grouse (8/13)

To encourage grouse and other wildlife, in Payment Unit(s) 5, leave at least six (6) large tops in a single pile and at least one pile for every 2 acres (11 total). These will be evenly scattered throughout the unit.

5.2.20 - Equipment width (2/04)

Equipment used to remove designated rows in Payment Units 1 and 3 must be capable of moving through cut rows without damaging residual trees.

5.2.32 - Decking/landing restoration (9/13)

All decking and landing areas must have the surface area restored to a condition equal to or better than before. This is to ensure the proper regeneration of the stand.

5.2.38 - No decking against live trees (2/04)

Cut products may not be decked against unmarked or designated leave trees.

5.2.39 - ORV trail/route protection (12/12)

There is an ORV trail and it is shown on the Timber Sale Map. Do not cut trees or damage posts with orange ORV markers. All stumps within 5 feet of the trail must be cut flush with the ground. Maintain a 10 foot wide slash, debris, and rut free zone daily using the ORV trail as the centerline. Do not run equipment down the ORV trail.

5.2.41 - Snowmobile trail protection (9/11)

There is a snowmobile trail and it is shown on the Timber Sale Map. Do not cut or damage posts with orange trail markers or traffic control signs. If the trail is used, it must be maintained and restored to a condition equal to or better than before the sale. If the trail road is to be used for hauling during the snowmobile season, then a snow covered base must be left on the trail. The snowmobile trail may only be crossed at right angles. Maintain a 20 foot wide slash, debris, and rut free zone daily using the snowmobile trail as the centerline. No decking of forest products will be permitted along the snowmobile trail. All stumps within 20 feet of the snowmobile trail must be cut at ground level.

5.4 - Soil Protection

5.4.1 - Rutting restriction, general (7/16)

Operations are to cease immediately if equipment and weather conditions result in rutting of roads and/or skid trails which is 12 inches or greater in depth and 50 feet in length. The Unit Manager or his/her representative may restrict hauling and/or skidding if ruts exceed the specified depth. With the Unit Manager or his/her representative's approval, the Purchaser may return to the area when the risk of rutting has decreased.

6 - Safety and Fire Prevention

6.2 - Signing

6.2.1 - Road posting (9/09)

The Purchaser is responsible for posting and maintaining caution signs on any haul roads prior to beginning operations. The road must be posted at appropriate distances from the sale area to warn of logging activity and truck traffic. Signs must be removed when harvest operations are suspended or completed. The Purchaser will provide these signs.

6.2.3 - Recreational trail posting (2/10)

The Purchaser is responsible for posting and maintaining caution signs on the ORV and snowmobile trails prior to beginning operations. The trail must be posted at appropriate distances from the sale area to warn of logging activity and truck traffic at both ends of the trail. Signs must be removed when harvest operations are suspended or completed. The Purchaser will provide these signs.



Sale Number	Year
61 - 150	17

TIMBER SALE MAP

This information provided by authority of Part 525, 1994 PA 451, as amended.

Forest Management Unit Traverse City	County Kalkaska	Mapped By Crigier	Date 8/22/2017	Page 1	of 1
Township 28N	Range 05W	Section(s) and Subdivision(s) 26: NE1/4, SE1/4, NESW, SENW	Scale 1:15,840		

Cover Type				Density			
A = Aspen	H = Hemlock	N = Marsh	U = Upland Brush	0 = Non Stocked	5 = Pole Timber Medium		
B = Paper Birch	J = Jack Pine	O = Oak	UM = Upland Mixed	1 = Seedling Sapling Poor	6 = Pole Timber Well		
C = Cedar	L = Lowland Brush	P = Lowland Poplar	V = Bog or Marsh	2 = Seedling Sapling Medium	7 = Saw Timber Poor		
D = Treed Bog	LM = Lowland Mixed	Q = Mixed Swamp Conifer	W = White Pine	3 = Seedling Sapling Well	8 = Saw Timber Medium		
E = Swamp Hdwoods	M = Mpl, Bch, Brch	R = Red Pine	X = Non Stocked	4 = Pole Timber Poor	9 = Saw Timber Well		
F = Spruce Fir	MC = Mixed Conifer	S = Black Spruce	Z = Water				
G = Grass	MD = Mixed Deciduous	T = Tamarack					

PU	Acres	PU	Acres
1	3.9	4	29.4
2	13	5	22.8
3	4.9		

Goose Creek Flooding Mix

Compartment 107

74 Acres

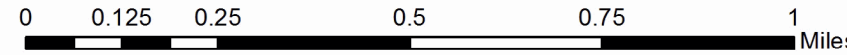
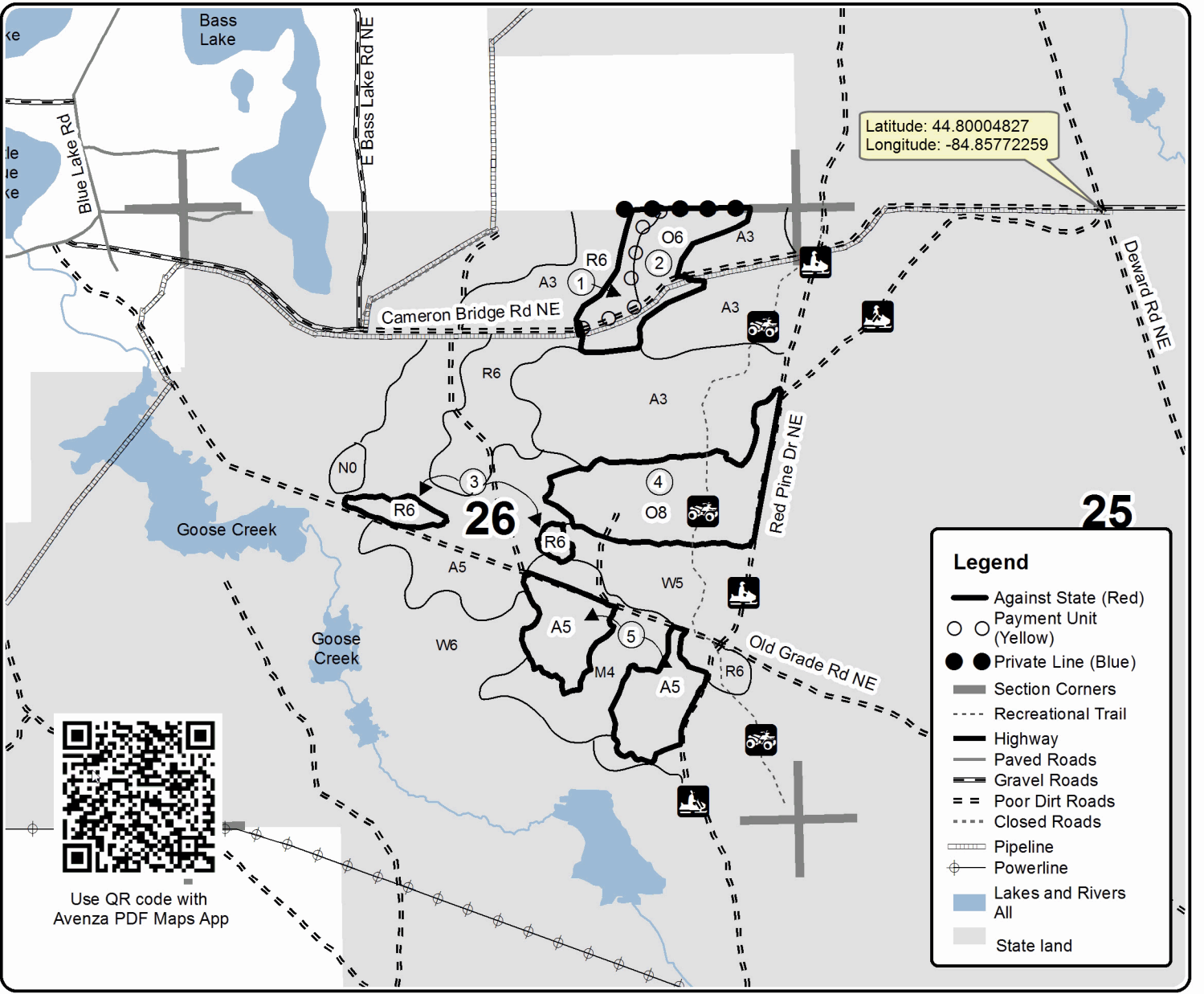

TIMBER SALE INFORMATION

Flowing Well Mix (61-166-17)

Kalkaska County (Advertised Price \$51,383.80)

SALE NOTE: Unit 4 must be chip harvested. Units 5, 6, and 7 must be cut in dry or frozen weather conditions. Crane mats might be needed in various location for skidding across areas of wet ground.

A timber sale contract for this lump sum, sealed bid timber sale will be awarded to the responsible bidder offering the highest sealed bid price. Bids must be at or above the following advertised price for each species:

<u>PRODUCTS & SPECIES</u>	<u>ESTIMATED UNITS*</u>		<u>ADVERTISED PRICE</u>
Sawtimber			
Basswood	1.00	MBF	\$ 93.00 / MBF
Black Cherry	27.10	MBF	\$ 167.00 / MBF
Mixed Aspen	86.30	MBF	\$ 93.00 / MBF
Paper Birch	6.00	MBF	\$ 25.00 / MBF
Red Maple	46.20	MBF	\$ 110.00 / MBF
Red Pine	8.80	MBF	\$ 98.00 / MBF
Sugar Maple	0.80	MBF	\$ 242.00 / MBF
White Pine	39.80	MBF	\$ 57.00 / MBF
Pulpwood			
Balsam Fir	233.00	Cords	\$ 11.75 / Cord
Jack Pine	3.00	Cords	\$ 11.60 / Cord
Mixed Aspen	740.00	Cords	\$ 16.80 / Cord
Mixed Hardwood	738.00	Cords	\$ 15.60 / Cord
Mixed Spruce	10.00	Cords	\$ 21.20 / Cord
Red Pine	20.00	Cords	\$ 32.10 / Cord
Scotch Pine	19.00	Cords	\$ 9.00 / Cord
White Pine	215.00	Cords	\$ 11.35 / Cord

* The total volume is statistically estimated within plus (+) or minus (-) 10.17 percent. The estimated units are final and not subject to adjustment. Prospective bidders are urged to examine this timber and to make their own estimates of quantity and quality.

BOND AND PAYMENT SCHEDULE:

1. A bond in the amount of \$2,569.00 to insure faithful performance of the conditions of the contract will be deposited by the successful bidder within 21 days of the sale award.
2. Cutting in any sale or unit without the required advance payment would be considered a trespass.
3. Total payment must be paid in advance or according to the following schedule:
 - (a) Ten percent (10%) of the sale value must be paid within 21 days of the sale award.
 - (b) The 10% down payment will be credited towards the first unit cut.
4. If no cutting takes place, the 10% down payment will not be refunded.
5. Operations on the contract issued will terminate on 12/31/2020.

Description of Timber by Payment Unit (PU)

PU	MARKET GROUP	PRODUCT	QUANTITY	UNIT	ACRES	ADVERTISE PRICE	
1	Black Cherry	Sawtimber	1.4	MBF	25.0	\$6,859.25	
	Mixed Aspen		21.8	MBF			
	<i>B. T. Aspen</i>		8.3	<i>MBF</i>			
	<i>Quaking Aspen</i>		13.5	<i>MBF</i>			
	Paper Birch		0.5	MBF			
	Red Maple		0.5	MBF			
	White Pine		1.0	MBF			
	Balsam Fir		Pulpwood	39.0			Cords
	Jack Pine			3.0			Cords
	Mixed Aspen			171.0			Cords
	<i>B. T. Aspen</i>			74.0			<i>Cords</i>
	<i>Quaking Aspen</i>			97.0			<i>Cords</i>
	Mixed Hardwood			55.0			Cords
	<i>Black Cherry</i>			34.0			<i>Cords</i>
	<i>Paper Birch</i>			3.0			<i>Cords</i>
	<i>Red Maple</i>			18.0			<i>Cords</i>
	White Pine	22.0		Cords			
2	Black Cherry	Sawtimber	3.0	MBF	13.5	\$7,327.30	
	Mixed Aspen		2.1	MBF			
	<i>B. T. Aspen</i>		2.1	<i>MBF</i>			
	Paper Birch		0.7	MBF			
	Red Maple		22.6	MBF			
	Red Pine		8.8	MBF			
	Sugar Maple		0.8	MBF			
	Balsam Fir		Pulpwood	12.0			Cords
	Mixed Aspen			2.0			Cords
	<i>B. T. Aspen</i>			2.0			<i>Cords</i>
	Mixed Hardwood			148.0			Cords
	<i>Black Cherry</i>			16.0			<i>Cords</i>
	<i>Paper Birch</i>			12.0			<i>Cords</i>
	<i>Red Maple</i>			108.0			<i>Cords</i>
	<i>Sugar Maple</i>			12.0			<i>Cords</i>
	Mixed Spruce			2.0			Cords
	<i>White Spruce</i>	2.0		<i>Cords</i>			
Red Pine	17.0	Cords					
3	Black Cherry	Sawtimber	9.5	MBF	18.1	\$6,072.00	
	Mixed Aspen		0.7	MBF			
	<i>B. T. Aspen</i>		0.7	<i>MBF</i>			
	Red Maple		1.8	MBF			
	White Pine		23.4	MBF			
	Balsam Fir		Pulpwood	6.0			Cords
	Mixed Aspen			7.0			Cords
	<i>B. T. Aspen</i>			2.0			<i>Cords</i>
	<i>Quaking Aspen</i>			5.0			<i>Cords</i>
	Mixed Hardwood			100.0			Cords
	<i>Black Cherry</i>			80.0			<i>Cords</i>
	<i>Red Maple</i>			20.0			<i>Cords</i>
	Red Pine	3.0		Cords			
White Pine	92.0	Cords					
4	Black Cherry	Sawtimber	6.4	MBF	26.2	\$6,134.05	
	Mixed Aspen		1.0	MBF			
	<i>Quaking Aspen</i>		1.0	<i>MBF</i>			
	White Pine		3.9	MBF			
	Balsam Fir		Pulpwood	11.0			Cords
	Mixed Aspen			23.0			Cords
	<i>Cottonwood</i>	2.0	<i>Cords</i>				

Description of Timber by Payment Unit (PU), con't

PU	MARKET GROUP	PRODUCT	QUANTITY	UNIT	ACRES	ADVERTISE PRICE
4 con't	<i>Quaking Aspen</i>	<i>Pulpwood</i>	21.0	<i>Cords</i>		
	Mixed Hardwood		227.0	Cords		
	<i>Black Cherry</i>		167.0	<i>Cords</i>		
	<i>Red Maple</i>		60.0	<i>Cords</i>		
	Scotch Pine		19.0	Cords		
	<i>Scotch Pine</i>	<i>Sawtimber</i>	1.1	<i>MBF</i>		
	<i>Scotch Pine</i>	<i>Pulpwood</i>	17.0	<i>Cords</i>		
	White Pine		46.0	Cords		
5	Mixed Aspen	Sawtimber	9.7	MBF	7.7	\$3,057.85
	<i>Quaking Aspen</i>		9.7	<i>MBF</i>		
	Red Maple		0.3	MBF		
	Balsam Fir	Pulpwood	5.0	Cords		
	Mixed Aspen		108.0	Cords		
	<i>Balsam Poplar</i>		9.0	<i>Cords</i>		
	<i>Quaking Aspen</i>		99.0	<i>Cords</i>		
	Mixed Hardwood		16.0	Cords		
	<i>Black Cherry</i>		7.0	<i>Cords</i>		
	<i>Red Maple</i>		9.0	<i>Cords</i>		
6	Basswood	Sawtimber	1.0	MBF	33.5	\$15,627.25
	Black Cherry		2.5	MBF		
	Mixed Aspen		48.0	MBF		
	<i>Quaking Aspen</i>		48.0	<i>MBF</i>		
	Paper Birch		1.0	MBF		
	Red Maple		3.2	MBF		
	White Pine		10.4	MBF		
	Balsam Fir	Pulpwood	135.0	Cords		
	Mixed Aspen		361.0	Cords		
	<i>Quaking Aspen</i>		361.0	<i>Cords</i>		
	Mixed Hardwood		83.0	Cords		
	<i>Basswood</i>		2.0	<i>Cords</i>		
	<i>Black Cherry</i>		62.0	<i>Cords</i>		
	<i>Paper Birch</i>		2.0	<i>Cords</i>		
	<i>Red Maple</i>		17.0	<i>Cords</i>		
	Mixed Spruce		8.0	Cords		
	<i>Black Spruce</i>		8.0	<i>Cords</i>		
	White Pine		50.0	Cords		
7	Black Cherry	Sawtimber	4.3	MBF	11.0	\$6,306.10
	Mixed Aspen		3.0	MBF		
	<i>Quaking Aspen</i>		3.0	<i>MBF</i>		
	Paper Birch		3.8	MBF		
	Red Maple		17.8	MBF		
	White Pine		1.1	MBF		
	Balsam Fir	Pulpwood	25.0	Cords		
	Mixed Aspen		68.0	Cords		
	<i>Quaking Aspen</i>		68.0	<i>Cords</i>		
	Mixed Hardwood		109.0	Cords		
	<i>Black Cherry</i>		32.0	<i>Cords</i>		
	<i>Paper Birch</i>		16.0	<i>Cords</i>		
	<i>Red Maple</i>		61.0	<i>Cords</i>		
White Pine		5.0	Cords			
TOTAL:			216.0	MBF		
TOTAL:			1,978.0	Cords		

Sale Specific Conditions & Requirements

Sale Name: Flowing Well Mix

Sale Number: 61-166-17 Seq#: 1

1 - Sale Area

1.2 - Boundaries

1.2.1 - Painted boundaries (1/14)

The sale boundary and Payment Unit boundaries are marked and identified by red and yellow paint. Exterior sale boundary lines against state are marked with red paint. Interior Payment Unit boundaries are marked with yellow paint. The painted boundary line trees are not Included Timber and are to be protected.

2 - Timber Specifications

2.1 - Included Timber

2.1.1 - Clearcut unit(s) with unmerchantable trees (6/14)

Within Payment Unit(s) 1, 5, 6, 7b, cut all trees that are two (2) inches or more at DBH except do not cut cedar, hemlock, oak, trees marked with green paint, and white pine less than 4" in diameter.

Within Payment Unit(s) 4, cut all trees regardless of merchantability.

2.1.3 - Cut tree marked unit(s) (12/08)

Within Payment Unit(s) 2 and 7a, all trees are designated for cutting when marked with orange paint above and below stump height, regardless of merchantability. In addition, cut all aspen, balsam fir, and, spruce. Also cut paper birch that is greater than 6" in diameter (unless it is marked with an orange 'X').

Within Payment Unit(s) 3, cut all trees marked with orange paint. In addition, cut all cherry (unless marked with and orange 'X'), balsam fir, spruce, aspen, and ironwood that are greater than 4" in diameter.

2.2 - Utilization

2.2.2 - Chipping required (5/14)

Payment Unit 4 must be chip harvested to facilitate subsequent planting operations. The Purchaser has the option to produce sawlogs or pulpwood bolts, but the remaining portion of the trees must be chipped and hauled. Do not chip 1/6 to 1/3 of the slash from harvested trees (tree tops and limbs less than four inches in diameter).

2.2.3 - Stump heights (4/07)

Stump heights within Payment Unit(s) 4 shall not exceed 6 inches for all trees. This is in order to facilitate planting operations.

3 - Payments

3.4 - Damaged Timber

3.4.1 - Damaged timber (6/14)

General Condition and Requirement 3.4 Damaged Timber, defines liquidated damages for undesignated live merchantable trees which are cut or injured. In addition, extreme care should be taken to avoid damage to tree seedlings and saplings.

Within the sale area, if more than 25% of the tree seedlings or saplings (1/4" to 4.5" DBH) within a specified portion of the sale area are damaged, liquidated damages will be assessed at \$200 per acre for all acreage within that specified portion of the sale area that was damaged.

No damage is acceptable to merchantable trees. Within the sale area, if more than 10% of trees (> 4.5" DBH) within a specified area of the sale are damaged, liquidated damages will be assessed for all trees damaged. Rates will be in accordance with General Condition and Requirement 3.4 Damaged Timber.

4 - Transportation

4.1 - Construction

4.1.6 - Road construction (1/09)

Construction of new roads or improvements of existing roads shall be done in such a way as to minimize the environmental and visual impacts. Merchantable trees shall be cut and utilized unless otherwise directed. Non-merchantable trees shall be severed and laid flat on the ground. Slash shall be scattered, and not left in windrows and kept a minimum of 10 feet back from the road edge. Stumps shall be set upright, not left on edge, and be moved at least 10 feet away from the road edge. Disturbed soil shall be feathered into the woods and not left in berms or windrows.

4.1.7 - Road closure (10/11)

All new roads built into the sale must be blocked to vehicle traffic within 30 days of completion of hauling. Overgrown roads that are reopened shall be considered new roads. In general, this will require constructing a four (4') foot high berm of stumps and logs covered with earth. Stumps and brush must be placed along the remainder of the trail. These roads must be rendered impassable to cars and trucks. Contact the sale administrator for specific details of design and placement.

5 - Operations

5.2 - Conduct of Operations

5.2.1 - Slash

5.2.1.8 - Slash height (12/08)

No slash or tree tops may exceed 36 inches in height.

5.2.2 - Hazard Trees/Snags

5.2.2.1 - Den trees (10/16)

Obvious hollow and/or den trees shall be protected and left standing unless they are a safety hazard.

5.2.3 - Operating Restrictions

5.2.3.1 - Operating restrictions (9/11)

Within Payment Unit(s) 5, 6, and 7, unless changed by written agreement, cutting and skidding are limited to dry or frozen ground conditions at the sale administrators approval. This restriction is because of wet ground conditions within these payment units.

5.2.3.3 - Bark slippage restriction (3/09)

Within Payment Unit(s) 2, cutting and skidding are not permitted during the period of April 15 to July 15. This restriction is because of bark slippage.

5.2.17 - Crane Mats/Timber Mats (9/17)

Some roads or skid trails may require extra protection such as that afforded by Crane Mats/Timber Mats. If available, Crane Mats/Timber Mats may be borrowed from the DNR and are located at the Marquette ICC, the Newberry Field Office and the Grayling Field Office. Contact the sale administrator for specific details. A Timber Sale Contract Supplement will be used to document the Purchaser's use of the DNR's Crane Mats/Timber Mats. It is the responsibility of the Purchaser to contact the sale administrator to schedule pick up and drop off. In addition, all mats must be cleaned prior to drop off. A charge of \$350.00 will be assessed for all damaged or non-returned mats. Damage is defined as misuse resulting in three or more broken cants.

5.2.29 - Shrub protection (9/07)

Do not cut or damage hawthorn, witch-hazel, dogwood or junberry. These woody-shrub plants are highly beneficial to various wildlife species.

5.2.32 - Decking/landing restoration (9/13)

All decking and landing areas must have the surface area restored to a condition equal to or better than before. This is to ensure the proper regeneration of the stand.

5.3 - Stream Protection

5.3.1 - Operating near stream (7/04)

No tracked or wheeled vehicles shall be operated within 50 feet of the Manistee River and Morrison Creek, except at an approved crossing.

5.4 - Soil Protection

5.4.1 - Rutting restriction, general (7/16)

Operations are to cease immediately if equipment and weather conditions result in rutting of roads and/or skid trails which is 12 inches or greater in depth and 50 feet in length. The Unit Manager or his/her representative may restrict hauling and/or skidding if ruts exceed the specified depth. With the Unit Manager or his/her representative's approval, the Purchaser may return to the area when the risk of rutting has decreased.

5.4.6 - Wet area protection (5/10)

No harvesting operations, including skidding and felling, are to take place within the vernal pond areas or drainages. When harvesting occurs, there should be no disturbance to the vernal pond depression. All equipment, trees and tops should be kept out of this area. Within 50 feet of the pond, equipment should only be used when the soil is in a dry or frozen condition. Care must be taken by the Purchaser to identify and avoid operating in these areas of the timber sale.

5.8 - Protection of Endangered Species

5.8.5 - Protection of raptor nests (3/13)

All trees with raptor nests will be protected if found during harvesting operations. Notification will be made to the Unit Manager or his/her representative who will notify the Wildlife Biologist so an on-site evaluation and recommendation can be made, if necessary.

6 - Safety and Fire Prevention

6.2 - Signing

6.2.1 - Road posting (9/09)

The Purchaser is responsible for posting and maintaining caution signs on Flowing Well Rd prior to beginning operations. The road must be posted at appropriate distances from the sale area to warn of logging activity and truck traffic. Signs must be removed when harvest operations are suspended or completed. The Purchaser will provide these signs.

Monster Stump Rally (61-135-17)
; Kalkaska COUNTY

In response to the notice of sale to be held 4:00 p.m. (local time) on November 20, 2017, I am hereby submitting my sealed bid (firm offer) for the following forest products to be cut. Bids for individual species must be at or above the advertised price. All non-responsive bid forms may be rejected.

<u>PRODUCTS & SPECIES</u>	<u>ESTIMATED VOLUME*</u>	<u>ADVERTISED PRICE</u>	<u>BID PRICE/UNIT</u>
Sawtimber			
Red Pine	70.20 MBF	\$ 122.00/MBF	\$ _____
White Pine	51.30 MBF	\$ 71.00/MBF	\$ _____
Pulpwood			
Balsam Fir	51.00 Cords	\$ 14.70/Cord	\$ _____
Black Spruce	23.00 Cords	\$ 26.50/Cord	\$ _____
Jack Pine	60.00 Cords	\$ 14.55/Cord	\$ _____
Mixed Aspen	2,532.00 Cords	\$ 21.00/Cord	\$ _____
Mixed Hardwood	312.00 Cords	\$ 19.45/Cord	\$ _____
Red Oak	12.00 Cords	\$ 13.15/Cord	\$ _____
Red Pine	93.00 Cords	\$ 40.15/Cord	\$ _____
Tamarack	10.00 Cords	\$ 35.55/Cord	\$ _____
White Pine	369.00 Cords	\$ 14.20/Cord	\$ _____

*The volumes are statistically estimated within plus (+) or minus (-) 10.16 percent. These estimated volumes are final and not subject to adjustment. Prospective bidders are urged to examine this timber and to make their own estimates of quantity and quality.

I understand that any or all bids may be rejected. All bids must be signed and all bid items must be bid or the bid form may be rejected. I also understand that consideration and awarding a contract will be based upon my past performance and ability to complete the contract based upon equipment and staffing subject to my control.

FEDERAL ID: _____ or SOCIAL SECURITY NUMBER: _____

Company or individual bidding: _____

Company representative's name: _____

Address: _____

City: _____ State: _____ Zip: _____

IF AVAILABLE, PLEASE PLACE THE PERSONALIZED LABEL FROM YOUR PROSPECTUS IN THE ABOVE BOX.

Individual or company representative's signature: _____ Date: _____

Phone number : _____ Email (optional): _____

THE WINNING BIDDER MUST COMPLETE THE VERIFICATION OF WORKER'S DISABILITY COMPENSATION ACT COMPLIANCE (ON REVERSE SIDE IF DOUBLE SIDED) WITHIN 21 DAYS OF SALE AWARD DATE



FOR DEPARTMENT USE ONLY
Sale Number (XX - XXX - XX - XX)
Forest Management Unit:

TIMBER SALE VERIFICATION OF WORKER'S DISABILITY COMPENSATION ACT COMPLIANCE

*As required by Act 317, P.A. 1969 (Worker's Compensation) and
Part 5 of Act 451 of 1994, as amended.*

VERIFICATION OF WORKER'S DISABILITY COMPENSATION ACT COMPLIANCE

- This verification must be completed and submitted within 21 days of contract award and prior to the issuance of the timber sale contract.
- In addition, if boxes 2B or 2C are checked, then Notice of Exclusion or Certificate of Insurance must be submitted within twenty-one (21) days of the contract award and prior to the issuance of the timber sale contract.
- All information must be typed or printed except for written signatures.

Please Check Appropriate Categories:

1. My business is organized as (you **must** check one of the boxes below):
 - A. Sole Proprietorship (individual)
 - B. Partnership
 - C. Corporation

2. You **must** check one of the boxes below:
 - A. I certify my business is a sole proprietorship and it has no employees but the sole proprietor. I am not subject to the Worker's Compensation Laws.
 - B. I certify my business has satisfied its obligation to the Worker's Compensation Act through the use of an approved Notice of Exclusion (BWC-337, Rev. 5/96). I will provide a copy of the Notice of Exclusion within 21 days of the contract award. (For questions or a copy of the BWC-337, please call the Worker's Compensation Bureau at 517-322-1195).
 - C. I certify my business has a Worker's Compensation Policy. I will provide an original Certificate of Insurance within twenty-one (21) days of the contract award.

3. If you have checked item 2(A) or 2(B), you **must** indicate the number of **both** full-time and part-time employees, other than yourself, including family members and active partners (if none, you must enter "0").

_____ Full-time Employees

_____ Part-time Employees

Name of Business		Federal ID (or) Social Security No.	
Address		Telephone ()	
City	State	ZIP	

I hereby certify that the above information is true and correct. I agree to notify the Michigan DNR of any changes that occur in factors affecting my coverage during any of my present and future operations.

Signature of Owner or Authorized Representative

Title

Date

Please complete the "SEALED BID" information on the next page

Trees and Trails (61-139-17)
; Kalkaska COUNTY

In response to the notice of sale to be held 4:00 p.m. (local time) on November 20, 2017, I am hereby submitting my sealed bid (firm offer) for the following forest products to be cut. Bids for individual species must be at or above the advertised price. All non-responsive bid forms may be rejected.

<u>PRODUCTS & SPECIES</u>	<u>ESTIMATED VOLUME*</u>	<u>ADVERTISED PRICE</u>	<u>BID PRICE/UNIT</u>
Sawtimber			
Red Maple	6.50 MBF	\$ 110.00/MBF	\$ _____
Red Oak	335.50 MBF	\$ 140.00/MBF	\$ _____
Red Pine	11.40 MBF	\$ 98.00/MBF	\$ _____
Pulpwood			
B. T. Aspen	8.00 Cords	\$ 16.80/Cord	\$ _____
Jack Pine	14.00 Cords	\$ 11.60/Cord	\$ _____
Misc. Species 1	14.00 Cords	\$ 3.00/Cord	\$ _____
Mixed Hardwood	83.00 Cords	\$ 15.60/Cord	\$ _____
Red Oak	667.00 Cords	\$ 10.50/Cord	\$ _____
Red Pine	13.00 Cords	\$ 32.10/Cord	\$ _____
White Pine	4.00 Cords	\$ 11.35/Cord	\$ _____

*The volumes are statistically estimated within plus (+) or minus (-) 12.21 percent. These estimated volumes are final and not subject to adjustment. Prospective bidders are urged to examine this timber and to make their own estimates of quantity and quality.

I understand that any or all bids may be rejected. All bids must be signed and all bid items must be bid or the bid form may be rejected. I also understand that consideration and awarding a contract will be based upon my past performance and ability to complete the contract based upon equipment and staffing subject to my control.

FEDERAL ID: _____ or SOCIAL SECURITY NUMBER: _____

Company or individual bidding: _____

Company representative's name: _____

Address: _____

City: _____ State: _____ Zip: _____

IF AVAILABLE, PLEASE PLACE THE PERSONALIZED LABEL FROM YOUR PROSPECTUS IN THE ABOVE BOX.

Individual or company representative's signature: _____ Date: _____

Phone number : _____ Email (optional): _____

THE WINNING BIDDER MUST COMPLETE THE VERIFICATION OF WORKER'S DISABILITY COMPENSATION ACT COMPLIANCE (ON REVERSE SIDE IF DOUBLE SIDED) WITHIN 21 DAYS OF SALE AWARD DATE



FOR DEPARTMENT USE ONLY	
Sale Number (XX - XXX - XX - XX)	
Forest Management Unit:	

TIMBER SALE VERIFICATION OF WORKER'S DISABILITY COMPENSATION ACT COMPLIANCE

As required by Act 317, P.A. 1969 (Worker's Compensation) and
Part 5 of Act 451 of 1994, as amended.

VERIFICATION OF WORKER'S DISABILITY COMPENSATION ACT COMPLIANCE

- This verification must be completed and submitted within 21 days of contract award and prior to the issuance of the timber sale contract.
- In addition, if boxes 2B or 2C are checked, then Notice of Exclusion or Certificate of Insurance must be submitted within twenty-one (21) days of the contract award and prior to the issuance of the timber sale contract.
- All information must be typed or printed except for written signatures.

Please Check Appropriate Categories:

1. My business is organized as (you **must** check one of the boxes below):
 - A. Sole Proprietorship (individual)
 - B. Partnership
 - C. Corporation
2. You **must** check one of the boxes below:
 - A. I certify my business is a sole proprietorship and it has no employees but the sole proprietor. I am not subject to the Worker's Compensation Laws.
 - B. I certify my business has satisfied its obligation to the Worker's Compensation Act through the use of an approved Notice of Exclusion (BWC-337, Rev. 5/96). I will provide a copy of the Notice of Exclusion within 21 days of the contract award. (For questions or a copy of the BWC-337, please call the Worker's Compensation Bureau at 517-322-1195).
 - C. I certify my business has a Worker's Compensation Policy. I will provide an original Certificate of Insurance within twenty-one (21) days of the contract award.
3. If you have checked item 2(A) or 2(B), you **must** indicate the number of **both** full-time and part-time employees, other than yourself, including family members and active partners (if none, you must enter "0").

_____ Full-time Employees

_____ Part-time Employees

Name of Business		Federal ID (or) Social Security No.	
Address		Telephone ()	
City	State	ZIP	

I hereby certify that the above information is true and correct. I agree to notify the Michigan DNR of any changes that occur in factors affecting my coverage during any of my present and future operations.

Signature of Owner or Authorized Representative

Title

Date

Please complete the "SEALED BID" information on the next page

Goose Creek Flooding Mix (61-150-17)
; Kalkaska COUNTY

In response to the notice of sale to be held 4:00 p.m. (local time) on November 20, 2017, I am hereby submitting my sealed bid (firm offer) for the following forest products to be cut. Bids for individual species must be at or above the advertised price. All non-responsive bid forms may be rejected.

<u>PRODUCTS & SPECIES</u>	<u>ESTIMATED VOLUME*</u>	<u>ADVERTISED PRICE</u>	<u>BID PRICE/UNIT</u>
Sawtimber			
BI/R/Hybrid Oak	2.20 MBF	\$ 104.00/MBF	\$ _____
Mixed Aspen	10.50 MBF	\$ 108.00/MBF	\$ _____
Red Maple	3.10 MBF	\$ 129.00/MBF	\$ _____
Red Oak	157.40 MBF	\$ 163.00/MBF	\$ _____
Red Pine	65.00 MBF	\$ 114.00/MBF	\$ _____
White Oak	1.60 MBF	\$ 56.00/MBF	\$ _____
White Pine	16.50 MBF	\$ 67.00/MBF	\$ _____
Pulpwood			
Jack Pine	2.00 Cords	\$ 13.55/Cord	\$ _____
Mixed Aspen	174.00 Cords	\$ 19.60/Cord	\$ _____
Mixed Hardwood	183.00 Cords	\$ 18.15/Cord	\$ _____
Mixed Oak	380.00 Cords	\$ 12.25/Cord	\$ _____
Red Pine	118.00 Cords	\$ 37.45/Cord	\$ _____
White Pine	54.00 Cords	\$ 13.25/Cord	\$ _____

*The volumes are statistically estimated within plus (+) or minus (-) 11.73 percent. These estimated volumes are final and not subject to adjustment. Prospective bidders are urged to examine this timber and to make their own estimates of quantity and quality.

I understand that any or all bids may be rejected. All bids must be signed and all bid items must be bid or the bid form may be rejected. I also understand that consideration and awarding a contract will be based upon my past performance and ability to complete the contract based upon equipment and staffing subject to my control.

FEDERAL ID: _____ or SOCIAL SECURITY NUMBER: _____

Company or individual bidding: _____

Company representative's name: _____

Address: _____

City: _____ State: _____ Zip: _____

IF AVAILABLE, PLEASE PLACE THE PERSONALIZED LABEL FROM YOUR PROSPECTUS IN THE ABOVE BOX.

Individual or company representative's signature: _____ Date: _____

Phone number : _____ Email (optional): _____

THE WINNING BIDDER MUST COMPLETE THE VERIFICATION OF WORKER'S DISABILITY COMPENSATION ACT COMPLIANCE (ON REVERSE SIDE IF DOUBLE SIDED) WITHIN 21 DAYS OF SALE AWARD DATE



FOR DEPARTMENT USE ONLY
Sale Number (XX - XXX - XX - XX)
Forest Management Unit:

TIMBER SALE VERIFICATION OF WORKER'S DISABILITY COMPENSATION ACT COMPLIANCE

*As required by Act 317, P.A. 1969 (Worker's Compensation) and
Part 5 of Act 451 of 1994, as amended.*

VERIFICATION OF WORKER'S DISABILITY COMPENSATION ACT COMPLIANCE

- This verification must be completed and submitted within 21 days of contract award and prior to the issuance of the timber sale contract.
- In addition, if boxes 2B or 2C are checked, then Notice of Exclusion or Certificate of Insurance must be submitted within twenty-one (21) days of the contract award and prior to the issuance of the timber sale contract.
- All information must be typed or printed except for written signatures.

Please Check Appropriate Categories:

1. My business is organized as (you **must** check one of the boxes below):
 - A. Sole Proprietorship (individual)
 - B. Partnership
 - C. Corporation

2. You **must** check one of the boxes below:
 - A. I certify my business is a sole proprietorship and it has no employees but the sole proprietor. I am not subject to the Worker's Compensation Laws.
 - B. I certify my business has satisfied its obligation to the Worker's Compensation Act through the use of an approved Notice of Exclusion (BWC-337, Rev. 5/96). I will provide a copy of the Notice of Exclusion within 21 days of the contract award. (For questions or a copy of the BWC-337, please call the Worker's Compensation Bureau at 517-322-1195).
 - C. I certify my business has a Worker's Compensation Policy. I will provide an original Certificate of Insurance within twenty-one (21) days of the contract award.

3. If you have checked item 2(A) or 2(B), you **must** indicate the number of **both** full-time and part-time employees, other than yourself, including family members and active partners (if none, you must enter "0").

_____ Full-time Employees

_____ Part-time Employees

Name of Business		Federal ID (or) Social Security No.	
Address		Telephone ()	
City	State	ZIP	

I hereby certify that the above information is true and correct. I agree to notify the Michigan DNR of any changes that occur in factors affecting my coverage during any of my present and future operations.

Signature of Owner or Authorized Representative

Title

Date

Please complete the "SEALED BID" information on the next page

Flowing Well Mix (61-166-17)
; Kalkaska COUNTY

In response to the notice of sale to be held 4:00 p.m. (local time) on November 20, 2017, I am hereby submitting my sealed bid (firm offer) for the following forest products to be cut. Bids for individual species must be at or above the advertised price. All non-responsive bid forms may be rejected.

<u>PRODUCTS & SPECIES</u>	<u>ESTIMATED VOLUME*</u>	<u>ADVERTISED PRICE</u>	<u>BID PRICE/UNIT</u>
Sawtimber			
Basswood	1.00 MBF	\$ 93.00/MBF	\$ _____
Black Cherry	27.10 MBF	\$ 167.00/MBF	\$ _____
Mixed Aspen	86.30 MBF	\$ 93.00/MBF	\$ _____
Paper Birch	6.00 MBF	\$ 25.00/MBF	\$ _____
Red Maple	46.20 MBF	\$ 110.00/MBF	\$ _____
Red Pine	8.80 MBF	\$ 98.00/MBF	\$ _____
Sugar Maple	0.80 MBF	\$ 242.00/MBF	\$ _____
White Pine	39.80 MBF	\$ 57.00/MBF	\$ _____
Pulpwood			
Balsam Fir	233.00 Cords	\$ 11.75/Cord	\$ _____
Jack Pine	3.00 Cords	\$ 11.60/Cord	\$ _____
Mixed Aspen	740.00 Cords	\$ 16.80/Cord	\$ _____
Mixed Hardwood	738.00 Cords	\$ 15.60/Cord	\$ _____
Mixed Spruce	10.00 Cords	\$ 21.20/Cord	\$ _____
Red Pine	20.00 Cords	\$ 32.10/Cord	\$ _____
Scotch Pine	19.00 Cords	\$ 9.00/Cord	\$ _____
White Pine	215.00 Cords	\$ 11.35/Cord	\$ _____

*The volumes are statistically estimated within plus (+) or minus (-) 10.17 percent. These estimated volumes are final and not subject to adjustment. Prospective bidders are urged to examine this timber and to make their own estimates of quantity and quality.

I understand that any or all bids may be rejected. All bids must be signed and all bid items must be bid or the bid form may be rejected. I also understand that consideration and awarding a contract will be based upon my past performance and ability to complete the contract based upon equipment and staffing subject to my control.

FEDERAL ID: ____ - ____ - ____ or SOCIAL SECURITY NUMBER: ____ - ____ - ____

Company or individual bidding: _____

Company representative's name: _____

Address: _____

City: _____ State: _____ Zip: _____

IF AVAILABLE, PLEASE PLACE THE PERSONALIZED LABEL FROM YOUR PROSPECTUS IN THE ABOVE BOX.

Individual or company representative's signature: _____ Date: _____

Phone number : _____ Email (optional): _____

THE WINNING BIDDER MUST COMPLETE THE VERIFICATION OF WORKER'S DISABILITY COMPENSATION ACT COMPLIANCE (ON REVERSE SIDE IF DOUBLE SIDED) WITHIN 21 DAYS OF SALE AWARD DATE



FOR DEPARTMENT USE ONLY
Sale Number (XX - XXX - XX - XX)
Forest Management Unit:

TIMBER SALE VERIFICATION OF WORKER'S DISABILITY COMPENSATION ACT COMPLIANCE

*As required by Act 317, P.A. 1969 (Worker's Compensation) and
Part 5 of Act 451 of 1994, as amended.*

VERIFICATION OF WORKER'S DISABILITY COMPENSATION ACT COMPLIANCE

- This verification must be completed and submitted within 21 days of contract award and prior to the issuance of the timber sale contract.
- In addition, if boxes 2B or 2C are checked, then Notice of Exclusion or Certificate of Insurance must be submitted within twenty-one (21) days of the contract award and prior to the issuance of the timber sale contract.
- All information must be typed or printed except for written signatures.

Please Check Appropriate Categories:

1. My business is organized as (you **must** check one of the boxes below):
 - A. Sole Proprietorship (individual)
 - B. Partnership
 - C. Corporation
2. You **must** check one of the boxes below:
 - A. I certify my business is a sole proprietorship and it has no employees but the sole proprietor. I am not subject to the Worker's Compensation Laws.
 - B. I certify my business has satisfied its obligation to the Worker's Compensation Act through the use of an approved Notice of Exclusion (BWC-337, Rev. 5/96). I will provide a copy of the Notice of Exclusion within 21 days of the contract award. (For questions or a copy of the BWC-337, please call the Worker's Compensation Bureau at 517-322-1195).
 - C. I certify my business has a Worker's Compensation Policy. I will provide an original Certificate of Insurance within twenty-one (21) days of the contract award.
3. If you have checked item 2(A) or 2(B), you **must** indicate the number of **both** full-time and part-time employees, other than yourself, including family members and active partners (if none, you must enter "0").

_____ Full-time Employees

_____ Part-time Employees

Name of Business		Federal ID (or) Social Security No.	
Address		Telephone ()	
City	State	ZIP	

I hereby certify that the above information is true and correct. I agree to notify the Michigan DNR of any changes that occur in factors affecting my coverage during any of my present and future operations.

Signature of Owner or Authorized Representative

Title

Date

Please complete the "SEALED BID" information on the next page

Marji Aspen (61-128-17)
; Kalkaska COUNTY

In response to the notice of sale to be held 4:00 p.m. (local time) on November 20, 2017, I am hereby submitting my sealed bid (firm offer) for the following forest products to be cut. Bids for individual species must be at or above the advertised price. All non-responsive bid forms may be rejected.

<u>PRODUCTS & SPECIES</u>	<u>ESTIMATED VOLUME*</u>	<u>ADVERTISED PRICE</u>	<u>BID PRICE/UNIT</u>
Sawtimber			
Black Cherry	15.20 MBF	\$ 208.00/MBF	\$ _____
Mixed Aspen	52.10 MBF	\$ 116.00/MBF	\$ _____
Red Maple	55.20 MBF	\$ 138.00/MBF	\$ _____
White Pine	1.40 MBF	\$ 71.00/MBF	\$ _____
Pulpwood			
Balsam Fir	370.00 Cords	\$ 14.70/Cord	\$ _____
Mixed Aspen	639.00 Cords	\$ 21.00/Cord	\$ _____
Mixed Hardwood	802.00 Cords	\$ 19.45/Cord	\$ _____
Paper Birch	20.00 Cords	\$ 19.85/Cord	\$ _____
Red Oak	4.00 Cords	\$ 13.15/Cord	\$ _____
White Pine	20.00 Cords	\$ 14.20/Cord	\$ _____
White Spruce	14.00 Cords	\$ 26.50/Cord	\$ _____

*The volumes are statistically estimated within plus (+) or minus (-) 12.30 percent. These estimated volumes are final and not subject to adjustment. Prospective bidders are urged to examine this timber and to make their own estimates of quantity and quality.

I understand that any or all bids may be rejected. All bids must be signed and all bid items must be bid or the bid form may be rejected. I also understand that consideration and awarding a contract will be based upon my past performance and ability to complete the contract based upon equipment and staffing subject to my control.

FEDERAL ID: _____ or SOCIAL SECURITY NUMBER: _____

Company or individual bidding: _____

Company representative's name: _____

Address: _____

City: _____ State: _____ Zip: _____

IF AVAILABLE, PLEASE PLACE THE PERSONALIZED LABEL FROM YOUR PROSPECTUS IN THE ABOVE BOX.

Individual or company representative's signature: _____ Date: _____

Phone number : _____ Email (optional): _____

THE WINNING BIDDER MUST COMPLETE THE VERIFICATION OF WORKER'S DISABILITY COMPENSATION ACT COMPLIANCE (ON REVERSE SIDE IF DOUBLE SIDED) WITHIN 21 DAYS OF SALE AWARD DATE



FOR DEPARTMENT USE ONLY	
Sale Number (XX - XXX - XX - XX)	
Forest Management Unit:	

TIMBER SALE VERIFICATION OF WORKER'S DISABILITY COMPENSATION ACT COMPLIANCE

As required by Act 317, P.A. 1969 (Worker's Compensation) and
Part 5 of Act 451 of 1994, as amended.

VERIFICATION OF WORKER'S DISABILITY COMPENSATION ACT COMPLIANCE

- This verification must be completed and submitted within 21 days of contract award and prior to the issuance of the timber sale contract.
- In addition, if boxes 2B or 2C are checked, then Notice of Exclusion or Certificate of Insurance must be submitted within twenty-one (21) days of the contract award and prior to the issuance of the timber sale contract.
- All information must be typed or printed except for written signatures.

Please Check Appropriate Categories:

1. My business is organized as (you **must** check one of the boxes below):
 - A. Sole Proprietorship (individual)
 - B. Partnership
 - C. Corporation
2. You **must** check one of the boxes below:
 - A. I certify my business is a sole proprietorship and it has no employees but the sole proprietor. I am not subject to the Worker's Compensation Laws.
 - B. I certify my business has satisfied its obligation to the Worker's Compensation Act through the use of an approved Notice of Exclusion (BWC-337, Rev. 5/96). I will provide a copy of the Notice of Exclusion within 21 days of the contract award. (For questions or a copy of the BWC-337, please call the Worker's Compensation Bureau at 517-322-1195).
 - C. I certify my business has a Worker's Compensation Policy. I will provide an original Certificate of Insurance within twenty-one (21) days of the contract award.
3. If you have checked item 2(A) or 2(B), you **must** indicate the number of **both** full-time and part-time employees, other than yourself, including family members and active partners (if none, you must enter "0").

_____ Full-time Employees

_____ Part-time Employees

Name of Business		Federal ID (or) Social Security No.	
Address		Telephone ()	
City	State	ZIP	

I hereby certify that the above information is true and correct. I agree to notify the Michigan DNR of any changes that occur in factors affecting my coverage during any of my present and future operations.

Signature of Owner or Authorized Representative

Title

Date

Please complete the "SEALED BID" information on the next page