



**DEPARTMENT OF NATURAL RESOURCES
STATE OF MICHIGAN
TIMBER SALE PROSPECTUS #7559**

SCHEDULED SALE DATE AND TIME: 10:00 a.m. (local time) on April 22, 2025.

LOCATION: ATLANTA MGMT UNIT, 13501 M 33, ATLANTA, MI 49709.

PROSPECTUS NOTE: The bidder is advised to inspect the sale area and review the location, estimated volumes, operating costs and contract terms of proposed sales. Please be aware that some landowners may request 60 days or more notice for access across their land.

Notice is hereby given that bids will be received by the Unit Manager, ATLANTA MANAGEMENT UNIT, for certain timber on the following described lands:

Sheridan & 489 East Aspen Oak (54-006-24) / T29N, R02E, SEC. 4 , NENW,S1/2NW,W1/2NE,SW.

T29N, R02E, SEC. 5 , SENE,E1/2SE.

Montmorency County, Advertised Price \$146,765.30, 173.7 Acres, Hardwood, Red Oak.

SALE NOTE: 2.2.2 - Chipping required- Payment Units 7-8

5.1.3 - Well heads and natural gas pipelines

5.1.6 - Utility R.O.W.

5.2.1.11 - Slash for reforestation- Payment Units 4-6

5.2.3.5 - Oak wilt restriction- All Payment Units

5.2.39 - ORV trail/route protection

A recreation site such as a trail, pathway, or campground is within the sale area or the vicinity. Certain restrictions/specifications may be applicable including time restrictions.

Sheridan & 489 North Aspen Oak (54-007-24) / T29N, R02E, SEC. 5 , N1/2SE,SWSE.

T29N, R02E, SEC. 5 , NW,NWNE,S1/2NE,N1/2SW,SWSW.

T29N, R02E, SEC. 6 , N1/2SE.

T29N, R02E, SEC. 6 , NENW,S1/2NW,NENE,S1/2NE,NESW.

Montmorency County, Advertised Price \$208,982.35, 223.7 Acres, Aspen, Hardwood.

SALE NOTE: 5.1.3 - Well heads and natural gas pipelines- All Payment Units

5.1.6 - Utility R.O.W.- Payment Unit 9

5.2.1.11 - Slash for reforestation- Payment Units 11-12

5.2.3.3 - Bark slippage restriction- Payment Unit 13

5.2.3.5 - Oak wilt restriction- Payment Units 1-12

5.2.3.4 - Oak Wilt Restriction, No Exceptions- Payment Unit 13

Bearly Aspen (54-029-24) / T34N, R07E, SEC. 29, SENW,NESW,NWSE.

T34N, R07E, SEC. 32, W1/2NE.

Presque Isle County, Advertised Price \$6,575.50, 28.6 Acres, Aspen, Hardwood.

SALE NOTE: There are special protection trees in Payment Unit 1. Refer to sale spec 3.4.2 for details.

BID INSTRUCTIONS (VER. 10/10/2022):

1. Scheduled Bid Location, Date, and Time (2/11)

Bids must be received by the Unit Manager, ATLANTA OFFICE, 13501 M 33, ATLANTA, MI 49709, no later than 10:00 a.m. (local time) on April 22, 2025. For further information concerning this sale, contact Matt Foster at 989-619-5921 extension .

2. Bidder's Qualifications (10/22)

If all or part of a timber sale was prepared by a private contractor, the contractor and that contractor's company are not permitted to bid on the timber sale. A person must be 18 years of age or older to purchase timber. Permanent employees of the Department of Natural Resources or members of their immediate household may not bid. Former employees, in the permanent or seasonal class, may not bid until 3 months after the last day of active duty. Bids will not be accepted from individuals or companies appearing on the DNR/FRD No-Bid List. This list contains the names of purchasers who previously failed to execute a contract within 21-days or who have a history of poor performance.

3. Preparation of Sealed Bids (5/16)

Bid Forms may be completed online thru Michigan DNR Timber Sale Online Bidding (OLB) at www.michigan.gov/timberbidding or by completing the hardcopy Bid Form found in the Timber Sale Prospectus . Hardcopy Bid Forms shall be manually signed in ink. Registration in OLB is considered your 'signature' for all bids submitted thru that system. Bid prices must be entered for each species and product in the Bid Price column for all material subject to bidding and all fill-in blanks must be completed. If erasures or other changes appear on the hardcopy Bid Form, each erasure or change must be initialed by the person signing the bid.

4. Submission of Sealed Bids (5/16)

Bid forms may be obtained from the Unit Manager or thru OLB. Bids may be submitted hardcopy or thru OLB. All hardcopy bids must be submitted on the bid form and in an envelope clearly identified as described in this section. NOTE: Only one bid form per bid envelope. Sealed bids must be submitted to the Unit office designated in the prospectus and must be submitted at or prior to the time established in the prospectus. The envelope should show on the outside (a) the sale name or number and (b) the date and time of bid opening, as shown in the prospectus. Bids received after the time specified in the sale prospectus are late bids and will be rejected.

It is possible for a bidder to submit multiple bids on a single sale. For example, a bid may be submitted hardcopy and a bid may be submitted thru OLB. Or, two bidders from the same company could both submit bids on the same sale. If this were to happen, the State would accept all bids received and award the contract accordingly. All bidding and contractual requirements would apply to all bids received.

5. Public Opening of Sealed Bids (7/16)

If conditions permit, the sealed bids will be publicly opened and posted at the time and place set in the prospectus.

If a bidder, present at a bid opening, has submitted bids on more than one sale, that bidder may withdraw their unopened bid envelopes or announce the withdrawal of their online bid after being declared the successful bidder on one sale.

6. Award of Contract (1/11)

Award of the contract will be made to the Bidder whose bid, conforming to the prospectus, is most advantageous to the State of Michigan on the basis of total value at rates bid for the estimated quantities. The State reserves the right to reject any bid or waive any minor irregularity in bids received. A written award mailed (or otherwise furnished) to the successful Bidder shall be deemed to result in a binding contract without further action by either party.

7. Down Payment (1/11)

The Bidder to whom award is made must make a down payment within 21 days of the sale award. The amount of the down payment will be calculated as shown in the Bond and Payment Schedule of this prospectus. Only cash may be used to meet this requirement.

8. Performance Security (1/11)

As guarantee of faithful performance, a cash bond, certificate of deposit, surety bond or irrevocable letter of credit (LOC) is required within 21 days of the sale award. The amount of the performance security is shown in the Bond and

Payment Schedule of this prospectus. If an LOC or surety is used, the coverage must extend for at least 6 months beyond the contract expiration.

9. Worker's Compensation (10/22)

Purchaser shall obtain worker's compensation insurance to cover claims under Michigan's Worker's Disability Compensation Act of 1969 or similar employee benefit act of any other state applicable to an employee. Verification of Worker's Disability Compensation Act Compliance must be completed and submitted within 21 days of contract award and prior to the issuance of the timber sale contract. In addition, if applicable, Notice of Exclusion or Certificate of Insurance must also be submitted.

10. Timber Sale Contract (10/22)

Additional conditions and requirements common to all timber sales are listed on the timber sale contract (R4031) and are available on line at www.michigan.gov/timber. Contact the Unit Manager for additional information or a sample contract. Within 21 days of the date of the award letter, the bidder must sign the contract and provide the required down payment, performance security, and verification of worker's disability compensation. The down payment and performance security shall be in accordance with the provisions of the timber sale contract, in the sums stated in this prospectus. If these actions are not taken, then the Bidder, the Bidder's corporation, and the corporation's principals may not be permitted to bid on State timber sales for a period of 3 months after the first offense, 6 months after the second offense, and 1 year after the third offense. An offense will only be counted against the Bidder for 5 years. In addition, the Bidder certifies that if awarded this contract, the Bidder will complete the timber sale contract in accordance with its terms and any modifications thereof including requirements to purchase, cut, and remove the included timber by the expiration date.

Payment Unit values in the State Forest Timber Sale Contract are calculated based on the advertised value of the Payment Unit as a percentage of the total advertised value of the contract. The advertised value of each Payment Unit is given in the Description of Timber by Payment Unit table on the Timber Sale Information page. For example, if the value of Payment Unit 1 is advertised as \$1,500 and the total Timber Sale value is advertised as \$10,000, the contract price for Payment Unit 1 will be 15% of the total bid price ($\$1,500/\$10,000 * 100$).

11. Disclaimer of Estimates and Bidder's Warranty of Inspection (10/22)

Before submitting this bid, the Bidder is advised and cautioned to inspect the sale area, review the requirements of the sale contract, and take other steps as may be reasonably necessary to ascertain the location, estimated volumes, construction estimates, and operating costs of the proposed sale. Failure to do so will not relieve the Bidder from responsibility for completing the contract.

The Bidder warrants that this bid is submitted solely on the basis of the Bidder's examination and inspection of the quality and quantity of the timber offered for sale and the Bidder's opinion of the value thereof and the costs of recovery. No reliance should be placed on the State of Michigan's estimates of timber quality, quantity or costs of recovery. Bidder further acknowledges that the State of Michigan: (i) expressly disclaims any warranty of fitness of timber for any purpose; (ii) offers this timber as is without any warranty of quality (merchantability) or quantity and (iii) expressly disclaims any warranty as to the quantity or quality of timber sold.

12. Certification and Chain-of-Custody (10/22)

Unless otherwise indicated in the contract under section 7 – Other Conditions of the Sale Specific Conditions & Requirements, the area encompassed by this timber sale is certified to the standards of the Forest Stewardship Council (FSC) - Certificate #SCS-FM/COC-00090N and the Sustainable Forestry Initiative (SFI) - Certificate #NSF-SFIS-5Y031-SF5. Forest products from this sale may be delivered to the mill as "FSC 100% and / or SFI certified" as long as the contractor hauling the forest products is chain-of-custody (COC) certified or covered under a COC certificate from the destination mill. The purchaser is responsible for maintaining COC after leaving the sale area.

13. Good Neighbor Authority (GNA) Requirements (10/22)

If the name of this timber sales contains the acronym GNA, it is authorized by the Good Neighbor Authority (GNA) and covered by various agreements between the U.S. Forest Service and the State. The timber sale occurs on federal land and the following conditions apply:

GNA contracts on US Forest Service land will not be awarded to purchasers on the Federal list of excluded parties. The System for Award Management (SAM) will be checked for active excluded parties prior to award of contract. In

addition, the Bidder to whom award is made must complete an Assurance Regarding Felony Conviction or Tax Delinquent Status for Corporate Applicants (AD-3031).

14. Good Neighbor Authority (GNA) Requirements, con't (10/22)

Bidder certifies, by signing this bid form, that to the best of Bidder's knowledge that the following representations are accurate and complete.

- a. That the Bidder and its principals are not presently debarred, suspended, proposed for debarment, declared ineligible, or voluntary excluded from timber sales (covered transactions) by any Federal department or agency.
- b. That the Bidder and its principals have not within a 3-year period preceding this bid been convicted of or had a civil judgment rendered against them for commission of fraud or a criminal offense in connection with obtaining , attempting to obtain, or performing a public (Federal, State, or local) transaction or contract under a public transaction; violation of Federal or State antitrust statutes or commission of embezzlement, theft, forgery, bribery, falsification or destruction of records, making false statements, or receiving stolen property.
- c. That the Bidder and its principals are not presently indicted for or otherwise criminally or civilly charged by a governmental entity (Federal, State, or local) with commission of any of the offenses enumerated in paragraph b of this certification.
- d. That the Bidder and its principals have not within a 3-year period preceding this bid had one or more public transactions (Federal, State, or local) terminated for breach or default of a timber or forest product contract.

Bidders that cannot certify this requirement, in whole or in part, shall submit an explanation with their bid.

Scott Bowen
Director

TIMBER SALE INFORMATION

Sheridan & 489 East Aspen Oak (54-006-24)
T29N, R02E, SEC. 4; T29N, R02E, SEC. 5.
Montmorency County (Advertised Price \$146,765.30)

SALE NOTE: 2.2.2 - Chipping required- Payment Units 7-8

5.1.3 - Well heads and natural gas pipelines

5.1.6 - Utility R.O.W.

5.2.1.11 - Slash for reforestation- Payment Units 4-6

5.2.3.5 - Oak wilt restriction- All Payment Units

5.2.39 - ORV trail/route protection

A recreation site such as a trail, pathway, or campground is within the sale area or the vicinity. Certain restrictions/specifications may be applicable including time restrictions.

A timber sale contract for this lump sum, sealed bid timber sale will be awarded to the responsible bidder offering the highest sealed bid price. All units of volume listed below were estimated using the Inventory Manager computer program and the new Michigan taper model. Bids must be at or above the following advertised price for each product and species:

<u>PRODUCTS & SPECIES</u>	<u>ESTIMATED UNITS*</u>		<u>ADVERTISED PRICE</u>
Sawtimber			
Black/Red (Hybrid) Oak	10.1	MBF	\$ 95.00 / MBF
Mixed Aspen	36.2	MBF	\$ 78.00 / MBF
Red Maple	11.7	MBF	\$ 51.00 / MBF
Red Oak	460.6	MBF	\$ 179.00 / MBF
Red Pine	21.0	MBF	\$ 117.00 / MBF
White Oak	65.7	MBF	\$ 70.00 / MBF
Pulpwood			
Mixed Aspen	848	Cords	\$ 17.95 / Cord
Mixed Oak	1,417	Cords	\$ 21.60 / Cord
Red Maple	259	Cords	\$ 19.45 / Cord
Red Pine	55	Cords	\$ 36.65 / Cord

* The total volume is statistically estimated within plus (+) or minus (-) 12.70 percent. There are an estimated 3,994 cords on this timber sale, plus or minus 507 cords at the 95% confidence level. The estimated units are final and not subject to adjustment. Prospective bidders are urged to examine this timber and to make their own estimates of quantity and quality.

BOND AND PAYMENT SCHEDULE:

1. A bond in the amount of \$7,338.00 to insure faithful performance of the conditions of the contract will be deposited by the successful bidder within 21 days of the sale award.

2. Cutting in any sale or unit without the required advance payment would be considered a trespass.

3. Total payment must be paid in advance or according to the following schedule :

(a) Ten percent (10%) of the sale value must be paid within 21 days of the sale award.

(b) The 10% down payment will be credited towards the first unit cut.

(c) Payment for each of the following units must be made before cutting begins in that unit:

<u>PAYMENT UNIT NUMBER</u>	<u>PERCENT OF TOTAL SALE VALUE</u>
01	8.4%
02	6.4%
03	6.3%
04	14.7%
05	12.7%
06	12.0%
07	20.9%
08	18.6%

4. If no cutting takes place, the 10% down payment will not be refunded.

5. Operations on the contract issued will terminate on 06/30/2028.

SALE STATISTICS

Volumes were calculated in cubic feet using the Michigan taper model. Cubic foot volume includes all wood inside bark for the product indicated. For display purposes, cubic feet were converted to cords and MBF using a simple conversion factor, e.g. 79 cubic feet per cord and 185 cubic feet per MBF. The cubic foot volumes are precise; the cords and MBF volumes are not. Cubic foot volume cannot be directly converted to cords or boards with precision.

SALE VOLUMES

The total estimated sale volume may not equal the sum of the species/products due to the nature of statistical calculations associated with double sampling methodology.

VOLUME			STATISTICAL RANGE IN CORDS	
TOTAL CUBIC FEET	TOTAL CORDS	PERCENT ERROR	MINIMUM	MAXIMUM
315,547	3,994	12.70%	3,487	4,502

VDU VOLUMES

A VDU is a Volume Determination Unit. Volumes and their associated statistics are calculated at the VDU level and summarized to the sale level. There is often a one to one relationship between a VDU and a Payment Unit, but not always, depending on the cruise design. Refer to the VDU TO PAYMENT UNIT table.

	VOLUME			RANGE IN CORDS	
VDU	TOTAL CUBIC FEET	TOTAL CORDS	PERCENT ERROR	MINIMUM	MAXIMUM
67	8,676	110	60.40%	43	176
88	91,270	1,155	22.07%	900	1,410
95	30,410	385	24.14%	292	478
96	90,396	1,144	29.13%	811	1,478
99	94,795	1,200	22.80%	926	1,474
TOTAL:	315,547	3,994		2,973	5,016

VDU TO PAYMENT UNIT

When a VDU is associated with more than one Payment Unit (PU), the VDU volumes are assigned to the PU based on acres of the VDU within the PU.

VDU	VDU ACRES	PU	PU ACRES
67	4.4	3	4.4
88	43.7	7	23.1
88	43.7	8	20.6
95	14.6	6	14.6
96	38.7	4	20.8
96	38.7	5	17.9
99	72.3	1	32.1
99	72.3	2	24.5
99	72.3	3	15.7
TOTAL:	400.7		173.7

DESCRIPTION OF TIMBER BY PAYMENT UNIT (PU)

PU	MARKET GROUP	PRODUCT	QUANTITY	UNIT	ACRES	ADVERTISE PRICE
1	Mixed Aspen	Sawtimber	4.5	MBF	32.1	\$12,284.70
	<i>B. T. Aspen</i>		4.5	<i>MBF</i>		
	Red Maple		0.9	MBF		
	Red Oak		5.7	MBF		
	Red Pine		2.9	MBF		
	White Oak	Pulpwood	14.4	MBF		
	Mixed Aspen		206	Cords		
	<i>B. T. Aspen</i>		206	<i>Cords</i>		
	Mixed Oak		195	Cords		
	<i>/Red (Hybrid) Oak</i>		2	<i>Cords</i>		
	<i>Red Oak</i>		130	<i>Cords</i>		
	<i>White Oak</i>		63	<i>Cords</i>		
	Red Maple		47	Cords		
	Red Pine		19	Cords		
2	Mixed Aspen	Sawtimber	3.5	MBF	24.5	\$9,374.00
	<i>B. T. Aspen</i>		3.5	<i>MBF</i>		
	Red Maple		0.7	MBF		
	Red Oak		4.4	MBF		
	Red Pine		2.2	MBF		
	White Oak	Pulpwood	11.1	MBF		
	Mixed Aspen		157	Cords		
	<i>B. T. Aspen</i>		157	<i>Cords</i>		
	Mixed Oak		147	Cords		
	<i>/Red (Hybrid) Oak</i>		1	<i>Cords</i>		
	<i>Red Oak</i>		99	<i>Cords</i>		
	<i>White Oak</i>		47	<i>Cords</i>		
	Red Maple		36	Cords		
	Red Pine		15	Cords		
3	Mixed Aspen	Sawtimber	5.5	MBF	20.1	\$9,257.35
	<i>B. T. Aspen</i>		2.2	<i>MBF</i>		
	<i>Quaking Aspen</i>		3.3	<i>MBF</i>		
	Red Maple		0.4	MBF		
	Red Oak		3.4	MBF		
	Red Pine	Pulpwood	12.8	MBF		
	White Oak		8.2	MBF		
	Mixed Aspen		136	Cords		
	<i>B. T. Aspen</i>		119	<i>Cords</i>		
	<i>Quaking Aspen</i>		17	<i>Cords</i>		
	Mixed Oak		118	Cords		
	<i>/Red (Hybrid) Oak</i>		1	<i>Cords</i>		
	<i>Red Oak</i>		83	<i>Cords</i>		
	<i>White Oak</i>		34	<i>Cords</i>		
	Red Maple		34	Cords		
	Red Pine		13	Cords		
4	Black/Red (Hybrid)	Sawtimber	2.4	MBF	20.8	\$21,617.25
	Mixed Aspen		9.8	MBF		
	<i>B. T. Aspen</i>		6.6	<i>MBF</i>		
	<i>Quaking Aspen</i>		3.2	<i>MBF</i>		
	Red Maple		4.1	MBF		
	Red Oak	Pulpwood	65.2	MBF		
	White Oak		6.5	MBF		
	Mixed Aspen		115	Cords		
	<i>B. T. Aspen</i>		98	<i>Cords</i>		
	<i>Quaking Aspen</i>		17	<i>Cords</i>		
	Mixed Oak		236	Cords		
	<i>/Red (Hybrid) Oak</i>		2	<i>Cords</i>		

DESCRIPTION OF TIMBER BY PAYMENT UNIT (PU), CON'T

PU	MARKET GROUP	PRODUCT	QUANTITY	UNIT	ACRES	ADVERTISE PRICE
4 con't	<i>Red Oak</i>	<i>Pulpwood</i>	208	<i>Cords</i>		
	<i>White Oak</i>		26	<i>Cords</i>		
	Red Maple		58	Cords		
5	Black/Red (Hybrid)	Sawtimber	2.0	MBF	17.9	\$18,617.65
	Mixed Aspen		8.5	MBF		
	<i>B. T. Aspen</i>		5.7	<i>MBF</i>		
	<i>Quaking Aspen</i>		2.8	<i>MBF</i>		
	Red Maple		3.5	MBF		
	Red Oak		56.2	MBF		
	White Oak		5.6	MBF		
	Mixed Aspen	Pulpwood	99	Cords		
	<i>B. T. Aspen</i>		84	<i>Cords</i>		
	<i>Quaking Aspen</i>		15	<i>Cords</i>		
	Mixed Oak		203	Cords		
	<i>/Red (Hybrid) Oak</i>		2	<i>Cords</i>		
	<i>Red Oak</i>		179	<i>Cords</i>		
	<i>White Oak</i>		22	<i>Cords</i>		
	Red Maple		50	Cords		
6	Red Oak	Sawtimber	70.1	MBF	14.6	\$17,620.40
	Red Pine		3.1	MBF		
	White Oak		2.6	MBF		
	Mixed Aspen	Pulpwood	11	Cords		
	<i>B. T. Aspen</i>		11	<i>Cords</i>		
	Mixed Oak		177	Cords		
	<i>Red Oak</i>		160	<i>Cords</i>		
	<i>White Oak</i>		17	<i>Cords</i>		
	Red Maple		11	Cords		
	Red Pine		8	Cords		
7	Black/Red (Hybrid)	Sawtimber	3.0	MBF	23.1	\$30,668.10
	Mixed Aspen		2.3	MBF		
	<i>Quaking Aspen</i>		2.3	<i>MBF</i>		
	Red Maple		1.1	MBF		
	Red Oak		135.1	MBF		
	White Oak		9.1	MBF		
	Mixed Aspen	Pulpwood	66	Cords		
	<i>B. T. Aspen</i>		55	<i>Cords</i>		
	<i>Quaking Aspen</i>		11	<i>Cords</i>		
	Mixed Oak		181	Cords		
	<i>/Red (Hybrid) Oak</i>		2	<i>Cords</i>		
	<i>Red Oak</i>		157	<i>Cords</i>		
	<i>White Oak</i>		22	<i>Cords</i>		
	Red Maple		12	Cords		
8	Black/Red (Hybrid)	Sawtimber	2.7	MBF	20.6	\$27,325.85
	Mixed Aspen		2.1	MBF		
	<i>Quaking Aspen</i>		2.1	<i>MBF</i>		
	Red Maple		1.0	MBF		
	Red Oak		120.5	MBF		
	White Oak		8.2	MBF		
	Mixed Aspen	Pulpwood	58	Cords		
	<i>B. T. Aspen</i>		49	<i>Cords</i>		
	<i>Quaking Aspen</i>		9	<i>Cords</i>		
	Mixed Oak		160	Cords		
	<i>/Red (Hybrid) Oak</i>		1	<i>Cords</i>		
	<i>Red Oak</i>		140	<i>Cords</i>		
	<i>White Oak</i>		19	<i>Cords</i>		
	Red Maple		11	Cords		

TOTAL:	605.3	MBF
TOTAL:	2,579	Cords

Sale Specific Conditions & Requirements

Sale Name: Sheridan & 489 East Aspen Oak

Sale Number: 54-006-24 Seq#: 2

1 - Sale Area

1.2 - Boundaries

1.2.1 - Painted Boundaries (9/19)

The sale boundary and Payment Unit boundaries are marked and identified by red and yellow paint, along with state forest roads, powerlines, and cover type changes. Exterior sale boundary lines against state are marked with red paint. Interior sale boundary lines adjacent to the non-forested openings (G0) are unpainted and identified by the cover type change. No harvesting may occur within G0 non-forested stands. Interior Payment Unit boundaries are marked with yellow paint, with the exception of the unpainted boundaries using state forest roads and a powerline as shown on the Timber Sale Map. The painted boundary line trees are not Included Timber and are to be protected. Yellow painted trees are only to be cut when all surrounding Payment Units have been paid. The state forest road segments and powerline designating an interior Payment Unit boundary are only to be crossed when all surrounding Payment Units have been paid.

2 - Timber Specifications

2.1 - Included Timber

2.1.1 - Clearcut Unit(s) with Unmerchantable Trees (6/14)

Within Payment Unit(s) 1-8, cut all trees that are two (2) inches or more at DBH, with the following exceptions:

- Within Payment Units 1-3, do not cut any white pine or trees marked with purple paint.
- Within Payment Unit 4-5, do not cut any white pine or red pine.

Note: See spec 5.2.4.4 - 'Dead and down creation' for instructions on orange marked trees.

2.2 - Utilization

2.2.2 - Chipping Required (12/24)

Payment Units 7 and 8 must be chip harvested to facilitate future silvicultural activities. The Purchaser has the option to produce sawlogs or pulpwood bolts, but the remaining portion of the trees must be chipped and hauled. Products may be produced as roundwood and forwarded to decking areas in final product length, but the tops must be left intact and skidded to the landing for chipping in order to minimize the amount of residual slash.

If market conditions limit the practicality of chipping the following is required: Tops must be cut into lengths 4 feet or less and trees greater than 4 inches at DBH must be cut to a 2-inch top or smaller. Sub-merchantable trees, and hardwood limbs 4 inches or greater where they attach to the stem, are to be cut/reduced to 4-foot lengths. Tops and slash must also be spread evenly across the sale. This is to speed the breakdown of tops and slash. The requirement to retain approximately 1/6 to 1/3 of tree tops and limbs less than four inches in diameter is still applicable (G. C. & R. 2.2).

2.2.3 - Stump Heights (12/24)

Stump heights within Payment Units 7 and 8 shall not exceed 8 inches for trees greater than 20 inches DBH and 6 inches for trees smaller than 20 inches DBH. This is in order to facilitate planting operations.

3 - Payments

3.3 - Pre-measured Sales

3.3.4 - Dividing Payment Units (7/14)

Payment Unit(s) may be divided at the request of the Purchaser and upon approval of the Unit Manager. Dividing Payment Units is a contract modification which requires a Timber Sale Contract Amendment. Payment Units valued over \$25,000 may be divided. There will be only one division per Payment Unit.

3.4 - Damaged Timber

3.4.1 - Damaged Timber (12/24)

General Condition and Requirement 3.4 Damaged Timber, defines liquidated damages for undesignated live merchantable trees which are cut or injured.

No damage is acceptable to undesignated live merchantable trees. Within the Sale Area, if more than 5% of trees (> 4.5" DBH) within a specified area of the sale are damaged, liquidated damages will be assessed for all trees damaged. Rates will be in accordance with General Condition and Requirement 3.4 Damaged Timber.

4 - Transportation

4.1 - Construction

4.1.3 - Slash and Earthen Piles (8/04)

Piles or windrows of earth along roads and landings that have been widened or constructed shall be leveled. Slash from road maintenance or construction, including stumps, shall be chipped, utilized or otherwise removed from the sale.

4.1.6 - Road Construction (4/24)

Construction of new roads or improvements of existing roads shall be done in such a way as to minimize the environmental and visual impacts. Merchantable trees shall be cut and utilized unless otherwise directed. Non-merchantable trees shall be severed and laid flat on the ground. Slash shall be scattered, and not left in windrows and kept a minimum of 10 feet back from the road edge. Stumps shall be set upright, not left on edge, and be moved at least 10 feet away from the road edge. Improved roads and constructed roads must not be unreasonably widened beyond 15 feet. Narrow access into some Payment Units will require widening and blading on lengths of state forest roads. Additional access timber must be piled separately for scaling by the Sale Administrator.

4.1.7 - Road Closure (10/11)

All new roads built into the sale must be blocked to vehicle traffic upon completion of the sale. Overgrown roads that are reopened shall be considered new roads. In general, this will require constructing a four (4') foot high berm of stumps and logs covered with earth. Stumps and brush must be placed along the remainder of the trail. These roads must be rendered impassable to cars and trucks. Contact the Sale Administrator for specific details of design and placement.

4.2 - Maintenance

4.2.5 - Two Wheel Drive Condition (2/04)

All existing trail roads on and adjacent to the Sale Area must be passable by two-wheel drive traffic for the duration of the sale.

5 - Operations

5.1 - Notification

5.1.1 - Pre-sale Conference (10/16)

A pre-sale conference between the Purchaser and Sale Administrator is required prior to beginning any operations to determine landing and road locations. The Unit Manager or his/her representative must be contacted at least 5 days in advance to schedule the conference.

5.1.3 - Well Heads and Natural Gas Pipelines (11/15)

The Purchaser is responsible for contacting the gas or pipeline company 30 days prior to operating equipment in the vicinity of well heads or natural gas pipelines.

Riverside Energy Michigan

10691 E Carter Rd, Suite 201

Traverse City, MI 49684

Tel: (231) 995-4000 (M-F, 8am-5pm)

24 HOUR EMERGENCY LINE: (989) 705-7665

(PIPELINE LEAK * SOUR GAS SMELL * FIRE * ACCIDENT)

5.1.4 - Post-Sale Conference (10/16)

A post-sale conference on site between the Purchaser and sale administrator is required 5 days prior to the completion of active logging operations to determine clean-up and repair of landings, road edges, and the fulfillment of other contract specifications.

5.1.6 - Utility R.O.W. (1/25)

It is the responsibility of the Purchaser to obtain permission from the utility company to utilize the power line right-of-way (R.O.W.) for operations.

5.2 - Conduct of Operations

5.2.1 - Slash

5.2.1.10 - No Slash in Openings (5/10)

No brush or logging debris is to be left in maintained wildlife openings which are indicated by "G0" on the Timber Sale Map. Any damage to the opening shall be repaired according to specifications of the Unit Manager or his/her representative.

5.2.1.11 - Slash for Reforestation (3/21)

To protect oak stump sprout regeneration from browsing, chipping or removal of sub-merchantable oak treetops from Payment Units 4-6 is not permitted. Sub-merchantable oak tops/slash are to be placed high, adjacent, and surrounding harvested oak stumps with the goal of making the slash impenetrable by deer.

5.2.2 - Hazard Trees/Snags

5.2.2.1 - Den Trees (10/16)

Obvious hollow and/or den trees shall be protected and left standing unless they are a safety hazard.

5.2.3 - Operating Restrictions

5.2.3.5 - Oak Wilt Restriction (1/18)

Within Payment Units 1-8, unless changed by written agreement, cutting, skidding, hauling within the sale and brushing of access roads to the sale are not permitted during the period of April 15 to July 15. Operations may be allowed if specific steps are taken to prevent damaging uncut oak during the high-risk period. Those steps may include completing all road brushing before April 15 and clearing a tree-length buffer along uncut oak cover before April 15. This is necessary to reduce the spread of oak wilt. For more information, contact the Unit Manager or his/her representative.

5.2.3.11 - Coppice Regeneration Protection (4/10)

Timber harvesting in Payment Units 1-6 must be completed within 60 days of severing/cutting stem(s) to minimize damage to deciduous regeneration. Any post-harvest operations, such as chipping, must be completed before sprouting of regeneration occurs. If it is anticipated that chipping will be delayed, then tops shall be carried to one central location or left unchipped. The Unit Manager or his/her representative may cease such operations if sprouting occurs before the operation is complete.

5.2.4 - Dead and Down Creation

5.2.4.4 - Dead and Down Creation, Grouse (6/18)

To encourage grouse and other wildlife, in Payment Unit(s) 1-3, push over and leave all orange marked trees on the ground. If it is impractical to push the trees over, they may be cut or partially cut and pushed over. Tree crowns should touch the ground. These trees are scattered evenly throughout the unit, and preferably at least two chains from any roads, two-tracks, or trails open to vehicles.

5.2.31 - Landing Locations (9/13)

Landing locations are shown on the Timber Sale Map. Landings must be confined to these designated sites unless otherwise authorized by the Unit Manager or his/her representative.

5.2.32 - Decking/Landing Restoration (9/13)

All decking and landing areas must have the surface area restored to a condition equal to or better than before. This is to ensure the proper regeneration of the stand. Wood debris, chips and "cookies" from trimmings must be removed or scattered away from landing and loading areas and may not be windrowed on the edge.

5.2.33 - Gas Well Revegetation (12/08)

In the event that the gas well is utilized for a landing, the site must be revegetated with a seeding mixture specified by the Unit Manager or his/her representative.

5.2.38 - No Decking Against Live Trees (2/04)

Cut products may not be decked against unmarked or designated leave trees.

5.2.39 - ORV Trail/Route Protection (4/18)

The Atlanta to Hunt Creek Motorcycle Trail is shown on the Timber Sale Map. Do not cut trees or damage posts with yellow ORV markers. All stumps within 5 feet of the trail must be cut flush with the ground. Maintain a 20-foot-wide slash, debris, and rut free zone daily using the ORV trail or route as the centerline. Do not run equipment down the motorcycle trail or route. Skidding across the trail or route may only occur in locations approved by the Sale Administrator.

5.4 - Soil Protection

5.4.1 - Rutting Restriction, General (7/16)

Operations are to cease immediately if equipment and weather conditions result in rutting of roads and/or skid trails which is 12 inches or greater in depth and 50 feet in length. The Unit Manager or his/her representative may restrict hauling and/or skidding if ruts exceed the specified depth. With the Unit Manager or his/her representative's approval, the Purchaser may return to the area when the risk of rutting has decreased.

5.4.2 - Skid Trails (2/04)

Skid trails up and down slopes should be avoided. If, however, this is unavoidable, these trails will be left in a non-erodible condition using water bars, logs, and slash. Placing of slash on these skid trails while logging is ongoing may alleviate need for any further action. At the direction of the Sale Administrator, seed, fertilizer, and mulch may also be required.

5.8 - Protection of Endangered Species

5.8.5 - Protection of Raptor Nests (3/13)

All trees with raptor nests will be protected if found during harvesting operations. Notification will be made to the Unit Manager or his/her representative who will notify the Wildlife Biologist so an onsite evaluation and recommendation can be made, if necessary.

6 - Safety and Fire Prevention

6.2 - Signing

6.2.3 - Recreational Trail Posting (10/20)

The Purchaser is responsible for posting and maintaining caution signs on Atlanta to Hunt Creek Motorcycle Trail prior to beginning operations. The trail must be posted at appropriate distances from the Sale Area to warn of logging activity and truck traffic at both ends of the trail. Signs must be removed when harvest operations are suspended or completed. The Purchaser will provide these signs.

**TIMBER SALE MAP**

This information provided by authority of Part 525, 1994 PA 451, as amended.

Sale Number

54-006-24

Date

08/30/2024

Forest Management Unit

Atlanta Mgt Unit

County

Montmorency

Mapped By: D. Coy

Cruised By: D. Coy

Scale

1:15,840

Page

1

Of

1Township
29NRange
02E

Section(s) and

Subdivision(s) Sec. 4 NENW,S1/2NW,W1/2NE,SW; Sec. 5 SENE,E1/2SE;

Cover Type

A = Aspen	J = Jack Pine	O = Oak	U = Upland Brush
B = Paper Birch	K = Rock	P = Lowland Poplar	UM = Upland Mix Forest
C = Cedar	L = Lowland Brush	Q = Mixed Swamp Conifer	V = Bog or Marsh
D = Treed Bog	LM = Lowland Mix Forest	R = Red Pine	W = White Pine
E = Swamp Hardwoods	M = Maple, Beech, Birch	S = Black Spruce	X = Non Stocked
F = Spruce/Fir	MC = Mixed Conifer	T = Tamarack	Y = Sand
G = Grass	MD = Mixed Deciduous	Z = Water	
H = Hemlock	N = Marsh		

Density

0 = Non Stocked	5 = Pole Timber Medium
1 = Seedling Sapling Poor	6 = Pole Timber Well
2 = Seedling Sapling Medium	7 = Saw Timber Poor
3 = Seedling Sapling Well	8 = Saw Timber Medium
4 = Pole Timber Poor	9 = Saw Timber Well

PU #	Acres	PU #	Acres
1	32.1	5	17.9
2	24.5	6	14.6
3	20.1	7	23.1
4	20.8	8	20.6

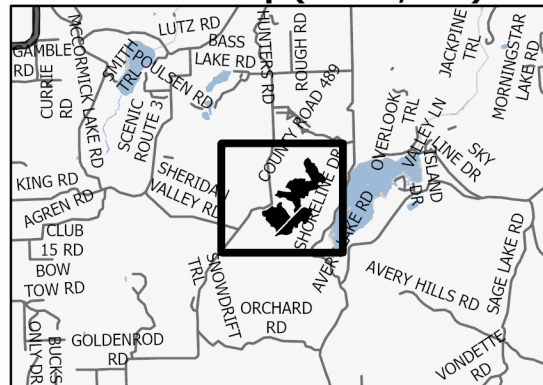
**Sheridan &
489 East
Aspen Oak
173.7 Acres****Locator Map (1:150,000)**

0 0.25 0.5 1 Miles

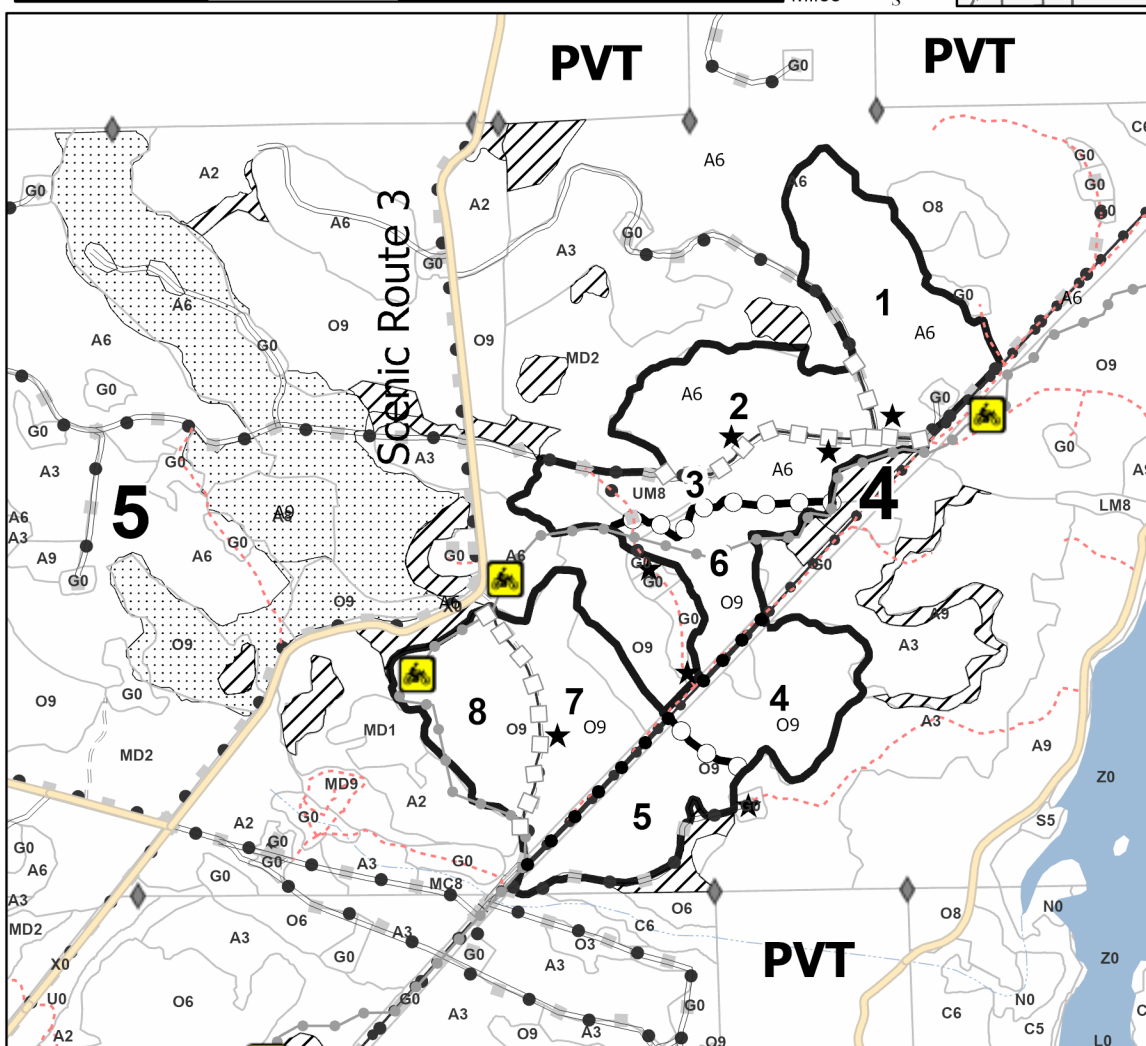
**Legend**

- Sale Boundary (Red)
- Payment Unit Line (Yellow)
- Payment Unit Line (Road- No Paint)
- Payment Unit Line (Powerline)
- ▨ Retention Areas (Red)
- ▨ Nearby Timber Sale
- Stand
- Recreational Trail
- Secondary Forest Road
- Forest Access Route
- Administrative Access Only
- Non-DNR Road
- Pipeline
- Powerline
- ★ Landing
- ◆ Survey Corner

Use QR Code to open Map in App



TIMBER SALE INFORMATION

Sheridan & 489 North Aspen Oak (54-007-24)
T29N, R02E, SEC. 5; T29N, R02E, SEC. 6.
Montmorency County (Advertised Price \$208,982.35)

SALE NOTE: 5.1.3 - Well heads and natural gas pipelines- All Payment Units

5.1.6 - Utility R.O.W.- Payment Unit 9

5.2.1.11 - Slash for reforestation- Payment Units 11-12

5.2.3.3 - Bark slippage restriction- Payment Unit 13

5.2.3.5 - Oak wilt restriction- Payment Units 1-12

5.2.3.4 - Oak Wilt Restriction, No Exceptions- Payment Unit 13

A timber sale contract for this lump sum, sealed bid timber sale will be awarded to the responsible bidder offering the highest sealed bid price. All units of volume listed below were estimated using the Inventory Manager computer program and the new Michigan taper model. Bids must be at or above the following advertised price for each product and species:

<u>PRODUCTS & SPECIES</u>	<u>ESTIMATED UNITS*</u>	<u>ADVERTISED PRICE</u>
Sawtimber		
Mixed Aspen	353.7 MBF	\$ 78.00 / MBF
Red Maple	32.8 MBF	\$ 51.00 / MBF
Red Oak	423.9 MBF	\$ 179.00 / MBF
Red Pine	17.8 MBF	\$ 117.00 / MBF
Sugar Maple	13.4 MBF	\$ 247.00 / MBF
White Oak	34.0 MBF	\$ 70.00 / MBF
Pulpwood		
Balsam Fir	17 Cords	\$ 16.80 / Cord
Basswood	16 Cords	\$ 17.15 / Cord
Mixed Aspen	2,872 Cords	\$ 17.95 / Cord
Mixed Hardwood	1,213 Cords	\$ 19.45 / Cord
Mixed Oak	902 Cords	\$ 21.60 / Cord
Paper Birch	33 Cords	\$ 13.40 / Cord
Red Pine	12 Cords	\$ 36.65 / Cord

* The total volume is statistically estimated within plus (+) or minus (-) 12.19 percent. There are an estimated 7,215 cords on this timber sale, plus or minus 880 cords at the 95% confidence level. The estimated units are final and not subject to adjustment. Prospective bidders are urged to examine this timber and to make their own estimates of quantity and quality.

BOND AND PAYMENT SCHEDULE:

1. A bond in the amount of \$10,449.00 to insure faithful performance of the conditions of the contract will be deposited by the successful bidder within 21 days of the sale award.

2. Cutting in any sale or unit without the required advance payment would be considered a trespass.

3. Total payment must be paid in advance or according to the following schedule :

(a) Ten percent (10%) of the sale value must be paid within 21 days of the sale award.

(b) The 10% down payment will be credited towards the first unit cut.

(c) Payment for each of the following units must be made before cutting begins in that unit:

<u>PAYMENT UNIT NUMBER</u>	<u>PERCENT OF TOTAL SALE VALUE</u>
01	5.1%
02	5.6%
03	10.8%
04	14.1%
05	9.5%
06	7.9%
07	6.9%
08	9.5%
09	10.7%
10	3.5%
11	4.1%
12	8.5%
13	3.8%

4. If no cutting takes place, the 10% down payment will not be refunded.

5. Operations on the contract issued will terminate on 06/30/2028.

SALE STATISTICS

Volumes were calculated in cubic feet using the Michigan taper model. Cubic foot volume includes all wood inside bark for the product indicated. For display purposes, cubic feet were converted to cords and MBF using a simple conversion factor, e.g. 79 cubic feet per cord and 185 cubic feet per MBF. The cubic foot volumes are precise; the cords and MBF volumes are not. Cubic foot volume cannot be directly converted to cords or boards with precision.

SALE VOLUMES

The total estimated sale volume may not equal the sum of the species/products due to the nature of statistical calculations associated with double sampling methodology.

VOLUME			STATISTICAL RANGE IN CORDS	
TOTAL CUBIC FEET	TOTAL CORDS	PERCENT ERROR	MINIMUM	MAXIMUM
569,985	7,215	12.19%	6,335	8,095

VDU VOLUMES

A VDU is a Volume Determination Unit. Volumes and their associated statistics are calculated at the VDU level and summarized to the sale level. There is often a one to one relationship between a VDU and a Payment Unit, but not always, depending on the cruise design. Refer to the VDU TO PAYMENT UNIT table.

	VOLUME			RANGE IN CORDS	
VDU	TOTAL CUBIC FEET	TOTAL CORDS	PERCENT ERROR	MINIMUM	MAXIMUM
4	15,791	200	36.18%	128	272
6	22,748	288	53.02%	135	441
33	59,037	747	22.61%	578	916
34	39,687	502	28.73%	358	647
54	130,012	1,646	24.72%	1,239	2,053
71	23,773	301	42.18%	174	428
155	225,922	2,860	24.58%	2,157	3,563
699	53,016	671	30.61%	466	876
TOTAL:	569,985	7,215		5,235	9,195

VDU TO PAYMENT UNIT

When a VDU is associated with more than one Payment Unit (PU), the VDU volumes are assigned to the PU based on acres of the VDU within the PU.

VDU	VDU ACRES	PU	PU ACRES
4	17.0	13	17.0
6	9.9	10	9.9
33	19.4	4	3.8
33	19.4	5	9.5
33	19.4	6	6.1
34	8.3	4	7.2
34	8.3	5	1.1
54	55.4	1	17.1
54	55.4	2	18.6
54	55.4	3	19.7
71	9.3	3	9.3
155	82.3	4	4.8
155	82.3	5	5.2
155	82.3	6	9.6
155	82.3	7	15.8
155	82.3	8	21.7
155	82.3	9	24.6
155	82.3	10	0.6
699	22.1	3	0.2
699	22.1	11	7.1
699	22.1	12	14.8
TOTAL:	919.6		223.7

DESCRIPTION OF TIMBER BY PAYMENT UNIT (PU)

PU	MARKET GROUP	PRODUCT	QUANTITY	UNIT	ACRES	ADVERTISE PRICE
1	Mixed Aspen	Sawtimber	10.5	MBF	17.1	\$10,661.95
	<i>B. T. Aspen</i>		2.4	<i>MBF</i>		
	<i>Quaking Aspen</i>		8.1	<i>MBF</i>		
	Red Maple		0.7	MBF		
	Red Oak		4.4	MBF		
	Red Pine		0.6	MBF		
	White Oak		2.0	MBF		
	Mixed Aspen	Pulpwood	274	Cords		
	<i>B. T. Aspen</i>		121	<i>Cords</i>		
	<i>Quaking Aspen</i>		153	<i>Cords</i>		
	Mixed Hardwood		99	Cords		
	<i>Beech</i>		1	<i>Cords</i>		
	<i>Black Cherry</i>		2	<i>Cords</i>		
	<i>Red Maple</i>		96	<i>Cords</i>		
	Mixed Oak		91	Cords		
	<i>Red Oak</i>		89	<i>Cords</i>		
	<i>White Oak</i>		2	<i>Cords</i>		
2	Mixed Aspen	Sawtimber	11.5	MBF	18.6	\$11,642.60
	<i>B. T. Aspen</i>		2.7	<i>MBF</i>		
	<i>Quaking Aspen</i>		8.8	<i>MBF</i>		
	Red Maple		0.8	MBF		
	Red Oak		4.8	MBF		
	Red Pine		0.7	MBF		
	White Oak		2.2	MBF		
	Mixed Aspen	Pulpwood	298	Cords		
	<i>B. T. Aspen</i>		132	<i>Cords</i>		
	<i>Quaking Aspen</i>		166	<i>Cords</i>		
	Mixed Hardwood		108	Cords		
	<i>Beech</i>		1	<i>Cords</i>		
	<i>Black Cherry</i>		2	<i>Cords</i>		
	<i>Red Maple</i>		105	<i>Cords</i>		
	Mixed Oak		100	Cords		
	<i>Red Oak</i>		97	<i>Cords</i>		
	<i>White Oak</i>		3	<i>Cords</i>		
3	Mixed Aspen	Sawtimber	12.4	MBF	29.2	\$22,594.40
	<i>B. T. Aspen</i>		3.0	<i>MBF</i>		
	<i>Quaking Aspen</i>		9.4	<i>MBF</i>		
	Red Maple		4.8	MBF		
	Red Oak		38.2	MBF		
	Red Pine		0.8	MBF		
	White Oak		2.5	MBF		
	Mixed Aspen	Pulpwood	417	Cords		
	<i>B. T. Aspen</i>		158	<i>Cords</i>		
	<i>Quaking Aspen</i>		259	<i>Cords</i>		
	Mixed Hardwood		197	Cords		
	<i>Black Cherry</i>		2	<i>Cords</i>		
	<i>Red Maple</i>		195	<i>Cords</i>		
	Mixed Oak		137	Cords		
	<i>Red Oak</i>		130	<i>Cords</i>		
	<i>White Oak</i>		7	<i>Cords</i>		
4	Mixed Aspen	Sawtimber	33.5	MBF	15.8	\$29,573.35
	<i>B. T. Aspen</i>		25.2	<i>MBF</i>		
	<i>Quaking Aspen</i>		8.3	<i>MBF</i>		
	Red Maple		4.0	MBF		
	Red Oak		101.2	MBF		
	Sugar Maple		3.8	MBF		

DESCRIPTION OF TIMBER BY PAYMENT UNIT (PU), CON'T

PU	MARKET GROUP	PRODUCT	QUANTITY	UNIT	ACRES	ADVERTISE PRICE
4 con't	White Oak	Sawtimber	0.7	MBF		
	Balsam Fir	Pulpwood	2	Cords		
	Basswood		7	Cords		
	<i>Basswood</i>	<i>Sawtimber</i>	1.6	<i>MBF</i>		
	<i>Basswood</i>	<i>Pulpwood</i>	4	<i>Cords</i>		
	Mixed Aspen		135	Cords		
	<i>B. T. Aspen</i>		69	<i>Cords</i>		
	<i>Balsam Poplar</i>		1	<i>Cords</i>		
	<i>Quaking Aspen</i>		65	<i>Cords</i>		
	Mixed Hardwood		145	Cords		
	<i>Red Maple</i>		93	<i>Cords</i>		
	<i>Sugar Maple</i>		52	<i>Cords</i>		
	Mixed Oak		102	Cords		
	<i>Red Oak</i>		101	<i>Cords</i>		
	<i>White Oak</i>		1	<i>Cords</i>		
	Paper Birch		4	Cords		
5	Mixed Aspen	Sawtimber	32.0	MBF	15.8	\$19,848.55
	<i>B. T. Aspen</i>		25.1	<i>MBF</i>		
	<i>Quaking Aspen</i>		6.9	<i>MBF</i>		
	Red Maple		5.9	MBF		
	Red Oak		54.6	MBF		
	Sugar Maple		3.1	MBF		
	White Oak		1.0	MBF		
	Balsam Fir	Pulpwood	4	Cords		
	Basswood		6	Cords		
	<i>Basswood</i>	<i>Sawtimber</i>	0.3	<i>MBF</i>		
	<i>Basswood</i>	<i>Pulpwood</i>	5	<i>Cords</i>		
	Mixed Aspen		133	Cords		
	<i>B. T. Aspen</i>		42	<i>Cords</i>		
	<i>Balsam Poplar</i>		1	<i>Cords</i>		
	<i>Quaking Aspen</i>		90	<i>Cords</i>		
	Mixed Hardwood		134	Cords		
	<i>Red Maple</i>		93	<i>Cords</i>		
	<i>Sugar Maple</i>		41	<i>Cords</i>		
	Mixed Oak		53	Cords		
	<i>Red Oak</i>		52	<i>Cords</i>		
	<i>White Oak</i>		1	<i>Cords</i>		
	Paper Birch		10	Cords		
6	Mixed Aspen	Sawtimber	36.0	MBF	15.7	\$16,420.90
	<i>B. T. Aspen</i>		24.0	<i>MBF</i>		
	<i>Quaking Aspen</i>		12.0	<i>MBF</i>		
	Red Maple		4.2	MBF		
	Red Oak		34.3	MBF		
	Sugar Maple		2.2	MBF		
	White Oak		1.3	MBF		
	Balsam Fir	Pulpwood	3	Cords		
	Basswood		3	Cords		
	<i>Basswood</i>		3	<i>Cords</i>		
	Mixed Aspen		193	Cords		
	<i>B. T. Aspen</i>		68	<i>Cords</i>		
	<i>Balsam Poplar</i>		1	<i>Cords</i>		
	<i>Quaking Aspen</i>		124	<i>Cords</i>		
	Mixed Hardwood		108	Cords		
	<i>Black Cherry</i>		1	<i>Cords</i>		
	<i>Red Maple</i>		83	<i>Cords</i>		
	<i>Sugar Maple</i>		24	<i>Cords</i>		

DESCRIPTION OF TIMBER BY PAYMENT UNIT (PU), CON'T

PU	MARKET GROUP	PRODUCT	QUANTITY	UNIT	ACRES	ADVERTISE PRICE
6 con't	Mixed Oak	Pulpwood	40	Cords		
	<i>Red Oak</i>		39	<i>Cords</i>		
	<i>White Oak</i>		1	<i>Cords</i>		
	Paper Birch		7	Cords		
7	Mixed Aspen	Sawtimber	42.6	MBF	15.8	\$14,389.05
	<i>B. T. Aspen</i>		22.8	<i>MBF</i>		
	<i>Quaking Aspen</i>		19.8	<i>MBF</i>		
	Red Maple		1.5	MBF		
	Red Oak		18.3	MBF		
	Sugar Maple		1.1	MBF		
	White Oak		1.6	MBF		
	Balsam Fir	Pulpwood	2	Cords		
	Mixed Aspen		281	Cords		
	<i>B. T. Aspen</i>		112	<i>Cords</i>		
	<i>Balsam Poplar</i>		2	<i>Cords</i>		
	<i>Quaking Aspen</i>		167	<i>Cords</i>		
	Mixed Hardwood		76	Cords		
	<i>Black Cherry</i>		1	<i>Cords</i>		
	<i>Red Maple</i>		70	<i>Cords</i>		
	<i>Sugar Maple</i>		5	<i>Cords</i>		
	Mixed Oak		34	Cords		
	<i>Red Oak</i>		33	<i>Cords</i>		
	<i>White Oak</i>		1	<i>Cords</i>		
	Paper Birch		3	Cords		
8	Mixed Aspen	Sawtimber	58.5	MBF	21.7	\$19,774.70
	<i>B. T. Aspen</i>		31.3	<i>MBF</i>		
	<i>Quaking Aspen</i>		27.2	<i>MBF</i>		
	Red Maple		2.0	MBF		
	Red Oak		25.1	MBF		
	Sugar Maple		1.5	MBF		
	White Oak		2.2	MBF		
	Balsam Fir	Pulpwood	3	Cords		
	Mixed Aspen		386	Cords		
	<i>B. T. Aspen</i>		154	<i>Cords</i>		
	<i>Balsam Poplar</i>		3	<i>Cords</i>		
	<i>Quaking Aspen</i>		229	<i>Cords</i>		
	Mixed Hardwood		104	Cords		
	<i>Black Cherry</i>		2	<i>Cords</i>		
	<i>Red Maple</i>		96	<i>Cords</i>		
	<i>Sugar Maple</i>		6	<i>Cords</i>		
	Mixed Oak		48	Cords		
	<i>Red Oak</i>		46	<i>Cords</i>		
	<i>White Oak</i>		2	<i>Cords</i>		
	Paper Birch		4	Cords		
9	Mixed Aspen	Sawtimber	66.0	MBF	24.6	\$22,456.55
	<i>B. T. Aspen</i>		35.4	<i>MBF</i>		
	<i>Quaking Aspen</i>		30.6	<i>MBF</i>		
	Red Maple		2.3	MBF		
	Red Oak		28.5	MBF		
	Sugar Maple		1.7	MBF		
	White Oak		2.5	MBF		
	Balsam Fir	Pulpwood	3	Cords		
	Mixed Aspen		441	Cords		
	<i>B. T. Aspen</i>		177	<i>Cords</i>		
	<i>Balsam Poplar</i>		4	<i>Cords</i>		
	<i>Quaking Aspen</i>		260	<i>Cords</i>		

DESCRIPTION OF TIMBER BY PAYMENT UNIT (PU), CON'T

PU	MARKET GROUP	PRODUCT	QUANTITY	UNIT	ACRES	ADVERTISE PRICE
9 con't	Mixed Hardwood	Pulpwood	118	Cords		
	<i>Black Cherry</i>		2	<i>Cords</i>		
	<i>Red Maple</i>		109	<i>Cords</i>		
	<i>Sugar Maple</i>		7	<i>Cords</i>		
	Mixed Oak		54	Cords		
	<i>Red Oak</i>		52	<i>Cords</i>		
	<i>White Oak</i>		2	<i>Cords</i>		
	Paper Birch		5	Cords		
10	Mixed Aspen	Sawtimber	17.6	MBF	10.5	\$7,392.85
	<i>B. T. Aspen</i>		0.9	<i>MBF</i>		
	<i>Quaking Aspen</i>		16.7	<i>MBF</i>		
	Red Maple		2.7	MBF		
	Red Oak		2.6	MBF		
	Red Pine		7.6	MBF		
	White Oak		0.1	MBF		
	Mixed Aspen	Pulpwood	197	Cords		
	<i>B. T. Aspen</i>		75	<i>Cords</i>		
	<i>Quaking Aspen</i>		122	<i>Cords</i>		
	Mixed Hardwood		20	Cords		
	<i>Red Maple</i>		20	<i>Cords</i>		
	Mixed Oak		14	Cords		
	<i>Red Oak</i>		14	<i>Cords</i>		
	Red Pine		8	Cords		
	Mixed Aspen	Sawtimber	10.3	MBF		
	<i>B. T. Aspen</i>		7.5	<i>MBF</i>		
	<i>Quaking Aspen</i>		2.8	<i>MBF</i>		
	Red Maple		1.0	MBF		
	Red Oak		27.2	MBF		
	Red Pine		1.9	MBF		
	White Oak		5.7	MBF		
	Mixed Aspen		34	Cords		
	<i>B. T. Aspen</i>		13	<i>Cords</i>		
	<i>Quaking Aspen</i>		21	<i>Cords</i>		
	Mixed Hardwood		13	Cords		
	<i>Red Maple</i>		13	<i>Cords</i>		
	Mixed Oak		60	Cords		
	<i>Red Oak</i>		51	<i>Cords</i>		
	<i>White Oak</i>		9	<i>Cords</i>		
12	Mixed Aspen	Sawtimber	21.6	MBF	14.8	\$17,774.35
	<i>B. T. Aspen</i>		15.7	<i>MBF</i>		
	<i>Quaking Aspen</i>		5.9	<i>MBF</i>		
	Red Maple		2.1	MBF		
	Red Oak		56.7	MBF		
	Red Pine		3.9	MBF		
	White Oak		11.7	MBF		
	Mixed Aspen	Pulpwood	71	Cords		
	<i>B. T. Aspen</i>		27	<i>Cords</i>		
	<i>Quaking Aspen</i>		44	<i>Cords</i>		
	Mixed Hardwood		27	Cords		
	<i>Red Maple</i>		27	<i>Cords</i>		
	Mixed Oak		126	Cords		
	<i>Red Oak</i>		106	<i>Cords</i>		
	<i>White Oak</i>		20	<i>Cords</i>		
	Red Pine		1	Cords		
13	Mixed Aspen	Sawtimber	1.2	MBF	17.0	\$7,949.45
	<i>Quaking Aspen</i>		1.2	<i>MBF</i>		

DESCRIPTION OF TIMBER BY PAYMENT UNIT (PU), CON'T

PU	MARKET GROUP	PRODUCT	QUANTITY	UNIT	ACRES	ADVERTISE PRICE
13 con't	Red Maple	Sawtimber	0.8	MBF		
	Red Oak		28.0	MBF		
	Red Pine		2.3	MBF		
	White Oak		0.5	MBF		
	Mixed Aspen	Pulpwood	12	Cords		
	<i>B. T. Aspen</i>		11	<i>Cords</i>		
	<i>Quaking Aspen</i>		1	<i>Cords</i>		
	Mixed Hardwood		64	Cords		
	<i>Red Maple</i>		64	<i>Cords</i>		
	Mixed Oak		43	Cords		
	<i>Red Oak</i>		42	<i>Cords</i>		
	<i>White Oak</i>		1	<i>Cords</i>		
	Red Pine	3	Cords			
TOTAL:			875.6	MBF		
TOTAL:			5,065	Cords		

Sale Specific Conditions & Requirements

Sale Name: Sheridan & 489 North Aspen Oak

Sale Number: 54-007-24 Seq#: 2

1 - Sale Area

1.2 - Boundaries

1.2.1 - Painted Boundaries (9/19)

The sale boundary and Payment Unit boundaries are marked and identified by red, blue, and yellow paint, along with roads and cover type changes. Exterior sale boundary lines against state are marked with red paint or designated by County Road 489, Sheridan Valley Road, and Scenic Route 3 Road as shown on the Timber Sale Map. Interior sale boundary lines adjacent to the non-forested openings (G0) or adjacent to county roads mentioned are unpainted and identified by the cover type change. No trees are to be cut within G0 non-forested stands. Interior retention boundaries are not to be entered and are marked with red paint. Exterior sale boundary lines against private are marked with blue paint. Interior Payment Unit boundaries are marked with yellow paint, with the exception of the unpainted boundaries using state forest roads as shown on the Timber Sale Map. The painted boundary line trees are not Included Timber and are to be protected. Yellow painted trees are only to be cut when all surrounding Payment Units have been paid. The state forest road segments designating an interior Payment Unit boundary are only to be crossed when all surrounding Payment Units have been paid.

2 - Timber Specifications

2.1 - Included Timber

2.1.1 - Clearcut Unit(s) with Unmerchantable Trees (6/14)

Within Payment Unit(s) 1-12, cut all trees that are 2 inches or more at DBH, with the following exceptions:

- Within Payment Units 1-9, do not cut any white pine or trees marked with green paint.
- Within Payment Unit 10 and 11, do not cut any trees marked with green paint.

Note: See spec 5.2.4.4 - 'Dead and down creation' for instructions on orange marked trees.

2.1.3 - Cut Tree Marked Unit(s) (12/08)

Within Payment Unit(s) 13, all trees are designated for cutting when marked with orange paint above and below stump height, regardless of merchantability.

3 - Payments

3.3 - Pre-measured Sales

3.3.4 - Dividing Payment Units (7/14)

Payment Unit(s) with a value over \$25,000 may be divided at the request of the Purchaser and upon approval of the Unit Manager. Dividing Payment Units is a contract modification which requires a Timber Sale Contract Amendment. There will be only one division per Payment Unit.

3.4 - Damaged Timber

3.4.1 - Damaged Timber (12/24)

General Condition and Requirement 3.4 Damaged Timber, defines liquidated damages for undesignated live merchantable trees which are cut or injured.

No damage is acceptable to undesignated live merchantable trees. Within the Sale Area, if more than 5% of trees (> 4.5" DBH) within a specified area of the sale are damaged, liquidated damages will be assessed for all trees damaged. Rates will be in accordance with General Condition and Requirement 3.4 Damaged Timber.

3.4.2 - Special Protection Trees (1/25)

The Purchaser shall not cut live or dead special protection trees within cutting units or clearings. Special protection trees are marked with green paint and greater than 26 inches in DBH. If Purchaser's operations have cut or damaged special protection trees through carelessness, the Purchaser shall pay \$250 as fixed, agreed and liquidated damages for each special protection tree cut or damaged. Such payment does not constitute ownership of the undesignated timber.

4 - Transportation

4.1 - Construction

4.1.3 - Slash and Earthen Piles (8/04)

Piles or windrows of earth along roads and landings that have been widened or constructed shall be leveled. Slash from road maintenance or construction, including stumps, shall be chipped, utilized or otherwise removed from the sale.

4.1.6 - Road Construction (4/24)

Construction of new roads or improvements of existing roads shall be done in such a way as to minimize the environmental and visual impacts. Merchantable trees shall be cut and utilized unless otherwise directed. Non-merchantable trees shall be severed and laid flat on the ground. Slash shall be scattered, and not left in windrows and kept a minimum of 10 feet back from the road edge. Stumps shall be set upright, not left on edge, and be moved at least 10 feet away from the road edge. Improved roads and constructed roads must not be unreasonably widened beyond 15 feet. Narrow access into some Payment Units will require widening and blading on lengths of state forest roads. Additional access timber must be piled separately for scaling by the Sale Administrator.

4.1.7 - Road Closure (10/11)

All new roads built into the sale must be blocked to vehicle traffic upon completion of the sale. Overgrown roads that are reopened shall be considered new roads. In general, this will require constructing a four (4') foot high berm of stumps and logs covered with earth. Stumps and brush must be placed along the remainder of the trail. These roads must be rendered impassable to cars and trucks. Contact the Sale Administrator for specific details of design and placement.

4.2 - Maintenance

4.2.5 - Two Wheel Drive Condition (2/04)

All existing trail roads on and adjacent to the Sale Area must be passable by two-wheel drive traffic for the duration of the sale.

5 - Operations

5.1 - Notification

5.1.1 - Pre-sale Conference (10/16)

A pre-sale conference between the Purchaser and Sale Administrator is required prior to beginning any operations to determine landing and road locations. The Unit Manager or his/her representative must be contacted at least 5 days in advance to schedule the conference.

5.1.3 - Well Heads and Natural Gas Pipelines (11/15)

The Purchaser is responsible for contacting the gas or pipeline company 30 days prior to operating equipment in the vicinity of well heads or natural gas pipelines.

Riverside Energy Michigan

10691 E Carter Rd, Suite 201

Traverse City, MI 49684

Tel: (231) 995-4000 (M-F, 8am-5pm)

24 HOUR EMERGENCY LINE: (989) 705-7665

(PIPELINE LEAK * SOUR GAS SMELL * FIRE * ACCIDENT)

5.1.4 - Post-Sale Conference (10/16)

A post-sale conference on site between the Purchaser and sale administrator is required 5 days prior to the completion of active logging operations to determine clean-up and repair of landings, road edges, and the fulfillment of other contract specifications.

5.1.6 - Utility R.O.W. (1/25)

It is the responsibility of the Purchaser to obtain permission from the utility company to utilize the power line right-of-way (R.O.W.) for operations.

PRESQUE ISLE ELECTRIC & GAS CO-OP

3149 Main Street
PO Box 308
Onaway, MI 49765-0308
HOURS OF OPERATION
Monday – Friday
8:00am – 4:30pm
Tel: (800)423-6634
GAS EMERGENCY LINE:
(800)655-8565

5.2 - Conduct of Operations

5.2.1 - Slash

5.2.1.10 - No Slash in Openings (5/10)

No brush or logging debris is to be left in maintained wildlife openings which are indicated by "G0" on the Timber Sale Map. Any damage to the opening shall be repaired according to specifications of the Unit Manager or his/her representative.

5.2.1.11 - Slash for Reforestation (3/21)

To protect oak stump sprout regeneration from browsing, chipping or removal of sub-merchantable oak treetops from Payment Units 11 and 12 is not permitted. Sub-merchantable oak tops/slash are to be placed high, adjacent, and surrounding harvested oak stumps with the goal of making the slash impenetrable by deer.

5.2.2 - Hazard Trees/Snags

5.2.2.1 - Den Trees (10/16)

Obvious hollow and/or den trees shall be protected and left standing unless they are a safety hazard.

5.2.3 - Operating Restrictions

5.2.3.3 - Bark Slippage Restriction (3/09)

Within Payment Unit(s) 13, unless changed by written agreement, cutting and skidding are not permitted during the period of April 15 to July 15. This restriction is because of bark slippage.

5.2.3.4 - Oak Wilt Restriction, No Exceptions (1/18)

Within Payment Unit 13, cutting, skidding, hauling within the sale and brushing of access roads to the sale are not permitted during the period of April 15 to July 15. No exceptions will be granted. This is necessary to reduce the spread of oak wilt.

5.2.3.5 - Oak Wilt Restriction (1/18)

Within Payment Units 1-12, unless changed by written agreement, cutting, skidding, hauling within the sale and brushing of access roads to the sale are not permitted during the period of April 15 to July 15. Operations may be allowed if specific steps are taken to prevent damaging uncut oak during the high-risk period. Those steps may include completing all road brushing before April 15 and clearing a tree-length buffer along uncut oak cover before April 15. This is necessary to reduce the spread of oak wilt. For more information, contact the Unit Manager or his/her representative.

5.2.3.11 - Coppice Regeneration Protection (4/10)

Timber harvesting in Payment Units 1-12 must be completed within 60 days of severing/cutting stem(s) to minimize damage to deciduous regeneration. Any post-harvest operations, such as chipping, must be completed before sprouting of regeneration occurs. If it is anticipated that chipping will be delayed, then tops shall be carried to one central location or left unchipped. The Unit Manager or his/her representative may cease such operations if sprouting occurs before the operation is complete.

5.2.4 - Dead and Down Creation

5.2.4.4 - Dead and Down Creation, Grouse (6/18)

To encourage grouse and other wildlife, in Payment Unit(s) 1-9, push over and leave all orange marked trees on the ground. If it is impractical to push the trees over, they may be cut or partially cut and pushed over. Tree crowns should touch the ground. These trees are scattered evenly throughout the unit, and preferably at least two chains from any

roads, two-tracks, or trails open to vehicles.

5.2.31 - Landing Locations (9/13)

Landing locations are shown on the Timber Sale Map. Landings must be confined to these designated sites unless otherwise authorized by the Unit Manager or his/her representative.

5.2.32 - Decking/Landing Restoration (9/13)

All decking and landing areas must have the surface area restored to a condition equal to or better than before. This is to ensure the proper regeneration of the stand. Wood debris, chips and "cookies" from trimmings must be removed or scattered away from landing and loading areas and may not be windrowed on the edge.

5.2.33 - Gas Well Revegetation (12/08)

In the event that the gas well is utilized for a landing, the site must be revegetated with a seeding mixture specified by the Unit Manager or his/her representative.

5.2.38 - No Decking Against Live Trees (2/04)

Cut products may not be decked against unmarked or designated leave trees.

5.3 - Stream Protection

5.3.1 - Operating Near Stream (1/25)

No tracked or wheeled vehicles shall be operated within 50 feet of the intermittent stream and drain along Payment Units 4 and 5, except at the approved state forest road crossing. No other crossings will be approved.

5.4 - Soil Protection

5.4.1 - Rutting Restriction, General (7/16)

Operations are to cease immediately if equipment and weather conditions result in rutting of roads and/or skid trails which is 12 inches or greater in depth and 50 feet in length. The Unit Manager or his/her representative may restrict hauling and/or skidding if ruts exceed the specified depth. With the Unit Manager or his/her representative's approval, the Purchaser may return to the area when the risk of rutting has decreased.

5.4.2 - Skid Trails (2/04)

Skid trails up and down slopes should be avoided. If, however, this is unavoidable, these trails will be left in a non-erodible condition using water bars, logs, and slash. Placing of slash on these skid trails while logging is ongoing may alleviate need for any further action. At the direction of the Sale Administrator, seed, fertilizer, and mulch may also be required.

5.5 - Protection of Improvements

5.5.3 - Protection of Improvements Detail (10/13)

The existing culvert within the state forest road along the west side of Payment Unit 4 must be protected from damage and restored to an equal or better condition.

5.8 - Protection of Endangered Species

5.8.5 - Protection of Raptor Nests (3/13)

All trees with raptor nests will be protected if found during harvesting operations. Notification will be made to the Unit Manager or his/her representative who will notify the Wildlife Biologist so an onsite evaluation and recommendation can be made, if necessary.



TIMBER SALE MAP

This information provided by authority of Part 525, 1994 PA 451, as amended.

Sale Number

54-007-24

Date

09/05/2024

Forest Management Unit

County

Mapped By: D. Coy

Scale

Page

Of

Atlanta Mgt Unit

Montmorency

Cruised By: D. Coy

1:15,840

1

2

Township
29N

Range
02E

Section(s) and
Subdivision(s) NENW,S1/2NW,NENE,S1/2NE,NESW;
Sec. 5 N1/2SE,SWSE; Sec. 5 NW,NWNE,S1/2NE,N1/2SW,SWSW; Sec. 6 N1/2SE; Sec. 6

Cover Type

A = Aspen	J = Jack Pine	O = Oak	U = Upland Brush
B = Paper Birch	K = Rock	P = Lowland Poplar	UM = Upland Mix Forest
C = Cedar	L = Lowland Brush	Q = Mixed Swamp Conifer	V = Bog or Marsh
D = Treed Bog	LM = Lowland Mix Forest	R = Red Pine	W = White Pine
E = Swamp Hardwoods	M = Maple, Beech, Birch	S = Black Spruce	X = Non Stocked
F = Spruce/Fir	MC = Mixed Conifer	T = Tamarack	Y = Sand
G = Grass	MD = Mixed Deciduous	Z = Water	
H = Hemlock	N = Marsh		

Density

0 = Non Stocked	5 = Pole Timber Medium
1 = Seedling Sapling Poor	6 = Pole Timber Well
2 = Seedling Sapling Medium	7 = Saw Timber Poor
3 = Seedling Sapling Well	8 = Saw Timber Medium
4 = Pole Timber Poor	9 = Saw Timber Well

Locator Map (1:150,000)

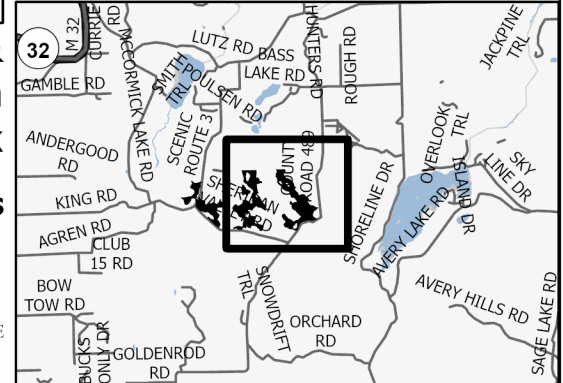

**Sheridan &
489 North
Aspen Oak**

223.7 Acres

PU #	Acres	PU #	Acres	PU #	Acres
1	17.1	6	15.7	11	7.2
2	18.6	7	15.8	12	14.8
3	29.1	8	21.7	13	17
4	15.8	9	24.6		
5	15.9	10	10.5		

0 0.25 0.5 1 Miles

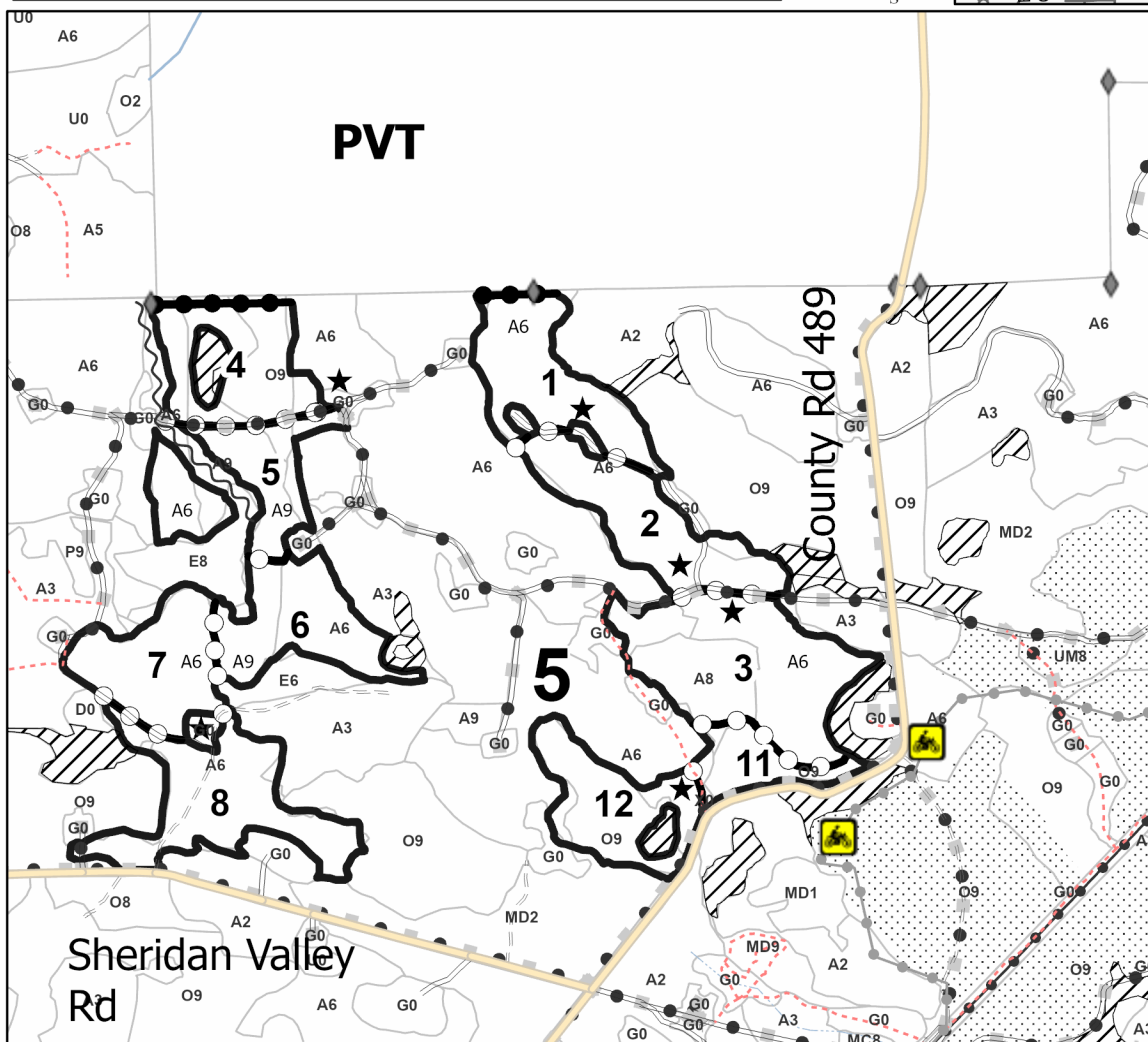

Legend

- Sale Boundary (Red)
- Stand
- Retention Areas (Red)
- Nearby Timber Sale
- Payment Unit (Yellow or Road)
- Private Line (Blue)
- Recreational Trail
- Intermittent Stream & Drain
- Secondary Forest Road
- Forest Access Route
- Administrative Access Only
- Non-DNR Road
- Pipeline
- Powerline
- Landing
- Survey Corner

Use QR Code to open Map in App





TIMBER SALE MAP

This information provided by authority of Part 525, 1994 PA 451, as amended.

Sale Number

54-007-24

Date

08/23/2024

Forest Management Unit

County

Mapped By: D. Coy

Scale

Page

Of

Atlanta Mgt Unit

Montmorency

Cruised By: D. Coy

1:15,840

2

2

Township
29N

Range
02E

Section(s) and Subdivision(s) NENW,S1/2NW,NENE,S1/2NE,NESW;
Sec. 5 N1/2SE,SWSE; Sec. 5 NW,NWNE,S1/2NE,N1/2SW,SWSW; Sec. 6 N1/2SE; Sec. 6

Cover Type

A = Aspen	J = Jack Pine	O = Oak	U = Upland Brush
B = Paper Birch	K = Rock	P = Lowland Poplar	UM = Upland Mix Forest
C = Cedar	L = Lowland Brush	Q = Mixed Swamp Conifer	V = Bog or Marsh
D = Treed Bog	LM = Lowland Mix Forest	R = Red Pine	W = White Pine
E = Swamp Hardwoods	M = Maple, Beech, Birch	S = Black Spruce	X = Non Stocked
F = Spruce/Fir	MC = Mixed Conifer	T = Tamarack	Y = Sand
G = Grass	MD = Mixed Deciduous	Z = Water	
H = Hemlock	N = Marsh		

Density

0 = Non Stocked	5 = Pole Timber Medium
1 = Seedling Sapling Poor	6 = Pole Timber Well
2 = Seedling Sapling Medium	7 = Saw Timber Poor
3 = Seedling Sapling Well	8 = Saw Timber Medium
4 = Pole Timber Poor	9 = Saw Timber Well

Locator Map (1:150,000)

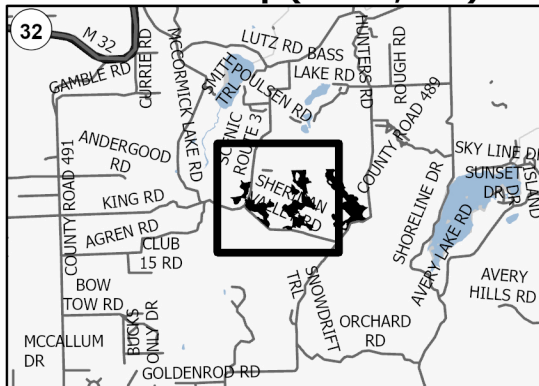

**Sheridan &
489 North
Aspen Oak**
223.7 Acres

PU #	Acres	PU #	Acres	PU #	Acres
1	17.1	6	15.7	11	7.2
2	18.6	7	15.8	12	14.8
3	29.1	8	21.7	13	17
4	15.8	9	24.6		
5	15.9	10	10.5		

0 0.25 0.5 1 Miles

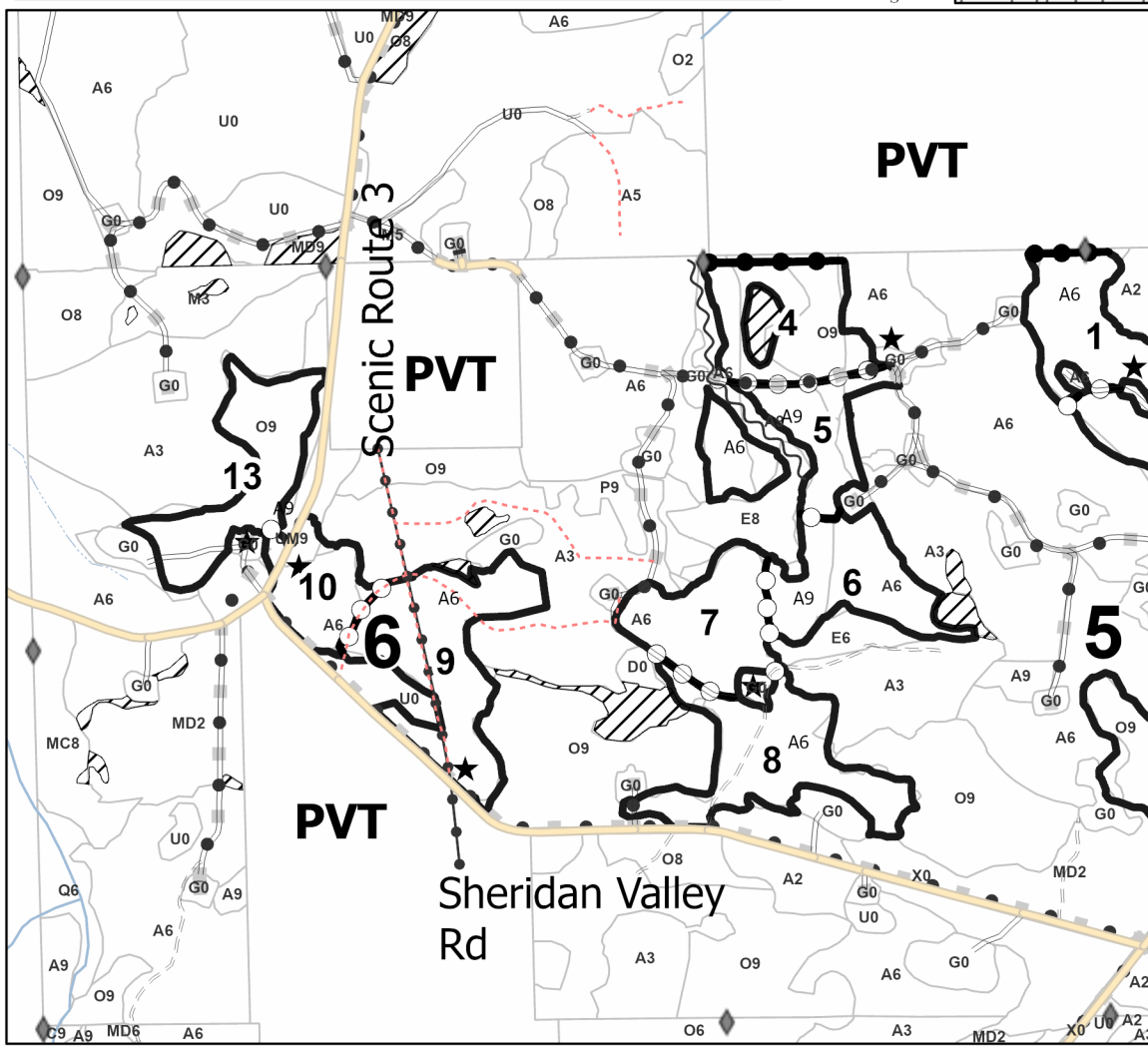

Legend

- Sale Boundary (Red)
- Stand
- Retention Areas
- Payment Unit (Yellow or Road)
- Private Line (Blue)
- Ephemeral Stream (No Crossing)
- Secondary Forest Road
- Forest Access Route
- Administrative Access Only
- Non-DNR Road
- Pipeline
- Powerline
- Landing
- Survey Corner

Use QR Code to open Map in App



TIMBER SALE INFORMATION

Bearly Aspen (54-029-24)

T34N, R07E, SEC. 29; T34N, R07E, SEC. 32.
Presque Isle County (Advertised Price \$6,575.50)

SALE NOTE: There are special protection trees in Payment Unit 1. Refer to sale spec 3.4.2 for details.

A timber sale contract for this lump sum, sealed bid timber sale will be awarded to the responsible bidder offering the highest sealed bid price. All units of volume listed below were estimated using the Inventory Manager computer program and the new Michigan taper model. Bids must be at or above the following advertised price for each product and species:

<u>PRODUCTS & SPECIES</u>	<u>ESTIMATED UNITS*</u>	<u>ADVERTISED PRICE</u>
Sawtimber		
Sugar Maple	10.4 MBF	\$ 165.00 / MBF
Pulpwood		
Balsam Fir	12 Cords	\$ 11.20 / Cord
Mixed Aspen	136 Cords	\$ 12.00 / Cord
Mixed Hardwood	129 Cords	\$ 12.95 / Cord
Mixed Spruce	27 Cords	\$ 7.95 / Cord
Paper Birch	115 Cords	\$ 8.95 / Cord
Red Pine	5 Cords	\$ 24.45 / Cord
White Pine	3 Cords	\$ 18.80 / Cord

* The total volume is statistically estimated within plus (+) or minus (-) 26.20 percent. There are an estimated 451 cords on this timber sale, plus or minus 118 cords at the 95% confidence level. The estimated units are final and not subject to adjustment. Prospective bidders are urged to examine this timber and to make their own estimates of quantity and quality.

BOND AND PAYMENT SCHEDULE:

- A bond in the amount of \$1,000.00 to insure faithful performance of the conditions of the contract will be deposited by the successful bidder within 21 days of the sale award.
- Cutting in any sale or unit without the required advance payment would be considered a trespass.
- Total payment must be paid in advance or according to the following schedule :
 - Ten percent (10%) of the sale value must be paid within 21 days of the sale award.
 - The 10% down payment will be credited towards the first unit cut.
 - Payment for each of the following units must be made before cutting begins in that unit:

PAYMENT UNIT NUMBER	PERCENT OF TOTAL SALE VALUE
01	36.2%
02	63.8%
- If no cutting takes place, the 10% down payment will not be refunded.
- Operations on the contract issued will terminate on 06/30/2027.

SALE STATISTICS

Volumes were calculated in cubic feet using the Michigan taper model. Cubic foot volume includes all wood inside bark for the product indicated. For display purposes, cubic feet were converted to cords and MBF using a simple conversion factor, e.g. 79 cubic feet per cord and 185 cubic feet per MBF. The cubic foot volumes are precise; the cords and MBF volumes are not. Cubic foot volume cannot be directly converted to cords or boards with precision.

SALE VOLUMES

The total estimated sale volume may not equal the sum of the species/products due to the nature of statistical calculations associated with double sampling methodology.

VOLUME		STATISTICAL RANGE IN CORDS		
TOTAL CUBIC FEET	TOTAL CORDS	PERCENT ERROR	MINIMUM	MAXIMUM
35,616	451	26.20%	333	569

VDU VOLUMES

A VDU is a Volume Determination Unit. Volumes and their associated statistics are calculated at the VDU level and summarized to the sale level. There is often a one to one relationship between a VDU and a Payment Unit, but not always, depending on the cruise design. Refer to the VDU TO PAYMENT UNIT table.

VDU	VOLUME		PERCENT ERROR	RANGE IN CORDS	
	TOTAL CUBIC FEET	TOTAL CORDS		MINIMUM	MAXIMUM
48	10,485	133	46.68%	71	195
71	25,131	318	32.84%	214	423
TOTAL:	35,616	451		284	617

VDU TO PAYMENT UNIT

When a VDU is associated with more than one Payment Unit (PU), the VDU volumes are assigned to the PU based on acres of the VDU within the PU.

VDU	VDU ACRES	PU	PU ACRES
48	8.3	1	8.3
71	20.3	2	20.3
TOTAL:	28.6		28.6

DESCRIPTION OF TIMBER BY PAYMENT UNIT (PU)

PU	MARKET GROUP	PRODUCT	QUANTITY	UNIT	ACRES	ADVERTISE PRICE
1	Sugar Maple	Sawtimber	5.7	MBF	8.3	\$2,378.15
	Mixed Aspen	Pulpwood	23	Cords		
	<i>Quaking Aspen</i>		23	<i>Cords</i>		
	Mixed Hardwood		54	Cords		
	<i>Sugar Maple</i>		54	<i>Cords</i>		
	Paper Birch		38	Cords		
	Red Pine		5	Cords		
	<i>Red Pine</i>	<i>Sawtimber</i>	0.6	<i>MBF</i>		
<i>Red Pine</i>	<i>Pulpwood</i>	4	<i>Cords</i>			
2	Sugar Maple	Sawtimber	4.7	MBF	20.3	\$4,197.35
	Balsam Fir	Pulpwood	12	Cords		
	Mixed Aspen		113	Cords		
	<i>B. T. Aspen</i>		22	<i>Cords</i>		
	<i>Quaking Aspen</i>		91	<i>Cords</i>		
	Mixed Hardwood		75	Cords		
	<i>Ironwood</i>		18	<i>Cords</i>		
	<i>Sugar Maple</i>		57	<i>Cords</i>		
	Mixed Spruce		27	Cords		
	<i>Black Spruce</i>		11	<i>Cords</i>		
	<i>White Spruce</i>		16	<i>Cords</i>		
	Paper Birch		77	Cords		
	White Pine		3	Cords		
	<i>White Pine</i>	<i>Sawtimber</i>	1.2	<i>MBF</i>		
	<i>White Pine</i>	<i>Pulpwood</i>	1	<i>Cords</i>		
TOTAL:			10.4	MBF		
TOTAL:			427	Cords		

Sale Specific Conditions & Requirements

Sale Name: Bearly Aspen

Sale Number: 54-029-24 Seq#: 2

1 - Sale Area

1.2 - Boundaries

1.2.1 - Painted Boundaries (9/19)

The sale boundary and Payment Unit boundaries are marked and identified by blue and red paint. Exterior sale boundary lines against private property are marked with blue paint. Exterior sale boundary lines against state are marked with red paint. Retention patches are marked with red paint; no harvesting activities may occur within these areas. The painted boundary line trees are not Included Timber and are to be protected.

2 - Timber Specifications

2.1 - Included Timber

2.1.1 - Clearcut Unit(s) with Unmerchantable Trees (6/14)

Within Payment Unit(s) 1 and 2, cut all trees that are 2 inches or more at DBH, except do not cut trees marked with teal paint in Payment Unit 1.

Special protection trees identified in accordance with 3.4.2, within clearcutting unit boundaries, are not Included Timber and are to be protected.

3 - Payments

3.4 - Damaged Timber

3.4.2 - Special Protection Trees (4/14)

The Purchaser shall not cut live or dead special protection trees within cutting units or clearings. Special protection trees are marked with teal paint. If the Purchaser's operations have cut or damaged special protection trees through carelessness, the Purchaser shall pay \$250 as fixed, agreed and liquidated damages for each special protection tree cut or damaged. Such payment does not constitute ownership of the undesignated timber.

4 - Transportation

4.1 - Construction

4.1.3 - Slash and Earthen Piles (8/04)

Piles or windrows of earth along roads and landings that have been widened or constructed shall be leveled. Slash from road maintenance or construction, including stumps, shall be dispersed throughout the sale, chipped, utilized or otherwise removed from the sale.

4.1.6 - Road Construction (4/24)

Construction of new roads or improvements of existing roads shall be done in such a way as to minimize the environmental and visual impacts. Merchantable trees shall be cut and utilized unless otherwise directed. Non-merchantable trees shall be severed and laid flat on the ground. Slash shall be scattered, and not left in windrows and kept a minimum of 10 feet back from the road edge. Stumps shall be set upright, not left on edge, and be moved at least 10 feet away from the road edge. Disturbed soil shall be feathered into the woods and not left in berms or windrows.

4.1.7 - Road Closure (10/11)

All new roads built into the sale must be blocked to vehicle traffic upon completion of the sale. Overgrown roads that are reopened shall be considered new roads. These roads must be rendered impassable to cars and trucks. All stumps from road building and landing construction must be reserved to block any newly constructed roads upon completion of the sale. These stumps must be scattered along the road system to prohibit vehicular movement. Temporary berms may be required if no sale activity occurs for 30 or more consecutive days. Contact the Sale Administrator for specific details of design and placement.

4.2 - Maintenance

4.2.5 - Two Wheel Drive Condition (2/04)

All existing trail roads on and adjacent to the Sale Area must be passable by two-wheel drive traffic for the duration of the sale.

5 - Operations

5.1 - Notification

5.1.1 - Pre-sale Conference (10/16)

A pre-sale conference on site between the Purchaser and Sale Administrator is required prior to beginning any operations to determine landing and road locations. The Unit Manager or his/her representative must be contacted at least 5 days in advance to schedule the conference.

5.1.4 - Post-Sale Conference (10/16)

A post-sale conference on site between the Purchaser and sale administrator is required 5 days prior to the completion of active logging operations to determine clean-up and repair of landings, road edges, and the fulfillment of other contract specifications.

5.2 - Conduct of Operations

5.2.2 - Hazard Trees/Snags

5.2.2.1 - Den Trees (10/16)

Obvious hollow and/or den trees shall be protected and left standing unless they are a safety hazard.

5.2.3 - Operating Restrictions

5.2.3.11 - Coppice Regeneration Protection (4/10)

Timber harvesting in Payment Unit 2 must be completed before significant aspen sprouting occurs in that Payment Unit so as to minimize damage to the new regeneration. Any post-harvest operations, such as chipping, must be completed before sprouting of regeneration occurs. If it is anticipated that chipping will be delayed, then tops shall be carried to one central location or left unchipped. The Unit Manager or his/her representative may cease such operations if sprouting occurs before the operation is complete.

5.2.4 - Dead and Down Creation

5.2.4.4 - Dead and Down Creation, Grouse (6/18)

To encourage grouse and other wildlife, in Payment Unit(s) 2, leave one 12-inch diameter or larger log-length (8ft minimum) piece or whole tree on the ground for every two acres, preferably a hardwood species such as oak or maple or if no hardwoods present, a pine species (white or red). These trees will be scattered throughout the unit, preferably at least two chains from any roads, two-tracks, or trails open to vehicles.

5.2.32 - Decking/Landing Restoration (9/13)

All decking and landing areas must have the surface area restored to a condition equal to or better than before. This is to ensure the proper regeneration of the stand. Wood debris, chips and "cookies" from trimmings must be removed or scattered away from landing and loading areas and may not be windrowed on the edge.

5.2.38 - No Decking Against Live Trees (2/04)

Cut products may not be decked against unmarked or designated leave trees.

5.4 - Soil Protection

5.4.1 - Rutting Restriction, General (7/16)

Operations are to cease immediately if equipment and weather conditions result in rutting of roads and/or skid trails which is 12 inches or greater in depth and 50 feet in length. The Unit Manager or his/her representative may restrict hauling and/or skidding if ruts exceed the specified depth. With the Unit Manager or his/her representative's approval, the Purchaser may return to the area when the risk of rutting has decreased.

5.8 - Protection of Endangered Species

5.8.5 - Protection of Raptor Nests (3/13)

All trees with raptor nests will be protected if found during harvesting operations. Notification will be made to the Unit Manager or his/her representative who will notify the Wildlife Biologist so an onsite evaluation and recommendation can be

made, if necessary.

6 - Safety and Fire Prevention

6.2 - Signing

6.2.1 - Road Posting (10/20)

The Purchaser is responsible for posting and maintaining caution signs on Miller Road prior to beginning operations. The road must be posted at appropriate distances from the Sale Area to warn of logging activity and truck traffic. Signs must be removed when harvest operations are suspended or completed. The Purchaser will provide these signs.

TIMBER SALE MAP

This information provided by authority of Part 525, 1994 PA 451, as amended.

Sale Number

54-029-24

Date

09/20/2024

Forest Management Unit

Atlanta Mgt Unit

County

Presque Isle

Mapped By: Allison Bundschuh

Cruised By: Allison Bundschuh

Scale

1:10,000

Page

1

Of

2Township
34NRange
07E

Section(s) and

Subdivision(s) Sec. 29 SENW,NESW,NWSE; Sec. 32 W1/2NE;

Cover Type

A = Aspen	J = Jack Pine	O = Oak	U = Upland Brush
B = Paper Birch	K = Rock	P = Lowland Poplar	UM = Upland Mix Forest
C = Cedar	L = Lowland Brush	Q = Mixed Swamp Conifer	V = Bog or Marsh
D = Treed Bog	LM = Lowland Mix Forest	R = Red Pine	W = White Pine
E = Swamp Hardwoods	M = Maple, Beech, Birch	S = Black Spruce	X = Non Stocked
F = Spruce/Fir	MC = Mixed Conifer	T = Tamarack	Y = Sand
G = Grass	MD = Mixed Deciduous	Z = Water	
H = Hemlock	N = Marsh		

Density

0 = Non Stocked	5 = Pole Timber Medium
1 = Seedling Sapling Poor	6 = Pole Timber Well
2 = Seedling Sapling Medium	7 = Saw Timber Poor
3 = Seedling Sapling Well	8 = Saw Timber Medium
4 = Pole Timber Poor	9 = Saw Timber Well

Locator Map (1:100,000)**PU # Acres**

1	8.3
2	20.3

**Bearly Aspen
28.6 Acres**

0 0.15 0.3 0.6 Miles

**Legend**

- Sale Boundary-Red
- Stand
- Retention Areas
- Primary Forest Road
- Forest Access Route
- Administrative Access Only
- Paved Road
- Government Gravel/Dirt
- Private Gravel/Dirt

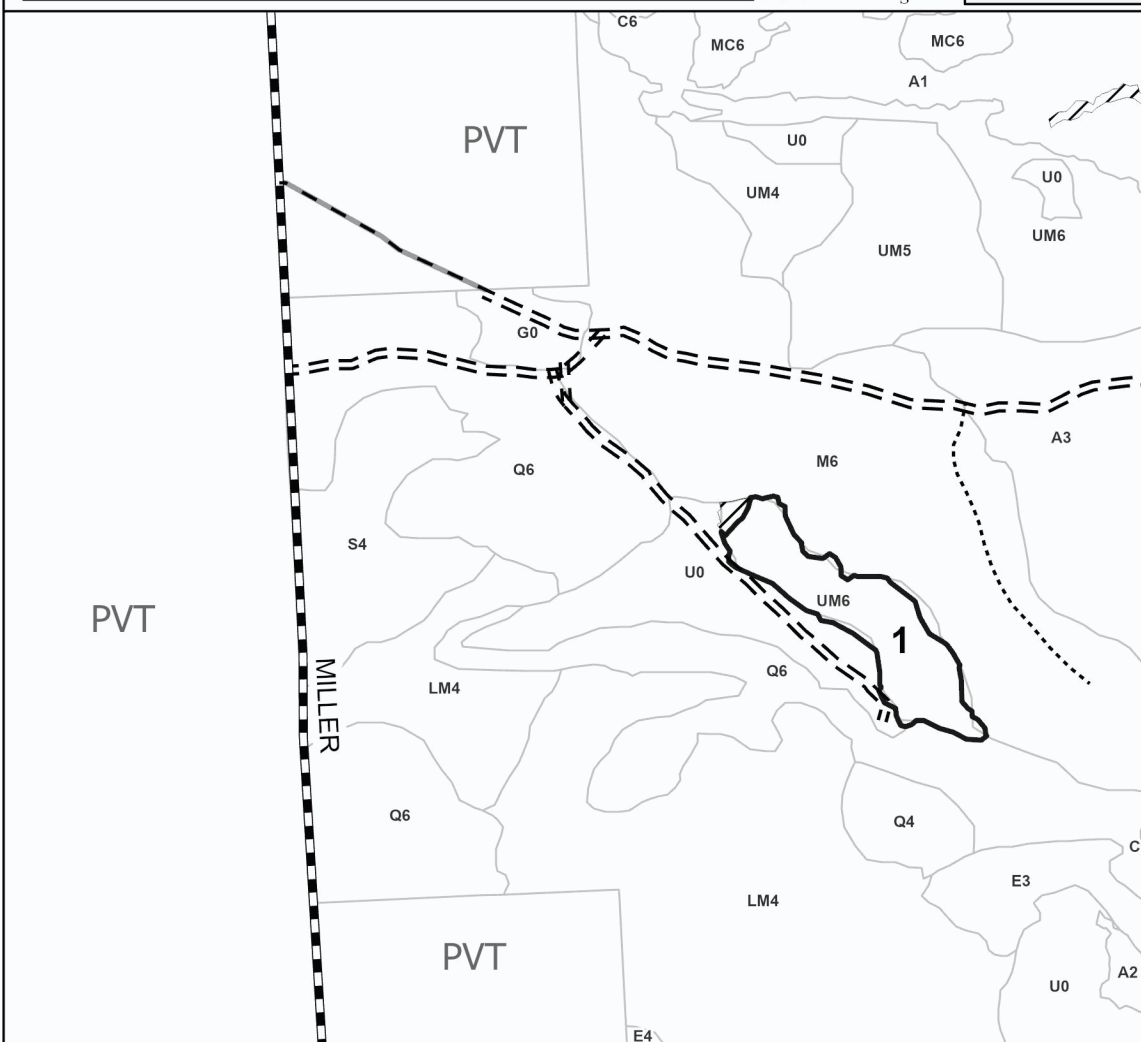

Use QR Code to open Map in App



TIMBER SALE MAP

This information provided by authority of Part 525, 1994 PA 451, as amended.

Sale Number

54-029-24

Date

09/20/2024

Forest Management Unit

County

Mapped By: Allison Bundschuh

Scale

Page

Of

Atlanta Mgt Unit

Presque Isle

Cruised By: Allison Bundschuh

1:10,000**2****2**Township
34NRange
07ESection(s) and
Subdivision(s) Sec. 29 SENW,NESW,NWSE; Sec. 32 W1/2NE;**Cover Type**

A = Aspen	J = Jack Pine	O = Oak	U = Upland Brush
B = Paper Birch	K = Rock	P = Lowland Poplar	UM = Upland Mix Forest
C = Cedar	L = Lowland Brush	Q = Mixed Swamp Conifer	V = Bog or Marsh
D = Treed Bog	LM = Lowland Mix Forest	R = Red Pine	W = White Pine
E = Swamp Hardwoods	M = Maple, Beech, Birch	S = Black Spruce	X = Non Stocked
F = Spruce/Fir	MC = Mixed Conifer	T = Tamarack	Y = Sand
G = Grass	MD = Mixed Deciduous	Z = Water	
H = Hemlock	N = Marsh		

Density

0 = Non Stocked	5 = Pole Timber Medium
1 = Seedling Sapling Poor	6 = Pole Timber Well
2 = Seedling Sapling Medium	7 = Saw Timber Poor
3 = Seedling Sapling Well	8 = Saw Timber Medium
4 = Pole Timber Poor	9 = Saw Timber Well

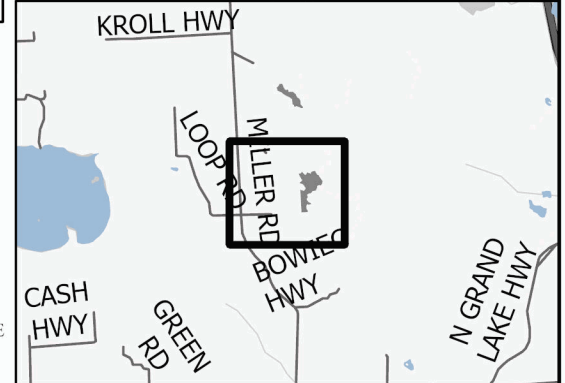
Locator Map (1:100,000)**PU # Acres**

1	8.3
2	20.3

Bearly Aspen**28.6 Acres**

0 0.15 0.3 0.6 Miles

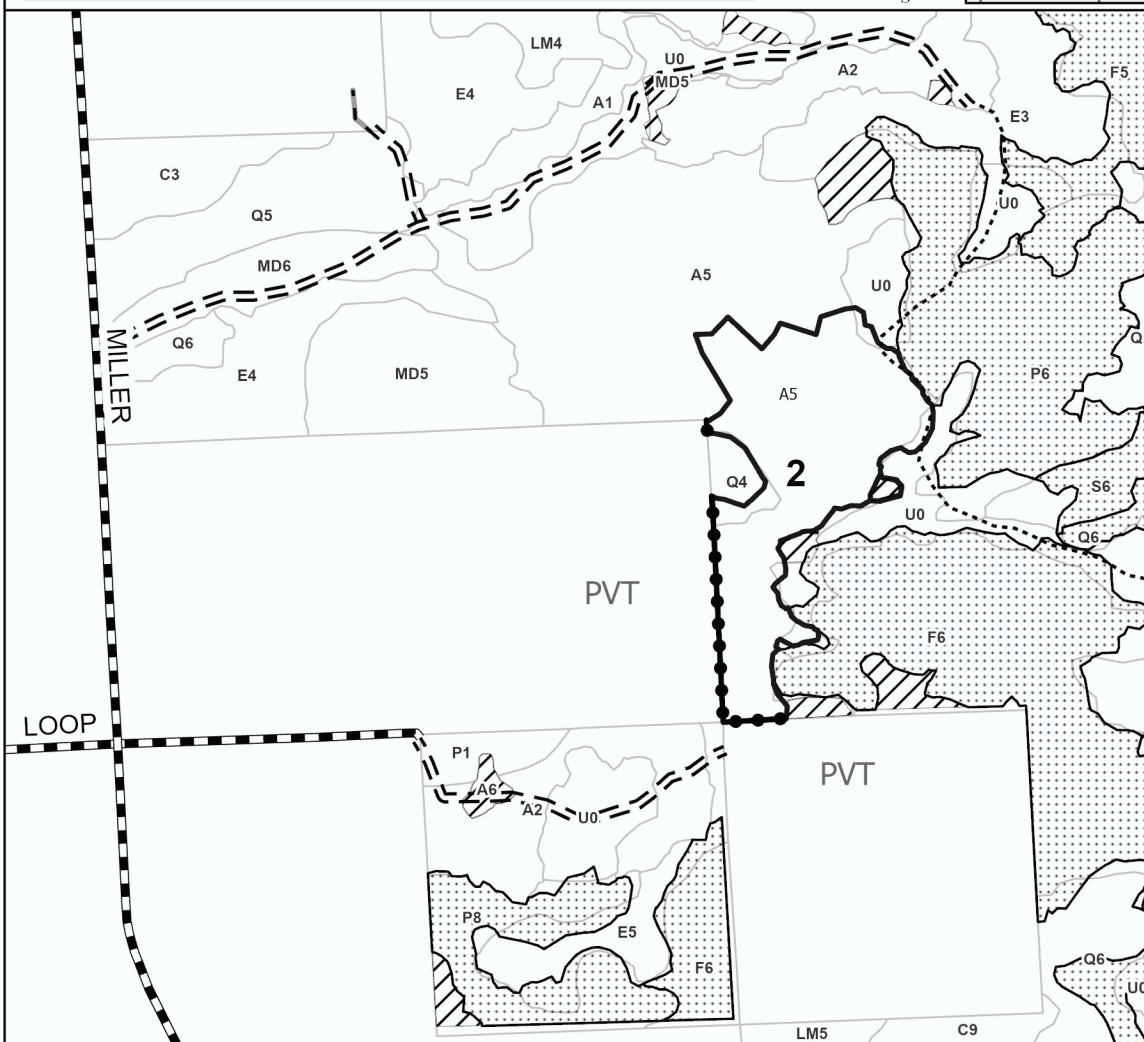
**Legend**

- Sale Boundary-Red
- Nearby Timber Sale
- Stand
- Retention Areas
- Private Line (Blue)
- Primary Forest Road
- Forest Access Route
- Administrative Access Only
- Paved Road
- Government Gravel/Dirt
- Private Gravel/Dirt

Use QR Code to open Map in App



Sheridan & 489 East Aspen Oak (54-006-24)
T29N, R02E, SEC. 4; T29N, R02E, SEC. 5; Montmorency COUNTY

In response to the notice of sale to be held 10:00 a.m. (local time) on April 22, 2025, I am hereby submitting my sealed bid (firm offer) for the following forest products to be cut. Bids for individual species must be at or above the advertised price. All non-responsive bid forms may be rejected.

PRODUCTS & SPECIES	ESTIMATED VOLUME*	ADVERTISED PRICE	BID PRICE/UNIT
Sawtimber			
Black/Red (Hybrid) Oak	10.1 MBF	\$ 95.00/MBF	\$ _____
Mixed Aspen	36.2 MBF	\$ 78.00/MBF	\$ _____
Red Maple	11.7 MBF	\$ 51.00/MBF	\$ _____
Red Oak	460.6 MBF	\$ 179.00/MBF	\$ _____
Red Pine	21.0 MBF	\$ 117.00/MBF	\$ _____
White Oak	65.7 MBF	\$ 70.00/MBF	\$ _____
Pulpwood			
Mixed Aspen	848 Cords	\$ 17.95/Cord	\$ _____
Mixed Oak	1,417 Cords	\$ 21.60/Cord	\$ _____
Red Maple	259 Cords	\$ 19.45/Cord	\$ _____
Red Pine	55 Cords	\$ 36.65/Cord	\$ _____

*The volumes are statistically estimated within plus (+) or minus (-) 12.70 percent at 95% confidence level. These estimated volumes are final and not subject to adjustment. Prospective bidders are urged to examine this timber and to make their own estimates of quantity and quality.

I understand that any or all bids may be rejected. All bids must be signed and all bid items must be bid or the bid form may be rejected. I also understand that consideration and awarding a contract will be based upon my past performance and ability to complete the contract based upon equipment and staffing subject to my control.

FEDERAL ID: ____ - ____ - ____ or SOCIAL SECURITY NUMBER: ____ - ____ - ____

Company or individual bidding: _____

Company representative's name: _____

Address: _____

City: _____ State: _____ Zip: _____

IF AVAILABLE, PLEASE PLACE THE PERSONALIZED LABEL FROM YOUR PROSPECTUS IN THE ABOVE BOX.

Individual or company representative's signature: _____ Date: _____

Phone number : _____ Email (optional): _____

THE WINNING BIDDER MUST COMPLETE THE VERIFICATION OF WORKER'S DISABILITY COMPENSATION ACT COMPLIANCE (ON REVERSE SIDE IF DOUBLE SIDED) WITHIN 21 DAYS OF SALE AWARD DATE



TIMBER SALE VERIFICATION OF WORKER'S DISABILITY COMPENSATION ACT COMPLIANCE

As required by Act 317, P.A. 1969 (Worker's Compensation) and
Part 5 of Act 451 of 1994, as amended.

FOR DEPARTMENT USE ONLY

Sale Number (XX - XXX - XX - XX)

Forest Management Unit:

VERIFICATION OF WORKER'S DISABILITY COMPENSATION ACT COMPLIANCE

- This verification must be completed and submitted within 21 days of contract award and prior to the issuance of the timber sale contract.
- In addition, if boxes 2B or 2C are checked, then Notice of Exclusion or Certificate of Insurance must be submitted within twenty-one (21) days of the contract award and prior to the issuance of the timber sale contract.
- All information must be typed or printed except for written signatures.

Please Check Appropriate Categories:

1. My business is organized as (you **must** check one of the boxes below):
 - A. ☐ Sole Proprietorship (individual)
 - B. ☐ Partnership
 - C. ☐ Corporation
2. You **must** check one of the boxes below:
 - A. ☐ I certify my business is a sole proprietorship and it has no employees but the sole proprietor. I am not subject to the Worker's Compensation Laws.
 - B. ☐ I certify my business has satisfied its obligation to the Worker's Compensation Act through the use of an approved Notice of Exclusion (BWC-337, Rev. 5/96). I will provide a copy of the Notice of Exclusion within 21 days of the contract award. (For questions or a copy of the BWC-337, please call the Worker's Compensation Bureau at 517-322-1195).
 - C. ☐ I certify my business has a Worker's Compensation Policy. I will provide an original Certificate of Insurance within twenty-one (21) days of the contract award.
3. If you have checked item 2(A) or 2(B), you **must** indicate the number of **both** full-time and part-time employees, other than yourself, including family members and active partners (if none, you must enter "0").

_____ Full-time Employees

_____ Part-time Employees

Name of Business		Federal ID (or) Social Security No.
Address		Telephone ()
City	State	ZIP

I hereby certify that the above information is true and correct. I agree to notify the Michigan DNR of any changes that occur in factors affecting my coverage during any of my present and future operations.

Signature of Owner or Authorized Representative

Title

Date

Please complete the "SEALED BID" information on the next page

Sheridan & 489 North Aspen Oak (54-007-24)
T29N, R02E, SEC. 5; T29N, R02E, SEC. 6; Montmorency COUNTY

In response to the notice of sale to be held 10:00 a.m. (local time) on April 22, 2025, I am hereby submitting my sealed bid (firm offer) for the following forest products to be cut. Bids for individual species must be at or above the advertised price. All non-responsive bid forms may be rejected.

PRODUCTS & SPECIES	ESTIMATED VOLUME*	ADVERTISED PRICE	BID PRICE/UNIT
Sawtimber			
Mixed Aspen	353.7 MBF	\$ 78.00/MBF	\$ _____
Red Maple	32.8 MBF	\$ 51.00/MBF	\$ _____
Red Oak	423.9 MBF	\$ 179.00/MBF	\$ _____
Red Pine	17.8 MBF	\$ 117.00/MBF	\$ _____
Sugar Maple	13.4 MBF	\$ 247.00/MBF	\$ _____
White Oak	34.0 MBF	\$ 70.00/MBF	\$ _____
Pulpwood			
Balsam Fir	17 Cords	\$ 16.80/Cord	\$ _____
Basswood	16 Cords	\$ 17.15/Cord	\$ _____
Mixed Aspen	2,872 Cords	\$ 17.95/Cord	\$ _____
Mixed Hardwood	1,213 Cords	\$ 19.45/Cord	\$ _____
Mixed Oak	902 Cords	\$ 21.60/Cord	\$ _____
Paper Birch	33 Cords	\$ 13.40/Cord	\$ _____
Red Pine	12 Cords	\$ 36.65/Cord	\$ _____

*The volumes are statistically estimated within plus (+) or minus (-) 12.19 percent at 95% confidence level. These estimated volumes are final and not subject to adjustment. Prospective bidders are urged to examine this timber and to make their own estimates of quantity and quality.

I understand that any or all bids may be rejected. All bids must be signed and all bid items must be bid or the bid form may be rejected. I also understand that consideration and awarding a contract will be based upon my past performance and ability to complete the contract based upon equipment and staffing subject to my control.

FEDERAL ID: ____ - ____ - ____ or SOCIAL SECURITY NUMBER: ____ - ____ - ____
Company or individual bidding: _____
Company representative's name: _____
Address: _____
City: _____ State: _____ Zip: _____

IF AVAILABLE, PLEASE PLACE THE PERSONALIZED LABEL FROM YOUR PROSPECTUS IN THE ABOVE BOX.

Individual or company representative's signature: _____ Date: _____

Phone number : _____ Email (optional): _____

**THE WINNING BIDDER MUST COMPLETE THE VERIFICATION OF WORKER'S DISABILITY COMPENSATION ACT
COMPLIANCE (ON REVERSE SIDE IF DOUBLE SIDED) WITHIN 21 DAYS OF SALE AWARD DATE**



TIMBER SALE VERIFICATION OF WORKER'S DISABILITY COMPENSATION ACT COMPLIANCE

As required by Act 317, P.A. 1969 (Worker's Compensation) and
Part 5 of Act 451 of 1994, as amended.

FOR DEPARTMENT USE ONLY

Sale Number (XX - XXX - XX - XX)

Forest Management Unit:

VERIFICATION OF WORKER'S DISABILITY COMPENSATION ACT COMPLIANCE

- This verification must be completed and submitted within 21 days of contract award and prior to the issuance of the timber sale contract.
- In addition, if boxes 2B or 2C are checked, then Notice of Exclusion or Certificate of Insurance must be submitted within twenty-one (21) days of the contract award and prior to the issuance of the timber sale contract.
- All Information must be typed or printed except for written signatures.

Please Check Appropriate Categories:

1. My business is organized as (you **must** check one of the boxes below):
 - A. ☐ Sole Proprietorship (individual)
 - B. ☐ Partnership
 - C. ☐ Corporation
2. You **must** check one of the boxes below:
 - A. ☐ I certify my business is a sole proprietorship and it has no employees but the sole proprietor. I am not subject to the Worker's Compensation Laws.
 - B. ☐ I certify my business has satisfied its obligation to the Worker's Compensation Act through the use of an approved Notice of Exclusion (BWC-337, Rev. 5/96). I will provide a copy of the Notice of Exclusion within 21 days of the contract award. (For questions or a copy of the BWC-337, please call the Worker's Compensation Bureau at 517-322-1195).
 - C. ☐ I certify my business has a Worker's Compensation Policy. I will provide an original Certificate of Insurance within twenty-one (21) days of the contract award.
3. If you have checked item 2(A) or 2(B), you **must** indicate the number of **both** full-time and part-time employees, other than yourself, including family members and active partners (if none, you must enter "0").

_____ Full-time Employees

_____ Part-time Employees

Name of Business		Federal ID (or) Social Security No.
Address		Telephone ()
City	State	ZIP

I hereby certify that the above information is true and correct. I agree to notify the Michigan DNR of any changes that occur in factors affecting my coverage during any of my present and future operations.

Signature of Owner or Authorized Representative

Title

Date

Please complete the "SEALED BID" information on the next page

Bearly Aspen (54-029-24)

T34N, R07E, SEC. 29; T34N, R07E, SEC. 32; Presque Isle COUNTY

In response to the notice of sale to be held 10:00 a.m. (local time) on April 22, 2025, I am hereby submitting my sealed bid (firm offer) for the following forest products to be cut. Bids for individual species must be at or above the advertised price. All non-responsive bid forms may be rejected.

<u>PRODUCTS & SPECIES</u>	<u>ESTIMATED VOLUME*</u>	<u>ADVERTISED PRICE</u>	<u>BID PRICE/UNIT</u>
Sawtimber			
Sugar Maple	10.4 MBF	\$ 165.00/MBF	\$ _____
Pulpwood			
Balsam Fir	12 Cords	\$ 11.20/Cord	\$ _____
Mixed Aspen	136 Cords	\$ 12.00/Cord	\$ _____
Mixed Hardwood	129 Cords	\$ 12.95/Cord	\$ _____
Mixed Spruce	27 Cords	\$ 7.95/Cord	\$ _____
Paper Birch	115 Cords	\$ 8.95/Cord	\$ _____
Red Pine	5 Cords	\$ 24.45/Cord	\$ _____
White Pine	3 Cords	\$ 18.80/Cord	\$ _____

*The volumes are statistically estimated within plus (+) or minus (-) 26.20 percent at 95% confidence level. These estimated volumes are final and not subject to adjustment. Prospective bidders are urged to examine this timber and to make their own estimates of quantity and quality.

I understand that any or all bids may be rejected. All bids must be signed and all bid items must be bid or the bid form may be rejected. I also understand that consideration and awarding a contract will be based upon my past performance and ability to complete the contract based upon equipment and staffing subject to my control.

FEDERAL ID: ____ - ____ - ____ or SOCIAL SECURITY NUMBER: ____ - ____ - ____

Company or individual bidding: _____

Company representative's name: _____

Address: _____

City: _____ State: _____ Zip: _____

IF AVAILABLE, PLEASE PLACE THE PERSONALIZED LABEL FROM YOUR PROSPECTUS IN THE ABOVE BOX.

Individual or company representative's signature: _____ Date: _____

Phone number : _____ Email (optional): _____

**THE WINNING BIDDER MUST COMPLETE THE VERIFICATION OF WORKER'S DISABILITY COMPENSATION ACT
COMPLIANCE (ON REVERSE SIDE IF DOUBLE SIDED) WITHIN 21 DAYS OF SALE AWARD DATE**



TIMBER SALE VERIFICATION OF WORKER'S DISABILITY COMPENSATION ACT COMPLIANCE

As required by Act 317, P.A. 1969 (Worker's Compensation) and
Part 5 of Act 451 of 1994, as amended.

FOR DEPARTMENT USE ONLY

Sale Number (XX - XXX - XX - XX)

Forest Management Unit:

VERIFICATION OF WORKER'S DISABILITY COMPENSATION ACT COMPLIANCE

- This verification must be completed and submitted within 21 days of contract award and prior to the issuance of the timber sale contract.
- In addition, if boxes 2B or 2C are checked, then Notice of Exclusion or Certificate of Insurance must be submitted within twenty-one (21) days of the contract award and prior to the issuance of the timber sale contract.
- All Information must be typed or printed except for written signatures.

Please Check Appropriate Categories:

1. My business is organized as (you **must** check one of the boxes below):
 - A. ☐ Sole Proprietorship (individual)
 - B. ☐ Partnership
 - C. ☐ Corporation
2. You **must** check one of the boxes below:
 - A. ☐ I certify my business is a sole proprietorship and it has no employees but the sole proprietor. I am not subject to the Worker's Compensation Laws.
 - B. ☐ I certify my business has satisfied its obligation to the Worker's Compensation Act through the use of an approved Notice of Exclusion (BWC-337, Rev. 5/96). I will provide a copy of the Notice of Exclusion within 21 days of the contract award. (For questions or a copy of the BWC-337, please call the Worker's Compensation Bureau at 517-322-1195).
 - C. ☐ I certify my business has a Worker's Compensation Policy. I will provide an original Certificate of Insurance within twenty-one (21) days of the contract award.
3. If you have checked item 2(A) or 2(B), you **must** indicate the number of **both** full-time and part-time employees, other than yourself, including family members and active partners (if none, you must enter "0").

_____ Full-time Employees

_____ Part-time Employees

Name of Business		Federal ID (or) Social Security No.
Address		Telephone ()
City	State	ZIP

I hereby certify that the above information is true and correct. I agree to notify the Michigan DNR of any changes that occur in factors affecting my coverage during any of my present and future operations.

Signature of Owner or Authorized Representative

Title

Date

Please complete the "SEALED BID" information on the next page