



**DEPARTMENT OF NATURAL RESOURCES
STATE OF MICHIGAN
TIMBER SALE PROSPECTUS #7867**

SCHEDULED SALE DATE AND TIME: 9:00 a.m. (local time) on July 13, 2026.

LOCATION: GRAYLING MGMT UNIT, 1955 HARTWICK PINES ROAD, GRAYLING, MI 49738.

PROSPECTUS NOTE: The bidder is advised to inspect the sale area and review the location, estimated volumes, operating costs and contract terms of proposed sales. Please be aware that some landowners may request 60 days or more notice for access across their land.

Notice is hereby given that bids will be received by the Unit Manager, GRAYLING MANAGEMENT UNIT, for certain timber on the following described lands:

GNA2 Cooke Dam RP (72-804-26) / T24N, R07E, SEC. 27, W1/2SW.

T24N, R07E, SEC. 28, SENW,NENE,S1/2NE,E1/2SW,SE.

T24N, R07E, SEC. 33, N1/2NW,NWNE.

Iosco County, Advertised Price \$103,411.95, 241.9 Acres, Red Pine, Hardwood.

SALE NOTE: The area encompassed by this timber sale is not certified to the standards of the Forest Stewardship Council (FSC) or the Sustainable Forestry Initiative (SFI). Forest products from this sale may not be delivered to the mill as "FSC and / or SFI certified". The lands within this sale belong to the National Forest system and are being managed by the State as part of a Good Neighbor Authority (GNA) agreement. Oak wilt restrictions, no exception.

EMR restrictions in PU 5, operations can only occur November 1 - April 30. Special protection area located in PU 3.

Operating Restrictions in PU 1 and 3, operations can only occur August 1 - September 30 due to red pine cone collection. One 1), two year extension will be available for PU 1 and 3 if a good cone production year does not occur. If a good cone production year does not occur within the extension PU's 1 and 3 shall be left uncut, penalty free.

Access may be through other public land.

Better Call Saw (72-006-24) / T28N, R04W, SEC. 31, SENE,SE.

T28N, R04W, SEC. 32, NW,W1/2SW.

Crawford County, Advertised Price \$50,598.45, 130.7 Acres, Hardwood, Jack Pine.

SALE NOTE: Please take note of the recreational trail that passes through the sale area. Also the gas and pipeline infrastructure within the vicinity of the sale area. Soft oak wilt specs also apply to this sale; however, the sale administrator may deny any requests to operate during the restricted time frame. Gas pipeline company will need to be contacted as it intersects likely haul route.

A recreation site such as a trail, pathway, or campground is within the sale area or the vicinity. Certain restrictions/specifications may be applicable including time restrictions.

The Hills Have Flies (72-015-24) / T25N, R03W, SEC. 16, NW,SWNE,N1/2SW.

Crawford County, Advertised Price \$51,385.70, 87.2 Acres, Hardwood, Aspen.

SALE NOTE: Soft oak wilt specs apply to this sale; however, the DNR may deny any requests to operate during the restricted timeframe. The private marked property bordering PU 2 is state owned but to be treated as private as it has radio tower infrastructure on it. Be aware of the MCCCT trail that runs through the sale area. Also, the 487 snowmobile trail may impacting hauling route(s). This sale has a 3 year contract on it to accommodate the oak wilt specs that apply.

Tree list is available upon request.

A recreation site such as a trail, pathway, or campground is within the sale area or the vicinity. Certain restrictions/specifications may be applicable including time restrictions.

Mason Tract SW (72-021-24) / T25N, R02W, SEC. 14, S1/2SW.

T25N, R02W, SEC. 15, SESE.

T25N, R02W, SEC. 22, E1/2NE,SW,S1/2SE.

T25N, R02W, SEC. 23, NW,NWSW.

Crawford County, Advertised Price \$90,270.05, 178.8 Acres, Hardwood, Red Oak.

SALE NOTE: The sale has seasonal operating restrictions associated with the Mason Tract and oak wilt. There is some steep terrain in Payment Units 1, 2, and 3. The oak, jack pine, aspen and balsam fir has been declining and dying.

Thayer Creek (72-024-24) / T25N, R02W, SEC. 13, N1/2NW,SWNW.

T25N, R02W, SEC. 14, NENE,S1/2NE.

Crawford County, Advertised Price \$14,416.90, 35.0 Acres, Aspen, Hardwood.

SALE NOTE: The sale contains areas of low ground that will only be operable during dry summer or frozen winter conditions. Soft oak wilt restriction also applies. The oak, jack pine and aspen have been declining and dying.

Tree list is available upon request.

A recreation site such as a trail, pathway, or campground is within the sale area or the vicinity. Certain restrictions/specifications may be applicable including time restrictions.

Goodfellers (72-027-24) / T26N, R03W, SEC. 28, S1/2SW,W1/2SE.

Crawford County, Advertised Price \$44,771.65, 47.9 Acres, Hardwood, Red Oak.

SALE NOTE: Soft oak wilt spec applies to this sale; however, the DNR may deny any requests to operate during the restricted time period. Also, please take a look in person at this sale as the Wilderness Trail Fire (June 2023) did burn through the northern half of this sale area but did not necessarily lead to mortality. Though there is charred bark present within sale area, and oak decline is present - more so in Payment Unit 1. There is a 3 year contract on this sale.

BID INSTRUCTIONS (VER. 10/10/2022):

1. Scheduled Bid Location, Date, and Time (2/11)

Bids must be received by the Unit Manager, GRAYLING OFFICE, 1955 HARTWICK PINES ROAD, GRAYLING, MI 49738, no later than 9:00 a.m. (local time) on July 13, 2026. For further information concerning this sale, contact Tom Barnes at 231-384-7732 extension .

2. Bidder's Qualifications (10/22)

If all or part of a timber sale was prepared by a private contractor, the contractor and that contractor's company are not permitted to bid on the timber sale. A person must be 18 years of age or older to purchase timber. Permanent employees of the Department of Natural Resources or members of their immediate household may not bid. Former employees, in the permanent or seasonal class, may not bid until 3 months after the last day of active duty. Bids will not be accepted from individuals or companies appearing on the DNR/FRD No-Bid List. This list contains the names of purchasers who previously failed to execute a contract within 21-days or who have a history of poor performance.

3. Preparation of Sealed Bids (5/16)

Bid Forms may be completed online thru Michigan DNR Timber Sale Online Bidding (OLB) at www.michigan.gov/timberbidding or by completing the hardcopy Bid Form found in the Timber Sale Prospectus . Hardcopy Bid Forms shall be manually signed in ink. Registration in OLB is considered your 'signature' for all bids submitted thru that system. Bid prices must be entered for each species and product in the Bid Price column for all material subject to bidding and all fill-in blanks must be completed. If erasures or other changes appear on the hardcopy Bid Form, each erasure or change must be initialed by the person signing the bid.

4. Submission of Sealed Bids (5/16)

Bid forms may be obtained from the Unit Manager or thru OLB. Bids may be submitted hardcopy or thru OLB. All hardcopy bids must be submitted on the bid form and in an envelope clearly identified as described in this section. NOTE: Only one bid form per bid envelope. Sealed bids must be submitted to the Unit office designated in the prospectus and must be submitted at or prior to the time established in the prospectus. The envelope should show on the outside (a) the sale name or number and (b) the date and time of bid opening, as shown in the prospectus. Bids received after the time specified in the sale prospectus are late bids and will be rejected.

It is possible for a bidder to submit multiple bids on a single sale. For example, a bid may be submitted hardcopy and a bid may be submitted thru OLB. Or, two bidders from the same company could both submit bids on the same sale. If this were to happen, the State would accept all bids received and award the contract accordingly. All bidding and contractual requirements would apply to all bids received.

5. Public Opening of Sealed Bids (7/16)

If conditions permit, the sealed bids will be publicly opened and posted at the time and place set in the prospectus.

If a bidder, present at a bid opening, has submitted bids on more than one sale, that bidder may withdraw their unopened bid envelopes or announce the withdrawal of their online bid after being declared the successful bidder on one sale.

6. Award of Contract (1/11)

Award of the contract will be made to the Bidder whose bid, conforming to the prospectus, is most advantageous to the State of Michigan on the basis of total value at rates bid for the estimated quantities. The State reserves the right to reject any bid or waive any minor irregularity in bids received. A written award mailed (or otherwise furnished) to the successful Bidder shall be deemed to result in a binding contract without further action by either party.

7. Down Payment (1/11)

The Bidder to whom award is made must make a down payment within 21 days of the sale award. The amount of the down payment will be calculated as shown in the Bond and Payment Schedule of this prospectus. Only cash may be used to meet this requirement.

8. Performance Security (1/11)

As guarantee of faithful performance, a cash bond, certificate of deposit, surety bond or irrevocable letter of credit (LOC) is required within 21 days of the sale award. The amount of the performance security is shown in the Bond and

Payment Schedule of this prospectus. If an LOC or surety is used, the coverage must extend for at least 6 months beyond the contract expiration.

9. Worker's Compensation (10/22)

Purchaser shall obtain worker's compensation insurance to cover claims under Michigan's Worker's Disability Compensation Act of 1969 or similar employee benefit act of any other state applicable to an employee. Verification of Worker's Disability Compensation Act Compliance must be completed and submitted within 21 days of contract award and prior to the issuance of the timber sale contract. In addition, if applicable, Notice of Exclusion or Certificate of Insurance must also be submitted.

10. Timber Sale Contract (10/22)

Additional conditions and requirements common to all timber sales are listed on the timber sale contract (R4031) and are available on line at www.michigan.gov/timber. Contact the Unit Manager for additional information or a sample contract. Within 21 days of the date of the award letter, the bidder must sign the contract and provide the required down payment, performance security, and verification of worker's disability compensation. The down payment and performance security shall be in accordance with the provisions of the timber sale contract, in the sums stated in this prospectus. If these actions are not taken, then the Bidder, the Bidder's corporation, and the corporation's principals may not be permitted to bid on State timber sales for a period of 3 months after the first offense, 6 months after the second offense, and 1 year after the third offense. An offense will only be counted against the Bidder for 5 years. In addition, the Bidder certifies that if awarded this contract, the Bidder will complete the timber sale contract in accordance with its terms and any modifications thereof including requirements to purchase, cut, and remove the included timber by the expiration date.

Payment Unit values in the State Forest Timber Sale Contract are calculated based on the advertised value of the Payment Unit as a percentage of the total advertised value of the contract. The advertised value of each Payment Unit is given in the Description of Timber by Payment Unit table on the Timber Sale Information page. For example, if the value of Payment Unit 1 is advertised as \$1,500 and the total Timber Sale value is advertised as \$10,000, the contract price for Payment Unit 1 will be 15% of the total bid price ($\$1,500/\$10,000 * 100$).

11. Disclaimer of Estimates and Bidder's Warranty of Inspection (10/22)

Before submitting this bid, the Bidder is advised and cautioned to inspect the sale area, review the requirements of the sale contract, and take other steps as may be reasonably necessary to ascertain the location, estimated volumes, construction estimates, and operating costs of the proposed sale. Failure to do so will not relieve the Bidder from responsibility for completing the contract.

The Bidder warrants that this bid is submitted solely on the basis of the Bidder's examination and inspection of the quality and quantity of the timber offered for sale and the Bidder's opinion of the value thereof and the costs of recovery. No reliance should be placed on the State of Michigan's estimates of timber quality, quantity or costs of recovery. Bidder further acknowledges that the State of Michigan: (i) expressly disclaims any warranty of fitness of timber for any purpose; (ii) offers this timber as is without any warranty of quality (merchantability) or quantity and (iii) expressly disclaims any warranty as to the quantity or quality of timber sold.

12. Certification and Chain-of-Custody (10/22)

Unless otherwise indicated in the contract under section 7 – Other Conditions of the Sale Specific Conditions & Requirements, the area encompassed by this timber sale is certified to the standards of the Forest Stewardship Council (FSC) - Certificate #SCS-FM/COC-00090N and the Sustainable Forestry Initiative (SFI) - Certificate #NSF-SFIS-5Y031-SF5. Forest products from this sale may be delivered to the mill as "FSC 100% and / or SFI certified" as long as the contractor hauling the forest products is chain-of-custody (COC) certified or covered under a COC certificate from the destination mill. The purchaser is responsible for maintaining COC after leaving the sale area.

13. Good Neighbor Authority (GNA) Requirements (10/22)

If the name of this timber sales contains the acronym GNA, it is authorized by the Good Neighbor Authority (GNA) and covered by various agreements between the U.S. Forest Service and the State. The timber sale occurs on federal land and the following conditions apply:

GNA contracts on US Forest Service land will not be awarded to purchasers on the Federal list of excluded parties. The System for Award Management (SAM) will be checked for active excluded parties prior to award of contract. In

addition, the Bidder to whom award is made must complete an Assurance Regarding Felony Conviction or Tax Delinquent Status for Corporate Applicants (AD-3031).

14. Good Neighbor Authority (GNA) Requirements, con't (10/22)

Bidder certifies, by signing this bid form, that to the best of Bidder's knowledge that the following representations are accurate and complete.

- a. That the Bidder and its principals are not presently debarred, suspended, proposed for debarment, declared ineligible, or voluntary excluded from timber sales (covered transactions) by any Federal department or agency.
- b. That the Bidder and its principals have not within a 3-year period preceding this bid been convicted of or had a civil judgment rendered against them for commission of fraud or a criminal offense in connection with obtaining , attempting to obtain, or performing a public (Federal, State, or local) transaction or contract under a public transaction; violation of Federal or State antitrust statutes or commission of embezzlement, theft, forgery, bribery, falsification or destruction of records, making false statements, or receiving stolen property.
- c. That the Bidder and its principals are not presently indicted for or otherwise criminally or civilly charged by a governmental entity (Federal, State, or local) with commission of any of the offenses enumerated in paragraph b of this certification.
- d. That the Bidder and its principals have not within a 3-year period preceding this bid had one or more public transactions (Federal, State, or local) terminated for breach or default of a timber or forest product contract.

Bidders that cannot certify this requirement, in whole or in part, shall submit an explanation with their bid.

Scott Bowen
Director

TIMBER SALE INFORMATION

GNA2 Cooke Dam RP (72-804-26)
 T24N, R07E, SEC. 27; T24N, R07E, SEC. 28; T24N, R07E, SEC. 33.
 Iosco County (Advertised Price \$103,411.95)

SALE NOTE: The area encompassed by this timber sale is not certified to the standards of the Forest Stewardship Council (FSC) or the Sustainable Forestry Initiative (SFI). Forest products from this sale may not be delivered to the mill as "FSC and / or SFI certified". The lands within this sale belong to the National Forest system and are being managed by the State as part of a Good Neighbor Authority (GNA) agreement. Oak wilt restrictions, no exception.

EMR restrictions in PU 5, operations can only occur November 1 - April 30. Special protection area located in PU 3.

Operating Restrictions in PU 1 and 3, operations can only occur August 1 - September 30 due to red pine cone collection. One 1), two year extension will be available for PU 1 and 3 if a good cone production year does not occur. If a good cone production year does not occur within the extension PU's 1 and 3 shall be left uncut, penalty free.

Access may be through other public land.

A timber sale contract for this lump sum, sealed bid timber sale will be awarded to the responsible bidder offering the highest sealed bid price. All units of volume listed below were estimated using the Inventory Manager computer program and the new Michigan taper model. Bids must be at or above the following advertised price for each product and species:

<u>PRODUCTS & SPECIES</u>	<u>ESTIMATED UNITS*</u>	<u>ADVERTISED PRICE</u>
Pulpwood		
Jack Pine	14 Cords	\$ 6.25 / Cord
Northern Pin Oak	16 Cords	\$ 11.45 / Cord
Red Pine	3,785 Cords	\$ 27.25 / Cord

* The total volume is statistically estimated within plus (+) or minus (-) 13.21 percent. There are an estimated 3,815 cords on this timber sale, plus or minus 504 cords at the 95% confidence level. The estimated units are final and not subject to adjustment. Prospective bidders are urged to examine this timber and to make their own estimates of quantity and quality.

BOND AND PAYMENT SCHEDULE:

1. A bond in the amount of \$5,171.00 to insure faithful performance of the conditions of the contract will be deposited by the successful bidder within 21 days of the sale award.
2. Cutting in any sale or unit without the required advance payment would be considered a trespass.
3. Total payment must be paid in advance or according to the following schedule :
 - (a) Ten percent (10%) of the sale value must be paid within 21 days of the sale award.
 - (b) The 10% down payment will be credited towards the first unit cut.
 - (c) Payment for each of the following units must be made before cutting begins in that unit:

PAYMENT UNIT NUMBER	PERCENT OF TOTAL SALE VALUE
01	17.1%
02	17.6%
03	49.7%
04	9.8%
05	5.8%
4. If no cutting takes place, the 10% down payment will not be refunded.
5. Operations on the contract issued will terminate on 09/30/2030.

SALE STATISTICS

Volumes were calculated in cubic feet using the Michigan taper model. Cubic foot volume includes all wood inside bark for the product indicated. For display purposes, cubic feet were converted to cords and MBF using a simple conversion factor, e.g. 79 cubic feet per cord and 185 cubic feet per MBF. The cubic foot volumes are precise; the cords and MBF volumes are not. Cubic foot volume cannot be directly converted to cords or boards with precision.

SALE VOLUMES

The total estimated sale volume may not equal the sum of the species/products due to the nature of statistical calculations associated with double sampling methodology.

VOLUME		STATISTICAL RANGE IN CORDS		
TOTAL CUBIC FEET	TOTAL CORDS	PERCENT ERROR	MINIMUM	MAXIMUM
301,356	3,815	13.21%	3,310	4,319

VDU VOLUMES

A VDU is a Volume Determination Unit. Volumes and their associated statistics are calculated at the VDU level and summarized to the sale level. There is often a one to one relationship between a VDU and a Payment Unit, but not always, depending on the cruise design. Refer to the VDU TO PAYMENT UNIT table.

VDU	VOLUME		PERCENT ERROR	RANGE IN CORDS	
	TOTAL CUBIC FEET	TOTAL CORDS		MINIMUM	MAXIMUM
43	201,339	2,549	18.12%	2,087	3,010
44	100,017	1,266	16.64%	1,055	1,477
TOTAL:	301,356	3,815		3,142	4,487

VDU TO PAYMENT UNIT

When a VDU is associated with more than one Payment Unit (PU), the VDU volumes are assigned to the PU based on acres of the VDU within the PU.

VDU	VDU ACRES	PU	PU ACRES
TOTAL:			

DESCRIPTION OF TIMBER BY PAYMENT UNIT (PU)

PU	MARKET GROUP	PRODUCT	QUANTITY	UNIT	ACRES	ADVERTISE PRICE
1	Jack Pine	Pulpwood	4	Cords	31.1	\$17,710.25
	Red Pine		649	Cords		
2	Northern Pin Oak	Pulpwood	8	Cords	64.0	\$18,185.60
	Red Pine		664	Cords		
3	Jack Pine	Pulpwood	10	Cords	90.3	\$51,456.00
	Red Pine		1,886	Cords		
4	Northern Pin Oak	Pulpwood	5	Cords	35.6	\$10,112.50
	Red Pine		369	Cords		
5	Northern Pin Oak	Pulpwood	3	Cords	20.9	\$5,947.60
	Red Pine		217	Cords		
TOTAL:			3,815	Cords		

Sale Specific Conditions & Requirements

Sale Name: GNA2 Cooke Dam RP

Sale Number: 72-804-26 Seq#: 1

1 - Sale Area

1.2 - Boundaries

1.2.1 - Painted Boundaries (9/19)

The sale boundary and Payment Unit boundaries are marked and identified by orange paint. Special protection areas are marked with orange paint and identified on Timber Sale Map. No operations are allowed within these areas. The painted boundary line trees are not Included Timber and are to be protected.

2 - Timber Specifications

2.1 - Included Timber

2.1.3 - Cut Tree Marked Unit(s) (12/08)

Within Payment Unit(s) 2, 4, and 5, all trees are designated for cutting when marked with Blue paint above and below stump height, regardless of merchantability.

2.1.4 - Designated Timber Unit(s) (6/17)

Within Payment Unit(s) 1 and 3, all Red and Jack pine are designated for cutting which meet minimum piece specifications in 2.2 Utilization. Do not cut snags unless needed for safety.

2.2 - Utilization

2.2.3 - Stump Heights (12/24)

Stump heights within the Sale Area shall not exceed six (6) inches for all trees.

2.2.10 - No Chipping Tops and Limbs (8/16)

Within Payment Unit(s) 1-5, Limbs and the remaining top must be left on site and scattered.

2.2.12 - GNA, Cut and Remove Included Timber (3/18)

Unless provided otherwise herein, the DNR agrees to sell and permit Purchaser to cut and remove Included Timber, and Purchaser agrees to purchase, cut, and remove Included Timber.

3 - Payments

3.3 - Pre-measured Sales

3.3.4 - Dividing Payment Units (7/14)

Payment Unit(s) 1, 2, and 3 may be divided at the request of the Purchaser and upon approval of the Unit Manager. Dividing Payment Units is a contract modification which requires a Timber Sale Contract Amendment.

3.4 - Damaged Timber

3.4.1 - Damaged Timber (12/24)

General Condition and Requirement 3.4 Damaged Timber, defines liquidated damages for undesignated live merchantable trees which are cut or injured.

No damage is acceptable to undesignated live merchantable trees. Within the Sale Area, if more than 10% of trees (> 4.5" DBH) within a specified area of the sale are damaged, liquidated damages will be assessed for all trees damaged. Rates will be in accordance with General Condition and Requirement 3.4 Damaged Timber.

3.4.3 - Special Protection Areas (8/11)

The Purchaser shall protect special protection areas from damage by the Purchaser's operations. Special protection areas are marked with a Orange boundary line. The Purchaser shall not cut live or dead trees within special protection areas. If the Purchaser's operations have cut or damaged special protection areas through carelessness, the Purchaser shall pay \$500 as fixed, agreed and liquidated damages for each acre or part thereof cut or damaged. Such payment does not constitute ownership of the undesignated timber.

4 - Transportation

4.1 - Construction

4.1.3 - Slash and Earthen Piles (8/04)

Piles or windrows of earth along roads and landings that have been widened or constructed shall be leveled. Slash from road maintenance or construction, including stumps, shall be dispersed throughout or removed from the sale.

4.1.6 - Road Construction (4/24)

Construction of new roads or improvements of existing roads shall be done in such a way as to minimize the environmental and visual impacts. Merchantable trees shall be cut and utilized unless otherwise directed. Non-merchantable trees shall be severed and laid flat on the ground. Slash shall be scattered, not left in windrows, and kept a minimum of 10 feet back from the road edge. be chipped, utilized or otherwise removed from the sale. Stumps shall be set upright, not left on edge, and be moved at least 10 feet away from the road edge. Disturbed soil shall be feathered into the woods and not left in berms or windrows.

4.1.7 - Road Closure (10/11)

All new roads built into the sale must be blocked to vehicle traffic upon completion of the sale. Overgrown roads that are reopened shall be considered new roads. In general, this will require constructing a four (4') foot high berm of stumps and logs covered with earth. Stumps and brush must be placed along the remainder of the trail. These roads must be rendered impassable to cars and trucks. All stumps from road building and landing construction must be reserved to block any newly constructed roads upon completion of the sale. These stumps must be scattered along the road system to prohibit vehicular movement. Contact the Sale Administrator for specific details of design and placement.

4.2 - Maintenance

4.2.5 - Two Wheel Drive Condition (2/04)

All existing trail roads on and adjacent to the Sale Area must be passable by two-wheel drive traffic for the duration of the sale.

5 - Operations

5.2 - Conduct of Operations

5.2.2 - Hazard Trees/Snags

5.2.2.1 - Den Trees (10/16)

Obvious hollow and/or den trees shall be protected and left standing unless they are a safety hazard.

5.2.3 - Operating Restrictions

5.2.3.1 - Operating Restrictions (9/11)

Within Payment Unit(s) 5, unless changed by written agreement, cutting and skidding, limited to the period of November 1st to April 30th. This restriction is because of Eastern Massasauga Conservation Habitat.

5.2.3.2 - Operating Restrictions (9/11)

Within Payment Unit(s) 1 and 3, harvest may only occur during a year of average or better cone crop, and must align with the optimal cone collection beginning in the 1st week of August. The sale administrator will determine when the crop is ready. The expectation will be that the contract holder will work with the administrator to harvest these units when the crop is ripe. The cone forecast will be made in Mid-July and the contractor will be notified that harvest needs to take place. Once harvesting begins in either Payment Unit 1 or 3 the remainder of both payment units may be cut at any time. This is because there is only one good cone collection year expected to occur during the duration of this Contract. The minimum bid on this contract has been reduced to accommodate the short notice and harvest timing requirements to accomplish this.

One (1) free two year extension will be granted for Payment Units 1 and 3 if a good cone year does not occur. If no good cone years occur after 5 years these payment units shall be left uncut, penalty free. If a good cone collection year occurs and no attempt is made to cut Payment Unit 1 or 3 there will be a penalty at the end of the 5 year contract for Payment Units 1 and 3. This restriction is for optimal red pine cone collection to help reduce seed shortages.

5.2.3.3 - Bark Slippage Restriction (3/09)

Within Payment Unit(s) 2, 4, and 5, unless changed by written agreement, cutting and skidding are not permitted during the

period of April 15 to July 15. This restriction is because of bark slippage.

5.2.3.4 - Oak Wilt Restriction, No Exceptions (1/18)

Within Payment Unit(s) 1-5, cutting, skidding, hauling within the sale and brushing of access roads to the sale are not permitted during the period of April 15 to July 15. No exceptions will be granted. This is necessary to reduce the spread of oak wilt.

5.2.3.6 - Bark Beetle Restriction (1/25)

In the event drought creates a high risk of pine bark beetle infestation, pine is not to be cut during the period March 1 through July 1, unless all portions of trees greater than two (2) inches in diameter are removed from the Sale Area, reduced to chips, or treated to the satisfaction of the Unit Manager or his/her representative, within 15 days of being severed from the stump. Pine log decks, pulpwood piles and treetops that are piled for chipping in the fall or winter within a 1/4 mile of susceptible sites must be removed before March 15. Residual slash must not be placed in piles or rows and must be spread over the site for quick drying. The Department of Natural Resources will exercise this specification if the risk of damage warrants.

5.2.32 - Decking/Landing Restoration (9/13)

All decking and landing areas must have the surface area restored to a condition equal to or better than before. This is to ensure the proper regeneration of the stand. Wood debris, chips and "cookies" from trimmings must be removed or scattered away from landing and loading areas and may not be windrowed on the edge.

5.2.38 - No Decking Against Live Trees (2/04)

Cut products may not be decked against unmarked or designated leave trees.

5.4 - Soil Protection

5.4.1 - Rutting Restriction, General (7/16)

Operations are to cease immediately if equipment and weather conditions result in rutting of roads and/or skid trails which are 12 inches or greater in depth and 50 feet in length. The Unit Manager or his/her representative may restrict hauling and/or skidding if ruts exceed the specified depth. With the Unit Manager or his/her representative's approval, the Purchaser may return to the area when the risk of rutting has decreased.

5.6 - Debris and Waste Material

5.6.2 - GNA, Equipment Cleaning (4/24)

(a) Areas, known by the DNR prior to timber sale advertisement, that are infested with invasive species of concern are shown on the Timber Sale Map. A current list of invasive species of concern and a map showing the extent of known infestations is available from the DNR. For purposes of this provision, "Off-Road Equipment" includes all logging and construction machinery, except for log trucks, chip vans, service vehicles, water trucks, pickup trucks, cars, and similar vehicles.

(b) Purchaser shall adhere to the following requirements with regard to cleaning "Off-Road Equipment":

(i) Prior to moving Off-Road Equipment onto the Sale Area, Purchaser shall identify the location of the equipment's most recent operation. Purchaser shall not move any Off-Road Equipment that last operated in an area infested with one or more invasive species of concern onto Sale Area without having cleaned such equipment of seeds, soil, vegetative matter, and other debris that could contain or hold seeds, and having notified the DNR, as provided in (iii). If the location of prior operation cannot be identified, then Purchaser shall assume that the location is infested with invasive species of concern.

(ii) Prior to moving Off-Road Equipment from a cutting unit that is shown on the Timber Sale Map to be infested with invasive species of concern to, or through any other area that is shown as being free of invasive species of concern, or infested with a different invasive species, Purchaser shall clean such equipment of seeds, soil, vegetative matter, and other debris that could contain or hold seeds, and shall notify the DNR, as provided in (iii).

(iii) Prior to moving any Off-Road Equipment subject to the cleaning requirements set forth above, Purchaser shall advise DNR of its cleaning measures and make the equipment available for inspection. DNR shall have two (2) days, excluding weekends and State holidays, to inspect equipment after it has been made available. After satisfactory inspection or after such 2-day period, Purchaser may move the equipment as planned. Equipment shall be considered clean when a visual inspection does not disclose seeds, soil, vegetative matter, and other debris that could contain or hold seeds. Purchaser shall

not be required to disassemble equipment unless so directed by the DNR after inspection.

(iv) If Purchaser desires to clean Off-Road Equipment on National Forest land, such as at the end of a project or prior to moving to, or through an area that is free of invasive species of concern, Purchaser shall obtain prior approval from the Unit Manager or his/her representative as to the location for such cleaning and measures, if any, for controlling impacts.

(v) Unit Manager or his/her representative may order delay, interruption, or modification of this Contract pursuant to Condition & Requirement 7.3 or 7.3.4.

(c) Nothing contained in this Condition & Requirement shall be interpreted as creating any warranty on the part of the DNR that all locations of invasive species of concern have been described herein, elsewhere in this Contract, or designated on the ground. Following sale advertisement, additional locations may be described or designated, and other species may be added to the list of invasive species of concern. In such event, the Unit Manager or his/her representative may order delay, interruption, or modification of this Contract pursuant to Condition & Requirement 7.3 or 7.3.4.

(d) The parties shall promptly communicate with one another with respect to description or designation of additional locations; discovery of locations of new species or new infestation; and, addition of species to the list of invasive species of concern.

5.7 - Protection of Historical Sites

5.7.2 - Potential Historical Site(s) (9/06)

The State Historic Preservation Office has identified the potential for a historic site within the boundary of this timber sale. Note that if the site is discovered during operations, General Condition and Requirement 5.7 - Protection of Historical Sites will apply.

5.8 - Protection of Endangered Species

5.8.5 - Protection of Raptor Nests (3/13)

All trees with raptor nests will be protected if found during harvesting operations. Notification will be made to the Unit Manager or his/her representative who will notify the Wildlife Biologist so an onsite evaluation and recommendation can be made, if necessary.

5.8.9 - GNA, Bat Habitat and Roost Trees (7/25)

If bats are observed emerging from a tree prior to being felled, or if injured or dead bats are found after a tree is felled, notify the Unit Manager for coordination with Forest Service biologists. If the tree is determined to be a roost, the contract may be amended to include a no activity buffer (typically 150 feet radius around the roost tree or trees).

During operations if any sick, injured, and/or dead bats (regardless of species) are found in the Sale Area the Purchaser shall report its location to the Sale Administrator as soon as possible, but no more than 12 hours upon discovery.

6 - Safety and Fire Prevention

6.2 - Signing

6.2.1 - Road Posting (10/20)

The Purchaser is responsible for posting and maintaining caution signs on River road, Cooke Dam road, FSR 2085 and FSR 4414 prior to beginning operations. The road must be posted at appropriate distances from the Sale Area to warn of logging activity and truck traffic. Signs must be removed when harvest operations are suspended or completed. The Purchaser will provide these signs.

7 - Other Conditions

SKIP

7.1.1 - GNA, Title (7/16)

General Condition & Requirement 7.1 is inapplicable. The following applies to this contract.

All right, title, and interest in and to any Included Timber shall remain in USDA Forest Service with the State of Michigan acting on behalf of the USDA Forest Service under this GNA contract, until it has been Measured, removed from Sale Area

or other authorized cutting area, and paid for, at which time title shall vest in Purchaser. Title to any Included Timber that has been Measured and paid for, but not removed from Sale Area or other authorized cutting area by Purchaser on or prior to Termination Date, shall remain in USDA Forest Service.

7.2 - Extensions

7.2.4 - Limited Extensions (4/17)

Given justification, only one (1), two-year extension may be granted if the contract has been paid in full. This will only be granted if a good cone year does not occur. If a good cone year does not occur within the extension, Payment Units 1 and 3 shall be left uncut, penalty free. If the Forest Service determines the units meet cone collection requirements and no attempt is made to cut the units there will be a penalty at the end of the 2 year extension.

7.3 - Contract Modifications

7.3.4 - GNA, Contract Suspension and Modification (5/16)

(a) The Unit Manager may, by written order, delay or interrupt authorized operations under this contract or, notwithstanding Condition & Requirement 7.3, modify this contract, in whole or in part:

(i) To prevent environmental degradation or resource damage, including, but not limited to, harm to habitat, plants, animals, cultural resources, or cave resources;

(ii) To ensure consistency with land and resource management plans or other documents prepared pursuant to the National Environmental Policy Act of 1969, 42 USC 4321-4347;

(iii) To conduct environmental analysis, including, but not limited to, engaging in consultation pursuant to the Endangered Species Act of 1973, 16 USC 1531, et seq.; or

(iv) Upon agreement of the Forest Service, due to administrative appeal or litigation, regardless of whether the Unit Manager's order is required by a court order or this contract is named in such a proceeding.

(b) In the event of an order delaying or interrupting Purchaser's Operations under this Condition & Requirement, Purchaser's remedy shall be:

(i) a no cost contract extension,

(ii) reimbursement for Out-of-Pocket Expenses,

however, the foregoing remedies shall be available only to the extent that the Unit Manager's order was the sole and exclusive cause of the delay or interruption of Purchaser's operations.

(c) Remedies awarded to the Purchaser shall not be duplicative, and the Unit Manager shall have the right to structure remedies provided herein to avoid duplicative compensation.

(d) Purchaser agrees that this Condition & Requirement, and the remedies provided herein shall apply regardless of any finding by any court that the DNR failed to comply with any statute, regulation and/or policy in connection with awarding, advertising, or authorizing this sale, or a similar sale.

7.5 - Loss

7.5.2 - GNA, Liability for Loss (7/16)

If Included Timber is destroyed or damaged by an unexpected event that changes the nature of Included Timber, such as wind, flood, insects, disease, or similar cause, the Purchaser shall bear the timber value loss resulting from such destruction or damage.

Deterioration or loss of timber value due to delay or interruption under 7.3.4 - GNA, contract suspension and modification, shall be borne by the party holding title. In this event, Included Timber to which USDA Forest Service holds title, Purchaser of the State GNA contract will not be obligated to remove and pay for such timber. This Subsection shall not be construed to relieve either party of liability for negligence.

7.10 - Certified Timber

7.10.1 - Non-Certified Timber (2/16)

The area encompassed by this timber sale is not certified to the standards of the Forest Stewardship Council (FSC) or the Sustainable Forestry Initiative (SFI). Forest products from this sale may not be delivered to the mill as "FSC and / or SFI certified". The lands within this sale belong to the National Forest system and are being managed by the State as part of a Good Neighbor Authority (GNA) agreement.



TIMBER SALE MAP

This information provided by authority of Part 525, 1994 PA 451, as amended.

Sale Number 72-804-26	Date 02/18/2026
Scale 1:10,000	Page 1
	Of 1

Forest Management Unit Grayling Mgt Unit	County Iosco	Mapped By: M. Lovelace
		Cruised By: M. Lovelace, C. Whitsett

Township 24N	Range 07E	Section(s) and Subdivision(s) Sec. 27 W1/2SW; Sec. 28 SENW,NENE,S1/2NE,E1/2SW,SE; Sec. 33 N1/2NW,NWNE;
-----------------	--------------	--

Cover Type			
A = Aspen	J = Jack Pine	O = Oak	U = Upland Brush
B = Paper Birch	K = Rock	P = Lowland Poplar	UM = Upland Mix Forest
C = Cedar	L = Lowland Brush	Q = Mixed Swamp Conifer	V = Bog or Marsh
D = Treed Bog	LM = Lowland Mix Forest	R = Red Pine	W = White Pine
E = Swamp Hardwoods	M = Maple, Beech, Birch	S = Black Spruce	X = Non Stocked
F = Spruce/Fir	MC = Mixed Conifer	T = Tamarack	Y = Sand
G = Grass	MD = Mixed Deciduous	Z = Water	
H = Hemlock	N = Marsh		

Density	
0 = Non Stocked	5 = Pole Timber Medium
1 = Seedling Sapling Poor	6 = Pole Timber Well
2 = Seedling Sapling Medium	7 = Saw Timber Poor
3 = Seedling Sapling Well	8 = Saw Timber Medium
4 = Pole Timber Poor	9 = Saw Timber Well

Use QR Code to open sale folder

Use QR Code to open Map in App



Payment Unit Number	Acres	Payment Unit Number	Acres
1	31.1	4	35.6
2	64.1	5	20.9
3	90.3		

GNA2 Cooke Dam RP
241.9 Acres

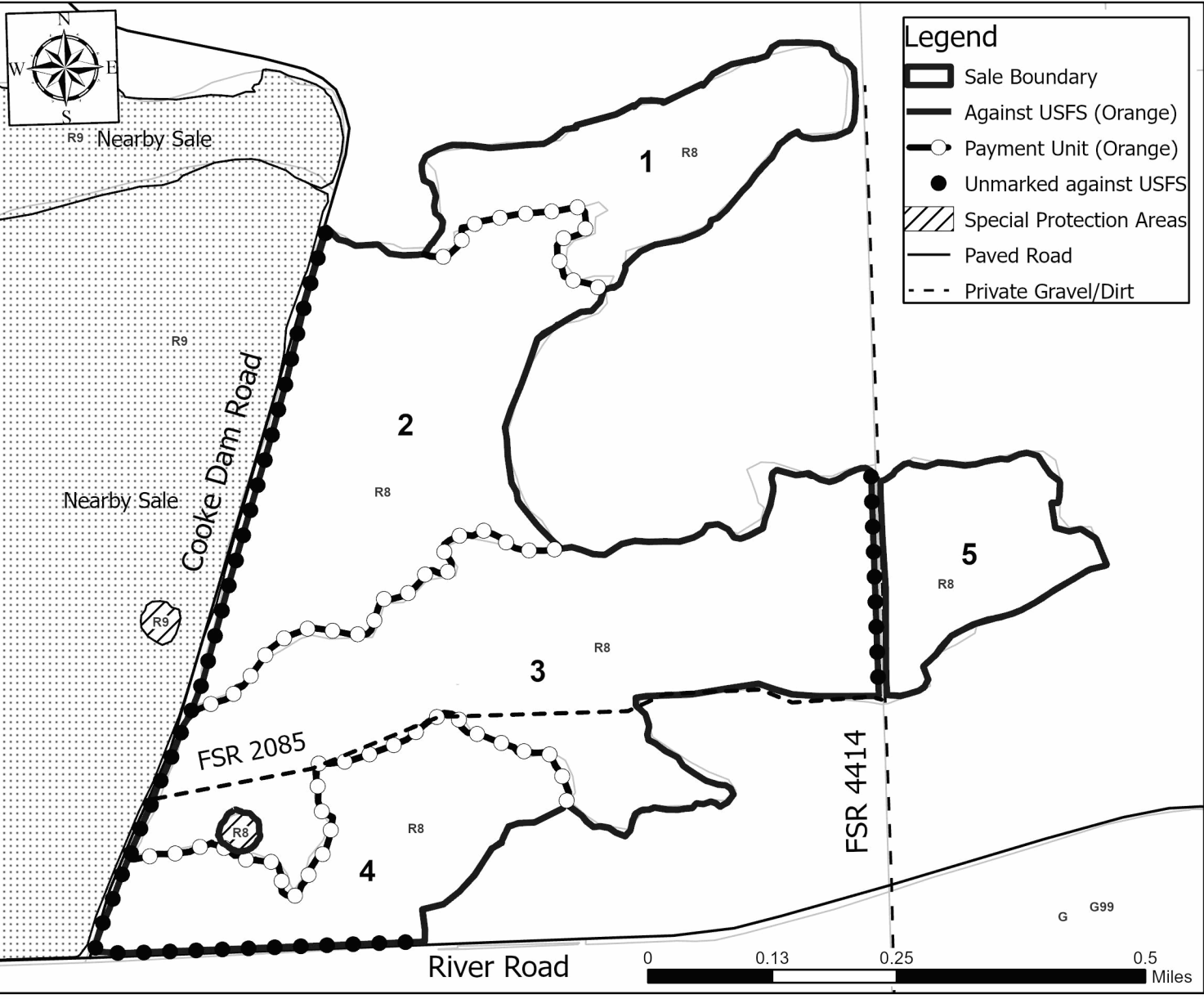

TIMBER SALE INFORMATION

Better Call Saw (72-006-24)

T28N, R04W, SEC. 31; T28N, R04W, SEC. 32.
Crawford County (Advertised Price \$50,598.45)

SALE NOTE: Please take note of the recreational trail that passes through the sale area. Also the gas and pipeline infrastructure within the vicinity of the sale area. Soft oak wilt specs also apply to this sale; however, the sale administrator may deny any requests to operate during the restricted time frame. Gas pipeline company will need to be contacted as it intersects likely haul route.

A recreation site such as a trail, pathway, or campground is within the sale area or the vicinity. Certain restrictions/specifications may be applicable including time restrictions.

A timber sale contract for this lump sum, sealed bid timber sale will be awarded to the responsible bidder offering the highest sealed bid price. All units of volume listed below were estimated using the Inventory Manager computer program and the new Michigan taper model. Bids must be at or above the following advertised price for each product and species:

<u>PRODUCTS & SPECIES</u>	<u>ESTIMATED UNITS*</u>		<u>ADVERTISED PRICE</u>
Sawtimber			
Black/Red (Hybrid) Oak	199.6	MBF	\$ 110.00 / MBF
White Oak	36.6	MBF	\$ 91.00 / MBF
Pulpwood			
Jack Pine	748	Cords	\$ 10.55 / Cord
Misc. Species 1	12	Cords	\$ 4.50 / Cord
Mixed Hardwood	219	Cords	\$ 19.55 / Cord
Mixed Oak	453	Cords	\$ 18.60 / Cord
Red Pine	99	Cords	\$ 42.10 / Cord
White Pine	34	Cords	\$ 14.45 / Cord

* The total volume is statistically estimated within plus (+) or minus (-) 14.54 percent. There are an estimated 2,122 cords on this timber sale, plus or minus 309 cords at the 95% confidence level. The estimated units are final and not subject to adjustment. Prospective bidders are urged to examine this timber and to make their own estimates of quantity and quality.

BOND AND PAYMENT SCHEDULE:

1. A bond in the amount of \$2,530.00 to insure faithful performance of the conditions of the contract will be deposited by the successful bidder within 21 days of the sale award.
2. Cutting in any sale or unit without the required advance payment would be considered a trespass.
3. Total payment must be paid in advance or according to the following schedule :
 - (a) Ten percent (10%) of the sale value must be paid within 21 days of the sale award.
 - (b) The 10% down payment will be credited towards the first unit cut.
 - (c) Payment for each of the following units must be made before cutting begins in that unit:

PAYMENT UNIT NUMBER	PERCENT OF TOTAL SALE VALUE
01	11.8%
02	17.9%
03	24.4%
04	23.5%
05	22.4%

4. If no cutting takes place, the 10% down payment will not be refunded.
5. Operations on the contract issued will terminate on 06/30/2029.

SALE STATISTICS

Volumes were calculated in cubic feet using the Michigan taper model. Cubic foot volume includes all wood inside bark for the product indicated. For display purposes, cubic feet were converted to cords and MBF using a simple conversion factor, e.g. 79 cubic feet per cord and 185 cubic feet per MBF. The cubic foot volumes are precise; the cords and MBF volumes are not. Cubic foot volume cannot be directly converted to cords or boards with precision.

SALE VOLUMES

The total estimated sale volume may not equal the sum of the species/products due to the nature of statistical calculations associated with double sampling methodology.

VOLUME			STATISTICAL RANGE IN CORDS	
TOTAL CUBIC FEET	TOTAL CORDS	PERCENT ERROR	MINIMUM	MAXIMUM
167,613	2,122	14.54%	1,813	2,430

VDU VOLUMES

A VDU is a Volume Determination Unit. Volumes and their associated statistics are calculated at the VDU level and summarized to the sale level. There is often a one to one relationship between a VDU and a Payment Unit, but not always, depending on the cruise design. Refer to the VDU TO PAYMENT UNIT table.

	VOLUME			RANGE IN CORDS	
VDU	TOTAL CUBIC FEET	TOTAL CORDS	PERCENT ERROR	MINIMUM	MAXIMUM
11	68,737	870	20.85%	689	1,051
15	91,510	1,158	21.44%	910	1,407
50	7,367	93	54.38%	43	144
TOTAL:	167,613	2,122		1,641	2,602

VDU TO PAYMENT UNIT

When a VDU is associated with more than one Payment Unit (PU), the VDU volumes are assigned to the PU based on acres of the VDU within the PU.

VDU	VDU ACRES	PU	PU ACRES
TOTAL:			

DESCRIPTION OF TIMBER BY PAYMENT UNIT (PU)

PU	MARKET GROUP	PRODUCT	QUANTITY	UNIT	ACRES	ADVERTISE PRICE			
1	White Oak	Sawtimber	1.4	MBF	29.5	\$5,983.90			
	Jack Pine	Pulpwood	341	Cords					
	Mixed Hardwood		4	Cords					
	<i>Red Maple</i>	<i>Sawtimber</i>	0.6	<i>MBF</i>					
	<i>Red Maple</i>	<i>Pulpwood</i>	3	<i>Cords</i>					
	Mixed Oak		6	Cords					
	<i>White Oak</i>		6	<i>Cords</i>					
	Red Pine		44	Cords					
	White Pine		15	Cords					
	2	Black/Red (Hybrid)	Sawtimber	5.5			MBF	41.7	\$9,039.40
White Oak			5.2	MBF					
Jack Pine		Pulpwood	407	Cords					
Mixed Hardwood			18	Cords					
<i>Red Maple</i>		<i>Sawtimber</i>	2.0	<i>MBF</i>					
<i>B. T. Aspen</i>		<i>Pulpwood</i>	2	<i>Cords</i>					
<i>Black Cherry</i>			1	<i>Cords</i>					
<i>Red Maple</i>			11	<i>Cords</i>					
Mixed Oak			39	Cords					
<i>/Red (Hybrid) Oak</i>			22	<i>Cords</i>					
<i>White Oak</i>			17	<i>Cords</i>					
Red Pine			55	Cords					
White Pine			19	Cords					
3		Black/Red (Hybrid)	Sawtimber	67.2	MBF	20.6	\$12,327.95		
		White Oak		10.4	MBF				
	Misc. Species 1	Pulpwood	4	Cords					
	Mixed Hardwood		69	Cords					
	<i>Red Maple</i>	<i>Sawtimber</i>	2.4	<i>MBF</i>					
	<i>Red Maple</i>	<i>Pulpwood</i>	64	<i>Cords</i>					
	Mixed Oak		141	Cords					
	<i>/Red (Hybrid) Oak</i>		107	<i>Cords</i>					
	<i>White Oak</i>		34	<i>Cords</i>					
	4	Black/Red (Hybrid)	Sawtimber	64.9	MBF			19.9	\$11,905.50
White Oak			10.0	MBF					
Misc. Species 1		Pulpwood	4	Cords					
Mixed Hardwood			66	Cords					
<i>Red Maple</i>		<i>Sawtimber</i>	2.3	<i>MBF</i>					
<i>Red Maple</i>		<i>Pulpwood</i>	61	<i>Cords</i>					
Mixed Oak			137	Cords					
<i>/Red (Hybrid) Oak</i>			104	<i>Cords</i>					
<i>White Oak</i>			33	<i>Cords</i>					
5		Black/Red (Hybrid)	Sawtimber	62.0	MBF	19.0	\$11,341.70		
	White Oak		9.6	MBF					
	Misc. Species 1	Pulpwood	4	Cords					
	Mixed Hardwood		62	Cords					
	<i>Red Maple</i>	<i>Sawtimber</i>	2.2	<i>MBF</i>					
	<i>Red Maple</i>	<i>Pulpwood</i>	58	<i>Cords</i>					
	Mixed Oak		130	Cords					
	<i>/Red (Hybrid) Oak</i>		99	<i>Cords</i>					
	<i>White Oak</i>		31	<i>Cords</i>					
	TOTAL:			236.2	MBF				
TOTAL:			1,565	Cords					

Sale Specific Conditions & Requirements

Sale Name: Better Call Saw

Sale Number: 72-006-24 Seq#: 3

1 - Sale Area

1.2 - Boundaries

1.2.1 - Painted Boundaries (9/19)

Exterior sale boundary lines against state are marked with red paint, except for the areas of the sale boundary that border County Road 612, as well as the well pad. Both of these stretches of boundary are unmarked. Interior Payment Unit boundaries are marked with yellow paint, except for the PU boundary of Payment Unit 3 against Payment Units 4 and 5. This boundary is being utilized by an unmarked forest access road. Yellow painted trees designating an interior Payment Unit boundary are Included Timber and are only to be cut when all surrounding Payment Units have been paid. Retention patches are marked with red painted X's; no harvesting activities may occur within these areas. The red painted external boundary line trees are not Included Timber and are to be protected.

2 - Timber Specifications

2.1 - Included Timber

2.1.1 - Clearcut Unit(s) with Unmerchantable Trees (6/14)

Within Payment Unit(s) 1-5, cut all trees that are two (2) inches or more at DBH except for trees marked with green paint above and below stump height. In addition to the green marked trees, within Payment Units 3-5 do not cut any pine species.

2.1.11 - Description of Timber Note (2/04)

Note that Misc Species 1 = dead oak.

2.2 - Utilization

2.2.10 - No Chipping Tops and Limbs (8/16)

Within Payment Unit(s) 1-5, chipping of the bole, 4-inches in diameter or greater, is allowed. Chipping of limbs or portions of the tree less than 4-inches in diameter is not permitted. Limbs and the remaining top must be left on site and scattered.

3 - Payments

3.4 - Damaged Timber

3.4.1 - Damaged timber (7/16)

General Condition and Requirement 3.4 Damaged Timber, defines liquidated damages for undesignated live merchantable trees which are cut or injured. No damage is acceptable to undesignated live merchantable trees. Within the sale area, if more than 10% of trees (> 4.5" DBH) within a specified area of the sale are damaged, liquidated damages will be assessed for all trees damaged. Rates will be in accordance with General Condition and Requirement 3.4 Damaged Timber.

4 - Transportation

4.1 - Construction

4.1.3 - Slash and Earthen Piles (8/04)

Piles or windrows of earth along roads and landings that have been widened or constructed shall be leveled. Slash from road maintenance or construction, including stumps, shall be dispersed throughout the sale.

4.1.6 - Road Construction (4/24)

Construction of new roads or improvements of existing roads shall be done in such a way as to minimize the environmental and visual impacts. Merchantable trees shall be cut and utilized unless otherwise directed. Non-merchantable trees shall be severed and laid flat on the ground. Slash shall be scattered, and not left in windrows and kept a minimum of 10 feet back from the road edge. Stumps shall be set upright, not left on edge, and be moved at least 10 feet away from the road edge. Disturbed soil shall be feathered into the woods and not left in berms or windrows.

4.1.7 - Road Closure (10/11)

All new roads built into the sale must be blocked to vehicle traffic upon completion of the sale. Sale administrator will not close the sale until road closure is completed. Overgrown roads that are reopened shall be considered new roads. Contact the

sale administrator for specific details of road closure design and placement.

4.1.11 - Permits (2/12)

The Purchaser will secure any necessary permits that may be required.

5 - Operations

5.1 - Notification

5.1.3 - Well Heads and Natural Gas Pipelines (11/15)

The Purchaser is responsible for contacting the gas or pipeline company prior to operating equipment in the vicinity of well heads or natural gas pipelines. Contact Riverside Energy Michigan, LLC at 1-989-705-7665.

5.2 - Conduct of Operations

5.2.1 - Slash

5.2.1.11 - Slash for Reforestation (3/21)

To facilitate reforestation, the Sale Area shall be left with slash evenly distributed. Bunched tops within the cutting area shall be broken up and scattered. Processing sites shall not be left with a compacted layer of slash; tops from these sites shall be hauled back into the cut area and scattered.

5.2.2 - Hazard Trees/Snags

5.2.2.1 - Den Trees (10/16)

Obvious hollow and/or den trees shall be protected and left standing unless they are a safety hazard.

5.2.3 - Operating Restrictions

5.2.3.5 - Oak Wilt Restriction (1/18)

Within Payment Unit(s) 2-5, unless changed by written agreement, cutting, skidding, hauling within the sale and brushing of access roads to the sale are not permitted during the period of April 15 to July 15. Operations may be allowed if specific steps are taken to prevent damaging uncut oak during the high-risk period. Those steps may include completing all road brushing before April 15 and clearing a tree-length buffer along uncut oak cover before April 15. This is necessary to reduce the spread of oak wilt. For more information, contact the Unit Manager or his/her representative.

5.2.29 - Shrub Protection (1/20)

Reasonable care should be taken to limit damage to hawthorn and juneberry. These woody-shrub plants are highly beneficial to various wildlife species.

5.2.32 - Decking/Landing Restoration (9/13)

All decking and landing areas must have the surface area restored to a condition equal to or better than before. This is to ensure the proper regeneration of the stand. Wood debris, chips and "cookies" from trimmings must be removed or scattered away from landing and loading areas and may not be windrowed on the edge.

5.2.38 - No Decking Against Live Trees (2/04)

Cut products may not be decked against unmarked or designated leave trees.

5.2.39 - ORV Trail/Route Protection (4/18)

The Frederic Trail is a motorcycle trail or route and is shown on the Timber Sale Map. Do not cut trees or damage posts with ORV markers. All stumps within 5 feet of the trail must be cut flush with the ground. Maintain a 20 foot wide slash, debris, and rut free zone daily using the ORV trail or route as the centerline. Do not run equipment down the ORV trail or route. Skidding across the trail or route may only occur in locations approved by the sale administrator.

5.4 - Soil Protection

5.4.2 - Skid Trails (2/04)

Skid trails up and down slopes should be avoided. If, however, this is unavoidable, these trails will be left in a non-erodible condition using water bars, logs, and slash. Placing of slash on these skid trails while logging is ongoing may alleviate need for any further action. At the direction of the Sale Administrator, seed, fertilizer, and mulch may also be required.

5.4.4 - Slope Protection (9/19)

Skid trails and roads on slopes shall be water barred with slash and stumps as soon as use is complete to prevent erosion.

5.8 - Protection of Endangered Species

5.8.5 - Protection of Raptor Nests (3/13)

All trees with raptor nests will be protected if found during harvesting operations. Notification will be made to the Unit Manager or his/her representative who will notify the Wildlife Biologist so an onsite evaluation and recommendation can be made, if necessary.

6 - Safety and Fire Prevention

6.2 - Signing

6.2.1 - Road Posting (10/20)

The Purchaser is responsible for posting and maintaining caution signs on Manistee River Rd prior to beginning operations. The road must be posted at appropriate distances from the sale area to warn of logging activity and truck traffic. Signs must be removed when harvest operations are suspended or completed. The Purchaser will provide these signs.

6.2.3 - Recreational Trail Posting (10/20)

The Purchaser is responsible for posting and maintaining caution signs on Frederic Trail prior to beginning operations. The trail must be posted at appropriate distances from the sale area to warn of logging activity and truck traffic at both ends of the trail. Signs must be removed when harvest operations are suspended or completed. The Purchaser will provide these signs.



TIMBER SALE MAP

This information provided by authority of Part 525, 1994 PA 451, as amended.

Sale Number

72-006-24

Date

02/24/2025

Forest Management Unit

Grayling Mgt Unit

County

Crawford

Mapped By: Halabut

Cruised By: Halabut, Hoffman, Mickevich

Scale

1:15,840

Page

1

Of

1

Township
28N

Range
04W

Section(s) and
Subdivision(s) Sec. 31 SENE,SE; Sec. 32 NW,W1/2SW;

Cover Type

A = Aspen	J = Jack Pine	O = Oak	U = Upland Brush
B = Paper Birch	K = Rock	P = Lowland Poplar	UM = Upland Mix Forest
C = Cedar	L = Lowland Brush	Q = Mixed Swamp Conifer	V = Bog or Marsh
D = Treed Bog	LM = Lowland Mix Forest	R = Red Pine	W = White Pine
E = Swamp Hardwoods	M = Maple, Beech, Birch	S = Black Spruce	X = Non Stocked
F = Spruce/Fir	MC = Mixed Conifer	T = Tamarack	Y = Sand
G = Grass	MD = Mixed Deciduous	Z = Water	
H = Hemlock	N = Marsh		

Density

0 = Non Stocked	5 = Pole Timber Medium
1 = Seedling Sapling Poor	6 = Pole Timber Well
2 = Seedling Sapling Medium	7 = Saw Timber Poor
3 = Seedling Sapling Well	8 = Saw Timber Medium
4 = Pole Timber Poor	9 = Saw Timber Well

PU # Acres

1	29.5
2	41.8
3	20.7
4	19.9
5	19

Better Call Saw

Comp. 174

130.7 Acres

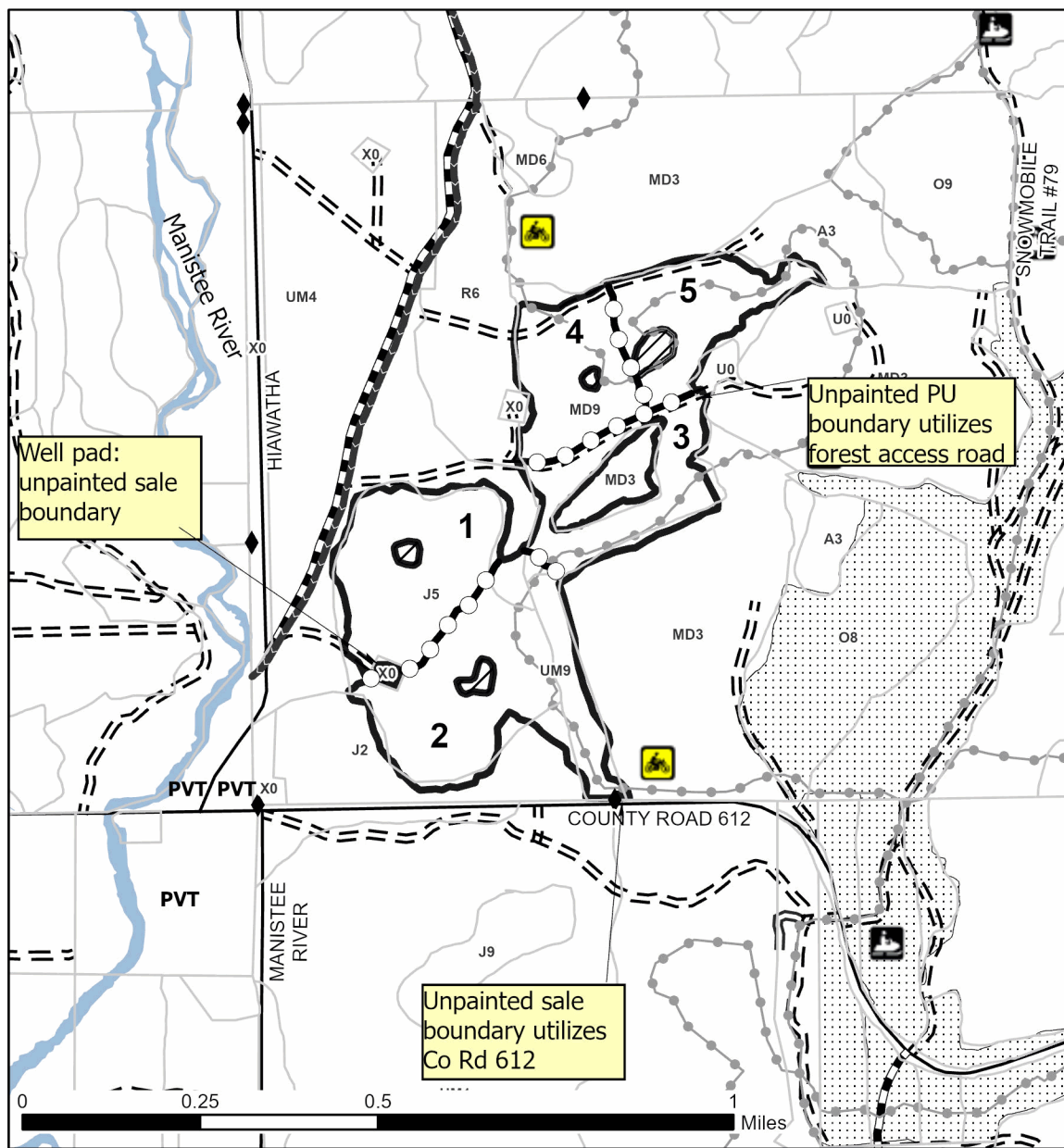
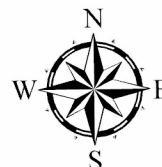

Legend

- Against State (Red/Unmarked)
- Payment Unit (Yellow/Unmarked Rd)
- Nearby Timber Sales
- Retention Area
- Stands
- Recreational Trail
- Primary Forest Road
- Forest Access Route
- Administrative Access Only
- Paved Road
- Government Gravel/Dirt
- Private Gravel/Dirt
- Lakes and Rivers
- Pipeline
- Field Grade Corner

Use QR Code to open Map in App



TIMBER SALE INFORMATION

The Hills Have Flies (72-015-24)

T25N, R03W, SEC. 16.

Crawford County (Advertised Price \$51,385.70)

SALE NOTE: Soft oak wilt specs apply to this sale; however, the DNR may deny any requests to operate during the restricted timeframe. The private marked property bordering PU 2 is state owned but to be treated as private as it has radio tower infrastructure on it. Be aware of the MCCCT trail that runs through the sale area. Also, the 487 snowmobile trail may impacting hauling route(s). This sale has a 3 year contract on it to accommodate the oak wilt specs that apply.

Tree list is available upon request.

A recreation site such as a trail, pathway, or campground is within the sale area or the vicinity. Certain restrictions/specifications may be applicable including time restrictions.

A timber sale contract for this lump sum, sealed bid timber sale will be awarded to the responsible bidder offering the highest sealed bid price. All units of volume listed below were estimated using the Inventory Manager computer program and the new Michigan taper model. Bids must be at or above the following advertised price for each product and species:

<u>PRODUCTS & SPECIES</u>	<u>ESTIMATED UNITS*</u>	<u>ADVERTISED PRICE</u>
Sawtimber		
Red Maple	14.8 MBF	\$ 51.00 / MBF
Red Oak	153.6 MBF	\$ 143.00 / MBF
White Oak	83.3 MBF	\$ 79.00 / MBF
Pulpwood		
B. T. Aspen	433 Cords	\$ 14.95 / Cord
Misc. Species 2	55 Cords	\$ 5.00 / Cord
Mixed Hardwood	196 Cords	\$ 15.70 / Cord
Mixed Oak	688 Cords	\$ 17.15 / Cord
White Pine	37 Cords	\$ 12.45 / Cord

* The total volume is statistically estimated within plus (+) or minus (-) 14.81 percent. There are an estimated 1,997 cords on this timber sale, plus or minus 296 cords at the 95% confidence level. The estimated units are final and not subject to adjustment. Prospective bidders are urged to examine this timber and to make their own estimates of quantity and quality.

BOND AND PAYMENT SCHEDULE:

1. A bond in the amount of \$2,569.00 to insure faithful performance of the conditions of the contract will be deposited by the successful bidder within 21 days of the sale award.
2. Cutting in any sale or unit without the required advance payment would be considered a trespass.
3. Total payment must be paid in advance or according to the following schedule:
 - (a) Ten percent (10%) of the sale value must be paid within 21 days of the sale award.
 - (b) The 10% down payment will be credited towards the first unit cut.
 - (c) Payment for each of the following units must be made before cutting begins in that unit:

<u>PAYMENT UNIT NUMBER</u>	<u>PERCENT OF TOTAL SALE VALUE</u>
01	40.5%
02	30.9%
03	28.6%

4. If no cutting takes place, the 10% down payment will not be refunded.
5. Operations on the contract issued will terminate on 12/31/2029.

SALE STATISTICS

Volumes were calculated in cubic feet using the Michigan taper model. Cubic foot volume includes all wood inside bark for the product indicated. For display purposes, cubic feet were converted to cords and MBF using a simple conversion factor, e.g. 79 cubic feet per cord and 185 cubic feet per MBF. The cubic foot volumes are precise; the cords and MBF volumes are not. Cubic foot volume cannot be directly converted to cords or boards with precision.

SALE VOLUMES

The total estimated sale volume may not equal the sum of the species/products due to the nature of statistical calculations associated with double sampling methodology.

VOLUME			STATISTICAL RANGE IN CORDS	
TOTAL CUBIC FEET	TOTAL CORDS	PERCENT ERROR	MINIMUM	MAXIMUM
157,795	1,997	14.81%	1,701	2,293

VDU VOLUMES

A VDU is a Volume Determination Unit. Volumes and their associated statistics are calculated at the VDU level and summarized to the sale level. There is often a one to one relationship between a VDU and a Payment Unit, but not always, depending on the cruise design. Refer to the VDU TO PAYMENT UNIT table.

	VOLUME			RANGE IN CORDS	
VDU	TOTAL CUBIC FEET	TOTAL CORDS	PERCENT ERROR	MINIMUM	MAXIMUM
16	84,241	1,066	22.04%	831	1,301
19	73,554	931	19.69%	748	1,114
TOTAL:	157,795	1,997		1,579	2,416

VDU TO PAYMENT UNIT

When a VDU is associated with more than one Payment Unit (PU), the VDU volumes are assigned to the PU based on acres of the VDU within the PU.

VDU	VDU ACRES	PU	PU ACRES
16	33.3	1	33.3
19	53.9	2	28.0
		3	25.9
TOTAL:	87.2		87.2

DESCRIPTION OF TIMBER BY PAYMENT UNIT (PU)

PU	MARKET GROUP	PRODUCT	QUANTITY	UNIT	ACRES	ADVERTISE PRICE
1	Red Maple	Sawtimber	14.3	MBF	33.3	\$20,812.60
	Red Oak		28.0	MBF		
	White Oak		18.0	MBF		
	B. T. Aspen	Pulpwood	433	Cords		
	Mixed Hardwood		148	Cords		
	<i>Black Cherry</i>		4	Cords		
	<i>Red Maple</i>		144	Cords		
	Mixed Oak		333	Cords		
	/Red (Hybrid) Oak	Sawtimber	2.3	MBF		
	/Red (Hybrid) Oak	Pulpwood	12	Cords		
	Red Oak		207	Cords		
	White Oak		109	Cords		
	White Pine		12	Cords		
	2	Red Maple	Sawtimber	0.3		
Red Oak			65.2	MBF		
White Oak			33.9	MBF		
Misc. Species 2		Pulpwood	29	Cords		
Mixed Hardwood			25	Cords		
<i>Sugar Maple</i>		Sawtimber	0.5	MBF		
<i>Red Maple</i>		Pulpwood	23	Cords		
<i>Sugar Maple</i>			1	Cords		
Mixed Oak			184	Cords		
/Red (Hybrid) Oak			2	Cords		
Red Oak			90	Cords		
White Oak			92	Cords		
White Pine			13	Cords		
3		Red Maple	Sawtimber	0.2	MBF	25.9
	Red Oak		60.4	MBF		
	White Oak		31.4	MBF		
	Misc. Species 2	Pulpwood	26	Cords		
	Mixed Hardwood		23	Cords		
	<i>Sugar Maple</i>	Sawtimber	0.5	MBF		
	<i>Red Maple</i>	Pulpwood	21	Cords		
	<i>Sugar Maple</i>		1	Cords		
	Mixed Oak		171	Cords		
	/Red (Hybrid) Oak		1	Cords		
	Red Oak		84	Cords		
	White Oak		86	Cords		
	White Pine		12	Cords		
	TOTAL:			251.7	MBF	
TOTAL:			1,409	Cords		

Sale Specific Conditions & Requirements

Sale Name: The Hills Have Flies

Sale Number: 72-015-24 Seq#: 2

1 - Sale Area

1.2 - Boundaries

1.2.1 - Painted Boundaries (9/19)

Sale boundary lines against state are marked with red paint, except the sale boundary is unmarked against Merrio Rd. Red boundary paint is also used against the private holding against PU 2, as this is technically state owned but to be treated as private. Interior Payment Unit boundaries are marked with yellow paint. Retention patches are marked with red paint; no harvesting activities may occur within these areas. The red painted sale boundary line trees are not Included Timber and are to be protected unless marked with orange paint. Yellow painted trees designating an interior Payment Unit boundary are only to be cut when all surrounding Payment Units have been paid.

2 - Timber Specifications

2.1 - Included Timber

2.1.1 - Clearcut Unit(s) with Unmerchantable Trees (6/14)

Within Payment Unit(s) 1, cut all trees that are two (2) inches or more at DBH except for any trees designated with green paint above and below stump height. These green designated trees are not included timber and are to be protected. In addition, there are grouse trees designated with orange paint, please refer to spec 5.2.4.1 for details.

2.1.5 - Overstory Removal Unit(s) (8/11)

Within Payment Unit(s) 2 and 3, all species/ trees with DBH equal to or greater than 4.6" which meet minimum piece specifications in 2.2 Utilization, are designated for cutting except for any trees designated above and below stump height with green paint.

2.1.11 - Description of Timber Note (2/04)

Note that Misc Species 2 = dead oak.

3 - Payments

3.3 - Pre-measured Sales

3.3.4 - Dividing Payment Units (7/14)

Payment Unit(s) 1-3 may be divided at the request of the Purchaser and upon approval of the Unit Manager. Dividing Payment Units is a contract modification which requires a Timber Sale Contract Amendment. There will be only one division per Payment Unit.

3.4 - Damaged Timber

3.4.1 - Damaged Timber (12/24)

General Condition and Requirement 3.4 Damaged Timber, defines liquidated damages for undesignated live merchantable trees which are cut or injured. In addition, reasonable care should be taken to avoid damage to tree seedlings and saplings.

Within the Sale Area, if more than 10% of the tree seedlings or saplings (1/4" to 4.5" DBH) within a specified portion of the Sale Area are damaged, liquidated damages will be assessed at \$400 per acre for all acreage within that specified portion of the Sale Area that was damaged. Seedlings and saplings cut cleanly for skid trails and operability will not be counted as damaged timber.

4 - Transportation

4.1 - Construction

4.1.3 - Slash and Earthen Piles (8/04)

Piles or windrows of earth along roads and landings that have been widened or constructed shall be leveled. Slash from road maintenance or construction, including stumps, shall be dispersed throughout the sale.

4.1.6 - Road Construction (4/24)

Construction of new roads or improvements of existing roads shall be done in such a way as to minimize the environmental and visual impacts. Merchantable trees shall be cut and utilized unless otherwise directed. Non-merchantable trees shall be severed and laid flat on the ground. Slash shall be scattered, and not left in windrows and kept a minimum of 10 feet back from the road edge. Stumps shall be set upright, not left on edge, and be moved at least 10 feet away from the road edge. Disturbed soil shall be feathered into the woods and not left in berms or windrows.

4.1.7 - Road Closure (10/11)

All new roads built into the sale must be blocked to vehicle traffic upon completion of the sale. Overgrown roads that are reopened shall be considered new roads. Temporary berms may be required if no sale activity occurs for 30 or more consecutive days. Contact the sale administrator for specific details of design and placement.

4.1.11 - Permits (2/12)

The Purchaser will secure any necessary permits that may be required.

5 - Operations

5.2 - Conduct of Operations

5.2.1 - Slash

5.2.1.11 - Slash for Reforestation (3/21)

To facilitate reforestation, the Sale Area shall be left with slash evenly distributed. Bunched tops within the cutting area shall be broken up and scattered. Stumps shall be cut low to the ground. Processing sites shall not be left with a compacted layer of slash; tops from these sites shall be hauled back into the cut area and scattered.

5.2.2 - Hazard Trees/Snags

5.2.2.1 - Den Trees (10/16)

Obvious hollow and/or den trees shall be protected and left standing unless they are a safety hazard.

5.2.3 - Operating Restrictions

5.2.3.5 - Oak Wilt Restriction (1/18)

Within Payment Unit(s) 2 and 3, unless changed by written agreement, cutting, skidding, hauling within the sale and brushing of access roads to the sale are not permitted during the period of April 15 to July 15. Operations may be allowed if specific steps are taken to prevent damaging uncut oak during the high-risk period. Those steps may include completing all road brushing before April 15 and clearing a tree-length buffer along uncut oak cover before April 15. This is necessary to reduce the spread of oak wilt. For more information, contact the Unit Manager or his/her representative.

5.2.4 - Dead and Down Creation

5.2.4.1 - Dead and Down Creation, Marked Trees (10/13)

All trees marked designated with orange paint above and below stump height must be felled and left on site for wildlife. These trees are not included timber and were not included within the cruise data.

5.2.32 - Decking/Landing Restoration (9/13)

All decking and landing areas must have the surface area restored to a condition equal to or better than before. This is to ensure the proper regeneration of the stand. Wood debris, chips and "cookies" from trimmings must be removed or scattered away from landing and loading areas and may not be windrowed on the edge.

5.2.38 - No Decking Against Live Trees (2/04)

Cut products may not be decked against unmarked or designated leave trees.

5.2.40 - Pathway Protection (10/10)

The MCCCT is a motorcycle trail and is shown on the Timber Sale Map. All stumps within 5 feet of the trail must be cut flush with the ground. Do not cut trees or damage posts with blue pathway markers. Maintain a 20-foot wide slash, debris, and rut free zone daily, using the pathway as the centerline. Do not run equipment down the pathway. Skidding across the trail may only occur in locations approved by the sale administrator.

5.2.41 - Snowmobile Trail Protection (9/11)

The 487 is a snowmobile trail and is shown on the Timber Sale Map and travels along Merrio Rd before extending to the East, South of the Sale Area. Do not cut or damage posts with orange trail markers or traffic control signs. If the trail is used, it must be maintained and restored to a condition equal to or better than before the sale. The road maintenance/restoration must be done prior to December 1. If the trail is used for hauling, it must be graded to the satisfaction of the Unit Manager or his/her representative prior to December 1st. If the trail road is to be used for hauling during the snowmobile season, then a snow-covered base must be left on the trail. The snowmobile trail may not be used for any timber sale operations from December 1 to March 31 unless given written permission by the Unit Manager. Maintain a 20-foot-wide slash, debris, and rut free zone daily using the snowmobile trail as the centerline.

5.4 - Soil Protection

5.4.1 - Rutting Restriction, General (7/16)

Operations are to cease immediately if equipment and weather conditions result in rutting of roads and/or skid trails which is 12 inches or greater in depth and 25 feet in length. This reduced rut length is being added to better ensure the protection of the slopes within the sale. The Unit Manager or his/her representative may restrict hauling and/or skidding if ruts exceed the specified depth. With the Unit Manager or his/her representative's approval, the Purchaser may return to the area when the risk of rutting has decreased.

5.4.4 - Slope Protection (9/19)

Skid trails and roads on slopes shall be water barred with slash and stumps as soon as use is complete to prevent erosion.

5.8 - Protection of Endangered Species

5.8.5 - Protection of Raptor Nests (3/13)

All trees with raptor nests will be protected if found during harvesting operations. Notification will be made to the Unit Manager or his/her representative who will notify the Wildlife Biologist so an onsite evaluation and recommendation can be made, if necessary.

6 - Safety and Fire Prevention

6.2 - Signing

6.2.1 - Road Posting (10/20)

The Purchaser is responsible for posting and maintaining caution signs on Merrio Rd prior to beginning operations. The road must be posted at appropriate distances from the sale area to warn of logging activity and truck traffic. Signs must be removed when harvest operations are suspended or completed. The Purchaser will provide these signs.

6.2.3 - Recreational Trail Posting (10/20)

The Purchaser is responsible for posting and maintaining caution signs on the MCCCT trail and snowmobile trail 487 prior to beginning operations. The trail must be posted at appropriate distances from the sale area to warn of logging activity and truck traffic at both ends of the trail. Signs must be removed when harvest operations are suspended or completed. The Purchaser will provide these signs.

7 - Other Conditions

7.5 - Loss

7.5.1 - Deteriorating Timber (7/09)

The Sale Area has received damage from oak decline. The Purchaser should harvest the wood as soon as possible. The Department of Natural Resources is held free of responsibility of any further damage or deterioration due to delay in harvesting.



TIMBER SALE MAP

This information provided by authority of Part 525, 1994 PA 451, as amended.

Sale Number

72-015-24

Date

02/28/2025

Forest Management Unit

Grayling Mgt Unit

County

Crawford

Mapped By: Jake Halabut

Cruised By: Jake Halabut

Scale

1:15,840

Page

1

Of

1

Township
25N

Range
03W

Section(s) and
Subdivision(s) Sec. 16 NW,SWNE,N1/2SW;

Cover Type

A = Aspen	J = Jack Pine	O = Oak	U = Upland Brush
B = Paper Birch	K = Rock	P = Lowland Poplar	UM = Upland Mix Forest
C = Cedar	L = Lowland Brush	Q = Mixed Swamp Conifer	V = Bog or Marsh
D = Treed Bog	LM = Lowland Mix Forest	R = Red Pine	W = White Pine
E = Swamp Hardwoods	M = Maple, Beech, Birch	S = Black Spruce	X = Non Stocked
F = Spruce/Fir	MC = Mixed Conifer	T = Tamarack	Y = Sand
G = Grass	MD = Mixed Deciduous	Z = Water	
H = Hemlock	N = Marsh		

Density

0 = Non Stocked	5 = Pole Timber Medium
1 = Seedling Sapling Poor	6 = Pole Timber Well
2 = Seedling Sapling Medium	7 = Saw Timber Poor
3 = Seedling Sapling Well	8 = Saw Timber Medium
4 = Pole Timber Poor	9 = Saw Timber Well

Locator Map (1:200,000)

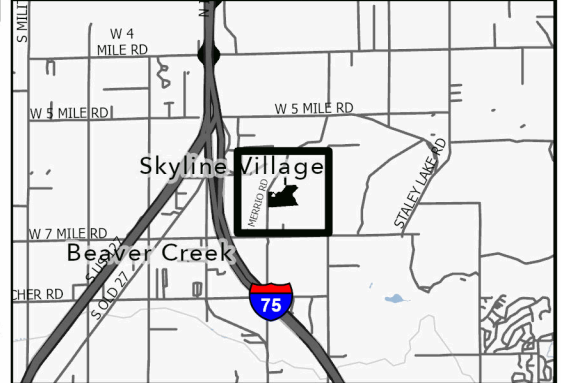

PU # Acres

1	33.3
2	28
3	26

**The Hills Have
Flies
87.2 Acres
Compartment 226**

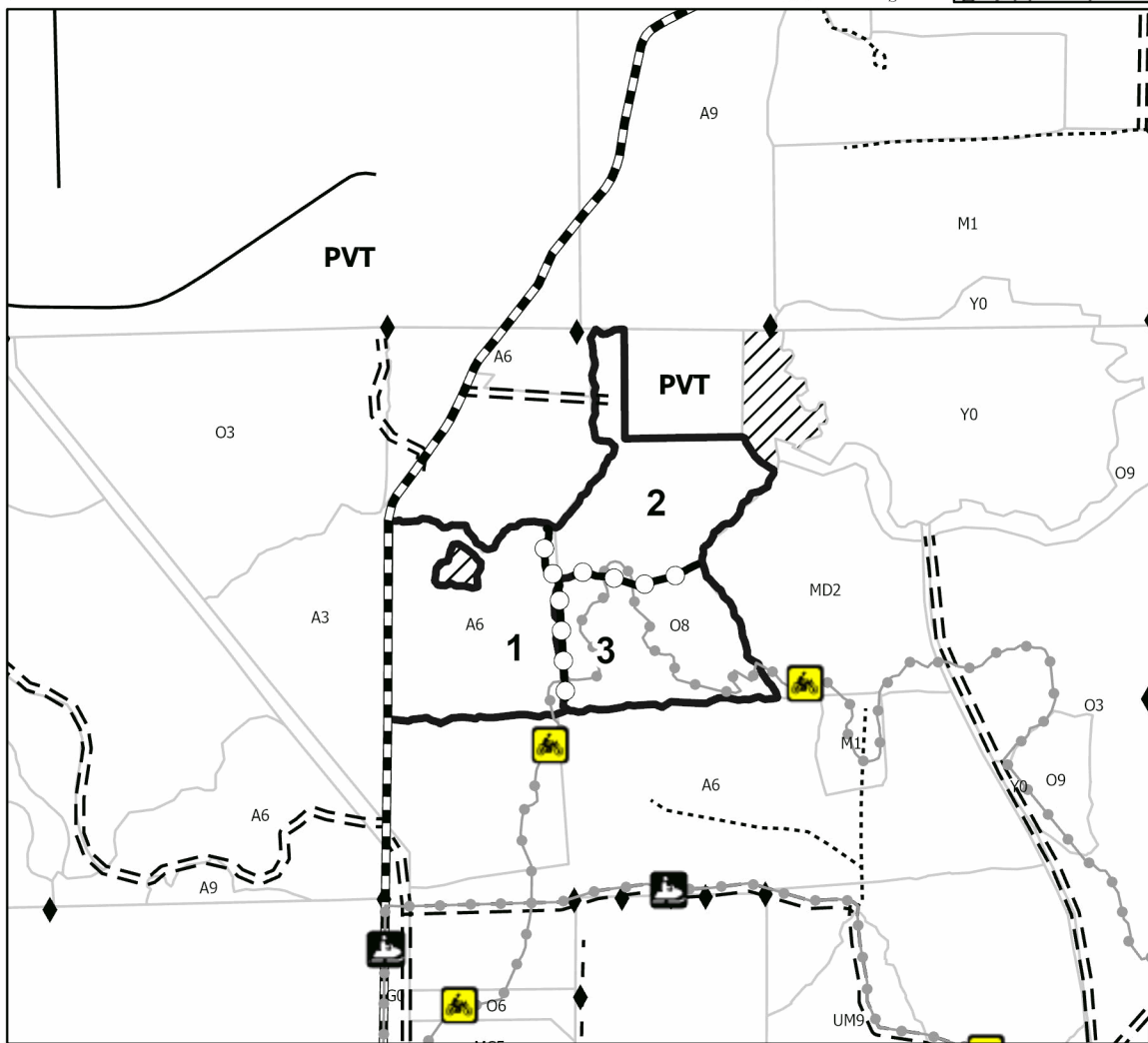
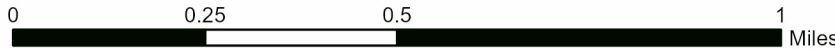

Legend

- Sale Boundary (Red/Unmarked)
- Payment Unit (Yellow)
- Retention Area
- Stands
- Recreational Trail
- Primary Forest Road
- Forest Access Route
- Administrative Access Only
- Paved Road
- Government Gravel/Dirt
- Private Gravel/Dirt
- Field Grade Corner

Use QR Code to open Map in App



TIMBER SALE INFORMATION

Mason Tract SW (72-021-24)

T25N, R02W, SEC. 14; T25N, R02W, SEC. 15; T25N, R02W, SEC. 22; T25N, R02W, SEC. 23.
Crawford County (Advertised Price \$90,270.05)

SALE NOTE: The sale has seasonal operating restrictions associated with the Mason Tract and oak wilt . There is some steep terrain in Payment Units 1, 2, and 3. The oak, jack pine, aspen and balsam fir has been declining and dying.

A timber sale contract for this lump sum, sealed bid timber sale will be awarded to the responsible bidder offering the highest sealed bid price. All units of volume listed below were estimated using the Inventory Manager computer program and the new Michigan taper model. Bids must be at or above the following advertised price for each product and species:

<u>PRODUCTS & SPECIES</u>	<u>ESTIMATED UNITS*</u>	<u>ADVERTISED PRICE</u>
Sawtimber		
Mixed Oak	28.5 MBF	\$ 95.00 / MBF
Red Oak	470.7 MBF	\$ 114.00 / MBF
White Oak	153.0 MBF	\$ 63.00 / MBF
Pulpwood		
Balsam Fir	199 Cords	\$ 19.10 / Cord
Jack Pine	163 Cords	\$ 7.50 / Cord
Mixed Aspen	99 Cords	\$ 11.95 / Cord
Mixed Oak	772 Cords	\$ 13.70 / Cord
Red Maple	92 Cords	\$ 12.55 / Cord
Red Pine	51 Cords	\$ 32.70 / Cord
Scotch Pine	13 Cords	\$ 51.75 / Cord
White Pine	395 Cords	\$ 9.95 / Cord
White Spruce	8 Cords	\$ 6.95 / Cord

* The total volume is statistically estimated within plus (+) or minus (-) 10.97 percent. There are an estimated 3,321 cords on this timber sale, plus or minus 365 cords at the 95% confidence level. The estimated units are final and not subject to adjustment. Prospective bidders are urged to examine this timber and to make their own estimates of quantity and quality.

BOND AND PAYMENT SCHEDULE:

1. A bond in the amount of \$4,514.00 to insure faithful performance of the conditions of the contract will be deposited by the successful bidder within 21 days of the sale award.
2. Cutting in any sale or unit without the required advance payment would be considered a trespass.
3. Total payment must be paid in advance or according to the following schedule :
 - (a) Ten percent (10%) of the sale value must be paid within 21 days of the sale award.
 - (b) The 10% down payment will be credited towards the first unit cut.
 - (c) Payment for each of the following units must be made before cutting begins in that unit:

PAYMENT UNIT NUMBER	PERCENT OF TOTAL SALE VALUE
01	13.9%
02	38.0%
03	23.0%
04	6.2%
05	6.4%
06	12.5%

4. If no cutting takes place, the 10% down payment will not be refunded.
5. Operations on the contract issued will terminate on 09/30/2030.

SALE STATISTICS

Volumes were calculated in cubic feet using the Michigan taper model. Cubic foot volume includes all wood inside bark for the product indicated. For display purposes, cubic feet were converted to cords and MBF using a simple conversion factor, e.g. 79 cubic feet per cord and 185 cubic feet per MBF. The cubic foot volumes are precise; the cords and MBF volumes are not. Cubic foot volume cannot be directly converted to cords or boards with precision.

SALE VOLUMES

The total estimated sale volume may not equal the sum of the species/products due to the nature of statistical calculations associated with double sampling methodology.

VOLUME			STATISTICAL RANGE IN CORDS	
TOTAL CUBIC FEET	TOTAL CORDS	PERCENT ERROR	MINIMUM	MAXIMUM
262,333	3,321	10.97%	2,956	3,685

VDU VOLUMES

A VDU is a Volume Determination Unit. Volumes and their associated statistics are calculated at the VDU level and summarized to the sale level. There is often a one to one relationship between a VDU and a Payment Unit, but not always, depending on the cruise design. Refer to the VDU TO PAYMENT UNIT table.

	VOLUME			RANGE IN CORDS	
VDU	TOTAL CUBIC FEET	TOTAL CORDS	PERCENT ERROR	MINIMUM	MAXIMUM
218	149,714	1,895	15.10%	1,609	2,181
231	30,515	386	32.27%	262	511
250	23,872	302	30.36%	210	394
270	58,232	737	23.51%	564	910
TOTAL:	262,333	3,321		2,645	3,997

VDU TO PAYMENT UNIT

When a VDU is associated with more than one Payment Unit (PU), the VDU volumes are assigned to the PU based on acres of the VDU within the PU.

VDU	VDU ACRES	PU	PU ACRES
218	117.3	1	21.7
		2	59.7
		3	35.9
231	16.4	4	16.4
250	15.6	5	15.6
270	29.5	6	29.5
TOTAL:	178.8		178.8

DESCRIPTION OF TIMBER BY PAYMENT UNIT (PU)

PU	MARKET GROUP	PRODUCT	QUANTITY	UNIT	ACRES	ADVERTISE PRICE
1	Red Oak	Sawtimber	87.1	MBF	21.7	\$12,511.10
	White Oak		18.9	MBF		
	Mixed Aspen	Pulpwood	3	Cords		
	<i>B. T. Aspen</i>		3	<i>Cords</i>		
	Mixed Oak		98	Cords		
	<i>Red Oak</i>		68	<i>Cords</i>		
	<i>White Oak</i>		30	<i>Cords</i>		
	Red Maple		1	Cords		
	<i>Red Maple</i>	<i>Sawtimber</i>	0.2	<i>MBF</i>		
	<i>Red Maple</i>	<i>Pulpwood</i>	1	<i>Cords</i>		
2	Red Oak	Sawtimber	239.5	MBF	59.7	\$34,422.05
	White Oak		52.0	MBF		
	Mixed Aspen	Pulpwood	9	Cords		
	<i>B. T. Aspen</i>		9	<i>Cords</i>		
	Mixed Oak		269	Cords		
	<i>Red Oak</i>		187	<i>Cords</i>		
	<i>White Oak</i>		82	<i>Cords</i>		
	Red Maple		4	Cords		
	<i>Red Maple</i>	<i>Sawtimber</i>	0.5	<i>MBF</i>		
	<i>Red Maple</i>	<i>Pulpwood</i>	3	<i>Cords</i>		
3	Red Oak	Sawtimber	144.1	MBF	35.9	\$20,723.50
	White Oak		31.2	MBF		
	Mixed Aspen	Pulpwood	5	Cords		
	<i>B. T. Aspen</i>		5	<i>Cords</i>		
	Mixed Oak		163	Cords		
	<i>Red Oak</i>		113	<i>Cords</i>		
	<i>White Oak</i>		50	<i>Cords</i>		
	Red Maple		3	Cords		
	<i>Red Maple</i>	<i>Sawtimber</i>	0.3	<i>MBF</i>		
	<i>Red Maple</i>	<i>Pulpwood</i>	2	<i>Cords</i>		
4	Mixed Oak	Sawtimber	8.2	MBF	16.4	\$5,579.85
	<i>/Red (Hybrid) Oak</i>		3.0	<i>MBF</i>		
	<i>Northern Pin Oak</i>		5.2	<i>MBF</i>		
	White Oak		17.3	MBF		
	Jack Pine	Pulpwood	17	Cords		
	Mixed Aspen		39	Cords		
	<i>B. T. Aspen</i>		39	<i>Cords</i>		
	Mixed Oak		80	Cords		
	<i>/Red (Hybrid) Oak</i>		19	<i>Cords</i>		
	<i>Northern Pin Oak</i>		3	<i>Cords</i>		
	<i>Red Oak</i>		4	<i>Cords</i>		
	<i>White Oak</i>		54	<i>Cords</i>		
	Red Maple		58	Cords		
	<i>Red Maple</i>	<i>Sawtimber</i>	3.6	<i>MBF</i>		
	<i>Red Maple</i>	<i>Pulpwood</i>	51	<i>Cords</i>		
White Pine		130	Cords			
5	Mixed Oak	Sawtimber	1.3	MBF	15.6	\$5,755.20
	<i>/Red (Hybrid) Oak</i>		1.3	<i>MBF</i>		
	White Oak		30.9	MBF		
	Mixed Aspen	Pulpwood	21	Cords		
	<i>B. T. Aspen</i>		21	<i>Cords</i>		
	Mixed Oak		92	Cords		
	<i>/Red (Hybrid) Oak</i>		2	<i>Cords</i>		
	<i>Northern Pin Oak</i>		6	<i>Cords</i>		
	<i>White Oak</i>		84	<i>Cords</i>		
	Red Maple		6	Cords		

DESCRIPTION OF TIMBER BY PAYMENT UNIT (PU), CON'T

PU	MARKET GROUP	PRODUCT	QUANTITY	UNIT	ACRES	ADVERTISE PRICE
5 con't	<i>Red Maple</i>	<i>Pulpwood</i>	6	<i>Cords</i>		
	Red Pine		45	Cords		
	White Pine		63	Cords		
6	Mixed Oak	Sawtimber	19.0	MBF	29.5	\$11,278.35
	<i>Northern Pin Oak</i>		19.0	<i>MBF</i>		
	White Oak		2.7	MBF		
	Balsam Fir	Pulpwood	199	Cords		
	Jack Pine		146	Cords		
	Mixed Aspen		22	Cords		
	<i>Quaking Aspen</i>		22	<i>Cords</i>		
	Mixed Oak		70	Cords		
	<i>Northern Pin Oak</i>		56	<i>Cords</i>		
	<i>White Oak</i>		14	<i>Cords</i>		
	Red Maple		20	Cords		
	<i>Red Maple</i>		20	<i>Cords</i>		
	Red Pine		6	Cords		
	Scotch Pine		13	Cords		
	White Pine		202	Cords		
	White Spruce		8	Cords		
	TOTAL:			652.2		
TOTAL:			1,792	Cords		

Sale Specific Conditions & Requirements

Sale Name: Mason Tract SW

Sale Number: 72-021-24 Seq#: 2

1 - Sale Area

1.2 - Boundaries

1.2.1 - Painted Boundaries (9/19)

The sale boundary and Payment Unit boundaries are marked and identified by blue, red and yellow paint, in addition to designated boundaries described along roads. Exterior sale boundary lines against private property are marked with blue paint. Exterior sale boundary lines against state are marked with red paint in addition to two segments of unpainted boundary along Mason Tract Trail (see Timber Sale Map). Interior Payment Unit boundaries are marked with yellow paint, in addition to two segments of unpainted boundary along Administrative Access Roads (see Timber Sale Map). Interior retention patches are marked with red paint; no harvesting activities may occur within these areas. The blue painted boundary line trees are not Included Timber and are to be protected. The red painted aspen, jack pine, and scotch pine boundary line trees are Included Timber and are only to be cut after the interior has been cut. If the red painted tree is in a multiple-stem clump, cut all stems within that clump. Yellow painted trees designating an interior Payment Unit boundary are only to be cut when all surrounding Payment Units have been paid.

2 - Timber Specifications

2.1 - Included Timber

2.1.1 - Clearcut Unit(s) with Unmerchantable Trees (6/14)

Within Payment Unit(s) 5 & 6, cut all trees that are two (2) inches or more at DBH except trees marked with green paint and sapling white pine and oak.

2.1.2 - Clearcut Unit(s) w/o Unmerchantable Trees (8/11)

Within Payment Unit(s) 4, cut all trees which meet minimum piece specifications in 2.2 Utilization except trees marked with green paint.

2.1.5 - Overstory Removal Unit(s) (8/11)

Within Payment Unit(s) 1, 2, & 3, all trees which meet minimum piece specifications in 2.2 Utilization, are designated for cutting except red pine, white pine, and trees marked with green paint.

2.1.11 - Description of Timber Note (2/04)

Note that all red pine, white pine, jack pine, aspen, spruce, and fir were cruised as pulp.

2.2 - Utilization

2.2.3 - Stump Heights (12/24)

Stump heights within the Sale Area shall not exceed 12 inches for trees greater than 10 inches DBH and 6 inches for trees smaller than 10 inches DBH. Stumps may be left up to 24 inches tall for trees greater than 20 inches DBH or where slope limits operations.

3 - Payments

3.3 - Pre-measured Sales

3.3.4 - Dividing Payment Units (7/14)

Payment Unit(s) 2 and 3 may be divided at the request of the Purchaser and upon approval of the Unit Manager. Dividing Payment Units is a contract modification which requires a Timber Sale Contract Amendment.

3.4 - Damaged Timber

3.4.1 - Damaged Timber (12/24)

General Condition and Requirement 3.4 Damaged Timber, defines liquidated damages for undesignated live merchantable trees which are cut or injured. In addition, reasonable care should be taken to avoid damage to tree seedlings and saplings.

Within the sale area, if more than 35% of the undesignated tree seedlings or saplings (1/4" to 4.5" DBH) within a specified

portion of the sale area are damaged, liquidated damages will be assessed at \$300 per acre for all acreage within that specified portion of the sale area that was damaged. Operable paths will have to be cut through areas of dense regeneration; if cut cleanly (not leaving bent/broken stems) those paths will not be considered damaged areas.

No damage is acceptable to undesignated live merchantable trees. Within the sale area, if more than 10% of trees (>4.5" DBH) within a specified area of the sale are damaged, liquidated damages will be assessed for all trees damaged. Rates will be in accordance with General Condition and Requirement 3.4 Damaged Timber.

4 - Transportation

4.1 - Construction

4.1.3 - Slash and Earthen Piles (8/04)

Piles or windrows of earth along roads and landings that have been widened or constructed shall be leveled. Slash from road maintenance or construction, including stumps, shall be utilized or dispersed into the sale.

4.1.6 - Road Construction (4/24)

Construction of new roads, landings, or improvements of existing roads shall be done in such a way as to minimize the environmental and visual impacts. Merchantable trees shall be cut and utilized unless otherwise directed. Non-merchantable trees shall be severed and laid flat on the ground. Slash shall be utilized or scattered, not left in windrows and kept a minimum of 10 feet back from the road edge. Stumps shall be set upright, not left on edge, and be moved at least 10 feet away from the road edge. Disturbed soil shall be feathered into the woods and not left in berms or windrows.

4.1.7 - Road Closure (10/11)

All new roads built into the sale must be blocked to vehicle traffic upon completion of the sale. Overgrown roads that are reopened shall be considered new roads. In general, closure will require constructing a four (4') foot high berm of stumps and logs covered with earth. Stumps and brush may also need to be placed at intervals along the trail. Contact the sale administrator for specific details of design and placement.

4.1.11 - Permits (2/12)

The Purchaser will secure any necessary highway and county road permits that may be required.

5 - Operations

5.1 - Notification

5.1.1 - Pre-sale Conference (10/25)

A pre-sale conference on site between the Purchaser and Sale Administrator is required prior to beginning any operations to determine landing and road locations. The Unit Manager or his/her representative must be contacted at least 5 days in advance to schedule the conference.

5.1.4 - Post-Sale Conference (10/16)

A post-sale conference on site between the Purchaser and sale administrator is required prior to the completion of active logging operations to determine clean-up and repair of landings, road edges, and the fulfillment of other contract specifications.

5.2 - Conduct of Operations

5.2.1 - Slash

5.2.1.13 - Dispose of Slash as Directed (12/05)

Slash is to be disposed of as directed by the Sale Administrator, such as flattening taller slash piles within the visual depth zone of the private property and county roads.

5.2.2 - Hazard Trees/Snags

5.2.2.1 - Den Trees (10/16)

Obvious hollow and/or den trees shall be protected and left standing unless they are a safety hazard.

5.2.3 - Operating Restrictions

5.2.3.1 - Operating Restrictions (9/11)

Within Payment Unit(s) 1-6, unless changed by written agreement, cutting and skidding are limited to the period of

November 1 to April 1. This restriction is because part of the sale is on Mason grant lands with associated management guidelines.

5.2.3.5 - Oak Wilt Restriction (1/18)

Within Payment Unit(s) 1-6, unless changed by written agreement, cutting, skidding, hauling within the sale and brushing of access roads to the sale are not permitted during the period of April 15 to July 15. Operations may be allowed if specific steps are taken to prevent damaging uncut oak during the high-risk period. Those steps may include completing all road brushing before April 15 and clearing a tree-length buffer along uncut oak cover before April 15. This is necessary to reduce the spread of oak wilt. For more information, contact the Unit Manager or his/her representative.

5.2.29 - Shrub Protection (1/20)

Reasonable care should be taken to avoid cutting or damaging hawthorn or juneberry. These woody-shrub plants are highly beneficial to various wildlife species.

5.2.38 - No Decking Against Live Trees (2/04)

Cut products may not be decked against unmarked or designated leave trees.

5.4 - Soil Protection

5.4.2 - Skid Trails (2/04)

Skid trails up and down slopes should be avoided. If, however, this is unavoidable, these trails will be left in a non-erodible condition using water bars, logs, and slash. Placing of slash on these skid trails while logging is ongoing may alleviate need for any further action. At the direction of the Sale Administrator, seed, fertilizer, and mulch may also be required.

6 - Safety and Fire Prevention

6.2 - Signing

6.2.1 - Road Posting (10/20)

The Purchaser is responsible for posting and maintaining caution signs on Mason Tract Trail and the forest road bordering the east edge of Payment Unit 6 prior to beginning operations. The road must be posted at appropriate distances from the sale area to warn of logging activity and truck traffic. Signs must be removed when harvest operations are suspended or completed. Signs only need to be posted on active Payment Units. The Purchaser will provide these signs.

7 - Other Conditions

7.5 - Loss

7.5.1 - Deteriorating Timber (7/09)

The Sale Area has received damage from age-related decline, spruce budworm and jack pine budworm. The Purchaser should harvest the wood as soon as possible. The Department of Natural Resources is held free of responsibility of any further damage or deterioration due to delay in harvesting.



TIMBER SALE MAP

This information provided by authority of Part 525, 1994 PA 451, as amended.

Sale Number 72-021-24	Date 09/24/2024
Scale 1:15,840	Page 1
	Of 1

Forest Management Unit Grayling Mgt Unit	County Crawford	Mapped By: Charlebois Cruised By: Charlebois
---	--------------------	---

Township 25N	Range 02W	Section(s) and Subdivision(s) Sec. 14 S1/2SW; Sec. 15 SESE; Sec. 22 E1/2NE,SW,S1/2SE; Sec. 23 NW,NWSW;
-----------------	--------------	--

Cover Type			
A = Aspen	J = Jack Pine	O = Oak	U = Upland Brush
B = Paper Birch	K = Rock	P = Lowland Poplar	UM = Upland Mix Forest
C = Cedar	L = Lowland Brush	Q = Mixed Swamp Conifer	V = Bog or Marsh
D = Treed Bog	LM = Lowland Mix Forest	R = Red Pine	W = White Pine
E = Swamp Hardwoods	M = Maple, Beech, Birch	S = Black Spruce	X = Non Stocked
F = Spruce/Fir	MC = Mixed Conifer	T = Tamarack	Y = Sand
G = Grass	MD = Mixed Deciduous	Z = Water	
H = Hemlock	N = Marsh		

Density	
0 = Non Stocked	5 = Pole Timber Medium
1 = Seedling Sapling Poor	6 = Pole Timber Well
2 = Seedling Sapling Medium	7 = Saw Timber Poor
3 = Seedling Sapling Well	8 = Saw Timber Medium
4 = Pole Timber Poor	9 = Saw Timber Well

PU #	Acres	PU #	Acres
1	21.7	4	16.4
2	59.7	5	15.6
3	35.9	6	29.5



Mason Tract SW

178.8 Acres

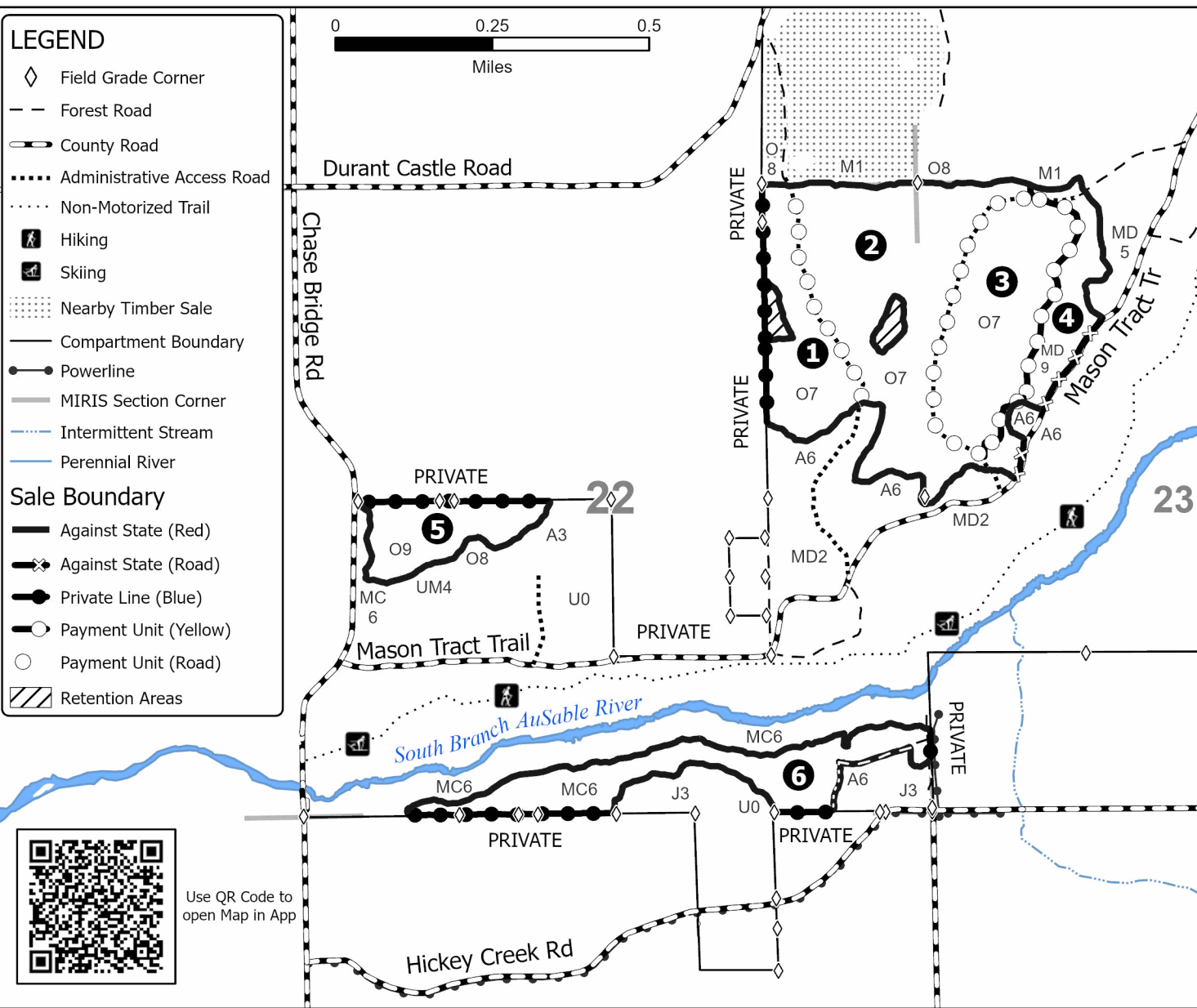

TIMBER SALE INFORMATION

Thayer Creek (72-024-24)

T25N, R02W, SEC. 13; T25N, R02W, SEC. 14.
Crawford County (Advertised Price \$14,416.90)

SALE NOTE: The sale contains areas of low ground that will only be operable during dry summer or frozen winter conditions. Soft oak wilt restriction also applies. The oak, jack pine and aspen have been declining and dying.

Tree list is available upon request.

A recreation site such as a trail, pathway, or campground is within the sale area or the vicinity. Certain restrictions/specifications may be applicable including time restrictions.

A timber sale contract for this lump sum, sealed bid timber sale will be awarded to the responsible bidder offering the highest sealed bid price. All units of volume listed below were estimated using the Inventory Manager computer program and the new Michigan taper model. Bids must be at or above the following advertised price for each product and species:

<u>PRODUCTS & SPECIES</u>	<u>ESTIMATED UNITS*</u>	<u>ADVERTISED PRICE</u>
Sawtimber		
Northern Pin Oak	22.2 MBF	\$ 72.00 / MBF
Pulpwood		
Balsam Fir	18 Cords	\$ 19.10 / Cord
Black Spruce	43 Cords	\$ 6.95 / Cord
Jack Pine	23 Cords	\$ 7.50 / Cord
Misc. Species 2	56 Cords	\$ 3.00 / Cord
Mixed Aspen	297 Cords	\$ 11.95 / Cord
Mixed Hardwood	166 Cords	\$ 12.55 / Cord
Mixed Oak	68 Cords	\$ 13.70 / Cord
Red Pine	90 Cords	\$ 32.70 / Cord
White Pine	234 Cords	\$ 9.95 / Cord

* The total volume is statistically estimated within plus (+) or minus (-) 26.53 percent. There are an estimated 1,046 cords on this timber sale, plus or minus 278 cords at the 95% confidence level. The estimated units are final and not subject to adjustment. Prospective bidders are urged to examine this timber and to make their own estimates of quantity and quality.

BOND AND PAYMENT SCHEDULE:

1. A bond in the amount of \$721.00 to insure faithful performance of the conditions of the contract will be deposited by the successful bidder within 21 days of the sale award.
2. Cutting in any sale or unit without the required advance payment would be considered a trespass.
3. Total payment must be paid in advance or according to the following schedule :
 - (a) Ten percent (10%) of the sale value must be paid within 21 days of the sale award.
 - (b) The 10% down payment will be credited towards the first unit cut.
 - (c) Payment for each of the following units must be made before cutting begins in that unit:

PAYMENT UNIT NUMBER	PERCENT OF TOTAL SALE VALUE
01	50.5%
02	15.0%
03	34.5%

4. If no cutting takes place, the 10% down payment will not be refunded.
5. Operations on the contract issued will terminate on 09/30/2029.

SALE STATISTICS

Volumes were calculated in cubic feet using the Michigan taper model. Cubic foot volume includes all wood inside bark for the product indicated. For display purposes, cubic feet were converted to cords and MBF using a simple conversion factor, e.g. 79 cubic feet per cord and 185 cubic feet per MBF. The cubic foot volumes are precise; the cords and MBF volumes are not. Cubic foot volume cannot be directly converted to cords or boards with precision.

SALE VOLUMES

The total estimated sale volume may not equal the sum of the species/products due to the nature of statistical calculations associated with double sampling methodology.

VOLUME			STATISTICAL RANGE IN CORDS	
TOTAL CUBIC FEET	TOTAL CORDS	PERCENT ERROR	MINIMUM	MAXIMUM
82,650	1,046	26.53%	769	1,324

VDU VOLUMES

A VDU is a Volume Determination Unit. Volumes and their associated statistics are calculated at the VDU level and summarized to the sale level. There is often a one to one relationship between a VDU and a Payment Unit, but not always, depending on the cruise design. Refer to the VDU TO PAYMENT UNIT table.

	VOLUME			RANGE IN CORDS	
VDU	TOTAL CUBIC FEET	TOTAL CORDS	PERCENT ERROR	MINIMUM	MAXIMUM
135	35,063	444	33.65%	294	593
138	47,586	602	39.60%	364	841
TOTAL:	82,650	1,046		658	1,434

VDU TO PAYMENT UNIT

When a VDU is associated with more than one Payment Unit (PU), the VDU volumes are assigned to the PU based on acres of the VDU within the PU.

VDU	VDU ACRES	PU	PU ACRES
135	17.3	3	17.3
138	17.7	1	13.6
		2	4.1
TOTAL:	35.0		35.0

DESCRIPTION OF TIMBER BY PAYMENT UNIT (PU)

PU	MARKET GROUP	PRODUCT	QUANTITY	UNIT	ACRES	ADVERTISE PRICE
1	Northern Pin Oak	Sawtimber	15.1	MBF	13.6	\$7,284.10
	Balsam Fir	Pulpwood	11	Cords		
	Black Spruce		33	Cords		
	Jack Pine		7	Cords		
	Misc. Species 2		12	Cords		
	Mixed Aspen		170	Cords		
	<i>Balsam Poplar</i>		10	Cords		
	<i>Quaking Aspen</i>		160	Cords		
	Mixed Hardwood		58	Cords		
	<i>Red Maple</i>		58	Cords		
	Mixed Oak		37	Cords		
	<i>Northern Pin Oak</i>		37	Cords		
	Red Pine		61	Cords		
	White Pine		41	Cords		
2	Northern Pin Oak	Sawtimber	4.5	MBF	4.1	\$2,156.30
	Balsam Fir	Pulpwood	3	Cords		
	Black Spruce		10	Cords		
	Jack Pine		2	Cords		
	Misc. Species 2		3	Cords		
	Mixed Aspen		51	Cords		
	<i>Balsam Poplar</i>		3	Cords		
	<i>Quaking Aspen</i>		48	Cords		
	Mixed Hardwood		17	Cords		
	<i>Red Maple</i>		17	Cords		
	Mixed Oak		11	Cords		
	<i>Northern Pin Oak</i>		11	Cords		
	Red Pine		18	Cords		
	White Pine		12	Cords		
3	Northern Pin Oak	Sawtimber	2.6	MBF	17.3	\$4,976.50
	Balsam Fir	Pulpwood	4	Cords		
	Jack Pine		14	Cords		
	Misc. Species 2		41	Cords		
	Mixed Aspen		76	Cords		
	<i>Quaking Aspen</i>		76	Cords		
	Mixed Hardwood		91	Cords		
	<i>Paper Birch</i>	<i>Sawtimber</i>	1.0	<i>MBF</i>		
	<i>Paper Birch</i>	<i>Pulpwood</i>	3	<i>Cords</i>		
	<i>Red Maple</i>		86	<i>Cords</i>		
	Mixed Oak		20	Cords		
	<i>Northern Pin Oak</i>		18	Cords		
	<i>White Oak</i>		2	Cords		
	Red Pine		11	Cords		
	White Pine		181	Cords		
	TOTAL:			22.2		
TOTAL:			995	Cords		

Sale Specific Conditions & Requirements

Sale Name: Thayer Creek

Sale Number: 72-024-24 Seq#: 2

1 - Sale Area

1.2 - Boundaries

1.2.1 - Painted Boundaries (9/19)

The sale boundary and Payment Unit boundaries are marked and identified by red paint. Exterior sale boundary lines against state are marked with red paint. Cut the merchantable red painted boundary trees after the interior has been felled. If the red painted tree is in a multiple-stem clump, cut all stems within that clump.

2 - Timber Specifications

2.1 - Included Timber

2.1.1 - Clearcut Unit(s) with Unmerchantable Trees (6/14)

Within Payment Unit(s) 1, 2, & 3, cut all trees that are two (2) inches or more at DBH except cedar, hemlock, and trees marked with green paint. Patches of white pine saplings may be left if they can be protected during harvesting.

2.1.11 - Description of Timber Note (2/04)

Note that all red pine, white pine, jack pine, aspen, red maple, spruce, and fir were cruised as pulp. Note also that Misc Species 2 is dead oak that the top has not broken out of.

2.2 - Utilization

2.2.3 - Stump Heights (12/24)

Stump heights within the Sale Area shall not exceed 12 inches for trees greater than 10 inches at DBH and six (6) inches for trees smaller than 10 inches at DBH. Stumps may be left up to 24 inches tall for trees greater than 20 inches at DBH.

3 - Payments

3.4 - Damaged Timber

3.4.1 - Damaged Timber (12/24)

General Condition and Requirement 3.4 Damaged Timber, defines liquidated damages for undesignated live merchantable trees which are cut or injured.

No damage is acceptable to undesignated live merchantable trees. Within the Sale Area, if more than 10% of trees (> 4.5" DBH) within a specified area of the sale are damaged, liquidated damages will be assessed for all trees damaged. Rates will be in accordance with General Condition and Requirement 3.4 Damaged Timber.

4 - Transportation

4.1 - Construction

4.1.3 - Slash and Earthen Piles (8/04)

Piles or windrows of earth along roads and landings that have been widened or constructed shall be leveled. Slash from road maintenance or construction, including stumps, shall be utilized or dispersed into the sale.

4.1.6 - Road Construction (4/24)

Construction of new roads, landings, or improvements of existing roads shall be done in such a way as to minimize the environmental and visual impacts. Merchantable trees shall be cut and utilized unless otherwise directed. Non-merchantable trees shall be severed and laid flat on the ground. Slash shall be utilized or scattered, not left in piles or windrows, and kept a minimum of 10 feet back from the road edge. Stumps shall be set upright, not left on edge, and be moved at least 10 feet away from the road edge. Disturbed soil shall be feathered into the woods and not left in berms or windrows.

4.1.7 - Road Closure (10/11)

All new roads built into the sale must be blocked to vehicle traffic upon completion of the sale. Overgrown roads that are reopened shall be considered new roads. In general, closure will require constructing a four (4') foot high berm of stumps and logs covered with earth. Stumps and brush may also need to be placed at intervals along the trail. Contact the sale

administrator for specific details of design and placement.

4.1.11 - Permits (2/12)

The Purchaser will secure any necessary highway and county road permits that may be required.

5 - Operations

5.1 - Notification

5.1.1 - Pre-sale Conference (10/25)

A pre-sale conference on site between the Purchaser and Sale Administrator is required prior to beginning any operations to determine landing and road locations. The Unit Manager or his/her representative must be contacted at least 5 days in advance to schedule the conference.

5.1.4 - Post-Sale Conference (10/16)

A post-sale conference on site between the Purchaser and sale administrator is required prior to the completion of active logging operations to determine clean-up and repair of landings, road edges, and the fulfillment of other contract specifications.

5.2 - Conduct of Operations

5.2.1 - Slash

5.2.1.13 - Dispose of Slash as Directed (12/05)

Slash is to be disposed of as directed by the Sale Administrator, such as flattening taller slash piles within the visual depth zone of the roads.

5.2.2 - Hazard Trees/Snags

5.2.2.1 - Den Trees (10/16)

Obvious hollow and/or den trees shall be protected and left standing unless they are a safety hazard.

5.2.3 - Operating Restrictions

5.2.3.1 - Operating Restrictions (9/11)

Within Payment Unit(s) 1, 2, & 3, unless changed by written agreement, cutting and skidding within the low ground areas are limited to dry summer or frozen winter conditions. This restriction is necessary to minimize rutting in the areas of low ground.

5.2.3.5 - Oak Wilt Restriction (1/18)

Within Payment Unit(s) 1, 2 & 3, unless changed by written agreement, cutting, skidding, hauling within the sale and brushing of access roads to the sale are not permitted during the period of April 15 to July 15. Operations may be allowed if specific steps are taken to prevent damaging uncut oak during the high-risk period. Those steps may include completing all road brushing before April 15 and clearing a tree-length buffer along uncut oak cover before April 15. This is necessary to reduce the spread of oak wilt. For more information, contact the Unit Manager or his/her representative.

5.2.4 - Dead and Down Creation

5.2.4.4 - Dead and Down Creation, Grouse (6/18)

To encourage grouse and other wildlife, in Payment Unit(s) 1-3 leave one 12" or larger diameter (or largest diameter trees within stand) whole tree on the ground for every two (2) acres, preferably a hardwood species such as oak or maple or if no hardwoods are present, a pine species (white or red). These trees will be evenly scattered throughout the Payment Unit, preferably at least two chains from any roads, two-tracks, or trails open to vehicles.

5.2.29 - Shrub Protection (1/20)

Reasonable care should be taken to avoid cutting or damaging hawthorn or juneberry. These woody-shrub plants are highly beneficial to various wildlife species.

5.2.38 - No Decking Against Live Trees (2/04)

Cut products may not be decked against unmarked or designated leave trees.

5.4 - Soil Protection

5.4.6 - Wet Area Protection (5/10)

No harvesting operations, including skidding and felling, are to take place within the sedge wetland shown on the Timber Sale Map in the south half of Payment Unit 1. Care must be taken by the Purchaser to identify and avoid operating in these areas of the timber sale.

6 - Safety and Fire Prevention

6.2 - Signing

6.2.1 - Road Posting (10/20)

The Purchaser is responsible for posting and maintaining caution signs on the roads with harvest interface prior to beginning operations. The road must be posted at appropriate distances from the sale area to warn of logging activity and truck traffic. Signs must be removed when harvest operations are suspended or completed. Signs only need to be posted on active Payment Units. The Purchaser will provide these signs.

7 - Other Conditions

7.5 - Loss

7.5.1 - Deteriorating Timber (7/09)

The Sale Area has received damage from age-related decline and jack pine budworm. The Purchaser should harvest the wood as soon as possible. The Department of Natural Resources is held free of responsibility of any further damage or deterioration due to delay in harvesting.



TIMBER SALE MAP

This information provided by authority of Part 525, 1994 PA 451, as amended.

Sale Number	Date	
72-024-24	01/14/2025	
Scale	Page	Of
1:7,920	1	1

Forest Management Unit	County	Mapped By: Charlebois
Grayling Mgt Unit	Crawford	Cruised By: Charlebois

Township	Range	Section(s) and Subdivision(s)
25N	02W	Sec. 13 N1/2NW,SWNW; Sec. 14 NENE,S1/2NE;

Cover Type			
A = Aspen	J = Jack Pine	O = Oak	U = Upland Brush
B = Paper Birch	K = Rock	P = Lowland Poplar	UM = Upland Mix Forest
C = Cedar	L = Lowland Brush	Q = Mixed Swamp Conifer	V = Bog or Marsh
D = Treed Bog	LM = Lowland Mix Forest	R = Red Pine	W = White Pine
E = Swamp Hardwoods	M = Maple, Beech, Birch	S = Black Spruce	X = Non Stocked

Density	
0 = Non Stocked	5 = Pole Timber Medium
1 = Seedling Sapling Poor	6 = Pole Timber Well
2 = Seedling Sapling Medium	7 = Saw Timber Poor
3 = Seedling Sapling Well	8 = Saw Timber Medium
4 = Pole Timber Poor	9 = Saw Timber Well

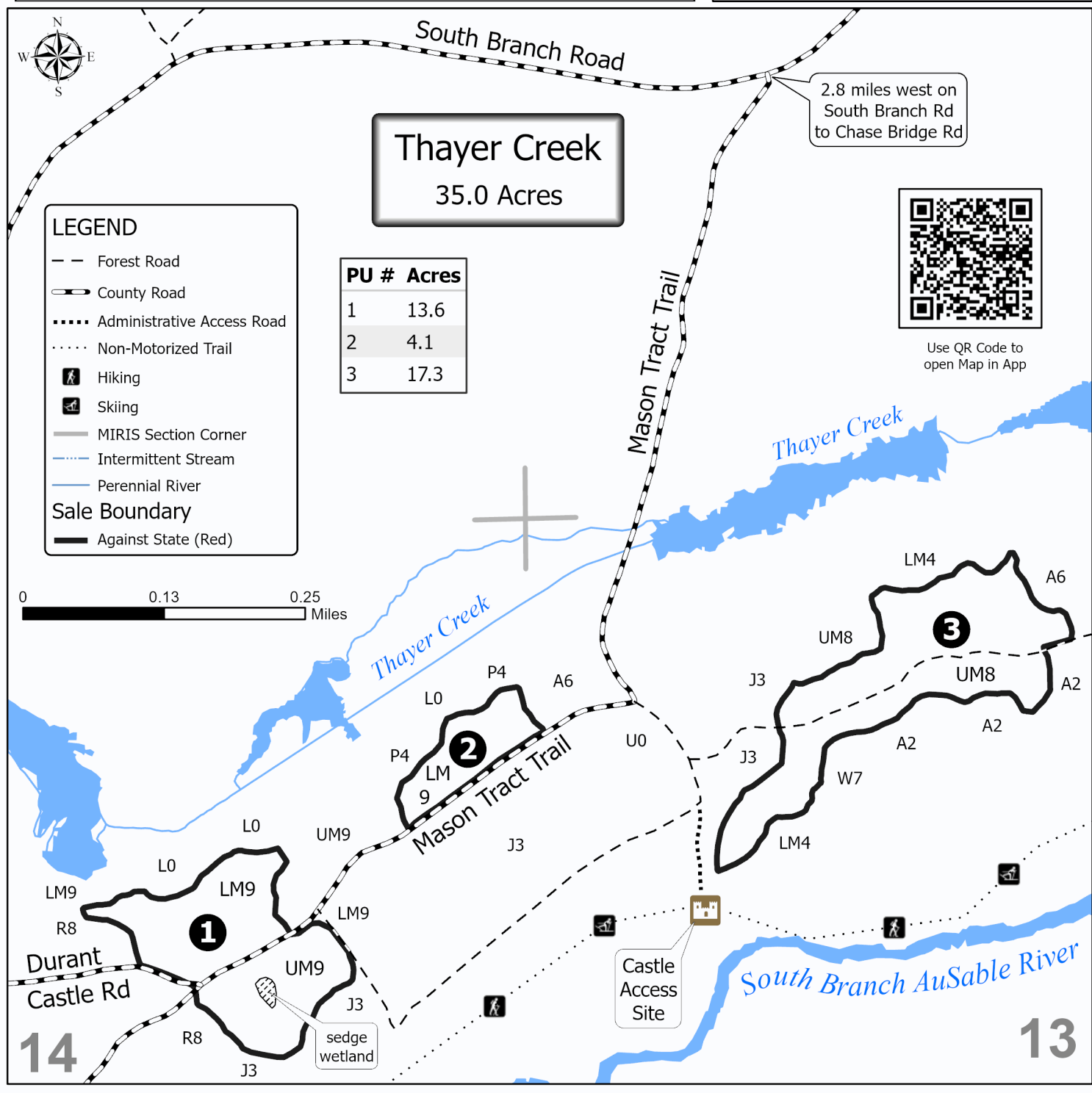

Use QR Code to open Map in App

TIMBER SALE INFORMATION

Goodfellers (72-027-24)

T26N, R03W, SEC. 28.

Crawford County (Advertised Price \$44,771.65)

SALE NOTE: Soft oak wilt spec applies to this sale; however, the DNR may deny any requests to operate during the restricted time period. Also, please take a look in person at this sale as the Wilderness Trail Fire (June 2023) did burn through the northern half of this sale area but did not necessarily lead to mortality. Though there is charred bark present within sale area, and oak decline is present - more so in Payment Unit 1. There is a 3 year contract on this sale.

A timber sale contract for this lump sum, sealed bid timber sale will be awarded to the responsible bidder offering the highest sealed bid price. All units of volume listed below were estimated using the Inventory Manager computer program and the new Michigan taper model. Bids must be at or above the following advertised price for each product and species:

<u>PRODUCTS & SPECIES</u>	<u>ESTIMATED UNITS*</u>	<u>ADVERTISED PRICE</u>
Sawtimber		
Black/Red (Hybrid) Oak	8.1 MBF	\$ 95.00 / MBF
Red Maple	9.9 MBF	\$ 41.00 / MBF
Red Oak	260.6 MBF	\$ 114.00 / MBF
White Oak	24.1 MBF	\$ 63.00 / MBF
Pulpwood		
B. T. Aspen	107 Cords	\$ 11.95 / Cord
Misc. Species 2	4 Cords	\$ 4.00 / Cord
Misc. Species 3	69 Cords	\$ 5.00 / Cord
Mixed Oak	589 Cords	\$ 13.70 / Cord
Red Maple	212 Cords	\$ 12.55 / Cord

* The total volume is statistically estimated within plus (+) or minus (-) 13.45 percent. There are an estimated 1,690 cords on this timber sale, plus or minus 227 cords at the 95% confidence level. The estimated units are final and not subject to adjustment. Prospective bidders are urged to examine this timber and to make their own estimates of quantity and quality.

BOND AND PAYMENT SCHEDULE:

1. A bond in the amount of \$2,239.00 to insure faithful performance of the conditions of the contract will be deposited by the successful bidder within 21 days of the sale award.
2. Cutting in any sale or unit without the required advance payment would be considered a trespass.
3. Total payment must be paid in advance or according to the following schedule :
 - (a) Ten percent (10%) of the sale value must be paid within 21 days of the sale award.
 - (b) The 10% down payment will be credited towards the first unit cut.
 - (c) Payment for each of the following units must be made before cutting begins in that unit:

PAYMENT UNIT NUMBER	PERCENT OF TOTAL SALE VALUE
01	32.8%
02	67.2%

4. If no cutting takes place, the 10% down payment will not be refunded.
5. Operations on the contract issued will terminate on 09/30/2029.

SALE STATISTICS

Volumes were calculated in cubic feet using the Michigan taper model. Cubic foot volume includes all wood inside bark for the product indicated. For display purposes, cubic feet were converted to cords and MBF using a simple conversion factor, e.g. 79 cubic feet per cord and 185 cubic feet per MBF. The cubic foot volumes are precise; the cords and MBF volumes are not. Cubic foot volume cannot be directly converted to cords or boards with precision.

SALE VOLUMES

The total estimated sale volume may not equal the sum of the species/products due to the nature of statistical calculations associated with double sampling methodology.

VOLUME		STATISTICAL RANGE IN CORDS		
TOTAL CUBIC FEET	TOTAL CORDS	PERCENT ERROR	MINIMUM	MAXIMUM
133,527	1,690	13.45%	1,463	1,918

VDU VOLUMES

A VDU is a Volume Determination Unit. Volumes and their associated statistics are calculated at the VDU level and summarized to the sale level. There is often a one to one relationship between a VDU and a Payment Unit, but not always, depending on the cruise design. Refer to the VDU TO PAYMENT UNIT table.

VDU	VOLUME		PERCENT ERROR	RANGE IN CORDS	
	TOTAL CUBIC FEET	TOTAL CORDS		MINIMUM	MAXIMUM
21	20,949	265	27.52%	192	338
24	112,577	1,425	15.18%	1,209	1,641
TOTAL:	133,527	1,690		1,401	1,980

VDU TO PAYMENT UNIT

When a VDU is associated with more than one Payment Unit (PU), the VDU volumes are assigned to the PU based on acres of the VDU within the PU.

VDU	VDU ACRES	PU	PU ACRES
21	15.6	1	15.6
24	32.3	1	5.5
		2	26.8
TOTAL:	47.9		47.9

DESCRIPTION OF TIMBER BY PAYMENT UNIT (PU)

PU	MARKET GROUP	PRODUCT	QUANTITY	UNIT	ACRES	ADVERTISE PRICE
1	Black/Red (Hybrid)	Sawtimber	1.4	MBF	21.1	\$14,677.10
	Red Maple		1.7	MBF		
	Red Oak		92.2	MBF		
	White Oak		11.7	MBF		
	B. T. Aspen	Pulpwood	18	Cords		
	Misc. Species 2		4	Cords		
	Misc. Species 3		21	Cords		
	Mixed Oak		178	Cords		
	/Red (Hybrid) Oak		4	Cords		
	Red Oak		135	Cords		
	White Oak		39	Cords		
	Red Maple		36	Cords		
2	Black/Red (Hybrid)	Sawtimber	6.7	MBF	26.8	\$30,094.55
	Red Maple		8.2	MBF		
	Red Oak		168.4	MBF		
	White Oak		12.4	MBF		
	B. T. Aspen	Pulpwood	89	Cords		
	Misc. Species 3		48	Cords		
	Mixed Oak		411	Cords		
	/Red (Hybrid) Oak		17	Cords		
	Red Oak		326	Cords		
	White Oak		68	Cords		
	Red Maple		176	Cords		
	TOTAL:			302.7		
TOTAL:			981	Cords		

Sale Specific Conditions & Requirements

Sale Name: Goodfellers

Sale Number: 72-027-24 Seq#: 2

1 - Sale Area

1.2 - Boundaries

1.2.1 - Painted Boundaries (9/19)

Exterior sale boundary lines against state are marked with red paint. Exterior sale boundary lines against private property are unmarked as there is a chain-linked fence bordering the private property. Interior Payment Unit boundary is unmarked and instead utilizes the forest access road to designate the division between Payment Units 1 and 2. Retention patches are marked with red paint; no harvesting activities may occur within these areas. The exterior, red painted boundary line trees are not Included Timber and are to be protected.

2 - Timber Specifications

2.1 - Included Timber

2.1.1 - Clearcut Unit(s) with Unmerchantable Trees (6/14)

Within Payment Unit(s) 1 and 2, cut all trees that are two (2) inches or more at DBH except do not cut any red or white pine. These species are not included timber and are to be protected.

2.1.11 - Description of Timber Note (2/04)

Note that Misc. Species 2 is dead aspen and Misc. Species 3 is dead oak. These trees are designated for cutting.

3 - Payments

3.3 - Pre-measured Sales

3.3.4 - Dividing Payment Units (7/14)

Payment Unit(s) may be divided at the request of the Purchaser and upon approval of the Unit Manager. Dividing Payment Units is a contract modification which requires a Timber Sale Contract Amendment. There will be only one division per Payment Unit.

3.4 - Damaged Timber

3.4.1 - Damaged Timber (12/24)

General Condition and Requirement 3.4 Damaged Timber, defines liquidated damages for undesignated live merchantable trees which are cut or injured. In addition, reasonable care should be taken to avoid damage to tree seedlings and saplings. No damage is acceptable to undesignated live merchantable trees. Within the Sale Area, if more than 10% of trees (> 4.5" DBH) within a specified area of the sale are damaged, liquidated damages will be assessed for all trees damaged. Rates will be in accordance with General Condition and Requirement 3.4 Damaged Timber.

4 - Transportation

4.1 - Construction

4.1.3 - Slash and Earthen Piles (8/04)

Piles or windrows of earth along roads and landings that have been widened or constructed shall be leveled. Slash from road maintenance or construction, including stumps, shall be dispersed throughout the sale.

4.1.6 - Road Construction (4/24)

Construction of new roads or improvements of existing roads shall be done in such a way as to minimize the environmental and visual impacts. Merchantable trees shall be cut and utilized unless otherwise directed. Non-merchantable trees shall be severed and laid flat on the ground. Slash shall be scattered, and not left in windrows and kept a minimum of 10 feet back from the road edge. Stumps shall be set upright, not left on edge, and be moved at least 10 feet away from the road edge. Disturbed soil shall be feathered into the woods and not left in berms or windrows.

4.1.7 - Road Closure (10/11)

All new roads built into the sale must be blocked to vehicle traffic upon completion of the sale. Overgrown roads that are reopened shall be considered new roads. Temporary berms may be required if no sale activity occurs for 30 or more

consecutive days. Contact the sale administrator for specific details of design and placement.

4.1.11 - Permits (2/12)

The Purchaser will secure any necessary permits that may be required.

5 - Operations

5.2 - Conduct of Operations

5.2.2 - Hazard Trees/Snags

5.2.2.1 - Den Trees (10/16)

Obvious hollow and/or den trees shall be protected and left standing unless they are a safety hazard.

5.2.3 - Operating Restrictions

5.2.3.5 - Oak Wilt Restriction (1/18)

Within Payment Unit(s) 1 and 2, unless changed by written agreement, cutting, skidding, hauling within the sale and brushing of access roads to the sale are not permitted during the period of April 15 to July 15. Operations may be allowed if specific steps are taken to prevent damaging uncut oak during the high-risk period. Those steps may include completing all road brushing before April 15 and clearing a tree-length buffer along uncut oak cover before April 15. This is necessary to reduce the spread of oak wilt. For more information, contact the Unit Manager or his/her representative.

5.2.32 - Decking/Landing Restoration (9/13)

All decking and landing areas must have the surface area restored to a condition equal to or better than before. This is to ensure the proper regeneration of the stand. Wood debris, chips and "cookies" from trimmings must be removed or scattered away from landing and loading areas and may not be windrowed on the edge.

5.2.38 - No Decking Against Live Trees (2/04)

Cut products may not be decked against unmarked or designated leave trees.

5.4 - Soil Protection

5.4.2 - Skid Trails (2/04)

Skid trails up and down slopes should be avoided. If, however, this is unavoidable, these trails will be left in a non-erodible condition using water bars, logs, and slash. Placing of slash on these skid trails while logging is ongoing may alleviate need for any further action. At the direction of the Sale Administrator, seed, fertilizer, and mulch may also be required.

5.5 - Protection of Improvements

5.5.3 - Protection of Improvements Detail (10/13)

Avoid damage to antenna tower and associated infrastructure located in the area indicated on the map.

5.8 - Protection of Endangered Species

5.8.5 - Protection of Raptor Nests (3/13)

All trees with raptor nests will be protected if found during harvesting operations. Notification will be made to the Unit Manager or his/her representative who will notify the Wildlife Biologist so an onsite evaluation and recommendation can be made, if necessary.

6 - Safety and Fire Prevention

6.2 - Signing

6.2.1 - Road Posting (10/20)

The Purchaser is responsible for posting and maintaining caution signs on Barker Lake Rd prior to beginning operations. The road must be posted appropriate distances from the forest road access off Barker Lake Rd to warn of logging activity and truck traffic. Signs must be removed when harvest operations are suspended or completed. The Purchaser will provide these signs.

7 - Other Conditions

7.5 - Loss

7.5.1 - Deteriorating Timber (7/09)

The Sale Area has received damage from the Wilderness Trail Fire in 2023, though predominately pertains to superficial bark charring on mature oak, maple, and aspen. There is however fairly widespread oak decline in Payment Unit 1. The Purchaser should harvest the wood as soon as possible. The Department of Natural Resources is held free of responsibility of any further damage or deterioration due to delay in harvesting.



TIMBER SALE MAP

This information provided by authority of Part 525, 1994 PA 451, as amended.

Sale Number

72-027-24

Date

01/22/2025

Forest Management Unit

Grayling Mgt Unit

County

Crawford

Mapped By: Jake Halabut

Cruised By: Jake Halabut

Scale

1:15,840

Page

1

Of

1

Township
26N

Range
03W

Section(s) and
Subdivision(s) Sec. 28 S1/2SW,W1/2SE;

Cover Type

A = Aspen	J = Jack Pine	O = Oak	U = Upland Brush
B = Paper Birch	K = Rock	P = Lowland Poplar	UM = Upland Mix Forest
C = Cedar	L = Lowland Brush	Q = Mixed Swamp Conifer	V = Bog or Marsh
D = Treed Bog	LM = Lowland Mix Forest	R = Red Pine	W = White Pine
E = Swamp Hardwoods	M = Maple, Beech, Birch	S = Black Spruce	X = Non Stocked
F = Spruce/Fir	MC = Mixed Conifer	T = Tamarack	Y = Sand
G = Grass	MD = Mixed Deciduous	Z = Water	
H = Hemlock	N = Marsh		

Density

0 = Non Stocked	5 = Pole Timber Medium
1 = Seedling Sapling Poor	6 = Pole Timber Well
2 = Seedling Sapling Medium	7 = Saw Timber Poor
3 = Seedling Sapling Well	8 = Saw Timber Medium
4 = Pole Timber Poor	9 = Saw Timber Well

Locator Map (1:200,000)

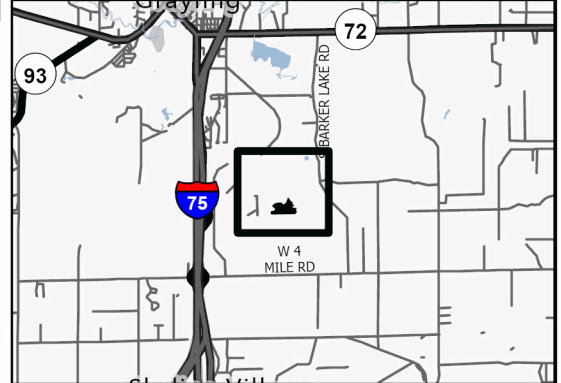

PU # Acres

1	21.1
2	26.7

Goodfellers

47.9 Acres

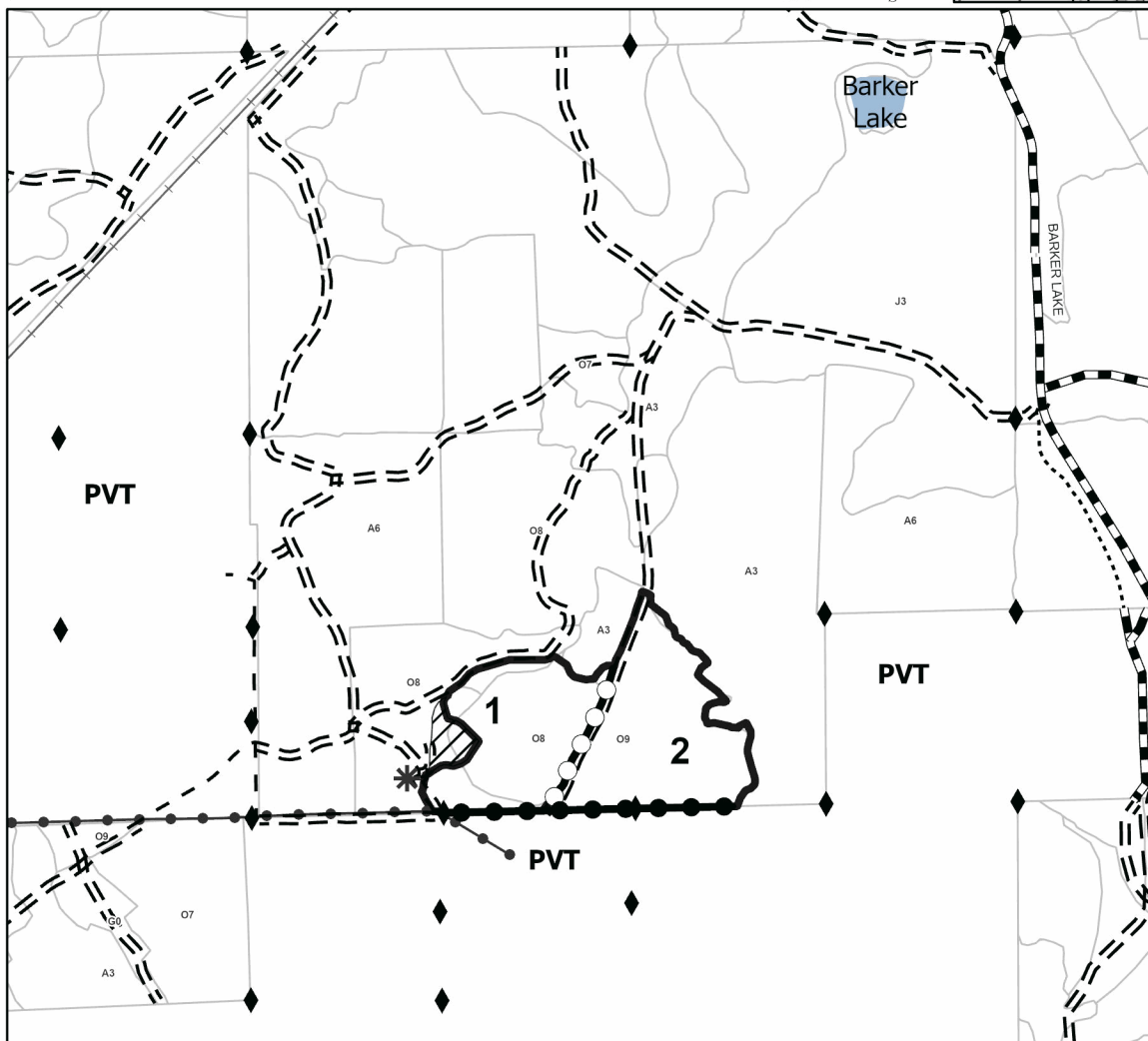

Legend

- Sale Boundary (Painted Red)
- Payment Unit (Unmarked Rd)
- Private Line (Unmarked Fence)
- Retention Area
- Stand
- Powerline
- Active Railroad
- Primary Forest Road
- Forest Access Route
- Administrative Access Only
- Paved Road
- Government Gravel/Dirt
- Private Gravel/Dirt
- Field Grade Corner
- Antenna Tower

Use QR Code to open Map in App





TIMBER SALE MAP

This information provided by authority of Part 525, 1994 PA 451, as amended.

Sale Number 72-027-24	Date 01/23/2025
Scale 1:7,920	Page 1
	Of 1

Forest Management Unit Grayling Mgt Unit	County Crawford	Mapped By: Jake Halabut Cruised By: Jake Halabut
---	--------------------	---

Township 26N	Range 03W	Section(s) and Subdivision(s) Sec. 28 S1/2SW,W1/2SE;
-----------------	--------------	--

Cover Type			
A = Aspen	J = Jack Pine	O = Oak	U = Upland Brush
B = Paper Birch	K = Rock	P = Lowland Poplar	UM = Upland Mix Forest
C = Cedar	L = Lowland Brush	Q = Mixed Swamp Conifer	V = Bog or Marsh
D = Treed Bog	LM = Lowland Mix Forest	R = Red Pine	W = White Pine
E = Swamp Hardwoods	M = Maple, Beech, Birch	S = Black Spruce	X = Non Stocked
F = Spruce/Fir	MC = Mixed Conifer	T = Tamarack	Y = Sand
G = Grass	MD = Mixed Deciduous	Z = Water	
H = Hemlock	N = Marsh		

Density	
0 = Non Stocked	5 = Pole Timber Medium
1 = Seedling Sapling Poor	6 = Pole Timber Well
2 = Seedling Sapling Medium	7 = Saw Timber Poor
3 = Seedling Sapling Well	8 = Saw Timber Medium
4 = Pole Timber Poor	9 = Saw Timber Well

PU #	Acres
1	21.1
2	26.7

Goodfellers

47.9 Acres

Locator Map (1:200,000)

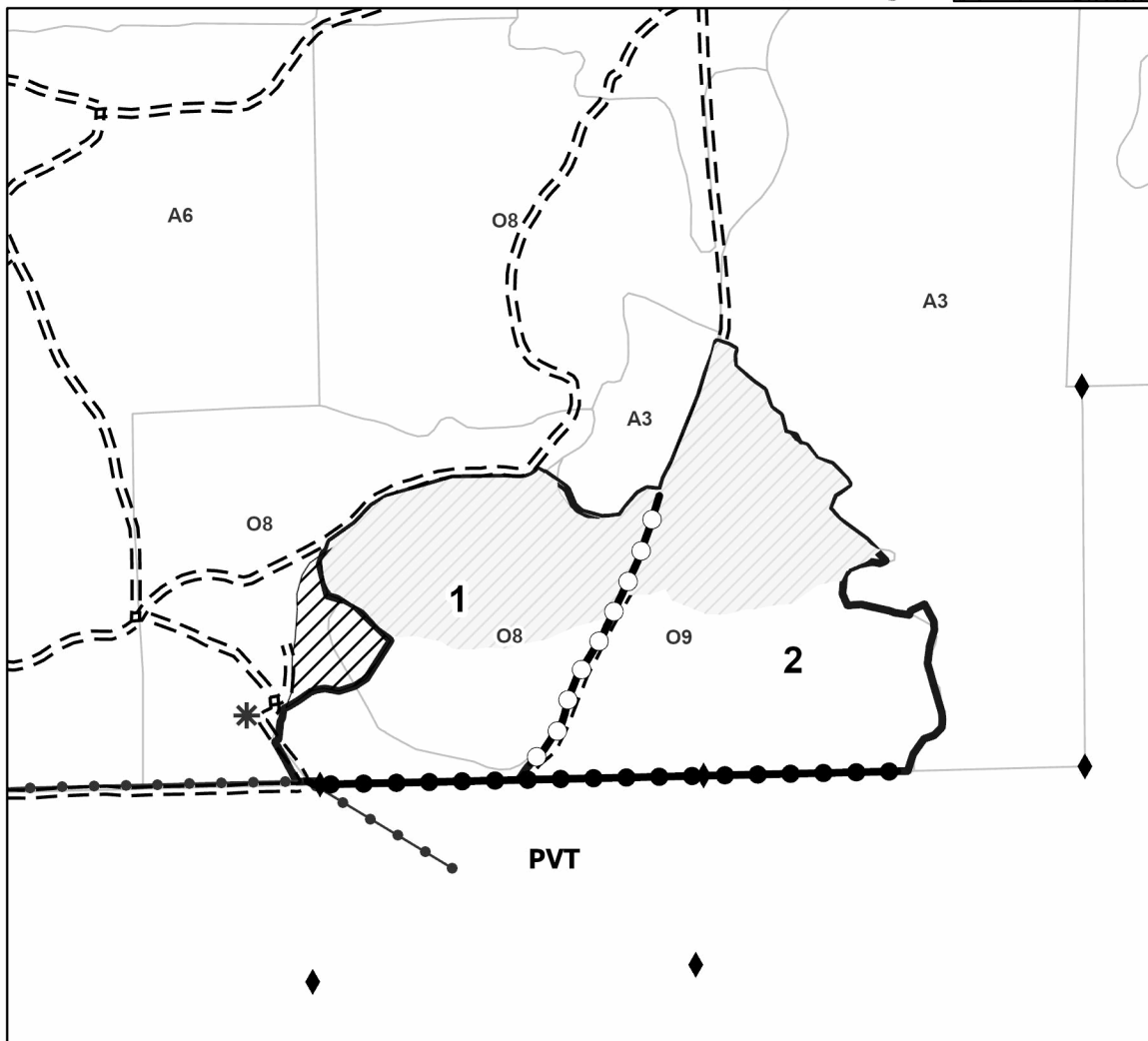
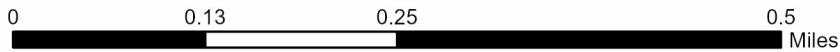
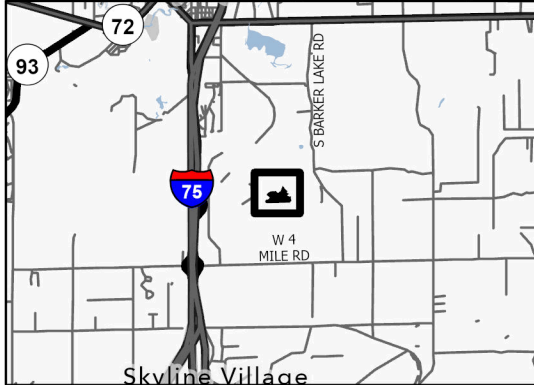

Legend

- Sale Boundary (Painted Red)
- Payment Unit (Unmarked Rd)
- Private Line (Unmarked Fence)
- Retention Area
- Wilderness Trail Fire Area
- Stand
- Powerline
- Primary Forest Road
- Forest Access Route
- Administrative Access Only
- Paved Road
- Government Gravel/Dirt
- Private Gravel/Dirt
- Field Grade Corner
- Antenna Tower

Use QR Code to open Map in App



The Hills Have Flies (72-015-24)
T25N, R03W, SEC. 16; Crawford COUNTY

In response to the notice of sale to be held 9:00 a.m. (local time) on July 13, 2026, I am hereby submitting my sealed bid (firm offer) for the following forest products to be cut. Bids for individual species must be at or above the advertised price. All non-responsive bid forms may be rejected.

<u>PRODUCTS & SPECIES</u>	<u>ESTIMATED VOLUME*</u>	<u>ADVERTISED PRICE</u>	<u>BID PRICE/UNIT</u>
Sawtimber			
Red Maple	14.8 MBF	\$ 51.00/MBF	\$ _____
Red Oak	153.6 MBF	\$ 143.00/MBF	\$ _____
White Oak	83.3 MBF	\$ 79.00/MBF	\$ _____
Pulpwood			
B. T. Aspen	433 Cords	\$ 14.95/Cord	\$ _____
Misc. Species 2	55 Cords	\$ 5.00/Cord	\$ _____
Mixed Hardwood	196 Cords	\$ 15.70/Cord	\$ _____
Mixed Oak	688 Cords	\$ 17.15/Cord	\$ _____
White Pine	37 Cords	\$ 12.45/Cord	\$ _____

*The volumes are statistically estimated within plus (+) or minus (-) 14.81 percent at 95% confidence level. These estimated volumes are final and not subject to adjustment. Prospective bidders are urged to examine this timber and to make their own estimates of quantity and quality.

I understand that any or all bids may be rejected. All bids must be signed and all bid items must be bid or the bid form may be rejected. I also understand that consideration and awarding a contract will be based upon my past performance and ability to complete the contract based upon equipment and staffing subject to my control .

FEDERAL ID: ____ - ____ - ____ or SOCIAL SECURITY NUMBER: ____ - ____ - ____

Company or individual bidding: _____

Company representative's name: _____

Address: _____

City: _____ State: _____ Zip: _____

IF AVAILABLE, PLEASE PLACE THE PERSONALIZED LABEL FROM YOUR PROSPECTUS IN THE ABOVE BOX.

Individual or company representative's signature: _____ Date: _____

Phone number : _____ Email (optional): _____

THE WINNING BIDDER MUST COMPLETE THE VERIFICATION OF WORKER'S DISABILITY COMPENSATION ACT COMPLIANCE (ON REVERSE SIDE IF DOUBLE SIDED) WITHIN 21 DAYS OF SALE AWARD DATE

Thayer Creek (72-024-24)
T25N, R02W, SEC. 13; T25N, R02W, SEC. 14; Crawford COUNTY

In response to the notice of sale to be held 9:00 a.m. (local time) on July 13, 2026, I am hereby submitting my sealed bid (firm offer) for the following forest products to be cut. Bids for individual species must be at or above the advertised price. All non-responsive bid forms may be rejected.

<u>PRODUCTS & SPECIES</u>	<u>ESTIMATED VOLUME*</u>	<u>ADVERTISED PRICE</u>	<u>BID PRICE/UNIT</u>
Sawtimber			
Northern Pin Oak	22.2 MBF	\$ 72.00/MBF	\$ _____
Pulpwood			
Balsam Fir	18 Cords	\$ 19.10/Cord	\$ _____
Black Spruce	43 Cords	\$ 6.95/Cord	\$ _____
Jack Pine	23 Cords	\$ 7.50/Cord	\$ _____
Misc. Species 2	56 Cords	\$ 3.00/Cord	\$ _____
Mixed Aspen	297 Cords	\$ 11.95/Cord	\$ _____
Mixed Hardwood	166 Cords	\$ 12.55/Cord	\$ _____
Mixed Oak	68 Cords	\$ 13.70/Cord	\$ _____
Red Pine	90 Cords	\$ 32.70/Cord	\$ _____
White Pine	234 Cords	\$ 9.95/Cord	\$ _____

*The volumes are statistically estimated within plus (+) or minus (-) 26.53 percent at 95% confidence level. These estimated volumes are final and not subject to adjustment. Prospective bidders are urged to examine this timber and to make their own estimates of quantity and quality.

I understand that any or all bids may be rejected. All bids must be signed and all bid items must be bid or the bid form may be rejected. I also understand that consideration and awarding a contract will be based upon my past performance and ability to complete the contract based upon equipment and staffing subject to my control.

FEDERAL ID: _____ or SOCIAL SECURITY NUMBER: _____

Company or individual bidding: _____

Company representative's name: _____

Address: _____

City: _____ State: _____ Zip: _____

IF AVAILABLE, PLEASE PLACE THE PERSONALIZED LABEL FROM YOUR PROSPECTUS IN THE ABOVE BOX.

Individual or company representative's signature: _____ Date: _____

Phone number : _____ Email (optional): _____

THE WINNING BIDDER MUST COMPLETE THE VERIFICATION OF WORKER'S DISABILITY COMPENSATION ACT COMPLIANCE (ON REVERSE SIDE IF DOUBLE SIDED) WITHIN 21 DAYS OF SALE AWARD DATE



TIMBER SALE VERIFICATION OF WORKER'S DISABILITY COMPENSATION ACT COMPLIANCE

As required by Act 317, P.A. 1969 (Worker's Compensation) and
Part 5 of Act 451 of 1994, as amended.

FOR DEPARTMENT USE ONLY	
Sale Number (XX - XXX - XX - XX)	
Forest Management Unit:	

VERIFICATION OF WORKER'S DISABILITY COMPENSATION ACT COMPLIANCE

- This verification must be completed and submitted within 21 days of contract award and prior to the issuance of the timber sale contract.
- In addition, if boxes 2B or 2C are checked, then Notice of Exclusion or Certificate of Insurance must be submitted within twenty-one (21) days of the contract award and prior to the issuance of the timber sale contract.
- All information must be typed or printed except for written signatures.

Please Check Appropriate Categories:

1. My business is organized as (you **must** check one of the boxes below):
 - A. Sole Proprietorship (individual)
 - B. Partnership
 - C. Corporation
2. You **must** check one of the boxes below:
 - A. I certify my business is a sole proprietorship and it has no employees but the sole proprietor. I am not subject to the Worker's Compensation Laws.
 - B. I certify my business has satisfied its obligation to the Worker's Compensation Act through the use of an approved Notice of Exclusion (BWC-337, Rev. 5/96). I will provide a copy of the Notice of Exclusion within 21 days of the contract award. (For questions or a copy of the BWC-337, please call the Worker's Compensation Bureau at 517 -322-1195).
 - C. I certify my business has a Worker's Compensation Policy. I will provide an original Certificate of Insurance within twenty-one (21) days of the contract award.
3. If you have checked item 2(A) or 2(B), you **must** indicate the number of **both** full-time and part-time employees, other than yourself, including family members and active partners (if none, you must enter "0").

_____ Full-time Employees

_____ Part-time Employees

Name of Business		Federal ID (or) Social Security No.	
Address		Telephone ()	
City	State	ZIP	

I hereby certify that the above information is true and correct. I agree to notify the Michigan DNR of any changes that occur in factors affecting my coverage during any of my present and future operations.

Signature of Owner or Authorized Representative

Title

Date

Please complete the "SEALED BID" information on the next page

Goodfellers (72-027-24)
T26N, R03W, SEC. 28; Crawford COUNTY

In response to the notice of sale to be held 9:00 a.m. (local time) on July 13, 2026, I am hereby submitting my sealed bid (firm offer) for the following forest products to be cut. Bids for individual species must be at or above the advertised price. All non-responsive bid forms may be rejected.

<u>PRODUCTS & SPECIES</u>	<u>ESTIMATED VOLUME*</u>	<u>ADVERTISED PRICE</u>	<u>BID PRICE/UNIT</u>
Sawtimber			
Black/Red (Hybrid) Oak	8.1 MBF	\$ 95.00/MBF	\$ _____
Red Maple	9.9 MBF	\$ 41.00/MBF	\$ _____
Red Oak	260.6 MBF	\$ 114.00/MBF	\$ _____
White Oak	24.1 MBF	\$ 63.00/MBF	\$ _____
Pulpwood			
B. T. Aspen	107 Cords	\$ 11.95/Cord	\$ _____
Misc. Species 2	4 Cords	\$ 4.00/Cord	\$ _____
Misc. Species 3	69 Cords	\$ 5.00/Cord	\$ _____
Mixed Oak	589 Cords	\$ 13.70/Cord	\$ _____
Red Maple	212 Cords	\$ 12.55/Cord	\$ _____

*The volumes are statistically estimated within plus (+) or minus (-) 13.45 percent at 95% confidence level. These estimated volumes are final and not subject to adjustment. Prospective bidders are urged to examine this timber and to make their own estimates of quantity and quality.

I understand that any or all bids may be rejected. All bids must be signed and all bid items must be bid or the bid form may be rejected. I also understand that consideration and awarding a contract will be based upon my past performance and ability to complete the contract based upon equipment and staffing subject to my control.

FEDERAL ID: ____ - ____ - ____ or SOCIAL SECURITY NUMBER: ____ - ____ - ____

Company or individual bidding: _____

Company representative's name: _____

Address: _____

City: _____ State: _____ Zip: _____

IF AVAILABLE, PLEASE PLACE THE PERSONALIZED LABEL FROM YOUR PROSPECTUS IN THE ABOVE BOX.

Individual or company representative's signature: _____ Date: _____

Phone number : _____ Email (optional): _____

THE WINNING BIDDER MUST COMPLETE THE VERIFICATION OF WORKER'S DISABILITY COMPENSATION ACT COMPLIANCE (ON REVERSE SIDE IF DOUBLE SIDED) WITHIN 21 DAYS OF SALE AWARD DATE

Mason Tract SW (72-021-24)
T25N, R02W, SEC. 14; T25N, R02W, SEC. 15; T25N, R02W, SEC. 22; T25N,

In response to the notice of sale to be held 9:00 a.m. (local time) on July 13, 2026, I am hereby submitting my sealed bid (firm offer) for the following forest products to be cut. Bids for individual species must be at or above the advertised price. All non-responsive bid forms may be rejected.

<u>PRODUCTS & SPECIES</u>	<u>ESTIMATED VOLUME*</u>	<u>ADVERTISED PRICE</u>	<u>BID PRICE/UNIT</u>
Sawtimber			
Mixed Oak	28.5 MBF	\$ 95.00/MBF	\$ _____
Red Oak	470.7 MBF	\$ 114.00/MBF	\$ _____
White Oak	153.0 MBF	\$ 63.00/MBF	\$ _____
Pulpwood			
Balsam Fir	199 Cords	\$ 19.10/Cord	\$ _____
Jack Pine	163 Cords	\$ 7.50/Cord	\$ _____
Mixed Aspen	99 Cords	\$ 11.95/Cord	\$ _____
Mixed Oak	772 Cords	\$ 13.70/Cord	\$ _____
Red Maple	92 Cords	\$ 12.55/Cord	\$ _____
Red Pine	51 Cords	\$ 32.70/Cord	\$ _____
Scotch Pine	13 Cords	\$ 51.75/Cord	\$ _____
White Pine	395 Cords	\$ 9.95/Cord	\$ _____
White Spruce	8 Cords	\$ 6.95/Cord	\$ _____

*The volumes are statistically estimated within plus (+) or minus (-) 10.97 percent at 95% confidence level. These estimated volumes are final and not subject to adjustment. Prospective bidders are urged to examine this timber and to make their own estimates of quantity and quality.

I understand that any or all bids may be rejected. All bids must be signed and all bid items must be bid or the bid form may be rejected. I also understand that consideration and awarding a contract will be based upon my past performance and ability to complete the contract based upon equipment and staffing subject to my control.

FEDERAL ID: ____ - ____ - ____ or SOCIAL SECURITY NUMBER: ____ - ____ - ____

Company or individual bidding: _____

Company representative's name: _____

Address: _____

City: _____ State: _____ Zip: _____

IF AVAILABLE, PLEASE PLACE THE PERSONALIZED LABEL FROM YOUR PROSPECTUS IN THE ABOVE BOX.

Individual or company representative's signature: _____ Date: _____

Phone number : _____ Email (optional): _____

THE WINNING BIDDER MUST COMPLETE THE VERIFICATION OF WORKER'S DISABILITY COMPENSATION ACT COMPLIANCE (ON REVERSE SIDE IF DOUBLE SIDED) WITHIN 21 DAYS OF SALE AWARD DATE



FOR DEPARTMENT USE ONLY
Sale Number (XX - XXX - XX - XX)
Forest Management Unit:

TIMBER SALE VERIFICATION OF WORKER'S DISABILITY COMPENSATION ACT COMPLIANCE

*As required by Act 317, P.A. 1969 (Worker's Compensation) and
Part 5 of Act 451 of 1994, as amended.*

VERIFICATION OF WORKER'S DISABILITY COMPENSATION ACT COMPLIANCE

- This verification must be completed and submitted within 21 days of contract award and prior to the issuance of the timber sale contract.
- In addition, if boxes 2B or 2C are checked, then Notice of Exclusion or Certificate of Insurance must be submitted within twenty-one (21) days of the contract award and prior to the issuance of the timber sale contract.
- All information must be typed or printed except for written signatures.

Please Check Appropriate Categories:

1. My business is organized as (you **must** check one of the boxes below):
 - A. Sole Proprietorship (individual)
 - B. Partnership
 - C. Corporation
2. You **must** check one of the boxes below:
 - A. I certify my business is a sole proprietorship and it has no employees but the sole proprietor. I am not subject to the Worker's Compensation Laws.
 - B. I certify my business has satisfied its obligation to the Worker's Compensation Act through the use of an approved Notice of Exclusion (BWC-337, Rev. 5/96). I will provide a copy of the Notice of Exclusion within 21 days of the contract award. (For questions or a copy of the BWC-337, please call the Worker's Compensation Bureau at 517 -322-1195).
 - C. I certify my business has a Worker's Compensation Policy. I will provide an original Certificate of Insurance within twenty-one (21) days of the contract award.
3. If you have checked item 2(A) or 2(B), you **must** indicate the number of **both** full-time and part-time employees, other than yourself, including family members and active partners (if none, you must enter "0").

_____ Full-time Employees

_____ Part-time Employees

Name of Business		Federal ID (or) Social Security No.	
Address		Telephone ()	
City	State	ZIP	

I hereby certify that the above information is true and correct. I agree to notify the Michigan DNR of any changes that occur in factors affecting my coverage during any of my present and future operations.

Signature of Owner or Authorized Representative

Title

Date

Please complete the "SEALED BID" information on the next page

GNA2 Cooke Dam RP (72-804-26)
T24N, R07E, SEC. 27; T24N, R07E, SEC. 28; T24N, R07E, SEC. 33; losco

In response to the notice of sale to be held 9:00 a.m. (local time) on July 13, 2026, I am hereby submitting my sealed bid (firm offer) for the following forest products to be cut. Bids for individual species must be at or above the advertised price. All non-responsive bid forms may be rejected.

<u>PRODUCTS & SPECIES</u>	<u>ESTIMATED VOLUME*</u>	<u>ADVERTISED PRICE</u>	<u>BID PRICE/UNIT</u>
Pulpwood			
Jack Pine	14 Cords	\$ 6.25/Cord	\$ _____
Northern Pin Oak	16 Cords	\$ 11.45/Cord	\$ _____
Red Pine	3,785 Cords	\$ 27.25/Cord	\$ _____

*The volumes are statistically estimated within plus (+) or minus (-) 13.21 percent at 95% confidence level. These estimated volumes are final and not subject to adjustment. Prospective bidders are urged to examine this timber and to make their own estimates of quantity and quality.

I understand that any or all bids may be rejected. All bids must be signed and all bid items must be bid or the bid form may be rejected. I also understand that consideration and awarding a contract will be based upon my past performance and ability to complete the contract based upon equipment and staffing subject to my control.

FEDERAL ID: ____ - ____ - ____ or SOCIAL SECURITY NUMBER: ____ - ____ - ____

Company or individual bidding: _____

Company representative's name: _____

Address: _____

City: _____ State: _____ Zip: _____

IF AVAILABLE, PLEASE PLACE THE PERSONALIZED LABEL FROM YOUR PROSPECTUS IN THE ABOVE BOX.

Individual or company representative's signature: _____ Date: _____

Phone number : _____ Email (optional): _____

THE WINNING BIDDER MUST COMPLETE THE VERIFICATION OF WORKER'S DISABILITY COMPENSATION ACT COMPLIANCE (ON REVERSE SIDE IF DOUBLE SIDED) WITHIN 21 DAYS OF SALE AWARD DATE



FOR DEPARTMENT USE ONLY
Sale Number (XX - XXX - XX - XX)
Forest Management Unit:

TIMBER SALE VERIFICATION OF WORKER'S DISABILITY COMPENSATION ACT COMPLIANCE

*As required by Act 317, P.A. 1969 (Worker's Compensation) and
Part 5 of Act 451 of 1994, as amended.*

VERIFICATION OF WORKER'S DISABILITY COMPENSATION ACT COMPLIANCE

- This verification must be completed and submitted within 21 days of contract award and prior to the issuance of the timber sale contract.
- In addition, if boxes 2B or 2C are checked, then Notice of Exclusion or Certificate of Insurance must be submitted within twenty-one (21) days of the contract award and prior to the issuance of the timber sale contract.
- All information must be typed or printed except for written signatures.

Please Check Appropriate Categories:

1. My business is organized as (you **must** check one of the boxes below):
 - A. Sole Proprietorship (individual)
 - B. Partnership
 - C. Corporation
2. You **must** check one of the boxes below:
 - A. I certify my business is a sole proprietorship and it has no employees but the sole proprietor. I am not subject to the Worker's Compensation Laws.
 - B. I certify my business has satisfied its obligation to the Worker's Compensation Act through the use of an approved Notice of Exclusion (BWC-337, Rev. 5/96). I will provide a copy of the Notice of Exclusion within 21 days of the contract award. (For questions or a copy of the BWC-337, please call the Worker's Compensation Bureau at 517 -322-1195).
 - C. I certify my business has a Worker's Compensation Policy. I will provide an original Certificate of Insurance within twenty-one (21) days of the contract award.
3. If you have checked item 2(A) or 2(B), you **must** indicate the number of **both** full-time and part-time employees, other than yourself, including family members and active partners (if none, you must enter "0").

_____ Full-time Employees

_____ Part-time Employees

Name of Business		Federal ID (or) Social Security No.	
Address		Telephone ()	
City	State	ZIP	

I hereby certify that the above information is true and correct. I agree to notify the Michigan DNR of any changes that occur in factors affecting my coverage during any of my present and future operations.

Signature of Owner or Authorized Representative

Title

Date

Please complete the "SEALED BID" information on the next page

Better Call Saw (72-006-24)
T28N, R04W, SEC. 31; T28N, R04W, SEC. 32; Crawford COUNTY

In response to the notice of sale to be held 9:00 a.m. (local time) on July 13, 2026, I am hereby submitting my sealed bid (firm offer) for the following forest products to be cut. Bids for individual species must be at or above the advertised price. All non-responsive bid forms may be rejected.

<u>PRODUCTS & SPECIES</u>	<u>ESTIMATED VOLUME*</u>	<u>ADVERTISED PRICE</u>	<u>BID PRICE/UNIT</u>
Sawtimber			
Black/Red (Hybrid) Oak	199.6 MBF	\$ 110.00/MBF	\$ _____
White Oak	36.6 MBF	\$ 91.00/MBF	\$ _____
Pulpwood			
Jack Pine	748 Cords	\$ 10.55/Cord	\$ _____
Misc. Species 1	12 Cords	\$ 4.50/Cord	\$ _____
Mixed Hardwood	219 Cords	\$ 19.55/Cord	\$ _____
Mixed Oak	453 Cords	\$ 18.60/Cord	\$ _____
Red Pine	99 Cords	\$ 42.10/Cord	\$ _____
White Pine	34 Cords	\$ 14.45/Cord	\$ _____

*The volumes are statistically estimated within plus (+) or minus (-) 14.54 percent at 95% confidence level. These estimated volumes are final and not subject to adjustment. Prospective bidders are urged to examine this timber and to make their own estimates of quantity and quality.

I understand that any or all bids may be rejected. All bids must be signed and all bid items must be bid or the bid form may be rejected. I also understand that consideration and awarding a contract will be based upon my past performance and ability to complete the contract based upon equipment and staffing subject to my control .

FEDERAL ID: ____ - ____ - ____ or SOCIAL SECURITY NUMBER: ____ - ____ - ____

Company or individual bidding: _____

Company representative's name: _____

Address: _____

City: _____ State: _____ Zip: _____

IF AVAILABLE, PLEASE PLACE THE PERSONALIZED LABEL FROM YOUR PROSPECTUS IN THE ABOVE BOX.

Individual or company representative's signature: _____ Date: _____

Phone number : _____ Email (optional): _____

THE WINNING BIDDER MUST COMPLETE THE VERIFICATION OF WORKER'S DISABILITY COMPENSATION ACT COMPLIANCE (ON REVERSE SIDE IF DOUBLE SIDED) WITHIN 21 DAYS OF SALE AWARD DATE



FOR DEPARTMENT USE ONLY
Sale Number (XX - XXX - XX - XX)
Forest Management Unit:

TIMBER SALE VERIFICATION OF WORKER'S DISABILITY COMPENSATION ACT COMPLIANCE

*As required by Act 317, P.A. 1969 (Worker's Compensation) and
Part 5 of Act 451 of 1994, as amended.*

VERIFICATION OF WORKER'S DISABILITY COMPENSATION ACT COMPLIANCE

- This verification must be completed and submitted within 21 days of contract award and prior to the issuance of the timber sale contract.
- In addition, if boxes 2B or 2C are checked, then Notice of Exclusion or Certificate of Insurance must be submitted within twenty-one (21) days of the contract award and prior to the issuance of the timber sale contract.
- All information must be typed or printed except for written signatures.

Please Check Appropriate Categories:

1. My business is organized as (you **must** check one of the boxes below):
 - A. Sole Proprietorship (individual)
 - B. Partnership
 - C. Corporation

2. You **must** check one of the boxes below:
 - A. I certify my business is a sole proprietorship and it has no employees but the sole proprietor. I am not subject to the Worker's Compensation Laws.
 - B. I certify my business has satisfied its obligation to the Worker's Compensation Act through the use of an approved Notice of Exclusion (BWC-337, Rev. 5/96). I will provide a copy of the Notice of Exclusion within 21 days of the contract award. (For questions or a copy of the BWC-337, please call the Worker's Compensation Bureau at 517 -322-1195).
 - C. I certify my business has a Worker's Compensation Policy. I will provide an original Certificate of Insurance within twenty-one (21) days of the contract award.

3. If you have checked item 2(A) or 2(B), you **must** indicate the number of **both** full-time and part-time employees, other than yourself, including family members and active partners (if none, you must enter "0").

_____ Full-time Employees

_____ Part-time Employees

Name of Business		Federal ID (or) Social Security No.	
Address		Telephone ()	
City	State	ZIP	

I hereby certify that the above information is true and correct. I agree to notify the Michigan DNR of any changes that occur in factors affecting my coverage during any of my present and future operations.

Signature of Owner or Authorized Representative

Title

Date

Please complete the "SEALED BID" information on the next page