



Facility Summary Report

Building Name: *Platte River State Fish Hatchery/Hatchery Building*

DNR TagID#: *82307*

Facility Location: *Platte River State Fish Hatchery*

Inventory Status: *Pending*

Inventory Date: *06/28/2017*

Managing Agency: *Fisheries*

Facility Type: *Other*

Facility Use: *Fish Production Facility*

Building Status: *Active*

Building Manager: *Aaron Switzer (231-325-4611)*

Building Telephone: *231-325-4611*

Building Fax: *231-325-2111*

Building Address: *Unknown*

Construction Date:

Square Footage: *25,728*

Historical Cost: *\$1,211,052*

Leased/Own: *DNR-Owned*

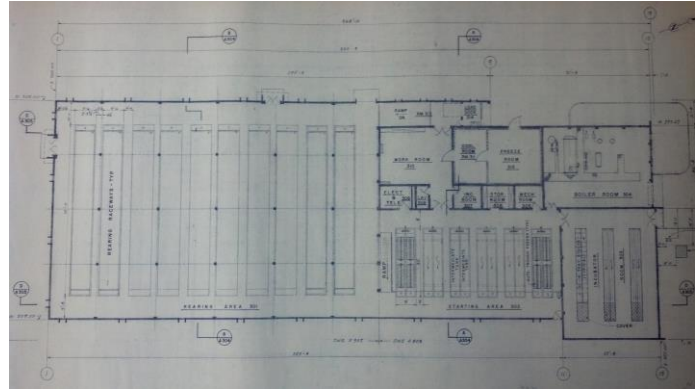

Employees at Location: *Yes - 4*

Vacant Workstations: *Yes - 0*

Electricity: *Yes*

Water: *Yes*

Heat: *Yes*

Storage Space: *Yes - Heated*

MISC. COMMENTS

LOCATION INFORMATION

COUNTY NAME	TIER/RANGE	TOWNSHIP NAME	SECTION	QQ	Q	LOTs PAR ID	LATITUDE	LONGITUDE
Benzie	26N - 13W	INLAND	07	NW	SW	13895	44.66386274	-85.93604946