

MICHIGAN DEPARTMENT OF CONSERVATION
O'CONNELL LAKE

AREA 3.6 ACRES

BARRY COUNTY T. 2 N., R. 10 W., SEC. 3
 SURVEY AND SOUNDINGS FEB. 14, 1964

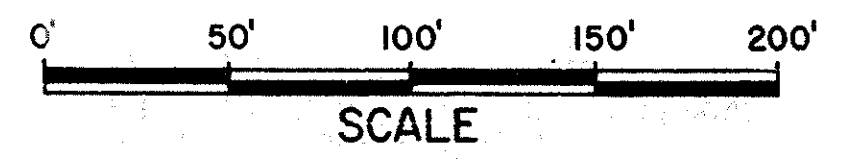
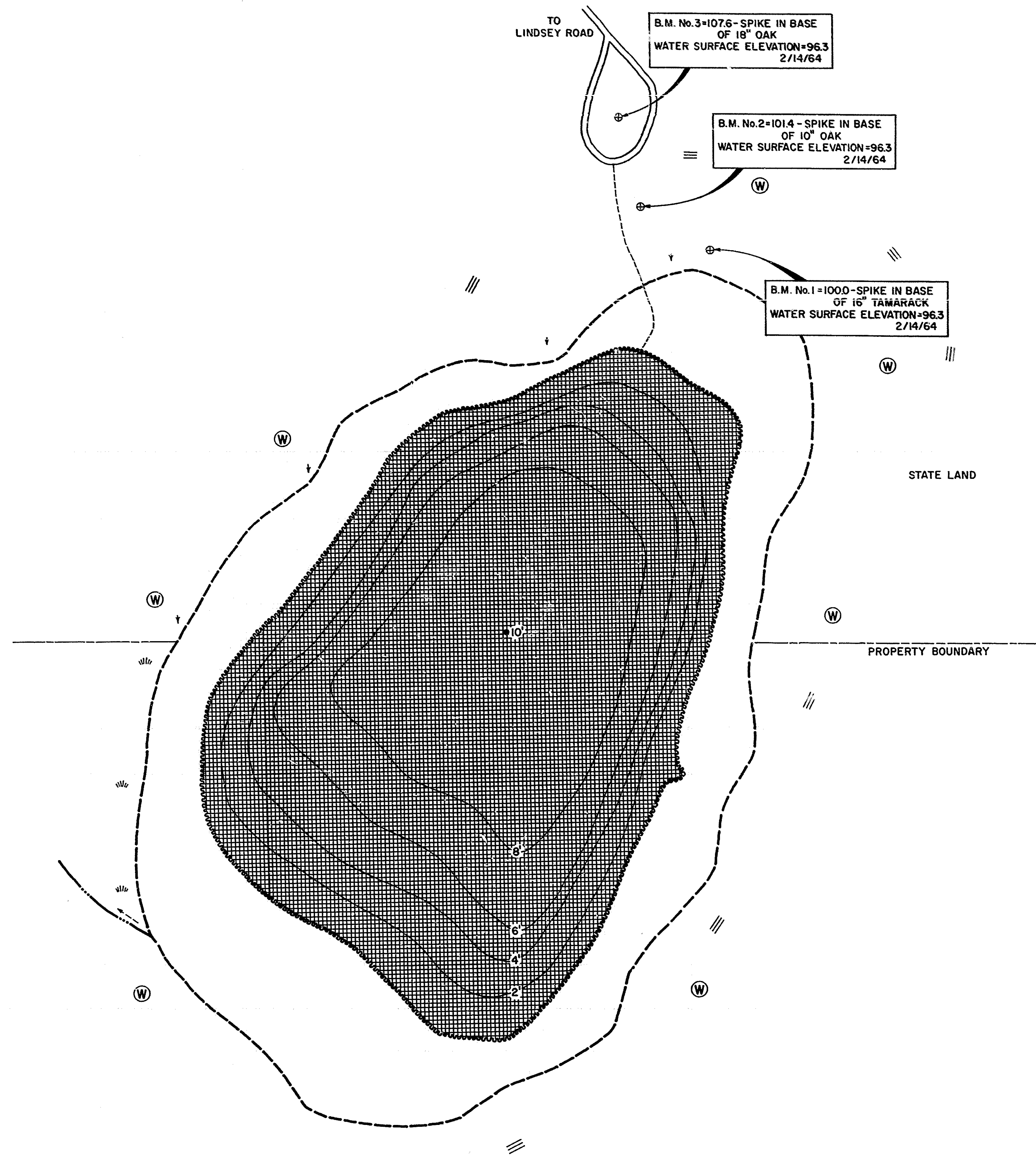

- LEGEND**
- BOTTOM**
- Marl
- SHORE FEATURES**
- Encroaching shore
 - Former shoreline
 - Steep slope
 - Wooded
 - Brush
 - Marsh
 - Improved road
 - Foot trail
 - Intermittent inlet or outlet