

B.M. = 100.0 - SPIKE IN BASE OF
24" RED PINE
WATER SURFACE ELEVATION +95.0
2/16/66

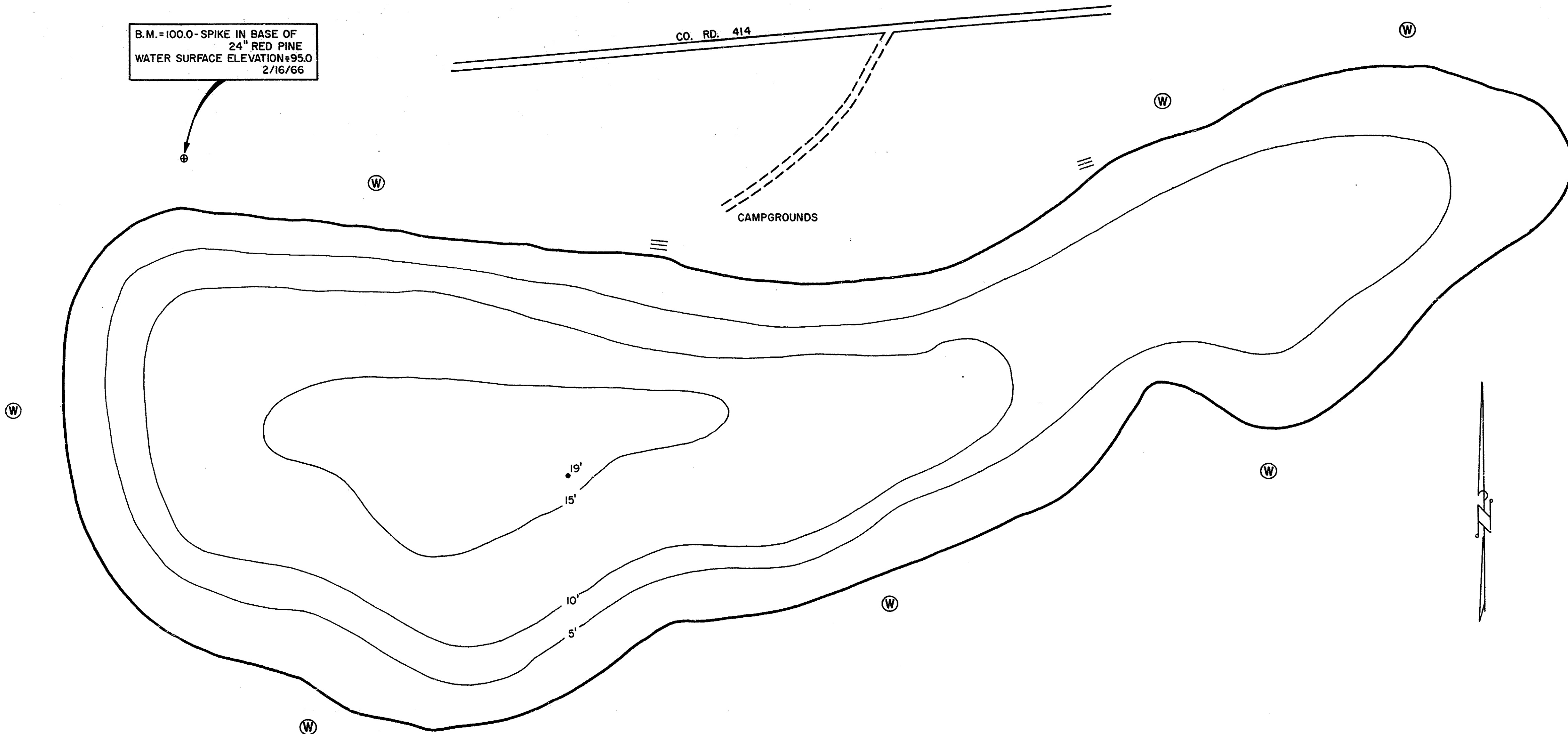

LEGEND

- BOTTOM**
□ Organic
- SHORE FEATURES**
≡ Steep slope
⊙ Wooded
= Improved road
- - - Unimproved road

MICHIGAN DEPARTMENT OF CONSERVATION
LITTLE PERCH LAKE
AREA 7.5 ACRES
LUCE COUNTY T.49N., R.9W., SEC. 17
SURVEY AND SOUNDINGS FEB. 16, 1966