

B.M.#100.0 - R.R. SPIKE BASE OF
LONE ISth NORWAY
PINE
WATER SURFACE ELEV. = 97.3
3/10/50

INSTITUTE FOR FISHERIES RESEARCH
DIVISION OF FISHERIES MICHIGAN CONSERVATION DEPT.
LAKE INVENTORY MAP
SILVER LAKE
AREA 54.5 ACRES
MARGINAL SURVEY AND SOUNDINGS 3/10/50
INVENTORY 8/17-18/50
CLARE COUNTY T. 18 N., R. 5-6 W., SEC'S. 25, 30

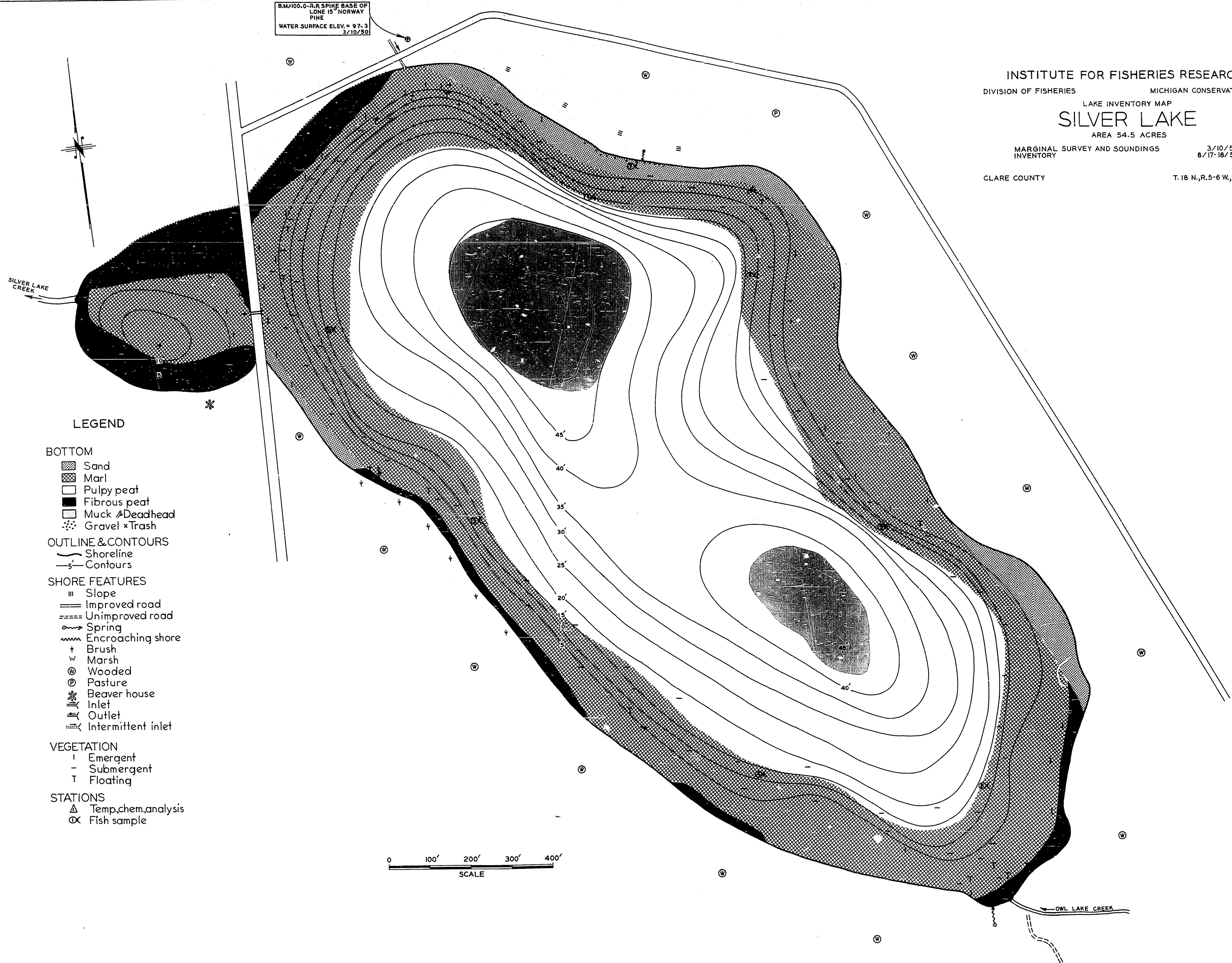

LEGEND

BOTTOM

- Sand
- Marl
- Pulpy peat
- Fibrous peat
- Muck & Deadhead
- Gravel & Trash

OUTLINE & CONTOURS

- Shoreline
- Contours

SHORE FEATURES

- Slope
- Improved road
- Unimproved road
- Spring
- Encroaching shore
- Brush
- Marsh
- Wooded
- Pasture
- Beaver house
- Inlet
- Outlet
- Intermittent inlet

VEGETATION

- Emergent
- Submergent
- Floating

STATIONS

- Temp, chem, analysis
- Fish sample

