

INSTITUTE FOR FISHERIES RESEARCH
 DIVISION OF FISHERIES MICHIGAN CONSERVATION DEPT.

LAKE INVENTORY MAP
HAYMARSH LAKE NO. 3
 AREA 17.5 ACRES

MARGINAL SURVEY AND SOUNDINGS INVENTORY 1/24, 25/46
 8/15-17/46

MECOSTA COUNTY T. 16 N., R. 9 W., SEC. 25, 26, 35, 36

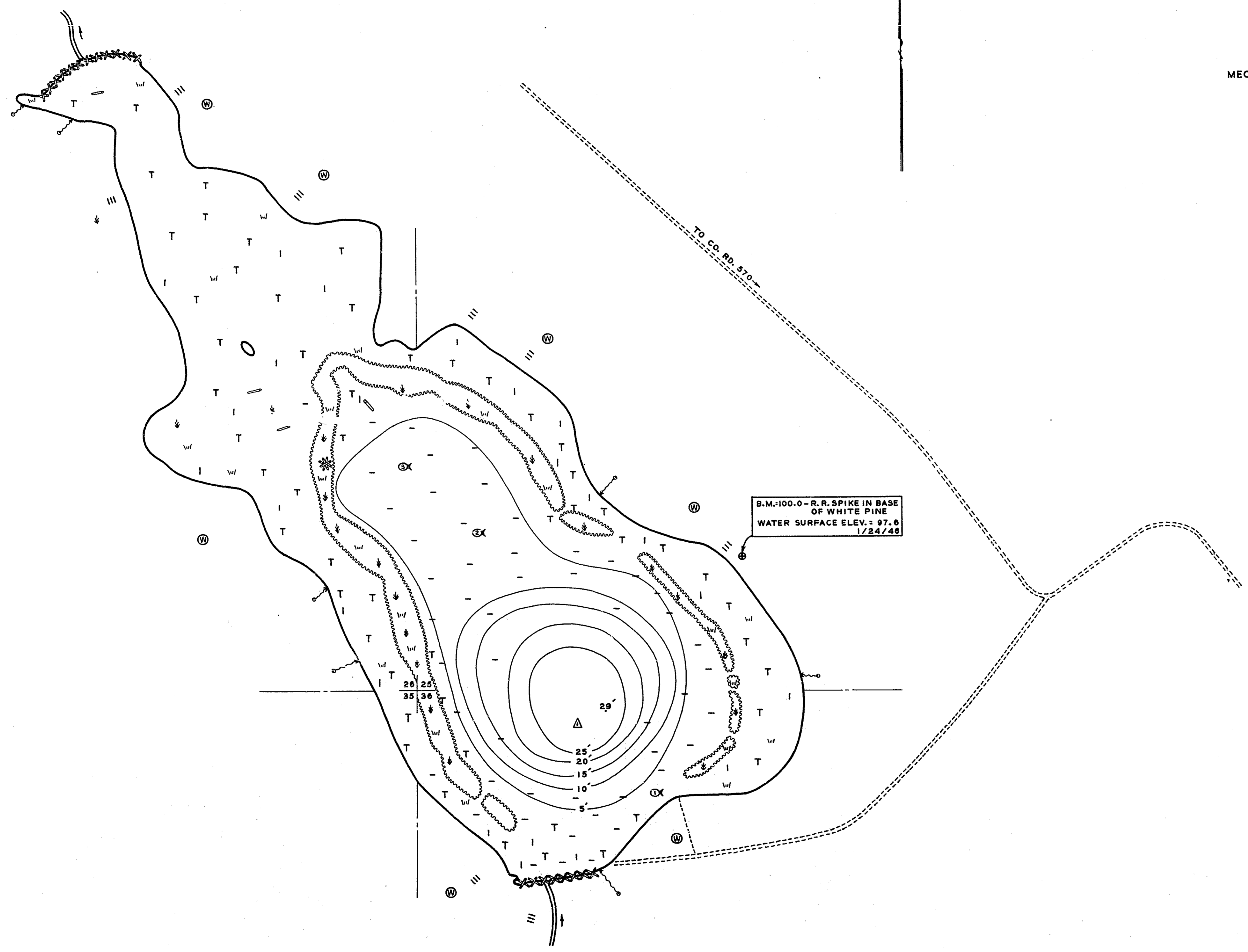

LEGEND

- BOTTOM**
- Pulpy peat
 - Fibrous peat
 - Deadheads
- OUTLINE & CONTOURS**
- Shoreline
 - Contours
- SHORE FEATURES**
- ==== Unimproved road
 - ||| Slope
 - ~ Spring
 - XXX Beaver dam
 - * Beaver house
 - W Marsh
 - ↓ Brush
 - ⊙ Wooded
 - ≡ Inlet
 - ≡ Outlet
 - Trail
 - ~~~~ Encroaching shore
- VEGETATION**
- T Floating
 - I Emergent
 - Submergent
- STATIONS**
- △ Temp., chemical
 - ⊗ Fish sample

