

LONG LAKE

94 ACRES 38.1 HECTARES

OAKLAND COUNTY T.4N., R.10E., SECS.1,2

SURVEY AND SOUNDINGS BY FISHERIES DIVISION
1965

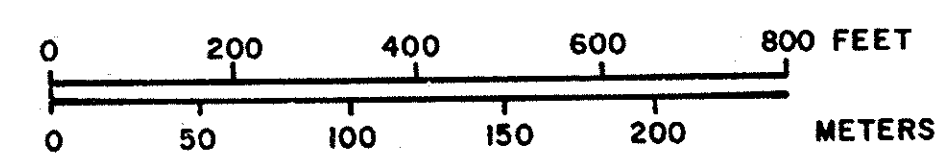
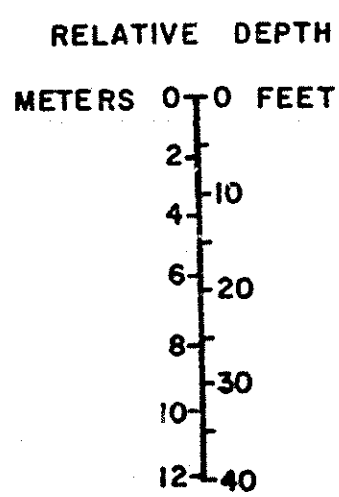
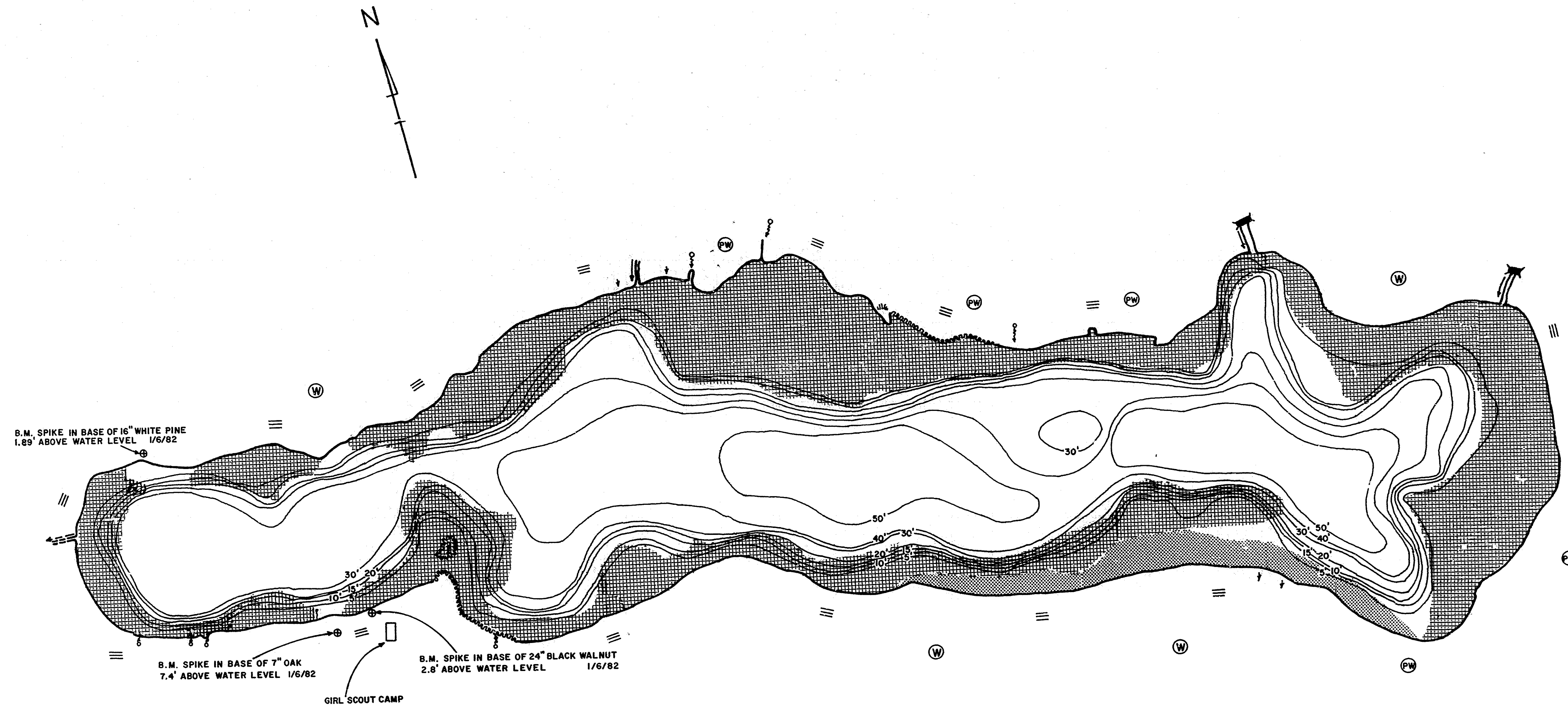

BOTTOM

- Sand
- Organic
- Marl

SHORE FEATURES

- Encroaching shore
- Steep slope
- Wooded
- Partly wooded
- Brush
- Marsh
- Spring
- Inlet or outlet
- Intermittent inlet or outlet
- Dam