

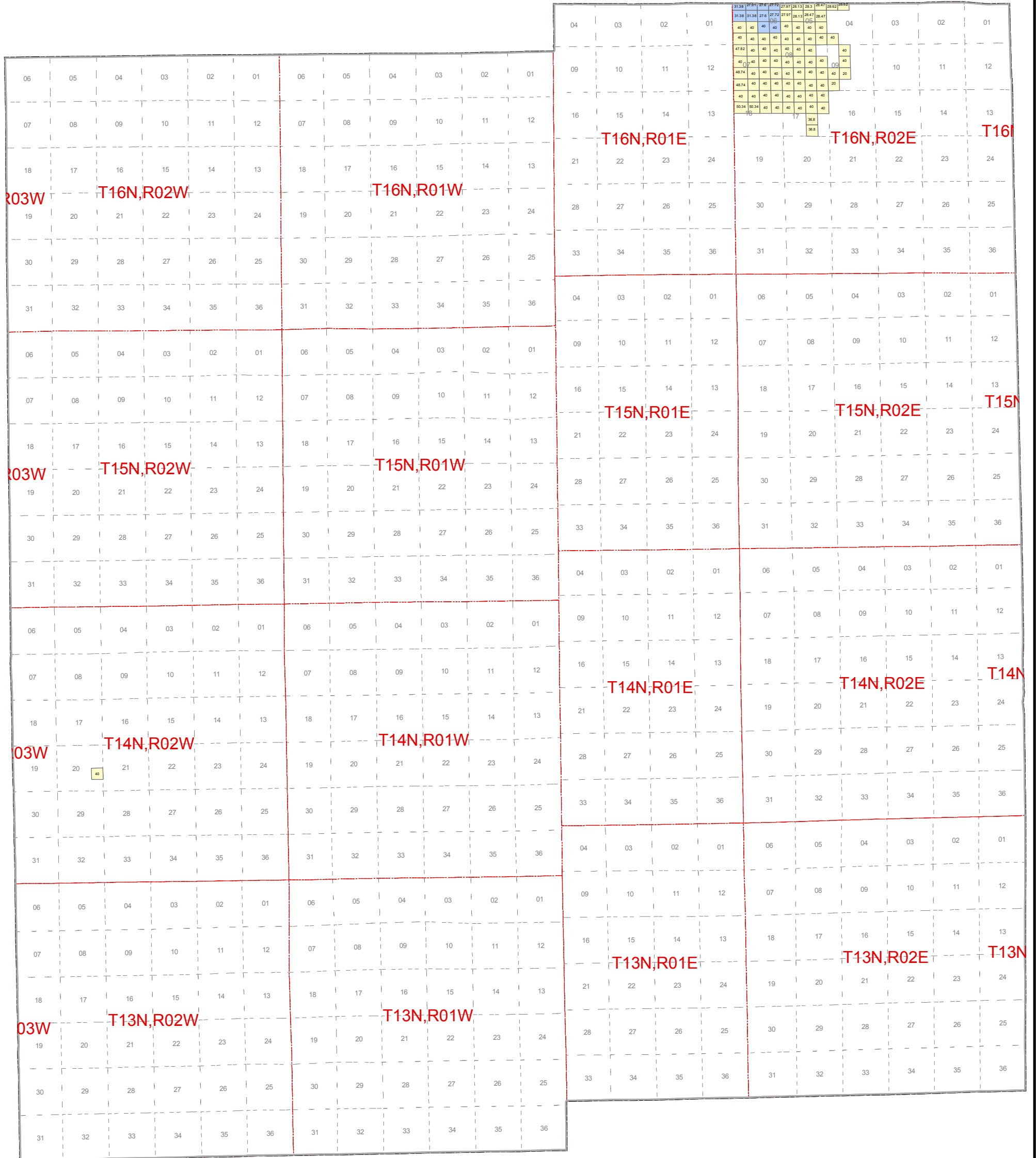

May 2010 Mineral Lease Auction Midland County



Legend

- Antares Exploration Fund Limited Partnership
- Atlas Gas & Oil Company, LLC
- BreitBurn Operating Limited Partnership
- Coughlin Land Services, LLC
- DTE Gas Storage Company
- Dennis R. Schumde, d/b/a Schumde Oil
- Energy West Corporation
- Exterra Resources, LLC
- Great Lakes Resources, LLC
- Jordan Development Company, L.L.C.
- Mason Dixon Energy LLC,
- Meridian Energy Corporation
- O.I.L. Niagaran L.L.C.
- Pine Energy, LLC
- Robert J. Mannes
- Sasquatch Exploration LLC
- Savoy Energy, L.P.
- Trendwell Energy Corporation
- Wolverine Gas and Oil Corporation
- Counties



(35 = Lease Acres)

Note: Some Leased blocks may contain more than one lessee. See Spreadsheet for more detailed information.