



**DEPARTMENT OF NATURAL RESOURCES  
STATE OF MICHIGAN**

**TIMBER SALE PROSPECTUS #6541**

SCHEDULED SALE DATE AND TIME: 3:00 p.m. (local time) on October 29, 2019.

LOCATION: INDIAN RIVER FIELD OFFICE, 6984 WILSON, INDIAN RIVER, MI 49749.

CONTACT NAME: Lucas Merrick  
PHONE NUMBER: (989) 732-3541

PROSPECTUS NOTE: The bidder is advised to inspect the sale area and review the location, estimated volumes, operating costs and contract terms of proposed sales. Please be aware that some landowners may request 60 days or more notice for access across their land.

Notice is hereby given that bids will be received by the Unit Manager, GAYLORD MANAGEMENT UNIT, for certain timber on the following described lands:

Gems Central Aspen (52-114-19) / T35N, R01W, SEC. 10, NWSW,S1/2SW.

T35N, R01W, SEC. 15, NW.

T35N, R01W, SEC. 16, NWNW,S1/2NW,SWNE,NWSW,NWSE.

T35N, R01W, SEC. 9 , NESE,S1/2SE.

Cheboygan County, Advertised Price \$53,006.10, 97.6 Acres, Aspen, Hardwood.

SALE NOTE: Sale consists of a 3 year contract with no contract extensions to be offered. No harvest activity will occur between September 14 and November 30. Recreational hunter walking trails are found on access roads. These roads must be maintained during harvest operations and repaired after completion. Sale area will be accessible from state highway.

A recreation site such as a trail, pathway, or campground is within the sale area or the vicinity. Certain restrictions/specifications may be applicable including time restrictions.

# TIMBER SALE INFORMATION

## Gems Central Aspen (52-114-19)

T35N, R01W, SEC. 10; T35N, R01W, SEC. 15; T35N, R01W, SEC. 16; T35N, R01W, SEC. 9.  
Cheboygan County (Advertised Price \$53,006.10)

**SALE NOTE:** Sale consists of a 3 year contract with no contract extensions to be offered. No harvest activity will occur between September 14 and November 30. Recreational hunter walking trails are found on access roads. These roads must be maintained during harvest operations and repaired after completion. Sale area will be accessible from state highway.

A recreation site such as a trail, pathway, or campground is within the sale area or the vicinity. Certain restrictions/specifications may be applicable including time restrictions.

A timber sale contract for this lump sum, sealed bid timber sale will be awarded to the responsible bidder offering the highest sealed bid price.

Bids must be at or above the following advertised price for each species:

<u>PRODUCTS &amp; SPECIES</u>	<u>ESTIMATED UNITS*</u>	<u>ADVERTISED PRICE</u>
Sawtimber		
B. T. Aspen	97.10 MBF	\$ 55.00 / MBF
Basswood	8.00 MBF	\$ 58.00 / MBF
Sugar Maple	58.40 MBF	\$ 279.00 / MBF
White Pine	1.40 MBF	\$ 46.00 / MBF
Pulpwood		
Balsam Fir	4.00 Cords	\$ 27.50 / Cord
Mixed Aspen	787.00 Cords	\$ 21.20 / Cord
Mixed Hardwood	469.00 Cords	\$ 28.40 / Cord
White Pine	32.00 Cords	\$ 22.80 / Cord

### **BOND AND PAYMENT SCHEDULE:**

1. A bond in the amount of \$2,650.31 to insure faithful performance of the conditions of the contract will be deposited by the successful bidder within 21 days of the sale award.
2. Cutting in any sale or unit without the required advance payment would be considered a trespass.
3. Total payment must be paid in advance or according to the following schedule:
  - (a) Ten percent (10%) of the sale value must be paid within 21 days of the sale award.
  - (b) The 10% down payment will be credited towards the first unit cut.
4. If no cutting takes place, the 10% down payment will not be refunded.
5. Operations on the contract issued will terminate on 12/31/2022.

### **Description of Timber by Payment Unit (PU)**

PU	MARKET GROUP	PRODUCT	QUANTITY	UNIT	ACRES	ADVERTISE PRICE
1	B. T. Aspen	Sawtimber	57.0	MBF	41.2	\$37,060.40
	Basswood		8.0	MBF		
	Sugar Maple		55.0	MBF		
	White Pine		1.4	MBF		
	Balsam Fir	Pulpwood	4.0	Cords		
	Mixed Aspen		264.0	Cords		
	Mixed Hardwood		409.0	Cords		
	White Pine		32.0	Cords		
2	B. T. Aspen	Sawtimber	40.1	MBF	56.4	\$15,945.70
	Sugar Maple		3.4	MBF		
	Mixed Aspen	Pulpwood	523.0	Cords		
	Mixed Hardwood		60.0	Cords		
TOTAL:			164.9	MBF		
TOTAL:			1,292.0	Cords		

## **Sale Specific Conditions & Requirements**

**Sale Name: Gems Central Aspen**

**Sale Number: 52-114-19 Seq#: 1**

### **1 - Sale Area**

#### **1.2 - Boundaries**

##### **1.2.1 - Painted boundaries (1/14)**

The sale boundaries are marked and identified by red paint. Exterior sale boundary lines adjacent to state-owned property are marked with red paint. The red painted boundary line trees are not Included Timber and are to be protected.

### **2 - Timber Specifications**

#### **2.1 - Included Timber**

##### **2.1.1 - Clearcut unit(s) with unmerchantable trees (6/14)**

Within Payment Unit(s) 1 and 2, cut all trees that are two (2) inches or more at DBH except, do not cut oak or hemlock, if present.

#### **2.2 - Utilization**

##### **2.2.8 - Utilization and removal (5/14)**

All products meeting standards set forth in General Condition and Requirement 2.2 - Utilization must be removed from the sale area. Retain on site 1/6 to 1/3 of the slash from harvested trees (tree tops and limbs less than four inches in diameter). This is because of biomass retention guidelines.

### **3 - Payments**

#### **3.3 - Pre-measured Sales**

##### **3.3.4 - Dividing payment units (7/14)**

Payment Unit(s) 1 and 2 may be divided at the request of the Purchaser and upon approval of the Unit Manager. Dividing Payment Units is a contract modification which requires a Timber Sale Contract Supplement. There will be only one division per Payment Unit.

### **4 - Transportation**

#### **4.1 - Construction**

##### **4.1.3 - Slash and earthen piles (8/04)**

Piles or windrows of earth along roads and landings that have been widened or constructed shall be leveled. Slash from road maintenance or construction, including stumps, shall be dispersed throughout the sale or chipped and utilized, or otherwise removed from the sale area.

##### **4.1.6 - Road construction (1/09)**

Construction of new roads or improvements of existing roads shall be done in such a way as to minimize the environmental and visual impacts. Merchantable trees shall be cut and utilized unless otherwise directed. Non-merchantable trees shall be severed and laid flat on the ground. Slash shall be scattered, and not left in windrows and kept a minimum of 10 feet back from the road edge. Stumps shall be set upright, not left on edge, and be moved at least 10 feet away from the road edge. Disturbed soil shall be feathered into the woods and not left in berms or windrows.

##### **4.1.7 - Road closure (10/11)**

All new roads built into the sale must be blocked to vehicle traffic upon completion of the sale. In general, this will require constructing a four (4') foot high berm of stumps and logs covered with earth. Contact the sale administrator for specific details of design and placement.

#### **4.4 - Access**

##### **4.4.3 - Access gate (12/08)**

The access gate must be locked at the completion of each day unless otherwise approved by the Unit Manager or his/her representative. The location of this gate falls off the Timber Sale Map and will be discussed at the Pre-Sale Meeting.

## **5 - Operations**

### **5.1 - Notification**

#### **5.1.1 - Pre-sale conference (10/16)**

A pre-sale conference between the Purchaser and sale administrator is required prior to beginning any operations to determine landing and road locations.

### **5.2 - Conduct of Operations**

#### **5.2.1 - Slash**

##### **5.2.1.1 - Slash within sale area (9/16)**

No trees are to be felled outside the sale area and all slash is to be kept at least 10 feet back from the red or blue paint line. Slash should uniformly be scattered throughout the sale area. If sale boundary lines are along a public road or highway, then slash must be removed 50' from these lines per General Condition & Requirement 5.2.1.

#### **5.2.2 - Hazard Trees/Snags**

##### **5.2.2.1 - Den trees (10/16)**

Obvious hollow and/or den trees shall be protected and left standing unless they are a safety hazard.

#### **5.2.3 - Operating Restrictions**

##### **5.2.3.1 - Operating restrictions (9/11)**

Within Payment Unit(s) 1 and 2, unless changed by written agreement, all harvest operations are not permitted during the period of September 14 to November 30. This restriction is because of the amount of hunters that will be present in this area during that time and the heavy use of the Hunter Trails/Poor Dirt Roads.

#### **5.2.4 - Dead and Down Creation**

##### **5.2.4.1 - Dead and down creation, marked trees (10/13)**

All trees marked with a band of green paint must be felled and left on site for wildlife.

#### **5.2.29 - Shrub protection (9/07)**

Do not cut or damage hawthorn, witch-hazel, dogwood or junberry, or any wild or planted mast producing shrub. These woody-shrub plants are highly beneficial to various wildlife species. Also, do not cut or damage any apple trees.

#### **5.2.32 - Decking/landing restoration (9/13)**

All decking and landing areas must have the surface area restored to a condition equal to or better than before. This is to ensure the proper regeneration of the stand. Wood debris, chips and "cookies" from trimmings must be removed or scattered away from landing and loading areas and may not be windrowed on the edge.

### **5.4 - Soil Protection**

#### **5.4.1 - Rutting restriction, general (7/16)**

Operations are to cease immediately if equipment and weather conditions result in rutting of roads which is 12 inches or greater in depth and 50 feet in length. The Unit Manager or his/her representative may restrict hauling and/or skidding if ruts exceed the specified depth. With the Unit Manager or his/her representative's approval, the Purchaser may return to the area when the risk of rutting has decreased.

### **5.8 - Protection of Endangered Species**

#### **5.8.5 - Protection of raptor nests (3/13)**

All trees with raptor nests will be protected if found during harvesting operations. Notification will be made to the Unit Manager or his/her representative who will notify the Wildlife Biologist so an on-site evaluation and recommendation can be made, if necessary.

## **7 - Other Conditions**

## 7.2 - Extensions

### 7.2.2 - No extensions (3/09)

There will be no extensions granted on this contract. Harvesting should begin as soon as possible after winning bid is awarded. The purpose of this sale is to create habitat for ruffed grouse and woodcock and balance the age of the aspen stands within the managed Lee Grande GEMS site.

# TIMBER SALE MAP

*This information provided by authority of Part 525, 1994 PA 451, as amended.*

Sale Number

Year

52-114-19-01 2019

Date	Page	of
8/07/2019	1	1

Forest Management Unit		County	Mapped By	Date	Page	of
GAYLORD-NORTH		CHEBOYGAN	STACKS	8/07/2019	1	1
Township	Range	Section(s) and Subdivision(s)				
T35N	ROIW	9 NESE, S½SE, 10 NWSW, S½SW, 15 NW¼, 16 NWNW, S½NW, SWNE, NWSW, NWSE				
Cover Type				Density		
A = Aspen	J = Jack Pine	O = Oak	U = Upland Brush	0 = Non Stocked	5 = Pole Timber Medium	
B = Paper Birch	K = Rock	P = Lowland Poplar	UM = Upland Mix Forest	1 = Seedling Sapling Poor	6 = Pole Timber Well	
C = Cedar	L = Lowland Brush	Q = Mixed Swamp Conifer	V = Bog or Marsh	2 = Seedling Sapling Medium	7 = Saw Timber Poor	
D = Treed Bog	LM = Lowland Mix Forest	R = Red Pine	W = White Pine	3 = Seedling Sapling Well	8 = Saw Timber Medium	
E = Swamp Hardwoods	M = Maple, Beech, Birch	S = Black Spruce	X = Non Stocked	4 = Pole Timber Poor	9 = Saw Timber Well	
F = Spruce/Fir	MC = Mixed Conifer	T = Tamarack	Y = Sand			
G = Grass	MD = Mixed Deciduous		Z = Water			
H = Hemlock	N = Marsh					

COMPARTMENT 190

<u>UNIT</u>	<u>ACRES</u>
1	41.2

$$\begin{array}{r} 2 \quad \cdot \quad 56.4 \\ \hline 97.6 \end{array}$$

GEMS CENTRAL ASPEN

CHEBOYGAN COUNTY

97.6 ACRES

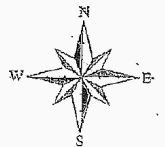

1:15,840

SALE AREA:

**SALE BOUNDARY.-**

(RED PAINT) - ~~REDACTED~~

PAYMENT UNIT- ①

RETENTION AREA-   
(RED PAINT)

POOR DIRT ROAD - ----  
(HUNTER TRAIL) .....

⑩ - 84.430057°  
45.425693°

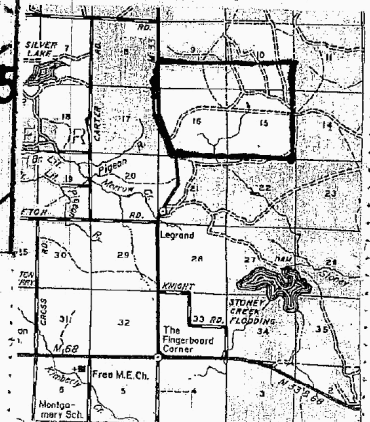
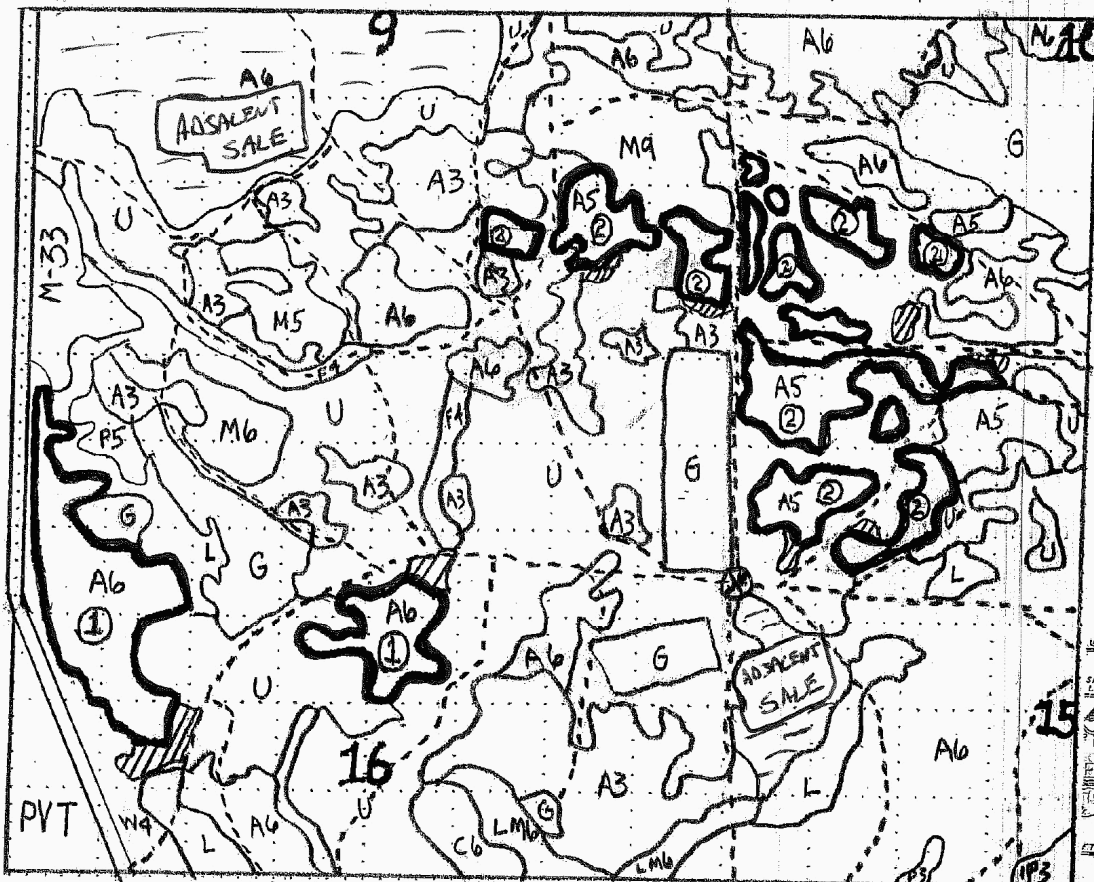

0.5 0.25 0 Miles