



**DEPARTMENT OF NATURAL RESOURCES
STATE OF MICHIGAN**

TIMBER SALE PROSPECTUS #6701

SCHEDULED SALE DATE AND TIME: 4:00 p.m. (local time) on May 28, 2020.

LOCATION: KALKASKA FIELD OFFICE, 2089 NORTH BIRCH STREET, KALKASKA, MI 49646.

CONTACT NAME: David Lemmien

PHONE NUMBER: (231) 922-6040

PROSPECTUS NOTE: It is recommended that for the duration of the "Stay Home, Stay Safe" executive order that bidders submit their bids through the Online Bidding System (<https://www2.dnr.state.mi.us/VMSONlineBidding/>). If you need to register, contact Jake Reid (ReidJ6@michigan.gov, 517-284-5908) or Donovan Asselin (AsselinD@michigan.gov, 517-930-1326). Paper bids will still be accepted during this time, either dropped in the bid box at the bid location or by mailing. If mailing, please allow for additional time.

The bidder is advised to inspect the sale area and review the location, estimated volumes, operating costs and contract terms of proposed sales. Please be aware that some landowners may request 60 days or more notice for access across their land.

Notice is hereby given that bids will be received by the Unit Manager, TRAVERSE CITY MANAGEMENT UNIT, for certain timber on the following described lands:

Tech Tech Mix (61-152-19) / T28N, R08W, SEC. 17, NENW, NE, NWSE.

T28N, R08W, SEC. 32, SENW.

Kalkaska County, Advertised Price \$58,015.70, 101.5 Acres, Aspen, White Pine.

SALE NOTE: The majority of this sale may not be cut during the period of April 15 to October 1. This is necessary to reduce the spread of oak wilt and to protect the habitat for a threatened species, so there will be no exceptions.

TIMBER SALE INFORMATION

Tech Tech Mix (61-152-19)

T28N, R08W, SEC. 17; T28N, R08W, SEC. 32.

Kalkaska County (Advertised Price \$58,015.70)

SALE NOTE: The majority of this sale may not be cut during the period of April 15 to October 1. This is necessary to reduce the spread of oak wilt and to protect the habitat for a threatened species, so there will be no exceptions.

A timber sale contract for this lump sum, sealed bid timber sale will be awarded to the responsible bidder offering the highest sealed bid price .

Bids must be at or above the following advertised price for each species:

<u>PRODUCTS & SPECIES</u>	<u>ESTIMATED UNITS*</u>	<u>ADVERTISED PRICE</u>
Sawtimber		
Mixed Aspen	115.90 MBF	\$ 81.00 / MBF
Red Maple	73.30 MBF	\$ 80.00 / MBF
Red Oak	21.30 MBF	\$ 113.00 / MBF
Red Pine	137.10 MBF	\$ 78.00 / MBF
Sugar Maple	20.00 MBF	\$ 197.00 / MBF
White Pine	208.60 MBF	\$ 30.00 / MBF
Pulpwood		
Jack Pine	9.00 Cords	\$ 7.65 / Cord
Mixed Aspen	674.00 Cords	\$ 10.00 / Cord
Mixed Hardwood	610.00 Cords	\$ 9.50 / Cord
Red Oak	47.00 Cords	\$ 6.60 / Cord
Red Pine	88.00 Cords	\$ 24.85 / Cord
White Pine	529.00 Cords	\$ 8.25 / Cord

BOND AND PAYMENT SCHEDULE:

1. A bond in the amount of \$5,801.57 to insure faithful performance of the conditions of the contract will be deposited by the successful bidder within 21 days of the sale award.
2. Cutting in any sale or unit without the required advance payment would be considered a trespass.
3. Total payment must be paid in advance or according to the following schedule :
 - (a) Ten percent (10%) of the sale value must be paid within 21 days of the sale award.
 - (b) The 10% down payment will be credited towards the first unit cut.
4. If no cutting takes place, the 10% down payment will not be refunded.
5. Operations on the contract issued will terminate on 06/30/2023.

Description of Timber by Payment Unit (PU)

PU	MARKET GROUP	PRODUCT	QUANTITY	UNIT	ACRES	ADVERTISE PRICE
1	Mixed Aspen	Sawtimber	17.1	MBF	49.9	\$28,257.25
	<i>B. T. Aspen</i>		17.1	<i>MBF</i>		
	Red Maple		37.7	MBF		
	Red Oak		10.7	MBF		
	Red Pine		114.9	MBF		
	White Pine		117.3	MBF		
	Jack Pine		9.0	Cords		
	Mixed Aspen		327.0	Cords		
	Mixed Hardwood		276.0	Cords		
	Red Oak		26.0	Cords		
	Red Pine		74.0	Cords		
	White Pine		266.0	Cords		
2	Mixed Aspen	Sawtimber	26.4	MBF	39.8	\$19,296.30
	<i>B. T. Aspen</i>		25.3	<i>MBF</i>		
	<i>Quaking Aspen</i>		1.1	<i>MBF</i>		
	Red Maple		35.6	MBF		
	Red Oak		10.6	MBF		
	Red Pine		22.2	MBF		
	Sugar Maple		3.5	MBF		
	White Pine		87.7	MBF		
	Mixed Aspen		306.0	Cords		
	Mixed Hardwood		258.0	Cords		
	Red Oak		21.0	Cords		
	Red Pine		14.0	Cords		
	White Pine		250.0	Cords		
	3		Mixed Aspen	Sawtimber		
<i>B. T. Aspen</i>		72.4	<i>MBF</i>			
Sugar Maple		16.5	MBF			
White Pine		3.6	MBF			
Mixed Aspen		41.0	Cords			
Mixed Hardwood		76.0	Cords			
White Pine		13.0	Cords			
TOTAL:			576.2	MBF		
TOTAL:			1,957.0	Cords		

Sale Specific Conditions & Requirements

Sale Name: Tech Tech Mix

Sale Number: 61-152-19 Seq#: 1

1 - Sale Area

1.2 - Boundaries

1.2.1 - Painted boundaries (9/19)

The sale boundary and Payment Unit boundaries are marked and identified by blue, red, and yellow paint. Exterior sale boundary lines against private property are marked with blue paint. Exterior sale boundary lines against state are marked with red paint. Interior Payment Unit boundaries are marked with yellow paint. The painted boundary and Payment Unit line trees are not Included Timber and are to be protected unless marked with orange paint.

2 - Timber Specifications

2.1 - Included Timber

2.1.3 - Cut tree marked unit(s) (12/08)

Within Payment Unit(s) 3, all trees are designated for cutting when marked with orange paint above and below stump height, regardless of merchantability. In addition, cut all ash, aspen, beech, and ironwood, unless marked with an orange X.

2.1.7 - Leave tree marked unit(s) (6/14)

Within Payment Unit(s) 1 and 2, cut all trees that are two (2) inches or more at DBH, except do not cut any trees marked with green paint above and below stump height. In addition, do not cut white pine less than 6 inches at DBH.

2.2 - Utilization

2.2.4 - Skidding length (2/14)

Within Payment Unit 3, skidding of unlimbed tops or lengths over 17 feet is not permissible unless approved by the Unit Manager or his/her representative.

2.2.9 - No chipping permitted (12/08)

Within Payment Unit(s) 1, 2, and 3, tops may not be chipped. Limbs and tops must remain scattered throughout the sale area.

3 - Payments

3.3 - Pre-measured Sales

3.3.4 - Dividing payment units (7/14)

Payment Unit(s) greater than \$20,000 may be divided at the request of the Purchaser and upon approval of the Unit Manager. Dividing Payment Units is a contract modification which requires a Timber Sale Contract Supplement. There will be only one division per Payment Unit.

3.4 - Damaged Timber

3.4.1 - Damaged timber (7/16)

General Condition and Requirement 3.4 Damaged Timber, defines liquidated damages for undesignated live merchantable trees which are cut or injured. In addition, extreme care should be taken to avoid damage to tree seedlings and saplings.

Within the sale area, if more than 25% of the tree seedlings or saplings (1/4" to 4.5" DBH) within a specified portion of the sale area are damaged, liquidated damages will be assessed at \$300 per acre for all acreage within that specified portion of the sale area that was damaged.

3.6 - Payment Unit Cutting Schedule

3.6.3 - Operating schedule (12/08)

Unless changed by written agreement, only one Payment Unit(s) may be operated at any one time. All contractual requirements on a Payment Unit shall be completed and accepted by the Unit Manager or his/her representative prior to the opening of an additional Payment Unit. Payment Units 1 and 2 shall be considered a single operational unit.

4 - Transportation

4.1 - Construction

4.1.6 - Road construction (1/09)

Construction of new roads or improvements of existing roads shall be done in such a way as to minimize the environmental and visual impacts. Merchantable trees shall be cut and utilized unless otherwise directed. Non-merchantable trees shall be severed and laid flat on the ground. Slash shall be scattered, and not left in windrows and kept a minimum of 10 feet back from the road edge. Stumps shall be set upright, not left on edge, and be moved at least 10 feet away from the road edge. Disturbed soil shall be feathered into the woods and not left in berms or windrows.

4.1.7 - Road closure (10/11)

All new roads built into the sale must be blocked to vehicle traffic within 30 days of completion of hauling. Overgrown roads that are reopened shall be considered new roads. In general, this will require constructing a four (4') foot high berm of stumps and logs covered with earth. These roads must be rendered impassable to cars, trucks, and ORVs. Temporary berms may be required if no sale activity occurs for 30 or more consecutive days. Contact the sale administrator for specific details of design and placement.

5 - Operations

5.1 - Notification

5.1.1 - Pre-sale conference (10/16)

A pre-sale conference on site between the Purchaser and sale administrator is required prior to beginning any operations. The Sale Administrator must be contacted at least 5 days in advance to schedule the conference.

5.2 - Conduct of Operations

5.2.1 - Slash

5.2.1.8 - Slash height (12/08)

No slash or tree tops may exceed 36 inches in height.

5.2.2 - Hazard Trees/Snags

5.2.2.1 - Den trees (10/16)

Obvious hollow and/or den trees shall be protected and left standing unless they are a safety hazard.

5.2.3 - Operating Restrictions

5.2.3.3 - Bark slippage restriction (3/09)

Within Payment Unit(s) 3, unless changed by written agreement, cutting and skidding are not permitted during the period of April 15 to July 15. This restriction is because of bark slippage.

5.2.3.4 - Oak wilt restriction, no exceptions (1/18)

Within Payment Unit(s) 1 and 2, cutting, skidding, hauling within the sale and brushing of access roads to the sale are not permitted during the period of April 15 to July 15. No exceptions will be granted. Note that hauling from certain landing locations may be permitted if approved by the sale administrator and roads are brushed out before April 15. This is necessary to reduce the spread of oak wilt. See spec 5.8.8 for additional restrictions regarding the Eastern Massasauga rattlesnake.

5.2.31 - Landing locations (9/13)

The recommended landing area for Payment Unit 3 is marked on the Timber Sale Map with the letter "L". Alternate access may be possible through the private land to the north, but this option has not been explored.

5.2.32 - Decking/landing restoration (9/13)

All decking and landing areas must have the surface area restored to a condition equal to or better than before. This is to ensure the proper regeneration of the stand. Wood debris, chips and "cookies" from trimmings must be removed or scattered away from landing and loading areas and may not be windrowed on the edge.

5.2.38 - No decking against live trees (2/04)

Cut products may not be decked against unmarked or designated leave trees.

5.4 - Soil Protection

5.4.1 - Rutting restriction, general (7/16)

Operations are to cease immediately if equipment and weather conditions result in rutting of roads and/or skid trails which is 12 inches or greater in depth and 50 feet in length. The Unit Manager or his/her representative may restrict hauling and/or skidding if ruts exceed the specified depth. With the Unit Manager or his/her representative's approval, the Purchaser may return to the area when the risk of rutting has decreased.

5.8 - Protection of Endangered Species

5.8.5 - Protection of raptor nests (3/13)

All trees with raptor nests will be protected if found during harvesting operations. Notification will be made to the Unit Manager or his/her representative who will notify the Wildlife Biologist so an on-site evaluation and recommendation can be made, if necessary.

5.8.8 - Protected species, other (2/12)

Within Payment Unit(s) 1 and 2, harvesting is not permitted during the period of May 1 to October 1. In addition, wood cut during the operational period must be hauled before May 1, or within 6 months of piling, whichever comes first. This restriction is to protect the habitat of the threatened Eastern Massasauga rattlesnake.

6 - Safety and Fire Prevention

6.2 - Signing

6.2.1 - Road posting (9/09)

The Purchaser is responsible for posting and maintaining caution signs on haul roads prior to beginning operations. The road must be posted at appropriate distances from the sale area to warn of logging activity and truck traffic. Signs must be removed when harvest operations are suspended or completed. The Purchaser will provide these signs.

7 - Other Conditions

7.5 - Loss

7.5.1 - Deteriorating timber (7/09)

The sale area has received damage from windthrow in scattered locations. The Purchaser should harvest the wood as soon as possible. The Department of Natural Resources is held free of responsibility of any further damage or deterioration due to delay in harvesting.

**TIMBER SALE MAP***This information provided by authority of Part 525, 1994 PA 451, as amended.*

Sale Number	Year
61-152	2019

Forest Management Unit Traverse City	County Kalkaska	Mapped By Armstrong	Date 9/6/2019	Page 1	of 2
Township 28N	Range 7W	Section(s) and Subdivision(s) Sec. 17: NENW, NE, NWSE Sec. 32: SENW	Scale 1:15,840		

Cover Type				Density	
A = Aspen	H = Hemlock	N = Marsh	U = Upland Brush	0 = Non Stocked	5 = Pole Timber Medium
B = Paper Birch	J = Jack Pine	O = Oak	UM = Upland Mixed	1 = Seedling Sapling Poor	6 = Pole Timber Well
C = Cedar	L = Lowland Brush	P = Lowland Poplar	V = Bog or Marsh	2 = Seedling Sapling Medium	7 = Saw Timber Poor
D = Treed Bog	LM = Lowland Mixed	Q = Mixed Swamp Conifer	W = White Pine	3 = Seedling Sapling Well	8 = Saw Timber Medium
E = Swamp Hdwoods	M = Mpl, Bch, Brch	R = Red Pine	X = Non Stocked	4 = Pole Timber Poor	9 = Saw Timber Well
F = Spruce Fir	MC = Mixed Conifer	S = Black Spruce	Z = Water		
G = Grass	MD = Mixed Decidious	T = Tamarack			

Unit Acres

1	49.9
2	39.8
3	11.8

**Tech Tech Mix
Compartment 171
101.5 acres****Legend****Sale Boundary**

- Against State (Red)
- Payment Unit (Yellow)
- Private Line (Blue)
- Stand Boundaries

Roads

- Paved Road
- - - Gravel Road
- ... Temp Mgmt Access
- Recreational Trail
- Section Corners
- State Forests

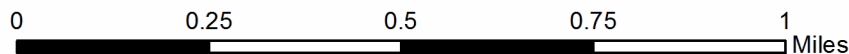
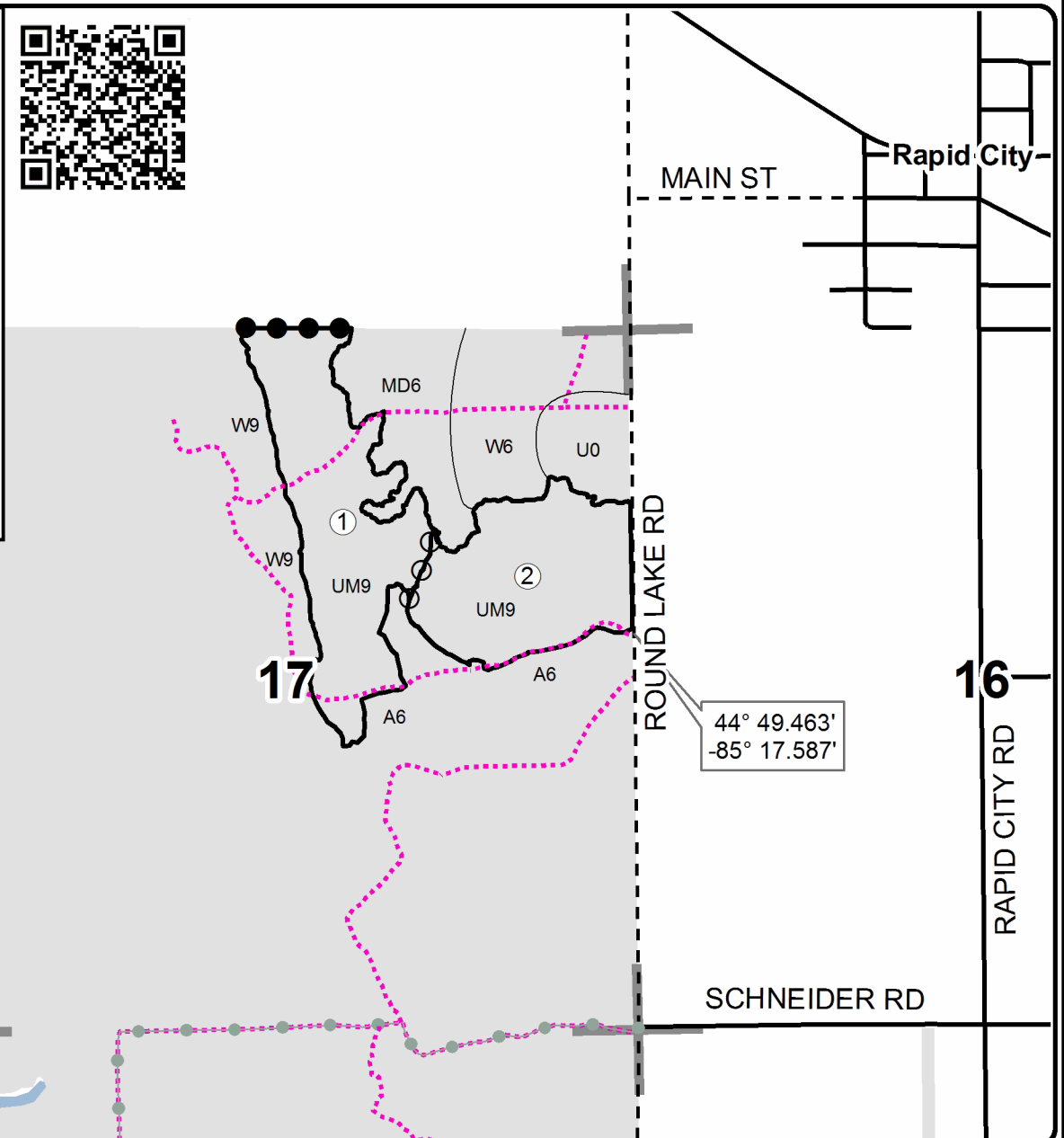

**TIMBER SALE MAP***This information provided by authority of Part 525, 1994 PA 451, as amended.*

Sale Number	Year
61-152	2019

Forest Management Unit Traverse City	County Kalkaska	Mapped By Armstrong	Date 9/6/2019	Page 2	of 2
Township 28N	Range 7W	Section(s) and Subdivision(s) Sec. 17: NENW, NE, NWSE Sec. 32: SENW	Scale 1:7,920		

Cover Type				Density	
A = Aspen	H = Hemlock	N = Marsh	U = Upland Brush	0 = Non Stocked	5 = Pole Timber Medium
B = Paper Birch	J = Jack Pine	O = Oak	UM = Upland Mixed	1 = Seedling Sapling Poor	6 = Pole Timber Well
C = Cedar	L = Lowland Brush	P = Lowland Poplar	V = Bog or Marsh	2 = Seedling Sapling Medium	7 = Saw Timber Poor
D = Treed Bog	LM = Lowland Mixed	Q = Mixed Swamp Conifer	W = White Pine	3 = Seedling Sapling Well	8 = Saw Timber Medium
E = Swamp Hdwoods	M = Mpl, Bch, Brch	R = Red Pine	X = Non Stocked	4 = Pole Timber Poor	9 = Saw Timber Well
F = Spruce Fir	MC = Mixed Conifer	S = Black Spruce	Z = Water		
G = Grass	MD = Mixed Deciduous	T = Tamarack			

Unit Acres

1	49.9
2	39.8
3	11.8

**Tech Tech Mix
Compartment 171
101.5 acres****Legend****Sale Boundary**

- Against State (Red)
- Payment Unit (Yellow)
- Private Line (Blue)

- Stand Boundaries
- ▨ Retention Area

Roads

- - - Gravel Road
- - - County Road - Seasonal
- Private
- Highway
- Temp Mgmt Access
- Recreational Trail
- Section Corners
- State Forests

