



**DEPARTMENT OF NATURAL RESOURCES
STATE OF MICHIGAN**

TIMBER SALE PROSPECTUS #6714

SCHEDULED SALE DATE AND TIME: **9:00 a.m. (local time) on October 19, 2020.**

LOCATION: **KALKASKA FIELD OFFICE, 2089 NORTH BIRCH STREET, KALKASKA, MI 49646.**

CONTACT NAME: David Lemmien

PHONE NUMBER: (231) 922-6040

PROSPECTUS NOTE: It is recommended that for the duration of the "Stay Home, Stay Safe" executive order that bidders submit their bids through the Online Bidding System (<https://www.dnr.state.mi.us/VMSONlineBidding/>). If you need to register, contact Jake Reid (ReidJ6@michigan.gov, 517-284-5908) or Donovan Asselin (AsselinD@michigan.gov, 517-930-1326). Paper bids will still be accepted during this time, either dropped in the bid box at the bid location or by mailing. If mailing, please allow for additional time.

The bidder is advised to inspect the sale area and review the location, estimated volumes, operating costs and contract terms of proposed sales. Please be aware that some landowners may request 60 days or more notice for access across their land.

Notice is hereby given that bids will be received by the Unit Manager, TRAVERSE CITY MANAGEMENT UNIT, for certain timber on the following described lands:

One Leg Aspen (61-107-20) / T25N, R05W, SEC. 20, E1/2NW, W1/2NE.

Kalkaska County, Advertised Price \$36,746.15, 73.0 Acres, Aspen, Hardwood.

SALE NOTE: A recreation site such as a trail, pathway, or campground is within the sale area or the vicinity. Certain restrictions/specifications may be applicable including time restrictions.

TIMBER SALE INFORMATION

One Leg Aspen (61-107-20)

T25N, R05W, SEC. 20.

Kalkaska County (Advertised Price \$36,746.15)

SALE NOTE: A recreation site such as a trail, pathway, or campground is within the sale area or the vicinity. Certain restrictions/specifications may be applicable including time restrictions.

A timber sale contract for this lump sum, sealed bid timber sale will be awarded to the responsible bidder offering the highest sealed bid price. All units of volume listed below were estimated using the T-Sale computer program and our traditional volume equations. Bids must be at or above the following advertised price for each product and species:

<u>PRODUCTS & SPECIES</u>	<u>ESTIMATED UNITS*</u>	<u>ADVERTISED PRICE</u>
Sawtimber		
Beech	4.6 MBF	\$ 54.00 / MBF
Black Cherry	2.3 MBF	\$ 239.00 / MBF
Mixed Aspen	147.5 MBF	\$ 88.00 / MBF
Mixed Oak	11.4 MBF	\$ 90.00 / MBF
Paper Birch	2.7 MBF	\$ 24.00 / MBF
Red Maple	18.2 MBF	\$ 88.00 / MBF
Red Pine	26.8 MBF	\$ 79.00 / MBF
Sugar Maple	17.9 MBF	\$ 148.00 / MBF
Pulpwood		
Balsam Fir	5 Cords	\$ 7.90 / Cord
Mixed Aspen	965 Cords	\$ 11.30 / Cord
Mixed Hardwood	344 Cords	\$ 10.65 / Cord
Mixed Oak	53 Cords	\$ 7.10 / Cord
Red Pine	19 Cords	\$ 27.65 / Cord

* The total volume is statistically estimated within plus (+) or minus (-) 13.95 percent. There are an estimated 1,850 cords on this timber sale, plus or minus 258 cords at the 95% confidence level. The estimated units are final and not subject to adjustment. Prospective bidders are urged to examine this timber and to make their own estimates of quantity and quality.

BOND AND PAYMENT SCHEDULE:

1. A bond in the amount of \$1,837.31 to insure faithful performance of the conditions of the contract will be deposited by the successful bidder within 21 days of the sale award.
2. Cutting in any sale or unit without the required advance payment would be considered a trespass.
3. Total payment must be paid in advance or according to the following schedule :
 - (a) Ten percent (10%) of the sale value must be paid within 21 days of the sale award.
 - (b) The 10% down payment will be credited towards the first unit cut.
4. If no cutting takes place, the 10% down payment will not be refunded.
5. Operations on the contract issued will terminate on 12/31/2022.

SALE STATISTICS

SALE VOLUMES

VOLUME			STATISTICAL RANGE IN CORDS	
TOTAL CUBIC FEET	TOTAL CORDS	PERCENT ERROR	MINIMUM	MAXIMUM
146,145	1,850	13.95%	1,592	2,108

VDU VOLUMES

A VDU is a Volume Determination Unit. Volumes and their associated statistics are calculated at the VDU level and summarized to the sale level. There is often a one to one relationship between a VDU and a Payment Unit, but not always, depending on the cruise design. Refer to the VDU TO PAYMENT UNIT table.

	VOLUME			RANGE IN CORDS	
VDU	TOTAL CUBIC FEET	TOTAL CORDS	PERCENT ERROR	MINIMUM	MAXIMUM
21	146,142	1,850	13.95%	1,592	2,108
TOTAL:	146,142	1,850		1,592	2,108

VDU TO PAYMENT UNIT

When a VDU is associated with more than one Payment Unit (PU), the VDU volumes are assigned to the PU based on acres of the VDU within the PU.

VDU	VDU ACRES	PU	PU ACRES
21	73.0	1	50.1
		2	22.9
TOTAL:	73.0		73.0

DESCRIPTION OF TIMBER BY PU (PU)

PU	MARKET GROUP	PRODUCT	QUANTITY	UNIT	ACRES	ADVERTISE PRICE
1	Beech	Sawtimber	3.2	MBF	50.1	\$25,223.95
	Black Cherry		1.6	MBF		
	Mixed Aspen		101.3	MBF		
	<i>B. T. Aspen</i>		30.1	<i>MBF</i>		
	<i>Quaking Aspen</i>		71.2	<i>MBF</i>		
	Mixed Oak		7.8	MBF		
	<i>Bl/R/Hybrid Oak</i>		2.3	<i>MBF</i>		
	<i>Red Oak</i>		5.5	<i>MBF</i>		
	Paper Birch		1.9	MBF		
	Red Maple		12.5	MBF		
	Red Pine		18.4	MBF		
	Sugar Maple		12.3	MBF		
	Balsam Fir	Pulpwood	3	Cords		
	Mixed Aspen		662	Cords		
	<i>B. T. Aspen</i>		47	<i>Cords</i>		
	<i>Quaking Aspen</i>		615	<i>Cords</i>		
	Mixed Hardwood		236	Cords		
	<i>Basswood</i>		40	<i>Cords</i>		
	<i>Beech</i>		9	<i>Cords</i>		
	<i>Black Cherry</i>		34	<i>Cords</i>		
	<i>Ironwood</i>		8	<i>Cords</i>		
	<i>Paper Birch</i>		16	<i>Cords</i>		
	<i>Red Maple</i>		53	<i>Cords</i>		
	<i>Sugar Maple</i>		73	<i>Cords</i>		
	<i>White Ash</i>		3	<i>Cords</i>		
	Mixed Oak		36	Cords		
	<i>Bl/R/Hybrid Oak</i>		8	<i>Cords</i>		
	<i>Red Oak</i>		28	<i>Cords</i>		
	Red Pine		13	Cords		
2	Beech	Sawtimber	1.4	MBF	22.9	\$11,522.20
	Black Cherry		0.7	MBF		
	Mixed Aspen		46.2	MBF		
	<i>B. T. Aspen</i>		13.7	<i>MBF</i>		
	<i>Quaking Aspen</i>		32.5	<i>MBF</i>		
	Mixed Oak		3.6	MBF		
	<i>Bl/R/Hybrid Oak</i>		1.1	<i>MBF</i>		
	<i>Red Oak</i>		2.5	<i>MBF</i>		
	Paper Birch		0.8	MBF		
	Red Maple		5.7	MBF		
	Red Pine		8.4	MBF		
	Sugar Maple		5.6	MBF		
	Balsam Fir	Pulpwood	2	Cords		
	Mixed Aspen		303	Cords		
	<i>B. T. Aspen</i>		22	<i>Cords</i>		
	<i>Quaking Aspen</i>		281	<i>Cords</i>		
	Mixed Hardwood		108	Cords		
	<i>Basswood</i>		18	<i>Cords</i>		
	<i>Beech</i>		4	<i>Cords</i>		
	<i>Black Cherry</i>		16	<i>Cords</i>		
	<i>Ironwood</i>		3	<i>Cords</i>		
	<i>Paper Birch</i>		8	<i>Cords</i>		
	<i>Red Maple</i>		24	<i>Cords</i>		
	<i>Sugar Maple</i>		33	<i>Cords</i>		
	<i>White Ash</i>		2	<i>Cords</i>		
	Mixed Oak		17	Cords		

DESCRIPTION OF TIMBER BY PU (PU), CON'T

PU	MARKET GROUP	PRODUCT	QUANTITY	UNIT	ACRES	ADVERTISE PRICE
2 con't	<i>Bl/R/Hybrid Oak</i>	<i>Pulpwood</i>	4	<i>Cords</i>		
	<i>Red Oak</i>		13	<i>Cords</i>		
	Red Pine		6	Cords		
TOTAL:			231.4	MBF		
TOTAL:			1,386	Cords		

Sale Specific Conditions & Requirements

Sale Name: One Leg Aspen

Sale Number: 61-107-20 Seq#: 1

1 - Sale Area

1.2 - Boundaries

1.2.1 - Painted boundaries (9/19)

The sale boundary and Payment Unit boundaries are marked and identified by red and yellow paint. Exterior sale boundary lines against state are marked with red paint. Interior Payment Unit boundaries are marked with yellow paint. Yellow painted trees designating an interior Payment Unit boundary are only to be cut when all surrounding Payment Units have been paid.

2 - Timber Specifications

2.1 - Included Timber

2.1.1 - Clearcut unit(s) with unmerchantable trees (6/14)

Within Payment Unit(s) 1 and 2, cut all trees that are two (2) inches or more at DBH, except do not any white oak or green marked trees.

3 - Payments

3.3 - Pre-measured Sales

3.3.4 - Dividing payment units (7/14)

Payment Unit(s) 1, may be divided at the request of the Purchaser and upon approval of the Unit Manager. Dividing Payment Units is a contract modification which requires a Timber Sale Contract Supplement. There shall be only one division per Payment Unit.

4 - Transportation

4.1 - Construction

4.1.6 - Road construction (1/09)

Construction of new roads or improvements of existing roads shall be done in such a way as to minimize the environmental and visual impacts. Merchantable trees shall be cut and utilized unless otherwise directed. Non-merchantable trees shall be severed and laid flat on the ground. Slash shall be scattered, not left in windrows and kept a minimum of ten (10) feet back from the road edge. Stumps shall be set upright, not left on edge, and be moved at least ten (10) feet away from the road edge. Disturbed soil shall be feathered into the woods and not left in berms or windrows.

4.1.7 - Road closure (10/11)

All new roads built into the sale must be blocked to vehicle traffic within 30 days of completion of hauling. Overgrown roads that are reopened shall be considered new roads. These roads must be rendered impassable to cars and trucks. In general, this will require constructing a four (4) foot high berm of stumps and logs covered with earth. Contact the sale administrator for details of design and placement.

5 - Operations

5.1 - Notification

5.1.1 - Pre-sale conference (10/16)

A pre-sale conference on site between the Purchaser and sale administrator is required prior to beginning any operation to determine landing, road location, and threatened species guidance. The Unit Manager or their representative must be contacted at least 5 days in advance to schedule this conference.

5.2 - Conduct of Operations

5.2.1 - Slash

5.2.1.8 - Slash height (12/08)

No slash or tree tops may exceed twenty four (24) inches in height.

5.2.1.10 - No slash in openings (5/10)

No brush or logging debris is to be left in the maintained wildlife opening, which is indicated by U0 on the Timber Sale Map east of the sale area. Any damage to the opening shall be repaired according to specifications of the Unit Manager or his/her representative.

5.2.3 - Operating Restrictions

5.2.3.1 - Operating restrictions (9/11)

Within Payment Unit(s) 1 and 2, unless changed by written agreement, there is a couple acre pocket on the east side of the Payment Units where cutting and skidding is limited to frozen ground condition. This restriction is because of a threatened species. Contact the sale administrator for additional details.

5.2.29 - Shrub protection (1/20)

Do not cut or damage hawthorn, witch-hazel, dogwood or juneberry. These woody-shrub plants are highly beneficial to various wildlife species.

5.2.32 - Decking/landing restoration (9/13)

All decking and landing areas must have the surface area restored to a condition equal to or better than before. This is to ensure the proper regeneration of the stand. Wood debris, chips and "cookies" from trimmings must be removed or scattered away from landing and loading areas and may not be windrowed on the edge.

5.2.37 - No decking areas (12/08)

No decking is allowed within the U0 cover types located on the east side of the timber sale. These are managed wildlife openings.

5.2.41 - Snowmobile trail protection (9/11)

The Cranberry trail is a snowmobile trail and is shown on the Timber Sale Map. Do not cut or damage posts with orange trail markers or traffic control signs. If the trail is used, it must be maintained and restored to a condition equal to or better than before the sale. If the trail is used for hauling, it must be graded to the satisfaction of the Unit Manager or their representative prior to December 1. If the trail road is used for hauling during the snowmobile season, then a snow covered base must be left on the trail. Maintain a twenty (20) foot wide slash, debris and rut free zone daily using the snowmobile trail as the center-line. No decking of forest products will be permitted along the snowmobile trail. All stumps within twenty (20) feet of the snowmobile trail must be cut at ground level.

5.2.43 - Opening protection (12/08)

No activities are permitted in openings marked on the Timber Sale Map with the letter "G". Any damage to the openings shall be repaired according to specifications of the Unit Manager or his/her representative.

5.4 - Soil Protection

5.4.1 - Rutting restriction, general (7/16)

Operations are to cease immediately if equipment and weather conditions result in rutting of roads and/or skid trails which is twelve (12) inches or greater in depth and fifty (50) feet in length. The Unit Manager or his/her representative may restrict hauling and/or skidding if ruts exceed the specified depth. With the Unit Manager or his/her representative's approval, the Purchaser may return to the area when the risk of rutting has decreased.

6 - Safety and Fire Prevention

6.2 - Signing

6.2.1 - Road posting (9/09)

The Purchaser is responsible for posting and maintaining caution signs on roads used for hauling prior to beginning operations. The road must be posted at appropriate distances from the sale area to warn of logging activity and truck traffic. Signs must be removed when harvest operations are suspended or completed. The Purchaser shall provide these signs.

6.2.2 - Snowmobile trail posting (8/09)

The Purchaser is responsible for posting and maintaining caution signs on Cranberry snowmobile trail prior to beginning operations during the snowmobile season (approximately December 1 to March 31). The trail must be posted at appropriate

distances from the sale area to warn of logging activity and truck traffic. Signs must be removed when harvest operations are suspended or completed. The Purchaser shall provide these signs.

**TIMBER SALE MAP**

This information provided by authority of Part 525, 1994 PA 451, as amended.

Sale Number	Year
61-107	20

Forest Management Unit	County	Mapped By	Date	Page	of
Traverse City	Kalkaska	Crigger	03/26/2020	1	1
Township	Range	Section(s) and Subdivision(s)	Scale		
25N	05W	Section 20	1:15,840		

Cover Type				Density	
A = Aspen	H = Hemlock	N = Marsh	U = Upland Brush	0 = Non Stocked	5 = Pole Timber Medium
B = Paper Birch	J = Jack Pine	O = Oak	UM = Upland Mixed	1 = Seedling Sapling Poor	6 = Pole Timber Well
C = Cedar	L = Lowland Brush	P = Lowland Poplar	V = Bog or Marsh	2 = Seedling Sapling Medium	7 = Saw Timber Poor
D = Treed Bog	LM = Lowland Mixed	Q = Mixed Swamp Conifer	W = White Pine	3 = Seedling Sapling Well	8 = Saw Timber Medium
E = Swamp Hdwoods	M = Mpl, Bch, Brch	R = Red Pine	X = Non Stocked	4 = Pole Timber Poor	9 = Saw Timber Well
F = Spruce Fir	MC = Mixed Conifer	S = Black Spruce	Z = Water		
G = Grass	MD = Mixed Deciduous	T = Tamarack			

PU	Acres	PU	Acres
1	50.1		
2	22.9		

One Leg Aspen

Compartment 143

73 Acres

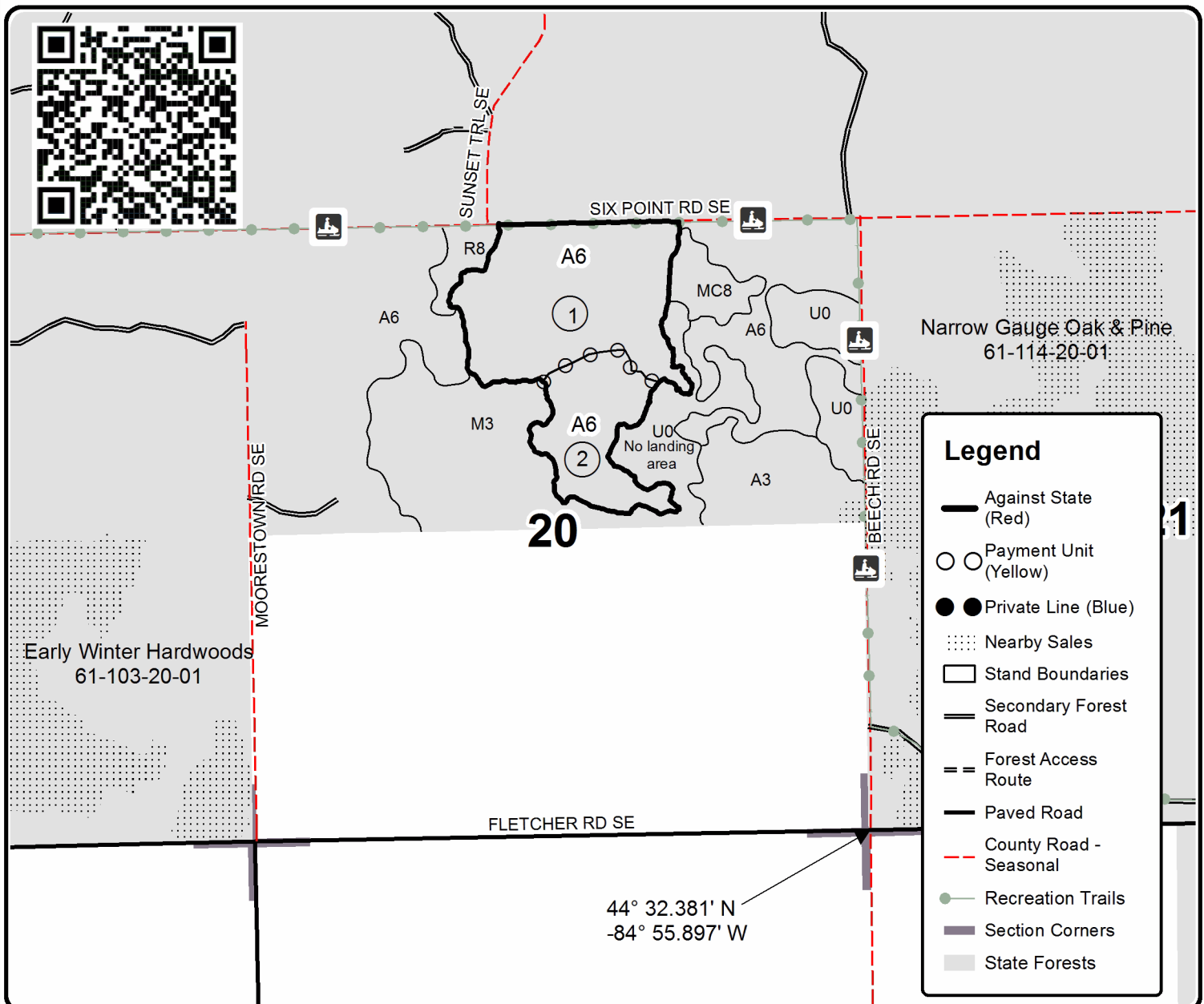

0 0.125 0.25 0.5 0.75 1 Miles