



**DEPARTMENT OF NATURAL RESOURCES
STATE OF MICHIGAN**

TIMBER SALE PROSPECTUS #6717

SCHEDULED SALE DATE AND TIME: 8:30 a.m. (local time) on August 12, 2020.

LOCATION: CRYSTAL FALLS MGMT UNIT, 1420 US 2 WEST, CRYSTAL FALLS, MI 49920.

CONTACT NAME: Dan McNamee

PHONE NUMBER: (906) 875-6622

PROSPECTUS NOTE: The bidder is advised to inspect the sale area and review the location, estimated volumes, operating costs and contract terms of proposed sales. Please be aware that some landowners may request 60 days or more notice for access across their land.

Notice is hereby given that bids will be received by the Unit Manager, CRYSTAL FALLS MANAGEMENT UNIT, for certain timber on the following described lands:

Gobblers Gamble (12-013-19) / T43N, R27W, SEC. 16, SWSW.

T43N, R27W, SEC. 17, S1/2NW,SW,NWSE,S1/2SE.

T43N, R27W, SEC. 18, N1/2SW,SE.

T43N, R27W, SEC. 19, NENE,S1/2NE,NWSE.

T43N, R27W, SEC. 20, N1/2NW,N1/2NE.

Dickinson County, Advertised Price \$149,662.95, 339.9 Acres, Aspen, Spruce/Fir/Tamarack.

SALE NOTE: Extensive road work is required on this sale (see spec 4.1.8). This sale has class A road access.

Access may be through private or other public land.

TIMBER SALE INFORMATION

Gobblers Gamble (12-013-19)

T43N, R27W, SEC. 16; T43N, R27W, SEC. 17; T43N, R27W, SEC. 18; T43N, R27W, SEC. 19; T43N, R27W, SEC. 20.
Dickinson County (Advertised Price \$149,662.95)

SALE NOTE: Extensive road work is required on this sale (see spec 4.1.8). This sale has class A road access.

Access may be through private or other public land.

A timber sale contract for this lump sum, sealed bid timber sale will be awarded to the responsible bidder offering the highest sealed bid price.

Bids must be at or above the following advertised price for each species:

<u>PRODUCTS & SPECIES</u>	<u>ESTIMATED UNITS*</u>		<u>ADVERTISED PRICE</u>
Sawtimber			
Black Cherry	0.80	MBF	\$ 67.00 / MBF
Paper Birch	3.10	MBF	\$ 62.00 / MBF
Sugar Maple	4.70	MBF	\$ 194.00 / MBF
Pulpwood			
Balsam Fir	235.00	Cords	\$ 13.00 / Cord
Mixed Aspen	4,179.00	Cords	\$ 30.30 / Cord
Mixed Hardwood	231.00	Cords	\$ 17.35 / Cord
Mixed Spruce	1,012.00	Cords	\$ 11.25 / Cord
Tamarack	1,164.00	Cords	\$ 2.95 / Cord

BOND AND PAYMENT SCHEDULE:

1. A bond in the amount of \$7,483.15 to insure faithful performance of the conditions of the contract will be deposited by the successful bidder within 21 days of the sale award.
2. Cutting in any sale or unit without the required advance payment would be considered a trespass.
3. Total payment must be paid in advance or according to the following schedule:
 - (a) Ten percent (10%) of the sale value must be paid within 21 days of the sale award.
 - (b) The 10% down payment will be credited towards the first unit cut.
4. If no cutting takes place, the 10% down payment will not be refunded.
5. Operations on the contract issued will terminate on 06/28/2024.

Description of Timber by Payment Unit (PU)

PU	MARKET GROUP	PRODUCT	QUANTITY	UNIT	ACRES	ADVERTISE PRICE
1	Black Cherry	Sawtimber	0.8	MBF	34.2	\$20,507.50
	Balsam Fir	Pulpwood	53.0	Cords		
	Mixed Aspen		642.0	Cords		
	Mixed Hardwood		18.0	Cords		
2	Sugar Maple	Sawtimber	0.9	MBF	47.8	\$33,688.05
	Balsam Fir	Pulpwood	4.0	Cords		
	Mixed Aspen		1,083.0	Cords		
	Mixed Hardwood		23.0	Cords		
	Mixed Spruce		22.0	Cords		
3	Balsam Fir	Pulpwood	84.0	Cords	49.7	\$27,987.40
	Mixed Aspen		862.0	Cords		
	Mixed Hardwood		13.0	Cords		
	Mixed Spruce		49.0	Cords		
4	Balsam Fir	Pulpwood	2.0	Cords	18.6	\$2,158.85
	Mixed Aspen		21.0	Cords		
	Mixed Hardwood		6.0	Cords		
	Mixed Spruce		75.0	Cords		
	Tamarack		186.0	Cords		
5	Paper Birch	Sawtimber	1.3	MBF	6.4	\$3,735.95
	Balsam Fir	Pulpwood	18.0	Cords		
	Mixed Aspen		93.0	Cords		
	Mixed Hardwood		27.0	Cords		
	Mixed Spruce		12.0	Cords		
6	Balsam Fir	Pulpwood	11.0	Cords	24.3	\$7,284.40
	Mixed Aspen		211.0	Cords		
	Mixed Hardwood		8.0	Cords		
	Mixed Spruce		40.0	Cords		
	Tamarack		54.0	Cords		
7	Paper Birch	Sawtimber	0.8	MBF	39.0	\$22,665.70
	Sugar Maple		1.4	MBF		
	Balsam Fir	Pulpwood	10.0	Cords		
	Mixed Aspen		685.0	Cords		
	Mixed Hardwood		40.0	Cords		
	Mixed Spruce		68.0	Cords		
8	Balsam Fir	Pulpwood	6.0	Cords	17.9	\$3,677.50
	Mixed Aspen		75.0	Cords		
	Mixed Hardwood		5.0	Cords		
	Mixed Spruce		46.0	Cords		
	Tamarack		245.0	Cords		
9	Balsam Fir	Pulpwood	11.0	Cords	40.6	\$9,256.25
	Mixed Aspen		117.0	Cords		
	Mixed Hardwood		6.0	Cords		
	Mixed Spruce		385.0	Cords		
	Tamarack		384.0	Cords		
10	Paper Birch	Sawtimber	0.5	MBF	35.5	\$6,938.90
	Balsam Fir	Pulpwood	8.0	Cords		
	Mixed Aspen		77.0	Cords		
	Mixed Hardwood		13.0	Cords		
	Mixed Spruce		300.0	Cords		
	Tamarack		295.0	Cords		
11	Paper Birch	Sawtimber	0.5	MBF	25.9	\$11,762.45
	Sugar Maple		2.4	MBF		
	Balsam Fir	Pulpwood	28.0	Cords		
	Mixed Aspen		313.0	Cords		

Description of Timber by Payment Unit (PU), con't

PU	MARKET GROUP	PRODUCT	QUANTITY	UNIT	ACRES	ADVERTISE PRICE
11 con't	Mixed Hardwood	Pulpwood	72.0	Cords		
	Mixed Spruce		15.0	Cords		
TOTAL:			8.6	MBF		
TOTAL:			6,821.0	Cords		

Sale Specific Conditions & Requirements

Sale Name: Gobblers Gamble

Sale Number: 12-013-19 Seq#: 3

1 - Sale Area

1.2 - Boundaries

1.2.1 - Painted boundaries (1/14)

The sale boundary and Payment Unit boundaries are marked and identified by blue, red and yellow paint. Exterior sale boundary lines against private property are marked with blue paint. Exterior sale boundary lines against state are marked with red paint. Interior Payment Unit boundaries are marked with yellow paint. The painted boundary line trees are not Included Timber and are to be protected. Yellow painted trees designating an interior Payment Unit boundary are only to be cut when all surrounding Payment Units have been paid.

2 - Timber Specifications

2.1 - Included Timber

2.1.1 - Clearcut unit(s) with unmerchantable trees (6/14)

Within Payment Unit(s) 1-11, cut all trees that are two (2) inches or more at DBH, except do not cut cedar, hemlock, oak and pine. In addition, within Payment Units 1-3 and 11, do not cut sub-merchantable conifers.

2.2 - Utilization

2.2.6 - Roundwood operation required (5/07)

The skidding of whole trees or tree segments with limbs attached is prohibited within Payment Unit(s) 4 and 8-10. All products must be produced as roundwood and forwarded to existing roads or landing areas in final product length.

3 - Payments

3.3 - Pre-measured Sales

3.3.4 - Dividing payment units (7/14)

Payment Unit(s) 2, 3, and 10 may be divided at the request of the Purchaser and upon approval of the Unit Manager.

Dividing Payment Units is a contract modification which requires a Timber Sale Contract Supplement. There will be only one division per Payment Unit.

3.4 - Damaged Timber

3.4.1 - Damaged timber (7/16)

General Condition and Requirement 3.4 Damaged Timber, defines liquidated damages for undesignated live merchantable trees which are cut or injured.

Within Payment Units 1-3 and 11, if more than 20% of the conifer tree seedlings or saplings (1/4" to 4.5" DBH) within a specified portion of the sale area are damaged, liquidated damages will be assessed at \$100 per acre for all acreage within that specified portion of the sale area that was damaged.

4 - Transportation

4.1 - Construction

4.1.4 - Timber removed for construction (12/09)

Trees cut or damaged in the process of pre-approved road, landing or skid trail construction will be decked in an area separate from other Designated Timber and not removed until measured by the sale administrator. Payment will be made at the specified Purchase Unit Price.

4.1.5 - Culverts (5/14)

Roads may require the installation of culverts for cross drainage or at natural drainage-ways. If culverts are needed in these locations, their placement will be specified by the sale administrator and they shall be installed prior to hauling. The culverts

shall be new, corrugated metal or plastic gauge. Culverts will be a minimum of 18 inches in diameter. Culverts needed beyond those specified as required road work, may be supplied by the DNR.

4.1.6 - Road construction (1/09)

Construction of new roads or improvements of existing roads shall be done in such a way as to minimize the environmental and visual impacts. Merchantable trees shall be cut and utilized unless otherwise directed. Non-merchantable trees shall be severed and laid flat on the ground. Slash shall be scattered, and not left in windrows and kept a minimum of 10 feet back from the road edge, or be chipped, utilized or otherwise removed from the sale. Stumps shall be set upright, not left on edge, and be moved at least 10 feet away from the road edge. Disturbed soil shall be feathered into the woods and not left in berms or windrows.

4.1.7 - Road closure (10/11)

All new roads built into the sale must be blocked to vehicle traffic upon completion of the sale. Overgrown roads that are reopened shall be considered new roads. In general, this will require constructing a four (4') foot high berm of stumps and logs covered with earth. Contact the sale administrator for specific details of design and placement.

4.1.8 - Road work (1) (8/07)

The following road work is required: 310 yards of gravel will need to be hauled and spread, and two equalization culverts 18" x 20' must be installed on Stafford Creek Rd before harvesting occurs. In addition, one equalization culvert 18" x 20' will need to be installed on the forest access route within Payment Unit 2 before the sale can be closed. Culverts must have at least 12 inches of fill placed over them. The culvert locations are identified on the Timber Sale Map. Culverts identified as required road work will be provided by the Purchaser. For more information regarding road work contact the sale administrator.

4.2 - Maintenance

4.2.5 - Two wheel drive condition (2/04)

All existing trail roads on and adjacent to the sale area must be passable by two-wheel drive traffic for the duration of the sale.

4.4 - Access

4.4.1 - Private property access (3/11)

Permission for access across private land is the responsibility of the Purchaser. Should the Purchaser desire to cross private land, a copy of the written permission from the private land-owner may be required by the DNR.

5 - Operations

5.2 - Conduct of Operations

5.2.1 - Slash

5.2.1.13 - Dispose of slash as directed (12/05)

Slash is to be disposed of as directed by the sale administrator.

5.2.22 - Operating Caution

5.2.22.1 - Operating caution (6/11)

It is recommended, but not required, that within Payment Unit(s) 6, cutting, skidding, and hauling occur during dry summer or frozen winter conditions. The reason for the recommendation is because wet ground.

5.2.32 - Decking/landing restoration (9/13)

All decking and landing areas must have the surface area restored to a condition equal to or better than before. This is to ensure the proper regeneration of the stand. Wood debris, chips and "cookies" from trimmings must be removed or scattered away from landing and loading areas and may not be windrowed on the edge.

5.4 - Soil Protection

5.4.3 - Erosion control (12/08)

Skid trails or haul roads may require erosion control structures or berms per direction of the Unit Manager or his/her representative.

6 - Safety and Fire Prevention

6.2 - Signing

6.2.1 - Road posting (9/09)

The Purchaser is responsible for posting and maintaining caution signs on County Road 426 prior to beginning operations. The road must be posted at appropriate distances from the sale area to warn of logging activity and truck traffic. Signs must be removed when harvest operations are suspended or completed.

7 - Other Conditions

7.2 - Extensions

7.2.5 - Weather related extension (1/13)

If weather conditions during the operating period of this contract prevent harvesting, this sale may qualify for a weather related extension. If approved, the normal extension fee would be waived. To qualify, there must be a documented attempt each year to harvest in the difficult portion of the sale.

7.5 - Loss

7.5.1 - Deteriorating timber (7/09)

The sale area has received damage from Eastern Dwarf Mistletoe. The Purchaser should harvest the wood as soon as possible. The Department of Natural Resources is held free of responsibility of any further damage or deterioration due to delay in harvesting.

8 - Performance and Settlement

8.3 - Uncompleted or Terminated Contracts

8.3.2 - Completion of contract, other (11/16)

Areas of this sale may be difficult to log. Per General Condition & Requirement 3.5 - Adjustment of Quantity, there will be no adjustment to contract volume, but unharvested timber may not be considered a violation of General Condition & Requirement 8.3 - Uncompleted or Terminated Contract. These areas are located within Payment Unit 5.



TIMBER SALE MAP

This information provided by authority of Part 525, 1994 PA 451, as amended.

Sale Number 013-19		Year 19	
Forest Management Unit Crystal Falls	County Dickinson	Mapped By Jacob Siler	Page 1 of 1
Township 43N	Range 27W	Section(s) and Subdivision(s) Sections: 16, 17, 18, 19, & 20	Date 08/30/2019
Scale 1:15,840		Density	
Cover Type		Density	
H = Hemlock J = Jack Pine L = Lowland Brush LM = Lowland Mixed M = Mpl, Bch, Brch MC = Mixed Conifer MD = Mixed Deciduous G = Grass		U = Upland Brush UM = Upland Mixed V = Bog or Marsh W = White Pine X = Non Stocked Z = Water	
A = Aspen B = Paper Birch C = Cedar D = Treed Bog E = Swamp Hdwoods F = Spruce Fir		0 = Non Stocked 1 = Seeding Sapling Poor 2 = Seeding Sapling Medium 3 = Seeding Sapling Well 4 = Pole Timber Poor 5 = Pole Timber Medium 6 = Pole Timber Well 7 = Saw Timber Poor 8 = Saw Timber Medium 9 = Saw Timber Well	

Legend

- Against State (Red)
- Private Line (BLUE)
- Payment Unit Line (Yellow)
- Poor Dirt Road
- Good Dirt Road
- County Road
- Closed Road
- Berm
- Gate
- Stream
- Section Corners
- State Boundary
- Exclusion

Gobblers Gamble

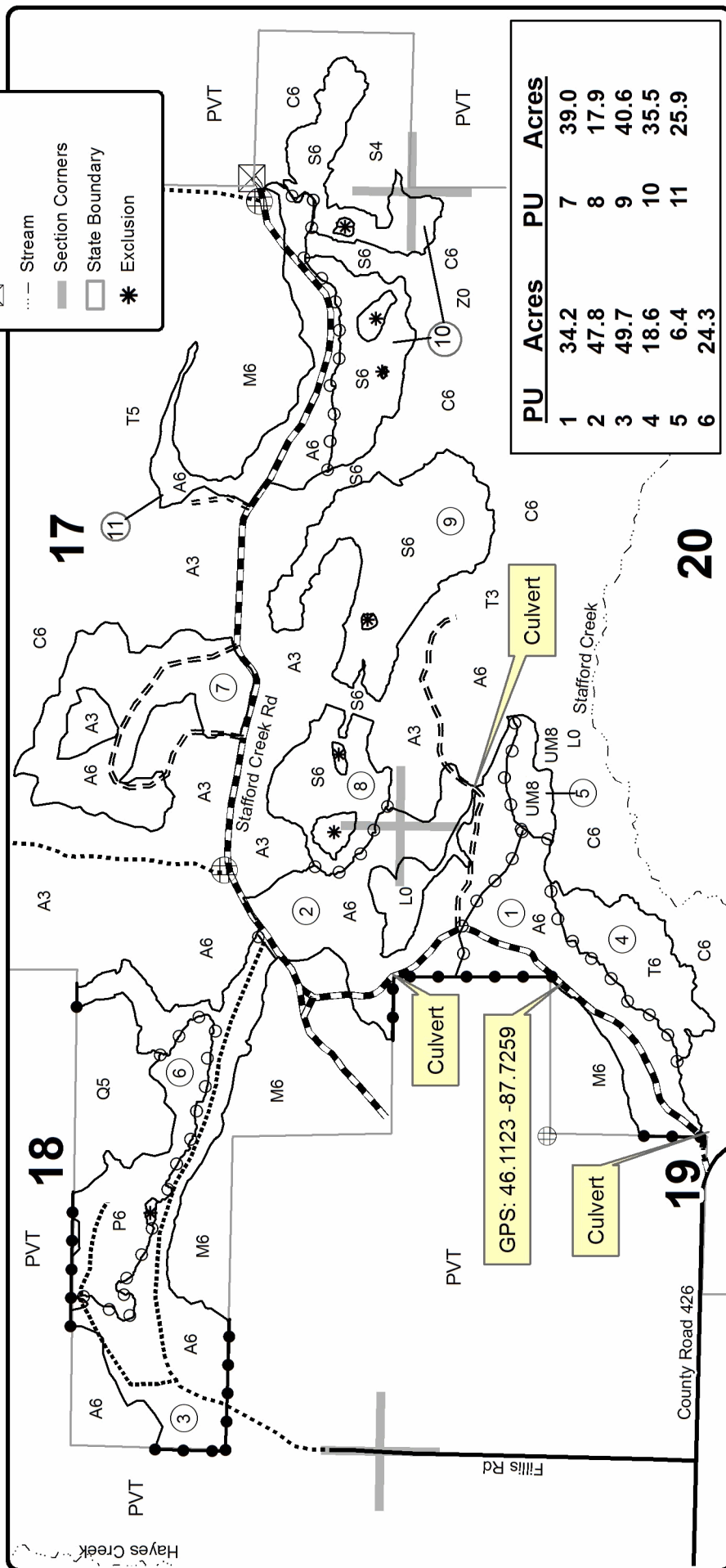

Compartment 30 339.9 Acres