



**DEPARTMENT OF NATURAL RESOURCES  
STATE OF MICHIGAN**

**TIMBER SALE PROSPECTUS #6735**

SCHEDULED SALE DATE AND TIME: 4:00 p.m. (local time) on January 25, 2021.

LOCATION: KALKASKA FIELD OFFICE, 2089 NORTH BIRCH STREET, KALKASKA, MI 49646.

CONTACT NAME: David Lemmien

PHONE NUMBER: (231) 922-6040

PROSPECTUS NOTE: It is recommended that for the duration of the "Stay Home, Stay Safe" executive order that bidders submit their bids through the Online Bidding System (<https://www.dnr.state.mi.us/VMSONlineBidding/>). If you need to register, contact Jake Reid (ReidJ6@michigan.gov, 517-284-5908) or Donovan Asselin (AsselinD@michigan.gov, 517-930-1326). Paper bids will still be accepted during this time, either dropped in the bid box at the bid location or by mailing. If mailing, please allow for additional time.

The bidder is advised to inspect the sale area and review the location, estimated volumes, operating costs and contract terms of proposed sales. Please be aware that some landowners may request 60 days or more notice for access across their land.

Notice is hereby given that bids will be received by the Unit Manager, TRAVERSE CITY MANAGEMENT UNIT, for certain timber on the following described lands:

Goodbye Kelly Aspen (61-123-20) / T26N, R08W, SEC. 2 , N1/2NE, SENE.

Kalkaska County, Advertised Price \$15,316.35, 20.2 Acres, Aspen, Hardwood.

## TIMBER SALE INFORMATION

Goodbye Kelly Aspen (61-123-20)  
T26N, R08W, SEC. 2.  
Kalkaska County (Advertised Price \$15,316.35)

A timber sale contract for this lump sum, sealed bid timber sale will be awarded to the responsible bidder offering the highest sealed bid price. All units of volume listed below were estimated using the T-Sale computer program and our traditional volume equations. Bids must be at or above the following advertised price for each product and species:

<u>PRODUCTS &amp; SPECIES</u>	<u>ESTIMATED UNITS*</u>	<u>ADVERTISED PRICE</u>
Sawtimber		
B. T. Aspen	32.4 MBF	\$ 77.00 / MBF
Beech	1.1 MBF	\$ 45.00 / MBF
Paper Birch	0.7 MBF	\$ 24.00 / MBF
Red Maple	18.2 MBF	\$ 95.00 / MBF
Red Oak	29.7 MBF	\$ 117.00 / MBF
Sugar Maple	12.2 MBF	\$ 135.00 / MBF
White Pine	7.7 MBF	\$ 41.00 / MBF
Pulpwood		
B. T. Aspen	176 Cords	\$ 11.90 / Cord
Mixed Hardwood	218 Cords	\$ 11.35 / Cord
Paper Birch	8 Cords	\$ 9.30 / Cord
Red Oak	77 Cords	\$ 8.25 / Cord
White Pine	29 Cords	\$ 10.70 / Cord

\* The total volume is statistically estimated within plus (+) or minus (-) 12.35 percent. There are an estimated 713 cords on this timber sale, plus or minus 88 cords at the 95% confidence level. The estimated units are final and not subject to adjustment. Prospective bidders are urged to examine this timber and to make their own estimates of quantity and quality.

### **BOND AND PAYMENT SCHEDULE:**

1. A bond in the amount of \$765.82 to insure faithful performance of the conditions of the contract will be deposited by the successful bidder within 21 days of the sale award.
2. Cutting in any sale or unit without the required advance payment would be considered a trespass.
3. Total payment must be paid in advance or according to the following schedule :
  - (a) Ten percent (10%) of the sale value must be paid within 21 days of the sale award.
  - (b) The remainder is due before cutting begins.
4. If no cutting takes place, the 10% down payment will not be refunded.
5. Operations on the contract issued will terminate on 03/31/2023.

### **SALE STATISTICS**

#### **SALE VOLUMES**

VOLUME			STATISTICAL RANGE IN CORDS	
TOTAL CUBIC FEET	TOTAL CORDS	PERCENT ERROR	MINIMUM	MAXIMUM
56,327	713	12.35%	625	801

#### **VDU VOLUMES**

A VDU is a Volume Determination Unit. Volumes and their associated statistics are calculated at the VDU level and summarized to the sale level. There is often a one to one relationship between a VDU and a Payment Unit, but not always, depending on the cruise design. Refer to the VDU TO PAYMENT UNIT table.

	VOLUME			RANGE IN CORDS	
VDU	TOTAL CUBIC FEET	TOTAL CORDS	PERCENT ERROR	MINIMUM	MAXIMUM
30	56,327	713	12.35%	625	801
<b>TOTAL:</b>	<b>56,327</b>	<b>713</b>		<b>625</b>	<b>801</b>

VDU TO PAYMENT UNIT

When a VDU is associated with more than one Payment Unit (PU), the VDU volumes are assigned to the PU based on acres of the VDU within the PU.

VDU	VDU ACRES	PU	PU ACRES
30	20.2	1	20.2
TOTAL:	20.2		20.2

DESCRIPTION OF TIMBER BY PU (PU)

PU	MARKET GROUP	PRODUCT	QUANTITY	UNIT	ACRES	ADVERTISE PRICE
1	B. T. Aspen	Sawtimber	32.4	MBF	20.2	\$15,316.35
	Beech		1.1	MBF		
	Paper Birch		0.7	MBF		
	Red Maple		18.2	MBF		
	Red Oak		29.7	MBF		
	Sugar Maple		12.2	MBF		
	White Pine		7.7	MBF		
	B. T. Aspen	Pulpwood	176	Cords		
	Mixed Hardwood		218	Cords		
	Beech		11	Cords		
	Red Maple		152	Cords		
	Sugar Maple		55	Cords		
	Paper Birch		8	Cords		
	Red Oak		77	Cords		
	White Pine		29	Cords		
TOTAL:			102.0	MBF		
TOTAL:			508	Cords		

## **Sale Specific Conditions & Requirements**

**Sale Name: Goodbye Kelly Aspen**

**Sale Number: 61-123-20 Seq#: 1**

### **1 - Sale Area**

#### **1.2 - Boundaries**

##### **1.2.1 - Painted boundaries (9/19)**

The sale boundary and Payment Unit boundaries are marked and identified by blue and red paint. Exterior sale boundary lines against private property are marked with blue paint. Exterior sale boundary lines against state are marked with red paint. Retention patches are marked with red paint; no harvesting activities may occur within these areas. The painted boundary line trees are not Included Timber and are to be protected.

### **2 - Timber Specifications**

#### **2.1 - Included Timber**

##### **2.1.1 - Clearcut unit(s) with unmerchantable trees (6/14)**

Within Payment Unit(s) 1, cut all trees that are two (2) inches or more at DBH.

### **4 - Transportation**

#### **4.1 - Construction**

##### **4.1.3 - Slash and earthen piles (8/04)**

Piles or windrows of earth along roads and landings that have been widened or constructed shall be leveled. Slash from road maintenance or construction, including stumps, shall be dispersed throughout the sale.

##### **4.1.4 - Timber removed for construction (12/09)**

Trees cut or damaged in the process of pre-approved road, landing or skid trail construction will be decked in an area separate from other Designated Timber and not removed until measured by the sale administrator. Payment will be made at the specified Purchase Unit Price.

##### **4.1.6 - Road construction (1/09)**

Construction of new roads or improvements of existing roads shall be done in such a way as to minimize the environmental and visual impacts. Merchantable trees shall be cut and utilized unless otherwise directed. Non-merchantable trees shall be severed and laid flat on the ground. Slash shall be scattered, and not left in windrows and kept a minimum of 10 feet back from the road edge. Stumps shall be set upright, not left on edge, and be moved at least 10 feet away from the road edge. Disturbed soil shall be feathered into the woods and not left in berms or windrows.

#### **4.2 - Maintenance**

##### **4.2.5 - Two wheel drive condition (2/04)**

All existing trail roads on and adjacent to the sale area must be passable by two-wheel drive traffic for the duration of the sale.

### **5 - Operations**

#### **5.1 - Notification**

##### **5.1.1 - Pre-sale conference (10/16)**

A pre-sale conference on site between the Purchaser and sale administrator is required prior to beginning any operations to determine landing and road locations. The Unit Manager or his/her representative must be contacted at least 5 days in advance to schedule the conference.

##### **5.1.4 - Post-sale conference (10/16)**

A post-sale conference on site between the Purchaser and sale administrator is required 5 days prior to the completion of active logging operations to determine clean-up and repair of landings, road edges, and the fulfillment of other contract specifications.

## 5.2 - Conduct of Operations

### 5.2.3 - Operating Restrictions

#### 5.2.3.4 - Oak wilt restriction, no exceptions (1/18)

Within Payment Unit(s) 1, cutting, skidding, hauling within the sale and brushing of access roads to the sale are not permitted during the period of April 15 to July 15. No exceptions will be granted. This is necessary to reduce the spread of oak wilt.

#### 5.2.32 - Decking/landing restoration (9/13)

All decking and landing areas must have the surface area restored to a condition equal to or better than before. This is to ensure the proper regeneration of the stand. Wood debris, chips and "cookies" from trimmings must be removed or scattered away from landing and loading areas and may not be windrowed on the edge.

**TIMBER SALE MAP**

This information provided by authority of Part 525, 1994 PA 451, as amended.

Sale Number	Year
61-123	20
Date	Page of
08/21/2020	1 of 1

Forest Management Unit		County	Mapped By	Roell
Traverse City		Kalkaska	Cruised By	Standerfer & Roell
Township	Range	Section(s) and Subdivision(s)		Scale
26N	08W	NE1/4 Section2		

Cover Type				Density	
A = Aspen	H = Hemlock	N = Marsh	U = Upland Brush	0 = Non Stocked	5 = Pole Timber Medium
B = Paper Birch	J = Jack Pine	O = Oak	UM = Upland Mixed	1 = Seedling Sapling Poor	6 = Pole Timber Well
C = Cedar	L = Lowland Brush	P = Lowland Poplar	V = Bog or Marsh	2 = Seedling Sapling Medium	7 = Saw Timber Poor
D = Treed Bog	LM = Lowland Mixed	Q = Mixed Swamp Conifer	W = White Pine	3 = Seedling Sapling Well	8 = Saw Timber Medium
E = Swamp Hardwoods	M = Mpl. Ech. Birch	R = Red Pine	X = Non Stocked	4 = Pole Timber Poor	9 = Saw Timber Well
F = Spruce Fir	MC = Mixed Conifer	S = Black Spruce	Z = Water		
G = Cress	MD = Mixed Deciduous	T = Tamarack			

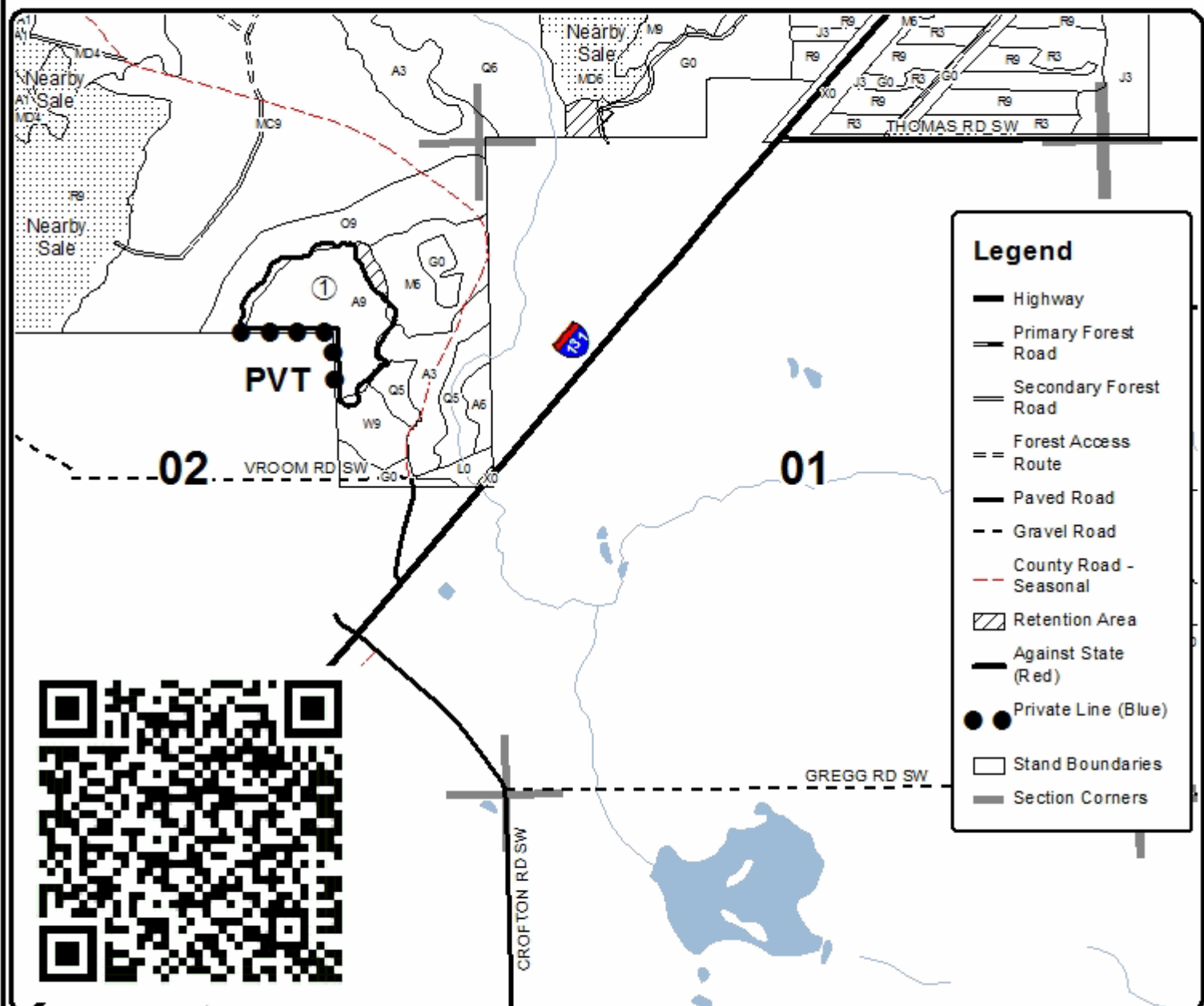
**PU Acres****1 20.2****Goodbye Kelly Aspen****Compartment 157****20.2 Acres**

0 0.125 0.25 0.5 0.75 1 Miles