



**DEPARTMENT OF NATURAL RESOURCES
STATE OF MICHIGAN**

TIMBER SALE PROSPECTUS #6908

SCHEDULED SALE DATE AND TIME: 3:00 p.m. (local time) on July 29, 2021.

LOCATION: NEWBERRY MGMT UNIT, 5666 S STATE HWY M 123, NEWBERRY, MI 49868.

CONTACT NAME: Keith Magnusson

PHONE NUMBER: (906) 293-3293

PROSPECTUS NOTE: The bidder is advised to inspect the sale area and review the location, estimated volumes, operating costs and contract terms of proposed sales. Please be aware that some landowners may request 60 days or more notice for access across their land.

Notice is hereby given that bids will be received by the Unit Manager, NEWBERRY MANAGEMENT UNIT, for certain timber on the following described lands:

C3 Mix (42-019-20) / T48N, R12W, SEC. 6 , SWNW,N1/2SW,SWSW,N1/2SE,SWSE.

Luce County, Advertised Price \$37,089.75, 108.2 Acres, Hardwood, N White Cedar.

SALE NOTE: Permission for access across private land is the responsibility of the Purchaser. See Sale Spec 4.4.1 for additional information.

It is recommended, that harvesting occur during dry summer or frozen winter conditions because of the low ground nature of some of the Payment Units. See Sale Spec 5.2.22.1 for recommendations.

There is a snowmobile trail that will need to be used to access the Sale Area. See Sale Spec 5.2.41 for restrictions.

A recreation site such as a trail, pathway, or campground is within the sale area or the vicinity. Certain restrictions/specifications may be applicable including time restrictions. Access may be through private land.

TIMBER SALE INFORMATION

C3 Mix (42-019-20)

T48N, R12W, SEC. 6.

Luce County (Advertised Price \$37,089.75)

SALE NOTE: Permission for access across private land is the responsibility of the Purchaser. See Sale Spec 4.4.1 for additional information.

It is recommended, that harvesting occur during dry summer or frozen winter conditions because of the low ground nature of some of the Payment Units. See Sale Spec 5.2.22.1 for recommendations.

There is a snowmobile trail that will need to be used to access the Sale Area. See Sale Spec 5.2.41 for restrictions.

A recreation site such as a trail, pathway, or campground is within the sale area or the vicinity. Certain restrictions/specifications may be applicable including time restrictions. Access may be through private land.

A timber sale contract for this lump sum, sealed bid timber sale will be awarded to the responsible bidder offering the highest sealed bid price. All units of volume listed below were estimated using the T-Sale computer program and our traditional volume equations. Bids must be at or above the following advertised price for each product and species:

<u>PRODUCTS & SPECIES</u>	<u>ESTIMATED UNITS*</u>	<u>ADVERTISED PRICE</u>
Sawtimber		
Paper Birch	9.8 MBF	\$ 27.00 / MBF
Red Maple	43.3 MBF	\$ 68.00 / MBF
Yellow Birch	3.6 MBF	\$ 35.00 / MBF
Pulpwood		
Balsam Fir	184 Cords	\$ 9.35 / Cord
Mixed Aspen	58 Cords	\$ 17.30 / Cord
Mixed Hardwood	751 Cords	\$ 10.90 / Cord
Mixed Spruce	408 Cords	\$ 18.30 / Cord
N. White Cedar	1,287 Cords	\$ 4.80 / Cord
Tamarack	38 Cords	\$ 4.80 / Cord
White Pine	569 Cords	\$ 15.85 / Cord

* The total volume is statistically estimated within plus (+) or minus (-) 13.04 percent. There are an estimated 3,471 cords on this timber sale, plus or minus 453 cords at the 95% confidence level. The estimated units are final and not subject to adjustment. Prospective bidders are urged to examine this timber and to make their own estimates of quantity and quality.

BOND AND PAYMENT SCHEDULE:

1. A bond in the amount of \$1,854.49 to insure faithful performance of the conditions of the contract will be deposited by the successful bidder within 21 days of the sale award.
2. Cutting in any sale or unit without the required advance payment would be considered a trespass.
3. Total payment must be paid in advance or according to the following schedule :
 - (a) Ten percent (10%) of the sale value must be paid within 21 days of the sale award.
 - (b) The 10% down payment will be credited towards the first unit cut.
 - (c) Payment for each of the following units must be made before cutting begins in that unit:

PAYMENT UNIT NUMBER	PERCENT OF TOTAL SALE VALUE
01	17.4%
02	17.1%
03	16.7%
04	8.8%
05	5.0%
06	10.2%
07	11.6%
08	6.5%
09	6.7%

4. If no cutting takes place, the 10% down payment will not be refunded.
5. Operations on the contract issued will terminate on 12/31/2025.

SALE STATISTICS

SALE VOLUMES

VOLUME			STATISTICAL RANGE IN CORDS	
TOTAL CUBIC FEET	TOTAL CORDS	PERCENT ERROR	MINIMUM	MAXIMUM
274,194	3,471	13.04%	3,018	3,923

VDU VOLUMES

A VDU is a Volume Determination Unit. Volumes and their associated statistics are calculated at the VDU level and summarized to the sale level. There is often a one to one relationship between a VDU and a Payment Unit, but not always, depending on the cruise design. Refer to the VDU TO PAYMENT UNIT table.

	VOLUME			RANGE IN CORDS	
VDU	TOTAL CUBIC FEET	TOTAL CORDS	PERCENT ERROR	MINIMUM	MAXIMUM
64	181,668	2,300	22.47%	1,783	2,816
65	35,748	453	27.19%	329	576
66	16,416	208	60.42%	82	333
67	26,228	332	18.17%	272	392
70	178,287	2,257	21.12%	1,780	2,733
71	14,615	185	67.08%	61	309
72	14,339	182	10.38%	163	200
TOTAL:	467,301	5,915		4,470	7,360

VDU TO PAYMENT UNIT

When a VDU is associated with more than one Payment Unit (PU), the VDU volumes are assigned to the PU based on acres of the VDU within the PU.

VDU	VDU ACRES	PU	PU ACRES
64	42.0	1	21.2
		2	20.8
65	13.2	3	13.2
66	5.1	4	5.1
67	11.3	3	0.3
		5	11.0
70	26.5	6	12.5
		7	14.0
71	4.9	8	4.9
72	5.2	9	5.2
TOTAL:	108.2		108.2

DESCRIPTION OF TIMBER BY PU (PU)

PU	MARKET GROUP	PRODUCT	QUANTITY	UNIT	ACRES	ADVERTISE PRICE
1	Paper Birch	Sawtimber	0.7	MBF	21.2	\$6,463.75
	Red Maple		1.4	MBF		
	Balsam Fir	Pulpwood	67	Cords		
	Mixed Aspen		5	Cords		
	<i>Quaking Aspen</i>		5	<i>Cords</i>		
	Mixed Hardwood		65	Cords		
	<i>Paper Birch</i>		23	<i>Cords</i>		
	<i>Red Maple</i>		42	<i>Cords</i>		
	Mixed Spruce		138	Cords		
	<i>Black Spruce</i>		94	<i>Cords</i>		
	<i>White Spruce</i>		44	<i>Cords</i>		
	N. White Cedar		200	Cords		
	Tamarack		10	Cords		
	White Pine		88	Cords		
2	Paper Birch	Sawtimber	0.6	MBF	20.8	\$6,339.10
	Red Maple		1.3	MBF		
	Balsam Fir	Pulpwood	66	Cords		
	Mixed Aspen		5	Cords		
	<i>Quaking Aspen</i>		5	<i>Cords</i>		
	Mixed Hardwood		65	Cords		
	<i>Paper Birch</i>		23	<i>Cords</i>		
	<i>Red Maple</i>		42	<i>Cords</i>		
	Mixed Spruce		135	Cords		
	<i>Black Spruce</i>		92	<i>Cords</i>		
	<i>White Spruce</i>		43	<i>Cords</i>		
	N. White Cedar		196	Cords		
	Tamarack		10	Cords		
	White Pine		86	Cords		
3	Red Maple	Sawtimber	10.8	MBF	13.5	\$6,201.35
	Yellow Birch		2.6	MBF		
	Mixed Aspen	Pulpwood	11	Cords		
	<i>B. T. Aspen</i>		11	<i>Cords</i>		
	Mixed Hardwood		129	Cords		
	<i>Red Maple</i>		111	<i>Cords</i>		
	<i>Yellow Birch</i>		18	<i>Cords</i>		
	Mixed Spruce		1	Cords		
	<i>Black Spruce</i>		1	<i>Cords</i>		
	N. White Cedar		1	Cords		
White Pine		237	Cords			
4	Red Maple	Sawtimber	14.7	MBF	5.1	\$3,258.50
	Balsam Fir	Pulpwood	9	Cords		
	Mixed Hardwood		105	Cords		
	<i>Red Maple</i>		105	<i>Cords</i>		
	White Pine		65	Cords		
5	Mixed Hardwood	Pulpwood	10	Cords	11.0	\$1,871.70
	<i>Paper Birch</i>		7	<i>Cords</i>		
	<i>Red Maple</i>		3	<i>Cords</i>		
	Mixed Spruce		23	Cords		
	<i>Black Spruce</i>		23	<i>Cords</i>		
	N. White Cedar		37	Cords		
	Tamarack		18	Cords		
	White Pine		68	Cords		
6	Paper Birch	Sawtimber	1.6	MBF	12.5	\$3,789.10
	Red Maple		1.1	MBF		
	Balsam Fir	Pulpwood	11	Cords		

DESCRIPTION OF TIMBER BY PU (PU), CON'T

PU	MARKET GROUP	PRODUCT	QUANTITY	UNIT	ACRES	ADVERTISE PRICE	
6 con't	Mixed Aspen	Pulpwood	3	Cords			
	<i>Balsam Poplar</i>		3	<i>Cords</i>			
	Mixed Hardwood		79	Cords			
	<i>Black Ash</i>		2	<i>Cords</i>			
	<i>Paper Birch</i>		34	<i>Cords</i>			
	<i>Red Maple</i>		39	<i>Cords</i>			
	<i>Yellow Birch</i>		4	<i>Cords</i>			
	Mixed Spruce		37	Cords			
	<i>Black Spruce</i>		27	<i>Cords</i>			
	<i>White Spruce</i>		10	<i>Cords</i>			
	N. White Cedar		389	Cords			
	White Pine		7	Cords			
	7		Paper Birch	Sawtimber			1.7
Red Maple			1.3	MBF			
Balsam Fir		Pulpwood	12	Cords			
Mixed Aspen			3	Cords			
<i>Balsam Poplar</i>			3	<i>Cords</i>			
Mixed Hardwood			90	Cords			
<i>Black Ash</i>			3	<i>Cords</i>			
<i>Paper Birch</i>			39	<i>Cords</i>			
<i>Red Maple</i>			43	<i>Cords</i>			
<i>Yellow Birch</i>			5	<i>Cords</i>			
Mixed Spruce			43	Cords			
<i>Black Spruce</i>			31	<i>Cords</i>			
<i>White Spruce</i>			12	<i>Cords</i>			
N. White Cedar			436	Cords			
White Pine			8	Cords			
8			Paper Birch	Sawtimber	4.2	MBF	4.9
	Red Maple			3.5	MBF		
	Balsam Fir	Pulpwood	11	Cords			
	Mixed Aspen		31	Cords			
	<i>Balsam Poplar</i>		7	<i>Cords</i>			
	<i>Quaking Aspen</i>		24	<i>Cords</i>			
	Mixed Hardwood		66	Cords			
	<i>Paper Birch</i>		15	<i>Cords</i>			
	<i>Red Maple</i>		51	<i>Cords</i>			
	Mixed Spruce		22	Cords			
	<i>Black Spruce</i>		13	<i>Cords</i>			
	<i>White Spruce</i>		9	<i>Cords</i>			
	N. White Cedar		28	Cords			
	White Pine		10	Cords			
9	Paper Birch		Sawtimber	1.0	MBF	5.2	\$2,474.90
	Red Maple		9.2	MBF			
	Yellow Birch		1.0	MBF			
	Balsam Fir	Pulpwood	8	Cords			
	Mixed Hardwood		142	Cords			
	<i>Paper Birch</i>		17	<i>Cords</i>			
	<i>Red Maple</i>		120	<i>Cords</i>			
	<i>Yellow Birch</i>		5	<i>Cords</i>			
	Mixed Spruce		9	Cords			
	<i>White Spruce</i>		9	<i>Cords</i>			
TOTAL:			56.7	MBF			
TOTAL:			3,295	Cords			

Sale Specific Conditions & Requirements

Sale Name: C3 Mix

Sale Number: 42-019-20 Seq#: 1

1 - Sale Area

1.2 - Boundaries

1.2.1 - Painted boundaries (9/19)

The sale boundary and Payment Unit boundaries are marked and identified by blue, red, and yellow paint. Exterior sale boundary lines against private property are marked with blue paint. Exterior sale boundary lines against state are marked with red paint. Interior Payment Unit boundaries are marked with yellow paint. Yellow painted trees designating an interior Payment Unit boundary are only to be cut when all surrounding Payment Units have been paid.

2 - Timber Specifications

2.1 - Included Timber

2.1.1 - Clearcut unit(s) with unmerchantable trees (6/14)

Within Payment Unit(s) 1, 2, 4, & 6 - 9, cut all trees that are two (2) inches or more at DBH, with the following exceptions:

- Do not cut any hemlock in any Payment Unit

- Within Payment Units 1 & 2, leave a minimum of two 18" or greater at DBH white pine per acre if they exist

- Within Payment Unit 4, do not cut any yellow birch or cherry if they exist

Payment Units 6-9 are optional to harvest due to potential access issues. Removing any or all of these Payment Units is a contract modification which requires a Timber Sale Contract Amendment.

2.1.7 - Leave tree marked unit(s) (6/14)

Within Payment Unit(s) 3 & 5, all trees, which meet minimum piece specifications in 2.2 Utilization, are designated for cutting except trees marked with green paint above and below stump height. Do not cut any hemlock in these Payment Units.

3 - Payments

3.3 - Pre-measured Sales

3.3.4 - Dividing payment units (7/14)

Payment Unit(s) 1 - 3 may be divided at the request of the Purchaser and upon approval of the Unit Manager. Dividing Payment Units is a contract modification which requires a Timber Sale Contract Amendment. There will be only one division per Payment Unit.

4 - Transportation

4.1 - Construction

4.1.6 - Road construction (1/09)

Construction of new roads or improvements of existing roads shall be done in such a way as to minimize the environmental and visual impacts. Merchantable trees shall be cut and utilized unless otherwise directed. Non-merchantable trees shall be severed and laid flat on the ground. Slash shall be scattered, and not left in windrows and kept a minimum of 10 feet back from the road edge. Stumps shall be set upright, not left on edge, and be moved at least 10 feet away from the road edge. Disturbed soil shall be feathered into the woods and not left in berms or windrows.

4.1.7 - Road closure (10/11)

All new roads built into the sale must be blocked to vehicle traffic upon completion of the sale. In general, this will require constructing a four (4') foot high berm of stumps and logs covered with earth. These roads must be rendered impassable to cars and trucks. Temporary berms may be required if no sale activity occurs for 30 or more consecutive days. Contact the sale administrator for specific details of design and placement.

4.2 - Maintenance

4.2.4 - Grading (10/16)

For completion of the sale, state forest roads must be graded. In general, this will require a road grader or bulldozer to shape up the roads after forest products have been hauled off site. This includes cleaning of drainage areas, grading, crowning, and filling with gravel, if necessary. The grading equipment to be used must be approved by the Unit Manager or his/her representative.

4.2.5 - Two wheel drive condition (2/04)

All existing trail roads on and adjacent to the sale area must be passable by two-wheel drive traffic for the duration of the sale.

4.4 - Access

4.4.1 - Private property access (3/11)

Permission for access across private land is the responsibility of the Purchaser. When crossing Hancock Timber Resource Group property, a permit from them is required. Allow 30 - 60 days for permit processing.

5 - Operations

5.1 - Notification

5.1.1 - Pre-sale conference (10/16)

A pre-sale conference between the Purchaser and sale administrator is required prior to beginning any operations to discuss access issues to the Sale Area. The Unit Manager or his/her representative must be contacted at least 5 days in advance to schedule the conference.

5.2 - Conduct of Operations

5.2.1 - Slash

5.2.1.8 - Slash height (12/08)

No slash may exceed 36 inches in height.

5.2.2 - Hazard Trees/Snags

5.2.2.1 - Den trees (10/16)

Obvious hollow and/or den trees shall be protected and left standing unless they are a safety hazard.

5.2.16 - Equipment recommended (11/18)

Tracked equipment may be necessary to harvest Payment Units 1, 2, 6 & 7 due to the low ground nature of the soils.

5.2.22 - Operating Caution

5.2.22.1 - Operating caution (6/11)

It is recommended, but not required, that within Payment Unit(s) 1 - 9, cutting, skidding, and hauling occur during dry summer or frozen winter conditions. The reason for the recommendation is because of the low ground nature of some of the Payment Units. In addition, all access routes leading into the Sale Area will involve snowmobile trails and significant plowing. Cutting most of the sale in the summer months would be recommended. However, the low ground Payment Units may have to be cut in the winter if soil conditions remain soft in the summer months.

5.2.32 - Decking/landing restoration (9/13)

All decking and landing areas must have the surface area restored to a condition equal to or better than before. This is to ensure the proper regeneration of the stand. Wood debris, chips, and "cookies" from trimmings must be removed or scattered away from landing and loading areas and may not be windrowed on the edge.

5.2.38 - No decking against live trees (2/04)

Cut products may not be decked against unmarked or designated leave trees.

5.2.41 - Snowmobile trail protection (9/11)

There is a snowmobile trail that will need to be used to access the Sale Area. Do not cut or damage posts with orange trail markers or traffic control signs. If the trail is used, it must be maintained and restored to a condition equal to or better than before the sale. Any road maintenance or restoration must be done prior to December 1. If the trail road is to be used for hauling during the snowmobile season, then a snow-covered base must be left on the trail.

5.4 - Soil Protection

5.4.1 - Rutting restriction, general (7/16)

Operations are to cease immediately if equipment and weather conditions result in rutting of roads and/or skid trails which is 12 inches or greater in depth and 50 feet in length. The Unit Manager or his/her representative may restrict hauling and/or skidding if ruts exceed the specified depth. With the Unit Manager or his/her representative's approval, the Purchaser may return to the area when the risk of rutting has decreased.

5.8 - Protection of Endangered Species

5.8.5 - Protection of raptor nests (3/13)

All trees with raptor nests will be protected if found during harvesting operations. Notification will be made to the Unit Manager or his/her representative who will notify the Wildlife Biologist so an on-site evaluation and recommendation can be made, if necessary.

6 - Safety and Fire Prevention

6.2 - Signing

6.2.1 - Road posting (10/20)

The Purchaser is responsible for posting and maintaining caution signs on roads being used during the sale, prior to beginning operations. The road must be posted at appropriate distances from the Sale Area to warn of logging activity and truck traffic. Signs must be removed when harvest operations are suspended or completed. The Purchaser will provide these signs.

6.2.2 - Snowmobile trail posting (10/20)

The Purchaser is responsible for posting and maintaining caution signs on the snowmobile trails prior to beginning operations during the snowmobile season (approximately December 1 to March 31). The trail must be posted to warn of logging activity and truck traffic. Signs must be removed when harvest operations are suspended or completed. The Purchaser will provide these signs.

TIMBER SALE MAP

This information provided by authority of Part 525, 1994 PA 451, as amended.

Forest Management Unit Newberry	County Luce	Year 2020
Township 48N	Range 12W	Section(s) and Subdivision(s) Section 06: SWNW,N1/2SW,SWSW,N1/2SE,SWSE
Maped By Livermore	Cruised By Grossman Forestry	Sale Number 42-019-20
Scale 1:15,840	Date 10/7/2020	Page 1 of 1

Cover Type	
A = Aspen	H = Hemlock
B = Paper Birch	J = Jack Pine
C = Cedar	L = Lowland Brush
D = Tired Bog	LM = Lowland Mixed
E = Swamp Hdwoods	M = Mpl. Bch, Brch
F = Spruce Fir	MC = Mixed Conifer
G = Grass	MD = Mixed Deciduous
	N = Marsh
	O = Oak
	P = Lowland Poplar
	Q = Mixed Swamp Conifer
	R = Red Pine
	S = Black Spruce
	T = Tamarack
	U = Upland Brush
	UM = Upland Mixed
	V = Bog or Marsh
	W = White Pine
	X = Non Stocked
	Z = Water

Density	
0 = Non Stocked	5 = Pole Timber Medium
1 = Seeding Sapling Poor	6 = Pole Timber Well
2 = Seeding Sapling Medium	7 = Saw Timber Poor
3 = Seeding Sapling Well	8 = Saw Timber Medium
4 = Pole Timber Poor	9 = Saw Timber Well

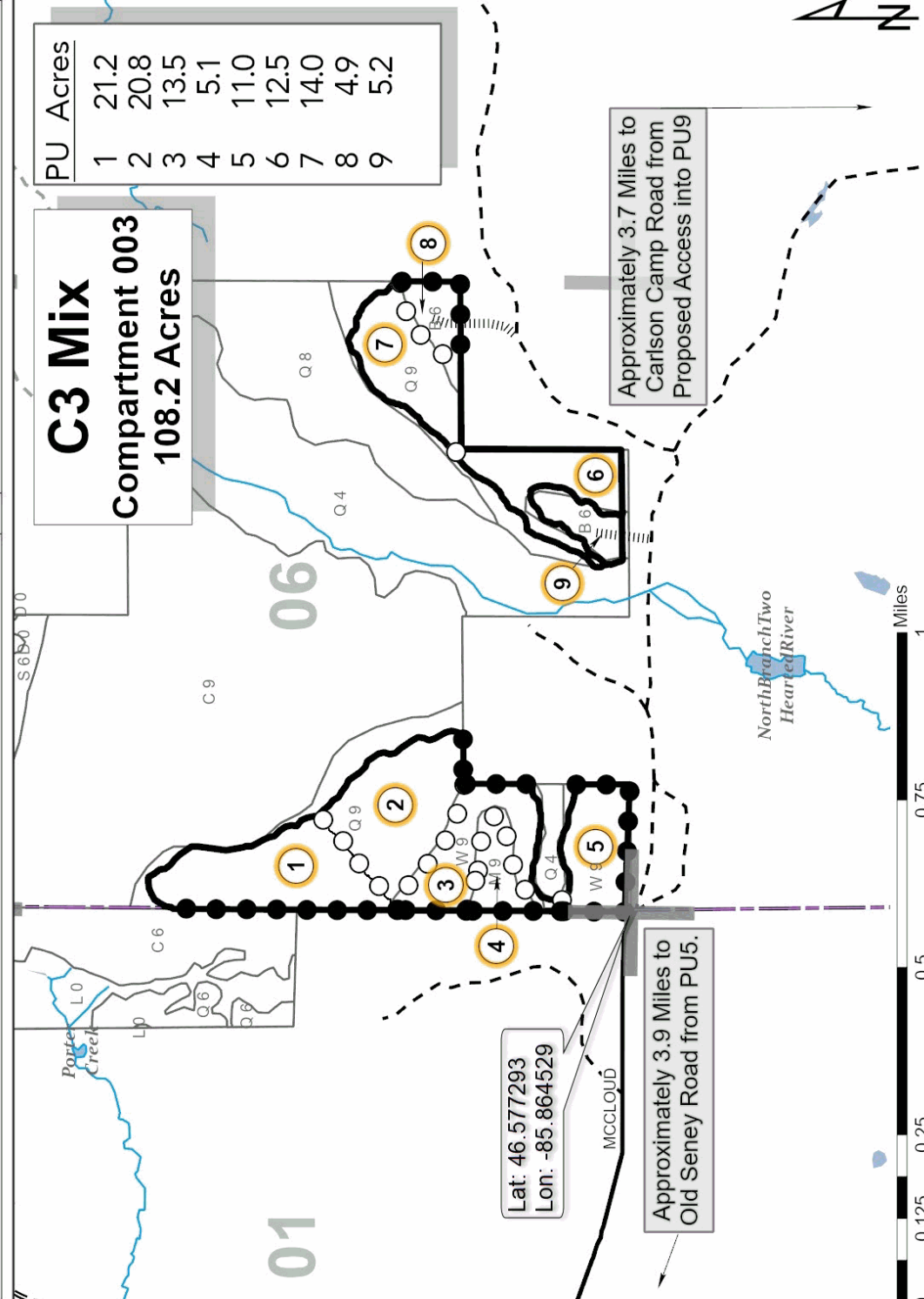

Against State (Red)
Payment Unit (Yellow)
Private Line (Blue)
Payment Unit Label

01 Section Numbers
Section Corners
Perennial River
Lakes and Rivers
Proposed Access

Roads Symbolology
DNR - Primary Forest Road
DNR - Secondary Forest Road
DNR - Forest Access Route
Federal / State Highway
Federal / State / County - Paved Road
Federal / State - Dirt / Gravel Road
County - Gravel Road
County - Dirt Road (Seasonal)
Private - Paved Road
Private - Dirt / Gravel Road
DNR - Management Access
DNR - Temporary Management Access (Internal Only)

Locator Map: 1:200,000
- Main Map Extent