



**DEPARTMENT OF NATURAL RESOURCES
STATE OF MICHIGAN**

TIMBER SALE PROSPECTUS #6833

SCHEDULED SALE DATE AND TIME: **3:00 p.m. (local time) on September 9, 2021.**

LOCATION: **NAUBINWAY FIELD OFFICE, PO BOX 287, US 2 W11569, NAUBINWAY, MI 49762.**

CONTACT NAME: Karen Rodock

PHONE NUMBER: (906) 477-6048

PROSPECTUS NOTE: The bidder is advised to inspect the sale area and review the location, estimated volumes, operating costs and contract terms of proposed sales. Please be aware that some landowners may request 60 days or more notice for access across their land.

Notice is hereby given that bids will be received by the Unit Manager, SAULT STE MARIE MANAGEMENT UNIT, for certain timber on the following described lands:

Upper Millecoquins Mix (45-117-20) / T44N, R10W, SEC. 1 , NW,N1/2SW,SESW.

T44N, R10W, SEC. 2 , NW,NENE.

T44N, R10W, SEC. 3 , E1/2NE,NESE.

Mackinac County, Advertised Price \$75,831.55, 208.2 Acres, Hardwood, Red Pine.

SALE NOTE: A recreation site such as a trail, pathway, or campground is within the sale area or the vicinity. Certain restrictions/specifications may be applicable including time restrictions.

TIMBER SALE INFORMATION

Upper Millecoquins Mix (45-117-20)

T44N, R10W, SEC. 1; T44N, R10W, SEC. 2; T44N, R10W, SEC. 3.
Mackinac County (Advertised Price \$75,831.55)

SALE NOTE: A recreation site such as a trail, pathway, or campground is within the sale area or the vicinity. Certain restrictions/specifications may be applicable including time restrictions.

A timber sale contract for this lump sum, sealed bid timber sale will be awarded to the responsible bidder offering the highest sealed bid price. All units of volume listed below were estimated using the T-Sale computer program and our traditional volume equations. Bids must be at or above the following advertised price for each product and species:

<u>PRODUCTS & SPECIES</u>	<u>ESTIMATED UNITS*</u>	<u>ADVERTISED PRICE</u>
Sawtimber		
Black Cherry	6.8 MBF	\$ 105.00 / MBF
Red Maple	44.0 MBF	\$ 107.00 / MBF
Sugar Maple	132.9 MBF	\$ 305.00 / MBF
Pulpwood		
Mixed Hardwood	1,052 Cords	\$ 12.35 / Cord
Red Pine	269 Cords	\$ 62.45 / Cord
White Spruce	4 Cords	\$ 20.95 / Cord

* The total volume is statistically estimated within plus (+) or minus (-) 13.89 percent. There are an estimated 1,692 cords on this timber sale, plus or minus 235 cords at the 95% confidence level. The estimated units are final and not subject to adjustment. Prospective bidders are urged to examine this timber and to make their own estimates of quantity and quality.

BOND AND PAYMENT SCHEDULE:

- A bond in the amount of \$6,066.52 to insure faithful performance of the conditions of the contract will be deposited by the successful bidder within 21 days of the sale award.
- Cutting in any sale or unit without the required advance payment would be considered a trespass.
- Total payment must be paid in advance or according to the following schedule:
 - Ten percent (10%) of the sale value must be paid within 21 days of the sale award.
 - The 10% down payment will be credited towards the first unit cut.
 - Payment for each of the following units must be made before cutting begins in that unit:

PAYMENT UNIT NUMBER	PERCENT OF TOTAL SALE VALUE
01	11.5%
02	10.8%
03	12.9%
04	11.9%
05	7.2%
06	14.7%
07	18.1%
08	12.9%
- If no cutting takes place, the 10% down payment will not be refunded.
- Operations on the contract issued will terminate on 06/30/2024.

SALE STATISTICS

SALE VOLUMES

VOLUME		STATISTICAL RANGE IN CORDS		
TOTAL CUBIC FEET	TOTAL CORDS	PERCENT ERROR	MINIMUM	MAXIMUM
133,671	1,692	13.89%	1,457	1,927

VDU VOLUMES

A VDU is a Volume Determination Unit. Volumes and their associated statistics are calculated at the VDU level and summarized to the sale level. There is often a one to one relationship between a VDU and a Payment Unit, but not always, depending on the cruise design. Refer to the VDU TO PAYMENT UNIT table.

	VOLUME			RANGE IN CORDS	
VDU	TOTAL CUBIC FEET	TOTAL CORDS	PERCENT ERROR	MINIMUM	MAXIMUM
36	21,575	273	27.84%	197	349
48	112,085	1,419	15.86%	1,194	1,644
TOTAL:	133,660	1,692		1,391	1,993

VDU TO PAYMENT UNIT

When a VDU is associated with more than one Payment Unit (PU), the VDU volumes are assigned to the PU based on acres of the VDU within the PU.

VDU	VDU ACRES	PU	PU ACRES
36	26.9	1	13.9
		2	13.0
48	181.3	3	30.0
		4	27.8
		5	16.8
		6	34.2
		7	42.4
		8	30.1
TOTAL:	208.2		208.2

DESCRIPTION OF TIMBER BY PU (PU)

PU	MARKET GROUP	PRODUCT	QUANTITY	UNIT	ACRES	ADVERTISE PRICE
1	Red Pine White Spruce	Pulpwood	139	Cords	13.9	\$8,722.45
			2	Cords		
2	Red Pine White Spruce	Pulpwood	130	Cords	13.0	\$8,160.40
			2	Cords		
3	Black Cherry	Sawtimber	1.1	MBF	30.0	\$9,755.50
	Red Maple		7.3	MBF		
	Sugar Maple		22.0	MBF		
	Mixed Hardwood	Pulpwood	174	Cords		
	<i>Beech</i>	<i>Sawtimber</i>	<i>0.6</i>	<i>MBF</i>		
	<i>Beech</i>	<i>Pulpwood</i>	<i>28</i>	<i>Cords</i>		
	<i>Black Cherry</i>		<i>14</i>	<i>Cords</i>		
	<i>Red Maple</i>		<i>26</i>	<i>Cords</i>		
	<i>Sugar Maple</i>		<i>105</i>	<i>Cords</i>		
4	Black Cherry	Sawtimber	1.0	MBF	27.8	\$9,044.60
	Red Maple		6.7	MBF		
	Sugar Maple		20.4	MBF		
	Mixed Hardwood	Pulpwood	162	Cords		
	<i>Beech</i>	<i>Sawtimber</i>	<i>0.6</i>	<i>MBF</i>		
	<i>Beech</i>	<i>Pulpwood</i>	<i>26</i>	<i>Cords</i>		
	<i>Black Cherry</i>		<i>13</i>	<i>Cords</i>		
	<i>Red Maple</i>		<i>24</i>	<i>Cords</i>		
	<i>Sugar Maple</i>		<i>98</i>	<i>Cords</i>		
5	Black Cherry	Sawtimber	0.6	MBF	16.8	\$5,475.85
	Red Maple		4.1	MBF		
	Sugar Maple		12.3	MBF		
	Mixed Hardwood	Pulpwood	99	Cords		
	<i>Beech</i>	<i>Sawtimber</i>	<i>0.4</i>	<i>MBF</i>		
	<i>Beech</i>	<i>Pulpwood</i>	<i>16</i>	<i>Cords</i>		
	<i>Black Cherry</i>		<i>8</i>	<i>Cords</i>		
	<i>Red Maple</i>		<i>15</i>	<i>Cords</i>		
	<i>Sugar Maple</i>		<i>59</i>	<i>Cords</i>		
6	Black Cherry	Sawtimber	1.3	MBF	34.2	\$11,125.40
	Red Maple		8.3	MBF		
	Sugar Maple		25.1	MBF		
	Mixed Hardwood	Pulpwood	198	Cords		
	<i>Beech</i>	<i>Sawtimber</i>	<i>0.7</i>	<i>MBF</i>		
	<i>Beech</i>	<i>Pulpwood</i>	<i>32</i>	<i>Cords</i>		
	<i>Black Cherry</i>		<i>15</i>	<i>Cords</i>		
	<i>Red Maple</i>		<i>30</i>	<i>Cords</i>		
	<i>Sugar Maple</i>		<i>120</i>	<i>Cords</i>		
7	Black Cherry	Sawtimber	1.7	MBF	42.4	\$13,736.65
	Red Maple		10.3	MBF		
	Sugar Maple		31.0	MBF		
	Mixed Hardwood	Pulpwood	243	Cords		
	<i>Beech</i>	<i>Sawtimber</i>	<i>0.9</i>	<i>MBF</i>		
	<i>Beech</i>	<i>Pulpwood</i>	<i>38</i>	<i>Cords</i>		
	<i>Black Cherry</i>		<i>18</i>	<i>Cords</i>		
	<i>Red Maple</i>		<i>37</i>	<i>Cords</i>		
	<i>Sugar Maple</i>		<i>148</i>	<i>Cords</i>		
8	Black Cherry	Sawtimber	1.1	MBF	30.1	\$9,798.35
	Red Maple		7.3	MBF		
	Sugar Maple		22.1	MBF		
	Mixed Hardwood	Pulpwood	175	Cords		
	<i>Beech</i>	<i>Sawtimber</i>	<i>0.6</i>	<i>MBF</i>		
	<i>Beech</i>	<i>Pulpwood</i>	<i>28</i>	<i>Cords</i>		

DESCRIPTION OF TIMBER BY PU (PU), CON'T

PU	MARKET GROUP	PRODUCT	QUANTITY	UNIT	ACRES	ADVERTISE PRICE
8 con't	<i>Black Cherry</i>	<i>Pulpwood</i>	<i>14</i>	<i>Cords</i>		
	<i>Red Maple</i>		<i>26</i>	<i>Cords</i>		
	<i>Sugar Maple</i>		<i>106</i>	<i>Cords</i>		
TOTAL:			183.7	MBF		
TOTAL:			1,324	Cords		

Sale Specific Conditions & Requirements

Sale Name: Upper Millecoquins Mix

Sale Number: 45-117-20 Seq#: 1

1 - Sale Area

1.2 - Boundaries

1.2.1 - Painted boundaries (9/19)

The sale boundary and Payment Unit boundaries are marked and identified by red and yellow paint. Exterior sale boundary lines against state are marked with red paint. Interior Payment Unit boundaries are marked with yellow paint. Retention patches are marked with red paint; no harvesting activities may occur within these areas. The painted boundary line trees are not Included Timber and are to be protected unless marked with orange paint. Yellow painted trees designating an interior Payment Unit boundary are only to be cut when all surrounding Payment Units have been paid and marked with orange paint.

2 - Timber Specifications

2.1 - Included Timber

2.1.3 - Cut tree marked unit(s) (12/08)

Within Payment Unit(s) 1 - 8, all trees are designated for cutting when marked with orange paint above and below stump height, regardless of merchantability.

2.2 - Utilization

2.2.6 - Roundwood operation required (5/07)

The skidding of whole trees or tree segments with limbs attached is prohibited within Payment Unit(s) 1 - 8. All products must be produced as roundwood and forwarded to existing roads or landing areas in final product length.

3 - Payments

3.3 - Pre-measured Sales

3.3.4 - Dividing payment units (7/14)

Payment Unit(s) 1 - 8 may be divided at the request of the Purchaser and upon approval of the Unit Manager. Dividing Payment Units is a contract modification which requires a Timber Sale Contract Amendment.

4 - Transportation

4.1 - Construction

4.1.12 - No new roads (1/12)

No new roads will be permitted in any Payment Unit. All operations are limited to existing roads. Skid trails only will be allowed.

4.2 - Maintenance

4.2.5 - Two wheel drive condition (2/04)

All existing trail roads on and adjacent to the sale area must be passable by two-wheel drive traffic for the duration of the sale.

5 - Operations

5.2 - Conduct of Operations

5.2.2 - Hazard Trees/Snags

5.2.2.1 - Den trees (10/16)

Obvious hollow and/or den trees shall be protected and left standing unless they are a safety hazard.

5.2.3 - Operating Restrictions

5.2.3.3 - Bark slippage restriction (3/09)

Within Payment Unit(s) 1 - 8, unless changed by written agreement, cutting and skidding are not permitted during the period of May 1 to June 30. This restriction is because of bark slippage.

5.2.4 - Dead and Down Creation

5.2.4.3 - Dead and down creation, dead trees (6/07)

Except as provided for in General Condition and Requirement 5.2.2, no dead trees, standing or down, are to be cut, skidded, or processed.

5.2.32 - Decking/landing restoration (9/13)

All decking and landing areas must have the surface area restored to a condition equal to or better than before. This is to ensure the proper regeneration of the stand. Wood debris, chips, and "cookies" from trimmings must be removed or scattered away from landing and loading areas and may not be windrowed on the edge.

5.2.38 - No decking against live trees (2/04)

Cut products may not be decked against unmarked or designated leave trees.

5.2.41 - Snowmobile trail protection (9/11)

The Section 34 is a snowmobile trail and is shown on the Timber Sale Map. Do not cut or damage posts with orange trail markers or traffic control signs. If the trail is used, it must be maintained and restored to a condition equal to or better than before the sale. The road maintenance/restoration must be done prior to December 1. If the trail is used for hauling, it must be graded to the satisfaction of the Unit Manager or his/her representative prior to December 1. If the trail road is to be used for hauling during the snowmobile season, then a snow-covered base must be left on the trail. The snowmobile trail may only be crossed at right angles. Maintain a 20-foot-wide slash, debris, and rut free zone daily using the snowmobile trail as the centerline. No decking of forest products will be permitted along the snowmobile trail. All stumps within 20 feet of the snowmobile trail must be cut at ground level.

5.4 - Soil Protection

5.4.1 - Rutting restriction, general (7/16)

Operations are to cease immediately if equipment and weather conditions result in rutting of roads and/or skid trails which is 12 inches or greater in depth and 50 feet in length. The Unit Manager or his/her representative may restrict hauling and/or skidding if ruts exceed the specified depth. With the Unit Manager or his/her representative's approval, the Purchaser may return to the area when the risk of rutting has decreased.

5.8 - Protection of Endangered Species

5.8.5 - Protection of raptor nests (3/13)

All trees with raptor nests will be protected if found during harvesting operations. Notification will be made to the Unit Manager or his/her representative who will notify the Wildlife Biologist so an on-site evaluation and recommendation can be made, if necessary.

6 - Safety and Fire Prevention

6.2 - Signing

6.2.1 - Road posting (9/09)

The Purchaser is responsible for posting and maintaining caution signs on roads leading into active Payment Units prior to beginning operations. The road must be posted at appropriate distances from the Sale Area to warn of logging activity and truck traffic. Signs must be removed when harvest operations are suspended or completed. The Purchaser will provide these signs.

**TIMBER SALE MAP**

This information provided by authority of Part 525, 1994 PA 451, as amended.

Sale Number	Year
45-117	20

Forest Management Unit Sault Ste Marie	County Mackinac	Mapped By A Krugh	Date 9/25/2019	Page 1	of 1
Township 44N	Range 10W	Section(s) and Subdivision(s) 1: W1/2 2: NENE, NW 3: E1/2NE, NESE	Scale 1:15,840		

Cover Type				Density	
A = Aspen	H = Hemlock	N = Marsh	U = Upland Brush	0 = Non Stocked	5 = Pole Timber Medium
B = Paper Birch	J = Jack Pine	O = Oak	UM = Upland Mixed	1 = Seedling Sapling Poor	6 = Pole Timber Well
C = Cedar	L = Lowland Brush	P = Lowland Poplar	V = Bog or Marsh	2 = Seedling Sapling Medium	7 = Saw Timber Poor
D = Treed Bog	LM = Lowland Mixed	Q = Mixed Swamp Conifer	W = White Pine	3 = Seedling Sapling Well	8 = Saw Timber Medium
E = Swamp Hdwoods	M = Mpl, Bch, Brch	R = Red Pine	X = Non Stocked	4 = Pole Timber Poor	9 = Saw Timber Well
F = Spruce Fir	MC = Mixed Conifer	S = Black Spruce	Z = Water		
G = Grass	MD = Mixed Deciduous	T = Tamarack			

PU	Acres	PU	Acres
1	13.9	5	16.8
2	13	6	34.2
3	30	7	42.4
4	27.8	8	30.1

Upper Millecoquins

Compartment 178

208.2 Acres

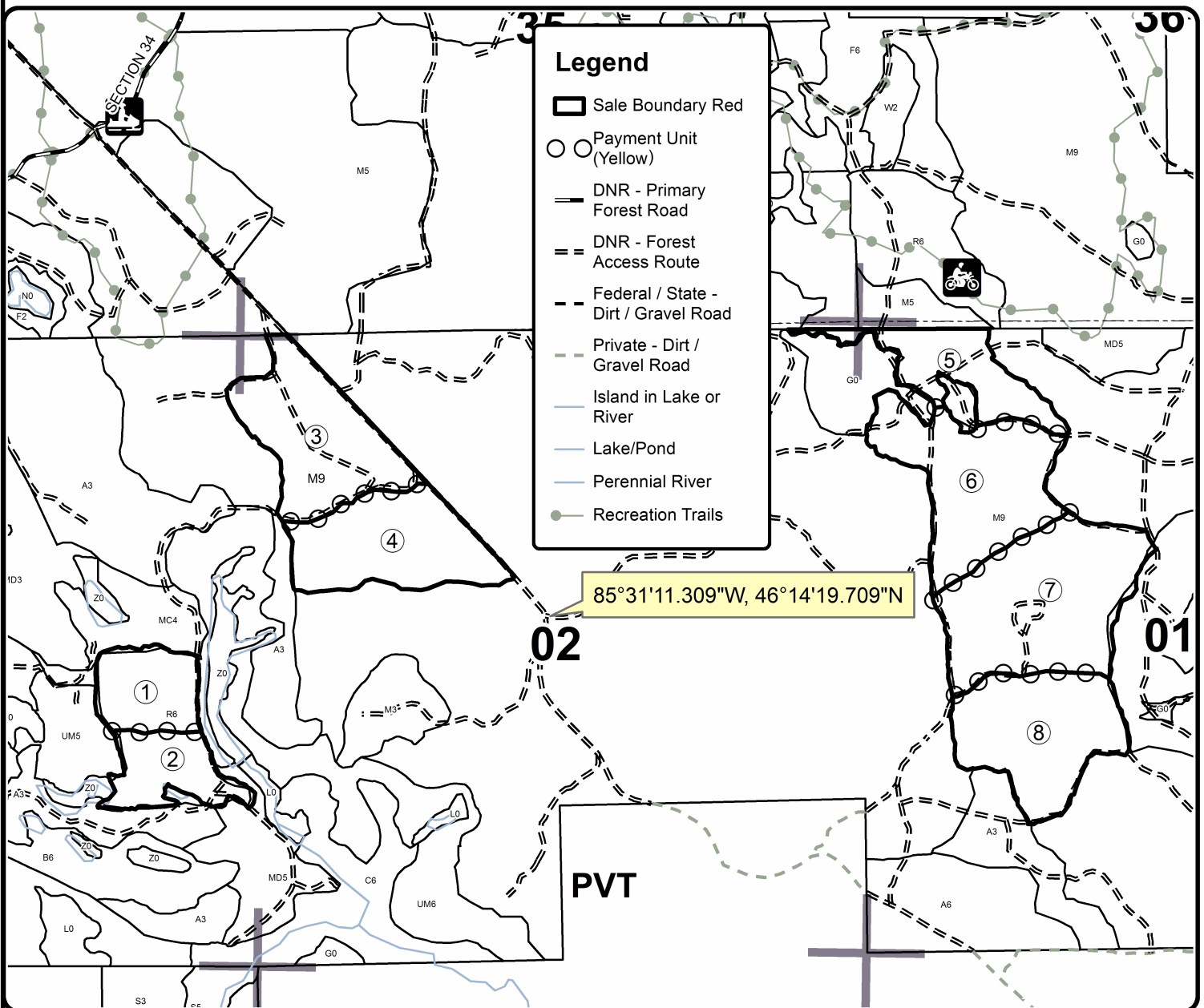

0 0.125 0.25 0.5 0.75 1 Miles