



**DEPARTMENT OF NATURAL RESOURCES
STATE OF MICHIGAN**

TIMBER SALE PROSPECTUS #6781

SCHEDULED SALE DATE AND TIME: 11:00 a.m. (local time) on December 8, 2020.

LOCATION: SW REGION-WILD, 621 NORTH 10TH STREET, PLAINWELL, MI 49080.

CONTACT NAME: Cynthia McQueer

PHONE NUMBER: (269) 767-1022

PROSPECTUS NOTE: The bidder is advised to inspect the sale area and review the location, estimated volumes, operating costs and contract terms of proposed sales. Please be aware that some landowners may request 60 days or more notice for access across their land.

Notice is hereby given that bids will be received by the Game Area Manager, CRANE POND SGA, for certain timber on the following described lands:

Roosevelt (21-001-20) / T06S, R13W, SEC. 10, NESW,S1/2SW,SWSE.

T06S, R13W, SEC. 13, NWSW.

T06S, R13W, SEC. 14, NESE.

T06S, R13W, SEC. 26, SW.

T06S, R13W, SEC. 27, SENE,N1/2SE.

T06S, R13W, SEC. 4, SENE.

Cass County, Advertised Price \$53,040.35, 65.8 Acres, Aspen, Hardwood.

SALE NOTE: 1. Operating restrictions for this sale limit cutting and skidding to 12/01 to 3/01.

2. Access to Payment Unit 5 is through Mann Rd. which is seasonally closed and gated. The Purchaser is responsible for obtaining a permit from the Cass County Road Commission to use the road and is responsible for abiding by permit requirements. Details for obtaining permit are available through the sale administrator.

Access may be through other public land.

TIMBER SALE INFORMATION

Roosevelt (21-001-20)

T06S, R13W, SEC. 10; T06S, R13W, SEC. 13; T06S, R13W, SEC. 14; T06S, R13W, SEC. 26; T06S, R13W, SEC. 27; T06S, R13W, SEC. 4.

SALE NOTE: 1. Operating restrictions for this sale limit cutting and skidding to 12/01 to 3/01.

2. Access to Payment Unit 5 is through Mann Rd. which is seasonally closed and gated. The Purchaser is responsible for obtaining a permit from the Cass County Road Commission to use the road and is responsible for abiding by permit requirements. Details for obtaining permit are available through the sale administrator.

Access may be through other public land.

A timber sale contract for this lump sum, sealed bid timber sale will be awarded to the responsible bidder offering the highest sealed bid price. All units of volume listed below were estimated using the T-Sale computer program and our traditional volume equations. Bids must be at or above the following advertised price for each product and species:

<u>PRODUCTS & SPECIES</u>	<u>ESTIMATED UNITS*</u>	<u>ADVERTISED PRICE</u>
Sawtimber		
B. T. Aspen	71.4 MBF	\$ 61.00 / MBF
Black Cherry	26.6 MBF	\$ 144.00 / MBF
Misc. Species 1	5.1 MBF	\$ 110.00 / MBF
Misc. Species 2	118.5 MBF	\$ 110.00 / MBF
Red Maple	43.5 MBF	\$ 75.00 / MBF
Red Oak	25.0 MBF	\$ 133.00 / MBF
Sugar Maple	2.9 MBF	\$ 198.00 / MBF
Pulpwood		
B. T. Aspen	493 Cords	\$ 19.15 / Cord
Mixed Hardwood	997 Cords	\$ 14.70 / Cord

* The estimated units are final and not subject to adjustment. Prospective bidders are urged to examine this timber and to make their own estimates of quantity and quality.

BOND AND PAYMENT SCHEDULE:

1. A bond in the amount of \$2,652.02 to insure faithful performance of the conditions of the contract will be deposited by the successful bidder within 21 days of the sale award.
2. Cutting in any sale or unit without the required advance payment would be considered a trespass.
3. Total payment must be paid in advance or according to the following schedule:
 - (a) Ten percent (10%) of the sale value must be paid within 21 days of the sale award.
 - (b) The 10% down payment will be credited towards the first unit cut.
4. If no cutting takes place, the 10% down payment will not be refunded.
5. Operations on the contract issued will terminate on 03/01/2023.

SALE STATISTICS

SALE VOLUMES

VOLUME			STATISTICAL RANGE IN CORDS	
TOTAL CUBIC FEET	TOTAL CORDS	PERCENT ERROR	MINIMUM	MAXIMUM
163,859	2,074	14.89%	1,765	2,383

VDU VOLUMES

A VDU is a Volume Determination Unit. Volumes and their associated statistics are calculated at the VDU level and summarized to the sale level. There is often a one to one relationship between a VDU and a Payment Unit, but not always, depending on the cruise design. Refer to the VDU TO PAYMENT UNIT table.

	VOLUME			RANGE IN CORDS	
VDU	TOTAL CUBIC FEET	TOTAL CORDS	PERCENT ERROR	MINIMUM	MAXIMUM
1	19,537	247	33.34%	165	330
2	24,759	313	27.80%	226	401
3	1,469	19	0.00%	19	19
4	38,402	486	32.81%	327	646
5	66,423	841	26.23%	620	1,061
6	4,203	53	10.65%	48	59
7	3,263	41	0.00%	41	41
8	5,799	73	64.94%	26	121
TOTAL:	163,854	2,074		1,471	2,677

VDU TO PAYMENT UNIT

When a VDU is associated with more than one Payment Unit (PU), the VDU volumes are assigned to the PU based on acres of the VDU within the PU.

VDU	VDU ACRES	PU	PU ACRES
1	8.8	1	8.8
2	12.3	2	12.3
3	3.5	3	3.5
4	11.6	4	11.6
5	21.3	5	21.3
6	1.2	6	1.2
7	5.2	7	5.2
8	1.9	8	1.9
TOTAL:	65.8		65.8

DESCRIPTION OF TIMBER BY PU (PU)

PU	MARKET GROUP	PRODUCT	QUANTITY	UNIT	ACRES	ADVERTISE PRICE
1	B. T. Aspen	Sawtimber	1.2	MBF	8.8	\$5,229.50
	Black Cherry		0.8	MBF		
	Misc. Species 1		2.4	MBF		
	Red Maple		12.0	MBF		
	Red Oak		5.6	MBF		
	B. T. Aspen	Pulpwood	30	Cords		
	Mixed Hardwood		174	Cords		
	<i>Black Cherry</i>		10	<i>Cords</i>		
	<i>Misc. Species 1</i>		23	<i>Cords</i>		
	<i>Red Maple</i>		100	<i>Cords</i>		
	<i>Red Oak</i>		41	<i>Cords</i>		
2	B. T. Aspen	Sawtimber	20.8	MBF	12.3	\$8,032.85
	Black Cherry		4.7	MBF		
	Misc. Species 1		2.7	MBF		
	Misc. Species 2		6.0	MBF		
	Red Maple		5.3	MBF		
	Red Oak		8.0	MBF		
	B. T. Aspen	Pulpwood	101	Cords		
	Mixed Hardwood		118	Cords		
	<i>Black Cherry</i>		27	<i>Cords</i>		
	<i>Misc. Species 1</i>		7	<i>Cords</i>		
	<i>Misc. Species 2</i>		12	<i>Cords</i>		
	<i>Red Maple</i>		42	<i>Cords</i>		
	<i>Red Oak</i>		30	<i>Cords</i>		
3	Red Maple	Sawtimber	3.1	MBF	3.5	\$408.90
	Mixed Hardwood	Pulpwood	12	Cords		
	<i>Red Maple</i>		12	<i>Cords</i>		
4	B. T. Aspen	Sawtimber	15.8	MBF	11.6	\$13,048.05
	Black Cherry		13.7	MBF		
	Misc. Species 2		27.3	MBF		
	Red Maple		10.1	MBF		
	Red Oak		5.1	MBF		
	B. T. Aspen	Pulpwood	145	Cords		
	Mixed Hardwood		197	Cords		
	<i>Black Cherry</i>		47	<i>Cords</i>		
	<i>Misc. Species 2</i>		54	<i>Cords</i>		
	<i>Red Maple</i>		78	<i>Cords</i>		
	<i>Red Oak</i>		18	<i>Cords</i>		
5	B. T. Aspen	Sawtimber	32.6	MBF	21.3	\$22,042.05
	Black Cherry		3.9	MBF		
	Misc. Species 2		74.7	MBF		
	Red Maple		10.8	MBF		
	Red Oak		6.3	MBF		
	Sugar Maple		1.0	MBF		
	B. T. Aspen	Pulpwood	193	Cords		
	Mixed Hardwood		390	Cords		
	<i>Black Cherry</i>		27	<i>Cords</i>		
	<i>Misc. Species 2</i>		73	<i>Cords</i>		
	<i>Red Maple</i>		208	<i>Cords</i>		
	<i>Red Oak</i>		43	<i>Cords</i>		
	<i>Sugar Maple</i>		39	<i>Cords</i>		
6	B. T. Aspen	Sawtimber	1.0	MBF	1.2	\$1,156.60
	Misc. Species 2		2.7	MBF		
	Red Maple		0.6	MBF		
	B. T. Aspen	Pulpwood	24	Cords		

DESCRIPTION OF TIMBER BY PU (PU), CON'T

PU	MARKET GROUP	PRODUCT	QUANTITY	UNIT	ACRES	ADVERTISE PRICE
6 con't	Mixed Hardwood	Pulpwood	20	Cords		
	Black Cherry		4	Cords		
	Black Walnut		9	Cords		
	Misc. Species 2		2	Cords		
	Red Maple		5	Cords		
7	Black Cherry	Sawtimber	2.5	MBF	5.2	\$1,363.10
	Misc. Species 2		1.0	MBF		
	Red Maple		1.6	MBF		
	Sugar Maple		1.9	MBF		
	Mixed Hardwood	Pulpwood	27	Cords		
	Black Cherry		12	Cords		
	Misc. Species 2		2	Cords		
	Red Maple		5	Cords		
	Sugar Maple		8	Cords		
8	Black Cherry	Sawtimber	1.0	MBF	1.9	\$1,759.30
	Misc. Species 2		6.8	MBF		
	Mixed Hardwood	Pulpwood	59	Cords		
	Black Cherry		27	Cords		
	Misc. Species 2		27	Cords		
	Red Oak		5	Cords		
TOTAL:			293.0	MBF		
TOTAL:			1,490	Cords		

Sale Specific Conditions & Requirements

Sale Name: Roosevelt

Sale Number: 21-001-20 Seq#: 1

1 - Sale Area

1.2 - Boundaries

1.2.1 - Painted boundaries (9/19)

The sale boundary and Payment Unit boundaries are marked and identified by blue, red and yellow paint. Exterior sale boundary lines against private property are marked with blue paint. Exterior sale boundary lines against state are marked with red paint. Interior Payment Unit boundaries are marked with yellow paint. The painted boundary line trees are not Included Timber and are to be protected unless marked with orange paint. Yellow painted trees designating an interior Payment Unit boundary are only to be cut when all surrounding Payment Units have been paid.

2 - Timber Specifications

2.1 - Included Timber

2.1.1 - Clearcut unit(s) with unmerchantable trees (6/14)

Within Payment Unit(s) 1, 2, 4, 5, 6, and 8, cut all trees that are two (2) inches or more at DBH, except do not cut trees marked in green paint above and below stump height.

2.1.3 - Cut tree marked unit(s) (12/08)

Within Payment Unit(s) 3 and 7, all trees are designated for cutting when marked with orange paint above and below stump height, regardless of merchantability.

2.1.11 - Description of timber note (2/04)

Note that Misc. Species 1 = Hickory and Misc. Species 2 = Tulip Poplar.

2.2 - Utilization

2.2.1 - Utilization (2/04)

All listed board foot volumes of sawlog size products in this contract have been determined using a top diameter inside bark of 10 inches.

2.3 - Log Rule

2.3.1 - Log rule (12/08)

All board foot volumes of sawlog size products in this contract have been determined by the International ¼ Inch Log Rule.

4 - Transportation

4.1 - Construction

4.1.12 - No new roads (1/12)

No new roads will be permitted in any Payment Unit. All operations are limited to existing roads. Skid trails only will be allowed.

4.2 - Maintenance

4.2.1 - Hauling restriction (12/08)

Hauling may be restricted on forest roads by the Unit Manager or his/her representative. The restriction may occur during spring breakup.

4.2.2 - Fill material (4/07)

To maintain roads, fill material may be needed in areas where "holes" exist or may be expected to develop. This fill material should be placed before trucking begins. Contact the sale administrator regarding the availability of onsite sand or gravel from adjacent State-owned lands.

4.4 - Access

4.4.3 - Access gate (12/08)

The access gate must be locked at the completion of each day unless otherwise approved by the Unit Manager or his/her representative.

4.4.4 - Restricted access (10/05)

Access to Payment Unit 5 is through Mann Rd. which is seasonally closed and gated. The Purchaser is responsible for obtaining a permit from the Cass County Road Commission to use the road and is responsible for abiding by permit requirements. Details for obtaining permit are available through the sale administrator.

5 - Operations

5.1 - Notification

5.1.1 - Pre-sale conference (10/16)

A pre-sale conference on site between the Purchaser and sale administrator is required prior to beginning any operations to determine landing and road locations. The Sale Administrator must be contacted at least 10 days in advance to schedule the conference.

5.1.4 - Post-sale conference (10/16)

A post-sale conference on site between the Purchaser and sale administrator is required 5 days prior to the completion of active logging operations to determine clean-up and repair of landings, road edges, and the fulfillment of other contract specifications.

5.2 - Conduct of Operations

5.2.1 - Slash

5.2.1.10 - No slash in openings (5/10)

No brush or logging debris is to be left in the maintained wildlife opening which is indicated by G0 on the Timber Sale Map. Any damage to the opening shall be repaired according to specifications of the Unit Manager or his/her representative.

5.2.1.13 - Dispose of slash as directed (12/05)

Slash is to be disposed of as directed by the Sale Administrator.

5.2.2 - Hazard Trees/Snags

5.2.2.1 - Den trees (10/16)

Obvious hollow and/or den trees shall be protected and left standing unless they are a safety hazard.

5.2.3 - Operating Restrictions

5.2.3.1 - Operating restrictions (9/11)

Within Payment Unit(s) 1-8, unless changed by written agreement, cutting and skidding are limited to the period of December 1 to March 1. This restriction is to facilitate aspen regeneration and to protect eastern massasauga rattlesnakes.

5.2.4 - Dead and Down Creation

5.2.4.4 - Dead and down creation, grouse (6/18)

To encourage grouse and other wildlife, in Payment Unit(s) 1, 2, 4, 5, 6, and 8, leave one, 12" diameter or larger log-length (8 foot minimum) piece on the ground for every 2 acres. These will be evenly scattered throughout the unit. These trees will be evenly scattered throughout the unit, preferably at least two chains from any roads, two-tracks, or trails open to vehicles. This can be an unmerchantable piece or a full tree. Each log must be clearly identified by a piece of blue flagging.

5.2.32 - Decking/landing restoration (9/13)

All decking and landing areas must have the surface area restored to a condition equal to or better than before. This is to ensure the proper regeneration of the stand. Wood debris, chips and "cookies" from trimmings must be removed or scattered away from landing and loading areas and may not be windrowed on the edge.

5.4 - Soil Protection

5.4.1 - Rutting restriction, general (7/16)

Operations are to cease immediately if equipment and weather conditions result in rutting of roads and/or skid trails which is 12 inches or greater in depth and 50 feet in length. The Unit Manager or his/her representative may restrict hauling and/or skidding if ruts exceed the specified depth. With the Unit Manager or his/her representative's approval, the Purchaser may return to the area when the risk of rutting has decreased.

5.4.2 - Skid trails (2/04)

Skid trails up and down slopes should be avoided. If however this is unavoidable, these trails will be left in a non-erodible condition using water bars, logs, and slash. Placing of slash on these skid trails while logging is ongoing may alleviate need for any further action. At the direction of the sale administrator, seed, fertilizer, and mulch may also be required.

5.4.3 - Erosion control (12/08)

Skid trails or haul roads may require erosion control structures or berms per direction of the Unit Manager or his/her representative.

5.4.4 - Slope protection (9/19)

Skid trails and roads on slopes shall be water barred with slash, stumps, and/or clean straw bales native to the area as soon as use is complete to prevent erosion.

5.4.6 - Wet area protection (5/10)

No harvesting operations, including skidding and felling, are to take place within the vernal pond areas or drainages. When harvesting occurs, there should be no disturbance to the vernal pond depression. All equipment, trees and tops should be kept out of this area. Within 100 feet of the pond, equipment should only be used when the soil is in a dry or frozen condition. Care must be taken by the Purchaser to identify and avoid operating in these areas of the timber sale.

5.6 - Debris and Waste Material

5.6.3 - Equipment cleaning (12/17)

For purposes of this provision, "Off-Road Equipment" includes all logging and construction machinery, except for log trucks, chip vans, service vehicles, water trucks, pickup trucks, cars, and similar vehicles. Off-Road Equipment brought on site must be clean and free from plant material and soil prior to arrival on any Payment Unit. Off-Road Equipment shall be cleaned of plant material and dirt prior to being moved to a new stand within the sale. Plant material includes leaves, stems, roots and seeds. Equipment shall be considered clean when a visual inspection does not disclose seeds, soil, vegetative matter, and other debris that could contain or hold seeds. This is to prevent the spread of invasive plant species.

6 - Safety and Fire Prevention

6.2 - Signing

6.2.1 - Road posting (9/09)

The Purchaser is responsible for posting and maintaining caution signs on M-40 and Rumsey St. prior to beginning operations. The road must be posted at appropriate distances from the sale area to warn of logging activity and truck traffic. Signs must be removed when harvest operations are suspended or completed. The Purchaser will provide these signs.

7 - Other Conditions

7.10 - Certified Timber

7.10.1 - Non-certified timber (2/16)

The area encompassed by this timber sale is not certified to the standards of the Forest Stewardship Council (FSC) or the Sustainable Forestry Initiative (SFI). Forest products from this sale may not be delivered to the mill as "FSC and / or SFI certified". The lands within this sale are managed as a State Game Area.

**TIMBER SALE MAP**

This information provided by authority of Part 525, 1994 PA 451 as amended.

Sale Number	21 -001	Year	20
Date	09/25/2020	Page	1
		of	1

Forest Management Unit	County	Mapped By	Nate DeVries
Crane Pond Field Office	Cass	Cruised By	Jesse Bramer
Township	Range	Section(s) and Subdivision(s)	Scale
06S	13W	Sections 4, 10, 13, 26, 27	1:60,000

Cover Type

A = Aspen	H = Hemlock	N = Marsh	U = Upland Brush
B = Paper Birch	J = Jack Pine	O = Oak	UM = Upland Mixed
C = Cedar	L = Lowland Brush	P = Lowland Poplar	V = Bog or Marsh
D = Treed Bog	LM = Lowland Mixed	Q = Mixed Swamp Conifer	W = White Pine
E = Swamp Hardwoods	M = Mpl. Ech. Birch	R = Red Pine	X = Non Stocked
F = Spruce Fir	MC = Mixed Conifer	S = Black Spruce	Z = Water
G = Cress	MD = Mixed Deciduous	T = Tamarack	

Density

0 = Non Stocked	5 = Pole Timber Medium
1 = Seedling Sapling Poor	6 = Pole Timber Well
2 = Seedling Sapling Medium	7 = Saw Timber Poor
3 = Seedling Sapling Well	8 = Saw Timber Medium
4 = Pole Timber Poor	9 = Saw Timber Well

PU	Acres	PU	Acres
1	8.8	5	21.3
2	12.3	6	1.2
3	3.5	7	5.2
4	11.6	8	1.9

Roosevelt

Compartment 8140202

65.9 Acres

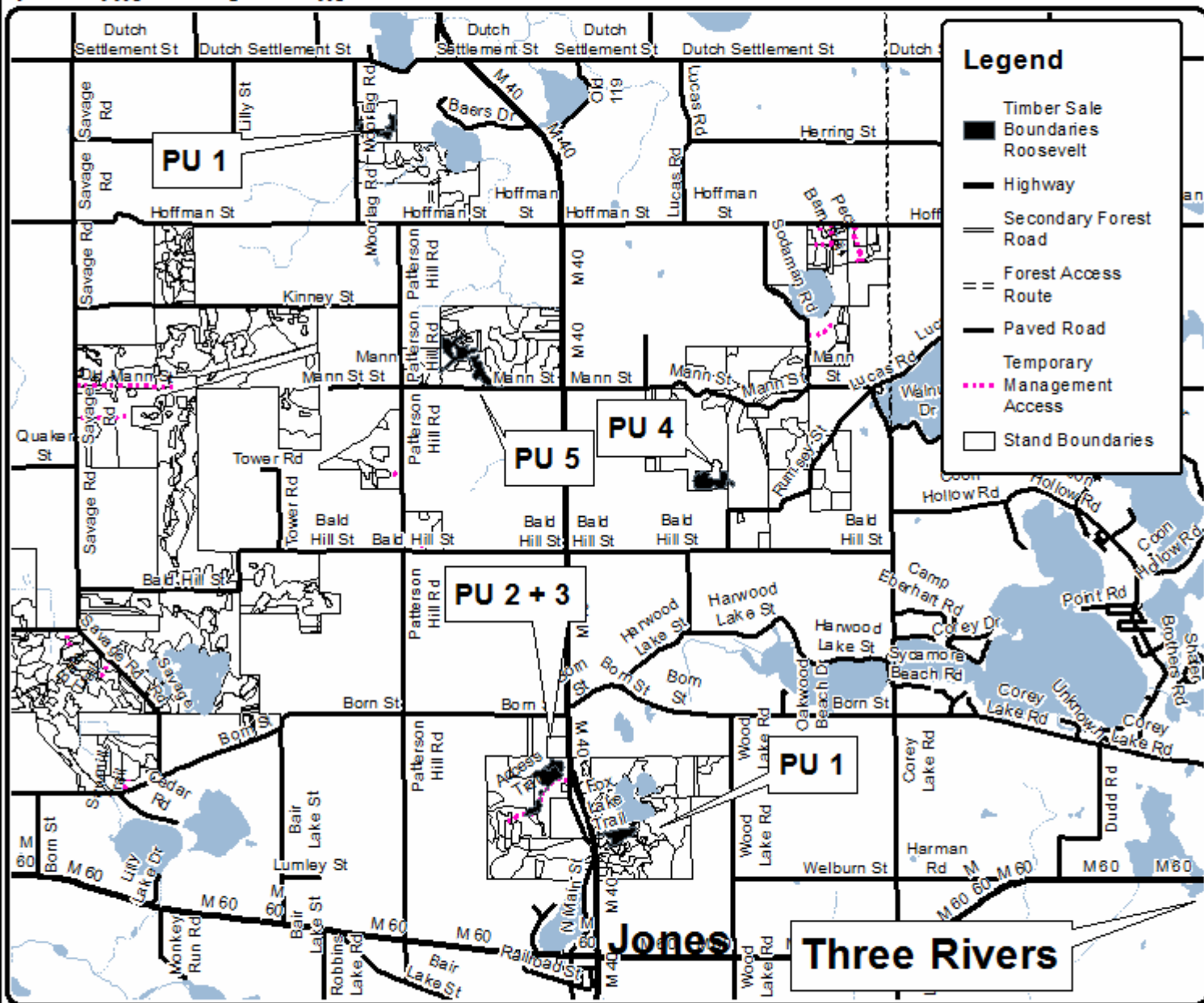
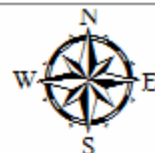

0 0.25 0.5 0.75 1 Miles

**TIMBER SALE MAP**

This information provided by authority of Part 525, 1994 PA 451, as amended.

Sale Number	Year
21 - 001	20

Date	Page	of
09/24/2020	1	1

Forest Management Unit Crane Pond Field Office	County Cass	Mapped By Nate DeVries	Cruised By Jesse Bramer
Township 06S	Range 13W	Section(s) and Subdivision(s) Sections 26, 27	Scale 1:10,000

Cover Type				Density	
A = Aspen	H = Hemlock	N = Marsh	U = Upland Brush	0 = Non Stocked	5 = Pole Timber Medium
B = Paper Birch	J = Jack Pine	O = Oak	UM = Upland Mixed	1 = Seedling Sapling Poor	6 = Pole Timber Well
C = Cedar	L = Lowland Brush	P = Lowland Poplar	V = Bog or Marsh	2 = Seedling Sapling Medium	7 = Saw Timber Poor
D = Treed Bog	LM = Lowland Mixed	Q = Mixed Swamp Conifer	W = White Pine	3 = Seedling Sapling Well	8 = Saw Timber Medium
E = Swamp Hardwoods	M = Mpl. Ech. Birch	R = Red Pine	X = Non Stocked	4 = Pole Timber Poor	9 = Saw Timber Well
F = Spruce Fir	MC = Mixed Conifer	S = Black Spruce	Z = Water		
G = Cress	MD = Mixed Deciduous	T = Tamarack			

Roosevelt

Compartment 8140202

65.9 Acres

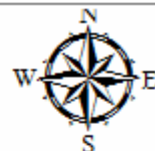
**Legend**

- Timber Sale Boundaries Roosevelt
- Skid Trails Roosevelt
- Landings Roosevelt
- Highway
- Primary Forest Road
- Secondary Forest Road
- Forest Access Route
- Paved Road
- Gravel Road
- County Road - Seasonal
- Private
- Stand Boundaries
- Section Corners
- Temporary Management Access
- Gates and Berms
- Type
- Gate

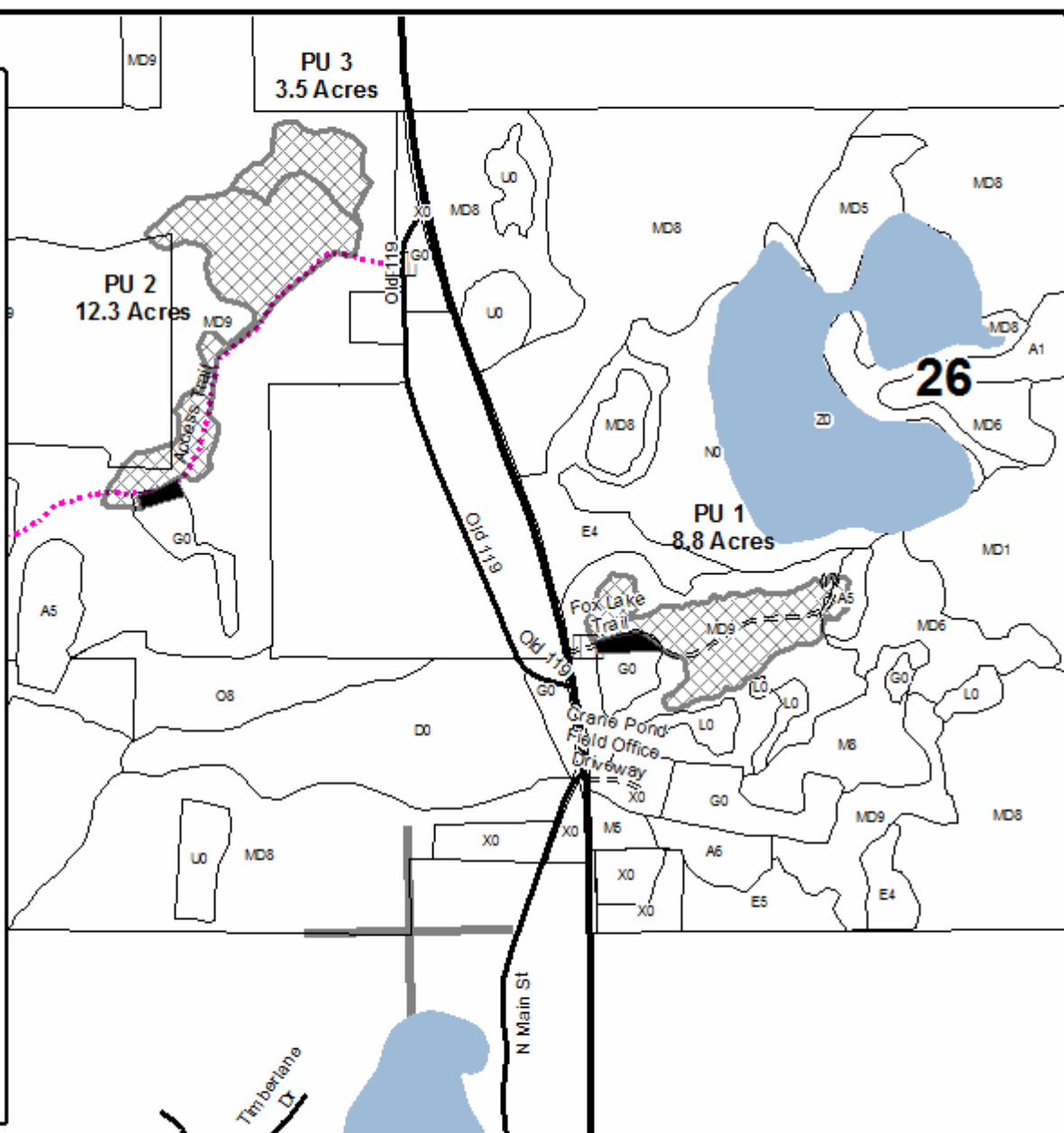

TIMBER SALE MAP

This information provided by authority of Part 525, 1994 PA 451, as amended.

Forest Management Unit Crane Pond Field Office		County Cass	Mapped By Nate DeVries	Date 09/24/2020	Page 1	of 1
Township 06S	Range 13W	Section(s) and Subdivision(s) Sections 13, 14		Scale 1:10,000		

Cover Type				Density	
A = Aspen	H = Hemlock	N = Marsh	U = Upland Brush	0 = Non Stocked	5 = Pole Timber Medium
B = Paper Birch	J = Jack Pine	O = Oak	UM = Upland Mixed	1 = Seeding Sapling Poor	6 = Pole Timber Well
C = Cedar	L = Lowland Brush	P = Lowland Poplar	V = Bog or Marsh	2 = Seeding Sapling Medium	7 = Saw Timber Poor
D = Tread Bog	LM = Lowland Mixed	Q = Mixed Swamp Conifer	W = White Pine	3 = Seeding Sapling Well	8 = Saw Timber Medium
E = Swamp Hardwoods	M = Mpl. Ech. Birch	R = Red Pine	X = Non Stocked	4 = Pole Timber Poor	9 = Saw Timber Well
F = Spruce Fir	MC = Mixed Conifer	S = Black Spruce	Z = Water		
G = Grass	MD = Mixed Deciduous	T = Tamarack			

PU	Acres
1	10
2	20
3	30
4	40
5	50
6	60
7	70
8	80
9	90
10	100
11	110
12	120
13	130
14	140
15	150
16	160
17	170
18	180
19	190
20	200
21	210
22	220
23	230
24	240
25	250
26	260
27	270
28	280
29	290
30	300
31	310
32	320
33	330
34	340
35	350
36	360
37	370
38	380
39	390
40	400
41	410
42	420
43	430
44	440
45	450
46	460
47	470
48	480
49	490
50	500
51	510
52	520
53	530
54	540
55	550
56	560
57	570
58	580
59	590
60	600
61	610
62	620
63	630
64	640
65	650
66	660
67	670
68	680
69	690
70	700
71	710
72	720
73	730
74	740
75	750
76	760
77	770
78	780
79	790
80	800
81	810
82	820
83	830
84	840
85	850
86	860
87	870
88	880
89	890
90	900
91	910
92	920
93	930
94	940
95	950
96	960
97	970
98	980
99	990
100	1000

4	11.6
---	------

Timber Sale Name

Compartment 8140202

65.9 Acres

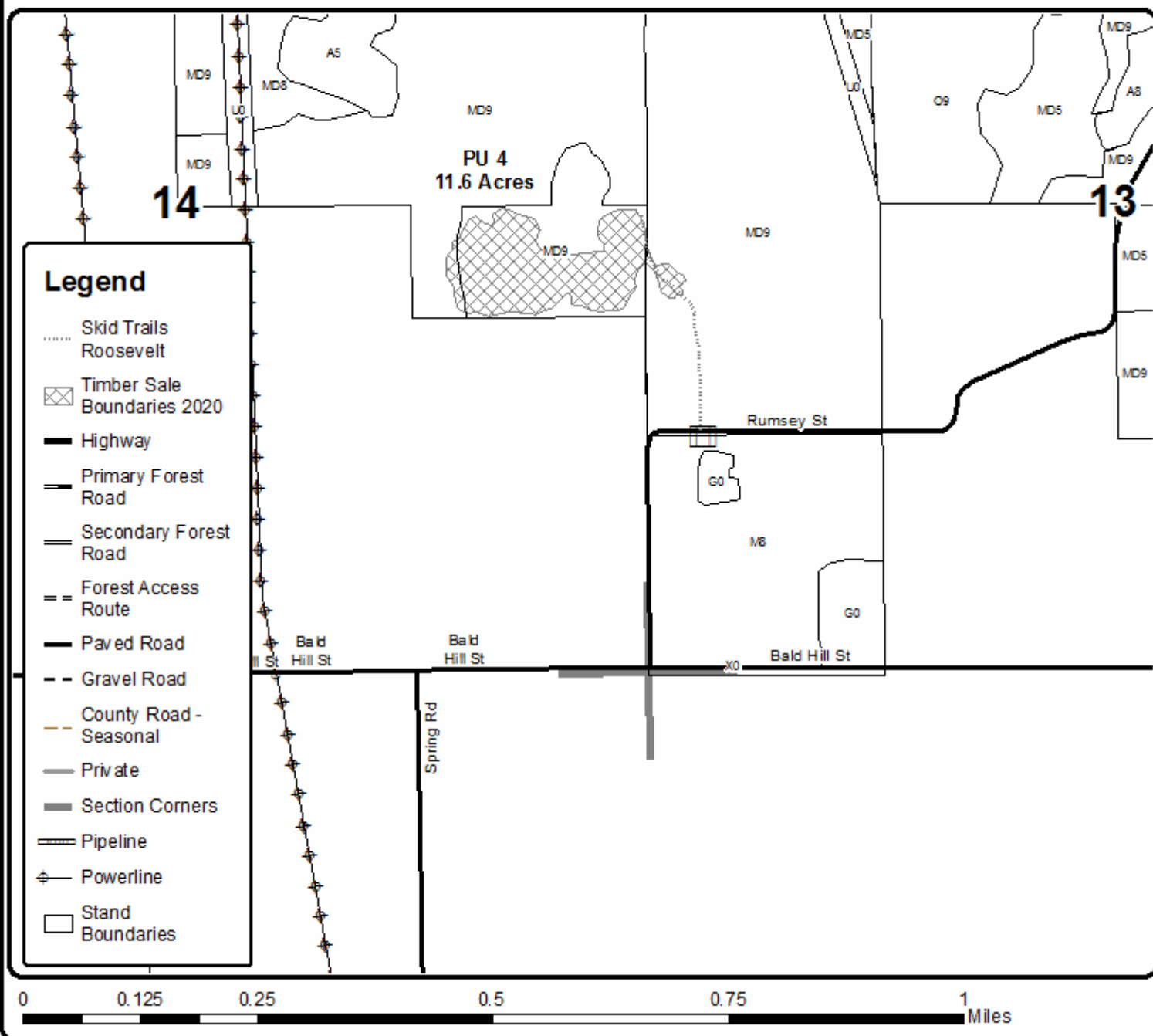
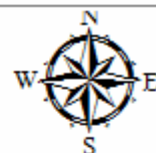

**TIMBER SALE MAP**

This information provided by authority of Part 525, 1994 PA 451, as amended.

Sale Number	Year
21 - 001	20

Date	Page	of
09/24/2020	1	1

Forest Management Unit Crane Pond Field Office	County Cass	Mapped By Nate DeVries	Cruised By Jesse Bramer
Township 06S	Range 13W	Section(s) and Subdivision(s) Sections 10	Scale 1:10,000

Cover Type				Density	
A = Aspen	H = Hemlock	N = Marsh	U = Upland Brush	0 = Non Stocked	5 = Pole Timber Medium
B = Paper Birch	J = Jack Pine	O = Oak	UM = Upland Mixed	1 = Seedling Sapling Poor	6 = Pole Timber Well
C = Cedar	L = Lowland Brush	P = Lowland Poplar	V = Bog or Marsh	2 = Seedling Sapling Medium	7 = Saw Timber Poor
D = Tread Bog	LM = Lowland Mixed	Q = Mixed Swamp Conifer	W = White Pine	3 = Seedling Sapling Well	8 = Saw Timber Medium
E = Swamp Hardwoods	M = Mpl. Ech. Birch	R = Red Pine	X = Non Stocked	4 = Pole Timber Poor	9 = Saw Timber Well
F = Spruce Fir	MC = Mixed Conifer	S = Black Spruce	Z = Water		
G = Cress	MD = Mixed Deciduous	T = Tamarack			

Roosevelt

Compartment 8140202

65.9 Acres

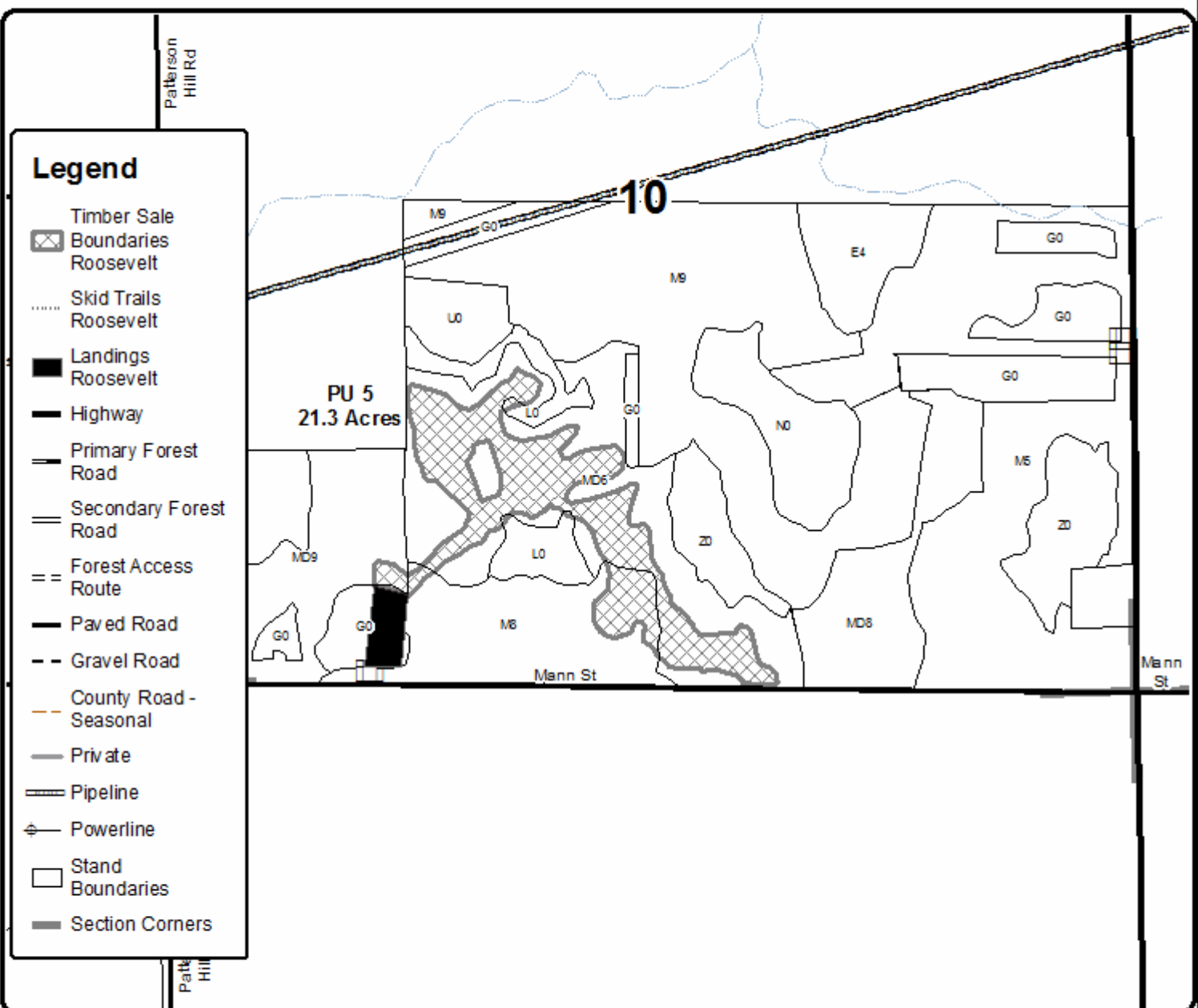

**TIMBER SALE MAP**

This information provided by authority of Part 525, 1994 PA 451, as amended.

Sale Number	21 - 001	Year	20
Date	09/24/2020	Page	1
		of	1

Forest Management Unit
Crane Pond Field OfficeCounty
CassMapped By Nate DeVries
Cruised By Jesse BramerTownship
06SRange
13WSection(s) and Subdivision(s)
Sections 10Scale
1:10,000**Cover Type**

A = Aspen
B = Paper Birch
C = Cedar
D = Tread Bog
E = Swamp Hardwoods
F = Spruce Fir
G = Cress

H = Hemlock
J = Jack Pine
L = Lowland Brush
LM = Lowland Mixed
M = Mpl. Ech. Birch
MC = Mixed Conifer
MD = Mixed Deciduous

N = Marsh
O = Oak
P = Lowland Poplar
Q = Mixed Swamp Conifer
R = Red Pine
S = Black Spruce
T = Tamarack

U = Upland Brush
UM = Upland Mixed
V = Bog or Marsh
W = White Pine
X = Non Stocked
Z = Water

Density

0 = Non Stocked
1 = Seedling Sapling Poor
2 = Seedling Sapling Medium
3 = Seedling Sapling Well
4 = Pole Timber Poor
5 = Pole Timber Medium
6 = Pole Timber Well
7 = Saw Timber Poor
8 = Saw Timber Medium
9 = Saw Timber Well

Roosevelt

Compartment 8140202

65.9 Acres

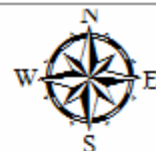
**Legend**

- Timber Sale
- Boundaries Roosevelt
- Skid Trails Roosevelt
- Highway
- Primary Forest Road
- Secondary Forest Road
- Forest Access Route
- Paved Road
- Gravel Road
- County Road - Seasonal
- Private
- Pipeline
- Powerline
- Stand Boundaries
- Section Corners

04PU 6
1.2 AcresPU 7
5.2 AcresPU 8
1.9 Acres

PU 7

0 0.125 0.25 0.5 0.75 1 Miles