



**DEPARTMENT OF NATURAL RESOURCES
STATE OF MICHIGAN**

TIMBER SALE PROSPECTUS #6858

REVISION NOTICE #1 - April 7, 2021

SCHEDULED SALE DATE AND TIME: **9:00 a.m. (local time) on Friday, April 9, 2021**

LOCATION: **GRAYLING MGMT UNIT, 1955 HARTWICK PINES ROAD, GRAYLING, MI 49738**

This prospectus has been modified with the following changes.

Arrowhead JP & Spruce (72-627-20) has been withdrawn from this prospectus.

We apologize for any inconvenience this may have caused. If you need assistance, please contact Thomas Barnes at 989-348-6371 ext. 7440.



**DEPARTMENT OF NATURAL RESOURCES
STATE OF MICHIGAN**

TIMBER SALE PROSPECTUS #6858

SCHEDULED SALE DATE AND TIME: **9:00 a.m. (local time) on April 9, 2021.**

LOCATION: **GRAYLING MGMT UNIT, 1955 HARTWICK PINES ROAD, GRAYLING, MI 49738.**

CONTACT NAME: Thomas Barnes

PHONE NUMBER: (989) 348-6371

PROSPECTUS NOTE: The bidder is advised to inspect the sale area and review the location, estimated volumes, operating costs and contract terms of proposed sales. Please be aware that some landowners may request 60 days or more notice for access across their land.

Notice is hereby given that bids will be received by the Unit Manager, GRAYLING MANAGEMENT UNIT, for certain timber on the following described lands:

MPRC Fuelbreak (72-624-20) / T27N, R03W, SEC. 13, NENE,S1/2NE,SESW,W1/2SE.

T27N, R03W, SEC. 23, SENE,SESW,W1/2SE.

T27N, R03W, SEC. 24, N1/2NW,SWNW.

Crawford County, Advertised Price \$23,363.85, 52.3 Acres, Hardwood, Red Oak.

SALE NOTE: The purpose of this harvest is to facilitate fuelbreak construction within Range 30.

Access will be limited and there is the potential to encounter unexploded ordinance.

TIMBER SALE INFORMATION

MPRC Fuelbreak (72-624-20)

T27N, R03W, SEC. 13; T27N, R03W, SEC. 23; T27N, R03W, SEC. 24.

Crawford County (Advertised Price \$23,363.85)

SALE NOTE: The purpose of this harvest is to facilitate fuelbreak construction within Range 30. Access will be limited and there is the potential to encounter unexploded ordinance.

A timber sale contract for this lump sum, sealed bid timber sale will be awarded to the responsible bidder offering the highest sealed bid price. All units of volume listed below were estimated using the T-Sale computer program and our traditional volume equations. Bids must be at or above the following advertised price for each product and species:

<u>PRODUCTS & SPECIES</u>	<u>ESTIMATED UNITS*</u>	<u>ADVERTISED PRICE</u>
Sawtimber		
Northern Pin Oak	11.6 MBF	\$ 63.00 / MBF
Red Oak	143.6 MBF	\$ 80.00 / MBF
White Oak	19.4 MBF	\$ 46.00 / MBF
Pulpwood		
Jack Pine	41 Cords	\$ 11.15 / Cord
Misc. Species 1	136 Cords	\$ 4.00 / Cord
Misc. Species 2	12 Cords	\$ 2.00 / Cord
Mixed Aspen	105 Cords	\$ 10.20 / Cord
Mixed Hardwood	162 Cords	\$ 14.85 / Cord
Mixed Oak	378 Cords	\$ 14.90 / Cord
Red Pine	3 Cords	\$ 24.60 / Cord
White Pine	4 Cords	\$ 11.20 / Cord

* The total volume is statistically estimated within plus (+) or minus (-) 16.69 percent. There are an estimated 1,187 cords on this timber sale, plus or minus 198 cords at the 95% confidence level. The estimated units are final and not subject to adjustment. Prospective bidders are urged to examine this timber and to make their own estimates of quantity and quality.

BOND AND PAYMENT SCHEDULE:

1. A bond in the amount of \$1,168.19 to insure faithful performance of the conditions of the contract will be deposited by the successful bidder within 21 days of the sale award.
 2. Cutting in any sale or unit without the required advance payment would be considered a trespass.
 3. Total payment must be paid in advance or according to the following schedule :
 - (a) Ten percent (10%) of the sale value must be paid within 21 days of the sale award.
 - (b) The 10% down payment will be credited towards the first unit cut.
 - (c) Payment for each of the following units must be made before cutting begins in that unit:
- | PAYMENT UNIT NUMBER | PERCENT OF TOTAL SALE VALUE |
|---------------------|-----------------------------|
| 01 | 28.7% |
| 02 | 71.3% |
4. If no cutting takes place, the 10% down payment will not be refunded.
 5. Operations on the contract issued will terminate on 06/30/2023.

SALE STATISTICS

SALE VOLUMES

VOLUME		STATISTICAL RANGE IN CORDS		
TOTAL CUBIC FEET	TOTAL CORDS	PERCENT ERROR	MINIMUM	MAXIMUM
93,751	1,187	16.69%	989	1,385

VDU VOLUMES

A VDU is a Volume Determination Unit. Volumes and their associated statistics are calculated at the VDU level and summarized to the sale level. There is often a one to one relationship between a VDU and a Payment Unit, but not always, depending on the cruise design. Refer to the VDU TO PAYMENT UNIT table.

	VOLUME			RANGE IN CORDS	
VDU	TOTAL CUBIC FEET	TOTAL CORDS	PERCENT ERROR	MINIMUM	MAXIMUM
3	8,840	112	35.99%	72	152
4	3,073	39	83.40%	6	71
18	6,794	86	49.12%	44	128
19	2,125	27	89.45%	3	51
20	11,194	142	39.46%	86	198
48	4,195	53	63.34%	19	87
53	20,817	264	38.04%	163	364
153	36,703	465	24.09%	353	577
TOTAL:	93,741	1,187		746	1,627

VDU TO PAYMENT UNIT

When a VDU is associated with more than one Payment Unit (PU), the VDU volumes are assigned to the PU based on acres of the VDU within the PU.

VDU	VDU ACRES	PU	PU ACRES
3	8.2	1	8.2
4	3.6	1	3.6
18	6.0	1	6.0
19	3.1	1	3.1
20	7.9	1	7.9
48	3.2	2	3.2
53	10.5	2	10.5
153	9.8	2	9.8
TOTAL:	52.3		52.3

DESCRIPTION OF TIMBER BY PU (PU)

PU	MARKET GROUP	PRODUCT	QUANTITY	UNIT	ACRES	ADVERTISE PRICE
1	Northern Pin Oak	Sawtimber	8.0	MBF	28.8	\$6,711.30
	Red Oak		20.5	MBF		
	White Oak		6.9	MBF		
	Jack Pine	Pulpwood	33	Cords		
	<i>Jack Pine</i>	<i>Sawtimber</i>	3.4	<i>MBF</i>		
	<i>Jack Pine</i>	<i>Pulpwood</i>	26	<i>Cords</i>		
	Misc. Species 1		20	Cords		
	Misc. Species 2		8	Cords		
	Mixed Aspen		69	Cords		
	<i>B. T. Aspen</i>	<i>Sawtimber</i>	3.1	<i>MBF</i>		
	<i>B. T. Aspen</i>	<i>Pulpwood</i>	63	<i>Cords</i>		
	Mixed Hardwood		31	Cords		
	<i>Red Maple</i>	<i>Sawtimber</i>	0.4	<i>MBF</i>		
	<i>Red Maple</i>	<i>Pulpwood</i>	30	<i>Cords</i>		
	Mixed Oak		168	Cords		
	<i>Northern Pin Oak</i>		76	<i>Cords</i>		
	<i>Red Oak</i>		42	<i>Cords</i>		
	<i>White Oak</i>		50	<i>Cords</i>		
	Red Pine		3	Cords		
	<i>Red Pine</i>	<i>Sawtimber</i>	1.0	<i>MBF</i>		
	<i>Red Pine</i>	<i>Pulpwood</i>	1	<i>Cords</i>		
	White Pine		4	Cords		
2	Northern Pin Oak	Sawtimber	3.6	MBF	23.5	\$16,637.70
	Red Oak		123.1	MBF		
	White Oak		12.5	MBF		
	Jack Pine	Pulpwood	8	Cords		
	<i>Jack Pine</i>	<i>Sawtimber</i>	1.5	<i>MBF</i>		
	<i>Jack Pine</i>	<i>Pulpwood</i>	5	<i>Cords</i>		
	Misc. Species 1		116	Cords		
	Misc. Species 2		4	Cords		
	Mixed Aspen		36	Cords		
	<i>B. T. Aspen</i>	<i>Sawtimber</i>	3.3	<i>MBF</i>		
	<i>B. T. Aspen</i>	<i>Pulpwood</i>	29	<i>Cords</i>		
	Mixed Hardwood		130	Cords		
	<i>Red Maple</i>	<i>Sawtimber</i>	1.6	<i>MBF</i>		
	<i>Red Maple</i>	<i>Pulpwood</i>	127	<i>Cords</i>		
	Mixed Oak		210	Cords		
	<i>Northern Pin Oak</i>		14	<i>Cords</i>		
	<i>Red Oak</i>		155	<i>Cords</i>		
	<i>White Oak</i>		41	<i>Cords</i>		
TOTAL:			174.6	MBF		
TOTAL:			840	Cords		

Sale Specific Conditions & Requirements

Sale Name: MPRC Fuelbreak

Sale Number: 72-624-20 Seq#: 2

1 - Sale Area

1.2 - Boundaries

1.2.1 - Painted boundaries (9/19)

The sale boundary and Payment Unit boundaries are marked and identified by red paint in addition to unpainted boundaries. Exterior sale boundary lines against state are marked with red paint in addition to an unpainted boundary designated as the Range fence. The interior Payment Unit boundary is unpainted and designated as the mapped road shown on the Timber Sale Map. The painted boundary line trees are not Included Timber and are to be protected.

2 - Timber Specifications

2.1 - Included Timber

2.1.1 - Clearcut unit(s) with unmerchantable trees (6/14)

Within Payment Unit(s) 1 & 2, cut all trees that are one (1) inch or more at DBH.

2.1.11 - Description of timber note (2/04)

Note that Misc Species 1 is dead oak & red maple. Misc Species 2 is dead pine

2.2 - Utilization

2.2.2 - Chipping required (2/18)

This area must be chip harvested to meet National Guard requirements. The Purchaser has the option to produce sawlogs or pulpwood bolts, but the remaining portion of the trees must be chipped and hauled. The requirement to retain approximately 1/6 to 1/3 of tree tops and limbs less than four inches in diameter does not apply (G. C. & R. 2.2) because the sale is on lands used for Military training.

2.2.3 - Stump heights (4/07)

Stump heights within the Sale Area shall not exceed 6 inches for all trees. This is to facilitate military requirements.

3 - Payments

3.3 - Pre-measured Sales

3.3.4 - Dividing payment units (7/14)

Payment Unit(s) may be divided at the request of the Purchaser and upon approval of the Unit Manager. Dividing Payment Units is a contract modification which requires a Timber Sale Contract Amendment.

4 - Transportation

4.1 - Construction

4.1.3 - Slash and earthen piles (8/04)

Piles or windrows of earth along roads and landings that have been widened or constructed shall be leveled. Slash from road maintenance or construction, including stumps, shall be chipped or used to close temporary roads.

4.1.6 - Road construction (1/09)

Construction of new roads or improvements of existing roads shall be done in such a way as to minimize the environmental and visual impacts. Merchantable trees shall be cut and utilized unless otherwise directed. Non-merchantable trees shall be severed and laid flat on the ground. Slash shall be chipped or utilized. Stumps shall be set upright, not left on edge, and be moved at least 10 feet away from the road edge. Disturbed soil shall be feathered into the woods and not left in berms or windrows.

4.1.7 - Road closure (10/11)

All new roads built into the sale must be blocked to vehicle traffic upon completion of the sale, unless otherwise directed by

the Military. Overgrown roads that are reopened shall be considered new roads. In general, this closure will require constructing a four (4') foot high berm of stumps and logs covered with earth.

4.1.11 - Permits (2/12)

The Purchaser will secure any necessary highway and county road permits that may be required.

4.4 - Access

4.4.3 - Access gate (12/08)

The Range access gate must be locked at all times unless otherwise directed by the Military.

5 - Operations

5.1 - Notification

5.1.1 - Pre-sale conference (10/16)

A pre-sale conference on site between the Purchaser and sale administrator is required prior to beginning any operations to determine landing and road locations. The Unit Manager or his/her representative must be contacted at least 5 days in advance to schedule the conference.

5.1.4 - Post-sale conference (10/16)

A post-sale conference on site between the Purchaser and sale administrator is required 5 days prior to the completion of active logging operations to determine clean-up and repair of landings, road edges, and the fulfillment of other contract specifications.

5.1.5 - National Guard notification (2/15)

This sale is upon lands utilized for training by the Michigan National Guard - Camp Grayling. A minimum of five (5) business days prior to opening this sale, the producer must request that the sale administrator contact the military for information regarding training plans that may impact sale operations.

5.2 - Conduct of Operations

5.2.3 - Operating Restrictions

5.2.3.5 - Oak wilt restriction (1/18)

Within Payment Units 1 & 2, unless changed by written agreement, cutting, skidding, hauling within the sale and brushing of access roads to the sale are not permitted during the period of April 15 to July 15. Operations may be allowed if specific steps are taken to prevent damaging uncut oak during the high risk period. Those steps may include completing all road brushing before April 15th and clearing a tree-length buffer along uncut oak cover before April 15th. This is necessary to reduce the spread of oak wilt. For more information, contact the Unit Manager or his/her representative.

5.2.3.7 - National Guard training restriction (1/09)

Operations on this contract will not be allowed during National Guard training operations. Typically, the restricted period is from May 1 to October 31. The contractor must check with the Unit Manager who will coordinate the cutting schedule with the Military. All harvest equipment and timber products must be removed from the Sale Area during the period of May 1 to October 31.

5.2.38 - No decking against live trees (2/04)

Cut products may not be decked against unmarked or designated leave trees.

5.4 - Soil Protection

5.4.1 - Rutting restriction, general (7/16)

Operations are to cease immediately if equipment and weather conditions result in rutting of roads and/or skid trails which is 12 inches or greater in depth and 50 feet in length. The Unit Manager or his/her representative may restrict hauling and/or skidding if ruts exceed the specified depth. With the Unit Manager or his/her representative's approval, the Purchaser may return to the area when the risk of rutting has decreased.

6 - Safety and Fire Prevention

6.2 - Signing

6.2.1 - Road posting (10/20)

The Purchaser is responsible for posting and maintaining caution signs on Aragon Trail prior to beginning operations. The road must be posted at both ends -- only if it will be used for hauling -- to warn of logging activity and truck traffic. Signs must be removed when harvest operations are suspended or completed. The Purchaser will provide these signs.

SKIP

6.4 - Unexploded ordinance (7/15)

Be aware that the sale area could contain UXO (unexploded ordinances). Do not touch, or drive over any metal objects. If any objects are found, please flag the area and notify the Unit Manager or his/her representative, so that they can make arrangements with the Military.

7 - Other Conditions

7.10 - Certified Timber

7.10.1 - Non-certified timber (2/16)

The area encompassed by this timber sale is not certified to the standards of the Forest Stewardship Council (FSC) or the Sustainable Forestry Initiative (SFI). Forest products from this sale may not be delivered to the mill as "FSC and / or SFI certified". The lands within this sale are managed for military training.

**TIMBER SALE MAP***This information provided by authority of Part 525, 1994 PA 451, as amended.*

Forest Management Unit Grayling		County Crawford	Mapped By Charlebois & Mittig	Date 09/30/2020	Page 1	of 1
Township 27N	Range 3W	Section(s) and Subdivision(s) Sec 13: E1/2NE, SWNE, E1/2SE, SESW Sec 23: SENE, N1/2SE, SWSE, SESW; Sec 24: N1/2NW, SWNW		Scale 1:15,840		

Cover Type

A = Aspen	H = Hemlock	N = Marsh	U = Upland Brush
B = Paper Birch	J = Jack Pine	O = Oak	UM = Upland Mixed
C = Cedar	L = Lowland Brush	P = Lowland Poplar	V = Bog or Marsh
D = Treed Bog	LM = Lowland Mixed	Q = Mixed Swamp Conifer	W = White Pine
E = Swamp Hdwoods	M = Mpl, Bch, Brch	R = Red Pine	X = Non Stocked
F = Spruce Fir	MC = Mixed Conifer	S = Black Spruce	Z = Water
	MD = Mixed Deciduous		

Density

0 = Non Stocked	5 = Pole Timber Medium
1 = Seedling Sapling Poor	6 = Pole Timber Well
2 = Seedling Sapling Medium	7 = Saw Timber Poor
3 = Seedling Sapling Well	8 = Saw Timber Medium
4 = Pole Timber Poor	9 = Saw Timber Well

MPRC Fuelbreak
Compartments 238, 239, 240
52.3 Acres

PU	Acres
1	28.8
2	23.5

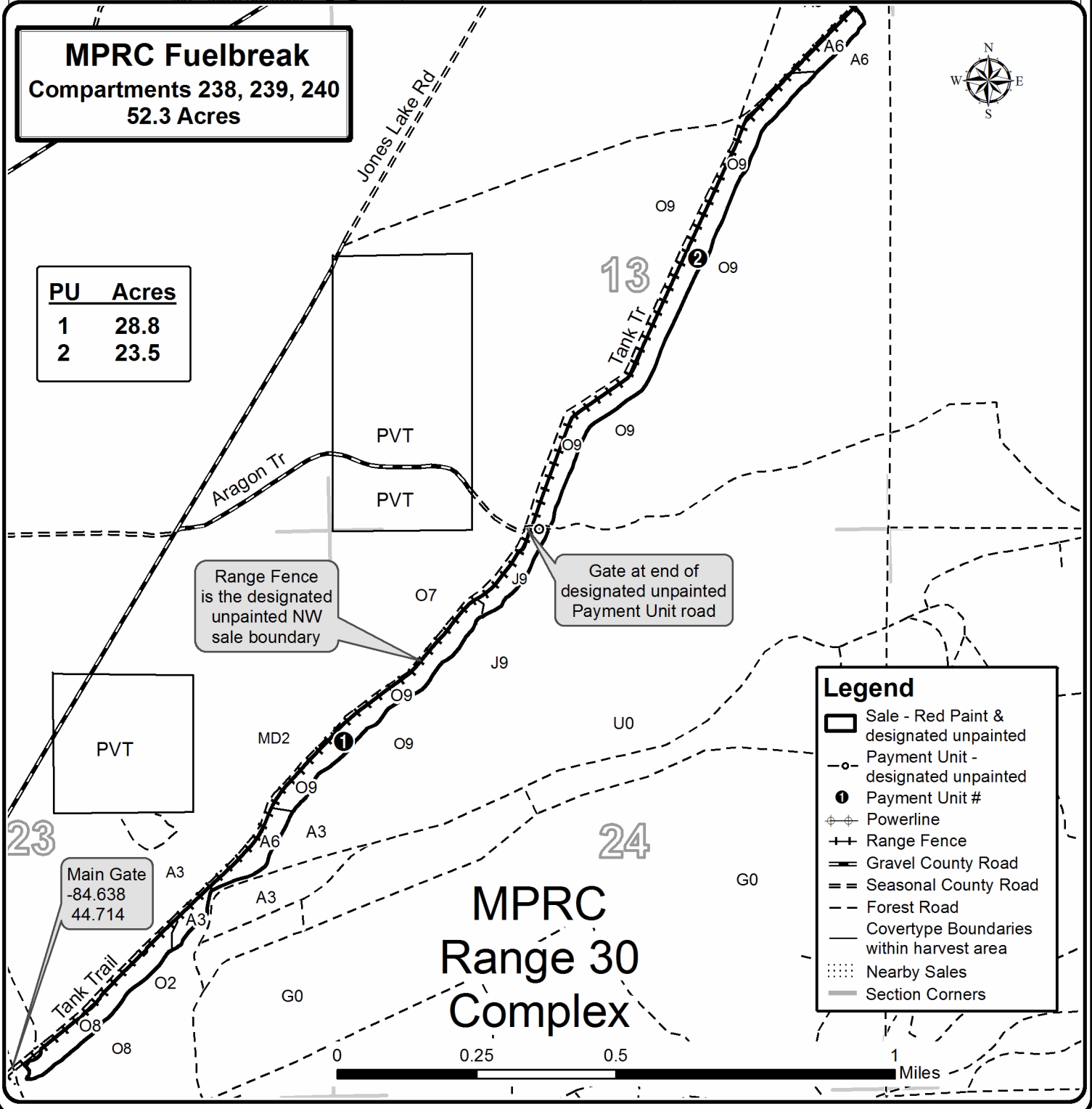

TIMBER SALE MAP

This information provided by authority of Part 525, 1994 PA 451, as amended.

Forest Management Unit Grayling		County Crawford	Mapped By Charlebois & Mittig	Date 09/30/2020	Supplemental Map
			Cruised By Charlebois & Mittig		
Township 27N	Range 3W	Section(s) and Subdivision(s) Sec 13: E 1/2NE, SWNE, E 1/2SE, SESW Sec 23: SENE, N 1/2SE, SWSE, SESW; Sec 24: N 1/2NW, SWNW		Scale 1:20,000	

Cover Type				Density	
A = Aspen	H = Hemlock	N = Marsh	U = Upland Brush	0 = Non Stocked	5 = Pole Timber Medium
B = Paper Birch	J = Jack Pine	O = Oak	UM = Upland Mixed	1 = Seedling Sapling Poor	6 = Pole Timber Well
C = Cedar	L = Lowland Brush	P = Lowland Poplar	V = Bog or Marsh	2 = Seedling Sapling Medium	7 = Saw Timber Poor
D = Treed Bog	LM = Lowland Mixed	Q = Mixed Swamp Conifer	W = White Pine	3 = Seedling Sapling Well	8 = Saw Timber Medium
E = Swamp Hdwoods	M = Mpl, Bch, Brch	R = Red Pine	X = Non Stocked	4 = Pole Timber Poor	9 = Saw Timber Well
F = Spruce Fir	MC = Mixed Conifer	S = Black Spruce	Z = Water		
G = Grass	MD = Mixed Deciduous	T = Tamarack			

