



**DEPARTMENT OF NATURAL RESOURCES
STATE OF MICHIGAN**

TIMBER SALE PROSPECTUS #6934

REVISION NOTICE #1 - November 2, 2021

SCHEDULED SALE DATE AND TIME: 8:30 a.m. (local time) on Wednesday, November 10, 2021

LOCATION: Crystal Falls Mgmt Unit, 1420 US 2 West, Crystal Falls, MI 49920

This prospectus has been modified with the following changes.

TWO MILE SPLIT (12-002-21)

2 - Timber Specifications:

2.1 - Included Timber

2.1.1 - Clearcut Unit(s) with unmerchantable trees (6/14)

DELETE:

Within Payment Unit(s) 8 and 9, cut all trees that are two (2) inches or more at DBH, except cedar, hemlock, oak, red pine and white pine. In addition, cut all spruce, balsam fir, tamarack and jack pine with two or more pulpwood sticks.

REPLACE WITH:

Within Payment Units 8, 9 and 12, cut all trees that are 2 inches or more at DBH, except cedar, hemlock, oak, red pine and white pine. Additionally, in Payment Units 8 and 9, cut all spruce, balsam fir, tamarack and jack pine with 2 or more pulpwood sticks. In Payment Unit 12 cut all spruce, balsam fir, tamarack and jack pine with one or more pulpwood sticks.

We apologize for any inconvenience this may have caused. If you need assistance, please contact Dan McNamee at 906-875-6622.



**DEPARTMENT OF NATURAL RESOURCES
STATE OF MICHIGAN**

TIMBER SALE PROSPECTUS #6934

SCHEDULED SALE DATE AND TIME: 8:30 a.m. (local time) on November 10, 2021.

LOCATION: CRYSTAL FALLS MGMT UNIT, 1420 US 2 WEST, CRYSTAL FALLS, MI 49920.

CONTACT NAME: Dan McNamee

PHONE NUMBER: (906) 875-6622

PROSPECTUS NOTE: The bidder is advised to inspect the sale area and review the location, estimated volumes, operating costs and contract terms of proposed sales. Please be aware that some landowners may request 60 days or more notice for access across their land.

Notice is hereby given that bids will be received by the Unit Manager, CRYSTAL FALLS MANAGEMENT UNIT, for certain timber on the following described lands:

Two Mile Split (12-002-21) / T44N, R29W, SEC. 10, W1/2SW.

T44N, R29W, SEC. 15, S1/2NW.

T44N, R29W, SEC. 16, N1/2NW,SWNW,N1/2NE,SWNE,SW.

T44N, R29W, SEC. 16, W1/2SE.

T44N, R29W, SEC. 17, SE.

T44N, R29W, SEC. 21, NE,NESE.

T44N, R29W, SEC. 22, SWNW.

T44N, R29W, SEC. 8 , SENW,SWNE,NESW,SE.

T44N, R29W, SEC. 9 , S1/2NW,SWNE,NWSW,S1/2SW,SE.

Dickinson County, Advertised Price \$197,291.30, 435.4 Acres, Aspen, Hardwood.

SALE NOTE: All units of volume listed for this sale were estimated using the Inventory Manager computer program and the new Michigan taper model.

This sale has areas of difficult access. Purchaser should make sure they have an access plan and necessary permissions before purchasing sale.

- See sale spec 4.4.1 for information on access through private property.

- See sale specs 4.1.2 and 4.1.11 for information on permit for mat bridge crossing.

Access may be through private or other public land.

TIMBER SALE INFORMATION

Two Mile Split (12-002-21)

T44N, R29W, SEC. 10; T44N, R29W, SEC. 15; T44N, R29W, SEC. 16; T44N, R29W, SEC. 17; T44N, R29W, SEC. 21; T44N, R29W, SEC. 22; T44N, R29W, SEC. 8; T44N, R29W, SEC. 9.

SALE NOTE: All units of volume listed for this sale were estimated using the Inventory Manager computer program and the new Michigan taper model.

This sale has areas of difficult access. Purchaser should make sure they have an access plan and necessary permissions before purchasing sale.

- See sale spec 4.4.1 for information on access through private property.

- See sale specs 4.1.2 and 4.1.11 for information on permit for mat bridge crossing.

Access may be through private or other public land.

A timber sale contract for this lump sum, sealed bid timber sale will be awarded to the responsible bidder offering the highest sealed bid price. All units of volume listed below were estimated using the Inventory Manager computer program and the new Michigan taper model. Bids must be at or above the following advertised price for each product and species:

<u>PRODUCTS & SPECIES</u>	<u>ESTIMATED UNITS*</u>	<u>ADVERTISED PRICE</u>
Sawtimber		
Basswood	24.7 MBF	\$ 54.00 / MBF
Paper Birch	123.6 MBF	\$ 94.00 / MBF
Red Maple	92.2 MBF	\$ 96.00 / MBF
Sugar Maple	257.0 MBF	\$ 172.00 / MBF
Yellow Birch	9.4 MBF	\$ 52.00 / MBF
Pulpwood		
Balsam Fir	395 Cords	\$ 7.60 / Cord
Mixed Aspen	4,471 Cords	\$ 20.30 / Cord
Mixed Hardwood	2,710 Cords	\$ 13.10 / Cord
Mixed Spruce	178 Cords	\$ 8.60 / Cord

* The total volume is statistically estimated within plus (+) or minus (-) 3.10 percent. There are an estimated 8,623 cords on this timber sale, plus or minus 268 cords at the 95% confidence level. The estimated units are final and not subject to adjustment. Prospective bidders are urged to examine this timber and to make their own estimates of quantity and quality.

BOND AND PAYMENT SCHEDULE:

1. A bond in the amount of \$13,810.39 to insure faithful performance of the conditions of the contract will be deposited by the successful bidder within 21 days of the sale award.
2. Cutting in any sale or unit without the required advance payment would be considered a trespass.
3. Total payment must be paid in advance or according to the following schedule:
 - (a) Ten percent (10%) of the sale value must be paid within 21 days of the sale award.
 - (b) The 10% down payment will be credited towards the first unit cut.
 - (c) Payment for each of the following units must be made before cutting begins in that unit:

<u>PAYMENT UNIT NUMBER</u>	<u>PERCENT OF TOTAL SALE VALUE</u>
01	9.7%
02	12.3%
03	3.1%
04	5.2%
05	8.6%
06	4.2%
07	3.4%
08	6.5%
09	9.6%
10	6.8%
11	3.0%
12	2.3%
13	2.1%
14	16.2%
15	7.0%

4. If no cutting takes place, the 10% down payment will not be refunded.
5. Operations on the contract issued will terminate on 06/30/2025.

SALE STATISTICS

Volumes were calculated in cubic feet using the Michigan taper model. Cubic foot volume includes all wood inside bark for the product indicated. For display purposes, cubic feet were converted to cords and MBF using a simple conversion factor, e.g. 79 cubic feet per cord and 185 cubic feet per MBF. The cubic foot volumes are precise; the cords and MBF volumes are not. Cubic foot volume cannot be directly converted to cords or boards with precision.

SALE VOLUMES

The total estimated sale volume may not equal the sum of the species/products due to the nature of statistical calculations associated with double sampling methodology.

VOLUME			STATISTICAL RANGE IN CORDS	
TOTAL CUBIC FEET	TOTAL CORDS	PERCENT ERROR	MINIMUM	MAXIMUM
681,190	8,623	3.10%	8,355	8,891

VDU VOLUMES

A VDU is a Volume Determination Unit. Volumes and their associated statistics are calculated at the VDU level and summarized to the sale level. There is often a one to one relationship between a VDU and a Payment Unit, but not always, depending on the cruise design. Refer to the VDU TO PAYMENT UNIT table.

	VOLUME			RANGE IN CORDS	
VDU	TOTAL CUBIC FEET	TOTAL CORDS	PERCENT ERROR	MINIMUM	MAXIMUM
9	26,852	340	11.29%	302	378
10	25,184	319	9.15%	290	348
15	16,745	212	15.50%	179	245
22	25,691	325	8.91%	296	354
28	76,785	972	12.01%	855	1,089
31	94,798	1,200	10.55%	1,073	1,327
33	38,328	485	10.46%	434	536
35	25,376	321	16.71%	268	375
43	43,376	549	10.06%	494	604
54	133,689	1,692	6.98%	1,574	1,810
55	25,248	320	14.60%	273	366
62	52,219	661	11.66%	584	738
63	18,584	235	9.45%	213	257
68	15,363	194	17.53%	160	229
336	74,457	942	9.98%	848	1,037
TOTAL:	692,694	8,768		7,844	9,693

VDU TO PAYMENT UNIT

When a VDU is associated with more than one Payment Unit (PU), the VDU volumes are assigned to the PU based on acres of the VDU within the PU.

VDU	VDU ACRES	PU	PU ACRES
9	32.7	4	32.7
10	19.2	3	19.2
15	20.4	11	20.4
22	23.2	6	23.2
28	35.1	9	35.1
31	33.0	2	33.0
33	44.1	10	44.1
35	28.5	15	28.5
43	50.0	5	50.0
54	53.7	14	53.7
55	28.5	7	28.5
62	17.5	8	17.5
63	8.6	13	8.6
68	10.4	12	10.4
336	30.5	1	30.5
TOTAL:	435.4		435.4

DESCRIPTION OF TIMBER BY PU (PU)

PU	MARKET GROUP	PRODUCT	QUANTITY	UNIT	ACRES	ADVERTISE PRICE
1	Paper Birch	Sawtimber	32.3	MBF	30.5	\$19,182.80
	Red Maple		8.3	MBF		
	Sugar Maple		2.4	MBF		
	Balsam Fir	Pulpwood	31	Cords		
	Mixed Aspen		574	Cords		
	<i>Balsam Poplar</i>		59	Cords		
	<i>Quaking Aspen</i>		515	Cords		
	Mixed Hardwood		196	Cords		
	<i>Black Ash</i>		8	Cords		
	<i>Paper Birch</i>		97	Cords		
	<i>Red Maple</i>		56	Cords		
	<i>Sugar Maple</i>		35	Cords		
	Mixed Spruce		56	Cords		
	<i>Black Spruce</i>		12	Cords		
	<i>White Spruce</i>		44	Cords		
2	Paper Birch	Sawtimber	19.3	MBF	33.0	\$24,207.40
	Sugar Maple		6.6	MBF		
	Balsam Fir	Pulpwood	57	Cords		
	Mixed Aspen		913	Cords		
	<i>Balsam Poplar</i>		149	Cords		
	<i>Quaking Aspen</i>		764	Cords		
	Mixed Hardwood		167	Cords		
	<i>Black Ash</i>		8	Cords		
	<i>Paper Birch</i>		51	Cords		
	<i>Red Maple</i>		81	Cords		
	<i>Sugar Maple</i>		18	Cords		
	<i>Yellow Birch</i>		9	Cords		
	Mixed Spruce		12	Cords		
	<i>White Spruce</i>		12	Cords		
3	Paper Birch	Sawtimber	4.3	MBF	19.2	\$6,022.60
	Balsam Fir	Pulpwood	1	Cords		
	Mixed Aspen		234	Cords		
	<i>Balsam Poplar</i>		31	Cords		
	<i>Quaking Aspen</i>		203	Cords		
	Mixed Hardwood		46	Cords		
	<i>Black Cherry</i>		10	Cords		
	<i>Paper Birch</i>		36	Cords		
	Mixed Spruce		30	Cords		
	<i>Black Spruce</i>		18	Cords		
	<i>White Spruce</i>		12	Cords		
4	Red Maple	Sawtimber	9.9	MBF	32.7	\$10,248.30
	Sugar Maple		33.7	MBF		
	Mixed Aspen	Pulpwood	26	Cords		
	<i>Balsam Poplar</i>		26	Cords		
	Mixed Hardwood		227	Cords		
	<i>Black Ash</i>	Sawtimber	1.6	MBF		
	<i>Black Ash</i>	Pulpwood	2	Cords		
	<i>Ironwood</i>		1	Cords		
	<i>Red Maple</i>		33	Cords		
	<i>Sugar Maple</i>		188	Cords		
5	Basswood	Sawtimber	11.7	MBF	50.0	\$16,951.80
	Paper Birch		2.7	MBF		
	Red Maple		13.9	MBF		
	Sugar Maple		56.4	MBF		
	Mixed Aspen	Pulpwood	11	Cords		

DESCRIPTION OF TIMBER BY PU (PU), CON'T

PU	MARKET GROUP	PRODUCT	QUANTITY	UNIT	ACRES	ADVERTISE PRICE
5 con't	<i>Balsam Poplar</i>	<i>Pulpwood</i>	4	<i>Cords</i>		
	<i>Quaking Aspen</i>		7	<i>Cords</i>		
	Mixed Hardwood		367	<i>Cords</i>		
	<i>Basswood</i>		5	<i>Cords</i>		
	<i>Paper Birch</i>		8	<i>Cords</i>		
	<i>Red Maple</i>		79	<i>Cords</i>		
	<i>Sugar Maple</i>		275	<i>Cords</i>		
6	Basswood	Sawtimber	2.1	MBF	23.2	\$8,313.30
	Paper Birch		9.5	MBF		
	Sugar Maple		21.5	MBF		
	Mixed Aspen	<i>Pulpwood</i>	40	<i>Cords</i>		
	<i>Balsam Poplar</i>		7	<i>Cords</i>		
	<i>Quaking Aspen</i>		33	<i>Cords</i>		
	Mixed Hardwood		203	<i>Cords</i>		
	<i>Basswood</i>		1	<i>Cords</i>		
	<i>Black Cherry</i>		4	<i>Cords</i>		
	<i>Ironwood</i>		3	<i>Cords</i>		
	<i>Paper Birch</i>		22	<i>Cords</i>		
	<i>Red Maple</i>		18	<i>Cords</i>		
	<i>Sugar Maple</i>		155	<i>Cords</i>		
	Mixed Spruce		16	<i>Cords</i>		
	<i>White Spruce</i>		16	<i>Cords</i>		
7	Sugar Maple	Sawtimber	17.8	MBF	28.5	\$6,765.90
	Yellow Birch		3.3	MBF		
	Balsam Fir	<i>Pulpwood</i>	24	<i>Cords</i>		
	Mixed Aspen		5	<i>Cords</i>		
	<i>Quaking Aspen</i>		5	<i>Cords</i>		
	Mixed Hardwood		248	<i>Cords</i>		
	<i>Ironwood</i>		2	<i>Cords</i>		
	<i>Sugar Maple</i>		239	<i>Cords</i>		
	<i>Yellow Birch</i>		7	<i>Cords</i>		
8	Balsam Fir	<i>Pulpwood</i>	32	<i>Cords</i>	17.5	\$12,911.50
	Mixed Aspen		620	<i>Cords</i>		
	<i>Balsam Poplar</i>		47	<i>Cords</i>		
	<i>Quaking Aspen</i>		573	<i>Cords</i>		
	Mixed Hardwood		3	<i>Cords</i>		
	<i>Black Cherry</i>		3	<i>Cords</i>		
	Mixed Spruce		5	<i>Cords</i>		
	<i>White Spruce</i>		5	<i>Cords</i>		
9	Paper Birch	Sawtimber	16.3	MBF	35.1	\$18,967.10
	Red Maple		15.5	MBF		
	Balsam Fir	<i>Pulpwood</i>	47	<i>Cords</i>		
	Mixed Aspen		615	<i>Cords</i>		
	<i>B. T. Aspen</i>		12	<i>Cords</i>		
	<i>Balsam Poplar</i>		50	<i>Cords</i>		
	<i>Quaking Aspen</i>		553	<i>Cords</i>		
	Mixed Hardwood		218	<i>Cords</i>		
	<i>Ironwood</i>		4	<i>Cords</i>		
	<i>Paper Birch</i>		49	<i>Cords</i>		
	<i>Red Maple</i>		77	<i>Cords</i>		
	<i>Sugar Maple</i>		88	<i>Cords</i>		
	Mixed Spruce		29	<i>Cords</i>		
	<i>White Spruce</i>		29	<i>Cords</i>		
10	Basswood	Sawtimber	8.4	MBF	44.1	\$13,381.20
	Paper Birch		0.9	MBF		

DESCRIPTION OF TIMBER BY PU (PU), CON'T

PU	MARKET GROUP	PRODUCT	QUANTITY	UNIT	ACRES	ADVERTISE PRICE
10 con't	Red Maple	Sawtimber	23.1	MBF		
	Sugar Maple		34.7	MBF		
	Mixed Aspen	Pulpwood	10	Cords		
	<i>Balsam Poplar</i>		10	Cords		
	Mixed Hardwood		340	Cords		
	<i>Basswood</i>		24	Cords		
	<i>Ironwood</i>		4	Cords		
	<i>Paper Birch</i>		2	Cords		
	<i>Red Maple</i>		52	Cords		
	<i>Sugar Maple</i>		258	Cords		
11	Paper Birch	Sawtimber	4.0	MBF	20.4	\$5,915.70
	Red Maple		3.0	MBF		
	Sugar Maple		18.9	MBF		
	Yellow Birch		2.7	MBF		
	Balsam Fir	Pulpwood	26	Cords		
	Mixed Hardwood		123	Cords		
	<i>Ironwood</i>		3	Cords		
	<i>Paper Birch</i>		6	Cords		
	<i>Red Maple</i>		19	Cords		
	<i>Sugar Maple</i>		93	Cords		
	<i>Yellow Birch</i>		2	Cords		
	Mixed Spruce		6	Cords		
	<i>White Spruce</i>		6	Cords		
12	Paper Birch	Sawtimber	15.9	MBF	10.4	\$4,476.30
	Red Maple		4.0	MBF		
	Sugar Maple		3.4	MBF		
	Yellow Birch		0.8	MBF		
	Balsam Fir	Pulpwood	25	Cords		
	Mixed Aspen		31	Cords		
	<i>Balsam Poplar</i>		10	Cords		
	<i>Quaking Aspen</i>		21	Cords		
	Mixed Hardwood		84	Cords		
	<i>Paper Birch</i>		33	Cords		
	<i>Red Maple</i>		17	Cords		
	<i>Sugar Maple</i>		32	Cords		
	<i>Yellow Birch</i>		2	Cords		
	Mixed Spruce		6	Cords		
	<i>White Spruce</i>		6	Cords		
13	Paper Birch	Sawtimber	3.3	MBF	8.6	\$4,177.60
	Red Maple		2.9	MBF		
	Sugar Maple		0.8	MBF		
	Yellow Birch		0.5	MBF		
	Balsam Fir	Pulpwood	25	Cords		
	Mixed Aspen		104	Cords		
	<i>Quaking Aspen</i>		104	Cords		
	Mixed Hardwood		74	Cords		
	<i>Ironwood</i>		2	Cords		
	<i>Paper Birch</i>		24	Cords		
	<i>Red Maple</i>		24	Cords		
	<i>Sugar Maple</i>		14	Cords		
	<i>Yellow Birch</i>		10	Cords		
	Mixed Spruce		18	Cords		
	<i>White Spruce</i>		18	Cords		
14	Paper Birch	Sawtimber	13.3	MBF	53.7	\$32,027.60
	Red Maple		2.0	MBF		

DESCRIPTION OF TIMBER BY PU (PU), CON'T

PU	MARKET GROUP	PRODUCT	QUANTITY	UNIT	ACRES	ADVERTISE PRICE
14 con't	Sugar Maple	Sawtimber	2.1	MBF		
	Balsam Fir	Pulpwood	127	Cords		
	Mixed Aspen		1,280	Cords		
	Balsam Poplar		55	Cords		
	Quaking Aspen		1,225	Cords		
	Mixed Hardwood		250	Cords		
	Ironwood		2	Cords		
	Paper Birch		142	Cords		
	Red Maple		97	Cords		
	Sugar Maple		9	Cords		
15	Basswood	Sawtimber	2.5	MBF	28.5	\$13,742.20
	Paper Birch		1.8	MBF		
	Red Maple		9.6	MBF		
	Sugar Maple		58.7	MBF		
	Yellow Birch		2.1	MBF		
	Mixed Aspen	Pulpwood	8	Cords		
	Quaking Aspen		8	Cords		
	Mixed Hardwood		164	Cords		
	Basswood		2	Cords		
	Ironwood		7	Cords		
	Paper Birch		1	Cords		
	Red Maple		16	Cords		
	Sugar Maple		136	Cords		
	Yellow Birch		2	Cords		
	TOTAL:			506.9		
TOTAL:			7,754	Cords		

Sale Specific Conditions & Requirements

Sale Name: Two Mile Split

Sale Number: 12-002-21 Seq#: 1

1 - Sale Area

1.2 - Boundaries

1.2.1 - Painted boundaries (9/19)

The sale boundary and Payment Unit boundaries are marked and identified by blue, red and yellow paint. Exterior sale boundary lines against private property are marked with blue paint. Exterior sale boundary lines against state are marked with red paint. Interior Payment Unit boundaries are marked with yellow paint. The painted boundary line trees are not Included Timber and are to be protected unless marked with orange paint. Yellow painted trees designating an interior Payment Unit boundary are only to be cut when all surrounding Payment Units have been paid.

2 - Timber Specifications

2.1 - Included Timber

2.1.1 - Clearcut unit(s) with unmerchantable trees (6/14)

Within Payment Unit(s) 1-3, cut all trees that are two (2) inches or more at DBH, except pine and cedar. In addition, do not cut trees marked with green paint above and below stump in Payment Unit 3.

Within Payment Unit(s), 8 and 9, cut all trees that are two (2) inches or more at DBH, except cedar, hemlock, oak, red pine, and white pine. In addition, cut all spruce, balsam fir, tamarack, and jack pine with two or more pulpwood sticks.

Within Payment Unit(s) 14, cut all trees that are two (2) inches or more at DBH, except cedar, hemlock, oak, black ash, cherry, red pine, and white pine. In addition, cut all spruce, balsam fir, tamarack, and jack pine with two or more pulpwood sticks.

Within Payment Unit(s) 13, cut all aspen, balsam poplar and maple with one or more pulpwood sticks. Additionally, cut all spruce, paper birch and balsam fir with two or more pulpwood sticks. Do not cut trees marked with green paint above and below stump height, cedar, hemlock, oak, red pine, or white pine.

2.1.3 - Cut tree marked unit(s) (12/08)

Within Payment Unit(s) 4-7, 10, 11, and 15, all trees are designated for cutting when marked with orange paint above and below stump height, regardless of merchantability. In addition:

- Within Payment Unit(s) 5, 7, 11 and 15, cut all aspen, balsam poplar, spruce, and balsam fir with two or more pulpwood sticks. Do not cut trees marked with green paint above and below stump height in Payment Unit 5, 7 and 15.
- Within Payment Unit(s) 6, cut all aspen, balsam poplar, spruce, paper birch, and balsam fir with two or more pulpwood sticks. Do not cut trees marked with green paint above and below stump height.
- Within Payment Unit(s) 10, cut all aspen and balsam poplar with one or more pulpwood sticks.

3 - Payments

3.3 - Pre-measured Sales

3.3.4 - Dividing payment units (7/14)

Payment Unit(s) 5, 10, and 14 may be divided at the request of the Purchaser and upon approval of the Unit Manager.

Dividing Payment Units is a contract modification which requires a Timber Sale Contract Amendment. There will be only one division per Payment Unit.

3.4 - Damaged Timber

3.4.1 - Damaged timber (7/16)

General Condition and Requirement 3.4 Damaged Timber, defines liquidated damages for undesignated live merchantable trees which are cut or injured. In addition, extreme care should be taken to avoid damage to tree seedlings and saplings.

No damage is acceptable to undesignated live merchantable trees. Within the Sale Area, if more than 10% of trees (> 4.5" DBH) within a specified area of the sale are damaged, liquidated damages will be assessed for all trees damaged. Rates will be in accordance with General Condition and Requirement 3.4 Damaged Timber.

4 - Transportation

4.1 - Construction

4.1.2 - Stream crossings, specific (3/11)

The unnamed stream crossing, labeled on the sale map north of Payment Unit 9, will require the installation of a timber mat bridge. The timber mat bridge will not be crossed with log or conventional trucks and is limited to frozen ground conditions. The installation will be performed in accordance with the specifications on the appropriate permits which shall be provided by the DNR. Crossing of unnamed stream dividing Payment Unit 9 will not be permitted.

4.1.5 - Culverts (5/14)

Roads may require the installation of culverts for cross drainage or at natural drainage-ways. If culverts are needed in these locations, their placement will be specified by the sale administrator. The culverts shall be new, corrugated metal or plastic gauge and at least 24 feet in length. Culvert diameter will be determined by sale administrator. If culverts are removed, soils shall be maintained and left in a non-erodible condition, with water bars, seed, fertilizer, mulch, and slash installed as directed by the sale administrator and as specified in the BMP manual. Stream crossing permits, if needed, will be obtained by the DNR.

4.1.6 - Road construction (1/09)

Construction of new roads or improvements of existing roads shall be done in such a way as to minimize the environmental and visual impacts. Merchantable trees shall be cut and utilized unless otherwise directed. Non-merchantable trees shall be severed and laid flat on the ground. Slash shall be scattered, and not left in windrows and kept a minimum of 10 feet back from the road edge, be chipped, utilized, or otherwise removed from the sale. Stumps shall be set upright, not left on edge, and be moved at least 10 feet away from the road edge. Disturbed soil shall be feathered into the woods and not left in berms or windrows.

4.1.7 - Road closure (10/11)

All new roads built into the sale must be blocked to vehicle traffic upon completion of the sale, unless otherwise stated by sale administrator. Overgrown roads that are reopened shall be considered new roads. In general, this will require constructing a four (4') foot high berm of stumps and logs covered with earth.

4.1.11 - Permits (2/12)

The DNR will secure any necessary stream crossing permits that may be required.

4.2 - Maintenance

4.2.1 - Hauling restriction (12/08)

Hauling may be restricted on forest roads by the Unit Manager or his/her representative. The restriction may occur during wet weather conditions.

4.2.2 - Fill material (4/07)

To maintain roads, fill material may be needed in areas where "holes" exist or may be expected to develop. This fill material should be placed before trucking begins. Contact the sale administrator regarding the availability of on site sand or gravel from adjacent State-owned lands.

4.4 - Access

4.4.1 - Private property access (3/11)

Permission for access across private land is the responsibility of the Purchaser. Should the Purchaser desire to cross private land, a copy of the written permission from the private land-owner may be required by the DNR.

5 - Operations

5.2 - Conduct of Operations

5.2.1 - Slash

5.2.1.13 - Dispose of slash as directed (12/05)

Slash is to be disposed of as directed by the sale administrator.

5.2.3 - Operating Restrictions

5.2.3.2 - Operating restrictions (9/11)

Within Payment Unit(s) 9, unless changed by written agreement, cutting, skidding, and hauling are limited to frozen ground conditions, as determined by timber sale administrator. This restriction is because of wet ground.

5.2.3.3 - Bark slippage restriction (3/09)

Within Payment Unit(s) 4-7, 10, 11, and 15, unless changed by written agreement, cutting and skidding are not permitted during the period of April 15 to July 15. This restriction is because of bark slippage.

5.2.22 - Operating Caution

5.2.22.1 - Operating caution (6/11)

It is recommended, but not required, that within Payment Unit(s) 1-5, 7, 8, and 10-14, cutting, skidding, and hauling occur during dry summer or frozen winter conditions. The reason for the recommendation is because wet ground within the Payment Unit or wet ground along access roads.

5.2.41 - Snowmobile trail protection (9/11)

The Big Wheel Road is a snowmobile trail and is shown on the Timber Sale Map. Do not cut or damage posts with orange trail markers or traffic control signs. If the trail is used, it must be maintained and restored to a condition equal to or better than before the sale. The road maintenance/restoration may be required prior to December 1. If the trail road is to be used for hauling during the snowmobile season, then a snow-covered base must be left on the trail. Maintain a 20-foot-wide slash, debris, and rut free zone daily using the snowmobile trail as the centerline.

5.4 - Soil Protection

5.4.3 - Erosion control (12/08)

Skid trails or haul roads may require erosion control structures or berms per direction of the Unit Manager or his/her representative.

6 - Safety and Fire Prevention

6.2 - Signing

6.2.1 - Road posting (10/20)

The Purchaser is responsible for posting and maintaining caution signs on the Big Wheel Road prior to beginning operations. The road must be posted at appropriate distances from the Sale Area to warn of logging activity and truck traffic. Signs must be removed when harvest operations are suspended or completed. The Purchaser will provide these signs.

**TIMBER SALE MAP***This information provided by authority of Part 525, 1994 PA 451, as amended.*

Sale Number	Year
12 - 002	21

Forest Management Unit Crystal Falls FMU	County Dickinson	Mapped By Jacob Siler	Date 02/05/21	Page 1	of 3
Township 44N	Range 29W	Section(s) and Subdivision(s) Sections: 8, 9, 10, 15, 16, 21, 22	Scale 1:15,840		

Cover Type				Density	
A = Aspen	H = Hemlock	N = Marsh	U = Upland Brush	0 = Non Stocked	5 = Pole Timber Medium
B = Paper Birch	J = Jack Pine	O = Oak	UM = Upland Mixed	1 = Seedling Sapling Poor	6 = Pole Timber Well
C = Cedar	L = Lowland Brush	P = Lowland Poplar	V = Bog or Marsh	2 = Seedling Sapling Medium	7 = Saw Timber Poor
D = Treed Bog	LM = Lowland Mixed	Q = Mixed Swamp Conifer	W = White Pine	3 = Seedling Sapling Well	8 = Saw Timber Medium
E = Swamp Hdwoods	M = Mpl, Bch, Brch	R = Red Pine	X = Non Stocked	4 = Pole Timber Poor	9 = Saw Timber Well
F = Spruce Fir	MC = Mixed Conifer	S = Black Spruce	Z = Water		
G = Grass	MD = Mixed Deciduous	T = Tamarack			

PU	Acres	PU	Acres	PU	Acres
1	30.5	6	23.2	11	20.4
2	33.0	7	28.5	12	10.4
3	19.2	8	17.5	13	8.6
4	32.7	9	35.1	14	53.7
5	50.0	10	44.1	15	28.5

Two Mile Creek Split

Compartment 6 & 7

435.4 Acres

**Legend**

- Private Line (Blue)
- Payment Unit Line (Yellow)
- ▭ Against State (Red)
- ▭ State Boundary
- ⊠ Gate
- ◇ Survey Grade Corners
- ⋯ Closed Road
- - - Poor Dirt Road
- Section Corners
- ⚡ Powerline
- - - Stream



SCAN FOR MAP

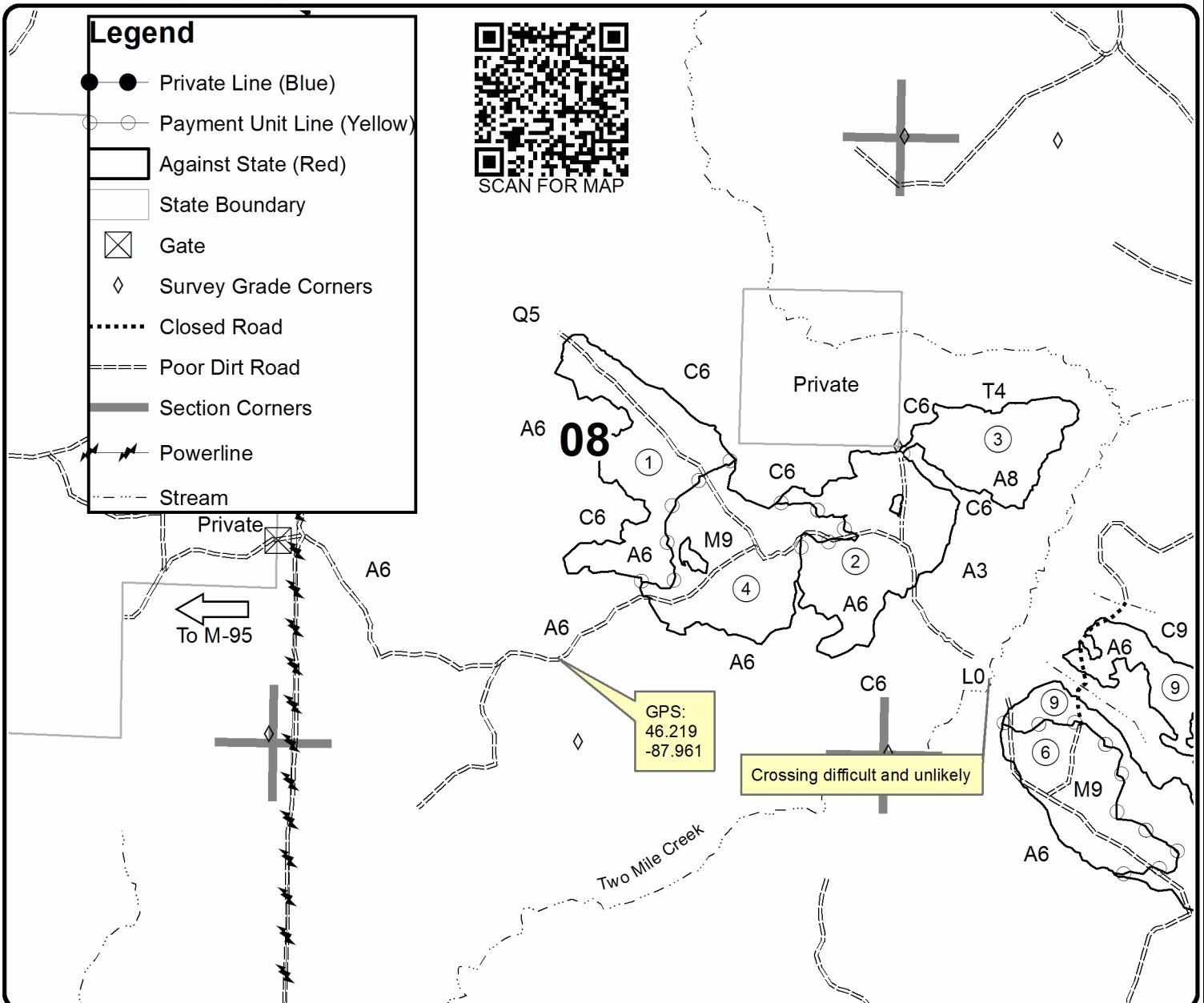

0 0.125 0.25 0.5 0.75 1 Miles

**TIMBER SALE MAP***This information provided by authority of Part 525, 1994 PA 451, as amended.*

Sale Number	Year
12 - 002	21

Forest Management Unit	County	Mapped By	Date	Page	of
Crystal Falls FMU	Dickinson	Jacob Siler	02/05/21	3	3
Township	Range	Section(s) and Subdivision(s)	Scale		
44N	29W	Sections: 8, 9, 10, 15, 16, 21, 22	1:15,840		

Cover Type

A = Aspen	H = Hemlock	N = Marsh	U = Upland Brush
B = Paper Birch	J = Jack Pine	O = Oak	UM = Upland Mixed
C = Cedar	L = Lowland Brush	P = Lowland Poplar	V = Bog or Marsh
D = Treed Bog	LM = Lowland Mixed	Q = Mixed Swamp Conifer	W = White Pine
E = Swamp Hdwoods	M = Mpl, Bch, Brch	R = Red Pine	X = Non Stocked
F = Spruce Fir	MC = Mixed Conifer	S = Black Spruce	Z = Water
G = Grass	MD = Mixed Deciduous	T = Tamarack	

Density

0 = Non Stocked	5 = Pole Timber Medium
1 = Seedling Sapling Poor	6 = Pole Timber Well
2 = Seedling Sapling Medium	7 = Saw Timber Poor
3 = Seedling Sapling Well	8 = Saw Timber Medium
4 = Pole Timber Poor	9 = Saw Timber Well

PU	Acres	PU	Acres	PU	Acres
1	30.5	6	23.2	11	20.4
2	33.0	7	28.5	12	10.4
3	19.2	8	17.5	13	8.6
4	32.7	9	35.1	14	53.7
5	50.0	10	44.1	15	28.5

Two Mile Creek Split

Compartment 6 & 7

435.4 Acres

