



**DEPARTMENT OF NATURAL RESOURCES  
STATE OF MICHIGAN**

**TIMBER SALE PROSPECTUS #6955**

**REVISION NOTICE #2 - January 11, 2022**

SCHEDULED SALE DATE AND TIME: 4:00 p.m. (local time) on Monday, January 24, 2022

LOCATION: TRAVERSE CITY MGMT UNIT, 2122 M 37 South, Traverse City, MI 49685

This prospectus has been modified with the following changes.

The sale map(s) for the Down Range Hardwoods timber sale (61-114-21) has been updated. Please use the attached sale map(s) when bidding on this sale and disregard the original sale map(s) sent with the prospectus.

There are a number of small, pink lined areas to clearcut within Units 4 and 5, as indicated in specification 2.1.3. These areas have been added to the map. The previous revision for this prospectus updated spec 2.1.3 to include clearcutting the pink lined regeneration gaps and this revision adds an updated map showing the location of these areas.

We apologize for any inconvenience this may have caused. If you need assistance, please contact David Lemmien at 231-922-6040.

**TIMBER SALE MAP**

This information provided by authority of Part 525, 1994 PA 451, as amended.

Sale Number	Year
61-114	21

Forest Management Unit Traverse City	County Kalkaska	Mapped By Crugier	Date 02/18/21	Page 1	of 1
Township 28N	Range 05W	Section(s) and Subdivision(s) Section 33	Scale 1:15,840		

**Cover Type**

A = Aspen	H = Hemlock	N = Marsh	U = Upland Brush
B = Paper Birch	J = Jack Pine	O = Oak	UM = Upland Mixed
C = Cedar	L = Lowland Brush	P = Lowland Poplar	V = Bog or Marsh
D = Treed Bog	LM = Lowland Mixed	Q = Mixed Swamp Conifer	W = White Pine
E = Swamp Hdwoods	M = Mpl, Bch, Brch	R = Red Pine	X = Non Stocked
F = Spruce Fir	MC = Mixed Conifer	S = Black Spruce	Z = Water
G = Grass	MD = Mixed Deciduous	T = Tamarack	

**Density**

0 = Non Stocked	5 = Pole Timber Medium
1 = Seedling Sapling Poor	6 = Pole Timber Well
2 = Seedling Sapling Medium	7 = Saw Timber Poor
3 = Seedling Sapling Well	8 = Saw Timber Medium
4 = Pole Timber Poor	9 = Saw Timber Well

PU	Acres	PU	Acres
1	28.1	4	50.1
2	19.1	5	51.3
3	64.7		

## Down Range Hardwoods

### Compartment 208

213.3 Acres

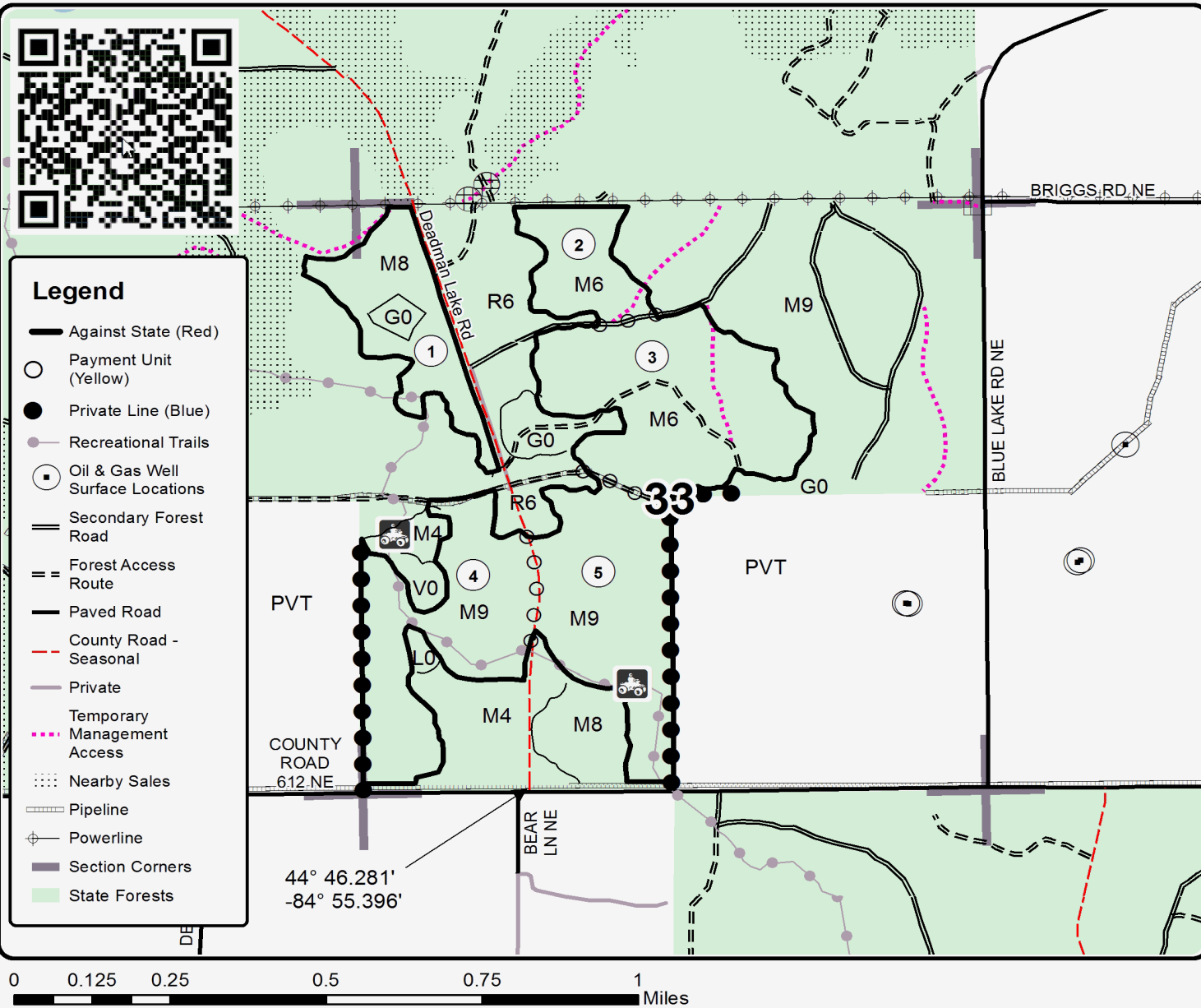
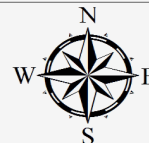



## TIMBER SALE MAP

This information provided by authority of Part 525, 1994 PA 451, as amended.

Sale Number	Year
61-114	21

Forest Management Unit	County	Mapped By	Date	Page	of
Traverse City	Kalkaska	Crugier	02/18/21	1	1
Township	Range	Section(s) and Subdivision(s)	Scale		
28N	05W	Section 33	1:15,840		

Cover Type				Density	
A = Aspen	H = Hemlock	N = Marsh	U = Upland Brush	0 = Non Stocked	5 = Pole Timber Medium
B = Paper Birch	J = Jack Pine	O = Oak	UM = Upland Mixed	1 = Seedling Sapling Poor	6 = Pole Timber Well
C = Cedar	L = Lowland Brush	P = Lowland Poplar	V = Bog or Marsh	2 = Seedling Sapling Medium	7 = Saw Timber Poor
D = Treed Bog	LM = Lowland Mixed	Q = Mixed Swamp Conifer	W = White Pine	3 = Seedling Sapling Well	8 = Saw Timber Medium
E = Swamp Hdwoods	M = Mpl, Bch, Brch	R = Red Pine	X = Non Stocked	4 = Pole Timber Poor	9 = Saw Timber Well
F = Spruce Fir	MC = Mixed Conifer	S = Black Spruce	Z = Water		
G = Grass	MD = Mixed Deciduous	T = Tamarack			

PU	Acres	PU	Acres
1	28.1	4	50.1
2	19.1	5	51.3
3	64.7		

## Down Range Hardwoods

### Compartment 208

213.3 Acres

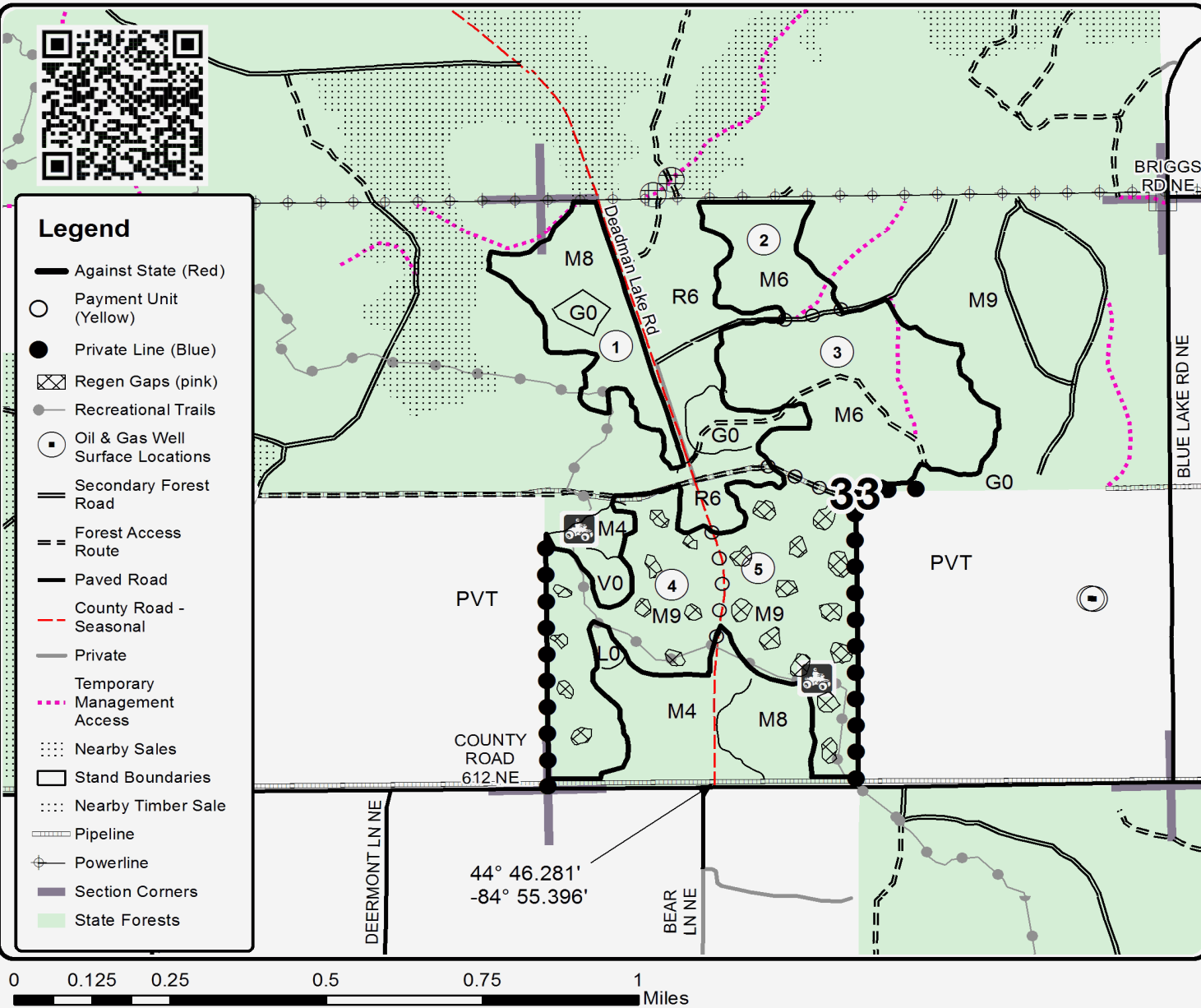
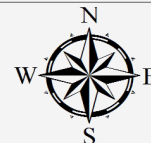



**DEPARTMENT OF NATURAL RESOURCES  
STATE OF MICHIGAN**

**TIMBER SALE PROSPECTUS #6955**

**REVISION NOTICE #1 - January 6, 2022**

SCHEDULED SALE DATE AND TIME: 4:00 p.m. (local time) on Monday, January 24, 2022

LOCATION: TRAVERSE CITY MGMT UNIT, 2122 M 37 South, Traverse City, MI 49685

The sale conditions for the Down Range Hardwoods timber sale (61-114-21) have been updated. Please use the attached sale conditions when bidding on this sale and disregard the original sale conditions sent with the prospectus.

We apologize for any inconvenience this may have caused. If you need assistance, please contact David Lemmien at 231-922-6040.

## **Sale Specific Conditions & Requirements**

**Sale Name: Down Range Hardwoods**

**Sale Number: 61-114-21    Seq#: 1**

### **1 - Sale Area**

#### **1.2 - Boundaries**

##### **1.2.1 - Painted boundaries (9/19)**

The sale boundary and Payment Unit boundaries are marked and identified by blue, red, and yellow paint. Exterior sale boundary lines against private property are marked with blue paint. Exterior sale boundary lines against state are marked with red paint. Interior Payment Unit boundaries are marked with yellow paint. The painted boundary line trees are not Included Timber and are to be protected unless marked with orange paint.

### **2 - Timber Specifications**

#### **2.1 - Included Timber**

##### **2.1.3 - Cut tree marked unit(s) (12/08)**

Within Payment Unit(s) 2-5, all trees are designated for cutting when marked with orange paint above and below stump height, regardless of merchantability. In addition, cut all ironwood, beech, and aspen, except for those marked with an orange 'X'. Cut all trees within the pink boundary line within units 4 & 5.

##### **2.1.5 - Overstory removal unit(s) (8/11)**

Within Payment Unit(s) 1, all trees with DBH equal to or greater than 4 inches which meet minimum piece specifications in 2.2 Utilization, are designated for cutting, except trees marked with green paint.

#### **2.2 - Utilization**

##### **2.2.4 - Skidding length (2/14)**

Skidding of unlimbed tops or lengths over 17 feet is not permissible.

### **3 - Payments**

#### **3.3 - Pre-measured Sales**

##### **3.3.4 - Dividing payment units (7/14)**

Payment Unit(s) 1-5 may be divided at the request of the Purchaser and upon approval of the Unit Manager. Dividing Payment Units is a contract modification which requires a Timber Sale Contract Amendment. There will be only one division per Payment Unit.

#### **3.4 - Damaged Timber**

##### **3.4.1 - Damaged timber (7/16)**

General Condition and Requirement 3.4 Damaged Timber, defines liquidated damages for undesignated live merchantable trees which are cut or injured. In addition, extreme care should be taken to avoid damage to tree seedlings and saplings.

Within the Sale Area, if more than 20% of the tree seedlings or saplings (1/4" to 4.5" DBH) within a specified portion of the Sale Area are damaged, liquidated damages will be assessed at \$200 per acre for all acreage within that specified portion of the Sale Area that was damaged.

No damage is acceptable to undesignated live merchantable trees. Within the Sale Area, if more than 10 % of trees (> 4.5" DBH) within a specified area of the sale are damaged, liquidated damages will be assessed for all trees damaged. Rates will be in accordance with General Condition and Requirement 3.4 Damaged Timber.

### **4 - Transportation**

#### **4.1 - Construction**

**4.1.6 - Road construction (1/09)**

Construction of new roads or improvements of existing roads shall be done in such a way as to minimize the environmental and visual impacts. Merchantable trees shall be cut and utilized unless otherwise directed.

Non-merchantable trees shall be severed and laid flat on the ground. Slash shall be scattered, and not left in windrows and kept a minimum of 10 feet back from the road edge. Stumps shall be set upright, not left on edge, and be moved at least 10 feet away from the road edge. Disturbed soil shall be feathered into the woods and not left in berms or windrows.

**4.1.7 - Road closure (10/11)**

All new roads built into the sale must be blocked to vehicle traffic within 30 days of completion of hauling. Overgrown roads that are reopened shall be considered new roads. In general, this will require constructing a four (4') foot high berm of stumps and logs covered with earth. These roads must be rendered impassable to cars and trucks. Contact the sale administrator for specific details of design and placement.

**5 - Operations****5.2 - Conduct of Operations****5.2.1 - Slash****5.2.1.8 - Slash height (12/08)**

No slash or tree tops may exceed 24 inches in height.

**5.2.3 - Operating Restrictions****5.2.3.3 - Bark slippage restriction (3/09)**

Within Payment Unit(s) 1-5, cutting and skidding are not permitted during the period of April 15 to July 15. This restriction is because of bark slippage.

**5.2.32 - Decking/landing restoration (9/13)**

All decking and landing areas must have the surface area restored to a condition equal to or better than before. This is to ensure the proper regeneration of the stand.

**5.2.38 - No decking against live trees (2/04)**

Cut products may not be decked against unmarked or designated leave trees.

**5.2.39 - ORV trail/route protection (4/18)**

There is an ORV trail and it is shown on the Timber Sale Map. Do not cut trees or damage posts with ORV markers. All stumps within 5 feet of the trail must be cut flush with the ground. Maintain a 20-foot-wide slash, debris, and rut free zone daily using the ORV trail or route as the centerline. Do not run equipment down the ORV trail. Skidding across the trail or route may only occur in locations approved by the sale administrator.

**5.4 - Soil Protection****5.4.1 - Rutting restriction, general (7/16)**

Operations are to cease immediately if equipment and weather conditions result in rutting of roads and/or skid trails which is 12 inches or greater in depth and 50 feet in length. The Unit Manager or his/her representative may restrict hauling and/or skidding if ruts exceed the specified depth. With the Unit Manager or his/her representative's approval, the Purchaser may return to the area when the risk of rutting has decreased.

**5.8 - Protection of Endangered Species****5.8.5 - Protection of raptor nests (3/13)**

All trees with raptor nests will be protected if found during harvesting operations. Notification will be made to the Unit Manager or his/her representative who will notify the Wildlife Biologist so an on-site evaluation and recommendation can be made, if necessary.

**6 - Safety and Fire Prevention****6.2 - Signing****6.2.1 - Road posting (10/20)**

The Purchaser is responsible for posting and maintaining caution signs on Deadman Lake Road prior to beginning operations. The road must be posted at appropriate distances from the Sale Area to warn of logging activity and truck traffic. Signs must be removed when harvest operations are suspended or completed. The Purchaser will provide these signs.

**6.2.3 - Recreational trail posting (10/20)**

The Purchaser is responsible for posting and maintaining caution signs on the ORV trail prior to beginning operations. The trail must be posted at appropriate distances from the Sale Area to warn of logging activity and truck traffic at both ends of the trail. Signs must be removed when harvest operations are suspended or completed. The Purchaser will provide these signs.



**DEPARTMENT OF NATURAL RESOURCES  
STATE OF MICHIGAN**

**TIMBER SALE PROSPECTUS #6955**

SCHEDULED SALE DATE AND TIME: 4:00 p.m. (local time) on January 24, 2022.

LOCATION: TRAVERSE CITY MGMT UNIT, 2122 M 37 SOUTH, TRAVERSE CITY, MI 49685.

CONTACT NAME: David Lemmien

PHONE NUMBER: (231) 922-6040

PROSPECTUS NOTE: Effective immediately: all bid openings for the Traverse City Management (Kalkaska Field Office and Traverse City Field Office) will be held at the Traverse City Field Office regardless of sale location within the unit. All payments will now be handled through the Traverse City Field Office. The Kalkaska Field Office will no longer accept payments or hard paper copies of timber sale bids. Payments for all contracts, use permits, bonds, etc. should be sent to the Traverse City Field Office.

The bidder is advised to inspect the sale area and review the location, estimated volumes, operating costs and contract terms of proposed sales. Please be aware that some landowners may request 60 days or more notice for access across their land.

Notice is hereby given that bids will be received by the Unit Manager, TRAVERSE CITY MANAGEMENT UNIT, for certain timber on the following described lands:

Down Range Hardwoods (61-114-21) / T28N, R05W, SEC. 32, NENE.

T28N, R05W, SEC. 33, NW, W1/2NE, SW.

Kalkaska County, Advertised Price \$144,482.85, 213.3 Acres, Hardwood, Sugar Maple.

SALE NOTE: All units of volume listed for this sale were estimated using the Inventory Manager computer program and the new Michigan taper model.

A recreation site such as a trail, pathway, or campground is within the sale area or the vicinity. Certain restrictions/specifications may be applicable including time restrictions.



## TIMBER SALE INFORMATION

### Down Range Hardwoods (61-114-21)

T28N, R05W, SEC. 32; T28N, R05W, SEC. 33.

Kalkaska County (Advertised Price \$144,482.85)

**SALE NOTE:** All units of volume listed for this sale were estimated using the Inventory Manager computer program and the new Michigan taper model.

A recreation site such as a trail, pathway, or campground is within the sale area or the vicinity. Certain restrictions/specifications may be applicable including time restrictions.

A timber sale contract for this lump sum, sealed bid timber sale will be awarded to the responsible bidder offering the highest sealed bid price. All units of volume listed below were estimated using the Inventory Manager computer program and the new Michigan taper model. Bids must be at or above the following advertised price for each product and species:

<u>PRODUCTS &amp; SPECIES</u>	<u>ESTIMATED UNITS*</u>		<u>ADVERTISED PRICE</u>
Sawtimber			
Basswood	240.0	MBF	\$ 87.00 / MBF
Beech	9.3	MBF	\$ 90.00 / MBF
Black Cherry	250.8	MBF	\$ 147.00 / MBF
Quaking Aspen	14.2	MBF	\$ 94.00 / MBF
Red Maple	190.6	MBF	\$ 126.00 / MBF
Red Pine	1.3	MBF	\$ 84.00 / MBF
Sugar Maple	115.3	MBF	\$ 206.00 / MBF
White Pine	15.0	MBF	\$ 34.00 / MBF
Pulpwood			
Basswood	344	Cords	\$ 13.85 / Cord
Black Cherry	539	Cords	\$ 13.45 / Cord
Mixed Hardwood	31	Cords	\$ 13.45 / Cord
Quaking Aspen	92	Cords	\$ 12.80 / Cord
Red Maple	681	Cords	\$ 13.45 / Cord
Red Pine	32	Cords	\$ 33.40 / Cord
Sugar Maple	842	Cords	\$ 13.45 / Cord
White Pine	72	Cords	\$ 14.10 / Cord

\* The total volume is statistically estimated within plus (+) or minus (-) 4.34 percent. There are an estimated 4,720 cords on this timber sale, plus or minus 205 cords at the 95% confidence level. The estimated units are final and not subject to adjustment. Prospective bidders are urged to examine this timber and to make their own estimates of quantity and quality.

### **BOND AND PAYMENT SCHEDULE:**

1. A bond in the amount of \$11,558.63 to insure faithful performance of the conditions of the contract will be deposited by the successful bidder within 21 days of the sale award.
2. Cutting in any sale or unit without the required advance payment would be considered a trespass.
3. Total payment must be paid in advance or according to the following schedule:
  - (a) Ten percent (10%) of the sale value must be paid within 21 days of the sale award.
  - (b) The 10% down payment will be credited towards the first unit cut.
  - (c) Payment for each of the following units must be made before cutting begins in that unit:

PAYMENT UNIT NUMBER	PERCENT OF TOTAL SALE VALUE
01	21.8%
02	8.1%
03	27.4%
04	21.1%
05	21.6%

4. If no cutting takes place, the 10% down payment will not be refunded.
5. Operations on the contract issued will terminate on 04/14/2025.

### **SALE STATISTICS**

Volumes were calculated in cubic feet using the Michigan taper model. Cubic foot volume includes all wood inside bark for the product indicated. For display purposes, cubic feet were converted to cords and MBF using a simple conversion factor, e.g. 79 cubic feet per cord and 185 cubic feet per MBF. The cubic foot volumes are precise; the cords and MBF volumes are not. Cubic foot volume cannot be directly converted to cords or boards with precision.

SALE VOLUMES

The total estimated sale volume may not equal the sum of the species/products due to the nature of statistical calculations associated with double sampling methodology.

VOLUME			STATISTICAL RANGE IN CORDS	
TOTAL CUBIC FEET	TOTAL CORDS	PERCENT ERROR	MINIMUM	MAXIMUM
372,879	4,720	4.34%	4,515	4,925

VDU VOLUMES

A VDU is a Volume Determination Unit. Volumes and their associated statistics are calculated at the VDU level and summarized to the sale level. There is often a one to one relationship between a VDU and a Payment Unit, but not always, depending on the cruise design. Refer to the VDU TO PAYMENT UNIT table.

	VOLUME			RANGE IN CORDS	
VDU	TOTAL CUBIC FEET	TOTAL CORDS	PERCENT ERROR	MINIMUM	MAXIMUM
25	74,565	944	11.75%	833	1,055
31	140,201	1,775	6.31%	1,663	1,887
38	125,375	1,587	6.41%	1,485	1,689
TOTAL:	340,141	4,306		3,981	4,630

VDU TO PAYMENT UNIT

When a VDU is associated with more than one Payment Unit (PU), the VDU volumes are assigned to the PU based on acres of the VDU within the PU.

VDU	VDU ACRES	PU	PU ACRES
25	28.1	1	28.1
31	105.9	3	4.5
		4	50.1
		5	51.3
38	79.3	2	19.1
		3	60.2
TOTAL:	213.3		213.3

**DESCRIPTION OF TIMBER BY PU (PU)**

PU	MARKET GROUP	PRODUCT	QUANTITY	UNIT	ACRES	ADVERTISE PRICE
1	Black Cherry	Sawtimber	143.5	MBF	28.1	\$31,484.20
	Quaking Aspen		9.7	MBF		
	Red Maple		7.6	MBF		
	White Pine		15.0	MBF		
	Black Cherry	Pulpwood	299	Cords		
	Quaking Aspen		19	Cords		
	Red Maple		203	Cords		
	White Pine		72	Cords		
2	Basswood	Sawtimber	41.7	MBF	19.1	\$11,687.35
	Beech		2.2	MBF		
	Black Cherry		3.5	MBF		
	Quaking Aspen		1.1	MBF		
	Red Maple		14.7	MBF		
	Sugar Maple		10.8	MBF		
	Basswood	Pulpwood	66	Cords		
	Black Cherry		12	Cords		
	Mixed Hardwood		7	Cords		
	<i>Beech</i>		5	Cords		
	<i>Ironwood</i>		1	Cords		
	<i>Yellow Birch</i>		1	Cords		
	Quaking Aspen		11	Cords		
	Red Maple		43	Cords		
	Sugar Maple		95	Cords		
3	Basswood	Sawtimber	134.1	MBF	64.7	\$39,609.90
	Beech		7.1	MBF		
	Black Cherry		15.0	MBF		
	Quaking Aspen		3.4	MBF		
	Red Maple		51.5	MBF		
	Red Pine		0.1	MBF		
	Sugar Maple		37.1	MBF		
	Basswood	Pulpwood	212	Cords		
	Black Cherry		46	Cords		
	Mixed Hardwood		22	Cords		
	<i>Beech</i>		15	Cords		
	<i>Ironwood</i>		4	Cords		
	<i>Yellow Birch</i>		3	Cords		
	Quaking Aspen		36	Cords		
	Red Maple		148	Cords		
	Red Pine		1	Cords		
	Sugar Maple		320	Cords		
4	Basswood	Sawtimber	31.7	MBF	50.1	\$30,487.85
	Black Cherry		43.9	MBF		
	Red Maple		57.7	MBF		
	Red Pine		0.6	MBF		
	Sugar Maple		33.3	MBF		
	Basswood	Pulpwood	33	Cords		
	Black Cherry		90	Cords		
	Mixed Hardwood		1	Cords		
	<i>Ironwood</i>		1	Cords		
	Quaking Aspen		13	Cords		
	Red Maple		142	Cords		
	Red Pine		15	Cords		
	Sugar Maple		211	Cords		
5	Basswood	Sawtimber	32.5	MBF	51.3	\$31,213.55
	Black Cherry		44.9	MBF		

DESCRIPTION OF TIMBER BY PU (PU), CON'T

PU	MARKET GROUP	PRODUCT	QUANTITY	UNIT	ACRES	ADVERTISE PRICE
5 con't	Red Maple	Sawtimber	59.1	MBF		
	Red Pine		0.6	MBF		
	Sugar Maple		34.1	MBF		
	Basswood	Pulpwood	33	Cords		
	Black Cherry		92	Cords		
	Mixed Hardwood		1	Cords		
	Ironwood		1	Cords		
	Quaking Aspen		13	Cords		
	Red Maple		145	Cords		
	Red Pine		16	Cords		
	Sugar Maple	216	Cords			
TOTAL:			836.5	MBF		
TOTAL:			2,633	Cords		

## **Sale Specific Conditions & Requirements**

**Sale Name: Down Range Hardwoods**

**Sale Number: 61-114-21 Seq#: 1**

### **1 - Sale Area**

#### **1.2 - Boundaries**

##### **1.2.1 - Painted boundaries (9/19)**

The sale boundary and Payment Unit boundaries are marked and identified by blue, red, and yellow paint. Exterior sale boundary lines against private property are marked with blue paint. Exterior sale boundary lines against state are marked with red paint. Interior Payment Unit boundaries are marked with yellow paint. The painted boundary line trees are not Included Timber and are to be protected unless marked with orange paint.

### **2 - Timber Specifications**

#### **2.1 - Included Timber**

##### **2.1.3 - Cut tree marked unit(s) (12/08)**

Within Payment Unit(s) 2-5, all trees are designated for cutting when marked with orange paint above and below stump height, regardless of merchantability. In addition, cut all ironwood, beech, and aspen, except for those marked with an orange 'X'.

##### **2.1.5 - Overstory removal unit(s) (8/11)**

Within Payment Unit(s) 1, all trees with DBH equal to or greater than 4 inches which meet minimum piece specifications in 2.2 Utilization, are designated for cutting, except trees marked with green paint.

#### **2.2 - Utilization**

##### **2.2.4 - Skidding length (2/14)**

Skidding of unlimbed tops or lengths over 17 feet is not permissible.

### **3 - Payments**

#### **3.3 - Pre-measured Sales**

##### **3.3.4 - Dividing payment units (7/14)**

Payment Unit(s) 1-5 may be divided at the request of the Purchaser and upon approval of the Unit Manager. Dividing Payment Units is a contract modification which requires a Timber Sale Contract Amendment. There will be only one division per Payment Unit.

#### **3.4 - Damaged Timber**

##### **3.4.1 - Damaged timber (7/16)**

General Condition and Requirement 3.4 Damaged Timber, defines liquidated damages for undesignated live merchantable trees which are cut or injured. In addition, extreme care should be taken to avoid damage to tree seedlings and saplings.

Within the Sale Area, if more than 20% of the tree seedlings or saplings (1/4" to 4.5" DBH) within a specified portion of the Sale Area are damaged, liquidated damages will be assessed at \$200 per acre for all acreage within that specified portion of the Sale Area that was damaged.

No damage is acceptable to undesignated live merchantable trees. Within the Sale Area, if more than 10 % of trees (> 4.5" DBH) within a specified area of the sale are damaged, liquidated damages will be assessed for all trees damaged. Rates will be in accordance with General Condition and Requirement 3.4 Damaged Timber.

### **4 - Transportation**

#### **4.1 - Construction**

##### **4.1.6 - Road construction (1/09)**

Construction of new roads or improvements of existing roads shall be done in such a way as to minimize the environmental and visual impacts. Merchantable trees shall be cut and utilized unless otherwise directed. Non-merchantable trees shall be

severed and laid flat on the ground. Slash shall be scattered, and not left in windrows and kept a minimum of 10 feet back from the road edge. Stumps shall be set upright, not left on edge, and be moved at least 10 feet away from the road edge. Disturbed soil shall be feathered into the woods and not left in berms or windrows.

#### 4.1.7 - Road closure (10/11)

All new roads built into the sale must be blocked to vehicle traffic within 30 days of completion of hauling. Overgrown roads that are reopened shall be considered new roads. In general, this will require constructing a four (4') foot high berm of stumps and logs covered with earth. These roads must be rendered impassable to cars and trucks. Contact the sale administrator for specific details of design and placement.

## 5 - Operations

### 5.2 - Conduct of Operations

#### 5.2.1 - Slash

##### 5.2.1.8 - Slash height (12/08)

No slash or tree tops may exceed 24 inches in height.

#### 5.2.3 - Operating Restrictions

##### 5.2.3.3 - Bark slippage restriction (3/09)

Within Payment Unit(s) 1-5, cutting and skidding are not permitted during the period of April 15 to July 15. This restriction is because of bark slippage.

#### 5.2.32 - Decking/landing restoration (9/13)

All decking and landing areas must have the surface area restored to a condition equal to or better than before. This is to ensure the proper regeneration of the stand.

#### 5.2.38 - No decking against live trees (2/04)

Cut products may not be decked against unmarked or designated leave trees.

#### 5.2.39 - ORV trail/route protection (4/18)

There is an ORV trail and it is shown on the Timber Sale Map. Do not cut trees or damage posts with ORV markers. All stumps within 5 feet of the trail must be cut flush with the ground. Maintain a 20-foot-wide slash, debris, and rut free zone daily using the ORV trail or route as the centerline. Do not run equipment down the ORV trail. Skidding across the trail or route may only occur in locations approved by the sale administrator.

### 5.4 - Soil Protection

#### 5.4.1 - Rutting restriction, general (7/16)

Operations are to cease immediately if equipment and weather conditions result in rutting of roads and/or skid trails which is 12 inches or greater in depth and 50 feet in length. The Unit Manager or his/her representative may restrict hauling and/or skidding if ruts exceed the specified depth. With the Unit Manager or his/her representative's approval, the Purchaser may return to the area when the risk of rutting has decreased.

### 5.8 - Protection of Endangered Species

#### 5.8.5 - Protection of raptor nests (3/13)

All trees with raptor nests will be protected if found during harvesting operations. Notification will be made to the Unit Manager or his/her representative who will notify the Wildlife Biologist so an on-site evaluation and recommendation can be made, if necessary.

## 6 - Safety and Fire Prevention

### 6.2 - Signing

#### 6.2.1 - Road posting (10/20)

The Purchaser is responsible for posting and maintaining caution signs on Deadman Lake Road prior to beginning operations. The road must be posted at appropriate distances from the Sale Area to warn of logging activity and truck traffic. Signs must be removed when harvest operations are suspended or completed. The Purchaser will provide these signs.

#### 6.2.3 - Recreational trail posting (10/20)

The Purchaser is responsible for posting and maintaining caution signs on the ORV trail prior to beginning operations. The trail must be posted at appropriate distances from the Sale Area to warn of logging activity and truck traffic at both ends of the trail. Signs must be removed when harvest operations are suspended or completed. The Purchaser will provide these signs.

**TIMBER SALE MAP**

This information provided by authority of Part 525, 1994 PA 451, as amended.

Sale Number	Year
61-114	21

Forest Management Unit Traverse City	County Kalkaska	Mapped By Crigier	Date 02/18/21	Page 1	of 1
Township 28N	Range 05W	Section(s) and Subdivision(s) Section 33	Scale 1:15,840		

Cover Type				Density	
A = Aspen	H = Hemlock	N = Marsh	U = Upland Brush	0 = Non Stocked	5 = Pole Timber Medium
B = Paper Birch	J = Jack Pine	O = Oak	UM = Upland Mixed	1 = Seedling Sapling Poor	6 = Pole Timber Well
C = Cedar	L = Lowland Brush	P = Lowland Poplar	V = Bog or Marsh	2 = Seedling Sapling Medium	7 = Saw Timber Poor
D = Treed Bog	LM = Lowland Mixed	Q = Mixed Swamp Conifer	W = White Pine	3 = Seedling Sapling Well	8 = Saw Timber Medium
E = Swamp Hdwoods	M = Mpl, Bch, Brch	R = Red Pine	X = Non Stocked	4 = Pole Timber Poor	9 = Saw Timber Well
F = Spruce Fir	MC = Mixed Conifer	S = Black Spruce	Z = Water		
G = Grass	MD = Mixed Deciduous	T = Tamarack			

PU	Acres	PU	Acres
1	28.1	4	50.1
2	19.1	5	51.3
3	64.7		

## Down Range Hardwoods

### Compartment 208

213.3 Acres

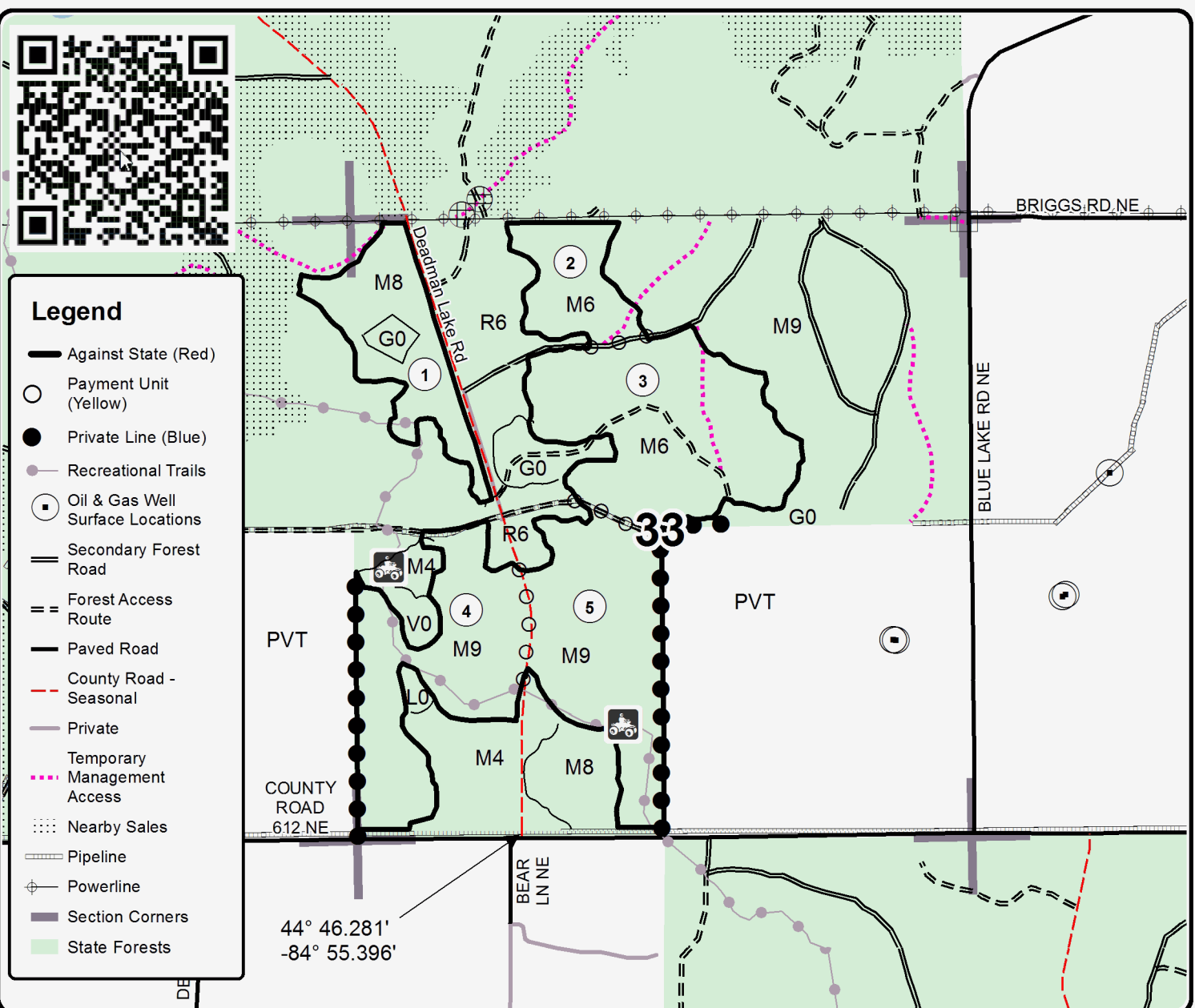

0 0.125 0.25 0.5 0.75 1 Miles