



**DEPARTMENT OF NATURAL RESOURCES
STATE OF MICHIGAN**

TIMBER SALE PROSPECTUS #6904

SCHEDULED SALE DATE AND TIME: **9:00 a.m. (local time) on October 7, 2021.**

LOCATION: **BARAGA MGMT UNIT, 427 US 41 NORTH, BARAGA, MI 49908.**

CONTACT NAME: Brad Carlson

PHONE NUMBER: (906) 353-6651

PROSPECTUS NOTE: The bidder is advised to inspect the sale area and review the location, estimated volumes, operating costs and contract terms of proposed sales. Please be aware that some landowners may request 60 days or more notice for access across their land.

Notice is hereby given that bids will be received by the Unit Manager, BARAGA MANAGEMENT UNIT, for certain timber on the following described lands:

Snake Eyes Mix (11-011-21) / T52N, R37W, SEC. 24, NW,NE,SW.

Ontonagon County, Advertised Price \$85,020.65, 303.4 Acres, Hardwood, Sugar Maple.

SALE NOTE: All units of volume listed for this sale were estimated using the Inventory Manager computer program and the new Michigan taper model.

Access may be through private land.

TIMBER SALE INFORMATION

Snake Eyes Mix (11-011-21)

T52N, R37W, SEC. 24.

Ontonagon County (Advertised Price \$85,020.65)

SALE NOTE: All units of volume listed for this sale were estimated using the Inventory Manager computer program and the new Michigan taper model.

Access may be through private land.

A timber sale contract for this lump sum, sealed bid timber sale will be awarded to the responsible bidder offering the highest sealed bid price. All units of volume listed below were estimated using the Inventory Manager computer program and the new Michigan taper model. Bids must be at or above the following advertised price for each product and species:

<u>PRODUCTS & SPECIES</u>	<u>ESTIMATED UNITS*</u>	<u>ADVERTISED PRICE</u>
Sawtimber		
Basswood	111.2 MBF	\$ 32.00 / MBF
Red Maple	33.8 MBF	\$ 64.00 / MBF
Red Oak	7.9 MBF	\$ 66.00 / MBF
Sugar Maple	457.2 MBF	\$ 130.00 / MBF
White Ash	119.0 MBF	\$ 31.00 / MBF
Yellow Birch	50.3 MBF	\$ 33.00 / MBF
Pulpwood		
Balsam Fir	12 Cords	\$ 1.90 / Cord
Basswood	376 Cords	\$ 3.40 / Cord
Mixed Aspen	110 Cords	\$ 11.00 / Cord
Mixed Hardwood	2,627 Cords	\$ 4.30 / Cord
Red Oak	9 Cords	\$ 17.55 / Cord
White Spruce	11 Cords	\$ 2.50 / Cord

* The total volume is statistically estimated within plus (+) or minus (-) 4.05 percent. There are an estimated 5,066 cords on this timber sale, plus or minus 205 cords at the 95% confidence level. The estimated units are final and not subject to adjustment. Prospective bidders are urged to examine this timber and to make their own estimates of quantity and quality.

BOND AND PAYMENT SCHEDULE:

1. A bond in the amount of \$7,500.00 to insure faithful performance of the conditions of the contract will be deposited by the successful bidder within 21 days of the sale award.
2. Cutting in any sale or unit without the required advance payment would be considered a trespass.
3. Total payment must be paid in advance or according to the following schedule :
 - (a) Ten percent (10%) of the sale value must be paid within 21 days of the sale award.
 - (b) The 10% down payment will be credited towards the first unit cut.
 - (c) Payment for each of the following units must be made before cutting begins in that unit:

<u>PAYMENT UNIT NUMBER</u>	<u>PERCENT OF TOTAL SALE VALUE</u>
01	30.2%
02	10.6%
03	8.6%
04	8.8%
05	11.5%
06	9.1%
07	15.0%
08	6.2%

4. If no cutting takes place, the 10% down payment will not be refunded.
5. Operations on the contract issued will terminate on 06/30/2024.

SALE STATISTICS

Volumes were calculated in cubic feet using the Michigan taper model. Cubic foot volume includes all wood inside bark for the product indicated. For display purposes, cubic feet were converted to cords and MBF using a simple conversion factor, e.g. 79 cubic feet per cord and 185 cubic feet per MBF. The cubic foot volumes are precise; the cords and MBF volumes are not. Cubic foot volume cannot be directly converted to cords or boards with precision.

SALE VOLUMES

The total estimated sale volume may not equal the sum of the species/products due to the nature of statistical calculations associated with double sampling methodology.

VOLUME			STATISTICAL RANGE IN CORDS	
TOTAL CUBIC FEET	TOTAL CORDS	PERCENT ERROR	MINIMUM	MAXIMUM
400,235	5,066	4.05%	4,861	5,272

VDU VOLUMES

A VDU is a Volume Determination Unit. Volumes and their associated statistics are calculated at the VDU level and summarized to the sale level. There is often a one to one relationship between a VDU and a Payment Unit, but not always, depending on the cruise design. Refer to the VDU TO PAYMENT UNIT table.

	VOLUME			RANGE IN CORDS	
VDU	TOTAL CUBIC FEET	TOTAL CORDS	PERCENT ERROR	MINIMUM	MAXIMUM
1	57,463	727	6.46%	680	774
2	144,831	1,833	7.99%	1,687	1,980
3	64,661	818	6.96%	762	875
4	77,332	979	8.08%	900	1,058
5	27,338	346	16.67%	288	404
TOTAL:	371,625	4,704		4,317	5,091

VDU TO PAYMENT UNIT

When a VDU is associated with more than one Payment Unit (PU), the VDU volumes are assigned to the PU based on acres of the VDU within the PU.

VDU	VDU ACRES	PU	PU ACRES
1	66.8	2	32.0
		5	34.8
2	48.8	1	48.8
3	80.2	3	39.7
		4	40.5
4	77.6	6	29.3
		7	48.3
5	30.0	8	30.0
TOTAL:	303.4		303.4

DESCRIPTION OF TIMBER BY PU (PU)

PU	MARKET GROUP	PRODUCT	QUANTITY	UNIT	ACRES	ADVERTISE PRICE
1	Basswood	Sawtimber	44.9	MBF	48.8	\$25,690.40
	Sugar Maple		116.8	MBF		
	White Ash		65.2	MBF		
	Yellow Birch		35.1	MBF		
	Basswood		Pulpwood	161		
	Mixed Aspen	60		Cords		
	<i>B. T. Aspen</i>	34		Cords		
	<i>Balsam Poplar</i>	17		Cords		
	<i>Quaking Aspen</i>	9		Cords		
	Mixed Hardwood	1,089		Cords		
	<i>Black Ash</i>	12		Cords		
	<i>Ironwood</i>	12		Cords		
	<i>Sugar Maple</i>	657		Cords		
	<i>White Ash</i>	127		Cords		
	<i>Yellow Birch</i>	281	Cords			
2	Basswood	Sawtimber	9.9	MBF	32.0	\$9,000.60
	Red Maple		5.6	MBF		
	Sugar Maple		54.9	MBF		
	White Ash		11.7	MBF		
	Yellow Birch		1.9	MBF		
	Basswood	Pulpwood	17	Cords		
	Mixed Hardwood		164	Cords		
	<i>Red Maple</i>		4	Cords		
	<i>Sugar Maple</i>		128	Cords		
	<i>White Ash</i>		10	Cords		
	<i>Yellow Birch</i>		22	Cords		
3	Basswood	Sawtimber	11.0	MBF	39.7	\$7,322.40
	Red Maple		10.7	MBF		
	Red Oak		3.9	MBF		
	Sugar Maple		34.0	MBF		
	White Ash		12.5	MBF		
	Yellow Birch		3.4	MBF		
	Basswood		Pulpwood	36		
	Mixed Hardwood	213		Cords		
	<i>Black Ash</i>	3		Cords		
	<i>Ironwood</i>	1		Cords		
	<i>Red Maple</i>	28		Cords		
	<i>Sugar Maple</i>	145		Cords		
	<i>White Ash</i>	13		Cords		
	<i>Yellow Birch</i>	23	Cords			
Red Oak	4	Cords				
4	Basswood	Sawtimber	11.3	MBF	40.5	\$7,488.75
	Red Maple		11.0	MBF		
	Red Oak		4.0	MBF		
	Sugar Maple		34.6	MBF		
	White Ash		12.7	MBF		
	Yellow Birch		3.4	MBF		
	Basswood		Pulpwood	37		
	Mixed Hardwood	219		Cords		
	<i>Black Ash</i>	4		Cords		
	<i>Ironwood</i>	2		Cords		
	<i>Red Maple</i>	28		Cords		
	<i>Sugar Maple</i>	147		Cords		
	<i>White Ash</i>	14		Cords		
	<i>Yellow Birch</i>	24	Cords			

DESCRIPTION OF TIMBER BY PU (PU), CON'T

PU	MARKET GROUP	PRODUCT	QUANTITY	UNIT	ACRES	ADVERTISE PRICE
4 con't	Red Oak	Pulpwood	5	Cords		
5	Basswood	Sawtimber	10.7	MBF	34.8	\$9,780.10
	Red Maple		6.0	MBF		
	Sugar Maple		59.7	MBF		
	White Ash		12.8	MBF		
	Yellow Birch		2.1	MBF		
	Basswood	Pulpwood	18	Cords		
	Mixed Hardwood		178	Cords		
	<i>Red Maple</i>		5	<i>Cords</i>		
	<i>Sugar Maple</i>		139	<i>Cords</i>		
	<i>White Ash</i>		11	<i>Cords</i>		
	<i>Yellow Birch</i>		23	<i>Cords</i>		
6	Basswood	Sawtimber	8.8	MBF	29.3	\$7,721.70
	Sugar Maple		48.5	MBF		
	White Ash		1.5	MBF		
	Yellow Birch		1.7	MBF		
	Balsam Fir	Pulpwood	5	Cords		
	Basswood		40	Cords		
	Mixed Aspen		2	Cords		
	<i>Quaking Aspen</i>		2	<i>Cords</i>		
	Mixed Hardwood		200	Cords		
	<i>Black Ash</i>		2	<i>Cords</i>		
	<i>Red Maple</i>		2	<i>Cords</i>		
	<i>Sugar Maple</i>		177	<i>Cords</i>		
	<i>White Ash</i>		2	<i>Cords</i>		
	<i>Yellow Birch</i>		17	<i>Cords</i>		
	White Spruce		2	Cords		
7	Basswood	Sawtimber	14.6	MBF	48.3	\$12,722.60
	Sugar Maple		79.9	MBF		
	White Ash		2.6	MBF		
	Yellow Birch		2.7	MBF		
	Balsam Fir	Pulpwood	7	Cords		
	Basswood		67	Cords		
	Mixed Aspen		4	Cords		
	<i>Quaking Aspen</i>		4	<i>Cords</i>		
	Mixed Hardwood		327	Cords		
	<i>Black Ash</i>		3	<i>Cords</i>		
	<i>Red Maple</i>		3	<i>Cords</i>		
	<i>Sugar Maple</i>		292	<i>Cords</i>		
	<i>White Ash</i>		2	<i>Cords</i>		
	<i>Yellow Birch</i>		27	<i>Cords</i>		
	White Spruce		3	Cords		
8	Red Maple	Sawtimber	0.5	MBF	30.0	\$5,294.10
	Sugar Maple		28.8	MBF		
	Mixed Aspen	Pulpwood	44	Cords		
	<i>Quaking Aspen</i>		44	<i>Cords</i>		
	Mixed Hardwood		237	Cords		
	<i>Red Maple</i>		16	<i>Cords</i>		
	<i>Sugar Maple</i>		201	<i>Cords</i>		
	<i>Yellow Birch</i>		20	<i>Cords</i>		
	White Spruce		6	Cords		
TOTAL:			779.4	MBF		
TOTAL:			3,145	Cords		

Sale Specific Conditions & Requirements

Sale Name: Snake Eyes Mix

Sale Number: 11-011-21 Seq#: 1

1 - Sale Area

1.2 - Boundaries

1.2.1 - Painted boundaries (9/19)

The sale boundary and Payment Unit boundaries are marked and identified by blue and red paint. Exterior sale boundary lines against private property are marked with blue paint. Exterior sale boundary lines against state are marked with red paint. Interior Payment Unit boundaries are marked with red paint. The painted boundary line trees are not Included timber and are to be protected unless marked with orange paint. Red painted trees designating an interior Payment Unit boundary are only to be cut when all surrounding Payment Units have been paid.

2 - Timber Specifications

2.1 - Included Timber

2.1.1 - Clearcut unit(s) with unmerchantable trees (6/14)

Within Payment Unit(s) 1, cut all species trees that are 4.6 inches or more at DBH, except hemlock, black cherry, cedar, oak, and white pine species. Also, reserve all sugar maple, red maple, yellow birch, basswood, and aspen stems over 22" at DBH.

2.1.3 - Cut tree marked unit(s) (12/08)

Within Payment Unit(s) 2 - 8, all trees are designated for cutting when marked with orange paint above and below stump height, regardless of merchantability.

2.2 - Utilization

2.2.1 - Utilization (2/04)

All listed board foot volumes of sawlog size products in this contract have been determined using a top diameter inside bark of 10 inches.

2.2.4 - Skidding length (2/14)

Skidding of lengths over 17 feet is permissible if the timber sale administrator approves the method and machinery used. If at any point damage exceeds specification 3.4.1, all the remaining wood must be skid in lengths less than 17 feet.

2.2.7 - Uncut designated trees (2/04)

Liquidated damages of \$10.00 per tree will be assessed for every marked tree not cut.

2.2.8 - Utilization and removal (5/14)

All products meeting standards set forth in General Condition and Requirement 2.2 - Utilization must be removed from the Sale Area. This is because excessive woody debris will inhibit regeneration.

3 - Payments

3.4 - Damaged Timber

3.4.1 - Damaged timber (7/16)

General Condition and Requirement 3.4 Damaged Timber, defines liquidated damages for undesignated live merchantable trees which are cut or injured. In addition, extreme care should be taken to avoid damage to tree seedlings and saplings.

4 - Transportation

4.1 - Construction

4.1.1 - Stream crossings, general (3/11)

All stream crossing structures will be temporary and therefore, shall be provided by the Purchaser, and must be removed upon completion of the sale. All permits for stream crossings will be provided by the DNR.

4.1.3 - Slash and earthen piles (8/04)

Piles or windrows of earth along roads and landings that have been widened or constructed shall be leveled. Slash from road maintenance or construction, including stumps, shall be dispersed throughout the Sale Area or chipped, utilized or otherwise removed from the sale.

4.1.5 - Culverts (5/14)

Roads may require the installation of culverts for cross drainage or at natural drainage-ways. If culverts are needed in these locations, their placement will be specified by the sale administrator, and they shall be installed prior to hauling. The culverts shall be new, corrugated metal or plastic gauge. Culverts will be a minimum of 12 inches in diameter and 24 feet in length. If culverts are removed, fill shall be removed from wetland soils as specified. Soils shall be maintained and left in a non-erodible condition, with water bars, seed, fertilizer, mulch, and slash installed as directed by the sale administrator and as specified in the BMP manual. Stream crossing permits, if needed, will be obtained by the DNR.

4.1.6 - Road construction (1/09)

Construction of new roads or improvements of existing roads shall be done in such a way as to minimize the environmental and visual impacts. Merchantable trees shall be cut and utilized unless otherwise directed. Non-merchantable trees shall be severed and laid flat on the ground. Slash shall be scattered, and not left in windrows and kept a minimum of 10 feet back from the road edge or be chipped, utilized or otherwise removed from the sale. Stumps shall be set upright, not left on edge, and be moved at least 10 feet away from the road edge. Disturbed soil shall be feathered into the woods and not left in berms or windrows.

4.1.7 - Road closure (10/11)

All new roads built into the sale must be blocked to vehicle traffic upon completion of the sale. Overgrown roads that are reopened shall be considered new roads. Some existing roads may also need to be closed, see the Timber Sale Map for locations. In general, this will require constructing a four (4') foot high berm of stumps and logs covered with earth. These roads must be rendered impassable to cars and trucks. All stumps from road building and landing construction must be reserved to block any newly constructed roads upon completion of the sale. These stumps must be scattered along the road system to prohibit vehicular movement. Temporary berms may be required if no sale activity occurs for 30 or more consecutive days. Contact the sale administrator for specific details of design and placement.

4.2 - Maintenance

4.2.2 - Fill material (4/07)

To maintain roads, fill material may be needed in areas where "holes" exist or may be expected to develop. This fill material should be placed before trucking begins. Contact the sale administrator regarding the availability of onsite sand or gravel from adjacent State-owned lands.

4.2.4 - Grading (10/16)

For completion of the sale, state forest roads must be graded. In general, this will require a road grader or bulldozer to shape up the roads after forest products have been hauled off site. This includes cleaning of drainage areas, grading, crowning, and filling with gravel, if necessary. The grading equipment to be used must be approved by the Unit Manager or his/her representative.

5 - Operations

5.1 - Notification

5.1.1 - Pre-sale conference (10/16)

A pre-sale conference on site between the Purchaser and sale administrator is required prior to beginning any operations to determine landing and road locations. The Unit Manager or his/her representative must be contacted at least 10 days in advance to schedule the conference.

5.1.4 - Post-sale conference (10/16)

A post-sale conference on site between the Purchaser and sale administrator is required 5 days prior to the completion of active logging operations to determine clean-up and repair of landings, road edges, and the fulfillment of other contract specifications.

5.2 - Conduct of Operations

5.2.1 - Slash

5.2.1.8 - Slash height (12/08)

No slash or tree tops may exceed 24 inches in height.

5.2.1.11 - Slash for reforestation (5/07)

To facilitate reforestation, the Sale Area shall be left with slash evenly distributed. Bunched tops within the cutting area shall be broken up and scattered. Stumps shall be cut low to the ground. Processing sites shall not be left with a compacted layer of slash; tops from these sites shall be hauled back into the cut area and scattered.

5.2.2 - Hazard Trees/Snags

5.2.2.1 - Den trees (10/16)

Obvious hollow and/or den trees shall be protected and left standing unless they are a safety hazard.

5.2.3 - Operating Restrictions

5.2.3.2 - Operating restrictions (9/11)

Within Payment Unit(s) 1 - 8, all cleanup activities are to be completed by July 15 upon completion of a Payment Unit unless otherwise directed by the Unit Manager or his/her representative. This restriction is to let the area revegetate before the dry season.

5.2.3.3 - Bark slippage restriction (3/09)

Within Payment Unit(s) 2 - 8, unless changed by written agreement, cutting and skidding are not permitted during the period of April 15 to July 15. This restriction is because of bark slippage.

5.2.30 - Landing/road top soil protection (2/15)

Top soil on landings and new roads must be removed, stockpiled and saved. Upon completion of the timber sale, soil must be evenly distributed back over the area for revegetation. In addition, the area must be seeded and mulched per instructions of the sale administrator.

5.2.32 - Decking/landing restoration (9/13)

All decking and landing areas must have the surface area restored to a condition equal to or better than before. This is to ensure the proper regeneration of the stand. Wood debris, chips, and "cookies" from trimmings must be removed or scattered away from landing and loading areas and may not be windrowed on the edge.

5.2.38 - No decking against live trees (2/04)

Cut products may not be decked against unmarked or designated leave trees.

5.4 - Soil Protection

5.4.1 - Rutting restriction, general (7/16)

Operations are to cease immediately if equipment and weather conditions result in rutting of roads and/or skid trails which is 12 inches or greater in depth and 50 feet in length. The Unit Manager or his/her representative may restrict hauling and/or skidding if ruts exceed the specified depth. With the Unit Manager or his/her representative's approval, the Purchaser may return to the area when the risk of rutting has decreased.

5.8 - Protection of Endangered Species

5.8.5 - Protection of raptor nests (3/13)

All trees with raptor nests will be protected if found during harvesting operations. Notification will be made to the Unit Manager or his/her representative who will notify the Wildlife Biologist so an on-site evaluation and recommendation can be made, if necessary.



TIMBER SALE MAP

This information provided by authority of Part 525, 1994 PA 451, as amended.

Forest Management Unit Baraga		County Ontonagon	Mapped By Ryan Mattila	Date 7/9/2021	Page 1	of 1
Township 52N	Range 37W	Section(s) and Subdivision(s) See Map		Scale 1:15,840		

Cover Type				Density	
A = Aspen	H = Hemlock	N = Marsh	U = Upland Brush	0 = Non Stocked	5 = Pole Timber Medium
B = Paper Birch	J = Jack Pine	O = Oak	UM = Upland Mixed	1 = Seedling Sapling Poor	6 = Pole Timber Well
C = Cedar	L = Lowland Brush	P = Lowland Poplar	V = Bog or Marsh	2 = Seedling Sapling Medium	7 = Saw Timber Poor
D = Treed Bog	LM = Lowland Mixed	Q = Mixed Swamp Conifer	W = White Pine	3 = Seedling Sapling Well	8 = Saw Timber Medium
E = Swamp Hdwoods	M = Mpl, Bch, Brch	R = Red Pine	X = Non Stocked	4 = Pole Timber Poor	9 = Saw Timber Well
F = Spruce Fir	MC = Mixed Conifer	S = Black Spruce	Z = Water		
G = Grass	MD = Mixed Deciduous	T = Tamarack			

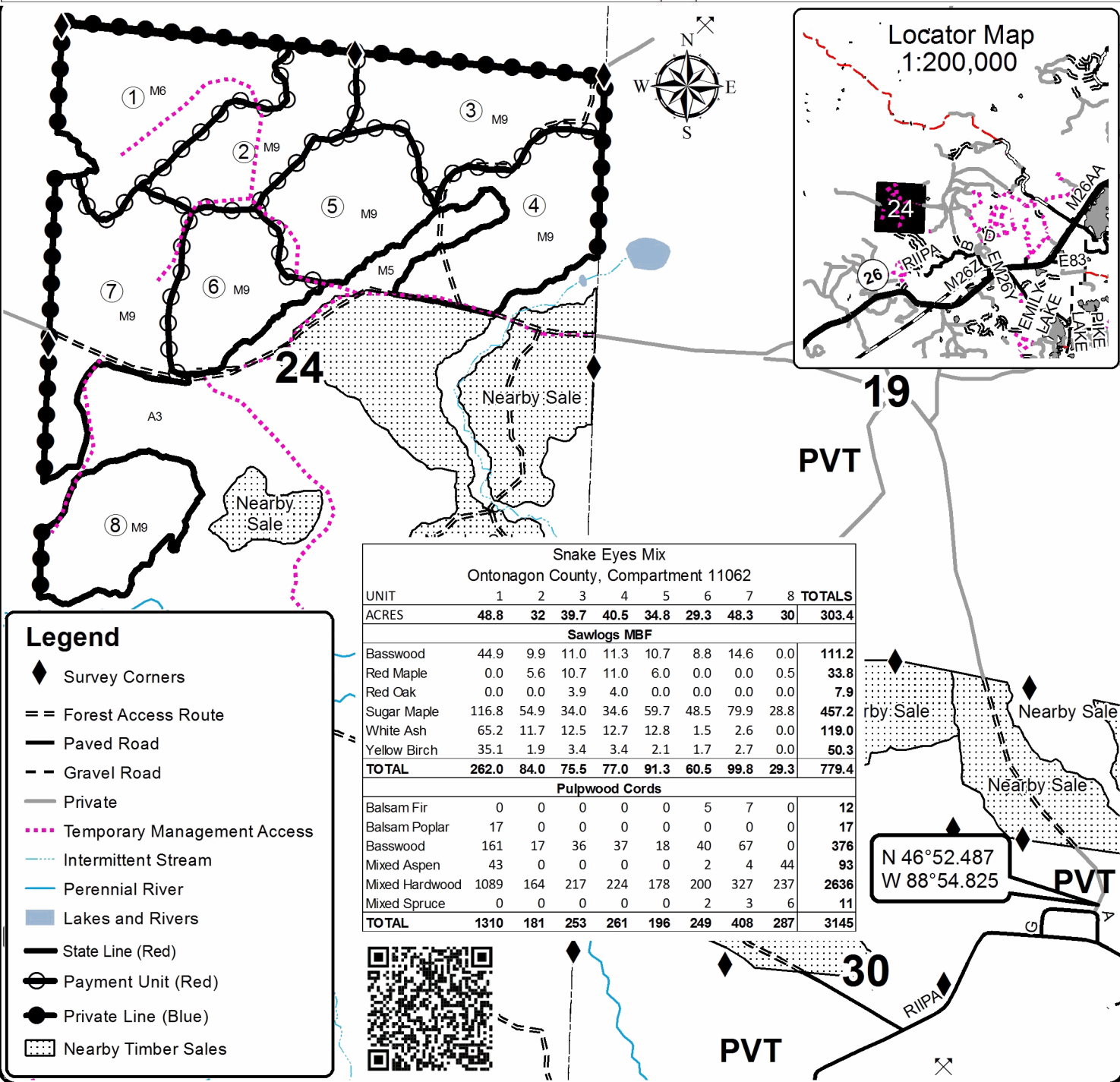

Legend

- ◆ Survey Corners
- == Forest Access Route
- Paved Road
- - Gravel Road
- Private
- ⋯ Temporary Management Access
- ⋯ Intermittent Stream
- Perennial River
- Lakes and Rivers
- State Line (Red)
- Payment Unit (Red)
- Private Line (Blue)
- ▨ Nearby Timber Sales

