



**DEPARTMENT OF NATURAL RESOURCES
STATE OF MICHIGAN**

TIMBER SALE PROSPECTUS #6968

SCHEDULED SALE DATE AND TIME: **9:00 a.m. (local time) on January 12, 2022.**

LOCATION: **ROSCOMMON MGMT UNIT, PO BOX 218, ROSCOMMON, MI 48653.**

CONTACT NAME: Doug Bates

PHONE NUMBER: (989) 275-4622

PROSPECTUS NOTE: The bidder is advised to inspect the sale area and review the location, estimated volumes, operating costs and contract terms of proposed sales. Please be aware that some landowners may request 60 days or more notice for access across their land.

Notice is hereby given that bids will be received by the Unit Manager, ROSCOMMON MANAGEMENT UNIT, for certain timber on the following described lands:

C30 Leftovers (71-009-21) / T23N, R02W, SEC. 18, SWNE, SWSW, NWSE.

T23N, R03W, SEC. 10, SESW, SWSE.

T23N, R03W, SEC. 12, N1/2SE.

T23N, R03W, SEC. 13, SENW, N1/2SW.

Roscommon County, Advertised Price \$105,215.70, 122.2 Acres, Aspen, Hardwood.

SALE NOTE: All units of volume listed for this sale were estimated using the Inventory Manager computer program and the new Michigan taper model.

TIMBER SALE INFORMATION

C30 Leftovers (71-009-21)

T23N, R02W, SEC. 18; T23N, R03W, SEC. 10; T23N, R03W, SEC. 12; T23N, R03W, SEC. 13.

Roscommon County (Advertised Price \$105,215.70)

SALE NOTE: All units of volume listed for this sale were estimated using the Inventory Manager computer program and the new Michigan taper model.

A timber sale contract for this lump sum, sealed bid timber sale will be awarded to the responsible bidder offering the highest sealed bid price. All units of volume listed below were estimated using the Inventory Manager computer program and the new Michigan taper model. Bids must be at or above the following advertised price for each product and species:

<u>PRODUCTS & SPECIES</u>	<u>ESTIMATED UNITS*</u>	<u>ADVERTISED PRICE</u>
Sawtimber		
Bl/R/Hybrid Oak	92.1 MBF	\$ 80.00 / MBF
Black Cherry	15.2 MBF	\$ 136.00 / MBF
Mixed Aspen	316.1 MBF	\$ 68.00 / MBF
Red Maple	63.2 MBF	\$ 63.00 / MBF
Red Oak	37.9 MBF	\$ 128.00 / MBF
Red Pine	33.1 MBF	\$ 92.00 / MBF
White Pine	18.4 MBF	\$ 46.00 / MBF
Pulpwood		
Balsam Fir	62 Cords	\$ 17.90 / Cord
Jack Pine	52 Cords	\$ 13.80 / Cord
Mixed Aspen	2,217 Cords	\$ 19.80 / Cord
Mixed Hardwood	436 Cords	\$ 15.35 / Cord
Mixed Oak	394 Cords	\$ 14.55 / Cord
Red Pine	19 Cords	\$ 34.40 / Cord
White Pine	128 Cords	\$ 21.55 / Cord

* The total volume is statistically estimated within plus (+) or minus (-) 4.24 percent. There are an estimated 4,575 cords on this timber sale, plus or minus 194 cords at the 95% confidence level. The estimated units are final and not subject to adjustment. Prospective bidders are urged to examine this timber and to make their own estimates of quantity and quality.

BOND AND PAYMENT SCHEDULE:

1. A bond in the amount of \$5,260.79 to insure faithful performance of the conditions of the contract will be deposited by the successful bidder within 21 days of the sale award.
2. Cutting in any sale or unit without the required advance payment would be considered a trespass.
3. Total payment must be paid in advance or according to the following schedule:
 - (a) Ten percent (10%) of the sale value must be paid within 21 days of the sale award.
 - (b) The 10% down payment will be credited towards the first unit cut.
 - (c) Payment for each of the following units must be made before cutting begins in that unit:

<u>PAYMENT UNIT NUMBER</u>	<u>PERCENT OF TOTAL SALE VALUE</u>
01	18.1%
02	10.5%
03	25.5%
04	2.2%
05	1.0%
06	15.0%
07	27.7%

4. If no cutting takes place, the 10% down payment will not be refunded.
5. Operations on the contract issued will terminate on 03/31/2024.

SALE STATISTICS

Volumes were calculated in cubic feet using the Michigan taper model. Cubic foot volume includes all wood inside bark for the product indicated. For display purposes, cubic feet were converted to cords and MBF using a simple conversion factor, e.g. 79 cubic feet per cord and 185 cubic feet per MBF. The cubic foot volumes are precise; the cords and MBF volumes are not. Cubic foot volume cannot be directly converted to cords or boards with precision.

SALE VOLUMES

The total estimated sale volume may not equal the sum of the species/products due to the nature of statistical calculations associated with double sampling methodology.

VOLUME			STATISTICAL RANGE IN CORDS	
TOTAL CUBIC FEET	TOTAL CORDS	PERCENT ERROR	MINIMUM	MAXIMUM
361,411	4,575	4.24%	4,380	4,769

VDU VOLUMES

A VDU is a Volume Determination Unit. Volumes and their associated statistics are calculated at the VDU level and summarized to the sale level. There is often a one to one relationship between a VDU and a Payment Unit, but not always, depending on the cruise design. Refer to the VDU TO PAYMENT UNIT table.

	VOLUME			RANGE IN CORDS	
VDU	TOTAL CUBIC FEET	TOTAL CORDS	PERCENT ERROR	MINIMUM	MAXIMUM
29	2,372	30	33.33%	20	40
46	59,432	752	6.66%	702	802
57	96,594	1,223	5.99%	1,149	1,296
94	37,485	474	15.23%	402	547
153	59,105	748	12.58%	654	842
176	10,722	136	29.10%	96	175
178	86,788	1,099	9.32%	996	1,201
TOTAL:	352,497	4,462		4,020	4,904

VDU TO PAYMENT UNIT

When a VDU is associated with more than one Payment Unit (PU), the VDU volumes are assigned to the PU based on acres of the VDU within the PU.

VDU	VDU ACRES	PU	PU ACRES
29	2.1	5	2.1
46	14.0	6	14.0
57	23.1	7	23.1
94	20.8	2	20.8
153	25.6	1	25.6
176	11.1	4	11.1
178	25.5	3	25.5
TOTAL:	122.2		122.2

DESCRIPTION OF TIMBER BY PU (PU)

PU	MARKET GROUP	PRODUCT	QUANTITY	UNIT	ACRES	ADVERTISE PRICE
1	BI/R/Hybrid Oak	Sawtimber	73.3	MBF	25.6	\$19,067.10
	Mixed Aspen		51.6	MBF		
	<i>B. T. Aspen</i>		9.5	<i>MBF</i>		
	<i>Quaking Aspen</i>		42.1	<i>MBF</i>		
	Red Maple		36.9	MBF		
	White Pine		7.8	MBF		
	Mixed Aspen	Pulpwood	117	Cords		
	<i>B. T. Aspen</i>		39	<i>Cords</i>		
	<i>Quaking Aspen</i>		78	<i>Cords</i>		
	Mixed Hardwood		102	Cords		
	<i>Black Cherry</i>		8	<i>Cords</i>		
	<i>Red Maple</i>		94	<i>Cords</i>		
	Mixed Oak		138	Cords		
	<i>White Oak</i>	<i>Sawtimber</i>	3.7	<i>MBF</i>		
	<i>BI/R/Hybrid Oak</i>	<i>Pulpwood</i>	123	<i>Cords</i>		
	<i>White Oak</i>		8	<i>Cords</i>		
	White Pine		52	Cords		
2	BI/R/Hybrid Oak	Sawtimber	9.6	MBF	20.8	\$11,004.90
	Mixed Aspen		24.3	MBF		
	<i>Quaking Aspen</i>		24.3	<i>MBF</i>		
	Red Maple		2.9	MBF		
	Red Pine		18.2	MBF		
	Balsam Fir	Pulpwood	17	Cords		
	Mixed Aspen		196	Cords		
	<i>Quaking Aspen</i>		196	<i>Cords</i>		
	Mixed Hardwood		88	Cords		
	<i>Black Cherry</i>		22	<i>Cords</i>		
	<i>Red Maple</i>		66	<i>Cords</i>		
	Mixed Oak		28	Cords		
	<i>BI/R/Hybrid Oak</i>		28	<i>Cords</i>		
	Red Pine		4	Cords		
	White Pine		30	Cords		
3	BI/R/Hybrid Oak	Sawtimber	3.7	MBF	25.5	\$26,844.10
	Black Cherry		15.2	MBF		
	Mixed Aspen		117.9	MBF		
	<i>B. T. Aspen</i>		104.9	<i>MBF</i>		
	<i>Quaking Aspen</i>		13.0	<i>MBF</i>		
	Red Maple		13.9	MBF		
	Red Pine		10.5	MBF		
	White Pine		4.4	MBF		
	Balsam Fir	Pulpwood	23	Cords		
	Mixed Aspen		529	Cords		
	<i>B. T. Aspen</i>		418	<i>Cords</i>		
	<i>Quaking Aspen</i>		111	<i>Cords</i>		
	Mixed Hardwood		132	Cords		
	<i>Black Cherry</i>		12	<i>Cords</i>		
	<i>Red Maple</i>		120	<i>Cords</i>		
	Mixed Oak		42	Cords		
	<i>BI/R/Hybrid Oak</i>		42	<i>Cords</i>		
	Red Pine		1	Cords		
	White Pine		40	Cords		
4	Red Maple	Sawtimber	2.6	MBF	11.1	\$2,353.45
	White Pine		4.2	MBF		
	Balsam Fir	Pulpwood	17	Cords		
	Jack Pine		52	Cords		

DESCRIPTION OF TIMBER BY PU (PU), CON'T

PU	MARKET GROUP	PRODUCT	QUANTITY	UNIT	ACRES	ADVERTISE PRICE
4 con't	<i>Jack Pine</i>	<i>Sawtimber</i>	8.6	<i>MBF</i>		
	<i>Jack Pine</i>	<i>Pulpwood</i>	35	<i>Cords</i>		
	Mixed Aspen		32	Cords		
	<i>Quaking Aspen</i>		32	<i>Cords</i>		
	Mixed Hardwood		18	Cords		
	<i>Red Maple</i>		18	<i>Cords</i>		
	White Pine		3	Cords		
5	Mixed Aspen	Sawtimber	1.8	MBF	2.1	\$1,076.35
	<i>B. T. Aspen</i>		1.8	<i>MBF</i>		
	Red Maple		0.2	MBF		
	Red Pine		4.4	MBF		
	Mixed Aspen	Pulpwood	2	Cords		
	<i>B. T. Aspen</i>		2	<i>Cords</i>		
	Mixed Hardwood		1	Cords		
	<i>Red Maple</i>		1	<i>Cords</i>		
6	Red Pine		14	Cords	14.0	\$15,766.85
	Bl/R/Hybrid Oak	Sawtimber	5.5	MBF		
	Mixed Aspen		39.7	MBF		
	<i>B. T. Aspen</i>		39.7	<i>MBF</i>		
	White Pine		2.0	MBF		
	Balsam Fir	Pulpwood	5	Cords		
	Mixed Aspen		552	Cords		
	<i>B. T. Aspen</i>		552	<i>Cords</i>		
	Mixed Hardwood		32	Cords		
	<i>Red Maple</i>		32	<i>Cords</i>		
7	Mixed Oak		66	Cords	23.1	\$29,102.95
	<i>Bl/R/Hybrid Oak</i>		66	<i>Cords</i>		
	White Pine		3	Cords		
	Mixed Aspen	Sawtimber	80.8	MBF		
	<i>B. T. Aspen</i>		80.8	<i>MBF</i>		
	Red Maple		6.7	MBF		
	Red Oak		37.9	MBF		
	Mixed Aspen	Pulpwood	789	Cords		
	<i>B. T. Aspen</i>		789	<i>Cords</i>		
	Mixed Hardwood		63	Cords		
<i>Red Maple</i>		63	<i>Cords</i>			
	Mixed Oak		120	Cords		
	<i>Bl/R/Hybrid Oak</i>		50	<i>Cords</i>		
	<i>Red Oak</i>		70	<i>Cords</i>		
TOTAL:			576.0	MBF		
TOTAL:			3,308	Cords		

Sale Specific Conditions & Requirements

Sale Name: C30 Leftovers

Sale Number: 71-009-21 Seq#: 1

1 - Sale Area

1.2 - Boundaries

1.2.1 - Painted boundaries (9/19)

The sale boundary and Payment Unit boundaries are marked and identified by blue, red, and yellow paint. Exterior sale boundary lines against private property are marked with blue paint. Exterior sale boundary lines against state are marked with red paint. Interior Payment Unit boundaries are marked with yellow paint. Retention patches are marked with red paint; no harvesting activities may occur within these areas. The painted boundary line trees are not Included Timber and are to be protected. Yellow painted trees designating an interior Payment Unit boundary are only to be cut when all surrounding Payment Units have been paid.

2 - Timber Specifications

2.1 - Included Timber

2.1.1 - Clearcut unit(s) with unmerchantable trees (6/14)

Within Payment Unit(s) 1-4, cut all trees that are two (2) inches or more at DBH, except trees marked with green paint.

2.1.3 - Cut tree marked unit(s) (12/08)

Within Payment Unit(s) 5, all trees are designated for cutting when marked with orange paint above and below stump height, regardless of merchantability.

2.2 - Utilization

2.2.3 - Stump heights (4/07)

Stump heights within the Sale Area shall not exceed 12 inches for trees greater than 10 inches at DBH and 4 inches for trees smaller than 10 inches at DBH.

2.2.6 - Roundwood operation required (3/21)

The skidding of whole trees or tree segments with limbs attached is prohibited within Payment Unit 5. All products must be produced as roundwood and forwarded to existing roads or landing areas in final product length.

2.2.9 - No chipping permitted (12/08)

Within Payment Unit(s) 4 and 5, all wood must be removed by whole tree, tree segment, or roundwood. No chipping is permitted, and the tops must be left scattered evenly throughout the Payment Unit area.

3 - Payments

3.3 - Pre-measured Sales

3.3.4 - Dividing payment units (7/14)

Payment Unit(s) may be divided at the request of the Purchaser and upon approval of the Unit Manager. Dividing Payment Units is a contract modification which requires a Timber Sale Contract Amendment.

3.4 - Damaged Timber

3.4.1 - Damaged timber (7/16)

General Condition and Requirement 3.4 Damaged Timber, defines liquidated damages for undesignated live merchantable trees which are cut or injured. No damage is acceptable to undesignated live merchantable trees. Within the Sale Area, if more than 5% of the residual trees (> 4.5" DBH) within a specified area of the sale are damaged, liquidated damages will be assessed for all trees damaged. Rates will be in accordance with General Condition and Requirement 3.4 Damaged Timber.

4 - Transportation

4.1 - Construction

4.1.6 - Road construction (1/09)

Construction of new roads or improvements of existing roads shall be done in such a way as to minimize the environmental and visual impacts. Merchantable trees shall be cut and utilized unless otherwise directed. Non-merchantable trees shall be severed and laid flat on the ground. Slash shall be scattered, and not left in windrows and kept a minimum of 10 feet back from the road edge. Stumps shall be set upright, not left on edge, and be moved at least 10 feet away from the road edge. Disturbed soil shall be feathered into the woods and not left in berms or windrows.

4.1.7 - Road closure (10/11)

All new roads built into the sale must be blocked to vehicle traffic upon completion of the sale. In general, this will require constructing a four (4') foot high berm of stumps and logs covered with earth. Stumps and brush must be placed along the remainder of the trail. These roads must be rendered impassable to cars and trucks. Contact the sale administrator for specific details of design and placement.

4.2 - Maintenance

4.2.1 - Hauling restriction (12/08)

Hauling may be restricted on forest roads by the Unit Manager or his/her representative. The restriction may occur during wet weather conditions.

4.2.3 - Road maintenance (8/13)

The following road maintenance is required: Within 60 days of completion of hauling, or if no hauling occurs for 60 days, the road must be maintained and graded. This includes cleaning of drainage areas, grading, crowning, and filling with gravel, if necessary. Damages will be assessed if grading/repair does not occur.

4.2.5 - Two wheel drive condition (2/04)

All existing trail roads on and adjacent to the sale area must be passable by two-wheel drive traffic for the duration of the sale.

5 - Operations

5.1 - Notification

5.1.1 - Pre-sale conference (10/16)

A pre-sale conference between the Purchaser and sale administrator is required prior to beginning any operations to determine landing and road locations.

5.1.3 - Well heads and natural gas pipelines (11/15)

The Purchaser is responsible for contacting the pipeline company 10 days prior to operating equipment in the vicinity of well heads or natural gas pipelines. Contact DTE Energy.

5.1.4 - Post-sale conference (10/16)

A post-sale conference on site between the Purchaser and sale administrator is required prior to the completion of active logging operations to determine clean-up and repair of landings, road edges, and the fulfillment of other contract specifications.

5.2 - Conduct of Operations

5.2.1 - Slash

5.2.1.8 - Slash height (12/08)

No slash or tree tops may exceed 24 inches in height. Any slash/tops left on the sale must be scattered uniformly over the entire Sale Area and not left in "windrows" from harvesting operations.

5.2.2 - Hazard Trees/Snags

5.2.2.1 - Den trees (10/16)

Obvious hollow and/or den trees shall be protected and left standing unless they are a safety hazard.

5.2.3 - Operating Restrictions

5.2.3.3 - Bark slippage restriction (3/09)

Within Payment Unit(s) 5, are not permitted during the period of April 15 to July 15. This restriction is because of bark slippage.

5.2.4 - Dead and Down Creation

5.2.4.2 - Dead and down creation, hare and grouse (1/14)

To improve habitat for snowshoe hare, grouse, and other species, the Purchaser is to leave two trees, nine (9) inches or larger in diameter on the ground for every two acres within Payment Unit(s) 1-3 and 6-7. They should be scattered throughout the sale or positioned per the sale administrator's instructions. If possible, the logs or trees should be felled so they overlap. Note these pieces should have a minimum length of five feet. They can be of any tree species and can be an un-merchantable piece of wood or a full tree.

5.2.4.3 - Dead and down creation, dead trees (6/07)

Except as provided for in General Condition and Requirement 5.2.2, no dead trees, standing or down, are to be cut, skidded, or processed.

5.2.4.4 - Dead and down creation, grouse (6/18)

To encourage grouse and other wildlife, in Payment Unit(s) 1-3 leave at least 1 large top pile per every 2 acres. These will be evenly spaced throughout the Payment Units.

5.2.32 - Decking/landing restoration (9/13)

All decking and landing areas must have the surface area restored to a condition equal to or better than before. This is to ensure the proper regeneration of the stand. Wood debris, chips, and "cookies" from trimmings must be removed or scattered away from landing and loading areas and may not be windrowed on the edge.

5.2.38 - No decking against live trees (2/04)

Cut products may not be decked against unmarked or designated leave trees.

**TIMBER SALE MAP**

This information provided by authority of Part 525, 1994 PA 451, as amended.

Sale Number	Year
71-009	21

Forest Management Unit Roscommon Management Unit	County Roscommon County	Mapped By Lewicki	Date 9/28/21	Page 1	of 2
Township 23N	Range 02W & 03W	Section(s) and Subdivision(s) S.12 N1/2SE S.13 SENW;N1/2SW S.18 SWNE;SWSW;NWSE	Scale 1:15,840		

Cover Type				Density	
A = Aspen	H = Hemlock	N = Marsh	U = Upland Brush	0 = Non Stocked	5 = Pole Timber Medium
B = Paper Birch	J = Jack Pine	O = Oak	UM = Upland Mixed	1 = Seedling Sapling Poor	6 = Pole Timber Well
C = Cedar	L = Lowland Brush	P = Lowland Poplar	V = Bog or Marsh	2 = Seedling Sapling Medium	7 = Saw Timber Poor
D = Treed Bog	LM = Lowland Mixed	Q = Mixed Swamp Conifer	W = White Pine	3 = Seedling Sapling Well	8 = Saw Timber Medium
E = Swamp Hdwoods	M = Mpl, Bch, Brch	R = Red Pine	X = Non Stocked	4 = Pole Timber Poor	9 = Saw Timber Well
F = Spruce Fir	MC = Mixed Conifer	S = Black Spruce	Z = Water		
G = Grass	MD = Mixed Deciduous	T = Tamarack			

PU	Acres	PU	Acres	PU	Acres
1	25.6	4	11.1	7	23.1
2	20.8	5	2.1		
3	25.5	6	14.0		

C30 Leftovers

Compartment 30

122.2 Acres

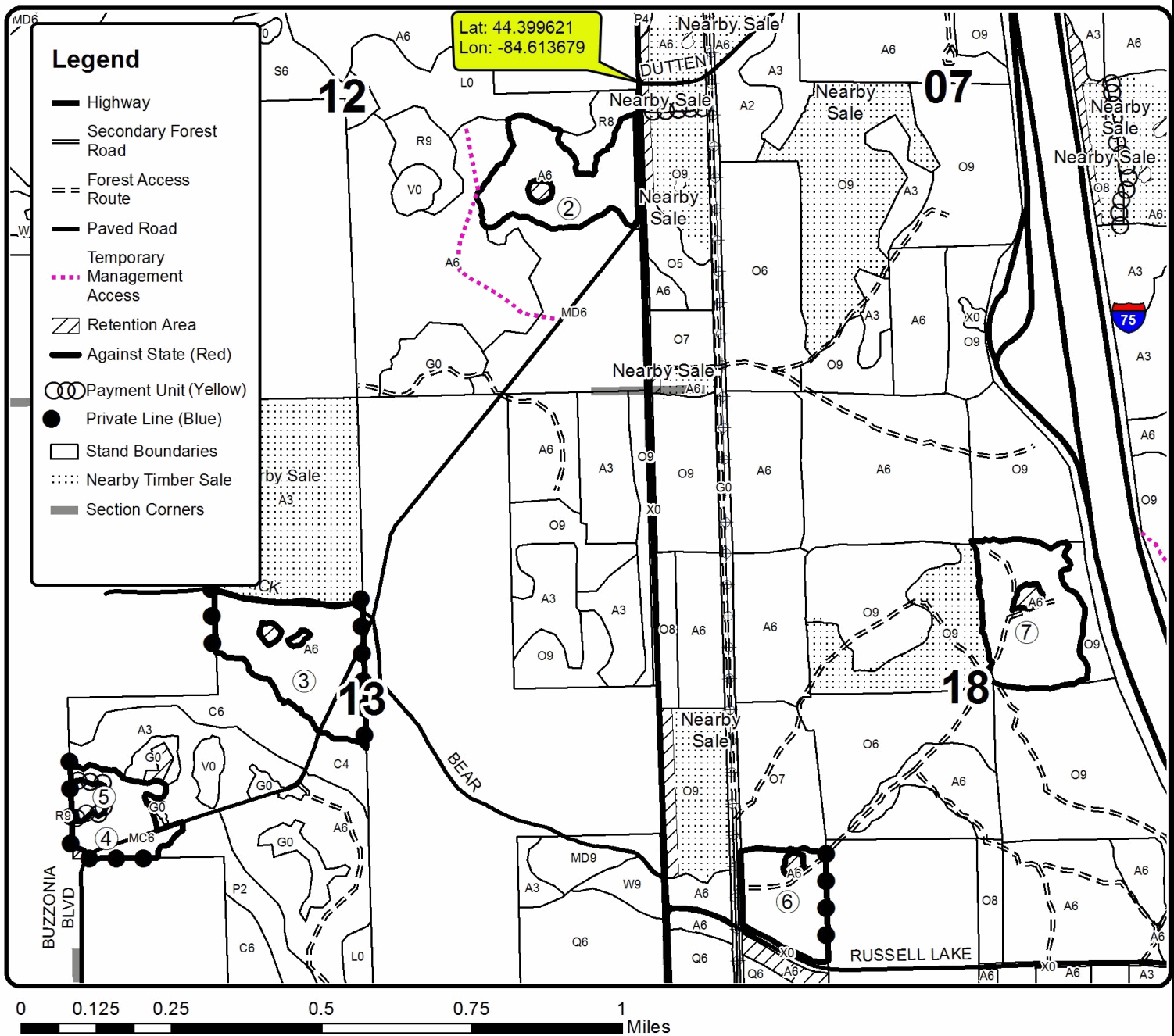

TIMBER SALE MAP

This information provided by authority of Part 525, 1994 PA 451, as amended.

Forest Management Unit		County	Mapped By	Lewicki	Date	Page	of
Roscommon Management Unit		Roscommon County	Cruised By	Lewicki	9/28/21	2	2
Township	Range	Section(s) and Subdivision(s)			Scale		
23N	03W	S. 10 SESW;SWSE			1:15,840		

Cover Type				Density	
A = Aspen	H = Hemlock	N = Marsh	U = Upland Brush	0 = Non Stocked	5 = Pole Timber Medium
B = Paper Birch	J = Jack Pine	O = Oak	UM = Upland Mixed	1 = Seedling Sapling Poor	6 = Pole Timber Well
C = Cedar	L = Lowland Brush	P = Lowland Poplar	V = Bog or Marsh	2 = Seedling Sapling Medium	7 = Saw Timber Poor
D = Treed Bog	LM = Lowland Mixed	Q = Mixed Swamp Conifer	W = White Pine	3 = Seedling Sapling Well	8 = Saw Timber Medium
E = Swamp Hdwoods	M = Mpl, Bch, Brch	R = Red Pine	X = Non Stocked	4 = Pole Timber Poor	9 = Saw Timber Well
F = Spruce Fir	MC = Mixed Conifer	S = Black Spruce	Z = Water		
G = Grass	MD = Mixed Deciduous	T = Tamarack			

PU	Acres	PU	Acres	PU	Acres
1	25.6	4	11.1	7	23.1
2	20.8	5	2.1		
3	25.5	6	14.0		

C30 Leftovers

Compartment 30

122.2 Acres

