



**DEPARTMENT OF NATURAL RESOURCES  
STATE OF MICHIGAN**

**TIMBER SALE PROSPECTUS #6917**

SCHEDULED SALE DATE AND TIME: 11:00 a.m. (local time) on September 22, 2021.

LOCATION: SW REGION-WILD, 621 NORTH 10TH STREET, PLAINWELL, MI 49080.

CONTACT NAME: Cynthia McQueer

PHONE NUMBER: (269) 767-1022

PROSPECTUS NOTE: The bidder is advised to inspect the sale area and review the location, estimated volumes, operating costs and contract terms of proposed sales. Please be aware that some landowners may request 60 days or more notice for access across their land.

Notice is hereby given that bids will be received by the Game Area Manager, BARRY SGA, for certain timber on the following described lands:

Solomon Engle Road (20-001-21) / T04N, R09W, SEC. 21, E1/2NE, NESE.

T04N, R09W, SEC. 22, SWNW.

T04N, R09W, SEC. 28, NW.

Barry County, Advertised Price \$127,837.75, 83.4 Acres, Aspen, Hardwood.

SALE NOTE: All units of volume listed for this sale were estimated using the Inventory Manager computer program and the new Michigan taper model.

Access may be through other public land.

## TIMBER SALE INFORMATION

Solomon Engle Road (20-001-21)

T04N, R09W, SEC. 21; T04N, R09W, SEC. 22; T04N, R09W, SEC. 28.

Barry County (Advertised Price \$127,837.75)

SALE NOTE: All units of volume listed for this sale were estimated using the Inventory Manager computer program and the new Michigan taper model.

Access may be through other public land.

A timber sale contract for this lump sum, sealed bid timber sale will be awarded to the responsible bidder offering the highest sealed bid price. All units of volume listed below were estimated using the Inventory Manager computer program and the new Michigan taper model. Bids must be at or above the following advertised price for each product and species:

<u>PRODUCTS &amp; SPECIES</u>	<u>ESTIMATED UNITS*</u>	<u>ADVERTISED PRICE</u>
Sawtimber		
B. T. Aspen	210.8 MBF	\$ 85.00 / MBF
Black Cherry	74.1 MBF	\$ 148.00 / MBF
Black Walnut	10.1 MBF	\$ 550.00 / MBF
Red Maple	232.8 MBF	\$ 104.00 / MBF
Red Oak	219.2 MBF	\$ 135.00 / MBF
Red Pine	55.0 MBF	\$ 83.00 / MBF
Scotch Pine	21.7 MBF	\$ 42.00 / MBF
Shagbark Hickory	11.8 MBF	\$ 135.00 / MBF
Sugar Maple	26.9 MBF	\$ 158.00 / MBF
White Oak	36.7 MBF	\$ 73.00 / MBF
Pulpwood		
B. T. Aspen	506 Cords	\$ 13.40 / Cord
Mixed Hardwood	955 Cords	\$ 11.80 / Cord
Mixed Oak	278 Cords	\$ 12.30 / Cord
Red Pine	129 Cords	\$ 31.15 / Cord
Scotch Pine	9 Cords	\$ 12.10 / Cord

\* The total volume is statistically estimated within plus (+) or minus (-) 8.40 percent. There are an estimated 3,986 cords on this timber sale, plus or minus 335 cords at the 95% confidence level. The estimated units are final and not subject to adjustment. Prospective bidders are urged to examine this timber and to make their own estimates of quantity and quality.

### **BOND AND PAYMENT SCHEDULE:**

1. A bond in the amount of \$6,391.89 to insure faithful performance of the conditions of the contract will be deposited by the successful bidder within 21 days of the sale award.
2. Cutting in any sale or unit without the required advance payment would be considered a trespass.
3. Total payment must be paid in advance or according to the following schedule:
  - (a) Ten percent (10%) of the sale value must be paid within 21 days of the sale award.
  - (b) The 10% down payment will be credited towards the first unit cut.
  - (c) Payment for each of the following units must be made before cutting begins in that unit:

PAYMENT UNIT NUMBER	PERCENT OF TOTAL SALE VALUE
01	32.3%
02	46.4%
03	21.3%
4. If no cutting takes place, the 10% down payment will not be refunded.
5. Operations on the contract issued will terminate on 03/01/2023.

### **SALE STATISTICS**

Volumes were calculated in cubic feet using the Michigan taper model. Cubic foot volume includes all wood inside bark for the product indicated. For display purposes, cubic feet were converted to cords and MBF using a simple conversion factor, e.g. 79 cubic feet per cord and 185 cubic feet per MBF. The cubic foot volumes are precise; the cords and MBF volumes are not. Cubic foot volume cannot be directly converted to cords or boards with precision.

## SALE VOLUMES

The total estimated sale volume may not equal the sum of the species/products due to the nature of statistical calculations associated with double sampling methodology.

VOLUME			STATISTICAL RANGE IN CORDS	
TOTAL CUBIC FEET	TOTAL CORDS	PERCENT ERROR	MINIMUM	MAXIMUM
314,878	3,986	8.40%	3,651	4,321

## VDU VOLUMES

A VDU is a Volume Determination Unit. Volumes and their associated statistics are calculated at the VDU level and summarized to the sale level. There is often a one to one relationship between a VDU and a Payment Unit, but not always, depending on the cruise design. Refer to the VDU TO PAYMENT UNIT table.

	VOLUME			RANGE IN CORDS	
VDU	TOTAL CUBIC FEET	TOTAL CORDS	PERCENT ERROR	MINIMUM	MAXIMUM
1	41,051	520	31.62%	355	684
2	9,437	119	46.84%	64	175
3	37,676	477	25.48%	355	598
4	3,991	51	50.00%	25	76
5	8,628	109	38.49%	67	151
6	12,379	157	22.77%	121	192
7	18,733	237	20.92%	188	287
8	6,309	80	20.41%	64	96
9	16,091	204	36.80%	129	279
10	5,502	70	28.87%	50	90
11	4,110	52	25.00%	39	65
12	47,892	606	16.33%	507	705
13	78,455	993	16.98%	824	1,162
<b>TOTAL:</b>	<b>290,253</b>	<b>3,674</b>		<b>2,788</b>	<b>4,560</b>

## VDU TO PAYMENT UNIT

When a VDU is associated with more than one Payment Unit (PU), the VDU volumes are assigned to the PU based on acres of the VDU within the PU.

VDU	VDU ACRES	PU	PU ACRES
1	4.6	1	4.6
2	1.6	1	1.6
3	11.0	1	11.0
4	1.8	1	1.8
5	2.2	1	2.2
6	2.8	1	2.8
7	7.0	2	7.0
8	3.4	2	3.4
9	4.0	2	4.0
10	2.5	2	2.5
11	2.7	3	2.7
12	19.3	3	19.3
13	20.5	2	20.5
<b>TOTAL:</b>	<b>83.4</b>		<b>83.4</b>

**DESCRIPTION OF TIMBER BY PU (PU)**

PU	MARKET GROUP	PRODUCT	QUANTITY	UNIT	ACRES	ADVERTISE PRICE
1	B. T. Aspen	Sawtimber	167.2	MBF	24.0	\$41,277.90
	Black Cherry		52.8	MBF		
	Red Maple		12.0	MBF		
	Red Pine		52.5	MBF		
	Scotch Pine		21.7	MBF		
	B. T. Aspen		397	Cords		
	Mixed Hardwood		272	Cords		
	Black Cherry		110	Cords		
	Black Locust		28	Cords		
	Red Maple		53	Cords		
	Shagbark Hickory		81	Cords		
	Mixed Oak		19	Cords		
	Red Oak		19	Cords		
	Red Pine		124	Cords		
	Scotch Pine		9	Cords		
2	B. T. Aspen	Sawtimber	20.0	MBF	37.4	\$59,334.85
	Black Cherry		15.3	MBF		
	Red Maple		173.9	MBF		
	Red Oak		156.7	MBF		
	Red Pine		2.5	MBF		
	Shagbark Hickory		11.8	MBF		
	Sugar Maple		26.9	MBF		
	White Oak		13.0	MBF		
	B. T. Aspen		102	Cords		
	Mixed Hardwood		454	Cords		
	Black Cherry		21	Cords		
	Red Maple		309	Cords		
	Sassafras		21	Cords		
	Shagbark Hickory		8	Cords		
	Sugar Maple		74	Cords		
	Tree of Heaven		21	Cords		
	Mixed Oak		183	Cords		
	Red Oak		158	Cords		
	White Oak		25	Cords		
	Red Pine		5	Cords		
3	B. T. Aspen	Sawtimber	23.6	MBF	22.0	\$27,225.00
	Black Cherry		6.0	MBF		
	Black Walnut		10.1	MBF		
	Red Maple		46.9	MBF		
	Red Oak		62.5	MBF		
	White Oak		23.7	MBF		
	B. T. Aspen		7	Cords		
	Mixed Hardwood		229	Cords		
	Black Cherry		58	Cords		
	Black Walnut		4	Cords		
	Red Maple		101	Cords		
	Sassafras		18	Cords		
	Sugar Maple		11	Cords		
	Willow		37	Cords		
	Mixed Oak		76	Cords		
	Red Oak		66	Cords		
	White Oak		10	Cords		
TOTAL:			899.1	MBF		
TOTAL:			1,877	Cords		

## **Sale Specific Conditions & Requirements**

**Sale Name: Solomon Engle Road**

**Sale Number: 20-001-21 Seq#: 1**

### **1 - Sale Area**

#### **1.2 - Boundaries**

##### **1.2.1 - Painted boundaries (9/19)**

The sale boundary and Payment Unit boundaries are marked by red paint. Payment Units 2 and 3 are separated by a gas line.

### **2 - Timber Specifications**

#### **2.1 - Included Timber**

##### **2.1.2 - Clearcut unit(s) w/o unmerchantable trees (8/11)**

Within Payment Unit(s) 1, cut all trees which meet minimum piece specifications in 2.2 Utilization, except oak equal to or greater than 12 inches at DBH. In addition, do not cut any white pine, beech, or hemlock.

##### **2.1.7 - Leave tree marked unit(s) (6/14)**

Within Payment Unit(s) 2 and 3, all trees, which meet minimum piece specifications in 2.2 Utilization, are designated for cutting, except trees marked with green paint above and below stump height. In addition, do not cut any white pine, beech, or hemlock.

#### **2.2 - Utilization**

##### **2.2.3 - Stump heights (4/07)**

Stump heights within the Sale Area shall not exceed 12 inches for trees greater than 10 inches at DBH and 4 inches for trees smaller than 10 inches at DBH.

### **4 - Transportation**

#### **4.3 - Public Right-of-Way**

##### **4.3.2 - County R-O-W (12/06)**

The county must be contacted prior to crossing or harvesting in the county road R-O-W.

### **5 - Operations**

#### **5.1 - Notification**

##### **5.1.1 - Pre-sale conference (10/16)**

A pre-sale conference on site between the Purchaser and sale administrator is required prior to beginning any operations to determine landing and road locations.

##### **5.1.3 - Well heads and natural gas pipelines (11/15)**

The Purchaser is responsible for contacting the pipeline company prior to operating equipment in the vicinity of well heads or natural gas pipelines.

#### **5.2 - Conduct of Operations**

##### **5.2.2 - Hazard Trees/Snags**

###### **5.2.2.1 - Den trees (10/16)**

Obvious hollow and/or den trees shall be protected and left standing unless they are a safety hazard.

##### **5.2.3 - Operating Restrictions**

###### **5.2.3.3 - Bark slippage restriction (3/09)**

Within Payment Unit(s) 1 - 3, unless changed by written agreement, cutting and skidding are not permitted during the

period of April 15 to July 15. This restriction is because of bark slippage.

#### 5.2.32 - Decking/landing restoration (9/13)

All decking and landing areas must have the surface area restored to a condition equal to or better than before. This is to ensure the proper regeneration of the stand. Wood debris, chips, and "cookies" from trimmings must be removed or scattered away from landing and loading areas and may not be windrowed on the edge.

#### 5.2.38 - No decking against live trees (2/04)

Cut products may not be decked against unmarked or designated leave trees.

### 5.4 - Soil Protection

#### 5.4.1 - Rutting restriction, general (7/16)

Operations are to cease immediately if equipment and weather conditions result in rutting of roads and/or skid trails which is 12 inches or greater in depth and 50 feet in length. The Unit Manager or his/her representative may restrict hauling and/or skidding if ruts exceed the specified depth. With the Unit Manager or his/her representative's approval, the Purchaser may return to the area when the risk of rutting has decreased.

#### 5.4.6 - Wet area protection (5/10)

No harvesting operations, including skidding and felling, are to take place within the vernal pond areas or drainages. When harvesting occurs, there should be no disturbance to the vernal pond depression. All equipment, trees and tops should be kept out of this area. Within 100 feet of the pond, equipment should only be used when the soil is in a dry or frozen condition. Care must be taken by the Purchaser to identify and avoid operating in these areas of the timber sale.

### 5.8 - Protection of Endangered Species

#### 5.8.5 - Protection of raptor nests (3/13)

All trees with raptor nests will be protected if found during harvesting operations. Notification will be made to the Unit Manager or his/her representative who will notify the Wildlife Biologist so an on-site evaluation and recommendation can be made, if necessary.

## 6 - Safety and Fire Prevention

### 6.2 - Signing

#### 6.2.1 - Road posting (10/20)

The Purchaser is responsible for posting and maintaining caution signs on the adjacent county roads prior to beginning operations. The road must be posted at appropriate distances from the Sale Area to warn of logging activity and truck traffic. Signs must be removed when harvest operations are suspended or completed. The Purchaser will provide these signs.

## 7 - Other Conditions

### 7.10 - Certified Timber

#### 7.10.1 - Non-certified timber (2/16)

The area encompassed by this timber sale is not certified to the standards of the Forest Stewardship Council (FSC) or the Sustainable Forestry Initiative (SFI). Forest products from this sale may not be delivered to the mill as "FSC and / or SFI certified". The lands within this sale are managed as a State Game Area.

**TIMBER SALE MAP**

This information provided by authority of Part 525, 1994 PA 451, as amended.

Sale Number	Year
20-001	21

Forest Management Unit Solomon Engle Road	County Barry	Mapped By J. Bramer	Date 07/02/2021	Page 1	of 1
Township 04N	Range 09W	Section(s) and Subdivision(s) Sections 21, 22, 28	Scale 1:15,840		

Cover Type				Density	
A = Aspen	H = Hemlock	N = Marsh	U = Upland Brush	0 = Non Stocked	5 = Pole Timber Medium
D = Paper Birch	J = Jack Pine	O = Oak	UM = Upland Mixed	1 = Seedling Sapling Poor	6 = Pole Timber Well
C = Cedar	L = Lowland Brush	P = Lowland Poplar	V = Bog or Marsh	2 = Seedling Sapling Medium	7 = Saw Timber Poor
D = Treed Bog	LM = Lowland Mixed	Q = Mixed Swamp Conifer	W = White Pine	3 = Seedling Sapling Well	8 = Saw Timber Medium
E = Swamp Hardwoods	M = Mpl. Dec. Dec.	R = Red Pine	X = Non Stocked	4 = Pole Timber Poor	9 = Saw Timber Well
F = Spruce Fir	MC = Mixed Conifer	S = Black Spruce	Z = Water		
G = Grass	MD = Mixed Deciduous	T = Tamarack			

PU	Acres
1	24
2	37.4
3	22

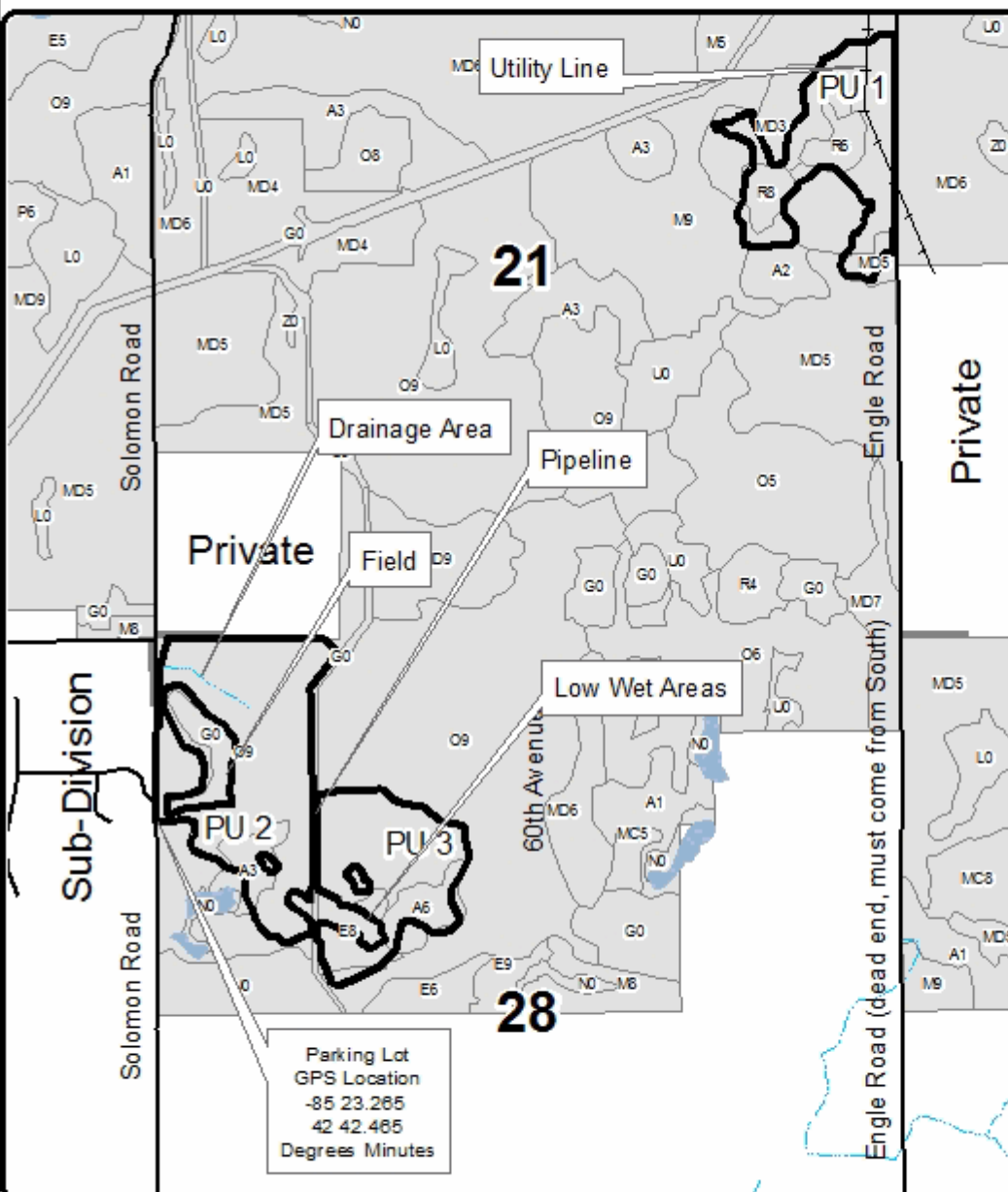
**Solomon Engle Road****83.4 Acres  
Compartment 1****Legend**

- Timber Sale Area (Red Paint)
- Road
- Stand Boundaries
- State Game Area
- Intermittent Stream
- Lakes and Rivers

QR code opens map  
in Avenza App.