



**DEPARTMENT OF NATURAL RESOURCES  
STATE OF MICHIGAN  
TIMBER SALE PROSPECTUS #7059**

SCHEDULED SALE DATE AND TIME: **10:00 a.m. (local time) on May 24, 2022.**

LOCATION: **ATLANTA MGMT UNIT, 13501 M 33, ATLANTA, MI 49709.**

CONTACT NAME: Cody Stevens

PHONE NUMBER: (989) 785-4251

PROSPECTUS NOTE: The bidder is advised to inspect the sale area and review the location, estimated volumes, operating costs and contract terms of proposed sales. Please be aware that some landowners may request 60 days or more notice for access across their land.

Notice is hereby given that bids will be received by the Unit Manager, ATLANTA MANAGEMENT UNIT, for certain timber on the following described lands:

JC Island Mix (54-020-21) / T31N, R07E, SEC. 34, NENW,SWNE,SE.

Alpena County, Advertised Price \$81,044.30, 82.6 Acres, Hardwood, White Pine.

SALE NOTE: All units of volume listed for this sale were estimated using the Inventory Manager computer program and the new Michigan taper model.

## TIMBER SALE INFORMATION

JC Island Mix (54-020-21)

T31N, R07E, SEC. 34.

Alpena County (Advertised Price \$81,044.30)

SALE NOTE: All units of volume listed for this sale were estimated using the Inventory Manager computer program and the new Michigan taper model.

A timber sale contract for this lump sum, sealed bid timber sale will be awarded to the responsible bidder offering the highest sealed bid price. All units of volume listed below were estimated using the Inventory Manager computer program and the new Michigan taper model. Bids must be at or above the following advertised price for each product and species:

<u>PRODUCTS &amp; SPECIES</u>	<u>ESTIMATED UNITS*</u>	<u>ADVERTISED PRICE</u>
Sawtimber		
Bl/R/Hybrid Oak	147.6 MBF	\$ 59.00 / MBF
Mixed Aspen	17.4 MBF	\$ 105.00 / MBF
Red Maple	9.6 MBF	\$ 48.00 / MBF
Red Oak	24.4 MBF	\$ 172.00 / MBF
Red Pine	54.4 MBF	\$ 118.00 / MBF
White Pine	716.0 MBF	\$ 35.00 / MBF
Pulpwood		
Balsam Fir	4 Cords	\$ 16.40 / Cord
Jack Pine	33 Cords	\$ 8.80 / Cord
Mixed Aspen	65 Cords	\$ 26.20 / Cord
Mixed Oak	366 Cords	\$ 41.70 / Cord
Red Maple	81 Cords	\$ 20.50 / Cord
Red Pine	118 Cords	\$ 38.65 / Cord
Scotch Pine	15 Cords	\$ 14.05 / Cord
White Pine	829 Cords	\$ 12.80 / Cord
White Spruce	1 Cords	\$ 7.75 / Cord

\* The total volume is statistically estimated within plus (+) or minus (-) 4.73 percent. There are an estimated 3,735 cords on this timber sale, plus or minus 177 cords at the 95% confidence level. The estimated units are final and not subject to adjustment. Prospective bidders are urged to examine this timber and to make their own estimates of quantity and quality.

### **BOND AND PAYMENT SCHEDULE:**

1. A bond in the amount of \$4,052.22 to insure faithful performance of the conditions of the contract will be deposited by the successful bidder within 21 days of the sale award.
2. Cutting in any sale or unit without the required advance payment would be considered a trespass.
3. Total payment must be paid in advance or according to the following schedule :
  - (a) Ten percent (10%) of the sale value must be paid within 21 days of the sale award.
  - (b) The 10% down payment will be credited towards the first unit cut.
  - (c) Payment for each of the following units must be made before cutting begins in that unit:

<u>PAYMENT UNIT NUMBER</u>	<u>PERCENT OF TOTAL SALE VALUE</u>
01	1.2%
02	20.1%
03	27.6%
04	16.2%
05	10.8%
06	13.8%
07	10.3%

4. If no cutting takes place, the 10% down payment will not be refunded.
5. Operations on the contract issued will terminate on 12/31/2024.

### **SALE STATISTICS**

Volumes were calculated in cubic feet using the Michigan taper model. Cubic foot volume includes all wood inside bark for the product indicated. For display purposes, cubic feet were converted to cords and MBF using a simple conversion factor, e.g. 79 cubic feet per cord and 185 cubic feet per MBF. The cubic foot volumes are precise; the cords and MBF volumes are not. Cubic foot volume cannot be directly converted to cords or boards with precision.

## SALE VOLUMES

The total estimated sale volume may not equal the sum of the species/products due to the nature of statistical calculations associated with double sampling methodology.

VOLUME			STATISTICAL RANGE IN CORDS	
TOTAL CUBIC FEET	TOTAL CORDS	PERCENT ERROR	MINIMUM	MAXIMUM
295,070	3,735	4.73%	3,558	3,912

## VDU VOLUMES

A VDU is a Volume Determination Unit. Volumes and their associated statistics are calculated at the VDU level and summarized to the sale level. There is often a one to one relationship between a VDU and a Payment Unit, but not always, depending on the cruise design. Refer to the VDU TO PAYMENT UNIT table.

	VOLUME			RANGE IN CORDS	
VDU	TOTAL CUBIC FEET	TOTAL CORDS	PERCENT ERROR	MINIMUM	MAXIMUM
8	4,178	53	14.17%	45	60
14	41,956	531	17.96%	436	626
22	119,663	1,515	4.66%	1,444	1,585
28	24,609	312	8.12%	286	337
38	26,541	336	15.45%	284	388
39	78,122	989	11.89%	871	1,106
<b>TOTAL:</b>	<b>295,070</b>	<b>3,735</b>		<b>3,367</b>	<b>4,103</b>

## VDU TO PAYMENT UNIT

When a VDU is associated with more than one Payment Unit (PU), the VDU volumes are assigned to the PU based on acres of the VDU within the PU.

VDU	VDU ACRES	PU	PU ACRES
8	3.0	1	3.0
14	10.2	2	5.4
		3	4.8
22	25.0	2	9.4
		3	15.6
28	12.2	4	12.2
38	12.5	6	12.5
39	19.7	5	10.0
		7	9.7
<b>TOTAL:</b>	<b>82.6</b>		<b>82.6</b>

**DESCRIPTION OF TIMBER BY PU (PU)**

PU	MARKET GROUP	PRODUCT	QUANTITY	UNIT	ACRES	ADVERTISE PRICE
1	Red Oak	Sawtimber	1.2	MBF	3.0	\$1,008.55
	Red Pine		1.0	MBF		
	Balsam Fir	Pulpwood	4	Cords		
	<i>Balsam Fir</i>	<i>Sawtimber</i>	<i>0.3</i>	<i>MBF</i>		
	<i>Balsam Fir</i>	<i>Pulpwood</i>	<i>3</i>	<i>Cords</i>		
	Jack Pine		33	Cords		
	Mixed Oak		3	Cords		
	<i>Bl/R/Hybrid Oak</i>		<i>2</i>	<i>Cords</i>		
	<i>Red Oak</i>		<i>1</i>	<i>Cords</i>		
	Red Maple		3	Cords		
	Red Pine		3	Cords		
	White Pine		2	Cords		
2	Bl/R/Hybrid Oak	Sawtimber	28.1	MBF	14.8	\$16,275.75
	Mixed Aspen		5.1	MBF		
	<i>B. T. Aspen</i>		<i>5.1</i>	<i>MBF</i>		
	Red Maple		2.9	MBF		
	Red Oak		3.4	MBF		
	Red Pine		0.4	MBF		
	White Pine		183.0	MBF		
	Mixed Aspen	Pulpwood	11	Cords		
	<i>B. T. Aspen</i>		<i>11</i>	<i>Cords</i>		
	Mixed Oak		78	Cords		
	<i>Bl/R/Hybrid Oak</i>		<i>63</i>	<i>Cords</i>		
	<i>Red Oak</i>		<i>15</i>	<i>Cords</i>		
	Red Maple		13	Cords		
	Red Pine		5	Cords		
	White Pine		227	Cords		
3	Bl/R/Hybrid Oak	Sawtimber	30.9	MBF	20.4	\$22,388.15
	Mixed Aspen		8.4	MBF		
	<i>B. T. Aspen</i>		<i>8.4</i>	<i>MBF</i>		
	Red Maple		4.7	MBF		
	Red Oak		5.6	MBF		
	Red Pine		0.3	MBF		
	White Pine		273.9	MBF		
	Mixed Aspen	Pulpwood	15	Cords		
	<i>B. T. Aspen</i>		<i>15</i>	<i>Cords</i>		
	Mixed Oak		92	Cords		
	<i>Bl/R/Hybrid Oak</i>		<i>73</i>	<i>Cords</i>		
	<i>Red Oak</i>		<i>19</i>	<i>Cords</i>		
	Red Maple		21	Cords		
	Red Pine		5	Cords		
	White Pine		314	Cords		
4	Mixed Aspen	Sawtimber	3.9	MBF	12.2	\$13,120.85
	<i>B. T. Aspen</i>		<i>3.9</i>	<i>MBF</i>		
	Red Oak		5.2	MBF		
	Red Pine		43.2	MBF		
	Mixed Aspen	Pulpwood	37	Cords		
	<i>B. T. Aspen</i>		<i>37</i>	<i>Cords</i>		
	Mixed Oak		33	Cords		
	<i>Red Oak</i>		<i>33</i>	<i>Cords</i>		
	Red Maple		7	Cords		
	Red Pine		104	Cords		
	Scotch Pine		15	Cords		
	<i>Scotch Pine</i>	<i>Sawtimber</i>	<i>5.1</i>	<i>MBF</i>		
	<i>Scotch Pine</i>	<i>Pulpwood</i>	<i>5</i>	<i>Cords</i>		

**DESCRIPTION OF TIMBER BY PU (PU), CON'T**

PU	MARKET GROUP	PRODUCT	QUANTITY	UNIT	ACRES	ADVERTISE PRICE
5	BI/R/Hybrid Oak	Sawtimber	3.7	MBF	10.0	\$8,724.85
	Red Maple		1.0	MBF		
	Red Oak		4.6	MBF		
	Red Pine		4.8	MBF		
	White Pine		129.9	MBF		
	Mixed Oak	Pulpwood	9	Cords		
	BI/R/Hybrid Oak		7	Cords		
	Red Oak		2	Cords		
	Red Maple		17	Cords		
	Red Pine		1	Cords		
	White Pine		140	Cords		
6	BI/R/Hybrid Oak	Sawtimber	81.4	MBF	12.5	\$11,157.15
	White Pine		3.1	MBF		
	Mixed Aspen	Pulpwood	2	Cords		
	B. T. Aspen		2	Cords		
	Mixed Oak		143	Cords		
	BI/R/Hybrid Oak		143	Cords		
	Red Maple		4	Cords		
	White Pine		11	Cords		
	White Spruce		1	Cords		
	7	BI/R/Hybrid Oak	Sawtimber	3.5		
Red Maple			1.0	MBF		
Red Oak			4.4	MBF		
Red Pine			4.7	MBF		
White Pine			126.1	MBF		
Mixed Oak		Pulpwood	8	Cords		
BI/R/Hybrid Oak			7	Cords		
Red Oak			1	Cords		
Red Maple			16	Cords		
White Pine			135	Cords		
TOTAL:			969.4	MBF		
TOTAL:			1,512	Cords		

## **Sale Specific Conditions & Requirements**

**Sale Name: JC Island Mix**

**Sale Number: 54-020-21 Seq#: 1**

### **1 - Sale Area**

#### **1.2 - Boundaries**

##### **1.2.1 - Painted boundaries (9/19)**

The sale boundary and Payment Unit boundaries are marked and identified by blue, red, and yellow paint. Exterior sale boundary lines against private property are marked with blue paint. Exterior sale boundary lines against state are marked with red paint. Interior Payment Unit boundaries are marked with yellow paint. The painted boundary line trees are not Included Timber and are to be protected. Yellow painted trees designating an interior Payment Unit boundary are only to be cut when all surrounding Payment Units have been paid.

### **2 - Timber Specifications**

#### **2.1 - Included Timber**

##### **2.1.1 - Clearcut unit(s) with unmerchantable trees (6/14)**

Within Payment Unit(s) 1-3 and 5-7, cut all trees that are two (2) inches or more at DBH, except do not cut trees marked with green paint. Special protection trees identified in accordance with condition 3.4.2, within clearcutting unit boundaries, are not Included Timber and are to be protected.

##### **2.1.3 - Cut tree marked unit(s) (12/08)**

Within Payment Unit(s) 4, red pine, white pine, scotch pine, and oak are designated for cutting when marked with orange paint above and below stump height, regardless of merchantability. In addition, all aspen, red maple, and paper birch which meet minimum piece specifications in 2.2 Utilization, are designated for cutting.

#### **2.2 - Utilization**

##### **2.2.2 - Chipping required (2/18)**

Payment Units 2 and 3 must be chip harvested to facilitate subsequent planting operations. The Purchaser has the option to produce sawlogs or pulpwood bolts, but the remaining portion of the trees must be chipped and hauled within 60 days of severing/cutting stem(s). Products may be produced as roundwood and forwarded to decking areas in final product length, but the tops must be left intact and skidded to the landing for chipping to minimize the amount of residual slash. If market conditions limit the practicality of chipping, chipping is not required if the following conditions are met. Trees greater than 4 inches at DBH must be cut to a 2-inch top or smaller. Sub-merchantable trees, and hardwood limbs 4 inches or greater where they attach to the stem, are to be cut/reduced to 4-foot lengths. Slash must be evenly dispersed throughout the Payment Unit, and not be more than 2 feet high. In all cases harvesting operations must allow for subsequent planting operations, as determined by the sale administrator. The requirement to retain approximately 1/6 to 1/3 of tree tops and limbs less than four inches in diameter is still applicable (G. C. & R. 2.2).

##### **2.2.3 - Stump heights (4/07)**

Stump heights within Payment Unit(s) 2 and 3 shall not exceed 6 inches for all trees. This is to facilitate planting operations.

### **3 - Payments**

#### **3.3 - Pre-measured Sales**

##### **3.3.4 - Dividing payment units (7/14)**

Payment Unit(s) \$25,000 in value or greater may be divided at the request of the Purchaser and upon approval of the Unit Manager. Dividing Payment Units is a contract modification which requires a Timber Sale Contract Amendment. There will be only one division per Payment Unit.

#### **3.4 - Damaged Timber**

##### **3.4.1 - Damaged timber (7/16)**

General Condition and Requirement 3.4 Damaged Timber, defines liquidated damages for undesignated live merchantable

trees which are cut or injured. In addition, extreme care should be taken to avoid damage to tree seedlings and saplings. Within Payment Unit 6, if more than 25% of the white pine and/or red pine tree seedlings or saplings (1/4" to 4.5" DBH) within a specified portion of the Sale Area are damaged, liquidated damages will be assessed at \$150 per acre for all acreage within that specified portion of the Sale Area that was damaged. Please note, all scotch pine regeneration is to be severed at its base.

No damage is acceptable to undesignated live merchantable trees. Within the Sale Area, if more than 5% of trees (> 4.5" DBH) within a specified area of the sale are damaged, liquidated damages will be assessed for all trees damaged. Rates will be in accordance with General Condition and Requirement 3.4 Damaged Timber.

#### 3.4.2 - Special Protection Trees (4/14)

The Purchaser shall not cut live or dead special protection trees within cutting units or clearings. Special protection trees are marked with green paint within Payment Units 2, 3, and 5-7. If the Purchaser's operations have cut or damaged special protection trees through carelessness, the Purchaser shall pay \$250 as fixed, agreed and liquidated damages for each special protection tree cut or damaged. Such payment does not constitute ownership of the undesignated timber.

### 4 - Transportation

#### 4.1 - Construction

##### 4.1.3 - Slash and earthen piles (8/04)

Piles or windrows of earth along roads and landings that have been widened or constructed shall be leveled. Slash from road maintenance or construction, including stumps, shall be dispersed throughout the sale.

##### 4.1.6 - Road construction (1/09)

Improvements of existing roads shall be done in such a way as to minimize the environmental and visual impacts. Merchantable trees shall be cut and utilized unless otherwise directed. Non-merchantable trees shall be severed and laid flat on the ground. Slash shall be scattered, and not left in windrows and kept a minimum of 10 feet back from the road edge. Stumps shall be set upright, not left on edge, and be moved at least 10 feet away from the road edge. Disturbed soil shall be feathered into the woods and not left in berms or windrows.

##### 4.1.8 - Road work (1) (8/07)

The following road work is required: before running logging trucks on the snowmobile trail for hauling wood from Payment Units, adequate amounts of 3 minus crushed limestone must be placed in the snowmobile trail, as determined by the sale administrator, to prevent the breakdown and rutting of the trail. If rutting begins in the snowmobile trail during hauling operations, all hauling must cease on the deteriorating portion of trail until 3 minus stone is placed and the sale administrator grants permission to continue hauling.

##### 4.1.12 - No new roads (1/12)

No new roads will be permitted in any Payment Unit. All operations are limited to existing roads. Skid trails only will be allowed.

#### 4.2 - Maintenance

##### 4.2.5 - Two wheel drive condition (2/04)

All existing trail roads on and adjacent to the sale area must be passable by two-wheel drive traffic for the duration of the sale.

### 5 - Operations

#### 5.1 - Notification

##### 5.1.1 - Pre-sale conference (10/16)

A pre-sale conference on site between the Purchaser and sale administrator is required prior to beginning any operations in a Payment Unit to determine landing and road locations. The Unit Manager or his/her representative must be contacted at least 5 days in advance to schedule the conference.

##### 5.1.4 - Post-sale conference (10/16)

A post-sale conference on site between the Purchaser and sale administrator is required 5 days prior to the completion of active logging operations to determine clean-up and repair of landings, road edges, and the fulfillment of other contract specifications.

## 5.2 - Conduct of Operations

### 5.2.1 - Slash

#### 5.2.1.10 - No slash in openings (5/10)

No brush or logging debris is to be left in the maintained wildlife opening which is indicated by G0 on the Timber Sale Map. Any damage to the opening shall be repaired according to specifications of the Unit Manager or his/her representative.

### 5.2.2 - Hazard Trees/Snags

#### 5.2.2.1 - Den trees (10/16)

Obvious hollow and/or den trees shall be protected and left standing unless they are a safety hazard.

### 5.2.3 - Operating Restrictions

#### 5.2.3.1 - Operating restrictions (9/11)

Within Payment Unit(s) 5-7 unless approved by the Unit Manager, hauling is not permitted from 5:00 p.m. Friday evening through 6:00 a.m. Monday morning during the period of December 1 to March 31. This restriction is due to the necessity of using the snowmobile trail for hauling wood from the sale.

#### 5.2.3.4 - Oak wilt restriction, no exceptions (1/18)

Within Payment Unit(s) 4, cutting, skidding, hauling within the sale and brushing of access roads to the sale are not permitted during the period of April 15 to July 15. No exceptions will be granted. This is necessary to reduce the spread of oak wilt.

#### 5.2.3.5 - Oak wilt restriction (1/18)

Within Payment Unit(s) 1-3 and 5-7 unless changed by written agreement, cutting, skidding, hauling within the sale and brushing of access roads to the sale are not permitted during the period of April 15 to July 15. Operations may be allowed if specific steps are taken to prevent damaging uncut oak during the high risk period. Those steps may include completing all road brushing before April 15th and clearing a tree-length buffer along uncut oak cover before April 15th. This is necessary to reduce the spread of oak wilt. For more information, contact the Unit Manager or his/her representative.

#### 5.2.3.6 - Bark beetle restriction (12/08)

In the event drought creates a high risk of pine bark beetle infestation, pine is not to be cut during the period March 1 through July 1, unless all portions of trees greater than two inches in diameter are removed from the sale area, reduced to chips, or treated to the satisfaction of the Unit Manager or his/her representative, within fifteen days of being severed from the stump. Pine log decks, pulpwood piles and treetops that are piled for chipping in the fall or winter within a 1/4 mile of susceptible sites must be removed before March 15. Residual slash must not be placed in piles or rows and must be spread over the site for quick drying. The Department of Natural Resources will exercise this specification if the risk of damage warrants.

#### 5.2.3.11 - Coppice regeneration protection (4/10)

Timber harvesting in Payment Units 1 and 5-7 must be completed before significant tree sprouting occurs to minimize damage to the new regeneration. Any post-harvest operations, such as chipping, must be completed before sprouting of regeneration occurs. If it is anticipated that chipping will be delayed, then tops shall be carried to one central location or left unchipped. The Unit Manager or his/her representative may cease such operations if sprouting occurs before the operation is complete.

### 5.2.32 - Decking/landing restoration (9/13)

All decking and landing areas must have the surface area restored to a condition equal to or better than before. This is to ensure the proper regeneration of the stand. Wood debris, chips, and "cookies" from trimmings must be removed or scattered away from landing and loading areas and may not be windrowed on the edge.

### 5.2.38 - No decking against live trees (2/04)

Cut products may not be decked against unmarked or designated leave trees.

### 5.2.41 - Snowmobile trail protection (9/11)

The LP461/462 trail is a snowmobile trail and is shown on the Timber Sale Map. Do not cut or damage posts with orange trail markers or traffic control signs. If the trail is used, it must be maintained and restored to a condition equal to or better than



before the sale. The road maintenance/restoration must be done prior to December 1. If the trail is used for hauling, it must be graded to the satisfaction of the Unit Manager or his/her representative prior to December 1. If the trail road is to be used for hauling during the snowmobile season, then a snow-covered base must be left on the trail. The snowmobile trail may only be crossed at right angles. Maintain a 20-foot-wide slash, debris, and rut free zone daily using the snowmobile trail as the centerline. No decking of forest products will be permitted along the snowmobile trail. All stumps within 20 feet of the snowmobile trail must be cut at ground level. In addition, any trees cut within 5 feet of the trail must have the stumps removed and be disposed of according to the direction of the Unit Manager or his/her representative.

#### 5.4 - Soil Protection

##### 5.4.1 - Rutting restriction, general (7/16)

Operations are to cease immediately if equipment and weather conditions result in rutting of roads and/or skid trails which is 12 inches or greater in depth and 50 feet in length. The Unit Manager or his/her representative may restrict hauling and/or skidding if ruts exceed the specified depth. With the Unit Manager or his/her representative's approval, the Purchaser may return to the area when the risk of rutting has decreased.

#### 5.8 - Protection of Endangered Species

##### 5.8.3 - Red shoulder hawk or goshawk (2/16)

In the event that an active red shoulder hawk or goshawk nest is found, the contract may be amended to protect the nest site until the nest is determined to be inactive. The value of the trees in this excluded area will be refunded or credited to the Purchaser. The nest will be buffered with a five-chain radius (eight acre) protection area, centered on the nest tree, in which there will be no cutting or new roads constructed. Avoid human disturbance, including loading and skidding, in the protection area.

An additional zone of five chains (ten chains centered on the active nest tree) will be established in which there is no management activity from March 15 to July 15 (NLP). Limit biomass harvesting and chipping operations within this ten-chain zone, retain the maximum one-third of residues per the Woody Biomass Harvesting Guidelines (Michigan DNR 2010). Nests determined to be inactive will be protected with a one-chain no-harvest buffer.

### 6 - Safety and Fire Prevention

#### 6.2 - Signing

##### 6.2.1 - Road posting (10/20)

The Purchaser is responsible for posting and maintaining caution signs on all forest roads prior to beginning operations. The road must be posted at appropriate distances from the Sale Area to warn of logging activity and truck traffic. Signs must be removed when harvest operations are suspended or completed. The Purchaser will provide these signs.

##### 6.2.2 - Snowmobile trail posting (10/20)

The Purchaser is responsible for posting and maintaining caution signs on snowmobile trail LP461/462 prior to beginning operations during the snowmobile season (approximately December 1 to March 31). The trail must be posted at appropriate distances from the Sale Area to warn of logging activity and truck traffic. Signs must be removed when harvest operations are suspended or completed. The Purchaser will provide these signs.



## TIMBER SALE MAP

This information provided by authority of Part 525, 1994 PA 451, as amended.

Sale Number	Year
54-020	21

Forest Management Unit Atlanta		County Alpena	Mapped By D. Parris	Date 08/28/2021	Page 1	of 1
Township 31N	Range 07E	Section(s) and Subdivision(s) Sec. 34 NENW,SWNE,SE		Scale 1:15,840		

Cover Type				Density	
A = Aspen	H = Hemlock	N = Marsh	U = Upland Brush	0 = Non Stocked	5 = Pole Timber Medium
B = Paper Birch	J = Jack Pine	O = Oak	UM = Upland Mixed	1 = Seedling Sapling Poor	6 = Pole Timber Well
C = Cedar	L = Lowland Brush	P = Lowland Poplar	V = Bog or Marsh	2 = Seedling Sapling Medium	7 = Saw Timber Poor
D = Treed Bog	LM = Lowland Mixed	Q = Mixed Swamp Conifer	W = White Pine	3 = Seedling Sapling Well	8 = Saw Timber Medium
E = Swamp Hdwoods	M = Mpl, Bch, Brch	R = Red Pine	X = Non Stocked	4 = Pole Timber Poor	9 = Saw Timber Well
F = Spruce Fir	MC = Mixed Conifer	S = Black Spruce	Z = Water		
G = Grass	MD = Mixed Deciduous	T = Tamarack			

PU	Acres	PU	Acres
1	3.0	5	10.0
2	14.8	6	12.5
3	20.4	7	9.7
4	12.2		

## JC Island Mix

Compartment 105  
82.6 Acres

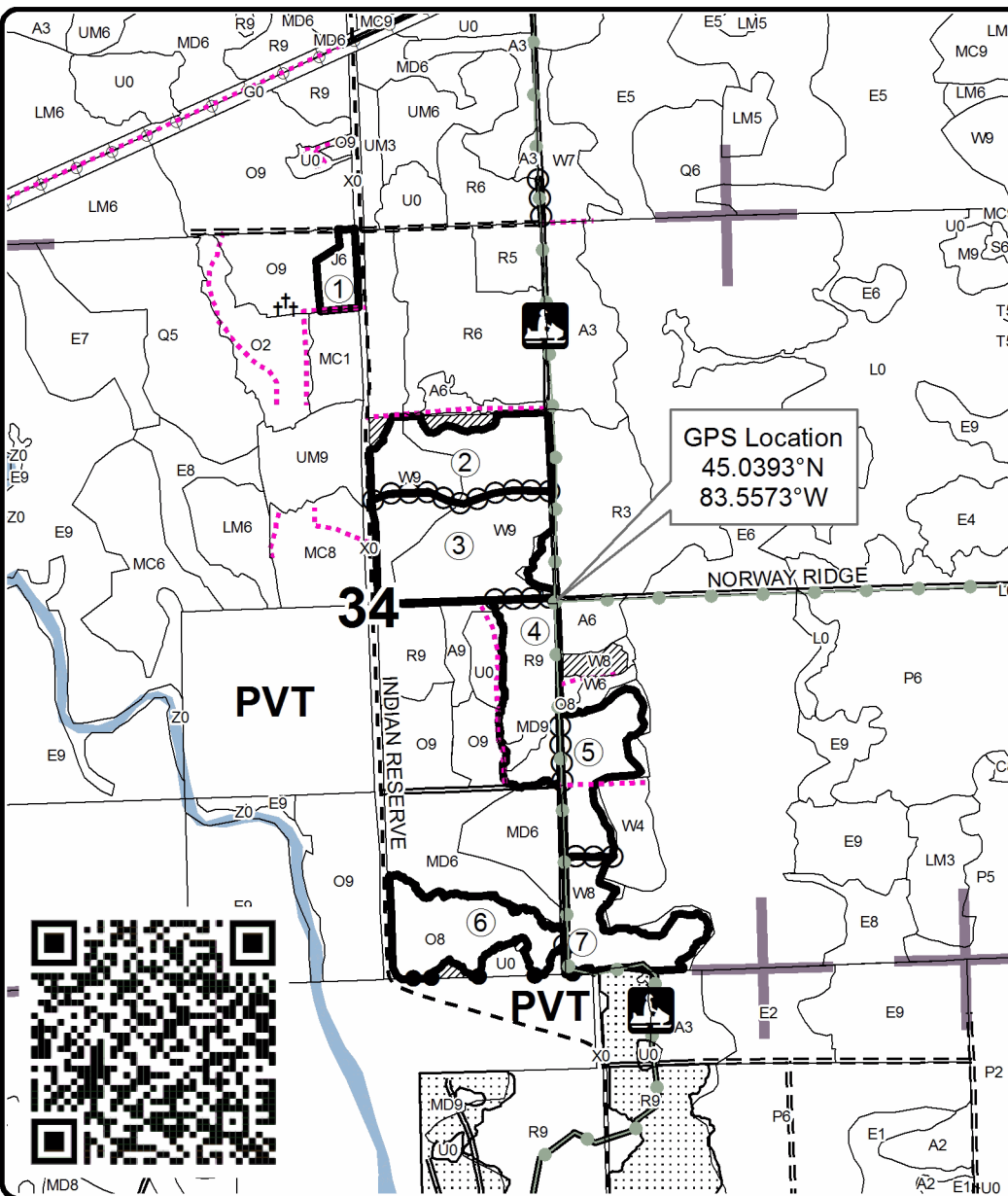
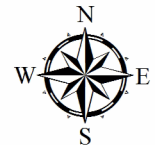

## Legend

- Against State (Red)
- ⊗ Payment Unit (Yellow)
- Private Line (Blue)
- Stand Boundaries
- ▨ Retention Area
- ▤ Nearby Timber Sales
- Payment Unit
- †† Cemetery
- == Secondary Forest Road
- == Forest Access Route
- - Gravel Road
- ... Temporary Management Access
- Recreational Trail
- ⚡ Powerline
- Lakes and Rivers
- Section Corners

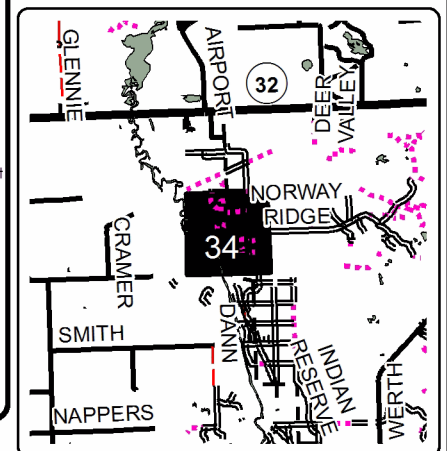
Locator Map  
1:150,000

0 0.125 0.25 0.5 0.75 1 Miles