



**DEPARTMENT OF NATURAL RESOURCES  
STATE OF MICHIGAN  
TIMBER SALE PROSPECTUS #7084**

SCHEDULED SALE DATE AND TIME: **10:00 a.m. (local time) on July 27, 2022.**

LOCATION: **GLADWIN MGMT UNIT, 801 NORTH SILVERLEAF, GLADWIN, MI 48624.**

CONTACT NAME: Patrick Mohnney

PHONE NUMBER: (989) 426-9205

PROSPECTUS NOTE: The bidder is advised to inspect the sale area and review the location, estimated volumes, operating costs and contract terms of proposed sales. Please be aware that some landowners may request 60 days or more notice for access across their land.

Notice is hereby given that bids will be received by the Unit Manager, GLADWIN MANAGEMENT UNIT, for certain timber on the following described lands:

Carrol Creek Select (73-009-21) / T14N, R01W, SEC. 4 , N1/2NW,SWNW.

T14N, R01W, SEC. 5 , SENW,NE.

T14N, R01W, SEC. 8 , S1/2NW.

T15N, R01W, SEC. 33, NENW,W1/2NE.

Midland County, Advertised Price \$47,354.20, 144.5 Acres, Hardwood, Red Oak.

SALE NOTE: All units of volume listed for this sale were estimated using the Inventory Manager computer program and the new Michigan taper model.

A recreation site such as a trail, pathway, or campground is within the sale area or the vicinity.  
Certain restrictions/specifications may be applicable including time restrictions.

## TIMBER SALE INFORMATION

Carrol Creek Select (73-009-21)

T14N, R01W, SEC. 4; T14N, R01W, SEC. 5; T14N, R01W, SEC. 8; T15N, R01W, SEC. 33.

Midland County (Advertised Price \$47,354.20)

**SALE NOTE:** All units of volume listed for this sale were estimated using the Inventory Manager computer program and the new Michigan taper model.

A recreation site such as a trail, pathway, or campground is within the sale area or the vicinity. Certain restrictions/specifications may be applicable including time restrictions.

A timber sale contract for this lump sum, sealed bid timber sale will be awarded to the responsible bidder offering the highest sealed bid price. All units of volume listed below were estimated using the Inventory Manager computer program and the new Michigan taper model. Bids must be at or above the following advertised price for each product and species:

<u>PRODUCTS &amp; SPECIES</u>	<u>ESTIMATED UNITS*</u>	<u>ADVERTISED PRICE</u>
Sawtimber		
Mixed Aspen	37.9 MBF	\$ 70.00 / MBF
Mixed Oak	101.0 MBF	\$ 57.00 / MBF
Red Maple	91.2 MBF	\$ 40.00 / MBF
Red Oak	134.2 MBF	\$ 86.00 / MBF
Swamp White Oak	53.1 MBF	\$ 88.00 / MBF
White Oak	32.1 MBF	\$ 65.00 / MBF
White Pine	10.9 MBF	\$ 57.00 / MBF
Pulpwood		
Mixed Aspen	164 Cords	\$ 23.70 / Cord
Mixed Hardwood	19 Cords	\$ 15.25 / Cord
Mixed Oak	299 Cords	\$ 12.75 / Cord
Red Maple	428 Cords	\$ 15.25 / Cord
Swamp White Oak	88 Cords	\$ 16.20 / Cord
White Pine	20 Cords	\$ 21.65 / Cord

\* The total volume is statistically estimated within plus (+) or minus (-) 6.58 percent. There are an estimated 2,129 cords on this timber sale, plus or minus 140 cords at the 95% confidence level. The estimated units are final and not subject to adjustment. Prospective bidders are urged to examine this timber and to make their own estimates of quantity and quality.

### **BOND AND PAYMENT SCHEDULE:**

1. A bond in the amount of \$2,367.71 to insure faithful performance of the conditions of the contract will be deposited by the successful bidder within 21 days of the sale award.
2. Cutting in any sale or unit without the required advance payment would be considered a trespass.
3. Total payment must be paid in advance or according to the following schedule :
  - (a) Ten percent (10%) of the sale value must be paid within 21 days of the sale award.
  - (b) The 10% down payment will be credited towards the first unit cut.
  - (c) Payment for each of the following units must be made before cutting begins in that unit:

<u>PAYMENT UNIT NUMBER</u>	<u>PERCENT OF TOTAL SALE VALUE</u>
01	3.9%
02	10.5%
03	11.2%
04	12.1%
05	44.8%
06	6.8%
07	10.7%

4. If no cutting takes place, the 10% down payment will not be refunded.
5. Operations on the contract issued will terminate on 09/30/2025.

### **SALE STATISTICS**

Volumes were calculated in cubic feet using the Michigan taper model. Cubic foot volume includes all wood inside bark for the product indicated. For display purposes, cubic feet were converted to cords and MBF using a simple conversion factor, e.g. 79 cubic feet per cord and 185 cubic feet per MBF. The cubic foot volumes are precise; the cords and MBF volumes are not. Cubic foot volume cannot be directly converted to cords or boards with precision.

## SALE VOLUMES

The total estimated sale volume may not equal the sum of the species/products due to the nature of statistical calculations associated with double sampling methodology.

VOLUME			STATISTICAL RANGE IN CORDS	
TOTAL CUBIC FEET	TOTAL CORDS	PERCENT ERROR	MINIMUM	MAXIMUM
168,165	2,129	6.58%	1,988	2,269

## VDU VOLUMES

A VDU is a Volume Determination Unit. Volumes and their associated statistics are calculated at the VDU level and summarized to the sale level. There is often a one to one relationship between a VDU and a Payment Unit, but not always, depending on the cruise design. Refer to the VDU TO PAYMENT UNIT table.

	VOLUME			RANGE IN CORDS	
VDU	TOTAL CUBIC FEET	TOTAL CORDS	PERCENT ERROR	MINIMUM	MAXIMUM
17	17,256	218	15.18%	185	252
18	69,585	881	8.69%	804	957
25	21,519	272	21.81%	213	332
39	8,858	112	22.26%	87	137
43	20,264	257	20.69%	203	310
96	10,186	129	22.51%	100	158
97	20,496	259	27.00%	189	330
<b>TOTAL:</b>	<b>168,165</b>	<b>2,129</b>		<b>1,782</b>	<b>2,475</b>

## VDU TO PAYMENT UNIT

When a VDU is associated with more than one Payment Unit (PU), the VDU volumes are assigned to the PU based on acres of the VDU within the PU.

VDU	VDU ACRES	PU	PU ACRES
17	12.5	4	12.5
18	51.2	5	51.2
25	29.7	3	29.7
39	8.5	1	8.5
43	13.8	2	13.8
96	6.9	6	6.9
97	21.9	7	21.9
<b>TOTAL:</b>	<b>144.5</b>		<b>144.5</b>

**DESCRIPTION OF TIMBER BY PU (PU)**

PU	MARKET GROUP	PRODUCT	QUANTITY	UNIT	ACRES	ADVERTISE PRICE
1	Mixed Aspen	Sawtimber	1.9	MBF	8.5	\$1,824.15
	<i>Quaking Aspen</i>		1.9	<i>MBF</i>		
	Mixed Oak		3.1	MBF		
	<i>Bl/R/Hybrid Oak</i>		3.1	<i>MBF</i>		
	Red Maple	Pulpwood	7.4	MBF		
	Mixed Aspen		1	Cords		
	<i>Quaking Aspen</i>		1	<i>Cords</i>		
	Mixed Oak		4	Cords		
	<i>Bl/R/Hybrid Oak</i>		4	<i>Cords</i>		
	Red Maple		75	Cords		
2	Mixed Oak	Sawtimber	44.4	MBF	13.8	\$4,950.05
	<i>Bl/R/Hybrid Oak</i>		44.4	<i>MBF</i>		
	Red Maple	Pulpwood	17.3	MBF		
	Mixed Hardwood		10	Cords		
	<i>Paper Birch</i>		10	<i>Cords</i>		
	Mixed Oak		35	Cords		
	<i>Bl/R/Hybrid Oak</i>		35	<i>Cords</i>		
	Red Maple		74	Cords		
3	Mixed Oak	Sawtimber	2.2	MBF	29.7	\$5,283.65
	<i>Northern Pin Oak</i>		2.2	<i>MBF</i>		
	Red Maple	Pulpwood	20.3	MBF		
	Red Oak		9.5	MBF		
	Swamp White Oak		4.3	MBF		
	White Oak		7.4	MBF		
	White Pine		2.0	MBF		
	Mixed Aspen		29	Cords		
	<i>B. T. Aspen</i>		29	<i>Cords</i>		
	Mixed Oak		63	Cords		
	<i>Northern Pin Oak</i>		52	<i>Cords</i>		
	<i>Red Oak</i>		5	<i>Cords</i>		
	<i>White Oak</i>		6	<i>Cords</i>		
	Red Maple		61	Cords		
	Swamp White Oak		7	Cords		
	White Pine		1	Cords		
4	Red Maple	Sawtimber	7.3	MBF	12.5	\$5,745.75
	Red Oak		34.2	MBF		
	Swamp White Oak	Pulpwood	2.7	MBF		
	White Oak		21.0	MBF		
	Mixed Oak		39	Cords		
	<i>Red Oak</i>		26	<i>Cords</i>		
	<i>White Oak</i>		13	<i>Cords</i>		
	Red Maple		26	Cords		
	Swamp White Oak		1	Cords		
5	Mixed Aspen	Sawtimber	27.3	MBF	51.2	\$21,258.90
	<i>B. T. Aspen</i>		5.8	<i>MBF</i>		
	<i>Quaking Aspen</i>		21.5	<i>MBF</i>		
	Red Maple	Pulpwood	35.7	MBF		
	Red Oak		90.5	MBF		
	Swamp White Oak		46.1	MBF		
	White Oak		2.8	MBF		
	Mixed Aspen		38	Cords		
	<i>B. T. Aspen</i>		2	<i>Cords</i>		
	<i>Quaking Aspen</i>		36	<i>Cords</i>		
	Mixed Hardwood		9	Cords		
	<i>Paper Birch</i>		2	<i>Cords</i>		

**DESCRIPTION OF TIMBER BY PU (PU), CON'T**

PU	MARKET GROUP	PRODUCT	QUANTITY	UNIT	ACRES	ADVERTISE PRICE	
5 con't	<i>Rock Elm</i>	<i>Pulpwood</i>	7	<i>Cords</i>			
	Mixed Oak		81	Cords			
	<i>Red Oak</i>		71	<i>Cords</i>			
	<i>White Oak</i>		10	<i>Cords</i>			
	Red Maple		166	Cords			
	Swamp White Oak		80	Cords			
6	Mixed Aspen	Sawtimber	8.7	MBF	6.9	\$3,215.60	
	<i>B. T. Aspen</i>		8.7	<i>MBF</i>			
	Mixed Oak		2.4	MBF			
	<i>Bl/R/Hybrid Oak</i>		2.4	<i>MBF</i>			
	Red Maple		3.2	MBF			
	Mixed Aspen		84	Cords			
	<i>B. T. Aspen</i>		67	<i>Cords</i>			
	<i>Quaking Aspen</i>		17	<i>Cords</i>			
	Mixed Oak		6	Cords			
	<i>Bl/R/Hybrid Oak</i>		6	<i>Cords</i>			
	Red Maple		18	Cords			
	7		Mixed Oak	Sawtimber			48.9
<i>Bl/R/Hybrid Oak</i>		48.9	<i>MBF</i>				
White Oak		0.9	MBF				
White Pine		8.9	MBF				
Mixed Aspen		12	Cords				
<i>B. T. Aspen</i>		12	<i>Cords</i>				
Mixed Oak		71	Cords				
<i>Bl/R/Hybrid Oak</i>		69	<i>Cords</i>				
<i>White Oak</i>		2	<i>Cords</i>				
Red Maple		8	Cords				
White Pine		19	Cords				
TOTAL:			460.4		MBF		
TOTAL:			1,018	Cords			

## Sale Specific Conditions & Requirements

**Sale Name: Carrol Creek Select**

**Sale Number: 73-009-21 Seq#: 1**

### 1 - Sale Area

#### 1.2 - Boundaries

##### 1.2.1 - Painted boundaries (9/19)

The sale boundary and Payment Unit boundaries are marked and identified by blue, red, and yellow paint. Exterior sale boundary lines against private property are marked with blue paint. Exterior sale boundary lines against state are marked with red paint. Interior Payment Unit boundaries are marked with yellow paint. The painted boundary line trees are not Included Timber and are to be protected unless marked with orange paint. Yellow painted trees designating an interior Payment Unit boundary are only to be cut when all surrounding Payment Units have been paid.

### 2 - Timber Specifications

#### 2.1 - Included Timber

##### 2.1.1 - Clearcut unit(s) with unmerchantable trees (6/14)

Within Payment Unit(s) 6, cut all trees that are two (2) inches or more at DBH, except trees marked with green paint above and below stump height.

##### 2.1.3 - Cut tree marked unit(s) (12/08)

Within Payment Unit(s) 1 and 3, all trees are designated for cutting when marked with orange paint above and below stump height, regardless of merchantability.

##### 2.1.5 - Overstory removal unit(s) (8/11)

Within Payment Unit(s) 2, 4, and 7, all trees with DBH equal to or greater than 4 inches which meet minimum piece specifications in 2.2 Utilization, are designated for cutting, except for trees marked with green paint above and below stump height. Do not cut red and white pine within Payment Units 2 and 4.

##### 2.1.7 - Leave tree marked unit(s) (6/14)

Within Payment Unit(s) 5, cut all trees that are six (6) inches or more at DBH, except trees marked with green paint above and below stump height.

#### 2.2 - Utilization

##### 2.2.6 - Roundwood operation required (3/21)

The skidding of whole trees or tree segments with limbs attached is prohibited within Payment Unit(s) 1-5 and 7. All products must be produced as roundwood and forwarded to existing roads or landing areas in final product length. Trees must be harvested with in-woods processor to retain existing understory and protect residual canopy trees.

##### 2.2.9 - No chipping permitted (12/08)

Within Payment Unit(s) 1-5 and 7, all wood must be removed by whole tree, tree segment, or roundwood. No chipping is permitted.

### 3 - Payments

#### 3.4 - Damaged Timber

##### 3.4.1 - Damaged timber (7/16)

General Condition and Requirement 3.4 Damaged Timber, defines liquidated damages for undesignated live merchantable trees which are cut or injured. In addition, extreme care should be taken to avoid damage to tree seedlings and saplings.

Within the Sale Area, if more than 25% of the tree seedlings or saplings (1/4" to 4.5" DBH) within a specified portion of the Sale Area are damaged, liquidated damages will be assessed at \$100 per acre for all acreage within that specified portion of the Sale Area that was damaged.

No damage is acceptable to undesignated live merchantable trees. Within the Sale Area, if more than 10% of trees (> 4.5" DBH) within a specified area of the sale are damaged, liquidated damages will be assessed for all trees damaged. Rates will

be in accordance with General Condition and Requirement 3.4 Damaged Timber.

## **4 - Transportation**

### **4.1 - Construction**

#### **4.1.6 - Road construction (1/09)**

Construction of new roads or improvements of existing roads shall be done in such a way as to minimize the environmental and visual impacts. Merchantable trees shall be cut and utilized unless otherwise directed. Non-merchantable trees shall be severed and laid flat on the ground. Slash shall be scattered, and not left in windrows and kept a minimum of 10 feet back from the road edge. Stumps shall be set upright, not left on edge, and be moved at least 10 feet away from the road edge. Disturbed soil shall be feathered into the woods and not left in berms or windrows.

#### **4.1.7 - Road closure (10/11)**

All new roads built into the sale must be blocked to vehicle traffic upon completion of the sale. Overgrown roads that are reopened shall be considered new roads. In general, this will require constructing a four (4') foot high berm of stumps and logs covered with earth. Stumps and brush must be placed along the remainder of the trail. These roads must be rendered impassable to cars and trucks. Contact the sale administrator for specific details of design and placement.

#### **4.1.8 - Road work (1) (8/07)**

The following road work is required if the Purchaser uses 11 Mile Road to access Payment Unit 3: cap road with 400 feet of geotextile fabric and 40 yards of gravel. On site fill may be used to raise roadbed.

#### **4.1.11 - Permits (2/12)**

The Purchaser will secure any necessary driveway and stream crossing permits that may be required.

## **5 - Operations**

### **5.2 - Conduct of Operations**

#### **5.2.1 - Slash**

##### **5.2.1.11 - Slash for reforestation (3/21)**

To facilitate reforestation, the Sale Area shall be left with slash evenly distributed. Bunched tops within the cutting area shall be broken up and scattered. Stumps shall be cut low to the ground. Processing sites shall not be left with a compacted layer of slash; tops from these sites shall be hauled back into the cut area and scattered.

#### **5.2.3 - Operating Restrictions**

##### **5.2.3.1 - Operating restrictions (9/11)**

Within Payment Unit(s) 1-7, unless changed by written agreement, cutting, skidding, and hauling are limited to the period of December 1 to April 15 and from June 15 to November 1. This restriction is because of seasonally saturated soils.

##### **5.2.3.3 - Bark slippage restriction (3/09)**

Within Payment Unit(s) 1, 3, and 5, unless changed by written agreement, cutting and skidding are not permitted during the period of April 15 to July 15. This restriction is because of bark slippage.

##### **5.2.3.4 - Oak wilt restriction, no exceptions (1/18)**

Within Payment Unit(s) 1-5 and 7, cutting, skidding, hauling within the sale and brushing of access roads to the sale are not permitted during the period of April 15 to July 15. No exceptions will be granted. This is necessary to reduce the spread of oak wilt.

#### **5.2.4 - Dead and Down Creation**

##### **5.2.4.4 - Dead and down creation, grouse (6/18)**

To encourage grouse and other wildlife, in Payment Unit(s) 6, leave one 12" or larger diameter whole tree on the ground for every 3 acres. Trees should be scattered throughout the sale and at least two chains from any roads, two-tracks, or trails open to vehicles, or positioned per the sale administrator's instructions. Stumps must be at least 3 feet tall.

##### **5.2.17 - Timber Mats and Interlocking Composite Mats (10/20)**

Some roads or skid trails may require extra protection such as that afforded by timber mats, interlocking composite mats, or

another approved system. A Timber Sale Contract Supplement will be used to document the Purchaser's use of the DNR's mats. Contact the sale administrator regarding availability and pick-up. Timber mats are available from various field offices. Composite mats are only available from the Grayling field office and the Marquette ICC. The Purchaser is responsible for picking up and hauling the mats to and from the site. The composite mats will require DNR staff onsite for installation and removal. Contact the sale administrator to schedule at least 30 days before desired install/removal date. All mats must be cleaned prior to drop off. This may include, but is not limited to, power washing and brushing to remove mud and debris. A charge of \$700.00 per timber mat and \$2,000.00 per composite mat will be assessed for all damaged or non-returned mats. Damage for the crane/timber mats is defined as three or more broken cants. Damage for the composite mats is defined as cracked or broken mats.

#### 5.2.31 - Landing locations (9/13)

Recommended landing areas are marked on the Timber Sale Map with the letter "L". All landing locations must be approved by the timber sale administrator.

#### 5.2.32 - Decking/landing restoration (9/13)

All decking and landing areas must have the surface area restored to a condition equal to or better than before. This is to ensure the proper regeneration of the stand. Wood debris, chips, and "cookies" from trimmings must be removed or scattered away from landing and loading areas and may not be windrowed on the edge.

### 5.4 - Soil Protection

#### 5.4.1 - Rutting restriction, general (7/16)

Operations are to cease immediately if equipment and weather conditions result in rutting of roads and/or skid trails which is 12 inches or greater in depth and 50 feet in length. The Unit Manager or his/her representative may restrict hauling and/or skidding if ruts exceed the specified depth. With the Unit Manager or his/her representative's approval, the Purchaser may return to the area when the risk of rutting has decreased.



**TIMBER SALE MAP**

This information provided by authority of Part 525, 1994 PA 451, as amended.

Sale Number	Year
73 - 009	21

Forest Management Unit Gladwin		County Midland	Mapped By Scott Shooltz	Date 09/30/2021	Page 1	of 3
			Cruised By Shooltz, Nyhoff			
Township 15N, 14N	Range 01W	Section(s) and Subdivision(s) 33, 04, 05, 08		Scale 1:15,840		

**Cover Type**

A = Aspen	H = Hemlock	N = Marsh	L = Upland Brush
E = Paper Birch	J = Jack Pine	O = Oak	LM = Upland Mixed
C = Cedar	L = Lowland Brush	P = Lowland Poplar	V = Bog or Marsh
D = Treed Bog	LM = Lowland Mixed	Q = Mixed Swamp Conifer	W = White Pine
G = Swamp Hardwoods	M = Mpl. Bch. Birch	R = Red Pine	X = Non Stocked
F = Spruce Fir	MC = Mixed Conifer	S = Black Spruce	Z = Water
C = Cress	MD = Mixed Deciduous	T = Tamarack	

**Density**

0 = Non Stocked	5 = Pole Timber Medium
1 = Seedling Sapling Poor	6 = Pole Timber Well
2 = Seedling Sapling Medium	7 = Saw Timber Poor
3 = Seedling Sapling Well	8 = Saw Timber Medium
4 = Pole Timber Poor	9 = Saw Timber Well

PU	Acres	PU	Acres	PU	Acres
1	8.5	4	12.5	7	21.9
2	13.8	5	51.2		
3	29.7	6	6.9		

**Carrol Creek Select**

Compartment 112

144.6 Acres

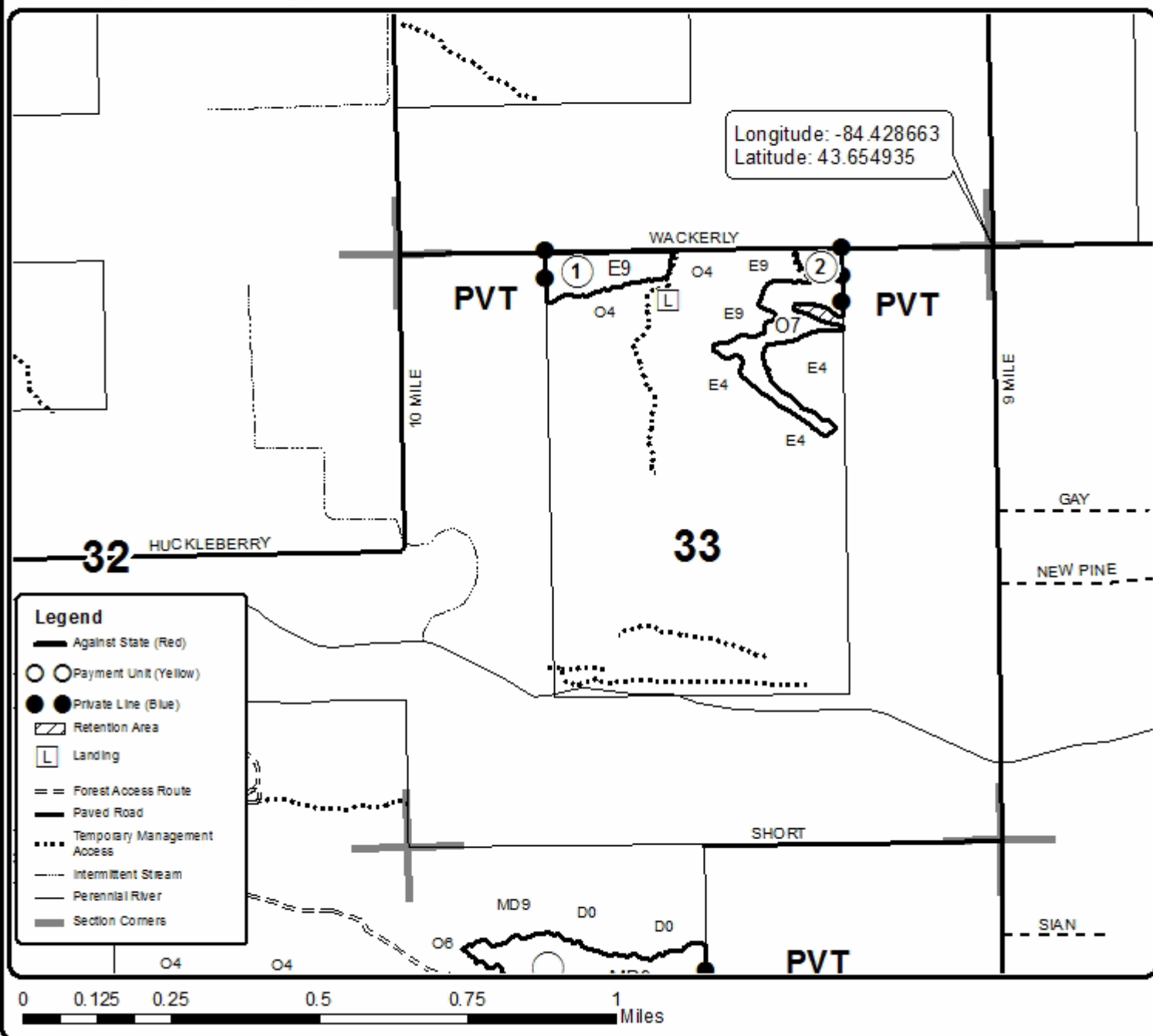
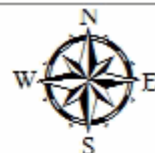



## TIMBER SALE MAP

This information provided by authority of Part 525, 1994 PA 451, as amended.

Sale Number	Year
73 - 009	21

Forest Management Unit Gladwin	County Midland	Mapped By Scott Shooltz	Date 09/30/2021	Page 2	of 3
Township 15N, 14N	Range 01W	Section(s) and Subdivision(s) 33, 04, 05, 08	Scale 1:15,840		

Cover Type				Density	
A = Aspen	H = Hemlock	N = Marsh	L = Upland Brush	0 = Non Stocked	5 = Pole Timber Medium
E = Paper Birch	J = Jack Pine	O = Oak	LM = Upland Mixed	1 = Seedling Sapling Poor	6 = Pole Timber Well
C = Cedar	L = Lowland Brush	P = Lowland Poplar	V = Bog or Marsh	2 = Seedling Sapling Medium	7 = Saw Timber Poor
D = Treed Bog	LM = Lowland Mixed	Q = Mixed Swamp Conifer	W = White Pine	3 = Seedling Sapling Well	8 = Saw Timber Medium
G = Swamp Hardwoods	M = Mpl. Bch. Birch	R = Red Pine	X = Non Stocked	4 = Pole Timber Poor	9 = Saw Timber Well
F = Spruce Fir	MC = Mixed Conifer	S = Black Spruce	Z = Water		
C = Cress	MD = Mixed Deciduous	T = Tamarack			

PU	Acres	PU	Acres	PU	Acres
1	8.5	4	12.5	7	21.9
2	13.8	5	51.2		
3	29.7	6	6.9		

## Carrol Creek Select

Compartment 112

144.6 Acres

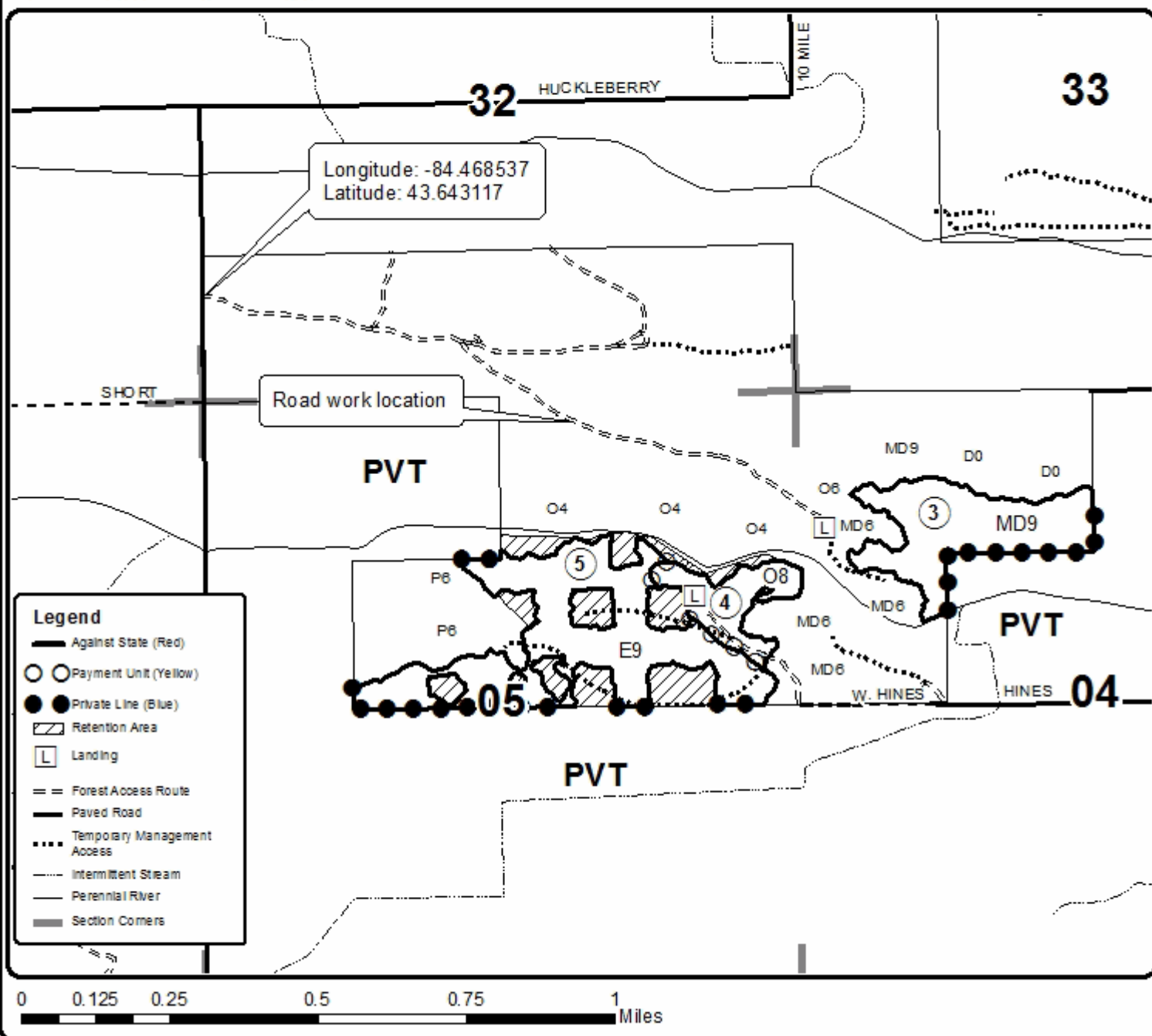
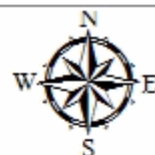

**TIMBER SALE MAP**

This information provided by authority of Part 525, 1994 PA 451, as amended.

Sale Number	Year
73 - 009	21

Forest Management Unit Gladwin	County Midland	Mapped By Scott Shooltz	Date 09/30/2021	Page 3	of 3
Township 15N, 14N	Range 01W	Section(s) and Subdivision(s) 33, 04, 05, 08	Cruised By Shooltz, Nyhoff	Scale 1:15,840	

**Cover Type**

A = Aspen	H = Hemlock	N = Marsh	U = Upland Brush
E = Paper Birch	J = Jack Pine	O = Oak	LM = Upland Mixed
C = Cedar	L = Lowland Brush	P = Lowland Poplar	V = Bog or Marsh
D = Treed Bog	LM = Lowland Mixed	Q = Mixed Swamp Conifer	W = White Pine
G = Swamp Hardwoods	M = Mpl. Bch. Birch	R = Red Pine	X = Non Stocked
F = Spruce Fir	MC = Mixed Conifer	S = Black Spruce	Z = Water
C = Cress	MD = Mixed Deciduous	T = Tamarack	

**Density**

0 = Non Stocked	5 = Pole Timber Medium
1 = Seedling Sapling Poor	6 = Pole Timber Well
2 = Seedling Sapling Medium	7 = Saw Timber Poor
3 = Seedling Sapling Well	8 = Saw Timber Medium
4 = Pole Timber Poor	9 = Saw Timber Well

PU	Acres	PU	Acres	PU	Acres
1	8.5	4	12.5	7	21.9
2	13.8	5	51.2		
3	29.7	6	6.9		

**Carrol Creek Select**

Compartment 112

144.6 Acres

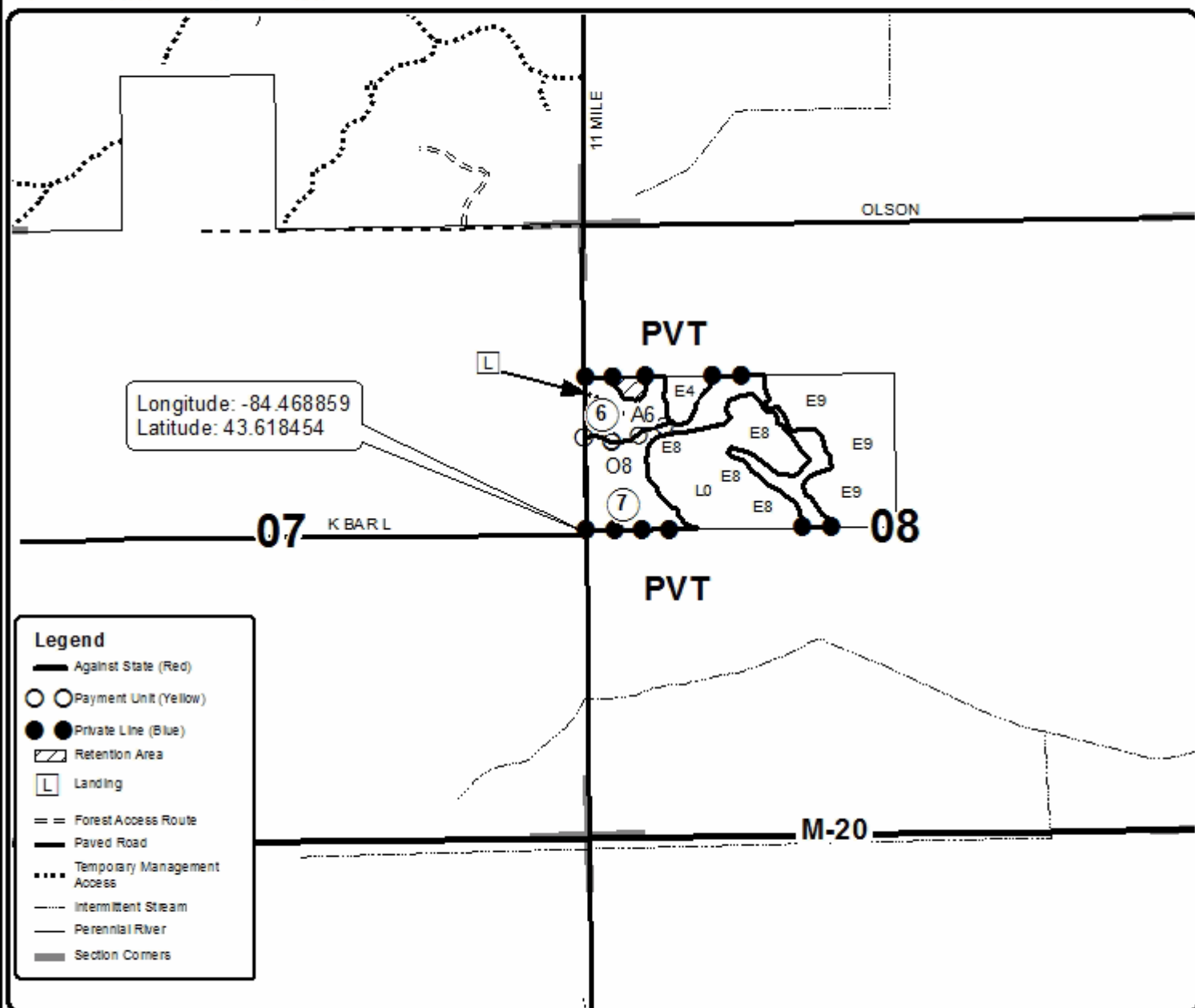

0 0.125 0.25 0.5 0.75 1 Miles