



**DEPARTMENT OF NATURAL RESOURCES  
STATE OF MICHIGAN**

**TIMBER SALE PROSPECTUS #7240**

**REVISION NOTICE #1 - August 14, 2023**

SCHEDULED SALE DATE AND TIME: **10:00 a.m. (local time) on Thursday, August 24, 2023**

LOCATION: **GLADWIN MGMT UNIT, 801 NORTH SILVERLEAF, GLADWIN, MI 48624**

This prospectus has been modified with the following changes. Leota Fuelbreak RP 73-998-23 has been removed from this prospectus. The sale has a volume calculation error. The sale will be readvertised once corrected.

Leota Fuelbreak RP (73-998-23) has been withdrawn from this prospectus.

We apologize for any inconvenience this may have caused. If you need assistance, please contact Blair Tweedale at 989-426-9205 ext. 7640.



**DEPARTMENT OF NATURAL RESOURCES  
STATE OF MICHIGAN  
TIMBER SALE PROSPECTUS #7240**

**SCHEDULED SALE DATE AND TIME: 10:00 a.m. (local time) on August 24, 2023.**

**LOCATION: GLADWIN MGMT UNIT, 801 NORTH SILVERLEAF, GLADWIN, MI 48624.**

**CONTACT NAME: Blair Tweedale**

**PHONE NUMBER: (989) 426-9205**

**PROSPECTUS NOTE:** The bidder is advised to inspect the sale area and review the location, estimated volumes, operating costs and contract terms of proposed sales. Please be aware that some landowners may request 60 days or more notice for access across their land.

Notice is hereby given that bids will be received by the Unit Manager, GLADWIN MANAGEMENT UNIT, for certain timber on the following described lands:

Loopy Grim Aspen (73-007-22) / T18N, R02E, SEC. 19, NESW, S1/2SW, SE.

T18N, R02E, SEC. 29, N1/2NW, SWNW, W1/2NE.

T18N, R02E, SEC. 30, W1/2NW, NE.

Gladwin County, Advertised Price \$101,985.40, 146.5 Acres, Aspen, Hardwood.

SALE NOTE: The sale area of Loopy Grim Aspen can be found off of Grim and Fournier road.

Culvert(s) may need to be installed along Grim and Fournier road to access payment units. Most of the sale contains low, wet ground and operating caution specs have been added.

A recreation site such as a trail, pathway, or campground is within the sale area or the vicinity.

Certain restrictions/specifications may be applicable including time restrictions.

## TIMBER SALE INFORMATION

### Loopy Grim Aspen (73-007-22)

T18N, R02E, SEC. 19; T18N, R02E, SEC. 29; T18N, R02E, SEC. 30.

Gladwin County (Advertised Price \$101,985.40)

**SALE NOTE:** The sale area of Loopy Grim Aspen can be found off of Grim and Fournier road. Culvert(s) may need to be installed along Grim and Fournier road to access payment units. Most of the sale contains low, wet ground and operating caution specs have been added.

A recreation site such as a trail, pathway, or campground is within the sale area or the vicinity. Certain restrictions/specifications may be applicable including time restrictions.

A timber sale contract for this lump sum, sealed bid timber sale will be awarded to the responsible bidder offering the highest sealed bid price. All units of volume listed below were estimated using the Inventory Manager computer program and the new Michigan taper model. Bids must be at or above the following advertised price for each product and species:

<u>PRODUCTS &amp; SPECIES</u>	<u>ESTIMATED UNITS*</u>		<u>ADVERTISED PRICE</u>
Sawtimber			
B. T. Aspen	85.5	MBF	\$ 76.00 / MBF
Northern Pin Oak	85.6	MBF	\$ 112.00 / MBF
Quaking Aspen	74.3	MBF	\$ 76.00 / MBF
Red Maple	91.0	MBF	\$ 72.00 / MBF
Red Pine	25.6	MBF	\$ 121.00 / MBF
Pulpwood			
B. T. Aspen	449	Cords	\$ 31.45 / Cord
Black Cherry	65	Cords	\$ 20.60 / Cord
Mixed Oak	280	Cords	\$ 16.90 / Cord
Paper Birch	90	Cords	\$ 21.45 / Cord
Quaking Aspen	1,107	Cords	\$ 31.45 / Cord
Red Maple	599	Cords	\$ 20.60 / Cord
Red Pine	5	Cords	\$ 52.50 / Cord
White Pine	34	Cords	\$ 31.30 / Cord

\* The total volume is statistically estimated within plus (+) or minus (-) 10.38 percent. There are an estimated 3,427 cords on this timber sale, plus or minus 356 cords at the 95% confidence level. The estimated units are final and not subject to adjustment. Prospective bidders are urged to examine this timber and to make their own estimates of quantity and quality.

### **BOND AND PAYMENT SCHEDULE:**

1. A bond in the amount of \$5,099.27 to insure faithful performance of the conditions of the contract will be deposited by the successful bidder within 21 days of the sale award.
2. Cutting in any sale or unit without the required advance payment would be considered a trespass.
3. Total payment must be paid in advance or according to the following schedule :
  - (a) Ten percent (10%) of the sale value must be paid within 21 days of the sale award.
  - (b) The 10% down payment will be credited towards the first unit cut.
  - (c) Payment for each of the following units must be made before cutting begins in that unit:

<u>PAYMENT UNIT NUMBER</u>	<u>PERCENT OF TOTAL SALE VALUE</u>
01	8.3%
02	12.2%
03	8.2%
04	6.1%
05	24.2%
06	3.7%
07	10.3%
08	5.0%
09	4.6%
10	17.4%

4. If no cutting takes place, the 10% down payment will not be refunded.
5. Operations on the contract issued will terminate on 09/30/2025.

### **SALE STATISTICS**

Volumes were calculated in cubic feet using the Michigan taper model. Cubic foot volume includes all wood inside bark for the product indicated. For display purposes, cubic feet were converted to cords and MBF using a simple conversion factor, e.g. 79 cubic feet per cord and 185 cubic feet per MBF. The cubic foot volumes are precise; the cords and MBF volumes are not. Cubic foot volume cannot be directly converted to cords or boards with precision.

## SALE VOLUMES

The total estimated sale volume may not equal the sum of the species/products due to the nature of statistical calculations associated with double sampling methodology.

VOLUME			STATISTICAL RANGE IN CORDS	
TOTAL CUBIC FEET	TOTAL CORDS	PERCENT ERROR	MINIMUM	MAXIMUM
270,706	3,427	10.38%	3,071	3,782

## VDU VOLUMES

A VDU is a Volume Determination Unit. Volumes and their associated statistics are calculated at the VDU level and summarized to the sale level. There is often a one to one relationship between a VDU and a Payment Unit, but not always, depending on the cruise design. Refer to the VDU TO PAYMENT UNIT table.

	VOLUME			RANGE IN CORDS	
VDU	TOTAL CUBIC FEET	TOTAL CORDS	PERCENT ERROR	MINIMUM	MAXIMUM
105	12,552	159	46.34%	85	233
164	20,158	255	26.82%	187	324
188	62,528	791	14.82%	674	909
189	26,507	336	22.67%	259	412
192	15,820	200	44.59%	111	290
196	51,516	652	24.43%	493	811
210	10,703	135	30.92%	94	177
244	30,633	388	40.39%	231	544
247	17,004	215	28.96%	153	278
248	23,286	295	46.22%	159	431
<b>TOTAL:</b>	<b>270,706</b>	<b>3,427</b>		<b>2,446</b>	<b>4,408</b>

## VDU TO PAYMENT UNIT

When a VDU is associated with more than one Payment Unit (PU), the VDU volumes are assigned to the PU based on acres of the VDU within the PU.

VDU	VDU ACRES	PU	PU ACRES
105	5.7	9	5.7
164	11.5	3	11.5
188	24.0	5	24.0
189	18.9	7	18.9
192	17.4	8	17.4
196	22.6	10	22.6
210	8.3	6	8.3
244	12.1	2	12.1
247	14.7	4	14.7
248	11.3	1	11.3
<b>TOTAL:</b>	<b>146.5</b>		<b>146.5</b>

**DESCRIPTION OF TIMBER BY PU (PU)**

PU	MARKET GROUP	PRODUCT	QUANTITY	UNIT	ACRES	ADVERTISE PRICE
1	B. T. Aspen	Sawtimber	16.0	MBF	11.3	\$8,495.55
	Northern Pin Oak		3.1	MBF		
	Red Maple		22.6	MBF		
	B. T. Aspen	Pulpwood	39	Cords		
	Black Cherry		2	Cords		
	<i>Black Cherry</i>		2	<i>Cords</i>		
	Mixed Oak		2	Cords		
	<i>Northern Pin Oak</i>		2	<i>Cords</i>		
	Paper Birch		3	Cords		
	<i>Paper Birch</i>		3	<i>Cords</i>		
	Quaking Aspen		53	Cords		
	Red Maple		86	Cords		
	White Pine		16	Cords		
	<i>White Pine</i>	<i>Sawtimber</i>	7.6	<i>MBF</i>		
	<i>White Pine</i>	<i>Pulpwood</i>	1	<i>Cords</i>		
2	B. T. Aspen	Sawtimber	13.0	MBF	12.1	\$12,457.70
	Northern Pin Oak		0.9	MBF		
	Quaking Aspen		9.5	MBF		
	Red Pine		21.5	MBF		
	B. T. Aspen	Pulpwood	51	Cords		
	Black Cherry		3	Cords		
	<i>Black Cherry</i>		3	<i>Cords</i>		
	Mixed Oak		1	Cords		
	<i>Northern Pin Oak</i>		1	<i>Cords</i>		
	Paper Birch		5	Cords		
	<i>Paper Birch</i>		5	<i>Cords</i>		
	Quaking Aspen		130	Cords		
	Red Maple		95	Cords		
	Red Pine		4	Cords		
3	B. T. Aspen	Sawtimber	5.6	MBF	11.5	\$8,385.65
	Northern Pin Oak		7.7	MBF		
	Quaking Aspen		2.7	MBF		
	Red Maple		1.8	MBF		
	B. T. Aspen	Pulpwood	11	Cords		
	Black Cherry		3	Cords		
	<i>Black Cherry</i>		3	<i>Cords</i>		
	Mixed Oak		10	Cords		
	<i>Northern Pin Oak</i>		10	<i>Cords</i>		
	Paper Birch		3	Cords		
	<i>Paper Birch</i>		3	<i>Cords</i>		
	Quaking Aspen		175	Cords		
	Red Maple		30	Cords		
4	Quaking Aspen	Sawtimber	23.0	MBF	14.7	\$6,205.65
	Black Cherry	Pulpwood	16	Cords		
	<i>Black Cherry</i>		16	<i>Cords</i>		
	Mixed Oak		15	Cords		
	<i>Northern Pin Oak</i>		13	<i>Cords</i>		
	<i>White Oak</i>		2	<i>Cords</i>		
	Paper Birch		13	Cords		
	<i>Paper Birch</i>		13	<i>Cords</i>		
	Quaking Aspen		94	Cords		
	Red Maple		28	Cords		
	White Pine		2	Cords		
	<i>White Pine</i>		2	<i>Cords</i>		
5	Northern Pin Oak	Sawtimber	17.3	MBF	24.0	\$24,618.20

**DESCRIPTION OF TIMBER BY PU (PU), CON'T**

PU	MARKET GROUP	PRODUCT	QUANTITY	UNIT	ACRES	ADVERTISE PRICE
5 con't	Quaking Aspen	Sawtimber	33.4	MBF		
	Red Maple		15.6	MBF		
	Black Cherry	Pulpwood	5	Cords		
	<i>Black Cherry</i>		5	<i>Cords</i>		
	Mixed Oak		26	Cords		
	<i>Northern Pin Oak</i>		26	<i>Cords</i>		
	Paper Birch		10	Cords		
	<i>Paper Birch</i>		10	<i>Cords</i>		
	Quaking Aspen		506	Cords		
	Red Maple		114	Cords		
6	Northern Pin Oak	Sawtimber	9.9	MBF	8.3	\$3,815.60
	Quaking Aspen		5.7	MBF		
	Red Maple		4.6	MBF		
	Mixed Oak	Pulpwood	22	Cords		
	<i>Northern Pin Oak</i>		20	<i>Cords</i>		
	<i>White Oak</i>		2	<i>Cords</i>		
	Paper Birch		7	Cords		
	<i>Paper Birch</i>		7	<i>Cords</i>		
	Quaking Aspen		17	Cords		
	Red Maple		43	Cords		
7	B. T. Aspen	Sawtimber	20.0	MBF	18.9	\$10,486.80
	Northern Pin Oak		14.2	MBF		
	Red Maple		2.1	MBF		
	B. T. Aspen	Pulpwood	129	Cords		
	Black Cherry		7	Cords		
	<i>Black Cherry</i>		7	<i>Cords</i>		
	Mixed Oak		38	Cords		
	<i>Northern Pin Oak</i>		38	<i>Cords</i>		
	Paper Birch		3	Cords		
	<i>Paper Birch</i>		3	<i>Cords</i>		
	Quaking Aspen		56	Cords		
	Red Maple		27	Cords		
8	B. T. Aspen	Sawtimber	11.1	MBF	17.4	\$5,119.65
	Red Maple		5.2	MBF		
	B. T. Aspen	Pulpwood	60	Cords		
	Black Cherry		5	Cords		
	<i>Black Cherry</i>	<i>Sawtimber</i>	0.7	<i>MBF</i>		
	<i>Black Cherry</i>	<i>Pulpwood</i>	4	<i>Cords</i>		
	Paper Birch		9	Cords		
	<i>Paper Birch</i>		9	<i>Cords</i>		
	Quaking Aspen		16	Cords		
	Red Maple		59	Cords		
9	Northern Pin Oak	Sawtimber	12.6	MBF	5.7	\$4,690.15
	Red Maple		24.1	MBF		
	Black Cherry	Pulpwood	9	Cords		
	<i>Black Cherry</i>		9	<i>Cords</i>		
	Mixed Oak		32	Cords		
	<i>Northern Pin Oak</i>		32	<i>Cords</i>		
	Quaking Aspen		7	Cords		
	Red Maple		29	Cords		
10	B. T. Aspen	Sawtimber	19.8	MBF	22.6	\$17,710.45
	Northern Pin Oak		19.9	MBF		
	Red Maple		15.0	MBF		
	Red Pine		4.1	MBF		
	B. T. Aspen	Pulpwood	159	Cords		

DESCRIPTION OF TIMBER BY PU (PU), CON'T

PU	MARKET GROUP	PRODUCT	QUANTITY	UNIT	ACRES	ADVERTISE PRICE
10 con't	Black Cherry	Pulpwood	15	Cords		
	Black Cherry		15	Cords		
	Mixed Oak		134	Cords		
	Northern Pin Oak		134	Cords		
	Paper Birch	Sawtimber	37	Cords		
	Paper Birch		4.9	MBF		
	Paper Birch		27	Cords		
	Quaking Aspen		53	Cords		
	Red Maple		88	Cords		
	Red Pine		1	Cords		
	White Pine		16	Cords		
	White Pine	Pulpwood	16	Cords		
TOTAL:			362.0	MBF		
TOTAL:			2,629	Cords		

## **Sale Specific Conditions & Requirements**

**Sale Name: Loopy Grim Aspen**

**Sale Number: 73-007-22 Seq#: 1**

### **1 - Sale Area**

#### **1.2 - Boundaries**

##### **1.2.1 - Painted boundaries (9/19)**

The sale boundary and Payment Unit boundaries are marked and identified by blue, red and yellow paint. Exterior sale boundary lines against private property are marked with blue paint. Exterior sale boundary lines against state are marked with red paint. There are designated unmarked private and state sale boundaries along Eastman and Fournier road. See timber sale map for more details. Interior Payment Unit boundaries are marked with yellow paint. Retention patches are marked with red paint; no harvesting activities may occur within these areas. The painted boundary line trees are not Included Timber and are to be protected unless marked with orange paint. Yellow painted trees designating an interior Payment Unit boundary are only to be cut when all surrounding Payment Units have been paid.

### **2 - Timber Specifications**

#### **2.1 - Included Timber**

##### **2.1.1 - Clearcut unit(s) with unmerchantable trees (6/14)**

Within Payment Unit(s) 1-10 (ALL UNITS), cut all trees that are two (2) inches or more at DBH except for oak marked with green paint above and below stump height in payment units 1,2,3,4,5,6, 7, 9 & 10. In addition, retain all oak within payment unit 8.

##### **2.1.15 - Hazard trees near roads (11/20)**

Cut and remove all standing dead trees within 100 feet of the cleared portion of designated county roads. These trees may be utilized or must be scattered back into the sale area.

### **3 - Payments**

#### **3.3 - Pre-measured Sales**

##### **3.3.4 - Dividing payment units (7/14)**

Payment Unit(s) may be divided at the request of the Purchaser and upon approval of the Unit Manager. Dividing Payment Units is a contract modification which requires a Timber Sale Contract Amendment. There will be only one division per Payment Unit.

### **4 - Transportation**

#### **4.1 - Construction**

##### **4.1.2 - Stream crossings, specific (3/11)**

Any creek/river crossing will require the installation of a culvert which may be borrowed from the DNR. This installation will be performed in accordance with the specifications on the appropriate permits which shall be provided by the DNR.

##### **4.1.5 - Culverts (5/14)**

Roads may require the installation of culverts for cross drainage or at natural drainage-ways. If culverts are needed in these locations, their placement will be specified by the sale administrator and they shall be installed prior to hauling. The culverts shall be new, corrugated metal or plastic gauge. If culverts are removed, fill shall be removed from wetland soils as specified. Soils shall be maintained and left in a non-erodible condition, with water bars, seed, fertilizer, mulch, and slash installed as directed by the sale administrator and as specified in the BMP manual. Stream crossing permits, if needed, will be obtained by the DNR.

##### **4.1.6 - Road construction (1/09)**

Construction of new roads or improvements of existing roads shall be done in such a way as to minimize the environmental and visual impacts. Merchantable trees shall be cut and utilized unless otherwise directed. Non-merchantable trees shall be severed and laid flat on the ground. Slash shall be scattered, and not left in windrows and kept a minimum of 10 feet back



from the road edge. Stumps shall be set upright, not left on edge, and be moved at least 10 feet away from the road edge. Disturbed soil shall be feathered into the woods and not left in berms or windrows.

#### 4.1.7 - Road closure (10/11)

All new roads built into the sale must be blocked to vehicle traffic upon completion of the sale. Overgrown roads that are reopened shall be considered new roads. In general, this will require constructing a four (4') foot high berm of stumps and logs covered with earth. Stumps and brush must be placed along the remainder of the trail. These roads must be rendered impassable to cars and trucks. Contact the sale administrator for specific details of design and placement.

## 5 - Operations

### 5.1 - Notification

#### 5.1.1 - Pre-sale conference (10/16)

A pre-sale conference on site between the Purchaser and sale administrator is required prior to beginning any operations to determine landing and road locations. The Unit Manager or his/her representative must be contacted at least 2 business days in advance to schedule the conference.

### 5.2 - Conduct of Operations

#### 5.2.2 - Hazard Trees/Snags

##### 5.2.2.1 - Den trees (10/16)

Obvious hollow and/or den trees shall be protected and left standing unless they are a safety hazard.

#### 5.2.3 - Operating Restrictions

##### 5.2.3.4 - Oak wilt restriction, no exceptions (1/18)

Within Payment Unit(s) 7, 8 & 10 cutting, skidding and hauling within the sale and brushing of access roads to the sale are not permitted during the period of April 15 to July 15. No exceptions will be granted. This is necessary to reduce the spread of oak wilt.

##### 5.2.3.5 - Oak wilt restriction (1/18)

Within Payment Unit(s) 6, unless changed by written agreement, cutting, skidding, hauling within the sale and brushing of access roads to the sale are not permitted during the period of April 15 to July 15. Operations may be allowed if specific steps are taken to prevent damaging uncut oak during the high risk period. Those steps may include completing all road brushing before April 15th and clearing a tree-length buffer along uncut oak cover before April 15th. This is necessary to reduce the spread of oak wilt. For more information, contact the Unit Manager or his/her representative.

#### 5.2.4 - Dead and Down Creation

##### 5.2.4.4 - Dead and down creation, grouse (6/18)

To encourage grouse and other wildlife, in Payment Unit(s) 1, 2, 4, 5, 6, 8 & 10 leave one 12" or larger diameter whole tree on the ground for every 3 acres. Trees should be scattered throughout the sale and at least two chains from any roads, two-tracks, or trails open to vehicles, or positioned per the sale administrators instructions. Stumps must be at least 3 feet tall.

#### 5.2.17 - Timber Mats and Interlocking Composite Mats (10/20)

Some roads or skid trails may require extra protection such as that afforded by timber mats, interlocking composite mats, or another approved system. If available, mats may be borrowed from the DNR. A Timber Sale Contract Supplement will be used to document the Purchaser's use of the DNR's mats. Contact the sale administrator regarding availability and pick-up. Timber mats are available from various field offices. Composite mats are only available from the Grayling field office and the Marquette ICC. The Purchaser is responsible for picking up and hauling the mats to and from the site. The composite mats will require DNR staff onsite for installation and removal. Contact the sale administrator to schedule at least 30 days before desired install/removal date. All mats must be cleaned prior to drop off. This may include, but is not limited to, power washing and brushing to remove mud and debris. A charge of \$700.00 per timber mat and \$2,000.00 per composite mat will be assessed for all damaged or non-returned mats. Damage for the crane/timber mats is defined as three or more broken cants. Damage for the composite mats is defined as cracked or broken mats.

#### 5.2.22 - Operating Caution

#### 5.2.22.1 - Operating caution (6/11)

It is recommended, but not required, that within Payment Unit(s) 1, 2, 3, 4, 5, 6 & 9, cutting, skidding, and hauling occur during dry summer or frozen winter conditions. The reason for the recommendation is because of saturated soils.

#### 5.2.32 - Decking/landing restoration (9/13)

All decking and landing areas must have the surface area restored to a condition equal to or better than before. This is to ensure the proper regeneration of the stand. Wood debris, chips and "cookies" from trimmings must be removed or scattered away from landing and loading areas and may not be windrowed on the edge.

## 6 - Safety and Fire Prevention

### 6.2 - Signing

#### 6.2.1 - Road posting (10/20)

The Purchaser is responsible for posting and maintaining caution signs on Grim road prior to beginning operations. The road must be posted at appropriate distances from the sale area to warn of logging activity and truck traffic. Signs must be removed when harvest operations are suspended or completed. The Purchaser will provide these signs.

#### 6.2.3 - Recreational trail posting (10/20)

The Purchaser is responsible for posting and maintaining caution signs on the Midland to Mackinac boy scout trail prior to beginning operations. The trail must be posted at appropriate distances from the sale area to warn of logging activity and truck traffic at both ends of the trail. Signs must be removed when harvest operations are suspended or completed. The Purchaser will provide these signs.



## TIMBER SALE MAP

This information provided by authority of Part 525, 1994 PA 451, as amended.

Sale Number	Year
73 - 007	22

Forest Management Unit	County	Mapped By	Date	Page	of
Gladwin	Gladwin	Behrmann	09/12/2022	1	1
Cruised By	Behrmann				

Township	Range	Section(s) and Subdivision(s)	Scale
18N	02E	Sec 19 S1/2, Sec 30 W1/2NE, NE, Sec 29 N1/2NW, SWNW, W1/2NE	1:15,840

## Cover Type

A = Aspen	H = Hemlock	N = Marsh	U = Upland Brush
B = Paper Birch	J = Jack Pine	O = Oak	UM = Upland Mixed
C = Cedar	L = Lowland Brush	P = Lowland Poplar	V = Bog or Marsh
D = Tired Bog	LM = Lowland Mixed	Q = Mixed Swamp Conifer	W = White Pine
E = Swamp Hardwoods	M = Mpl, Boh, Brch	R = Red Pine	X = Non Stocked
F = Spruce Fir	MC = Mixed Conifer	S = Black Spruce	Z = Water
G = Grass	MD = Mixed Deciduous	T = Tamarack	

## Density

0 = Non Stocked	5 = Pole Timber Medium
1 = Seedling Sapling Poor	6 = Pole Timber Well
2 = Seedling Sapling Medium	7 = Saw Timber Poor
3 = Seedling Sapling Well	8 = Saw Timber Medium
4 = Pole Timber Poor	9 = Saw Timber Well

PU	Acres	PU	Acres
1	11.3	6	8.3
2	12.1	7	18.9
3	11.5	8	17.4
4	14.7	9	5.7
5	24.0	10	22.6

## Loopy Grim Aspen

Compartment 79

146.5 Acres

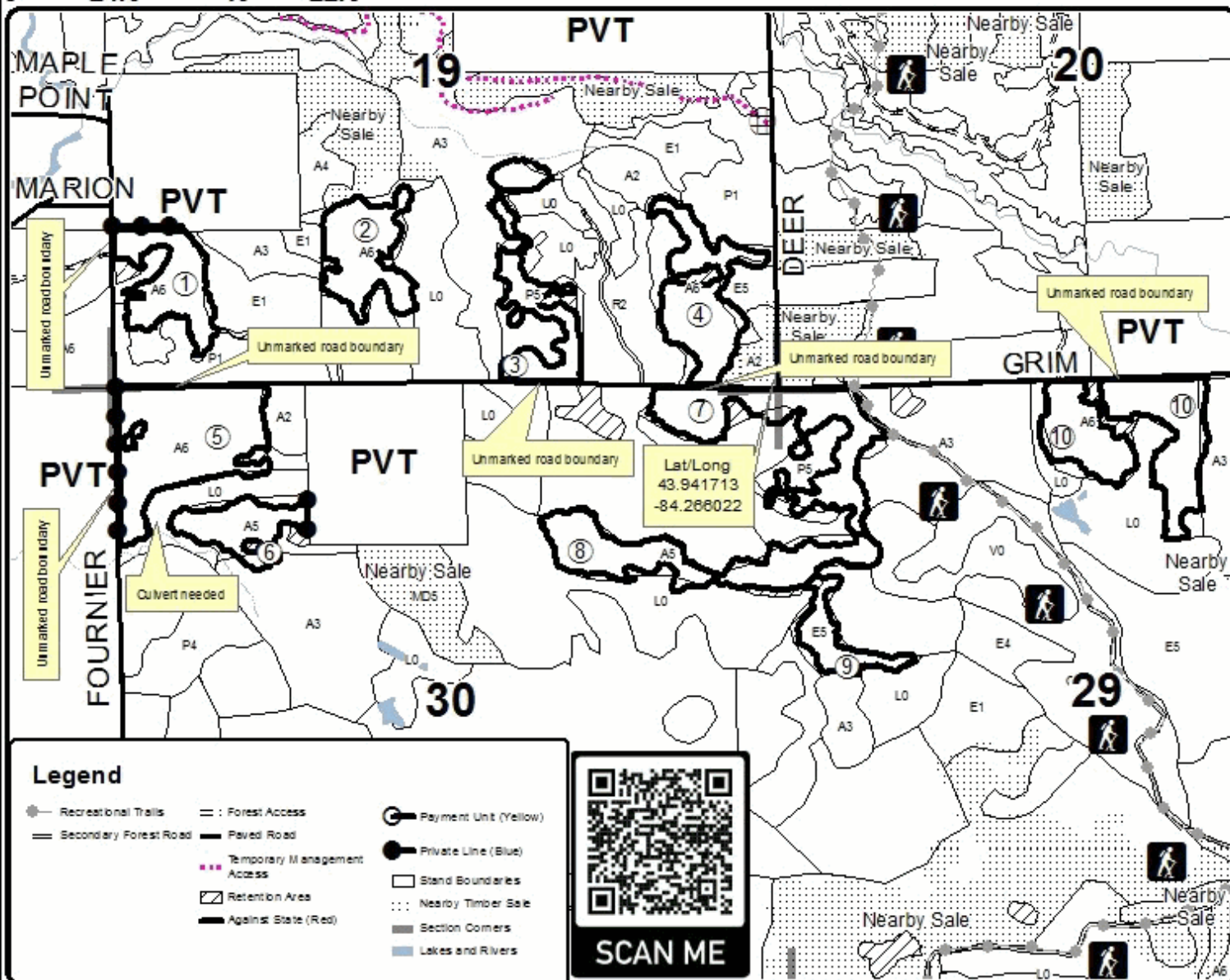

0 0.125 0.25 0.5 0.75 1 Miles