



**DEPARTMENT OF NATURAL RESOURCES
STATE OF MICHIGAN
TIMBER SALE PROSPECTUS #7238**

SCHEDULED SALE DATE AND TIME: 10:00 a.m. (local time) on June 22, 2023.

LOCATION: GLADWIN MGMT UNIT, 801 NORTH SILVERLEAF, GLADWIN, MI 48624.

CONTACT NAME: Blair Tweedale

PHONE NUMBER: (989) 426-9205

PROSPECTUS NOTE: The bidder is advised to inspect the sale area and review the location, estimated volumes, operating costs and contract terms of proposed sales. Please be aware that some landowners may request 60 days or more notice for access across their land.

Notice is hereby given that bids will be received by the Unit Manager, GLADWIN MANAGEMENT UNIT, for certain timber on the following described lands:

Middle C36 (73-010-22) / T19N, R01E, SEC. 10, NESE.

T19N, R01E, SEC. 11, W1/2NW,NWSW.

T19N, R01E, SEC. 22, N1/2NE,SESW.

T19N, R01E, SEC. 26, NESW.

T19N, R01E, SEC. 27, E1/2NW.

Gladwin County, Advertised Price \$128,936.25, 118.3 Acres, Aspen, Hardwood.

SALE NOTE: Portions of this sale are wet and are restricted to dry/frozen conditions. There are also units that are restricted to the dormancy period because of age of the trees and concerns about regeneration. The access to units 7, 8, and 9 across private land is possible. The current land owner indicates they are willing to let a logger cross using their easement.

A recreation site such as a trail, pathway, or campground is within the sale area or the vicinity. Certain restrictions/specifications may be applicable including time restrictions. Access may be through private or other public land.

TIMBER SALE INFORMATION

Middle C36 (73-010-22)

T19N, R01E, SEC. 10; T19N, R01E, SEC. 11; T19N, R01E, SEC. 22; T19N, R01E, SEC. 26; T19N, R01E, SEC. 27.

Gladwin County (Advertised Price \$128,936.25)

SALE NOTE: Portions of this sale are wet and are restricted to dry/frozen conditions. There are also unit that are restricted to the dormancy period because of age of the trees and concerns about regeneration. The access to units 7, 8, and 9 across private land is possible. The current land owner indicates they are willing to let a logger cross using their easement.

A recreation site such as a trail, pathway, or campground is within the sale area or the vicinity. Certain restrictions/specifications may be applicable including time restrictions. Access may be through private or other public land.

A timber sale contract for this lump sum, sealed bid timber sale will be awarded to the responsible bidder offering the highest sealed bid price. All units of volume listed below were estimated using the Inventory Manager computer program and the new Michigan taper model. Bids must be at or above the following advertised price for each product and species:

<u>PRODUCTS & SPECIES</u>	<u>ESTIMATED UNITS*</u>	<u>ADVERTISED PRICE</u>
Sawtimber		
Black/Red (Hybrid) Oak	298.1 MBF	\$ 79.00 / MBF
Mixed Aspen	203.3 MBF	\$ 78.00 / MBF
Red Maple	61.9 MBF	\$ 60.00 / MBF
Red Pine	12.5 MBF	\$ 113.00 / MBF
White Pine	198.2 MBF	\$ 68.00 / MBF
Pulpwood		
Balsam Fir	5 Cords	\$ 35.05 / Cord
Black/Red (Hybrid) Oak	633 Cords	\$ 16.45 / Cord
Mixed Aspen	1,095 Cords	\$ 32.95 / Cord
Mixed Hardwood	137 Cords	\$ 19.80 / Cord
Red Maple	655 Cords	\$ 19.80 / Cord
Red Pine	63 Cords	\$ 50.70 / Cord
White Pine	177 Cords	\$ 30.40 / Cord

* The total volume is statistically estimated within plus (+) or minus (-) 11.79 percent. There are an estimated 4,471 cords on this timber sale, plus or minus 528 cords at the 95% confidence level. The estimated units are final and not subject to adjustment. Prospective bidders are urged to examine this timber and to make their own estimates of quantity and quality.

BOND AND PAYMENT SCHEDULE:

1. A bond in the amount of \$6,446.81 to insure faithful performance of the conditions of the contract will be deposited by the successful bidder within 21 days of the sale award.
2. Cutting in any sale or unit without the required advance payment would be considered a trespass.
3. Total payment must be paid in advance or according to the following schedule :
 - (a) Ten percent (10%) of the sale value must be paid within 21 days of the sale award.
 - (b) The 10% down payment will be credited towards the first unit cut.
 - (c) Payment for each of the following units must be made before cutting begins in that unit:

<u>PAYMENT UNIT NUMBER</u>	<u>PERCENT OF TOTAL SALE VALUE</u>
01	12.8%
02	14.5%
03	9.1%
04	2.5%
05	9.2%
06	6.5%
07	5.0%
08	16.1%
09	19.9%
10	4.4%

4. If no cutting takes place, the 10% down payment will not be refunded.
5. Operations on the contract issued will terminate on 06/30/2025.

SALE STATISTICS

Volumes were calculated in cubic feet using the Michigan taper model. Cubic foot volume includes all wood inside bark for the product indicated. For display purposes, cubic feet were converted to cords and MBF using a simple conversion factor, e.g. 79 cubic feet per cord and 185 cubic feet per MBF. The cubic foot volumes are precise; the cords and MBF volumes are not. Cubic foot volume cannot be directly converted to cords or boards with precision.

SALE VOLUMES

The total estimated sale volume may not equal the sum of the species/products due to the nature of statistical calculations associated with double sampling methodology.

VOLUME			STATISTICAL RANGE IN CORDS	
TOTAL CUBIC FEET	TOTAL CORDS	PERCENT ERROR	MINIMUM	MAXIMUM
353,248	4,471	11.79%	3,944	4,999

VDU VOLUMES

A VDU is a Volume Determination Unit. Volumes and their associated statistics are calculated at the VDU level and summarized to the sale level. There is often a one to one relationship between a VDU and a Payment Unit, but not always, depending on the cruise design. Refer to the VDU TO PAYMENT UNIT table.

	VOLUME			RANGE IN CORDS	
VDU	TOTAL CUBIC FEET	TOTAL CORDS	PERCENT ERROR	MINIMUM	MAXIMUM
167	87,112	1,103	27.18%	803	1,402
172	26,424	334	32.43%	226	443
177	10,762	136	76.02%	33	240
178	33,023	418	32.46%	282	554
207	16,092	204	35.12%	132	275
209	15,503	196	28.83%	140	253
225	17,455	221	72.90%	60	382
226	133,098	1,685	15.73%	1,420	1,950
244	13,779	174	52.58%	83	266
TOTAL:	353,248	4,471		3,178	5,765

VDU TO PAYMENT UNIT

When a VDU is associated with more than one Payment Unit (PU), the VDU volumes are assigned to the PU based on acres of the VDU within the PU.

VDU	VDU ACRES	PU	PU ACRES
167	22.0	1	10.3
		2	11.7
172	9.3	3	9.3
177	3.0	4	3.0
178	17.7	5	17.7
207	6.5	6	6.5
209	9.9	6	9.9
225	10.1	7	10.1
226	33.1	8	14.8
		9	18.3
244	6.7	10	6.7
TOTAL:	118.3		118.3

DESCRIPTION OF TIMBER BY PU (PU)

PU	MARKET GROUP	PRODUCT	QUANTITY	UNIT	ACRES	ADVERTISE PRICE
1	Black/Red (Hybrid	Sawtimber	7.6	MBF	10.3	\$16,446.05
	Mixed Aspen		49.7	MBF		
	<i>B. T. Aspen</i>		29.2	<i>MBF</i>		
	<i>Quaking Aspen</i>		20.5	<i>MBF</i>		
	Red Maple	Pulpwood	4.3	MBF		
	White Pine		38.4	MBF		
	Balsam Fir		2	Cords		
	Black/Red (Hybrid		18	Cords		
	Mixed Aspen		183	Cords		
	<i>B. T. Aspen</i>		81	<i>Cords</i>		
	<i>Quaking Aspen</i>		102	<i>Cords</i>		
	Mixed Hardwood		3	Cords		
	<i>Black Cherry</i>		3	<i>Cords</i>		
	Red Maple		66	Cords		
	White Pine		44	Cords		
2	Black/Red (Hybrid	Sawtimber	8.6	MBF	11.7	\$18,674.40
	Mixed Aspen		56.5	MBF		
	<i>B. T. Aspen</i>		33.2	<i>MBF</i>		
	<i>Quaking Aspen</i>		23.3	<i>MBF</i>		
	Red Maple	Pulpwood	4.8	MBF		
	White Pine		43.7	MBF		
	Balsam Fir		3	Cords		
	Black/Red (Hybrid		20	Cords		
	Mixed Aspen		207	Cords		
	<i>B. T. Aspen</i>		92	<i>Cords</i>		
	<i>Quaking Aspen</i>		115	<i>Cords</i>		
	Mixed Hardwood		4	Cords		
	<i>Black Cherry</i>		4	<i>Cords</i>		
	Red Maple		76	Cords		
	White Pine		49	Cords		
3	Black/Red (Hybrid	Sawtimber	11.0	MBF	9.3	\$11,683.70
	Mixed Aspen		17.8	MBF		
	<i>B. T. Aspen</i>		14.5	<i>MBF</i>		
	<i>Quaking Aspen</i>		3.3	<i>MBF</i>		
	Red Maple	Pulpwood	10.6	MBF		
	Red Pine		12.5	MBF		
	White Pine		10.7	MBF		
	Black/Red (Hybrid		9	Cords		
	Mixed Aspen		51	Cords		
	<i>B. T. Aspen</i>		49	<i>Cords</i>		
	<i>Quaking Aspen</i>		2	<i>Cords</i>		
	Red Maple		30	Cords		
	Red Pine		63	Cords		
	White Pine		34	Cords		
4	Mixed Aspen	Sawtimber	6.3	MBF	3.0	\$3,284.65
	<i>B. T. Aspen</i>		6.3	<i>MBF</i>		
	Red Maple	Pulpwood	10.0	MBF		
	White Pine		4.9	MBF		
	Black/Red (Hybrid		17	Cords		
	Mixed Aspen		20	Cords		
	<i>B. T. Aspen</i>		20	<i>Cords</i>		
	Red Maple		45	Cords		
5	Black/Red (Hybrid	Sawtimber	26.6	MBF	17.7	\$11,860.05
	Mixed Aspen		15.3	MBF		

DESCRIPTION OF TIMBER BY PU (PU), CON'T

PU	MARKET GROUP	PRODUCT	QUANTITY	UNIT	ACRES	ADVERTISE PRICE
5 con't	<i>B. T. Aspen</i>	<i>Sawtimber</i>	15.3	<i>MBF</i>		
	Red Maple	Pulpwood	5.8	MBF		
	White Pine		47.8	MBF		
	Black/Red (Hybrid		29	Cords		
	Mixed Aspen		56	Cords		
	<i>B. T. Aspen</i>		56	<i>Cords</i>		
	Mixed Hardwood		6	Cords		
	<i>Paper Birch</i>		6	<i>Cords</i>		
	Red Maple		103	Cords		
	White Pine		16	Cords		
6	Black/Red (Hybrid	Sawtimber	22.4	MBF	16.4	\$8,431.75
	Red Maple	Pulpwood	6.4	MBF		
	Black/Red (Hybrid		139	Cords		
	Mixed Aspen		28	Cords		
	<i>Quaking Aspen</i>		28	<i>Cords</i>		
	Mixed Hardwood		66	Cords		
	<i>Black Cherry</i>		19	<i>Cords</i>		
	<i>Paper Birch</i>		47	<i>Cords</i>		
	Red Maple		89	Cords		
7	Black/Red (Hybrid	Sawtimber	28.6	MBF	10.1	\$6,421.75
	Mixed Aspen	Pulpwood	2.7	MBF		
	<i>B. T. Aspen</i>		2.7	<i>MBF</i>		
	Black/Red (Hybrid		54	Cords		
	Mixed Aspen		71	Cords		
	<i>B. T. Aspen</i>		71	<i>Cords</i>		
	Mixed Hardwood		12	Cords		
	<i>Black Cherry</i>		12	<i>Cords</i>		
	White Pine		16	Cords		
8	Black/Red (Hybrid	Sawtimber	86.4	MBF	14.8	\$20,758.35
	Mixed Aspen	Pulpwood	19.5	MBF		
	<i>B. T. Aspen</i>		19.5	<i>MBF</i>		
	Red Maple		8.9	MBF		
	White Pine		23.6	MBF		
	Black/Red (Hybrid		152	Cords		
	Mixed Aspen		157	Cords		
	<i>B. T. Aspen</i>		157	<i>Cords</i>		
	Mixed Hardwood		18	Cords		
	<i>Paper Birch</i>		18	<i>Cords</i>		
	Red Maple		101	Cords		
	White Pine		8	Cords		
9	Black/Red (Hybrid	Sawtimber	106.9	MBF	18.3	\$25,649.95
	Mixed Aspen	Pulpwood	24.2	MBF		
	<i>B. T. Aspen</i>		24.2	<i>MBF</i>		
	Red Maple		11.1	MBF		
	White Pine		29.1	MBF		
	Black/Red (Hybrid		187	Cords		
	Mixed Aspen		194	Cords		
	<i>B. T. Aspen</i>		194	<i>Cords</i>		
	Mixed Hardwood		23	Cords		
	<i>Paper Birch</i>		23	<i>Cords</i>		
	Red Maple		125	Cords		
	White Pine		9	Cords		
10	Mixed Aspen	Sawtimber	11.3	MBF	6.7	\$5,725.60
	<i>B. T. Aspen</i>		7.6	<i>MBF</i>		
	<i>Quaking Aspen</i>		3.7	<i>MBF</i>		

DESCRIPTION OF TIMBER BY PU (PU), CON'T

PU	MARKET GROUP	PRODUCT	QUANTITY	UNIT	ACRES	ADVERTISE PRICE
10 con't	Black/Red (Hybrid	Pulpwood	8	Cords		
	Mixed Aspen		128	Cords		
	<i>B. T. Aspen</i>		125	<i>Cords</i>		
	<i>Quaking Aspen</i>		3	<i>Cords</i>		
	Mixed Hardwood		5	Cords		
	<i>Paper Birch</i>		5	<i>Cords</i>		
	Red Maple		20	Cords		
TOTAL:			774.0	MBF		
TOTAL:			2,765	Cords		

Sale Specific Conditions & Requirements

Sale Name: Middle C36

Sale Number: 73-010-22 Seq#: 1

1 - Sale Area

1.2 - Boundaries

1.2.1 - Painted boundaries (9/19)

The sale boundary and Payment Unit boundaries are marked and identified by blue, red and yellow paint. Exterior sale boundary lines against private property are marked with blue paint. Exterior sale boundary lines against state are marked with red paint. Interior Payment Unit boundaries are marked with yellow paint. Yellow painted trees designating an interior Payment Unit boundary are only to be cut when all surrounding Payment Units have been paid.

2 - Timber Specifications

2.1 - Included Timber

2.1.1 - Clearcut unit(s) with unmerchantable trees (6/14)

Within Payment Unit(s) 1, 2, 3, 4, 6, 7, 8, 9, and 10, cut all trees that are two (2) inches or more at DBH except do not cut any trees marked with green paint above and below stump height and within unit 6 do not cut any pine.

2.1.4 - Designated timber unit(s) (6/17)

Within Payment Unit(s) 5, all hardwood trees are designated for cutting which are two (2) inches or more at DBH regardless of merchantability. In addition, cut all tree marked with orange paint above and below stump height regardless of merchantability.

3 - Payments

3.3 - Pre-measured Sales

3.3.4 - Dividing payment units (7/14)

Payment Unit(s) 1, 2, 8, and 9 may be divided at the request of the Purchaser and upon approval of the Unit Manager. Dividing Payment Units is a contract modification which requires a Timber Sale Contract Amendment. There will be only one division per Payment Unit.

3.4 - Damaged Timber

3.4.1 - Damaged timber (7/16)

General Condition and Requirement 3.4 Damaged Timber, defines liquidated damages for undesignated live merchantable trees which are cut or injured. In addition, extreme care should be taken to avoid damage to tree seedlings and saplings.

Within unit 5, if more than 25% of the tree seedlings or saplings (1/4" to 4.5" DBH) within a specified portion of the sale area are damaged, liquidated damages will be assessed at \$300 per acre for all acreage within that specified portion of the sale area that was damaged.

No damage is acceptable to undesignated live merchantable trees. Within the sale area, if more than 5% of trees (> 4.5" DBH) within a specified area of the sale are damaged, liquidated damages will be assessed for all trees damaged. Rates will be in accordance with General Condition and Requirement 3.4 Damaged Timber.

4 - Transportation

4.4 - Access

4.4.1 - Private property access (3/11)

Permission for access across private land is the responsibility of the Purchaser.

5 - Operations

5.2 - Conduct of Operations

5.2.2 - Hazard Trees/Snags

5.2.2.1 - Den trees (10/16)

Obvious hollow and/or den trees shall be protected and left standing unless they are a safety hazard.

5.2.3 - Operating Restrictions

5.2.3.1 - Operating restrictions (9/11)

Within Payment Unit(s) 7, 8, and 9, cutting, skidding, and hauling are not permitted during the period of 04/01 to 09/30. This restriction is because of concerns about regeneration.

5.2.3.3 - Bark slippage restriction (3/09)

Within Payment Unit(s) 5, unless changed by written agreement, cutting and skidding are not permitted during the period of April 15 to July 15. This restriction is because of bark slippage.

5.2.3.6 - Bark beetle restriction (12/08)

In the event drought creates a high risk of pine bark beetle infestation, pine is not to be cut during the period March 1 through July 1, unless all portions of trees greater than two inches in diameter are removed from the sale area, reduced to chips, or treated to the satisfaction of the Unit Manager or his/her representative, within fifteen days of being severed from the stump. Pine log decks, pulpwood piles and treetops that are piled for chipping in the fall or winter within a 1/4 mile of susceptible sites must be removed before March 15. Residual slash must not be placed in piles or rows and must be spread over the site for quick drying. The Department of Natural Resources will exercise this specification if the risk of damage warrants.

5.2.4 - Dead and Down Creation

5.2.4.4 - Dead and down creation, grouse (6/18)

To encourage grouse and other wildlife, in Payment Unit(s) 1, 2, 3, 6, 8, 9, and 10 leave one 12" or larger diameter whole tree on the ground for every 3 acres. Trees should be scattered throughout the sale and at least two chains from any roads, two-tracks, or trails open to vehicles, or positioned per the sale administrators instructions. Stumps must be at least 3 feet tall.

5.2.22 - Operating Caution

5.2.22.1 - Operating caution (6/11)

It is recommended, but not required, that within Payment Unit(s) 4, 5, and 10, cutting, skidding, and hauling occur during dry summer or frozen winter conditions. The reason for the recommendation is because units are seasonally wet.

5.2.40 - Pathway protection (10/10)

The Midland to Mackinac is a hiking trail and is shown on the Timber Sale Map. Do not cut trees or damage posts with blue pathway markers. Maintain a 20-foot wide slash, debris, and rut free zone daily, using the pathway as the centerline.

5.4 - Soil Protection

5.4.1 - Rutting restriction, general (7/16)

Operations are to cease immediately if equipment and weather conditions result in rutting of roads and/or skid trails which is 12 inches or greater in depth and 50 feet in length. The Unit Manager or his/her representative may restrict hauling and/or skidding if ruts exceed the specified depth. With the Unit Manager or his/her representative's approval, the Purchaser may return to the area when the risk of rutting has decreased.

**TIMBER SALE MAP**

This information provided by authority of Part 525, 1994 PA 451, as amended.

Sale Number

73 - 010

Year

22

Forest Management Unit
Gladwin Management UnitCounty
GladwinMapped By Steven Nyhoff
Cruised By Shooltz, Nyhoff

Date

09/30/2022

Page

of
1 3

Township

19N

Range

1E

Section(s) and Subdivision(s)

Various

Scale

1:15,840

Cover Type

A = Aspen	H = Hemlock	N = Marsh	U = Upland Brush
B = Paper Birch	J = Jack Pine	O = Oak	UM = Upland Mixed
C = Cedar	L = Lowland Brush	P = Lowland Poplar	V = Bog or Marsh
D = Treed Bog	LM = Lowland Mixed	Q = Mixed Swamp Conifer	W = White Pine
E = Swamp Hdwoods	M = Mpl, Bch, Brch	R = Red Pine	X = Non Stocked
F = Spruce Fir	MC = Mixed Conifer	S = Black Spruce	Z = Water
G = Grass	MD = Mixed Deciduous	T = Tamarack	

Density

0 = Non Stocked	5 = Pole Timber Medium
1 = Seedling Sapling Poor	6 = Pole Timber Well
2 = Seedling Sapling Medium	7 = Saw Timber Poor
3 = Seedling Sapling Well	8 = Saw Timber Medium
4 = Pole Timber Poor	9 = Saw Timber Well

PU	Acres	PU	Acres	PU	Acres
1	10.3	5	17.7	9	18.3
2	11.7	6	16.4	10	6.7
3	9.3	7	10.1		
4	3.0	8	14.8		

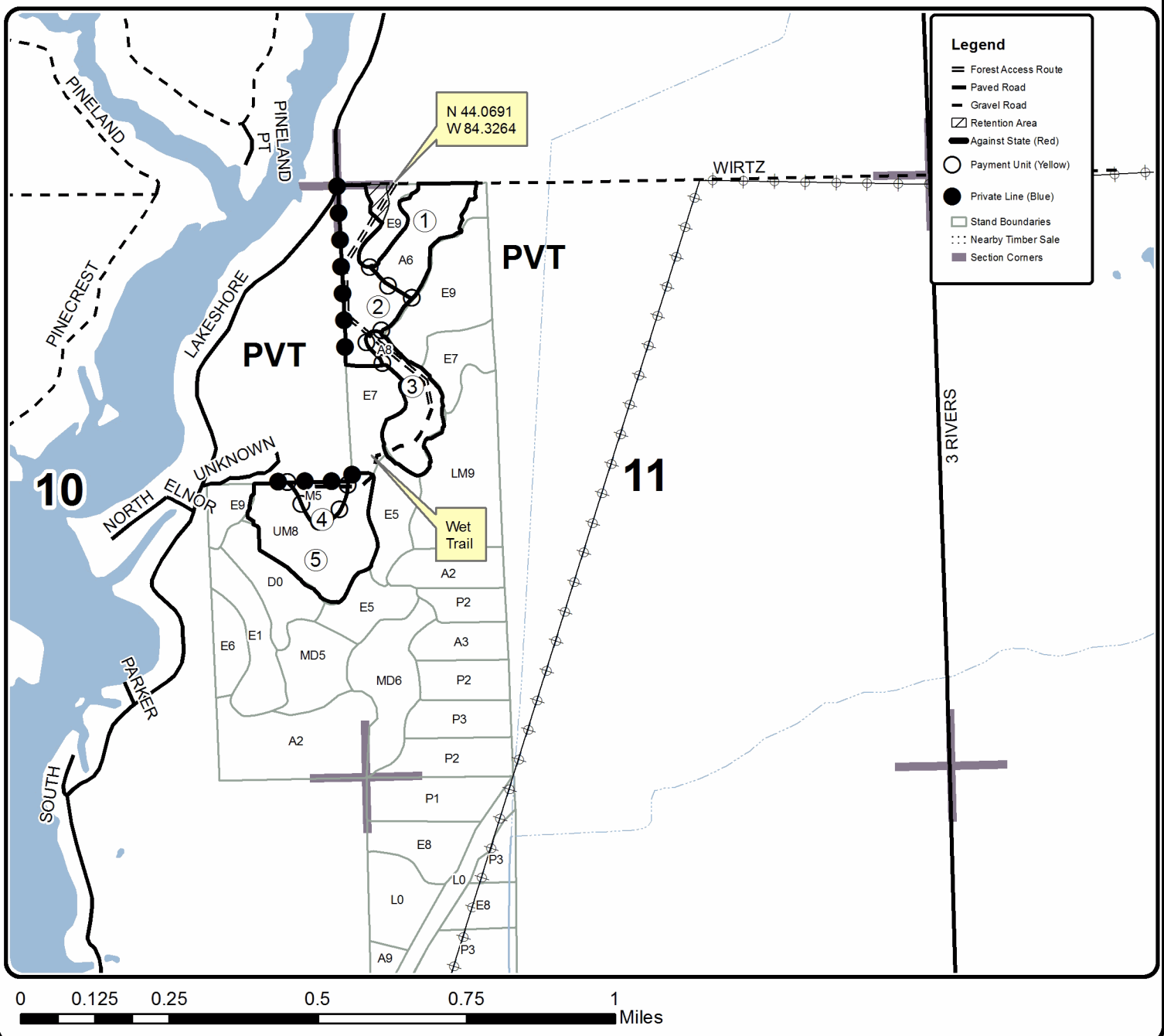
Middle C36
Compartment 36
118.3 Acres



TIMBER SALE MAP

This information provided by authority of Part 525, 1994 PA 451, as amended.

Sale Number	Year
73 - 010	22

Forest Management Unit	County	Mapped By	Date	Page	of
Gladwin Management Unit	Gladwin	Steven Nyhoff	09/30/2022	2	3
Township	Range	Section(s) and Subdivision(s)	Scale		
19N	1E	Various	1:15,840		

Cover Type				Density	
A = Aspen	H = Hemlock	N = Marsh	U = Upland Brush	0 = Non Stocked	5 = Pole Timber Medium
B = Paper Birch	J = Jack Pine	O = Oak	UM = Upland Mixed	1 = Seedling Sapling Poor	6 = Pole Timber Well
C = Cedar	L = Lowland Brush	P = Lowland Poplar	V = Bog or Marsh	2 = Seedling Sapling Medium	7 = Saw Timber Poor
D = Treed Bog	LM = Lowland Mixed	Q = Mixed Swamp Conifer	W = White Pine	3 = Seedling Sapling Well	8 = Saw Timber Medium
E = Swamp Hdwoods	M = Mpl, Bch, Brch	R = Red Pine	X = Non Stocked	4 = Pole Timber Poor	9 = Saw Timber Well
F = Spruce Fir	MC = Mixed Conifer	S = Black Spruce	Z = Water		
G = Grass	MD = Mixed Deciduous	T = Tamarack			

PU	Acres	PU	Acres	PU	Acres
1	10.3	5	17.7	9	18.3
2	11.7	6	16.4	10	6.7
3	9.3	7	10.1		
4	3.0	8	14.8		

Middle C36

Compartment 36

118.3 Acres

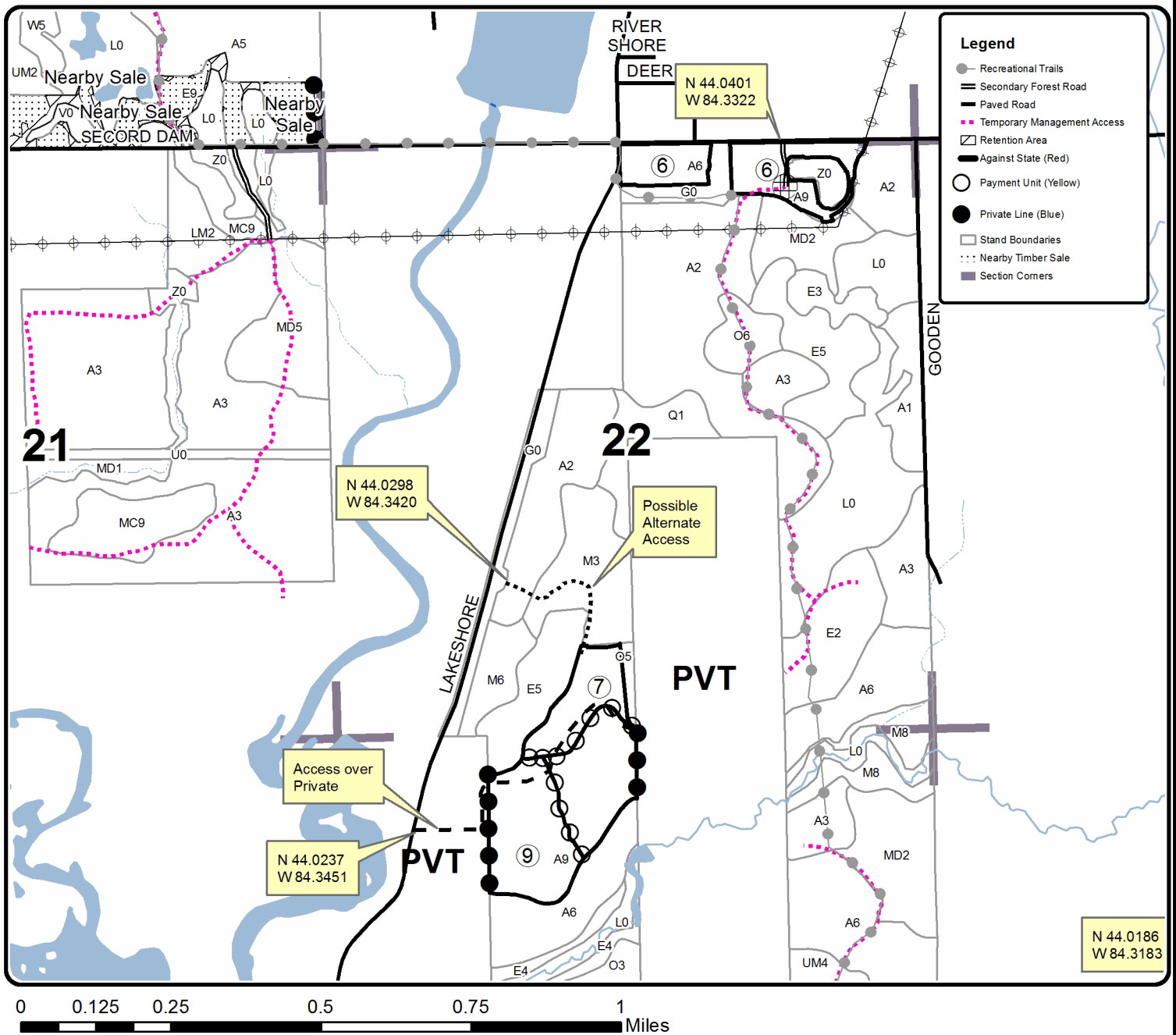



TIMBER SALE MAP

This information provided by authority of Part 525, 1994 PA 451, as amended.

Sale Number	Year
73 - 010	22

Forest Management Unit	County	Mapped By	Date	Page	of
Gladwin Management Unit	Gladwin	Steven Nyhoff	09/30/2022	3	3
Township	Range	Section(s) and Subdivision(s)	Scale		
19N	1E	Various	1:15,840		

Cover Type				Density	
A = Aspen	H = Hemlock	N = Marsh	U = Upland Brush	0 = Non Stocked	5 = Pole Timber Medium
B = Paper Birch	J = Jack Pine	O = Oak	UM = Upland Mixed	1 = Seedling Sapling Poor	6 = Pole Timber Well
C = Cedar	L = Lowland Brush	P = Lowland Poplar	V = Bog or Marsh	2 = Seedling Sapling Medium	7 = Saw Timber Poor
D = Treed Bog	LM = Lowland Mixed	Q = Mixed Swamp Conifer	W = White Pine	3 = Seedling Sapling Well	8 = Saw Timber Medium
E = Swamp Hdwoods	M = Mpl, Bch, Brch	R = Red Pine	X = Non Stocked	4 = Pole Timber Poor	9 = Saw Timber Well
F = Spruce Fir	MC = Mixed Conifer	S = Black Spruce	Z = Water		
G = Grass	MD = Mixed Deciduous	T = Tamarack			

PU	Acres	PU	Acres	PU	Acres
1	10.3	5	17.7	9	18.3
2	11.7	6	16.4	10	6.7
3	9.3	7	10.1		
4	3.0	8	14.8		

Middle C36

Compartment 36

118.3 Acres

