



**DEPARTMENT OF NATURAL RESOURCES  
STATE OF MICHIGAN  
TIMBER SALE PROSPECTUS #7396**

**SCHEDULED SALE DATE AND TIME: 10:00 a.m. (local time) on May 9, 2024.**

**LOCATION: GLADWIN MGMT UNIT, 801 NORTH SILVERLEAF, GLADWIN, MI 48624.**

**CONTACT NAME: Blair Tweedale**

**PHONE NUMBER: (989) 426-9205**

**PROSPECTUS NOTE:** The bidder is advised to inspect the sale area and review the location, estimated volumes, operating costs and contract terms of proposed sales. Please be aware that some landowners may request 60 days or more notice for access across their land.

Notice is hereby given that bids will be received by the Unit Manager, GLADWIN MANAGEMENT UNIT, for certain timber on the following described lands:

Arnie Lake Alert (73-006-23) / T20N, R03W, SEC. 1 , NW.

T20N, R03W, SEC. 32, SESE.

T20N, R03W, SEC. 33, SWSW,S1/2SE.

T20N, R03W, SEC. 4 , NWNW,S1/2NW.

T20N, R03W, SEC. 5 , E1/2NE.

Clare County, Advertised Price \$214,289.10, 99.8 Acres, Red Pine, White Pine.

SALE NOTE: There is a large opening south of Payment Unit 3 that will be utilized for decking.

Payment Unit 4 has a large opening on the north end that will be utilized for decking.

A recreation site such as a trail, pathway, or campground is within the sale area or the vicinity.

Certain restrictions/specifications may be applicable including time restrictions.

## TIMBER SALE INFORMATION

Arnie Lake Alert (73-006-23)

T20N, R03W, SEC. 1; T20N, R03W, SEC. 32; T20N, R03W, SEC. 33; T20N, R03W, SEC. 4; T20N, R03W, SEC. 5.

Clare County (Advertised Price \$214,289.10)

**SALE NOTE:** There is a large opening south of Payment Unit 3 that will be utilized for decking. Payment Unit 4 has a large opening on the north end that will be utilized for decking.

A recreation site such as a trail, pathway, or campground is within the sale area or the vicinity. Certain restrictions/specifications may be applicable including time restrictions.

A timber sale contract for this lump sum, sealed bid timber sale will be awarded to the responsible bidder offering the highest sealed bid price. All units of volume listed below were estimated using the Inventory Manager computer program and the new Michigan taper model. Bids must be at or above the following advertised price for each product and species:

<u>PRODUCTS &amp; SPECIES</u>	<u>ESTIMATED UNITS*</u>	<u>ADVERTISED PRICE</u>
Sawtimber		
Basswood	11.6 MBF	\$ 81.00 / MBF
Black/Red (Hybrid) Oak	61.7 MBF	\$ 122.00 / MBF
Mixed Aspen	31.4 MBF	\$ 68.00 / MBF
Red Maple	6.0 MBF	\$ 65.00 / MBF
Red Pine	687.6 MBF	\$ 135.00 / MBF
Sugar Maple	38.8 MBF	\$ 326.00 / MBF
White Oak	6.4 MBF	\$ 80.00 / MBF
White Pine	166.6 MBF	\$ 65.00 / MBF
Pulpwood		
Basswood	26 Cords	\$ 15.15 / Cord
Beech	18 Cords	\$ 20.75 / Cord
Jack Pine	7 Cords	\$ 25.45 / Cord
Mixed Aspen	169 Cords	\$ 30.40 / Cord
Mixed Hardwood	69 Cords	\$ 20.75 / Cord
Mixed Oak	122 Cords	\$ 17.10 / Cord
Paper Birch	10 Cords	\$ 22.40 / Cord
Red Pine	966 Cords	\$ 56.50 / Cord
White Pine	669 Cords	\$ 33.00 / Cord

\* The total volume is statistically estimated within plus (+) or minus (-) 24.07 percent. There are an estimated 4,422 cords on this timber sale, plus or minus 1,065 cords at the 95% confidence level. The estimated units are final and not subject to adjustment. Prospective bidders are urged to examine this timber and to make their own estimates of quantity and quality.

### **BOND AND PAYMENT SCHEDULE:**

1. A bond in the amount of \$10,714.46 to insure faithful performance of the conditions of the contract will be deposited by the successful bidder within 21 days of the sale award.
2. Cutting in any sale or unit without the required advance payment would be considered a trespass.
3. Total payment must be paid in advance or according to the following schedule:
  - (a) Ten percent (10%) of the sale value must be paid within 21 days of the sale award.
  - (b) The 10% down payment will be credited towards the first unit cut.
  - (c) Payment for each of the following units must be made before cutting begins in that unit:

PAYMENT UNIT NUMBER	PERCENT OF TOTAL SALE VALUE
01	22.2%
02	11.5%
03	2.7%
04	63.6%
4. If no cutting takes place, the 10% down payment will not be refunded.
5. Operations on the contract issued will terminate on 08/31/2026.

### **SALE STATISTICS**

Volumes were calculated in cubic feet using the Michigan taper model. Cubic foot volume includes all wood inside bark for the product indicated. For display purposes, cubic feet were converted to cords and MBF using a simple conversion factor, e.g. 79 cubic feet per cord and 185 cubic feet per MBF. The cubic foot volumes are precise; the cords and MBF volumes are not. Cubic foot volume cannot be directly converted to cords or boards with precision.

## SALE VOLUMES

The total estimated sale volume may not equal the sum of the species/products due to the nature of statistical calculations associated with double sampling methodology.

VOLUME			STATISTICAL RANGE IN CORDS	
TOTAL CUBIC FEET	TOTAL CORDS	PERCENT ERROR	MINIMUM	MAXIMUM
349,320	4,422	24.07%	3,357	5,486

## VDU VOLUMES

A VDU is a Volume Determination Unit. Volumes and their associated statistics are calculated at the VDU level and summarized to the sale level. There is often a one to one relationship between a VDU and a Payment Unit, but not always, depending on the cruise design. Refer to the VDU TO PAYMENT UNIT table.

	VOLUME			RANGE IN CORDS	
VDU	TOTAL CUBIC FEET	TOTAL CORDS	PERCENT ERROR	MINIMUM	MAXIMUM
26	68,868	872	29.00%	619	1,125
33	160,627	2,033	17.05%	1,687	2,380
95	71,497	905	38.11%	560	1,250
106	40,184	509	56.43%	222	796
112	8,145	103	76.80%	24	182
<b>TOTAL:</b>	<b>349,320</b>	<b>4,422</b>		<b>3,111</b>	<b>5,732</b>

## VDU TO PAYMENT UNIT

When a VDU is associated with more than one Payment Unit (PU), the VDU volumes are assigned to the PU based on acres of the VDU within the PU.

VDU	VDU ACRES	PU	PU ACRES
26	17.6	4	17.6
33	49.6	4	49.6
95	17.7	1	17.7
106	10.1	2	10.1
112	4.8	3	4.8
<b>TOTAL:</b>	<b>99.8</b>		<b>99.8</b>

**DESCRIPTION OF TIMBER BY PU (PU)**

PU	MARKET GROUP	PRODUCT	QUANTITY	UNIT	ACRES	ADVERTISE PRICE
1	Basswood	Sawtimber	11.6	MBF	17.7	\$47,481.90
	Black/Red (Hybrid		2.9	MBF		
	Mixed Aspen		23.5	MBF		
	B. T. Aspen		23.5	MBF		
	Red Maple		6.0	MBF		
	Red Pine		110.4	MBF		
	Sugar Maple		31.9	MBF		
	Basswood	Pulpwood	26	Cords		
	Beech		6	Cords		
	Beech	Sawtimber	2.7	MBF		
	Beech	Pulpwood	1	Cords		
	Mixed Aspen		140	Cords		
	B. T. Aspen		140	Cords		
	Mixed Hardwood		50	Cords		
	Red Maple		12	Cords		
	Sugar Maple		38	Cords		
	Mixed Oak		12	Cords		
	/Red (Hybrid) Oak		12	Cords		
	Paper Birch		10	Cords		
	Paper Birch	Sawtimber	0.8	MBF		
	Paper Birch	Pulpwood	8	Cords		
	Red Pine		224	Cords		
2	Red Pine	Sawtimber	77.7	MBF	10.1	\$24,713.80
	Sugar Maple		6.9	MBF		
	White Pine		40.5	MBF		
	Beech	Pulpwood	12	Cords		
	Beech	Sawtimber	2.7	MBF		
	Beech	Pulpwood	7	Cords		
	Jack Pine		7	Cords		
	Mixed Hardwood		17	Cords		
	Red Maple		4	Cords		
	Sugar Maple		13	Cords		
	Red Pine		113	Cords		
	White Pine		66	Cords		
	3	Red Pine	Sawtimber	8.3		
Red Pine		Pulpwood	84	Cords		
4	Black/Red (Hybrid	Sawtimber	58.8	MBF	67.2	\$136,226.90
	Mixed Aspen		7.9	MBF		
	B. T. Aspen		4.1	MBF		
	Quaking Aspen		3.8	MBF		
	Red Pine		491.2	MBF		
	White Oak		6.4	MBF		
	White Pine		126.1	MBF		
	Mixed Aspen	Pulpwood	29	Cords		
	B. T. Aspen		16	Cords		
	Quaking Aspen		13	Cords		
	Mixed Hardwood		2	Cords		
	Black Cherry		2	Cords		
	Mixed Oak		110	Cords		
	/Red (Hybrid) Oak		92	Cords		
	White Oak		18	Cords		
	Red Pine		545	Cords		
	White Pine		603	Cords		
	TOTAL:			1,010.1		

TOTAL:	2,056	Cords
--------	-------	-------

## **Sale Specific Conditions & Requirements**

**Sale Name: Arnie Lake Alert**

**Sale Number: 73-006-23 Seq#: 1**

### **1 - Sale Area**

#### **1.2 - Boundaries**

##### **1.2.1 - Painted boundaries (9/19)**

The sale boundary and Payment Unit boundaries are marked and identified by blue and red paint, along with roads. Exterior sale boundary lines against private property are marked with blue paint, with the exception of the southern boundaries of Payment Units 1 & 2, which are unpainted and designated by Arnold Lake Road. Exterior sale boundary lines against state are marked with red paint, with the exception of the northern boundary of Payment Unit 4, which is unpainted and designated by Claroskee Road. Retention patches are marked with red paint; no harvesting activities may occur within these areas. The painted boundary line trees are not Included Timber and are to be protected unless marked with orange paint.

### **2 - Timber Specifications**

#### **2.1 - Included Timber**

##### **2.1.1 - Clearcut unit(s) with unmerchantable trees (6/14)**

Within Payment Unit(s) 1, 2, & 4, cut all trees that are two (2) inches or more at DBH.

##### **2.1.3 - Cut tree marked unit(s) (12/08)**

Within Payment Unit(s) 3, all trees are designated for cutting when marked with orange paint above and below stump height, regardless of merchantability.

##### **2.1.15 - Hazard trees near roads (11/20)**

Cut and remove all standing dead trees within 100 feet of the cleared portion of designated county roads. These trees may be utilized or must be scattered back into the Sale Area.

#### **2.2 - Utilization**

##### **2.2.2 - Chipping required (2/18)**

Payment Units 1 & 2 must be chip harvested to facilitate subsequent planting operations. The Purchaser has the option to produce sawlogs or pulpwood bolts, but the remaining portion of the trees must be chipped and hauled. A chipping exemption can be obtained if proposed operations are determined to be suitable for planting by reforestation staff. This exemption must be granted in writing. The requirement to retain approximately 1/6 to 1/3 of tree tops and limbs less than four inches in diameter is still applicable (G. C. & R. 2.2).

##### **2.2.3 - Stump heights (4/07)**

Stump heights within Payment Units 1 & 2 shall not exceed 6 inches for all trees. This is in order to facilitate planting operations.

### **3 - Payments**

#### **3.3 - Pre-measured Sales**

##### **3.3.4 - Dividing payment units (7/14)**

Payment Unit(s) may be divided at the request of the Purchaser and upon approval of the Unit Manager. Dividing Payment Units is a contract modification which requires a Timber Sale Contract Amendment. There will be only one division per Payment Unit.

#### **3.4 - Damaged Timber**

##### **3.4.1 - Damaged timber (7/16)**

General Condition and Requirement 3.4 Damaged Timber, defines liquidated damages for undesignated live merchantable trees which are cut or injured. No damage is acceptable to undesignated live merchantable trees. Within Payment Unit 3, if more than 20% of trees (> 4.5" DBH) within a specified area of the sale are damaged, liquidated damages will be assessed for all trees damaged. Rates will be in accordance with General Condition and Requirement 3.4 Damaged Timber.

## **4 - Transportation**

### **4.1 - Construction**

#### **4.1.7 - Road closure (10/11)**

All new roads built into the sale must be blocked to vehicle traffic upon completion of the sale. Overgrown roads that are reopened shall be considered new roads. In general, this will require constructing a four (4') foot high berm of stumps and logs covered with earth. Stumps and brush must be placed along the remainder of the trail. These roads must be rendered impassable to cars and trucks. Contact the Sale Administrator for specific details of design and placement.

## **5 - Operations**

### **5.1 - Notification**

#### **5.1.3 - Well heads and natural gas pipelines (11/15)**

The Purchaser is responsible for contacting the gas or pipeline company 30 days prior to operating equipment in the vicinity of well heads or natural gas pipelines.

### **5.2 - Conduct of Operations**

#### **5.2.1 - Slash**

##### **5.2.1.8 - Slash height (12/08)**

No slash may exceed 24 inches in height.

#### **5.2.3 - Operating Restrictions**

##### **5.2.3.3 - Bark slippage restriction (3/09)**

Within Payment Unit(s) 3, unless changed by written agreement, cutting and skidding are not permitted during the period of April 15 to July 15. This restriction is because of bark slippage.

##### **5.2.3.5 - Oak wilt restriction (1/18)**

Within Payment Unit 4, unless changed by written agreement, cutting, skidding, hauling within the sale and brushing of access roads to the sale are not permitted during the period of April 15 to July 15. Operations may be allowed if specific steps are taken to prevent damaging uncut oak during the high risk period. Those steps may include completing all road brushing before April 15th and clearing a tree-length buffer along uncut oak cover before April 15th. This is necessary to reduce the spread of oak wilt. For more information, contact the Unit Manager or his/her representative.

##### **5.2.3.6 - Bark beetle restriction (12/08)**

In the event drought creates a high risk of pine bark beetle infestation, pine is not to be cut during the period March 1 through July 1, unless all portions of trees greater than two inches in diameter are removed from the sale area, reduced to chips, or treated to the satisfaction of the Unit Manager or his/her representative, within fifteen days of being severed from the stump. Pine log decks, pulpwood piles and treetops that are piled for chipping in the fall or winter within a 1/4 mile of susceptible sites must be removed before March 15. Residual slash must not be placed in piles or rows and must be spread over the site for quick drying. The Department of Natural Resources will exercise this specification if the risk of damage warrants.

#### **5.2.32 - Decking/landing restoration (9/13)**

All decking and landing areas must have the surface area restored to a condition equal to or better than before. This is to ensure the proper regeneration of the stand. Wood debris, chips and "cookies" from trimmings must be removed or scattered away from landing and loading areas and may not be windrowed on the edge.

#### **5.2.41 - Snowmobile trail protection (9/11)**

LP 655 is a snowmobile trail and is shown on the Timber Sale Map. Do not cut or damage posts with orange trail markers or traffic control signs. If the trail is used, it must be maintained and restored to a condition equal to or better than before the sale. If the trail is used for hauling, it must be graded to the satisfaction of the Unit Manager or his/her representative prior to December 1. If the trail is to be used for hauling during the snowmobile season, then a snow-covered base must be left on the trail. The snowmobile trail may only be crossed at right angles. Maintain a 20-foot-wide slash, debris, and rut free zone daily using the snowmobile trail as the centerline. No decking of forest products will be permitted along the snowmobile trail. All stumps within 20 feet of the snowmobile trail must be cut at ground level.

## **6 - Safety and Fire Prevention**

### **6.2 - Signing**

#### **6.2.1 - Road posting (10/20)**

The Purchaser is responsible for posting and maintaining caution signs on Arnold Lake, Claroskee, & Angle Roads prior to beginning operations. The road must be posted at appropriate distances from the Sale Area to warn of logging activity and truck traffic. Signs must be removed when harvest operations are suspended or completed. The Purchaser will provide these signs.

#### **6.2.2 - Snowmobile trail posting (10/20)**

The Purchaser is responsible for posting and maintaining caution signs on the LP 655 Snowmobile Trail prior to beginning operations during the snowmobile season (approximately December 1 to March 31). The trail must be posted at appropriate distances from the Sale Area to warn of logging activity and truck traffic. Signs must be removed when harvest operations are suspended or completed. The Purchaser will provide these signs.



**TIMBER SALE MAP**

This information provided by authority of Part 525, 1994 PA 451, as amended.

Sale Number	Year
73 - 006	23

Forest Management Unit	County	Mapped By	Date	Page	of
Gladwin Management Unit	Clare County	Behrmann	07/24/2023	1	3
Cruised By	Behrmann				

Township	Range	Section(s) and Subdivision(s)	Scale
20N	03W	Sec 32 SESE, Sec 33 SESE, Sec 1 NENW, Sec 4 S1/2NW	1:15,840

Cover Type				Density	
A = Aspen	H = Hemlock	N = Marsh	U = Upland Brush	0 = Non Stocked	5 = Pole Timber Medium
B = Paper Birch	J = Jack Pine	O = Oak	UM = Upland Mixed	1 = Seedling Sapling Poor	6 = Pole Timber Well
C = Cedar	L = Lowland Brush	P = Lowland Poplar	V = Bog or Marsh	2 = Seedling Sapling Medium	7 = Saw Timber Poor
D = Tired Bog	LM = Lowland Mixed	Q = Mixed Swamp Conifer	W = White Pine	3 = Seedling Sapling Well	8 = Saw Timber Medium
E = Swamp Hdwoods	M = Mpl, Boh, Brch	R = Red Pine	X = Non Stocked	4 = Pole Timber Poor	9 = Saw Timber Well
F = Spruce Fir	MC = Mixed Conifer	S = Black Spruce	Z = Water		
G = Grass	MD = Mixed Deciduous	T = Tamarack			

PU	Acres	PU	Acres
1	17.7	3	4.8
2	10.1	4	67.2

**Arnie Lake Alert**

Compartment 2

99.8 Acres

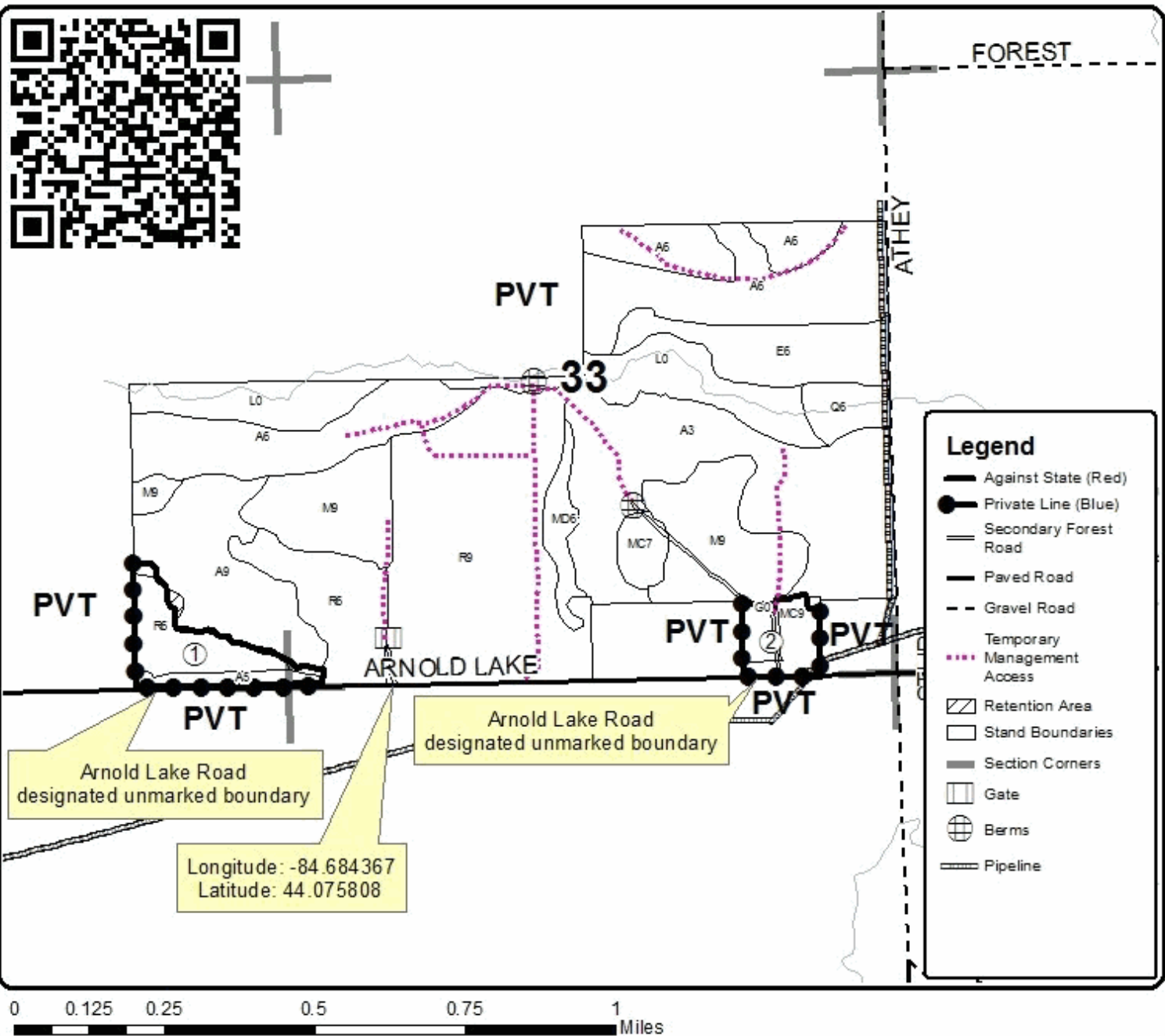



## TIMBER SALE MAP

This information provided by authority of Part 525, 1994 PA 451, as amended.

Sale Number	Year
73 - 006	23

Forest Management Unit	County	Mapped By	Date	Page	of
Gladwin Management Unit	Clare County	Behrmann	07/24/2023	2	3
Cruised By	Behrmann				

Township	Range	Section(s) and Subdivision(s)	Scale
20N	03W	Sec 32 SESE, Sec 33 SESE, Sec 1 NENW, Sec 4 S1/2NW	1:7,920

Cover Type				Density	
A = Aspen	H = Hemlock	N = Marsh	U = Upland Brush	0 = Non Stocked	5 = Pole Timber Medium
B = Paper Birch	J = Jack Pine	O = Oak	UM = Upland Mixed	1 = Seedling Sapling Poor	6 = Pole Timber Well
C = Cedar	L = Lowland Brush	P = Lowland Poplar	V = Bog or Marsh	2 = Seedling Sapling Medium	7 = Saw Timber Poor
D = Tired Bog	LM = Lowland Mixed	Q = Mixed Swamp Conifer	W = White Pine	3 = Seedling Sapling Well	8 = Saw Timber Medium
E = Swamp Hardwoods	M = Mpl, Boh, Brch	R = Red Pine	X = Non Stocked	4 = Pole Timber Poor	9 = Saw Timber Well
F = Spruce Fir	MC = Mixed Conifer	S = Black Spruce	Z = Water		
G = Grass	MD = Mixed Deciduous	T = Tamarack			

PU	Acres	PU	Acres
1	17.7	3	4.8
2	10.1	4	67.2

## Arnie Lake Alert

Compartment 2  
99.8 Acres

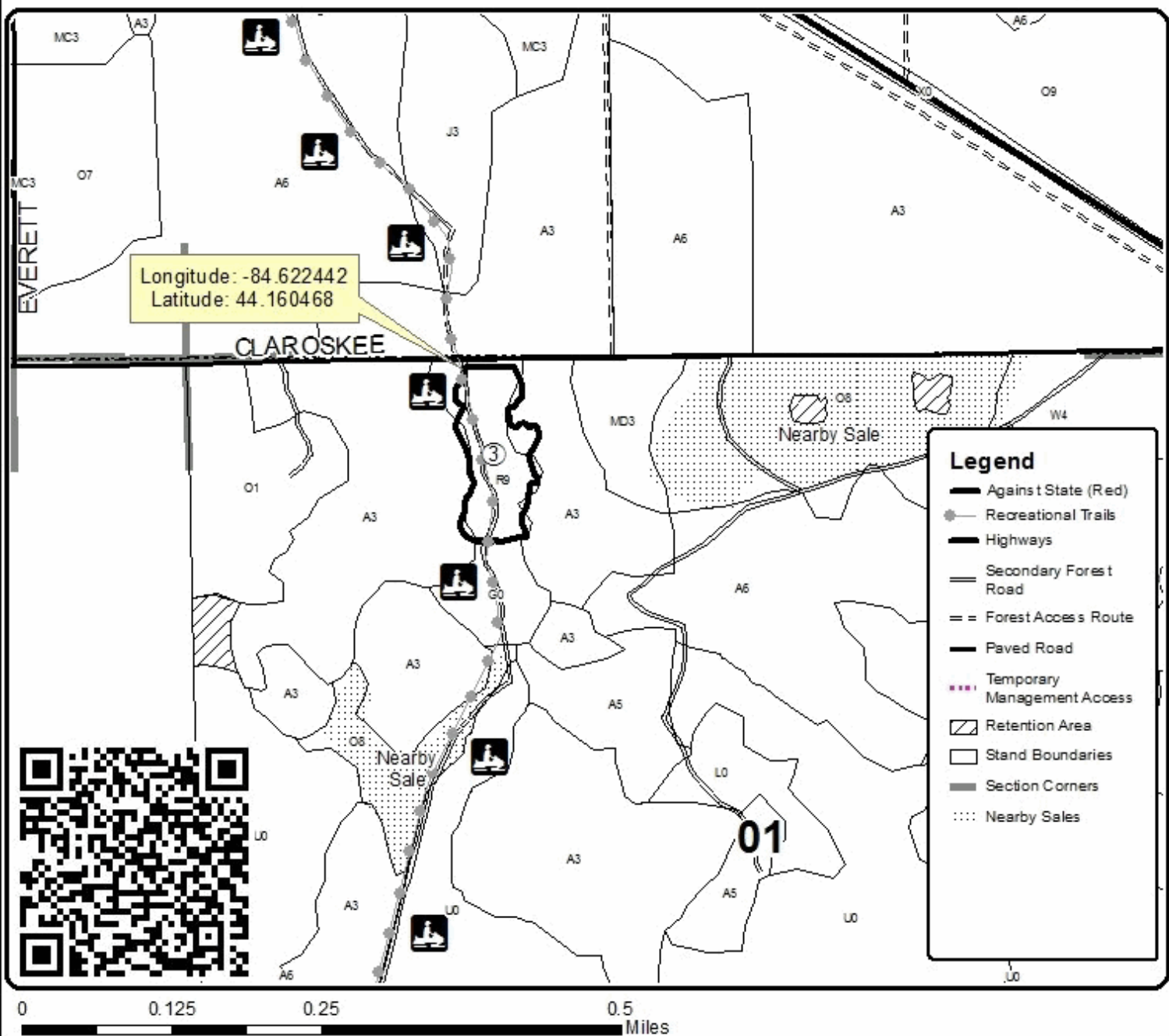

## TIMBER SALE MAP

*This information provided by authority of Part 525, 1994 PA 451, as amended.*

Forest Management Unit		County	Mapped By	Behrmann	Date	Page	of
Gladwin Management Unit		Clare County	Cruised By	Behrmann	07/24/2023	3	3
Township	Range	Section(s) and Subdivision(s)			Scale		
20N	03W	Sec 32 SESE, Sec 33 SESE, Sec 1 NENW, Sec 4 S1/2NW			1:7,920		

Cover Type				Density	
A = Aspen	H = Hemlock	N = Marsh	U = Upland Brush	0 = Non Stocked	5 = Pole Timber Medium
B = Paper Birch	J = Jack Pine	O = Oak	UM = Upland Mixed	1 = Seedling Sapling Poor	6 = Pole Timber Well
C = Cedar	L = Lowland Brush	P = Lowland Poplar	V = Bog or Marsh	2 = Seedling Sapling Medium	7 = Saw Timber Poor
D = Tired Bog	LM = Lowland Mixed	Q = Mixed Swamp Conifer	W = White Pine	3 = Seedling Sapling Well	8 = Saw Timber Medium
E = Swamp Hardwoods	M = Mpl, Boh, Brch	R = Red Pine	X = Non Stocked	4 = Pole Timber Poor	9 = Saw Timber Well
F = Spruce Fir	MC = Mixed Conifer	S = Black Spruce	Z = Water		
G = Grass	MD = Mixed Deciduous	T = Tamarack			

PU	Acres	PU	Acres
1	17.7	3	4.8
2	10.1	4	67.2

## Arnie Lake Alert

### Compartment 2

**99.8 Acres**

