



**DEPARTMENT OF NATURAL RESOURCES
STATE OF MICHIGAN
TIMBER SALE PROSPECTUS #7422**

SCHEDULED SALE DATE AND TIME: **2:00 p.m. (local time) on April 3, 2024.**

LOCATION: **SHINGLETON MGMT UNIT, PO BOX 67, M 28 WEST, SHINGLETON, MI 49884.**

CONTACT NAME: Robert Burnham

PHONE NUMBER: (906) 420-1645

PROSPECTUS NOTE: Timber Sales on this prospectus have been reduced due to "no bid" on previous advertisement.

The bidder is advised to inspect the sale area and review the location, estimated volumes, operating costs and contract terms of proposed sales. Please be aware that some landowners may request 60 days or more notice for access across their land.

Notice is hereby given that bids will be received by the Unit Manager, SHINGLETON MANAGEMENT UNIT, for certain timber on the following described lands:

Nature Boy Pine (41-011-20) / T47N, R15W, SEC. 1, NW, W1/2NE, SW, SWSE.

T47N, R15W, SEC. 11, SE.

T47N, R15W, SEC. 12, NW, NWNE, S1/2NE, SW, SE.

T47N, R15W, SEC. 13, NWNW, SENE, N1/2SE, SESE.

T47N, R15W, SEC. 14, NENE.

Schoolcraft County, Advertised Price \$210,002.35, 442.9 Acres, Red Pine, White Pine.

SALE NOTE: Extensive road work is required on this sale. The advertised price has been reduced by the estimate cost of this road work to off-set the additional expense.

The Sale Area has received damage from wildfire, within Payment Unit 5. The Purchaser should harvest the wood as soon as possible. Payment Unit 5 is an optional Payment Unit. If it is not harvested, damages will NOT be assessed.

A new bridge has been constructed at Stanley Lake for better access to the Sale Area.

It is recommended that within Payment Units 16, 17, 19, 20, 21 and 22, harvesting occur during dry summer or frozen winter conditions because of soft soils.

Road work is required on this sale. See Sale Spec. 4.1.8 for specific requirements.

The Fox River Pathway is a non-motorized trail and is shown on the Timber Sale Map. See Sale Spec. 5.2.40 for restrictions.

Trail 43 is a snowmobile trail shown on the Timber Sale Map. See Sale Spec. 5.2.41 for additional information.

A recreation site such as a trail, pathway, or campground is within the sale area or the vicinity. Certain restrictions/specifications may be applicable including time restrictions.

TIMBER SALE INFORMATION

Nature Boy Pine (41-011-20)

T47N, R15W, SEC. 1; T47N, R15W, SEC. 11; T47N, R15W, SEC. 12; T47N, R15W, SEC. 13; T47N, R15W, SEC. 14.
Schoolcraft County (Advertised Price \$210,002.35)

SALE NOTE: Extensive road work is required on this sale. The advertised price has been reduced by the estimate cost of this road work to off-set the additional expense.

The Sale Area has received damage from wildfire, within Payment Unit 5. The Purchaser should harvest the wood as soon as possible. Payment Unit 5 is an optional Payment Unit. If it is not harvested, damages will NOT be assessed.

A new bridge has been constructed at Stanley Lake for better access to the Sale Area.

It is recommended that within Payment Units 16, 17, 19, 20, 21 and 22, harvesting occur during dry summer or frozen winter conditions because of soft soils.

Road work is required on this sale. See Sale Spec. 4.1.8 for specific requirements.

The Fox River Pathway is a non-motorized trail and is shown on the Timber Sale Map. See Sale Spec. 5.2.40 for restrictions.

Trail 43 is a snowmobile trail shown on the Timber Sale Map. See Sale Spec. 5.2.41 for additional information.

A recreation site such as a trail, pathway, or campground is within the sale area or the vicinity. Certain restrictions/specifications may be applicable including time restrictions.

A timber sale contract for this lump sum, sealed bid timber sale will be awarded to the responsible bidder offering the highest sealed bid price. All units of volume listed below were estimated using the T-Sale computer program and our traditional volume equations. Bids must be at or above the following advertised price for each product and species:

<u>PRODUCTS & SPECIES</u>	<u>ESTIMATED UNITS*</u>	<u>ADVERTISED PRICE</u>
Pulpwood		
Balsam Fir	4 Cords	\$ 8.95 / Cord
Black Spruce	263 Cords	\$ 12.75 / Cord
Jack Pine	52 Cords	\$ 15.55 / Cord
N. White Cedar	38 Cords	\$ 4.70 / Cord
Paper Birch	12 Cords	\$ 8.95 / Cord
Quaking Aspen	232 Cords	\$ 19.25 / Cord
Red Maple	61 Cords	\$ 14.55 / Cord
Red Pine	3,193 Cords	\$ 60.10 / Cord
Tamarack	25 Cords	\$ 5.85 / Cord
White Pine	424 Cords	\$ 19.15 / Cord

* The estimated units are final and not subject to adjustment. Prospective bidders are urged to examine this timber and to make their own estimates of quantity and quality.

BOND AND PAYMENT SCHEDULE:

1. A bond in the amount of \$10,500.12 to insure faithful performance of the conditions of the contract will be deposited by the successful bidder within 21 days of the sale award.
2. Cutting in any sale or unit without the required advance payment would be considered a trespass.
3. Total payment must be paid in advance or according to the following schedule:
 - (a) Ten percent (10%) of the sale value must be paid within 21 days of the sale award.
 - (b) The 10% down payment will be credited towards the first unit cut.

(c) Payment for each of the following units must be made before cutting begins in that unit:

PAYMENT UNIT NUMBER	PERCENT OF TOTAL SALE VALUE
01	4.3%
02	4.6%
03	6.4%
04	4.6%
05	2.9%
06	9.3%
07	6.6%
08	3.7%
09	0.5%
10	3.4%
11	6.8%
12	9.8%
13	9.3%
14	8.9%
15	14.1%
16	1.1%
17	0.4%
18	0.3%
19	1.1%
20	0.3%
21	0.9%
22	0.7%

4. If no cutting takes place, the 10% down payment will not be refunded.

5. Operations on the contract issued will terminate on 06/30/2027.

SALE STATISTICS

SALE VOLUMES

VOLUME		PERCENT ERROR	STATISTICAL RANGE IN CORDS	
TOTAL CUBIC FEET	TOTAL CORDS		MINIMUM	MAXIMUM
339,982	4,304	0.00%	4,304	4,304

VDU VOLUMES

A VDU is a Volume Determination Unit. Volumes and their associated statistics are calculated at the VDU level and summarized to the sale level. There is often a one to one relationship between a VDU and a Payment Unit, but not always, depending on the cruise design. Refer to the VDU TO PAYMENT UNIT table.

	VOLUME			RANGE IN CORDS	
VDU	TOTAL CUBIC FEET	TOTAL CORDS	PERCENT ERROR	MINIMUM	MAXIMUM
10	0	0	37.64%	0	0
11	0	0	67.83%	0	0
13	0	0	39.91%	0	0
15	0	0	21.77%	0	0
16	0	0	0.00%	0	0
18	0	0	50.45%	0	0
19	0	0	43.22%	0	0
20	0	0	41.69%	0	0
22	0	0	73.57%	0	0
23	0	0	0.00%	0	0
24	0	0	13.93%	0	0
25	0	0	0.00%	0	0
26	0	0	0.00%	0	0
27	0	0	61.58%	0	0
28	0	0	111.50%	0	0
29	0	0	71.48%	0	0
30	0	0	17.85%	0	0
34	0	0	27.57%	0	0
35	0	0	21.45%	0	0
38	0	0	32.51%	0	0
39	0	0	20.52%	0	0
40	0	0	30.97%	0	0
41	0	0	59.24%	0	0
46	0	0	22.22%	0	0
48	0	0	26.33%	0	0
51	0	0	25.49%	0	0
52	0	0	34.73%	0	0
54	0	0	31.94%	0	0
56	0	0	24.49%	0	0
85	0	0	33.24%	0	0
87	0	0	44.50%	0	0
89	0	0	9.46%	0	0
95	0	0	80.22%	0	0
96	0	0	42.78%	0	0
97	0	0	1.74%	0	0
411	0	0	47.19%	0	0
TOTAL:	0	0		0	0

VDU TO PAYMENT UNIT

When a VDU is associated with more than one Payment Unit (PU), the VDU volumes are assigned to the PU based on acres of the VDU within the PU.

VDU	VDU ACRES	PU	PU ACRES
10	24.8	10	24.8
11	16.9	6	16.9
13	27.3	4	27.3
15	10.0	2	10.0
16	4.3	1	4.3
18	12.8	1	12.8
19	3.9	6	3.9
20	25.5	6	25.5
22	7.2	8	7.2
23	3.8	8	3.8
24	8.9	8	8.9
25	3.9	8	3.9
26	0.8	9	0.8
27	6.0	11	6.0
28	7.7	11	7.7
29	8.4	11	8.4
30	9.6	11	9.6
34	48.2	15	48.2
35	47.6	14	47.6
38	11.6	21	11.6
39	2.4	20	2.4
40	7.2	22	7.2
41	2.3	20	2.3
46	1.8	19	1.8
48	25.0	13	25.0
51	29.7	12	29.7
52	9.1	12	9.1
54	11.5	7	11.5
56	19.6	7	19.6
85	10.8	16	10.8
87	4.9	17	4.9
89	2.1	19	2.1
95	1.7	18	1.7
96	13.1	3	13.1
97	5.6	13	5.6
411	6.9	5	6.9
TOTAL:	442.9		442.9

DESCRIPTION OF TIMBER BY PU (PU)

PU	MARKET GROUP	PRODUCT	QUANTITY	UNIT	ACRES	ADVERTISE PRICE
1	Red Pine	Pulpwood	149	Cords	17.1	\$8,954.90
2	Red Maple Red Pine White Pine	Pulpwood	1 126 110	Cords Cords Cords	10.0	\$9,693.65
3	Quaking Aspen Red Pine White Pine	Pulpwood	18 214 9	Cords Cords Cords	13.1	\$13,380.25
4	Quaking Aspen Red Maple Red Pine White Pine	Pulpwood	175 3 69 108	Cords Cords Cords Cords	27.3	\$9,627.50
5	Red Pine	Pulpwood	101	Cords	6.9	\$6,070.10
6	Red Pine White Pine	Pulpwood	324 6	Cords Cords	46.3	\$19,587.30
7	Red Pine	Pulpwood	231	Cords	31.1	\$13,883.10
8	Red Pine White Pine	Pulpwood	129 5	Cords Cords	23.8	\$7,848.65
9	Red Pine	Pulpwood	18	Cords	0.8	\$1,081.80
10	Jack Pine Red Pine White Pine	Pulpwood	12 115 4	Cords Cords Cords	24.8	\$7,174.70
11	Red Pine White Pine	Pulpwood	235 9	Cords Cords	31.7	\$14,295.85
12	Quaking Aspen Red Pine	Pulpwood	3 343	Cords Cords	38.8	\$20,672.05
13	Jack Pine Red Pine	Pulpwood	3 323	Cords Cords	30.6	\$19,458.95
14	Quaking Aspen Red Maple Red Pine White Pine	Pulpwood	36 6 290 27	Cords Cords Cords Cords	47.6	\$18,726.35
15	Red Pine White Pine	Pulpwood	486 10	Cords Cords	48.2	\$29,400.10
16	Black Spruce N. White Cedar Red Maple Tamarack White Pine	Pulpwood	86 2 2 6 65	Cords Cords Cords Cords Cords	10.8	\$2,414.85
17	Black Spruce Red Maple Tamarack White Pine	Pulpwood	12 4 13 28	Cords Cords Cords Cords	4.9	\$823.45
18	Red Maple Red Pine White Pine	Pulpwood	1 7 9	Cords Cords Cords	1.7	\$607.60
19	Black Spruce Jack Pine Red Pine	Pulpwood	20 19 29	Cords Cords Cords	3.9	\$2,293.35
20	Balsam Fir Black Spruce N. White Cedar Tamarack White Pine	Pulpwood	1 30 3 3 8	Cords Cords Cords Cords Cords	4.7	\$576.30
21	Black Spruce	Pulpwood	82	Cords	11.6	\$1,928.05

DESCRIPTION OF TIMBER BY PU (PU), CON'T

PU	MARKET GROUP	PRODUCT	QUANTITY	UNIT	ACRES	ADVERTISE PRICE
21 con't	Jack Pine	Pulpwood	18	Cords		
	Red Pine		4	Cords		
	Tamarack		3	Cords		
	White Pine		18	Cords		
22	Balsam Fir	Pulpwood	3	Cords	7.2	\$1,503.50
	Black Spruce		33	Cords		
	N. White Cedar		33	Cords		
	Paper Birch		12	Cords		
	Red Maple		44	Cords		
	White Pine		8	Cords		
TOTAL:			4,304	Cords		

Sale Specific Conditions & Requirements

Sale Name: Nature Boy Pine

Sale Number: 41-011-20 Seq#: 2

1 - Sale Area

1.2 - Boundaries

1.2.1 - Painted boundaries (9/19)

The sale boundary and Payment Unit boundaries are marked and identified by red and yellow paint. Exterior sale boundary lines against state are marked with red paint. Interior Payment Unit boundaries are marked with yellow paint. The painted boundary line trees are not Included Timber and are to be protected unless marked with orange paint. Yellow painted trees designating an interior Payment Unit boundary are only to be cut when all surrounding Payment Units have been paid.

2 - Timber Specifications

2.1 - Included Timber

2.1.1 - Clearcut unit(s) with unmerchantable trees (6/14)

Within Payment Unit(s) 2-5 and 9, cut all trees that are two (2) inches or more at DBH, with the following exceptions:

- Within Payment Unit 4, do not cut white pine that are twenty-four (24) inches or more at DBH.
- Within Payment Unit 5, see sale specifications 7.5.1 and 99.1.

Special protection trees identified in accordance with condition 3.4.2, within clearcutting unit boundaries, are not Included Timber and are to be protected.

2.1.2 - Clearcut unit(s) w/o unmerchantable trees (8/11)

Within Payment Unit(s) 16, 17, and 19-22, cut all trees which meet minimum piece specifications in 2.2 Utilization, except do not cut hemlock or oak. Special protection trees identified in accordance with condition 3.4.2, within clearcutting unit boundaries, are not Included Timber and are to be protected.

2.1.3 - Cut tree marked unit(s) (12/08)

Within Payment Unit(s) 1, 6-8, and 10-15, all trees are designated for cutting when marked with orange paint above and below stump height, regardless of merchantability.

2.1.7 - Leave tree marked unit(s) (6/14)

Within Payment Unit(s) 18, all trees, which meet minimum piece specifications in 2.2 Utilization, are designated for cutting, except do not cut any trees marked with green paint above and below stump height.

2.2 - Utilization

2.2.3 - Stump heights (4/07)

Stump heights within the marked tree Payment Units 1, 6-8, and 10-15 shall not exceed 12 inches for trees greater than 10 inches at DBH and 4 inches for trees smaller than 10 inches at DBH. This is to facilitate future planting operations.

3 - Payments

3.3 - Pre-measured Sales

3.3.4 - Dividing payment units (7/14)

Payment Unit(s) that are \$15,000 or greater in value may be divided at the request of the Purchaser and upon approval of the Unit Manager. Dividing Payment Units is a contract modification which requires a Timber Sale Contract Amendment.

3.4 - Damaged Timber

3.4.2 - Special Protection Trees (4/14)

The Purchaser shall not cut live or dead special protection trees within cutting units or clearings. Special protection trees are hemlock and oak. If the Purchaser's operations have cut or damaged special protection trees through carelessness, the Purchaser shall pay \$100 as fixed, agreed and liquidated damages for each special protection tree cut or damaged. Such

payment does not constitute ownership of the undesignated timber.

4 - Transportation

4.1 - Construction

4.1.3 - Slash and earthen piles (8/04)

Piles or windrows of earth along roads and landings that have been widened or constructed shall be leveled. Slash from road maintenance or construction, including stumps, shall be dispersed throughout the sale.

4.1.6 - Road construction (1/09)

Construction of new roads or improvements of existing roads shall be done in such a way as to minimize the environmental and visual impacts. Merchantable trees shall be cut and utilized unless otherwise directed. Non-merchantable trees shall be severed and laid flat on the ground. Slash shall be scattered, and not left in windrows and kept a minimum of 10 feet back from the road edge. Stumps shall be set upright, not left on edge, and be moved at least 10 feet away from the road edge. Disturbed soil shall be feathered into the woods and not left in berms or windrows.

4.1.7 - Road closure (10/11)

All new roads built into the sale must be blocked to vehicle traffic upon completion of the sale. Overgrown roads that are reopened shall be considered new roads. In general, this will require constructing a four (4') foot high berm of stumps and logs covered with earth. Stumps and brush must be placed along the remainder of the trail. All stumps from road building and landing construction must be reserved to block any newly constructed roads upon completion of the sale. These stumps must be scattered along the road system to prohibit vehicular movement. Contact the Sale Administrator for specific details of design and placement.

4.1.8 - Road work (1) (8/07)

The following road work is required: 400 cubic yards of breaker run gravel must be purchased, hauled and spread between the Fox River Road and the Stanley Lake Bridge. All work is at the Purchaser's expense and must be placed before hauling can begin. If the sale is accessed from the Taylor Dam Road, the breaker run gravel will be placed on Trail 43 between the sale and Taylor Dam Road.

4.1.10 - Oversight (12/08)

The Unit Manager, or his/her representative, must be present when the road improvement project is initiated.

4.2 - Maintenance

4.2.2 - Fill material (4/07)

To maintain roads, fill material may be needed in areas where "holes" exist or may be expected to develop. This fill material should be placed before trucking begins.

4.2.4 - Grading (10/16)

For completion of the sale, state forest roads must be graded. In general, this will require a road grader or bulldozer to shape up the roads after forest products have been hauled off site. This includes cleaning of drainage areas, grading, crowning, and filling with gravel, if necessary. The grading equipment to be used must be approved by the Unit Manager or his/her representative.

5 - Operations

5.2 - Conduct of Operations

5.2.2 - Hazard Trees/Snags

5.2.2.1 - Den trees (10/16)

Obvious hollow and/or den trees shall be protected and left standing unless they are a safety hazard.

5.2.3 - Operating Restrictions

5.2.3.6 - Bark beetle restriction (12/08)

In the event drought creates a high risk of pine bark beetle infestation, pine is not to be cut during the period March 1 through July 1, unless all portions of trees greater than two inches in diameter are removed from the sale area, reduced to chips, or treated to the satisfaction of the Unit Manager or his/her representative, within fifteen days of being severed

from the stump. Pine log decks, pulpwood piles and treetops that are piled for chipping in the fall or winter within a 1/4 mile of susceptible sites must be removed before March 15. Residual slash must not be placed in piles or rows and must be spread over the site for quick drying. The Department of Natural Resources will exercise this specification if the risk of damage warrants.

5.2.22 - Operating Caution

5.2.22.1 - Operating caution (6/11)

It is recommended, but not required, that within Payment Unit(s) 16, 17, 19, and 20-22, cutting, skidding, and hauling occur during dry summer or frozen winter conditions. The reason for the recommendation is because of soft soils.

5.2.32 - Decking/landing restoration (9/13)

All decking and landing areas must have the surface area restored to a condition equal to or better than before. This is to ensure the proper regeneration of the stand. Wood debris, chips, and "cookies" from trimmings must be removed or scattered away from landing and loading areas and may not be windrowed on the edge.

5.2.38 - No decking against live trees (2/04)

Cut products may not be decked against unmarked or designated leave trees.

5.2.40 - Pathway protection (10/10)

The Fox River Pathway is a non-motorized trail and is shown on the Timber Sale Map. Do not cut trees or damage posts with blue pathway markers. Maintain a 20-foot-wide slash, debris, and rut free zone daily, using the pathway as the centerline. Do not run equipment down the pathway. Skidding across the trail may occur, but will need to be cleared of all debris upon completion of the Payment Unit.

5.2.41 - Snowmobile trail protection (9/11)

Trail 43 is a snowmobile trail and is shown on the Timber Sale Map. Do not cut or damage posts with orange trail markers or traffic control signs. If the trail is used for hauling, it must be graded to the satisfaction of the Unit Manager or his/her representative prior to December 1. The snowmobile trail may not be used for any timber sale operations from December 1 to March 31 unless approved by the Unit Manager. Maintain a 20-foot-wide slash, debris, and rut free zone daily using the snowmobile trail as the centerline. All stumps within 20 feet of the snowmobile trail must be cut at ground level.

5.8 - Protection of Endangered Species

5.8.3 - Red shoulder hawk or goshawk (1) (2/16)

In the event that an active red shoulder hawk or goshawk nest is found, the contract may be amended to protect the nest site until the nest is determined to be inactive. The value of the trees in this excluded area will be refunded or credited to the Purchaser. The nest will be buffered with a five-chain radius (eight acre) protection area, centered on the nest tree, in which there will be no cutting or new roads constructed. Avoid human disturbance, including loading and skidding, in the protection area.

An additional zone of five chains (ten chains centered on the active nest tree) will be established in which there is no management activity from April 1 to July 30. Limit biomass harvesting and chipping operations within this ten-chain zone, retain the maximum one-third of residues per the Woody Biomass Harvesting Guidelines (Michigan DNR 2010). Nests determined to be inactive will be protected with a one-chain no-harvest buffer.

6 - Safety and Fire Prevention

6.2 - Signing

6.2.3 - Recreational trail posting (10/20)

The Purchaser is responsible for posting and maintaining caution signs on Fox River Pathway prior to beginning operations. The trail must be posted at appropriate distances from the Sale Area to warn of logging activity and truck traffic at both ends of the trail. Signs must be removed when harvest operations are suspended or completed. The Purchaser will provide these signs.

7 - Other Conditions

7.5 - Loss

7.5.1 - Deteriorating timber (7/09)

The sale area has received damage from wildfire within Payment Unit 5. The Purchaser should harvest the wood as soon as possible. The Department of Natural Resources is held free of responsibility of any further damage or deterioration due to delay in harvesting.

99 - Unique

SKIP

99.1 - Unique Sale Condition (5/19)

Payment Unit 5 is an optional Payment Unit and does not need to be harvested for the execution of the contract. If the Purchaser chooses to harvest Payment Unit 5, they shall pay awarded price for the Payment Unit.



TIMBER SALE MAP

This information provided by authority of Part 5, 1994 PA 451, as amended.

Sale Number	Year
41-011	20

Forest Management Unit	County	Mapped By	Date	Page	of
Shingleton	Schodcraft	DNR Staff	8/26/20	1	2
Compartiment Number	Township	Range	Section(s) and Subdivision(s)		
143	47N	15W	1, 12, 11		

Cover Type				Density	
A = Aspen	J = Jack Pine	O = Oak	U = Upland Brush	0 = Non Stocked	5 = Pole Timber Medium
B = Paper Birch	K = Rock	P = Lowland Poplar	UM = Upland Mix Forest	1 = Seedling Sapling Poor	6 = Pole Timber Well
C = Cedar	L = Lowland Brush	Q = Mixed Swamp Conifer	V = Bog or Marsh	2 = Seedling Sapling Medium	7 = Saw Timber Poor
D = Treed Bog	LM = Lowland Mix Forest	R = Red Pine	W = White Pine	3 = Seedling Sapling Well	8 = Saw Timber Medium
E = Swamp Hardwoods	M = Maple, Beech, Birch	S = Black Spruce	X = Non Stocked	4 = Pole Timber Poor	9 = Saw Timber Well
F = Spruce/Fir	MC = Mixed Conifer	T = Tamarack	Y = Sand		
G = Grass	MD = Mixed Deciduous		Z = Water		
H = Hemlock	N = Marsh				

Nature Boy
Pine
442.9 acres

Unit	Acres
1	17.1
2	10
3	13.1
4	27.3
5	6.9
6	46.3
7	31.1
8	23.8
9	0.8
10	24.8
11	31.7
12	38.8
13	30.6
14	47.6
15	48.2
16	10.8
17	4.9
18	1.7
19	3.9
20	4.7
21	11.6
22	7.2

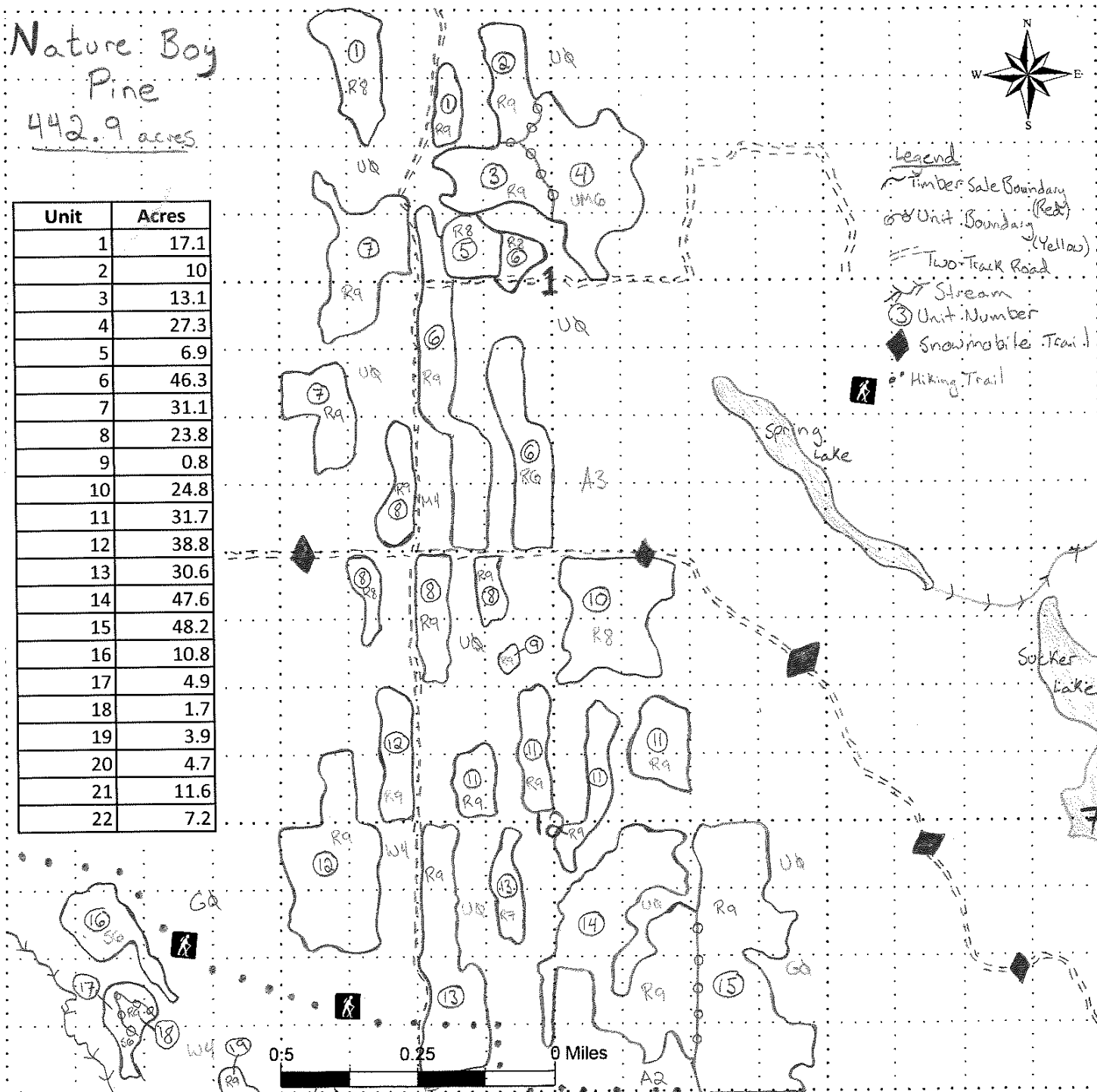



TIMBER SALE MAP

This information provided by authority of Part 5, 1994 PA 451, as amended.

Sale Number	Year
41-011	20

Forest Management Unit Shingleton	County Schoolcraft	Mapped By DNR Staff	Date 8/26/20	Page 2	of 2
Compartment Number 143	Township 47 N	Range 15 W	Section(s) and Subdivision(s) 12, 11, 13		

Cover Type				Density	
A = Aspen	J = Jack Pine	O = Oak	U = Upland Brush	0 = Non Stocked	5 = Pole Timber Medium
B = Paper Birch	K = Rock	P = Lowland Poplar	UM = Upland Mix Forest	1 = Seedling Sapling Poor	6 = Pole Timber Well
C = Cedar	L = Lowland Brush	Q = Mixed Swamp Conifer	V = Bog or Marsh	2 = Seedling Sapling Medium	7 = Saw Timber Poor
D = Treed Bog	LM = Lowland Mix Forest	R = Red Pine	W = White Pine	3 = Seedling Sapling Well	8 = Saw Timber Medium
E = Swamp Hardwoods	M = Maple, Beech, Birch	S = Black Spruce	X = Non Stocked	4 = Pole Timber Poor	9 = Saw Timber Well
F = Spruce/Fir	MC = Mixed Conifer	T = Tamarack	Y = Sand		
G = Grass	MD = Mixed Deciduous		Z = Water		
H = Hemlock	N = Marsh				

