



**DEPARTMENT OF NATURAL RESOURCES
STATE OF MICHIGAN
TIMBER SALE PROSPECTUS #7487**

SCHEDULED SALE DATE AND TIME: **10:00 a.m. (local time) on October 7, 2024.**

LOCATION: **SE REGION-WILD, 3580 STATE PARK DRIVE, BAY CITY, MI 48706.**

CONTACT NAME: Don Bonnette

PHONE NUMBER: (989) 385-5616

PROSPECTUS NOTE: The bidder is advised to inspect the sale area and review the location, estimated volumes, operating costs and contract terms of proposed sales. Please be aware that some landowners may request 60 days or more notice for access across their land.

Notice is hereby given that bids will be received by the Game Area Manager, CASS CITY FIELD OFFICE, for certain timber on the following described lands:

Tucker Lake Aspen (55-147-24) / T12N, R08E, SEC. 25, NE, N1/2SE, SESE.

Tuscola County, Advertised Price \$43,148.60, 57.1 Acres, Aspen, Hardwood.

SALE NOTE: Access may be through other public land.

TIMBER SALE INFORMATION

Tucker Lake Aspen (55-147-24)

T12N, R08E, SEC. 25.

Tuscola County (Advertised Price \$43,148.60)

SALE NOTE: Access may be through other public land.

A timber sale contract for this lump sum, sealed bid timber sale will be awarded to the responsible bidder offering the highest sealed bid price. All units of volume listed below were estimated using the Inventory Manager computer program and the new Michigan taper model. Bids must be at or above the following advertised price for each product and species:

<u>PRODUCTS & SPECIES</u>	<u>ESTIMATED UNITS*</u>	<u>ADVERTISED PRICE</u>
Sawtimber		
Black Cherry	40.9 MBF	\$ 68.00 / MBF
Green Ash	5.9 MBF	\$ 23.00 / MBF
Mixed Aspen	586.5 MBF	\$ 38.00 / MBF
Red Maple	75.4 MBF	\$ 45.00 / MBF
Sugar Maple	2.8 MBF	\$ 71.00 / MBF
Pulpwood		
Jack Pine	6 Cords	\$ 9.40 / Cord
Mixed Aspen	826 Cords	\$ 11.25 / Cord
Mixed Hardwood	417 Cords	\$ 12.00 / Cord

* The total volume is statistically estimated within plus (+) or minus (-) 34.11 percent. There are an estimated 2,914 cords on this timber sale, plus or minus 994 cords at the 95% confidence level. The estimated units are final and not subject to adjustment. Prospective bidders are urged to examine this timber and to make their own estimates of quantity and quality.

BOND AND PAYMENT SCHEDULE:

1. A bond in the amount of \$2,157.43 to insure faithful performance of the conditions of the contract will be deposited by the successful bidder within 21 days of the sale award.
2. Cutting in any sale or unit without the required advance payment would be considered a trespass.
3. Total payment must be paid in advance or according to the following schedule :
 - (a) Ten percent (10%) of the sale value must be paid within 21 days of the sale award.
 - (b) The 10% down payment will be credited towards the first unit cut.
 - (c) Payment for each of the following units must be made before cutting begins in that unit:

PAYMENT UNIT NUMBER	PERCENT OF TOTAL SALE VALUE
01	30.1%
02	39.6%
03	30.3%
4. If no cutting takes place, the 10% down payment will not be refunded.
5. Operations on the contract issued will terminate on 04/01/2026.

SALE STATISTICS

Volumes were calculated in cubic feet using the Michigan taper model. Cubic foot volume includes all wood inside bark for the product indicated. For display purposes, cubic feet were converted to cords and MBF using a simple conversion factor, e.g. 79 cubic feet per cord and 185 cubic feet per MBF. The cubic foot volumes are precise; the cords and MBF volumes are not. Cubic foot volume cannot be directly converted to cords or boards with precision.

SALE VOLUMES

The total estimated sale volume may not equal the sum of the species/products due to the nature of statistical calculations associated with double sampling methodology.

VOLUME		STATISTICAL RANGE IN CORDS		
TOTAL CUBIC FEET	TOTAL CORDS	PERCENT ERROR	MINIMUM	MAXIMUM
230,198	2,914	34.11%	1,920	3,908

VDU VOLUMES

A VDU is a Volume Determination Unit. Volumes and their associated statistics are calculated at the VDU level and summarized to the sale level. There is often a one to one relationship between a VDU and a Payment Unit, but not always, depending on the cruise design. Refer to the VDU TO PAYMENT UNIT table.

VDU	VOLUME		PERCENT ERROR	RANGE IN CORDS	
	TOTAL CUBIC FEET	TOTAL CORDS		MINIMUM	MAXIMUM
5	69,765	883	34.19%	581	1,185
13	90,487	1,145	25.87%	849	1,442
15	67,087	849	35.81%	545	1,153
16	2,859	36	109.49%	0	76
TOTAL:	230,198	2,914		1,975	3,856

VDU TO PAYMENT UNIT

When a VDU is associated with more than one Payment Unit (PU), the VDU volumes are assigned to the PU based on acres of the VDU within the PU.

VDU	VDU ACRES	PU	PU ACRES
5	19.8	1	19.8
13	18.4	2	18.4
15	17.3	3	17.3
16	1.6	3	1.6
TOTAL:	57.1		57.1

DESCRIPTION OF TIMBER BY PU (PU)

PU	MARKET GROUP	PRODUCT	QUANTITY	UNIT	ACRES	ADVERTISE PRICE	
1	Black Cherry	Sawtimber	14.5	MBF	19.8	\$12,988.90	
	Green Ash		0.8	MBF			
	Mixed Aspen		161.0	MBF			
	<i>B. T. Aspen</i>		161.0	<i>MBF</i>			
	Red Maple		22.8	MBF			
	Mixed Aspen		Pulpwood	218			Cords
	<i>B. T. Aspen</i>			218			<i>Cords</i>
	Mixed Hardwood			199			Cords
	<i>Black Cherry</i>			86			<i>Cords</i>
	<i>Green Ash</i>			4			<i>Cords</i>
	<i>Paper Birch</i>			3			<i>Cords</i>
	<i>Red Maple</i>			106			<i>Cords</i>
2	Black Cherry	Sawtimber	14.4	MBF	18.4	\$17,107.05	
	Green Ash		5.1	MBF			
	Mixed Aspen		234.5	MBF			
	<i>B. T. Aspen</i>		234.5	<i>MBF</i>			
	Red Maple		34.9	MBF			
	Sugar Maple		2.8	MBF			
	Mixed Aspen		Pulpwood	301			Cords
	<i>B. T. Aspen</i>			301			<i>Cords</i>
	Mixed Hardwood			162			Cords
	<i>Basswood</i>			7			<i>Cords</i>
	<i>Black Cherry</i>			22			<i>Cords</i>
	<i>Green Ash</i>			13			<i>Cords</i>
	<i>Red Maple</i>			106			<i>Cords</i>
	<i>Sugar Maple</i>			14			<i>Cords</i>
3	Black Cherry	Sawtimber	12.0	MBF	18.9	\$13,052.65	
	Mixed Aspen		191.0	MBF			
	<i>B. T. Aspen</i>		167.5	<i>MBF</i>			
	<i>Cottonwood</i>		13.7	<i>MBF</i>			
	<i>Quaking Aspen</i>		9.8	<i>MBF</i>			
	Red Maple		17.7	MBF			
	Jack Pine		Pulpwood	6			Cords
	Mixed Aspen			307			Cords
	<i>B. T. Aspen</i>			275			<i>Cords</i>
	<i>Cottonwood</i>			17			<i>Cords</i>
	<i>Quaking Aspen</i>			15			<i>Cords</i>
	Mixed Hardwood			56			Cords
	<i>Black Cherry</i>			11			<i>Cords</i>
	<i>Paper Birch</i>			3			<i>Cords</i>
	<i>Red Maple</i>			42			<i>Cords</i>
TOTAL:			711.5	MBF			
TOTAL:			1,249	Cords			

Sale Specific Conditions & Requirements

Sale Name: Tucker Lake Aspen

Sale Number: 55-147-24 Seq#: 1

1 - Sale Area

1.2 - Boundaries

1.2.1 - Painted boundaries (9/19)

The sale boundary and Payment Unit boundaries are marked and identified by red and blue paint. Exterior sale boundary lines against private property are marked with blue paint. Exterior sale boundary lines against state are marked with red paint. The painted boundary line trees are not Included Timber and are to be protected.

2 - Timber Specifications

2.1 - Included Timber

2.1.1 - Clearcut unit(s) with unmerchantable trees (6/14)

Within Payment Unit(s) 1-3, cut all trees that are two (2) inches or more at DBH, with the following exceptions:

- Do not cut any oak, hemlock, white pine, beech, or cedar trees.
- Do not cut any trees marked with green paint.

Special protection trees identified in accordance with condition 3.4.2, within clearcutting unit boundaries, are not Included Timber and are to be protected.

2.2 - Utilization

2.2.3 - Stump heights (4/07)

Stump heights within the Sale Area shall not exceed 12 inches for trees greater than 10 inches DBH and 4 inches for trees smaller than 10 inches DBH.

2.2.5 - Limbed tree skidding (1/09)

The skidding of whole trees or tree segments with limbs attached is prohibited.

3 - Payments

3.4 - Damaged Timber

3.4.2 - Special Protection Trees (4/14)

The Purchaser shall not cut live or dead special protection trees within cutting units or clearings. Special protection trees are oak, hemlock, cedar, white pine and beech. If the Purchaser's operations have cut or damaged special protection trees through carelessness, the Purchaser shall pay \$200 as fixed, agreed and liquidated damages for each special protection tree cut or damaged. Such payment does not constitute ownership of the undesignated timber.

3.6 - Payment Unit Cutting Schedule

3.6.2 - One active unit (12/08)

Each Payment Unit must be completed to the satisfaction of the Unit Manager or his/her representative before the next unit may be opened.

4 - Transportation

4.1 - Construction

4.1.3 - Slash and earthen piles (8/04)

Piles or windrows of earth along roads and landings that have been widened or constructed shall be leveled. Slash from road maintenance or construction, including stumps, shall be dispersed throughout the sale.

4.1.6 - Road construction (1/09)

Construction of new roads or improvements of existing roads shall be done in such a way as to minimize the environmental and visual impacts. Merchantable trees shall be cut and utilized unless otherwise directed. Non-merchantable trees shall be

severed and laid flat on the ground. Slash shall be scattered, and not left in windrows and kept a minimum of 10 feet back from the road edge. Stumps shall be set upright, not left on edge, and be moved at least 10 feet away from the road edge. Disturbed soil shall be feathered into the woods and not left in berms or windrows.

4.1.7 - Road closure (10/11)

Any roads into the sale must be blocked to vehicle traffic upon completion of the sale. All stumps from road building and landing construction must be reserved to block any newly constructed roads upon completion of the sale. These stumps must be scattered along the road system to prohibit vehicular movement. Temporary berms may be required if no sale activity occurs for 30 or more consecutive days. Contact the Sale Administrator for specific details of design and placement.

4.2 - Maintenance

4.2.4 - Grading (10/16)

For completion of the sale, temporary skid trails and roads must be graded. In general, this will require a road grader or bulldozer to shape up skid trails and/or roads after forest products have been hauled off site. This includes cleaning of drainage areas, grading, crowning and filling with gravel, if necessary. The grading equipment to be used must be approved by the Unit Manager or his/her representative.

4.4 - Access

4.4.3 - Access gate (12/08)

The access gate to Payment Unit 2 must be locked at all times. This is to prevent unauthorized access and to prevent someone other than the Purchaser from going through the gate and being locked in.

5 - Operations

5.1 - Notification

5.1.1 - Pre-sale conference (10/16)

A pre-sale conference between the Purchaser and sale administrator is required prior to beginning any operations to determine landing and road locations.

5.1.4 - Post-sale conference (10/16)

A post-sale conference on site between the Purchaser and sale administrator is required prior to the completion of active logging operations to determine clean-up and repair of landings, road edges, and the fulfillment of other contract specifications.

5.2 - Conduct of Operations

5.2.1 - Slash

5.2.1.8 - Slash height (12/08)

No slash or tree tops may exceed 24 inches in height.

5.2.1.10 - No slash in openings (5/10)

No brush or logging debris is to be left in the maintained wildlife opening which is indicated by G0 or U0 on the Timber Sale Map. Any damage to the opening shall be repaired according to specifications of the Unit Manager or his/her representative.

5.2.2 - Hazard Trees/Snags

5.2.2.1 - Den trees (10/16)

Obvious hollow and/or den trees shall be protected and left standing unless they are a safety hazard. This includes all standing dead timber within the Sale Area.

5.2.3 - Operating Restrictions

5.2.3.1 - Operating restrictions (9/11)

Within Payment Unit(s) 1-3, unless changed by written agreement, cutting, skidding, and hauling are not permitted during the period of March 10 to September 1 and is limited to dry or frozen ground conditions at any other time. The Sale Administrator will determine what constitutes dry or frozen ground conditions. This restriction is necessary to minimize disturbance to nesting and breeding wildlife and reduce the risk of rutting on sensitive soils.

5.2.3.2 - Operating restrictions (9/11)

Within Payment Unit(s) 1-3, operating feller bunchers before 7 AM and after 9 PM is prohibited. This restriction is due to the close proximity of residences to the Sale Area.

5.2.3.11 - Coppice regeneration protection (4/10)

Timber harvesting in any Payment Unit must be completed before significant aspen sprouting occurs in that Payment Unit so as to minimize damage to the new regeneration.

5.2.3.12 - Hunting operating restriction (1/18)

No Payment Unit may be started during the period of September 25 through October 5 or November 1 through November 30 without permission of the Unit Manager or his/her representative.

5.2.31 - Landing locations (9/13)

Landing locations will be determined in the pre-sale meeting. Landings must be confined to these agreed upon designated sites unless otherwise authorized by the Unit Manager or his/her representative. In general, landings are limited to a "T" turnaround which will accommodate a truck with a 50-foot trailer and should be no larger than absolutely necessary.

5.2.32 - Decking/landing restoration (9/13)

All decking and landing areas must have the surface area restored to a condition equal to or better than before. This is to ensure the proper regeneration of the stand. Wood debris, chips and "cookies" from trimmings must be removed or scattered away from landing and loading areas and may not be windrowed on the edge.

5.2.37 - No decking areas (12/08)

No decking is allowed in any parking area. Equipment storage is not allowed in any parking area.

5.2.38 - No decking against live trees (2/04)

Cut products may not be decked against unmarked or designated leave trees.

5.3 - Stream Protection

5.3.2 - Parking equipment near water (10/23)

Within Payment Unit(s) 1-3, the parking of or storage of equipment is prohibited within 100 feet of water bodies or ground water supplies. All equipment, when not in use for harvest operations, must be parked a minimum of 100 feet away from water sources (streams, rivers, lakes, ponds, vernal pools, ground water sources) and 50 feet away from slopes leading to water sources and/or riparian areas. This restriction is for preventing unforeseen oil and/or fluid leaks from contaminating water bodies and/or ground water supplies.

5.4 - Soil Protection

5.4.1 - Rutting restriction, general (7/16)

Operations are to cease immediately if equipment and weather conditions result in rutting of the Sale Area, roads and skid trails which is 12 inches or greater in depth and 50 feet in length. The Unit Manager or his/her representative may restrict hauling and/or skidding if ruts exceed the specified depth. With the Unit Manager or his/her representative's approval, the Purchaser may return to the area when the risk of rutting has decreased.

5.4.2 - Skid trails (2/04)

Skid trails up and down slopes should be avoided. If however this is unavoidable, these trails will be left in a non-erodible condition using water bars, logs, and slash. Placing of slash on these skid trails while logging is ongoing may alleviate need for any further action. At the direction of the sale administrator, seed, fertilizer, and mulch may also be required.

5.4.3 - Erosion control (12/08)

Skid trails or haul roads may require erosion control structures or berms per direction of the Unit Manager or his/her representative.

5.4.4 - Slope protection (9/19)

Skid trails and roads on slopes shall be water barred with slash, stumps, and/or clean straw bales native to the area as soon as use is complete to prevent erosion.

5.7 - Protection of Historical Sites

5.7.2 - Potential historical site(s) (9/06)

The State Historic Preservation Office has identified the potential for a historic site within the boundary of this timber sale. Note that if the site is discovered during operations, General Condition and Requirement 5.7 - Protection of Historical Sites will apply.

6 - Safety and Fire Prevention

6.2 - Signing

6.2.1 - Road posting (10/20)

The Purchaser is responsible for posting and maintaining caution signs on Washburn Road prior to beginning operations. The road must be posted at appropriate distances from the Sale Area to warn of logging activity and truck traffic. Signs must be removed when harvest operations are suspended or completed. The Purchaser will provide these signs.

7 - Other Conditions

7.10 - Certified Timber

7.10.1 - Non-certified timber (2/16)

The area encompassed by this timber sale is not certified to the standards of the Forest Stewardship Council (FSC) or the Sustainable Forestry Initiative (SFI). Forest products from this sale may not be delivered to the mill as "FSC and / or SFI certified". The lands within this sale are managed as a State Game Area.



TIMBER SALE MAP

This information provided by authority of Part 525, 1994 PA 451, as amended.

Sale Number
55-147-24

Date
04/04/2024

Forest Management Unit Cass City Field Office	County Tuscola	Mapped By: Bonnette
		Cruised By: Bonnette

Scale 1:10,000	Page 1	Of 1
-------------------	-----------	---------

Township 12N	Range 08E	Section(s) and Subdivision(s) Sec. 25 NE,N1/2SE,SESE;
-----------------	--------------	--

Cover Type

A = Aspen	J = Jack Pine	O = Oak	U = Upland Brush
B = Paper Birch	K = Rock	P = Lowland Poplar	UM = Upland Mix Forest
C = Cedar	L = Lowland Brush	Q = Mixed Swamp Conifer	V = Bog or Marsh
D = Treed Bog	LM = Lowland Mix Forest	R = Red Pine	W = White Pine
E = Swamp Hardwoods	M = Maple, Beech, Birch	S = Black Spruce	X = Non Stocked
F = Spruce/Fir	MC = Mixed Conifer	T = Tamarack	Y = Sand
G = Grass	MD = Mixed Deciduous		Z = Water
H = Hemlock	N = Marsh		

Density

0 = Non Stocked	5 = Pole Timber Medium
1 = Seedling Sapling Poor	6 = Pole Timber Well
2 = Seedling Sapling Medium	7 = Saw Timber Poor
3 = Seedling Sapling Well	8 = Saw Timber Medium
4 = Pole Timber Poor	9 = Saw Timber Well

PU 1 19.8 Acres
 PU 2 18.4 Acres
 PU 3 18.9 Acres

Tucker Lake Aspen
 57.1 Acres

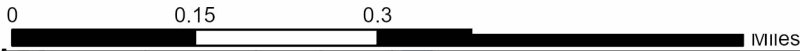

Use QR Code to open Map in App

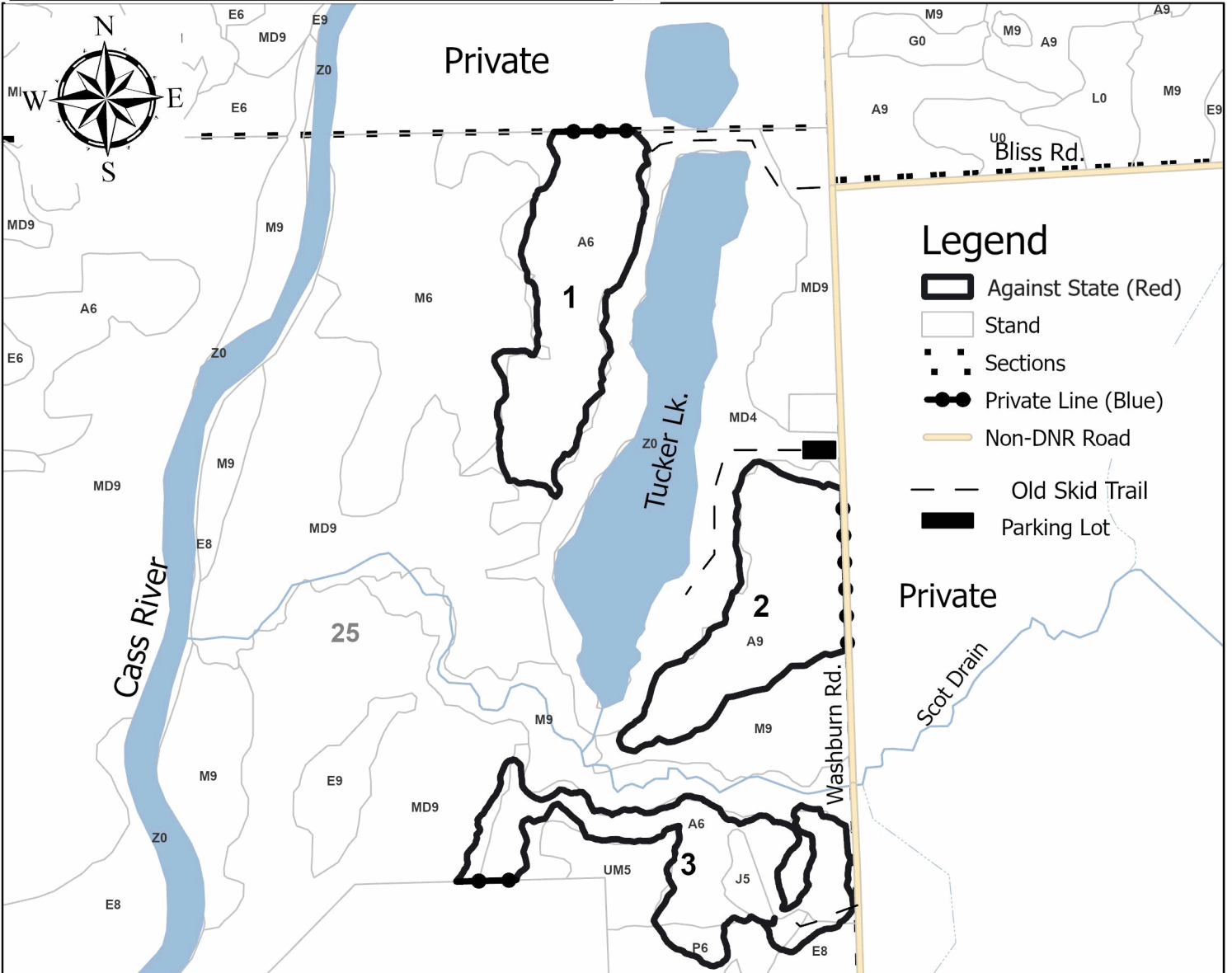

Legend

- Against State (Red)
- Stand
- Sections
- Private Line (Blue)
- Non-DNR Road
- Old Skid Trail
- Parking Lot