



**DEPARTMENT OF NATURAL RESOURCES
STATE OF MICHIGAN
TIMBER SALE PROSPECTUS #7459**

SCHEDULED SALE DATE AND TIME: **9:00 a.m. (local time) on July 9, 2024.**

LOCATION: **GAYLORD MGMT UNIT, 1732 WEST M 32, GAYLORD, MI 49735.**

CONTACT NAME: Lucas Merrick

PHONE NUMBER: (989) 732-3541

PROSPECTUS NOTE: The bidder is advised to inspect the sale area and review the location, estimated volumes, operating costs and contract terms of proposed sales. Please be aware that some landowners may request 60 days or more notice for access across their land.

Notice is hereby given that bids will be received by the Unit Manager, GAYLORD MANAGEMENT UNIT, for certain timber on the following described lands:

Way Back There Mix (52-122-23) / T38N, R04W, SEC. 17, S1/2NW,N1/2SW,NWSE.
T38N, R04W, SEC. 18, NE,N1/2SE.

Emmet County, Advertised Price \$42,101.45, 151.5 Acres, Aspen, Hardwood.

SALE NOTE: Payment Unit 1 includes some large DBH, over-mature aspen. Drier ground in center portion of the Payment Unit, wetter ground along east side of Payment Unit. Payment Unit 2 has a high volume of red maple sawlog and pulpwood. Two wet areas in the western portion of the Payment Unit. Payment Unit 3 has a high volume of red maple and cedar with some individual tree blowdown. Recommend summer or winter harvest.

TIMBER SALE INFORMATION

Way Back There Mix (52-122-23)
T38N, R04W, SEC. 17; T38N, R04W, SEC. 18.
Emmet County (Advertised Price \$42,101.45)

SALE NOTE: Payment Unit 1 includes some large DBH, over-mature aspen. Drier ground in center portion of the Payment Unit, wetter ground along east side of Payment Unit. Payment Unit 2 has a high volume of red maple sawlog and pulpwood. Two wet areas in the western portion of the Payment Unit. Payment Unit 3 has a high volume of red maple and cedar with some individual tree blowdown. Recommend summer or winter harvest.

A timber sale contract for this lump sum, sealed bid timber sale will be awarded to the responsible bidder offering the highest sealed bid price. All units of volume listed below were estimated using the Inventory Manager computer program and the new Michigan taper model. Bids must be at or above the following advertised price for each product and species:

<u>PRODUCTS & SPECIES</u>	<u>ESTIMATED UNITS*</u>	<u>ADVERTISED PRICE</u>
Sawtimber		
Paper Birch	6.1 MBF	\$ 18.00 / MBF
Red Maple	116.0 MBF	\$ 76.00 / MBF
Pulpwood		
Balsam Fir	296 Cords	\$ 5.90 / Cord
Mixed Aspen	1,217 Cords	\$ 8.50 / Cord
Mixed Hardwood	1,387 Cords	\$ 9.05 / Cord
N. White Cedar	764 Cords	\$ 5.40 / Cord
Paper Birch	324 Cords	\$ 4.70 / Cord
White Spruce	515 Cords	\$ 5.60 / Cord

* The total volume is statistically estimated within plus (+) or minus (-) 9.81 percent. There are an estimated 4,888 cords on this timber sale, plus or minus 480 cords at the 95% confidence level. The estimated units are final and not subject to adjustment. Prospective bidders are urged to examine this timber and to make their own estimates of quantity and quality.

BOND AND PAYMENT SCHEDULE:

1. A bond in the amount of \$4,210.15 to insure faithful performance of the conditions of the contract will be deposited by the successful bidder within 21 days of the sale award.
2. Cutting in any sale or unit without the required advance payment would be considered a trespass.
3. Total payment must be paid in advance or according to the following schedule :
 - (a) Ten percent (10%) of the sale value must be paid within 21 days of the sale award.
 - (b) The 10% down payment will be credited towards the first unit cut.
 - (c) Payment for each of the following units must be made before cutting begins in that unit:

PAYMENT UNIT NUMBER	PERCENT OF TOTAL SALE VALUE
01	31.0%
02	44.8%
03	24.2%
4. If no cutting takes place, the 10% down payment will not be refunded.
5. Operations on the contract issued will terminate on 12/31/2028.

SALE STATISTICS

Volumes were calculated in cubic feet using the Michigan taper model. Cubic foot volume includes all wood inside bark for the product indicated. For display purposes, cubic feet were converted to cords and MBF using a simple conversion factor, e.g. 79 cubic feet per cord and 185 cubic feet per MBF. The cubic foot volumes are precise; the cords and MBF volumes are not. Cubic foot volume cannot be directly converted to cords or boards with precision.

SALE VOLUMES

The total estimated sale volume may not equal the sum of the species/products due to the nature of statistical calculations associated with double sampling methodology.

VOLUME		PERCENT ERROR	STATISTICAL RANGE IN CORDS	
TOTAL CUBIC FEET	TOTAL CORDS		MINIMUM	MAXIMUM
386,179	4,888	9.81%	4,409	5,368

VDU VOLUMES

A VDU is a Volume Determination Unit. Volumes and their associated statistics are calculated at the VDU level and summarized to the sale level. There is often a one to one relationship between a VDU and a Payment Unit, but not always, depending on the cruise design. Refer to the VDU TO PAYMENT UNIT table.

VDU	VOLUME		PERCENT ERROR	RANGE IN CORDS	
	TOTAL CUBIC FEET	TOTAL CORDS		MINIMUM	MAXIMUM
25	138,457	1,753	14.88%	1,492	2,013
36	152,409	1,929	18.61%	1,570	2,288
38	95,313	1,206	17.79%	992	1,421
TOTAL:	386,179	4,888		4,054	5,723

VDU TO PAYMENT UNIT

When a VDU is associated with more than one Payment Unit (PU), the VDU volumes are assigned to the PU based on acres of the VDU within the PU.

VDU	VDU ACRES	PU	PU ACRES
25	50.4	1	50.4
36	63.9	2	63.9
38	37.2	3	37.2
TOTAL:	151.5		151.5

DESCRIPTION OF TIMBER BY PU (PU)

PU	MARKET GROUP	PRODUCT	QUANTITY	UNIT	ACRES	ADVERTISE PRICE
1	Balsam Fir	Pulpwood	120	Cords	50.4	\$13,055.80
	Mixed Aspen		934	Cords		
	<i>B. T. Aspen</i>		60	<i>Cords</i>		
	<i>Balsam Poplar</i>		53	<i>Cords</i>		
	<i>Quaking Aspen</i>		821	<i>Cords</i>		
	Mixed Hardwood		156	Cords		
	<i>Red Maple</i>		149	<i>Cords</i>		
	<i>White Ash</i>		7	<i>Cords</i>		
	N. White Cedar		331	Cords		
	White Spruce		216	Cords		
2	Paper Birch	Sawtimber	6.1	MBF	63.9	\$18,858.75
	Red Maple	Pulpwood	79.9	MBF		
	Balsam Fir		123	Cords		
	Mixed Aspen		188	Cords		
	<i>B. T. Aspen</i>		79	<i>Cords</i>		
	<i>Quaking Aspen</i>		109	<i>Cords</i>		
	Mixed Hardwood		879	Cords		
	<i>Red Maple</i>		810	<i>Cords</i>		
	<i>Sugar Maple</i>		69	<i>Cords</i>		
	N. White Cedar		180	Cords		
	Paper Birch		133	Cords		
	White Spruce		143	Cords		
3	Red Maple		Sawtimber	36.1	MBF	37.2
	Balsam Fir	Pulpwood	53	Cords		
	Mixed Aspen		95	Cords		
	<i>Quaking Aspen</i>		95	<i>Cords</i>		
	Mixed Hardwood		352	Cords		
	<i>Red Maple</i>		318	<i>Cords</i>		
	<i>White Ash</i>		34	<i>Cords</i>		
	N. White Cedar		253	Cords		
	Paper Birch		191	Cords		
	White Spruce		156	Cords		
TOTAL:			122.1	MBF		
TOTAL:			4,503	Cords		

Sale Specific Conditions & Requirements

Sale Name: Way Back There Mix

Sale Number: 52-122-23 Seq#: 3

1 - Sale Area

1.2 - Boundaries

1.2.1 - Painted boundaries (9/19)

The sale boundary and Payment Unit boundaries are marked and identified by blue, red and yellow paint. Exterior sale boundary lines against private property are marked with blue paint. Exterior sale boundary lines against state are marked with red paint. Interior Payment Unit boundaries are marked with yellow paint. Retention patches are marked with red paint; no harvesting activities may occur within these areas.

2 - Timber Specifications

2.1 - Included Timber

2.1.2 - Clearcut unit(s) w/o unmerchantable trees (8/11)

Within Payment Unit(s) 1-3, cut all trees which meet minimum piece specifications in 2.2 Utilization, with the following exceptions:

- Within Payment Units 1 & 3, do not cut hemlock or white pine.
- Within Payment Unit 2, do not cut any white pine that are twenty-two (22) inches or more at DBH or hemlock.

4 - Transportation

4.1 - Construction

4.1.3 - Slash and earthen piles (8/04)

Piles or windrows of earth along roads and landings that have been widened or constructed shall be leveled. Slash from road maintenance or construction, including stumps, shall be dispersed throughout the sale.

4.1.6 - Road construction (1/09)

Construction of new roads or improvements of existing roads shall be done in such a way as to minimize the environmental and visual impacts. Merchantable trees shall be cut and utilized unless otherwise directed. Non-merchantable trees shall be severed and laid flat on the ground. Slash shall be scattered, and not left in windrows and kept a minimum of 10 feet back from the road edge. Stumps shall be set upright, not left on edge, and be moved at least 10 feet away from the road edge. Disturbed soil shall be feathered into the woods and not left in berms or windrows.

4.1.7 - Road closure (10/11)

All new roads built into the sale must be blocked to vehicle traffic upon completion of the sale. In general, this will require constructing a four (4') foot high berm of stumps and logs covered with earth. All stumps from road building and landing construction must be reserved to block any newly constructed roads upon completion of the sale. These stumps must be scattered along the road system to prohibit vehicular movement. Contact the Sale Administrator for specific details of design and placement.

4.2 - Maintenance

4.2.4 - Grading (10/16)

For completion of the sale, state forest roads must be graded. In general, this will require a road grader or bulldozer to shape up the roads after forest products have been hauled off site. This includes cleaning of drainage areas, grading, crowning and filling with gravel, if necessary. The grading equipment to be used must be approved by the Unit Manager or his/her representative.

5 - Operations

5.1 - Notification

5.1.1 - Pre-sale conference (10/16)

A pre-sale conference on site between the Purchaser and sale administrator is required prior to beginning any operations to determine landing and road locations. The Unit Manager or his/her representative must be contacted at least 3 days in advance to schedule the conference.

5.1.4 - Post-sale conference (10/16)

A post-sale conference on site between the Purchaser and sale administrator is required 3 days prior to the completion of active logging operations to determine clean-up and repair of landings, road edges, and the fulfillment of other contract specifications.

5.2 - Conduct of Operations

5.2.2 - Hazard Trees/Snags

5.2.2.1 - Den trees (10/16)

Obvious hollow and/or den trees shall be protected and left standing unless they are a safety hazard.

5.2.4 - Dead and Down Creation

5.2.4.2 - Dead and down creation, hare and grouse (1/14)

To improve habitat for snowshoe hare, grouse, and other species, the Purchaser is to leave two trees, nine (9) inches or larger in diameter on the ground for every two acres. If possible, the logs or trees should be felled so they overlap. Note these pieces should have a minimum length of ten feet. They can be of any tree species and can be an un-merchantable piece of wood or a full tree.

5.2.17 - Timber Mats and Interlocking Composite Mats (5/23)

Skid trails in Payment Units 1 & 2 may require extra protection such as that afforded by timber mats and interlocking composite mats. If available, mats may be borrowed from the DNR. A Timber Sale Contract Amendment will be used to document the Purchaser's use of the DNR's mats. Contact the Sale Administrator regarding availability and pick-up. The Purchaser is responsible for picking up and hauling the mats to and from the site. The composite mats will require DNR staff onsite for installation and removal. Contact the Sale Administrator to schedule at least 30 days before desired install/removal date. All mats must be cleaned prior to drop off. This may include, but is not limited to, power washing and brushing to remove mud and debris. A charge of \$700.00 per timber mat and \$2,000.00 per composite mat will be assessed for all damaged or non-returned mats. Damage for the crane/timber mats is defined as three or more broken cants. Damage for the composite mats is defined as cracked or broken mats.

5.2.22 - Operating Caution

5.2.22.1 - Operating caution (6/11)

It is recommended, but not required, that within Payment Unit(s) 1-3, cutting, skidding, and hauling occur during dry summer (June, July, & August) or frozen winter (January, February, & March) conditions with tracked equipment. The reason for the recommendation is due to the wet soil conditions within all Payment Units.

5.2.29 - Shrub protection (1/20)

Do not cut or damage hawthorn, witch-hazel, dogwood or juneberry. These woody-shrub plants are highly beneficial to various wildlife species.

5.2.32 - Decking/landing restoration (9/13)

All decking and landing areas must have the surface area restored to a condition equal to or better than before. This is to ensure the proper regeneration of the stand. Wood debris, chips and "cookies" from trimmings must be removed or scattered away from landing and loading areas and may not be windrowed on the edge.

5.4 - Soil Protection

5.4.1 - Rutting restriction, general (7/16)

Operations are to cease immediately if equipment and weather conditions result in rutting of roads and/or skid trails which is 12 inches or greater in depth and 50 feet in length. The Unit Manager or his/her representative may restrict hauling and/or skidding if ruts exceed the specified depth. With the Unit Manager or his/her representative's approval, the Purchaser may return to the area when the risk of rutting has decreased.

5.4.5 - Soil caution (11/04)

Care must be taken to minimize soil damage due to the wet soils.

5.8 - Protection of Endangered Species

5.8.5 - Protection of raptor nests (3/13)

All trees with raptor nests will be protected if found during harvesting operations. Notification will be made to the Unit Manager or his/her representative who will notify the Wildlife Biologist so an on-site evaluation and recommendation can be made, if necessary.

6 - Safety and Fire Prevention

6.2 - Signing

6.2.1 - Road posting (10/20)

The Purchaser is responsible for posting and maintaining caution signs on Gill and Munger Roads prior to beginning operations. The road must be posted at appropriate distances from the Sale Area to warn of logging activity and truck traffic. Signs must be removed when harvest operations are suspended or completed.

7 - Other Conditions

7.5 - Loss

7.5.1 - Deteriorating timber (7/09)

The sale area has received damage from individual tree windthrow and over-maturity. The Purchaser should harvest the wood as soon as possible. The Department of Natural Resources is held free of responsibility of any further damage or deterioration due to delay in harvesting.



TIMBER SALE MAP

This information provided by authority of Part 525, 1994 PA 451, as amended.

Forest Management Unit Gaylord		County Emmet	Mapped By TSP	Date 09/19/2023	Page 1	of 1
Township 38N	Range 04W	Section(s) and Subdivision(s) 17: S1/2NW, N1/2SW, NWSE; 18: NE, N1/2SE		Scale 1:15,840		

Cover Type				Density	
A = Aspen	H = Hemlock	N = Marsh	U = Upland Brush	0 = Non Stocked	5 = Pole Timber Medium
B = Paper Birch	J = Jack Pine	O = Oak	UM = Upland Mixed	1 = Seedling Sapling Poor	6 = Pole Timber Well
C = Cedar	L = Lowland Brush	P = Lowland Poplar	V = Bog or Marsh	2 = Seedling Sapling Medium	7 = Saw Timber Poor
D = Treed Bog	LM = Lowland Mixed	Q = Mixed Swamp Conifer	W = White Pine	3 = Seedling Sapling Well	8 = Saw Timber Medium
E = Swamp Hdwoods	M = Mpl, Bch, Brch	R = Red Pine	X = Non Stocked	4 = Pole Timber Poor	9 = Saw Timber Well
F = Spruce Fir	MC = Mixed Conifer	S = Black Spruce	Z = Water		
G = Grass	MD = Mixed Deciduous	T = Tamarack			

PU	Acres
1	50.4
2	63.9
3	37.2

Way Back There Mix

Compartment 120
151.5 Acres

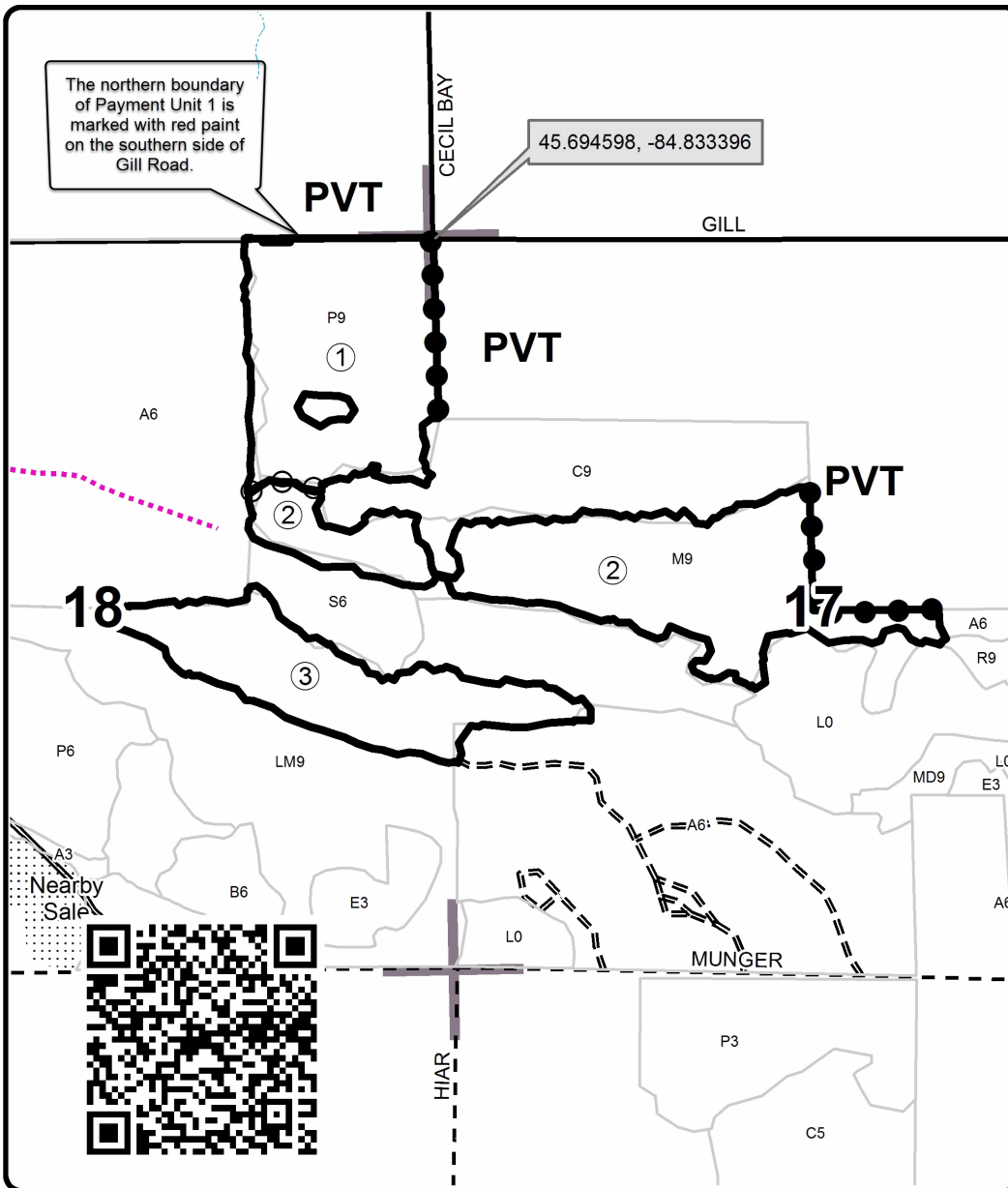

Legend

- Against State (Red)
- ○ Payment Unit (Yellow)
- ● Private Line (Blue)
- ▨ Retention Area
- ⋯ Nearby Timber Sales
- Stand Boundaries
- == Secondary Forest Road
- == Forest Access Route
- Paved Road
- - Gravel Road
- ⋯ Temporary Management Access
- ⋯ Intermittent Stream
- Section Corners

Locator Map
1:200,000

