



**DEPARTMENT OF NATURAL RESOURCES
STATE OF MICHIGAN
TIMBER SALE PROSPECTUS #7628**

SCHEDULED SALE DATE AND TIME: **9:00 a.m. (local time) on July 10, 2025.**

LOCATION: **BARAGA MGMT UNIT, 427 US 41 NORTH, BARAGA, MI 49908.**

CONTACT NAME: Brad Carlson

PHONE NUMBER: (906) 353-6651

PROSPECTUS NOTE: The bidder is advised to inspect the sale area and review the location, estimated volumes, operating costs and contract terms of proposed sales. Please be aware that some landowners may request 60 days or more notice for access across their land.

Notice is hereby given that bids will be received by the Unit Manager, BARAGA MANAGEMENT UNIT, for certain timber on the following described lands:

Promotion Mix (11-018-25) / T51N, R37W, SEC. 24, NESW,S1/2SW.

T51N, R37W, SEC. 25, NENW,N1/2NE,SENE.

Ontonagon County, Advertised Price \$52,257.95, 87.0 Acres, Hardwood, Sugar Maple.

TIMBER SALE INFORMATION

Promotion Mix (11-018-25)

T51N, R37W, SEC. 24; T51N, R37W, SEC. 25.

Ontonagon County (Advertised Price \$52,257.95)

A timber sale contract for this lump sum, sealed bid timber sale will be awarded to the responsible bidder offering the highest sealed bid price. All units of volume listed below were estimated using the Inventory Manager computer program and the new Michigan taper model. Bids must be at or above the following advertised price for each product and species:

<u>PRODUCTS & SPECIES</u>	<u>ESTIMATED UNITS*</u>	<u>ADVERTISED PRICE</u>
Sawtimber		
Black Cherry	0.6 MBF	\$ 40.00 / MBF
Red Maple	122.4 MBF	\$ 140.00 / MBF
Sugar Maple	51.0 MBF	\$ 271.00 / MBF
Yellow Birch	20.1 MBF	\$ 121.00 / MBF
Pulpwood		
Balsam Fir	9 Cords	\$ 4.80 / Cord
Mixed Hardwood	1,351 Cords	\$ 13.70 / Cord
Mixed Spruce	27 Cords	\$ 10.85 / Cord

* The total volume is statistically estimated within plus (+) or minus (-) 13.20 percent. There are an estimated 1,842 cords on this timber sale, plus or minus 243 cords at the 95% confidence level. The estimated units are final and not subject to adjustment. Prospective bidders are urged to examine this timber and to make their own estimates of quantity and quality.

BOND AND PAYMENT SCHEDULE:

- A bond in the amount of \$5,225.80 to insure faithful performance of the conditions of the contract will be deposited by the successful bidder within 21 days of the sale award.
- Cutting in any sale or unit without the required advance payment would be considered a trespass.
- Total payment must be paid in advance or according to the following schedule :
 - Ten percent (10%) of the sale value must be paid within 21 days of the sale award.
 - The 10% down payment will be credited towards the first unit cut.
 - Payment for each of the following units must be made before cutting begins in that unit:

PAYMENT UNIT NUMBER	PERCENT OF TOTAL SALE VALUE
01	27.5%
02	30.4%
03	31.5%
04	10.6%
- If no cutting takes place, the 10% down payment will not be refunded.
- Operations on the contract issued will terminate on 06/30/2028.

SALE STATISTICS

Volumes were calculated in cubic feet using the Michigan taper model. Cubic foot volume includes all wood inside bark for the product indicated. For display purposes, cubic feet were converted to cords and MBF using a simple conversion factor, e.g. 79 cubic feet per cord and 185 cubic feet per MBF. The cubic foot volumes are precise; the cords and MBF volumes are not. Cubic foot volume cannot be directly converted to cords or boards with precision.

SALE VOLUMES

The total estimated sale volume may not equal the sum of the species/products due to the nature of statistical calculations associated with double sampling methodology.

VOLUME			STATISTICAL RANGE IN CORDS	
TOTAL CUBIC FEET	TOTAL CORDS	PERCENT ERROR	MINIMUM	MAXIMUM
145,520	1,842	13.20%	1,599	2,085

VDU VOLUMES

A VDU is a Volume Determination Unit. Volumes and their associated statistics are calculated at the VDU level and summarized to the sale level. There is often a one to one relationship between a VDU and a Payment Unit, but not always, depending on the cruise design. Refer to the VDU TO PAYMENT UNIT table.

	VOLUME			RANGE IN CORDS	
VDU	TOTAL CUBIC FEET	TOTAL CORDS	PERCENT ERROR	MINIMUM	MAXIMUM
4	40,626	514	26.72%	377	652
6	41,056	520	27.10%	379	661
12	10,002	127	40.55%	75	178
38	38,852	492	25.90%	364	619
41	14,984	190	35.70%	122	257
TOTAL:	145,520	1,842		1,317	2,367

VDU TO PAYMENT UNIT

When a VDU is associated with more than one Payment Unit (PU), the VDU volumes are assigned to the PU based on acres of the VDU within the PU.

VDU	VDU ACRES	PU	PU ACRES
4	18.3	1	18.3
6	21.4	2	21.4
12	13.0	4	13.0
38	26.0	3	26.0
41	8.3	4	8.3
TOTAL:	87.0		87.0

DESCRIPTION OF TIMBER BY PU (PU)

PU	MARKET GROUP	PRODUCT	QUANTITY	UNIT	ACRES	ADVERTISE PRICE
1	Red Maple	Sawtimber	20.2	MBF	18.3	\$14,361.30
	Sugar Maple		18.7	MBF		
	Yellow Birch		7.8	MBF		
	Balsam Fir	Pulpwood	3	Cords		
	Mixed Hardwood		402	Cords		
	Red Maple		161	Cords		
	Sugar Maple		229	Cords		
	Yellow Birch		12	Cords		
2	Red Maple	Sawtimber	30.8	MBF	21.4	\$15,880.20
	Sugar Maple		20.5	MBF		
	Yellow Birch		7.3	MBF		
	Balsam Fir	Pulpwood	4	Cords		
	Mixed Hardwood		354	Cords		
	Red Maple		218	Cords		
	Sugar Maple		127	Cords		
	Yellow Birch		9	Cords		
	Mixed Spruce		24	Cords		
	White Spruce		24	Cords		
	3	Red Maple	Sawtimber	69.4		
Sugar Maple			9.5	MBF		
Mixed Hardwood		Pulpwood	307	Cords		
Red Maple			231	Cords		
Sugar Maple			76	Cords		
4	Black Cherry	Sawtimber	0.6	MBF	21.3	\$5,520.05
	Red Maple		2.0	MBF		
	Sugar Maple		2.3	MBF		
	Yellow Birch		5.0	MBF		
	Balsam Fir	Pulpwood	2	Cords		
	Mixed Hardwood		288	Cords		
	Black Cherry		6	Cords		
	Ironwood		1	Cords		
	Red Maple		149	Cords		
	Sugar Maple		114	Cords		
	Yellow Birch		18	Cords		
	Mixed Spruce		3	Cords		
	White Spruce		3	Cords		
	TOTAL:			194.1		
TOTAL:			1,387	Cords		

Sale Specific Conditions & Requirements

Sale Name: Promotion Mix

Sale Number: 11-018-25 Seq#: 1

1 - Sale Area

1.2 - Boundaries

1.2.1 - Painted Boundaries (9/19)

The sale boundary and Payment Unit boundaries are marked and identified by blue and purple paint. Exterior sale boundary lines against private property are marked with blue paint. Exterior sale boundary lines against state property are marked with purple paint. Interior Payment Unit boundary lines are marked with purple paint. Purple painted trees designating an interior Payment Unit boundary are only to be cut when all surrounding Payment Units have been paid.

2 - Timber Specifications

2.1 - Included Timber

2.1.2 - Clearcut Unit(s) w/o Unmerchantable Trees (8/11)

Within Payment Unit(s) 1, 2 & 3, cut all trees which meet minimum piece specifications in 2.2 Utilization, except do not cut hemlock, white pine, yellow birch, cedar, black cherry, or red oak. In addition, within Payment Units 1 & 2, cut all yellow birch marked with orange paint.

2.1.3 - Cut Tree Marked Unit(s) (12/08)

Within Payment Unit(s) 4, all trees are designated for cutting when marked with orange paint above and below stump height, regardless of merchantability.

2.2 - Utilization

2.2.4 - Skidding Length (12/24)

Skidding of unlimbed tops or lengths over 17 feet is not permissible unless approved by the Unit Manager or his/her representative.

2.2.7 - Uncut Designated Trees (2/04)

Liquidated damages of \$10.00 per tree will be assessed for every marked tree not cut.

2.2.8 - Utilization and Removal (12/24)

All products not meeting standards set forth in General Condition and Requirement 2.2 Utilization may not be removed from the Sale Area, e.g. tops. This is because this area is a deer wintering yard.

2.2.11 - Chipping Restriction (9/14)

If chipping occurs on this sale, then no woody debris present on the ground at the start of the sale may be chipped. In addition, brush or chips may not be stored or stockpiled on site for more than 30 days.

3 - Payments

3.4 - Damaged Timber

3.4.1 - Damaged Timber (12/24)

General Condition and Requirement 3.4 Damaged Timber, defines liquidated damages for undesignated live merchantable trees which are cut or injured. In addition, extreme care should be taken to avoid damage to tree seedlings and saplings.

No damage is acceptable to undesignated live merchantable trees. Within the Sale Area, if more than 5% of trees (> 4.5" DBH) within a specified area of the sale are damaged, liquidated damages will be assessed for all trees damaged. Rates will be in accordance with General Condition and Requirement 3.4 Damaged Timber.

4 - Transportation

4.1 - Construction

4.1.1 - Stream Crossings, General (1/25)

All stream crossing structures will be temporary and, therefore, shall be provided by the Purchaser and must be removed upon completion of the sale. All permits for stream crossings will be provided by the DNR for crossings located on state land. The Purchaser will secure any necessary stream crossing permits that may be required on private land.

4.1.3 - Slash and Earthen Piles (8/04)

Piles or windrows of earth along roads and landings that have been widened or constructed shall be leveled. Slash from road maintenance or construction, including stumps, shall be dispersed throughout the sale, chipped, utilized or otherwise removed from the sale.

4.1.5 - Culverts (5/14)

Roads may require the installation of culverts for cross drainage or at natural drainage-ways. If culverts are needed in these locations, their placement will be specified by the Sale Administrator and they shall be installed prior to hauling. The culverts shall be new, corrugated metal or plastic gauge. Culverts will be a minimum of 12 inches in diameter and 24 feet in length. If culverts are removed, fill shall be removed from wetland soils as specified. Soils shall be maintained and left in a non-erodible condition, with water bars, seed, fertilizer, mulch, and slash installed as directed by the Sale Administrator and as specified in the BMP manual.

4.1.7 - Road Closure (10/11)

All new roads built into the sale must be blocked to vehicle traffic upon completion of the sale. Overgrown roads that are reopened shall be considered new roads. In general, this will require constructing a four (4') foot high berm of stumps and logs covered with earth. Contact the Sale Administrator for specific details of design and placement.

4.2 - Maintenance

4.2.2 - Fill Material (4/07)

To maintain roads, fill material may be needed in areas where "holes" exist or may be expected to develop. This fill material should be placed before trucking begins.

4.2.5 - Two Wheel Drive Condition (2/04)

All existing trail roads on and adjacent to the Sale Area must be passable by two-wheel drive traffic for the duration of the sale.

4.4 - Access

4.4.1 - Private property access (3/11)

Permission for access across private land is the responsibility of the Purchaser. Should the Purchaser desire to cross private land, a copy of the written permission from the private landowner must be given to the Unit Manager within 30 days of the bid opening and prior to the beginning of operations if the Purchaser desires to access the sale on roads where the state does not hold easement.

5 - Operations

5.1 - Notification

5.1.1 - Pre-sale Conference (10/16)

A pre-sale conference between the Purchaser and Sale Administrator is required prior to beginning any operations. The Unit Manager or his/her representative must be contacted at least 10 days in advance to schedule the conference.

5.1.4 - Post-Sale Conference (10/16)

A post-sale conference on site between the Purchaser and sale administrator is required 5 days prior to the completion of active logging operations to determine clean-up and repair of landings, road edges, and the fulfillment of other contract specifications.

5.2 - Conduct of Operations

5.2.1 - Slash

5.2.1.1 - Slash Within Sale Area (9/16)

No trees are to be felled outside the Sale Area, and all slash is to be kept at least 10 feet back from the blue paint line. If sale boundary lines are along a public road or highway, then slash must be removed 50' from these lines per General

Condition & Requirement 5.2.1.

5.2.1.11 - Slash for Reforestation (3/21)

To facilitate reforestation, the Sale Area shall be left with slash evenly distributed. Bunched tops within the cutting area shall be broken up and scattered. Stumps shall be cut low to the ground. Processing sites shall not be left with a compacted layer of slash; tops from these sites shall be hauled back into the cut area and scattered.

5.2.2 - Hazard Trees/Snags

5.2.2.1 - Den Trees (10/16)

Obvious hollow and/or den trees shall be protected and left standing unless they are a safety hazard.

5.2.3 - Operating Restrictions

5.2.3.2 - Operating Restrictions (9/11)

Within Payment Unit(s) 1, 2, 3 & 4 unless changed by written agreement, all cleanup activities must be completed by June 30 for all areas that were harvested during the previous harvest season. This restriction is to allow the harvest area to revegetate before the dry season.

5.2.3.3 - Bark Slippage Restriction (3/09)

Within Payment Unit(s) 1, 2, 3 & 4, unless changed by written agreement, cutting and skidding are not permitted during the period of April 15 to July 15. This restriction is because of bark slippage.

5.2.17 - Timber Mats and Interlocking Composite Mats (5/23)

Some roads or skid trails may require extra protection such as that afforded by timber mats, interlocking composite mats, or another approved system. If available, mats may be borrowed from the DNR. A Timber Sale Contract Amendment will be used to document the Purchaser's use of the DNR's mats. Contact the Sale Administrator regarding availability and pick-up. Timber mats are available from various field offices. Composite mats are only available from the Grayling field office and the Marquette ICC. The Purchaser is responsible for picking up and hauling the mats to and from the site. The composite mats will require DNR staff onsite for installation and removal. Contact the Sale Administrator to schedule at least 30 days before desired install/removal date. All mats must be cleaned prior to drop off. This may include, but is not limited to, power washing and brushing to remove mud and debris. A charge of \$700.00 per timber mat and \$2,000.00 per composite mat will be assessed for all damaged or non-returned mats. Damage for the crane/timber mats is defined as three or more broken cants. Damage for the composite mats is defined as cracked or broken mats.

5.2.30 - Landing/Road Topsoil Protection (1/25)

Topsoil must be removed, stockpiled, and saved. Upon completion of the timber sale, soil must be evenly distributed back over the area for revegetation.

5.2.32 - Decking/Landing Restoration (9/13)

All decking and landing areas must have the surface area restored to a condition equal to or better than before. This is to ensure the proper regeneration of the stand. Wood debris, chips and "cookies" from trimmings must be removed or scattered away from landing and loading areas and may not be windrowed on the edge.

5.2.38 - No Decking Against Live Trees (2/04)

Cut products may not be decked against unmarked or designated leave trees.

5.4 - Soil Protection

5.4.1 - Rutting Restriction, General (7/16)

Operations are to cease immediately if equipment and weather conditions result in rutting of roads and/or skid trails which is 12 inches or greater in depth and 50 feet in length. The Unit Manager or his/her representative may restrict hauling and/or skidding if ruts exceed the specified depth. With the Unit Manager or his/her representative's approval, the Purchaser may return to the area when the risk of rutting has decreased.

5.8 - Protection of Endangered Species

5.8.5 - Protection of Raptor Nests (3/13)

All trees with raptor nests will be protected if found during harvesting operations. Notification will be made to the Unit Manager or his/her representative who will notify the Wildlife Biologist so an onsite evaluation and recommendation can be made, if necessary.

**TIMBER SALE MAP**

This information provided by authority of Part 525, 1994 PA 451, as amended.

Sale Number

11-018-25

Date

04/01/2025

Forest Management Unit

County

Mapped By: Dorvinen, K

Scale

Page

Of

Baraga Mgt Unit

Ontonagon

Cruised By: Dorvinen/Hansen

1:15,840**1****1**

Township

Range

Section(s) and

51N

37W

Subdivision(s) Sec. 24 NESW,S1/2SW; Sec. 25 NENW,N1/2NE,SENE;

Cover Type

A = Aspen J = Jack Pine O = Oak U = Upland Brush
B = Paper Birch K = Rock P = Lowland Poplar UM = Upland Mix Forest
C = Cedar L = Lowland Brush Q = Mixed Swamp Conifer V = Bog or Marsh
D = Treed Bog LM = Lowland Mix Forest R = Red Pine W = White Pine
E = Swamp Hardwoods M = Maple, Beech, Birch S = Black Spruce X = Non Stocked
F = Spruce/Fir MC = Mixed Conifer T = Tamarack Y = Sand
G = Grass MD = Mixed Deciduous Z = Water
H = Hemlock N = Marsh

Density

0 = Non Stocked 5 = Pole Timber Medium
1 = Seedling Sapling Poor 6 = Pole Timber Well
2 = Seedling Sapling Medium 7 = Saw Timber Poor
3 = Seedling Sapling Well 8 = Saw Timber Medium
4 = Pole Timber Poor 9 = Saw Timber Well

Legend

- Against State (Purple)
- Private Line (Blue)
- Payment Unit (Purple)
- Survey Grade Corner
- Forest Access Road
- County Road
- HWY
- Private Road
- Selection
- Clearcut

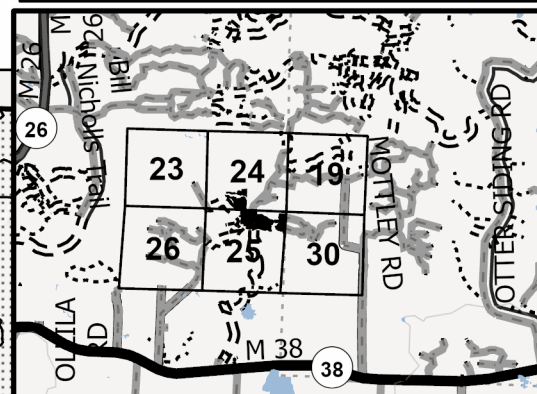
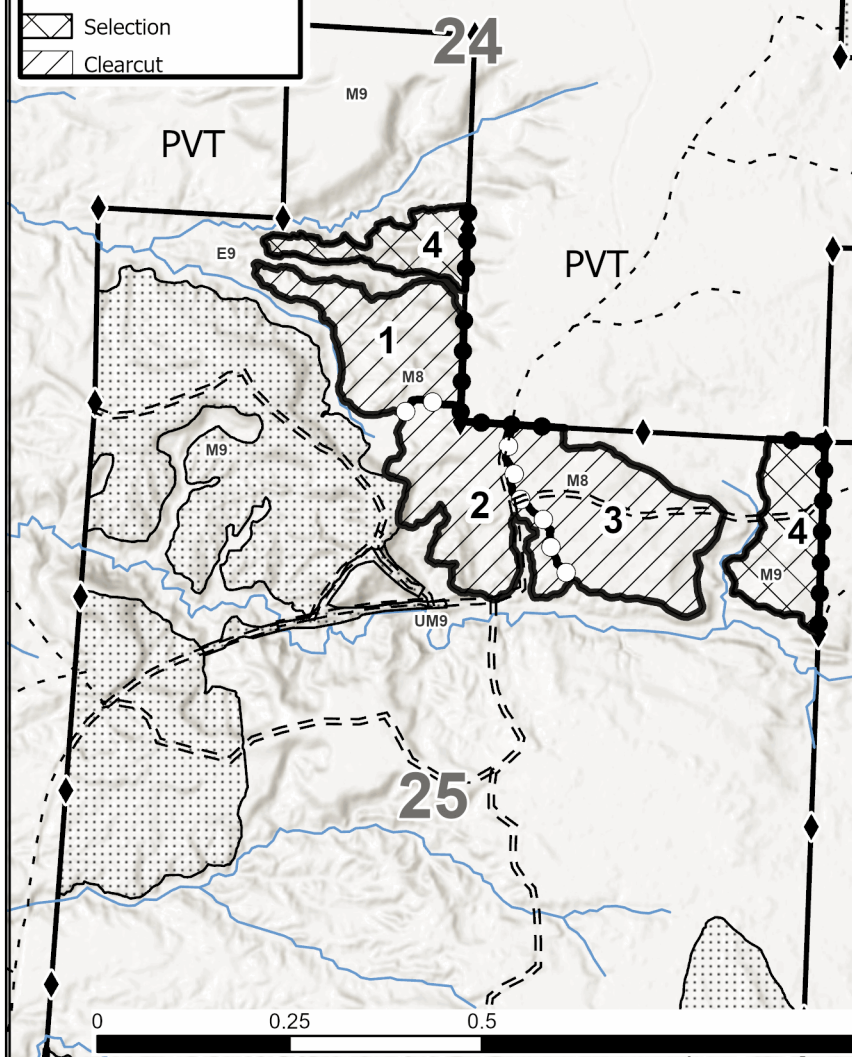
**Locator Map 1:150,000****Promotion Mix**

Baraga, Compartment 64

UNIT	1	2	3	4	TOTALS
ACRES	18.3	21.4	26	21.3	87.0
Sawlogs MBF					
Red Maple	20.2	30.8	69.4	2.0	122.4
Sugar Maple	18.7	20.5	9.5	2.3	51.0
Yellow Birch	7.8	7.3	0.0	5.0	20.1
Black Cherry	0.0	0.0	0.0	0.6	0.6
TOTAL	46.7	58.6	78.9	9.9	194.1
Pulpwood CORDS					
Balsam Fir	3	4	0	2	9
Mixed Hardwood	402	354	307	288	1351
Mixed Spruce	0	24	0	3	27
TOTAL	405	382	307	293	1387

Use QR Code to
open Map in App