



**DEPARTMENT OF NATURAL RESOURCES
STATE OF MICHIGAN**

TIMBER SALE PROSPECTUS #7556

REVISION NOTICE #1 - January 14, 2025

SCHEDULED SALE DATE AND TIME: **9:00 a.m. (local time) on Thursday, January 30, 2025**

LOCATION: **GRAYLING MGMT UNIT, 1955 HARTWICK PINES ROAD, GRAYLING, MI 49738**

This prospectus has been modified with the following changes.
Red Shouldered Pine, 72-045-21, has been withdrawn from the prospectus.

We apologize for any inconvenience this may have caused. If you need assistance, please contact Scott McClarren at 989-348-6371.



**DEPARTMENT OF NATURAL RESOURCES
STATE OF MICHIGAN
TIMBER SALE PROSPECTUS #7556**

SCHEDULED SALE DATE AND TIME: 9:00 a.m. (local time) on January 30, 2025.

LOCATION: GRAYLING MGMT UNIT, 1955 HARTWICK PINES ROAD, GRAYLING, MI 49738.

CONTACT NAME: Scott McClarren

PHONE NUMBER: (989) 348-6371

PROSPECTUS NOTE: The bidder is advised to inspect the sale area and review the location, estimated volumes, operating costs and contract terms of proposed sales. Please be aware that some landowners may request 60 days or more notice for access across their land.

Notice is hereby given that bids will be received by the Unit Manager, GRAYLING MANAGEMENT UNIT, for certain timber on the following described lands:

Bring a Buncher Oak (72-001-24) / T25N, R02W, SEC. 17, SW,NWSE,S1/2SE.

T25N, R02W, SEC. 18, SESE.

T25N, R02W, SEC. 20, NENW,N1/2NE,SENE,N1/2SE,SWSE.

T25N, R02W, SEC. 21, NWNW.

Crawford County, Advertised Price \$158,317.60, 303.4 Acres, Hardwood, Red Pine.

SALE NOTE: Payment Units 2 and 3 are being converted to red pine and must be clearcut, chipped, and low stumps. Within Payment Units 1, 4, and 5, all advanced regeneration is being protected. Hard and soft oak wilt restrictions on sale due to oak wilt having been found and treated in the area. Oak wilt no exceptions to protect advanced regeneration in Payment Units 1, 4, and 5. Soft oak wilt restriction spec to protect retention and oak in stands adjacent to Payment Units 2 and 3.

TIMBER SALE INFORMATION

Bring a Buncher Oak (72-001-24)

T25N, R02W, SEC. 17; T25N, R02W, SEC. 18; T25N, R02W, SEC. 20; T25N, R02W, SEC. 21.

Crawford County (Advertised Price \$158,317.60)

SALE NOTE: Payment Units 2 and 3 are being converted to red pine and must be clearcut, chipped, and low stumps. Within Payment Units 1, 4, and 5, all advanced regeneration is being protected. Hard and soft oak wilt restrictions on sale due to oak wilt having been found and treated in the area. Oak wilt no exceptions to protect advanced regeneration in Payment Units 1, 4, and 5. Soft oak wilt restriction spec to protect retention and oak in stands adjacent to Payment Units 2 and 3.

A timber sale contract for this lump sum, sealed bid timber sale will be awarded to the responsible bidder offering the highest sealed bid price. All units of volume listed below were estimated using the Inventory Manager computer program and the new Michigan taper model. Bids must be at or above the following advertised price for each product and species:

<u>PRODUCTS & SPECIES</u>	<u>ESTIMATED UNITS*</u>	<u>ADVERTISED PRICE</u>
Sawtimber		
Black/Red (Hybrid) Oak	777.3 MBF	\$ 137.00 / MBF
White Oak	96.4 MBF	\$ 111.00 / MBF
Pulpwood		
B. T. Aspen	49 Cords	\$ 26.60 / Cord
Misc. Species 1	30 Cords	\$ 5.00 / Cord
Mixed Oak	1,321 Cords	\$ 25.05 / Cord
Red Maple	20 Cords	\$ 32.50 / Cord
Red Pine	92 Cords	\$ 48.50 / Cord
White Pine	67 Cords	\$ 21.95 / Cord

* The total volume is statistically estimated within plus (+) or minus (-) 9.79 percent. There are an estimated 3,627 cords on this timber sale, plus or minus 355 cords at the 95% confidence level. The estimated units are final and not subject to adjustment. Prospective bidders are urged to examine this timber and to make their own estimates of quantity and quality.

BOND AND PAYMENT SCHEDULE:

1. A bond in the amount of \$7,915.88 to insure faithful performance of the conditions of the contract will be deposited by the successful bidder within 21 days of the sale award.
2. Cutting in any sale or unit without the required advance payment would be considered a trespass.
3. Total payment must be paid in advance or according to the following schedule :
 - (a) Ten percent (10%) of the sale value must be paid within 21 days of the sale award.
 - (b) The 10% down payment will be credited towards the first unit cut.
 - (c) Payment for each of the following units must be made before cutting begins in that unit:

<u>PAYMENT UNIT NUMBER</u>	<u>PERCENT OF TOTAL SALE VALUE</u>
01	18.9%
02	23.5%
03	17.4%
04	16.7%
05	23.5%

4. If no cutting takes place, the 10% down payment will not be refunded.
5. Operations on the contract issued will terminate on 03/31/2027.

SALE STATISTICS

Volumes were calculated in cubic feet using the Michigan taper model. Cubic foot volume includes all wood inside bark for the product indicated. For display purposes, cubic feet were converted to cords and MBF using a simple conversion factor, e.g. 79 cubic feet per cord and 185 cubic feet per MBF. The cubic foot volumes are precise; the cords and MBF volumes are not. Cubic foot volume cannot be directly converted to cords or boards with precision.

SALE VOLUMES

The total estimated sale volume may not equal the sum of the species/products due to the nature of statistical calculations associated with double sampling methodology.

<u>VOLUME</u>		<u>STATISTICAL RANGE IN CORDS</u>		
<u>TOTAL CUBIC FEET</u>	<u>TOTAL CORDS</u>	<u>PERCENT ERROR</u>	<u>MINIMUM</u>	<u>MAXIMUM</u>
286,545	3,627	9.79%	3,272	3,982

VDU VOLUMES

A VDU is a Volume Determination Unit. Volumes and their associated statistics are calculated at the VDU level and summarized to the sale level. There is often a one to one relationship between a VDU and a Payment Unit, but not always, depending on the cruise design. Refer to the VDU TO PAYMENT UNIT table.

	VOLUME			RANGE IN CORDS	
VDU	TOTAL CUBIC FEET	TOTAL CORDS	PERCENT ERROR	MINIMUM	MAXIMUM
31	61,338	776	16.52%	648	905
61	225,207	2,851	11.66%	2,518	3,183
TOTAL:	286,545	3,627		3,166	4,088

VDU TO PAYMENT UNIT

When a VDU is associated with more than one Payment Unit (PU), the VDU volumes are assigned to the PU based on acres of the VDU within the PU.

VDU	VDU ACRES	PU	PU ACRES
31	63.2	1	63.2
61	240.2	2	69.9
61	240.2	3	51.4
61	240.2	4	49.4
61	240.2	5	69.5
TOTAL:	1,024.0		303.4

DESCRIPTION OF TIMBER BY PU (PU)

PU	MARKET GROUP	PRODUCT	QUANTITY	UNIT	ACRES	ADVERTISE PRICE
1	Black/Red (Hybrid	Sawtimber	132.9	MBF	63.2	\$29,950.30
	White Oak		6.7	MBF		
	Misc. Species 1	Pulpwood	10	Cords		
	Mixed Oak		393	Cords		
	/Red (Hybrid) Oak		300	Cords		
	White Oak		93	Cords		
	Red Maple		9	Cords		
	White Pine		37	Cords		
2	Black/Red (Hybrid	Sawtimber	187.5	MBF	69.9	\$37,333.15
	White Oak		26.1	MBF		
	B. T. Aspen	Pulpwood	15	Cords		
	Misc. Species 1		6	Cords		
	Mixed Oak		270	Cords		
	/Red (Hybrid) Oak		209	Cords		
	White Oak		61	Cords		
	Red Maple		3	Cords		
	Red Pine		26	Cords		
	White Pine		9	Cords		
3	Black/Red (Hybrid	Sawtimber	137.9	MBF	51.4	\$27,493.65
	White Oak		19.2	MBF		
	B. T. Aspen	Pulpwood	10	Cords		
	Misc. Species 1		4	Cords		
	Mixed Oak		199	Cords		
	/Red (Hybrid) Oak		154	Cords		
	White Oak		45	Cords		
	Red Maple		3	Cords		
	Red Pine		20	Cords		
White Pine		6	Cords			
4	Black/Red (Hybrid	Sawtimber	132.5	MBF	49.4	\$26,383.65
	White Oak		18.4	MBF		
	B. T. Aspen	Pulpwood	10	Cords		
	Misc. Species 1		4	Cords		
	Mixed Oak		191	Cords		
	/Red (Hybrid) Oak		148	Cords		
	White Oak		43	Cords		
	Red Maple		2	Cords		
	Red Pine		19	Cords		
	White Pine		6	Cords		
5	Black/Red (Hybrid	Sawtimber	186.5	MBF	69.5	\$37,156.85
	White Oak		26.0	MBF		
	B. T. Aspen	Pulpwood	14	Cords		
	Misc. Species 1		6	Cords		
	Mixed Oak		268	Cords		
	/Red (Hybrid) Oak		208	Cords		
	White Oak		60	Cords		
	Red Maple		3	Cords		
	Red Pine		27	Cords		
White Pine		9	Cords			
TOTAL:			873.7	MBF		
TOTAL:			1,579	Cords		

Sale Specific Conditions & Requirements

Sale Name: Bring a Buncher Oak

Sale Number: 72-001-24 Seq#: 2

1 - Sale Area

1.2 - Boundaries

1.2.1 - Painted Boundaries (9/19)

The sale boundary and Payment Unit boundaries are marked and identified by blue, red and yellow paint, as well as existing roads and immature stands (see Timber Sale Map). Exterior sale boundary lines against private property are marked with blue paint. Exterior sale boundary lines against state are marked with red paint with the following exceptions: the northwest portion of Payment Unit 1 is unmarked and designated by Stephan Bridge Rd; the southeast portion of Payment Unit 1, the south portion of Payment Unit 2, and the west boundaries of Payment Units 3 and 4 are unmarked and designated by the same immature stand; and the west boundaries of Payment Units 3 and 4 are unmarked and designated by immature stands. Interior Payment Unit boundaries are marked with yellow paint. Retention patches are marked with red paint; no harvesting activities may occur within these areas. The painted boundary line trees are not Included Timber and are to be protected except the trees with red paint on the backside adjacent to the nearby sale along the east boundaries of Payment Units 3 and 4 which may be harvested. Yellow painted trees designating an interior Payment Unit boundary are only to be cut when all surrounding Payment Units have been paid.

2 - Timber Specifications

2.1 - Included Timber

2.1.1 - Clearcut Unit(s) with Unmerchantable Trees (6/14)

Within Payment Unit(s) 2 and 3, cut all trees that are two (2) inches or more at DBH, , except do not cut trees marked with green paint.

Special protection trees identified in accordance with condition 3.4.2, within clearcutting unit boundaries, are not Included Timber and are to be protected.

2.1.5 - Overstory Removal Unit(s) (8/11)

Within Payment Unit(s) 1, 4, and 5, all trees which meet minimum piece specifications in 2.2 Utilization, are designated for cutting, except do not cut trees marked with green paint.

Special protection trees identified in accordance with condition 3.4.2, within clearcutting unit boundaries, are not Included Timber and are to be protected.

2.1.11 - Description of Timber Note (2/04)

Note that Misc. Species 1 is dead oak.

2.2 - Utilization

2.2.2 - Chipping required (2/18)

Payment Units 2 and 3 must be chip harvested to facilitate subsequent planting operations. The Purchaser has the option to produce sawlogs or pulpwood bolts, but the remaining portion of the trees must be chipped and hauled. If market conditions limit the practicality of chipping, tops and slash must be arranged in a way that will not inhibit future planting operations, as directed by the Sale Administrator. A chipping exemption can be obtained if proposed operations are determined to be suitable for planting by reforestation staff. The requirement to retain approximately 1/6 to 1/3 of tree tops and limbs less than four inches in diameter is still applicable (G. C. & R. 2.2).

2.2.3 - Stump heights (4/07)

Stump heights within Payment Units 2 and 3 shall not exceed 6 inches for all trees. This is in order to facilitate planting operations.

3 - Payments

3.3 - Pre-measured Sales

3.3.4 - Dividing payment units (7/14)

Payment Unit(s) may be divided at the request of the Purchaser and upon approval of the Unit Manager. Dividing Payment Units is a contract modification which requires a Timber Sale Contract Amendment.

3.4 - Damaged Timber

3.4.1 - Damaged timber (7/16)

General Condition and Requirement 3.4 Damaged Timber, defines liquidated damages for undesignated live merchantable trees which are cut or injured. In addition, reasonable care should be taken to avoid damage to tree seedlings and saplings.

Within the Sale Area, if more than 30% of the tree seedlings or saplings (1/4" to 4.5" DBH) within a specified portion of the Sale Area are damaged, liquidated damages will be assessed at \$400 per acre for all acreage within that specified portion of the Sale Area that was damaged. Trees cut cleanly for skid trails and operational pathways will not be counted as damaged timber.

3.4.2 - Special Protection Trees (4/14)

The Purchaser shall not cut live or dead special protection trees within cutting units or clearings. Special protection trees are marked with green paint. If the Purchaser's operations have cut or damaged special protection trees through carelessness, the Purchaser shall pay \$500 as fixed, agreed and liquidated damages for each special protection tree cut or damaged. Such payment does not constitute ownership of the undesignated timber.

4 - Transportation

4.1 - Construction

4.1.6 - Road construction (4/24)

Construction of new roads or improvements of existing roads shall be done in such a way as to minimize the environmental and visual impacts. Merchantable trees shall be cut and utilized unless otherwise directed. Non-merchantable trees shall be severed and laid flat on the ground. Slash shall be scattered, and not left in windrows and kept a minimum of 10 feet back from the road edge. Stumps shall be set upright, not left on edge, and be moved at least 10 feet away from the road edge. Disturbed soil shall be feathered into the woods and not left in berms or windrows.

4.1.7 - Road closure (10/11)

All new roads built into the sale must be blocked to vehicle traffic upon completion of the sale. Overgrown roads that are reopened shall be considered new roads. In general, this will require constructing a four (4') foot high berm of stumps and logs covered with earth. Stumps and brush must be placed along the remainder of the trail. These roads must be rendered impassable to cars and trucks. All stumps from road building and landing construction must be reserved to block any newly constructed roads upon completion of the sale. These stumps must be scattered along the road system to prohibit vehicular movement. Contact the Sale Administrator for specific details of design and placement.

4.1.11 - Permits (2/12)

The Purchaser will secure any necessary permits that may be required.

5 - Operations

5.2 - Conduct of Operations

5.2.2 - Hazard Trees/Snags

5.2.2.1 - Den trees (10/16)

Obvious hollow and/or den trees shall be protected and left standing unless they are a safety hazard.

5.2.3 - Operating Restrictions

5.2.3.4 - Oak wilt restriction, no exceptions (1/18)

Within Payment Units 1, 4, and 5, cutting, skidding, and hauling within the sale and brushing of access roads to the sale are not permitted during the period of April 15 to July 15. No exceptions will be granted. This is necessary to reduce the spread of oak wilt. Hauling from landings may be permitted if all haul road brushing is completed prior to oak wilt

restricted time.

5.2.3.5 - Oak wilt restriction (1/18)

Within Payment Units 2 and 3, unless changed by written agreement, cutting, skidding, hauling within the sale and brushing of access roads to the sale are not permitted during the period of April 15 to July 15. Operations may be allowed if specific steps are taken to prevent damaging uncut oak during the high risk period. Those steps may include completing all road brushing before April 15th and clearing a tree-length buffer along uncut oak cover before April 15th. This is necessary to reduce the spread of oak wilt. For more information, contact the Unit Manager or his/her representative.

5.2.32 - Decking/landing restoration (9/13)

All decking and landing areas must have the surface area restored to a condition equal to or better than before. This is to ensure the proper regeneration of the stand. Wood debris, chips and "cookies" from trimmings must be removed or scattered away from landing and loading areas and may not be windrowed on the edge.

5.4 - Soil Protection

5.4.2 - Skid trails (2/04)

Skid trails up and down slopes should be avoided. If however this is unavoidable, these trails will be left in a non-erodible condition using water bars, logs, and slash. Placing of slash on these skid trails while logging is ongoing may alleviate need for any further action. At the direction of the sale administrator, seed, fertilizer, and mulch may also be required.

6 - Safety and Fire Prevention

6.2 - Signing

6.2.1 - Road posting (10/20)

The Purchaser is responsible for posting and maintaining caution signs on haul roads prior to beginning operations. The road must be posted at appropriate distances from the Sale Area to warn of logging activity and truck traffic. Signs must be removed when harvest operations are suspended or completed. The Purchaser will provide these signs.

**TIMBER SALE MAP**

This information provided by authority of Part 525, 1994 PA 451, as amended.

Sale Number
72-001-24Date
05/15/2024Forest Management Unit
Grayling Mgt UnitCounty
CrawfordMapped By: Scott McClarren
Cruised By: Scott McClarrenScale
1:15,840Page
1Of
1

Township 25N Range 02W Section(s) and Subdivision(s) Sec 21: NWNW Sec 17: SW,NWSE,S1/2SE, Sec 18: SESE, Sec 20: NENW,N1/2NE,SENE,N1/2SE,SWSE,

Cover Type

A = Aspen	J = Jack Pine	O = Oak	U = Upland Brush
B = Paper Birch	K = Rock	P = Lowland Poplar	UM = Upland Mix Forest
C = Cedar	L = Lowland Brush	Q = Mixed Swamp Conifer	V = Bog or Marsh
D = Treed Bog	LM = Lowland Mix Forest	R = Red Pine	W = White Pine
E = Swamp Hardwoods	M = Maple, Beech, Birch	S = Black Spruce	X = Non Stocked
F = Spruce/Fir	MC = Mixed Conifer	T = Tamarack	Y = Sand
G = Grass	MD = Mixed Deciduous		Z = Water
H = Hemlock	N = Marsh		

Density

0 = Non Stocked	5 = Pole Timber Medium
1 = Seedling Sapling Poor	6 = Pole Timber Well
2 = Seedling Sapling Medium	7 = Saw Timber Poor
3 = Seedling Sapling Well	8 = Saw Timber Medium
4 = Pole Timber Poor	9 = Saw Timber Well

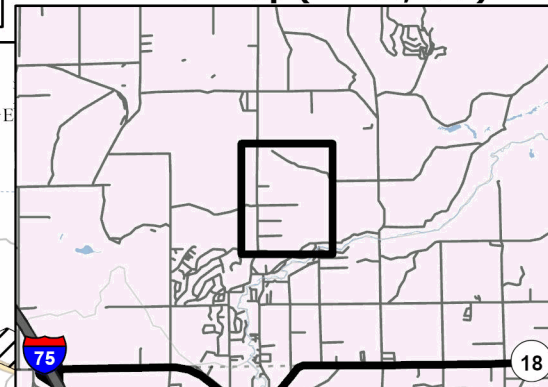
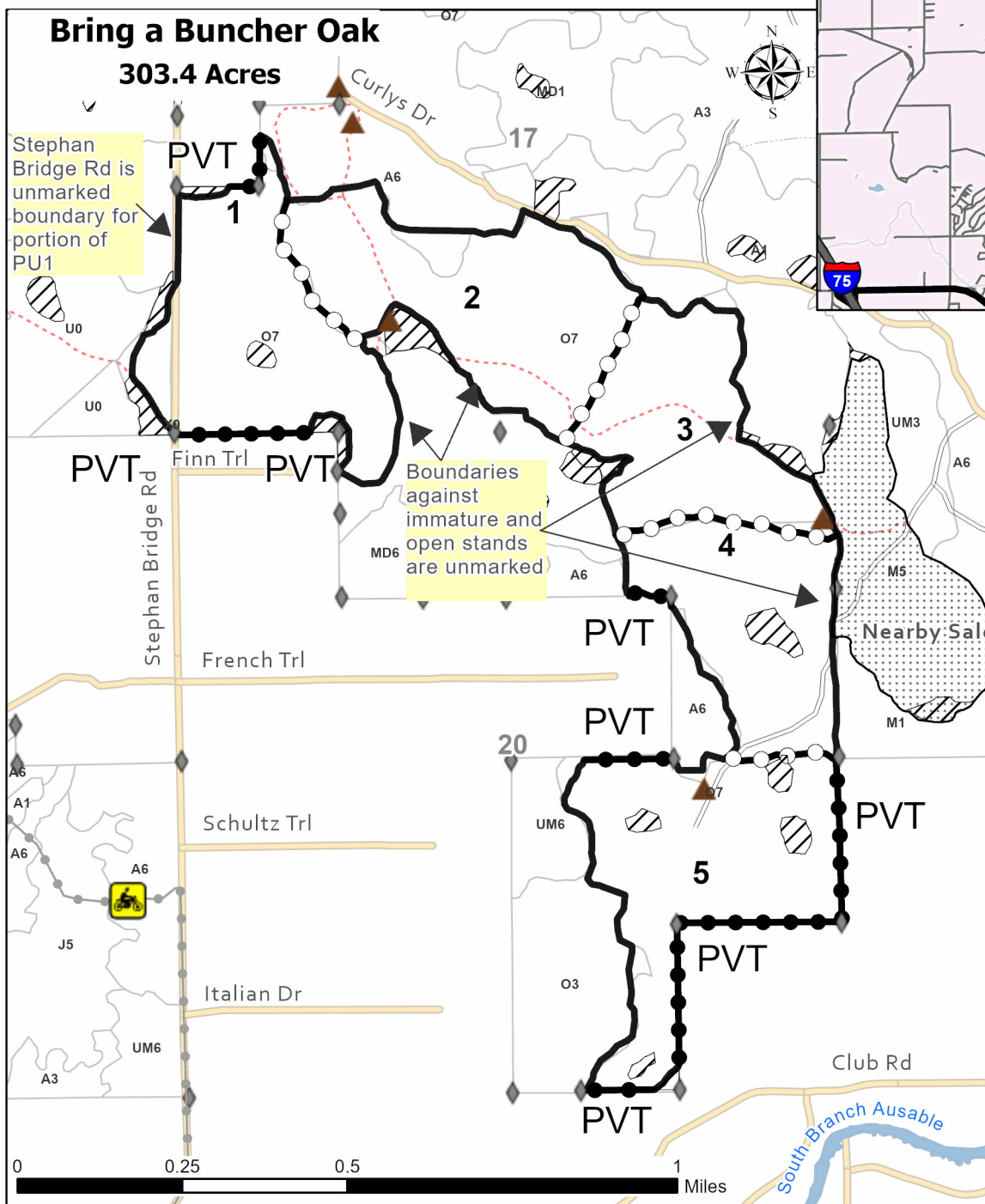
Locator Map (1:200,000)**Bring a Buncher Oak****303.4 Acres****Legend**

- Stand
- Retention Areas (Red)
- Nearby Sale
- Lakes and Rivers
- Against State (Red/Unmarked)
- Payment Unit (Yellow)
- Private Line (Blue)
- Recreational Trail
- Secondary Forest Road
- Administrative Access Only
- Non-DNR Road
- Field Grade Corner
- Berm

PU #	Acres
1	63.2
2	69.9
3	51.3
4	49.4
5	69.5

Use QR Code to open Map in App

