



**DEPARTMENT OF NATURAL RESOURCES
STATE OF MICHIGAN**

TIMBER SALE PROSPECTUS #7581

REVISION NOTICE #1 - February 10, 2025

SCHEDULED SALE DATE AND TIME: **9:00 a.m. (local time) on Friday, February 28, 2025**

LOCATION: **GAYLORD MGMT UNIT, 1732 West M 32, Gaylord, MI 49735**

This prospectus has been modified with the following changes.

Notice of Revision: Quality Control Red Pine, 52-107-24

Spec 5.8.5 will be modified with a timber sale amendment following purchase. This amendment will remove the requirement to buffer a nest found to be inactive prior to and during operations. It will also remove the requirement for two-year monitoring prior to operations. Only nest(s) found to be active will require a buffer and/or further monitoring.

We apologize for any inconvenience this may have caused. If you need assistance, please contact Lucas Merrick at 989-732-3541.



**DEPARTMENT OF NATURAL RESOURCES
STATE OF MICHIGAN
TIMBER SALE PROSPECTUS #7581**

SCHEDULED SALE DATE AND TIME: **9:00 a.m. (local time) on February 28, 2025.**

LOCATION: **GAYLORD MGMT UNIT, 1732 WEST M 32, GAYLORD, MI 49735.**

CONTACT NAME: Lucas Merrick

PHONE NUMBER: (989) 732-3541

PROSPECTUS NOTE: The bidder is advised to inspect the sale area and review the location, estimated volumes, operating costs and contract terms of proposed sales. Please be aware that some landowners may request 60 days or more notice for access across their land.

Notice is hereby given that bids will be received by the Unit Manager, GAYLORD MANAGEMENT UNIT, for certain timber on the following described lands:

Quality Control Red Pine (52-107-24) / T33N, R02W, SEC. 10, S1/2SE.

T33N, R02W, SEC. 3, NWNE, S1/2NE, N1/2SE, SESE.

Cheboygan County, Advertised Price \$66,699.80, 61.3 Acres, Red Pine.

SALE NOTE: Two week notice of intent to harvest is required to allow adequate time to observe the status of a stick nest which was inactive during timber sale preparation. If the stick nest is or becomes active, buffers and/or harvest timeline restrictions may be implemented. The Purchaser will be reimbursed for the reduction in acreage if already paid, or the cost will be deducted from the agreed purchase amount.

Refer to spec 5.8.5 for further detail. No extensions will be granted on this 4 year contract.

TIMBER SALE INFORMATION

Quality Control Red Pine (52-107-24)
 T33N, R02W, SEC. 10; T33N, R02W, SEC. 3.
 Cheboygan County (Advertised Price \$66,699.80)

SALE NOTE: Two week notice of intent to harvest is required to allow adequate time to observe the status of a stick nest which was inactive during timber sale preparation. If the stick nest is or becomes active, buffers and/or harvest timeline restrictions may be implemented. The Purchaser will be reimbursed for the reduction in acreage if already paid, or the cost will be deducted from the agreed purchase amount. Refer to spec 5.8.5 for further detail. No extensions will be granted on this 4 year contract.

A timber sale contract for this lump sum, sealed bid timber sale will be awarded to the responsible bidder offering the highest sealed bid price . All units of volume listed below were estimated using the Inventory Manager computer program and the new Michigan taper model. Bids must be at or above the following advertised price for each product and species:

<u>PRODUCTS & SPECIES</u>	<u>ESTIMATED UNITS*</u>	<u>ADVERTISED PRICE</u>
Sawtimber		
Red Pine	1.6 MBF	\$ 158.00 / MBF
Pulpwood		
Red Pine	1,380 Cords	\$ 48.15 / Cord

* The total volume is statistically estimated within plus (+) or minus (-) 21.19 percent. There are an estimated 1,383 cords on this timber sale, plus or minus 293 cords at the 95% confidence level. The estimated units are final and not subject to adjustment. Prospective bidders are urged to examine this timber and to make their own estimates of quantity and quality.

BOND AND PAYMENT SCHEDULE:

1. A bond in the amount of \$3,334.99 to insure faithful performance of the conditions of the contract will be deposited by the successful bidder within 21 days of the sale award.
2. Cutting in any sale or unit without the required advance payment would be considered a trespass.
3. Total payment must be paid in advance or according to the following schedule :
 - (a) Ten percent (10%) of the sale value must be paid within 21 days of the sale award.
 - (b) The remainder is due before cutting begins.
 - (c) Payment for each of the following units must be made before cutting begins in that unit:

PAYMENT UNIT NUMBER	PERCENT OF TOTAL SALE VALUE
01	100.0%
4. If no cutting takes place, the 10% down payment will not be refunded.
5. Operations on the contract issued will terminate on 06/30/2029.

SALE STATISTICS

Volumes were calculated in cubic feet using the Michigan taper model. Cubic foot volume includes all wood inside bark for the product indicated. For display purposes, cubic feet were converted to cords and MBF using a simple conversion factor, e.g. 79 cubic feet per cord and 185 cubic feet per MBF. The cubic foot volumes are precise; the cords and MBF volumes are not. Cubic foot volume cannot be directly converted to cords or boards with precision.

SALE VOLUMES

The total estimated sale volume may not equal the sum of the species/products due to the nature of statistical calculations associated with double sampling methodology.

VOLUME		PERCENT ERROR	STATISTICAL RANGE IN CORDS	
TOTAL CUBIC FEET	TOTAL CORDS		MINIMUM	MAXIMUM
109,225	1,383	21.19%	1,090	1,676

VDU VOLUMES

A VDU is a Volume Determination Unit. Volumes and their associated statistics are calculated at the VDU level and summarized to the sale level. There is often a one to one relationship between a VDU and a Payment Unit, but not always, depending on the cruise design. Refer to the VDU TO PAYMENT UNIT table.

VDU	VOLUME		PERCENT ERROR	RANGE IN CORDS	
	TOTAL CUBIC FEET	TOTAL CORDS		MINIMUM	MAXIMUM
26	86,055	1,089	23.95%	828	1,350
33	11,422	145	90.94%	13	276
97	11,749	149	68.48%	47	251
TOTAL:	109,225	1,383		888	1,877

VDU TO PAYMENT UNIT

When a VDU is associated with more than one Payment Unit (PU), the VDU volumes are assigned to the PU based on acres of the VDU within the PU.

VDU	VDU ACRES	PU	PU ACRES
26	50.0	1	50.0
33	5.9	1	5.9
97	5.4	1	5.4
TOTAL:	61.3		61.3

DESCRIPTION OF TIMBER BY PU (PU)

PU	MARKET GROUP	PRODUCT	QUANTITY	UNIT	ACRES	ADVERTISE PRICE
1	Red Pine	Sawtimber	1.6	MBF	61.3	\$66,699.80
	Red Pine	Pulpwood	1,380	Cords		
TOTAL:			1.6	MBF		
TOTAL:			1,380	Cords		

Sale Specific Conditions & Requirements

Sale Name: Quality Control Red Pine

Sale Number: 52-107-24 Seq#: 2

1 - Sale Area

1.2 - Boundaries

1.2.1 - Painted Boundaries (9/19)

The sale boundary and Payment Unit boundaries are marked and identified by red paint. Exterior sale boundary lines against state are marked with red paint. The painted boundary line trees are not Included Timber and are to be protected unless marked with orange paint.

2 - Timber Specifications

2.1 - Included Timber

2.1.3 - Cut Tree Marked Unit(s) (12/08)

Within Payment Unit(s) 1, all trees are designated for cutting when marked with orange paint above and below stump height, regardless of merchantability. Any species other than marked red pine, which are required to cut for operability are to be severed flush with the ground and laid flat. If these species are merchantable and desirable, they may be decked separately and scaled at the landing. Payment will be made at contract prices or average prices, if not on the contract.

2.2 - Utilization

2.2.6 - Roundwood Operation Required (3/21)

The skidding of whole trees or tree segments with limbs attached is prohibited. All products must be produced as roundwood and forwarded to existing roads or landing areas in final product length.

3 - Payments

3.3 - Pre-measured Sales

3.3.4 - Dividing Payment Units (7/14)

Payment Unit(s) 1 may be divided at the request of the Purchaser and upon approval of the Unit Manager. Dividing Payment Units is a contract modification which requires a Timber Sale Contract Amendment.

3.4 - Damaged Timber

3.4.1 - Damaged timber (7/16)

General Condition and Requirement 3.4 Damaged Timber, defines liquidated damages for undesignated live merchantable trees which are cut or injured. No damage is acceptable to undesignated live merchantable trees. Within the Sale Area, if more than 5% of red pine (> 4.5" DBH) within a specified area of the sale are damaged, liquidated damages will be assessed for all red pine damaged. Rates will be in accordance with General Condition and Requirement 3.4 Damaged Timber.

4 - Transportation

4.1 - Construction

4.1.7 - Road Closure (10/11)

Overgrown and/or bermed roads that are reopened for operations must be closed upon completion of the contract. Any re-opened skid trails outside of the Sale Area must also be rendered impassable at the completion of the sale. In general, this will require constructing a four (4') foot high berm of stumps and logs covered with earth at specified road closure locations and berms and/or slash impeding motor vehicles from using adjacent skid trails. These roads and skid trails must be rendered impassable to cars and trucks. Temporary berms may be required if no sale activity occurs for 30 or more consecutive days. Contact the Sale Administrator for specific details of design and placement.

4.2 - Maintenance

4.2.4 - Grading (10/16)

For completion of the sale, state forest roads must be graded. In general, this will require a road grader or bulldozer to shape up the roads after forest products have been hauled off site. This includes cleaning of drainage areas, grading, crowning and filling with gravel, if necessary. The grading equipment to be used must be approved by the Unit Manager or his/her representative.

4.2.5 - Two Wheel Drive Condition (2/04)

All existing trail roads on and adjacent to the Sale Area must be passable by two-wheel drive traffic for the duration of the sale.

5 - Operations

5.2 - Conduct of Operations

5.2.3 - Operating Restrictions

5.2.3.3 - Bark Slippage Restriction (3/09)

Within Payment Unit(s) 1, unless changed by written agreement, cutting and skidding are not permitted during the period of April 15 to July 15. This restriction is because of bark slippage.

5.4 - Soil Protection

5.4.1 - Rutting Restriction, General (7/16)

Operations are to cease immediately if equipment and weather conditions result in rutting of roads and/or skid trails which is 12 inches or greater in depth and 50 feet in length. The Unit Manager or his/her representative may restrict hauling and/or skidding if ruts exceed the specified depth. With the Unit Manager or his/her representative's approval, the Purchaser may return to the area when the risk of rutting has decreased.

5.8 - Protection of Endangered Species

5.8.5 - Protection of Raptor Nests (3/13)

All trees with raptor nests will be protected if found during harvesting operations. Notification will be made to the Unit Manager or his/her representative who will notify the Wildlife Biologist so an onsite evaluation and recommendation can be made, if necessary. An inactive small stick nest was located on the north end of Payment Unit 1 during Timber Sale Preparation. The Sale Administrator must be notified two (2) weeks prior to the intent to harvest for the Wildlife Biologist to complete an on-site evaluation of the nest. In the event that the nest is found to be active, the contract may be amended to protect the nest site until the nest is determined to be inactive. The value of the trees in this excluded area will be refunded or credited to the Purchaser. The nest will be buffered, depending on the requirements of the avian species present, with a protection area, centered on the nest tree, in which there will be no cutting or new roads constructed. Avoid human disturbance, including loading and skidding, in the protection area. An additional zone of protection will be established in which there is no management activity or harvesting during the breeding season of avian species present. Nests determined to be inactive will be protected with a one-chain no-harvest buffer. For a nest to be considered inactive, it must be observed as inactive 2 years in a row by a Wildlife Biologist.

7 - Other Conditions

7.2 - Extensions

7.2.2 - No Extensions (3/09)

There will be no extensions granted on this contract.



TIMBER SALE MAP

This information provided by authority of Part 525, 1994 PA 451, as amended.

Sale Number
52-107-24

Date
09/20/2024

Forest Management Unit
Gaylord Mgt Unit

County
Cheboygan

Mapped By: TSP
Cruised By: TSP

Scale
1:24,000

Page
1

Of
1

Township
33N

Range
02W

Section(s) and Subdivision(s)
Sec. 10 S1/2SE; Sec. 3 NWNE,S1/2NE,N1/2SE,SESE;

Cover Type

A = Aspen	J = Jack Pine	O = Oak	U = Upland Brush
B = Paper Birch	K = Rock	P = Lowland Poplar	UM = Upland Mix Forest
C = Cedar	L = Lowland Brush	Q = Mixed Swamp Conifer	V = Bog or Marsh
D = Treed Bog	LM = Lowland Mix Forest	R = Red Pine	W = White Pine
E = Swamp Hardwoods	M = Maple, Beech, Birch	S = Black Spruce	X = Non Stocked
F = Spruce/Fir	MC = Mixed Conifer	T = Tamarack	Y = Sand
G = Grass	MD = Mixed Deciduous	Z = Water	
H = Hemlock	N = Marsh		

Density

0 = Non Stocked	5 = Pole Timber Medium
1 = Seedling Sapling Poor	6 = Pole Timber Well
2 = Seedling Sapling Medium	7 = Saw Timber Poor
3 = Seedling Sapling Well	8 = Saw Timber Medium
4 = Pole Timber Poor	9 = Saw Timber Well

PU #	Acres
1	61.3

Quality Control Red Pine
61.3 Acres

Locator Map 1:200,000

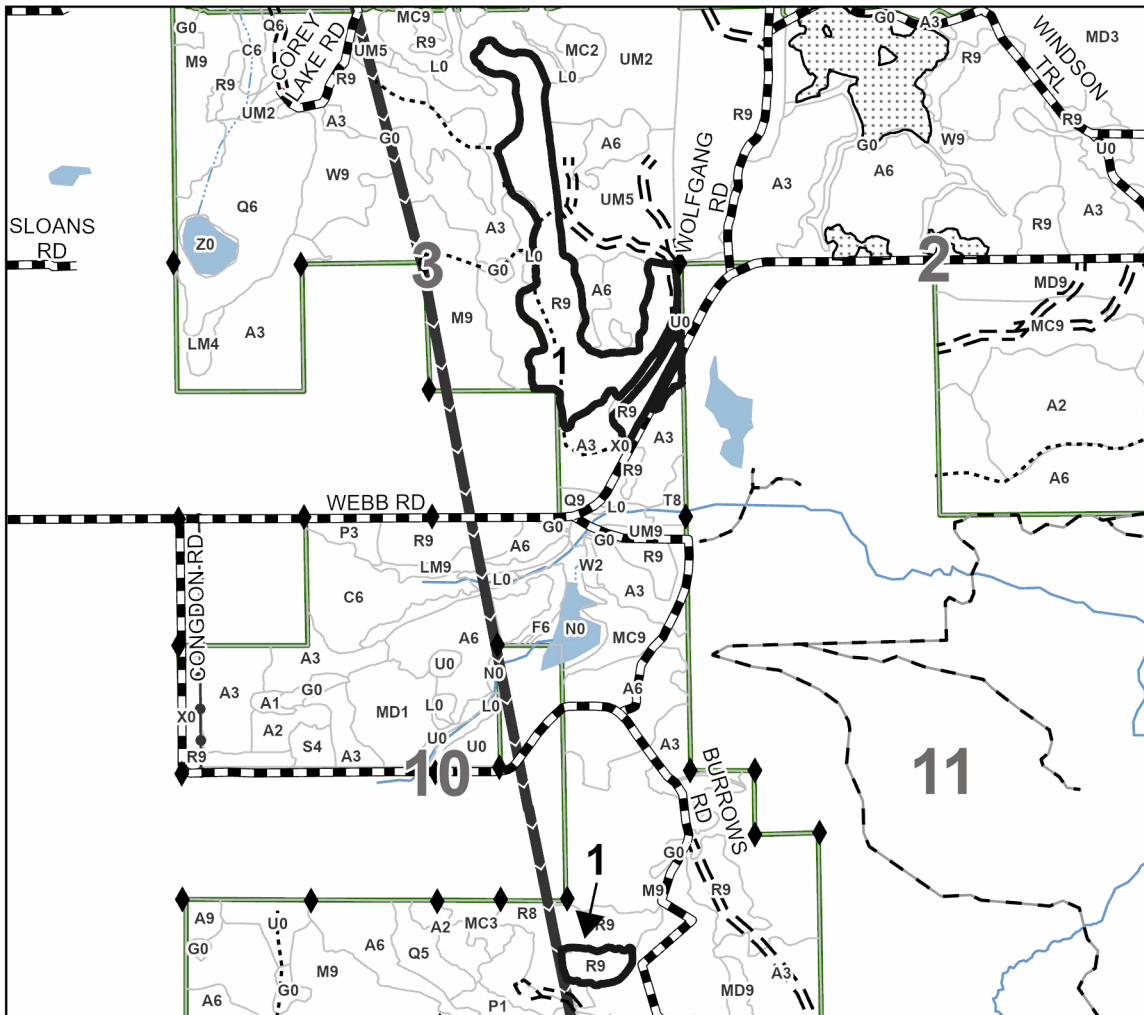
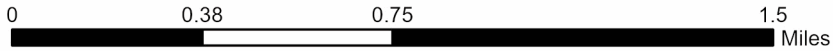
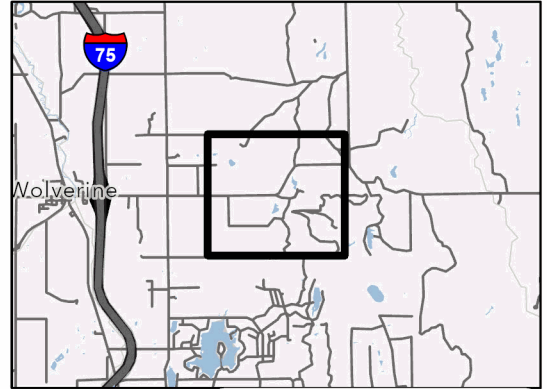

Legend

- Against State (Red)
- Forest Access Route
- Administrative Access Only
- Government Gravel/Dirt
- Private Gravel/Dirt
- Pipeline
- Powerline
- Survey Corners

Use QR Code to open Map in App

