



**DEPARTMENT OF NATURAL RESOURCES
STATE OF MICHIGAN
TIMBER SALE PROSPECTUS #7602**

SCHEDULED SALE DATE AND TIME: **9:00 a.m. (local time) on March 24, 2025.**

LOCATION: **GRAYLING MGMT UNIT, 1955 HARTWICK PINES ROAD, GRAYLING, MI 49738.**

CONTACT NAME: Scott McClarren

PHONE NUMBER: (989) 348-6371

PROSPECTUS NOTE: The bidder is advised to inspect the sale area and review the location, estimated volumes, operating costs and contract terms of proposed sales. Please be aware that some landowners may request 60 days or more notice for access across their land.

Notice is hereby given that bids will be received by the Unit Manager, GRAYLING MANAGEMENT UNIT, for certain timber on the following described lands:

Choppenheimer (72-620-24) / T28N, R02W, SEC. 10, E1/2NW,NE,NESW,NWSE.

Crawford County, Advertised Price \$56,366.90, 92.6 Acres, Aspen, Hardwood.

SALE NOTE: Please take note that this sale is on military land and that oak wilt specs apply. Oak wilt is being taken into consideration due to residual oak within the sale and oak component in adjacent stands. Due to these reasons, there is a 3 year contract to accommodate.

TIMBER SALE INFORMATION

Choppenheimer (72-620-24)

T28N, R02W, SEC. 10.

Crawford County (Advertised Price \$56,366.90)

SALE NOTE: Please take note that this sale is on military land and that oak wilt specs apply. Oak wilt is being taken into consideration due to residual oak within the sale and oak component in adjacent stands. Due to these reasons, there is a 3 year contract to accommodate.

A timber sale contract for this lump sum, sealed bid timber sale will be awarded to the responsible bidder offering the highest sealed bid price. All units of volume listed below were estimated using the Inventory Manager computer program and the new Michigan taper model. Bids must be at or above the following advertised price for each product and species:

<u>PRODUCTS & SPECIES</u>	<u>ESTIMATED UNITS*</u>	<u>ADVERTISED PRICE</u>
Sawtimber		
Mixed Oak	72.1 MBF	\$ 138.00 / MBF
Pulpwood		
Misc. Species 2	4 Cords	\$ 7.50 / Cord
Mixed Aspen	1,106 Cords	\$ 26.15 / Cord
Mixed Hardwood	221 Cords	\$ 32.15 / Cord
Mixed Oak	402 Cords	\$ 24.80 / Cord
White Pine	19 Cords	\$ 20.55 / Cord

* The total volume is statistically estimated within plus (+) or minus (-) 18.35 percent. There are an estimated 1,924 cords on this timber sale, plus or minus 353 cords at the 95% confidence level. The estimated units are final and not subject to adjustment. Prospective bidders are urged to examine this timber and to make their own estimates of quantity and quality.

BOND AND PAYMENT SCHEDULE:

1. A bond in the amount of \$2,818.35 to insure faithful performance of the conditions of the contract will be deposited by the successful bidder within 21 days of the sale award.
2. Cutting in any sale or unit without the required advance payment would be considered a trespass.
3. Total payment must be paid in advance or according to the following schedule :
 - (a) Ten percent (10%) of the sale value must be paid within 21 days of the sale award.
 - (b) The 10% down payment will be credited towards the first unit cut.
 - (c) Payment for each of the following units must be made before cutting begins in that unit:

PAYMENT UNIT NUMBER	PERCENT OF TOTAL SALE VALUE
01	49.2%
02	50.8%
4. If no cutting takes place, the 10% down payment will not be refunded.
5. Operations on the contract issued will terminate on 03/31/2028.

SALE STATISTICS

Volumes were calculated in cubic feet using the Michigan taper model. Cubic foot volume includes all wood inside bark for the product indicated. For display purposes, cubic feet were converted to cords and MBF using a simple conversion factor, e.g. 79 cubic feet per cord and 185 cubic feet per MBF. The cubic foot volumes are precise; the cords and MBF volumes are not. Cubic foot volume cannot be directly converted to cords or boards with precision.

SALE VOLUMES

The total estimated sale volume may not equal the sum of the species/products due to the nature of statistical calculations associated with double sampling methodology.

VOLUME		STATISTICAL RANGE IN CORDS		
TOTAL CUBIC FEET	TOTAL CORDS	PERCENT ERROR	MINIMUM	MAXIMUM
151,967	1,924	18.35%	1,571	2,277

VDU VOLUMES

A VDU is a Volume Determination Unit. Volumes and their associated statistics are calculated at the VDU level and summarized to the sale level. There is often a one to one relationship between a VDU and a Payment Unit, but not always, depending on the cruise design. Refer to the VDU TO PAYMENT UNIT table.

VDU	VOLUME		PERCENT ERROR	RANGE IN CORDS	
	TOTAL CUBIC FEET	TOTAL CORDS		MINIMUM	MAXIMUM
6	15,628	198	40.83%	117	279
8	109,392	1,385	22.45%	1,074	1,696
32	26,948	341	45.64%	185	497
TOTAL:	151,967	1,924		1,376	2,471

VDU TO PAYMENT UNIT

When a VDU is associated with more than one Payment Unit (PU), the VDU volumes are assigned to the PU based on acres of the VDU within the PU.

VDU	VDU ACRES	PU	PU ACRES
6	26.5	1	9.1
6	26.5	2	17.4
8	52.8	1	20.4
8	52.8	2	32.4
32	13.3	1	13.3
TOTAL:	171.9		92.6

DESCRIPTION OF TIMBER BY PU (PU)

PU	MARKET GROUP	PRODUCT	QUANTITY	UNIT	ACRES	ADVERTISE PRICE
1	Mixed Oak	Sawtimber	37.0	MBF	42.8	\$27,742.85
	/Red (Hybrid) Oak		1.7	MBF		
	Red Oak		35.3	MBF		
	Misc. Species 2	Pulpwood	1	Cords		
	Mixed Aspen		547	Cords		
	B. T. Aspen		454	Cords		
	Quaking Aspen		93	Cords		
	Mixed Hardwood		111	Cords		
	Red Maple	Sawtimber	6.6	MBF		
	Black Cherry	Pulpwood	3	Cords		
	Red Maple		95	Cords		
	Mixed Oak		186	Cords		
	/Red (Hybrid) Oak		3	Cords		
	Northern Pin Oak		2	Cords		
	Red Oak		181	Cords		
	White Pine		7	Cords		
	2	Mixed Oak	Sawtimber	35.1		
/Red (Hybrid) Oak			3.3	MBF		
Red Oak			31.8	MBF		
Misc. Species 2		Pulpwood	3	Cords		
Mixed Aspen			559	Cords		
B. T. Aspen			460	Cords		
Quaking Aspen			99	Cords		
Mixed Hardwood			110	Cords		
Red Maple		Sawtimber	1.9	MBF		
Black Cherry		Pulpwood	5	Cords		
Red Maple			101	Cords		
Mixed Oak			216	Cords		
/Red (Hybrid) Oak			7	Cords		
Northern Pin Oak			5	Cords		
Red Oak			204	Cords		
White Pine			12	Cords		
TOTAL:			72.1	MBF		
TOTAL:			1,752	Cords		

Sale Specific Conditions & Requirements

Sale Name: Choppenheimer

Sale Number: 72-620-24 Seq#: 2

1 - Sale Area

1.2 - Boundaries

1.2.1 - Painted Boundaries (9/19)

The sale boundary and Payment Unit boundaries are marked and identified with red and yellow paint, as well as roads. Exterior sale boundary lines against state are marked with red paint, with the exception of stretches of sale boundary that border Lonesome Lake Road, which is unpainted and designated by the road. Interior Payment Unit boundaries are marked with yellow paint. Retention patches are marked with red paint; no harvesting activities may occur within these areas. The painted red, exterior boundary line trees are not Included Timber and are to be protected. Yellow painted trees designating an interior Payment Unit boundary are only to be cut when all surrounding Payment Units have been paid.

2 - Timber Specifications

2.1 - Included Timber

2.1.1 - Clearcut Unit(s) with Unmerchantable Trees (6/14)

Within Payment Unit(s) 1 and 2, cut all trees that are two (2) inches or more at DBH, except do not cut any white oak or paper birch. These two species are not Included Timber and are to be protected.

2.1.11 - Description of Timber Note (2/04)

Note that Misc species 2 is dead oak. Also, Mixed Aspen was cruised entirely as pulp.

2.2 - Utilization

2.2.2 - Chipping required (2/18)

The Sale Area must be chip harvested to meet National Guard requirements. However, the chipping requirement could be waived with military approval, if chip markets are depressed. The requirement to retain approximately 1/6 to 1/3 of tree tops and limbs less than four inches in diameter does not apply (G. C. & R. 2.2). This is because these are non-certified military long-term lease lands.

2.2.3 - Stump heights (4/07)

Stump heights within the Sale Area shall not exceed 6 inches for all trees. This is in order to facilitate military requirements.

3 - Payments

3.3 - Pre-measured Sales

3.3.4 - Dividing Payment Units (7/14)

Payment Unit(s) 1 and 2 may be divided at the request of the Purchaser and upon approval of the Unit Manager. Dividing Payment Units is a contract modification which requires a Timber Sale Contract Amendment. There will be only one division per Payment Unit.

3.4 - Damaged Timber

3.4.1 - Damaged timber (7/16)

General Condition and Requirement 3.4 Damaged Timber, defines liquidated damages for undesignated live merchantable trees which are cut or injured. No damage is acceptable to undesignated live merchantable trees. Rates will be in accordance with General Condition and Requirement 3.4 Damaged Timber.

4 - Transportation

4.1 - Construction

4.1.3 - Slash and Earthen Piles (8/04)

Piles or windrows of earth along roads and landings that have been widened or constructed shall be leveled. Slash from road

maintenance or construction, including stumps, shall be chipped, utilized or otherwise removed from the sale.

4.1.6 - Road Construction (4/24)

Construction of new roads or improvements of existing roads shall be done in such a way as to minimize the environmental and visual impacts. Merchantable trees shall be cut and utilized unless otherwise directed. Non-merchantable trees shall be severed and laid flat on the ground. Slash shall be chipped, utilized or otherwise removed from the sale. Stumps shall be set upright, not left on edge, and be moved at least 10 feet away from the road edge. Disturbed soil shall be feathered into the woods and not left in berms or windrows.

4.1.7 - Road Closure (10/11)

All new roads built into the sale must be blocked to vehicle traffic upon completion of the sale. Overgrown roads that are reopened shall be considered new roads. Temporary berms may be required if no sale activity occurs for 30 or more consecutive days. Contact the Sale Administrator for specific details of design and placement.

4.1.11 - Permits (2/12)

The Purchaser will secure any necessary permits that may be required.

5 - Operations

5.1 - Notification

5.1.5 - National Guard notification (2/15)

This sale is upon lands utilized for training by the Michigan National Guard - Camp Grayling. A minimum of five (5) business days prior to opening this sale, the producer must request that the sale administrator contact the military for information regarding training plans that may impact sale operations.

5.2 - Conduct of Operations

5.2.2 - Hazard Trees/Snags

5.2.2.1 - Den Trees (10/16)

Obvious hollow and/or den trees shall be protected and left standing unless they are a safety hazard.

5.2.3 - Operating Restrictions

5.2.3.5 - Oak Wilt Restriction (1/18)

Within Payment Unit(s) 1 and 2, unless changed by written agreement, cutting, skidding, hauling within the sale and brushing of access roads to the sale are not permitted during the period of April 15 to July 15. Operations may be allowed if specific steps are taken to prevent damaging uncut oak during the high-risk period. Those steps may include completing all road brushing before April 15 and clearing a tree-length buffer along uncut oak cover before April 15. This is necessary to reduce the spread of oak wilt. For more information, contact the Unit Manager or his/her representative.

5.2.3.7 - National Guard training restriction (1/09)

Operations on this contract may not be allowed during National Guard training operations. Typically, the restricted period is from May 1 to October 31. The contractor must check with the Unit Manager who will coordinate the cutting schedule with the Military. All harvest equipment and timber products must be removed from the Sale Area during the period of May 1 to October 31, unless otherwise approved by the Unit Manager.

5.2.4 - Dead and Down Creation

5.2.4.1 - Dead and Down Creation, Marked Trees (10/13)

All trees marked with a band of orange paint must be felled and left on site for wildlife. These trees have been taken off the timber tally and are not Included Timber.

5.2.29 - Shrub Protection (1/20)

A reasonable effort should be made to protect from damage: hawthorn, hazelnut, or juneberry (serviceberry). These woody-shrub plants are highly beneficial to various wildlife species.

5.2.32 - Decking/Landing Restoration (9/13)

All decking and landing areas must have the surface area restored to a condition equal to or better than before. This is to ensure the proper regeneration of the stand. Wood debris, chips and "cookies" from trimmings must be removed or scattered

away from landing and loading areas and may not be windrowed on the edge.

5.2.38 - No Decking Against Live Trees (2/04)

Cut products may not be decked against unmarked or designated leave trees.

5.4 - Soil Protection

5.4.1 - Rutting Restriction, General (7/16)

Operations are to cease immediately if equipment and weather conditions result in rutting of roads and/or skid trails which is 12 inches or greater in depth and 50 feet in length. The Unit Manager or his/her representative may restrict hauling and/or skidding if ruts exceed the specified depth. With the Unit Manager or his/her representative's approval, the Purchaser may return to the area when the risk of rutting has decreased.

5.4.2 - Skid Trails (2/04)

Skid trails up and down slopes should be avoided. If, however, this is unavoidable, these trails will be left in a non-erodible condition using water bars, logs, and slash. Placing of slash on these skid trails while logging is ongoing may alleviate need for any further action. At the direction of the Sale Administrator, seed, fertilizer, and mulch may also be required.

5.8 - Protection of Endangered Species

5.8.5 - Protection of Raptor Nests (3/13)

All trees with raptor nests will be protected if found during harvesting operations. Notification will be made to the Unit Manager or his/her representative who will notify the Wildlife Biologist so an onsite evaluation and recommendation can be made, if necessary.

6 - Safety and Fire Prevention

6.2 - Signing

6.2.1 - Road Posting (10/20)

The Purchaser is responsible for posting and maintaining caution signs on Lonesome Lake Road prior to beginning operations. The road must be posted at appropriate distances from the Sale Area that are approved by the Sale Administrator to warn of logging activity and truck traffic. Signs must be removed when harvest operations are suspended or completed. The Purchaser will provide these signs.

SKIP

6.4 - Unexploded Ordinance (7/15)

Be aware that the Sale Area could contain UXO (unexploded ordinances). Do not touch or drive over any metal objects. If any objects are found, please flag the area and notify the Unit Manager or his/her representative, so that they can make arrangements with the Military.

7 - Other Conditions

7.10 - Certified Timber

7.10.1 - Non-Certified Timber (2/16)

The area encompassed by this timber sale is not certified to the standards of the Forest Stewardship Council (FSC) or the Sustainable Forestry Initiative (SFI). Forest products from this sale may not be delivered to the mill as "FSC and / or SFI certified". The lands within this sale are managed for military training.



TIMBER SALE MAP

This information provided by authority of Part 525, 1994 PA 451, as amended.

Sale Number
72-620-24

Date
01/10/2025

Forest Management Unit	County	Mapped By: Jake Halabut
Grayling Mgt Unit	Crawford	Cruised By: Jake Halabut

Scale	Page	Of
1:20,000	1	1

Township	Range	Section(s) and Subdivision(s)
28N	02W	Sec. 10 E1/2NW,NE,NESW,NWSE; Sec. 3 SESW, SWSE

Cover Type

A = Aspen	J = Jack Pine	O = Oak	U = Upland Brush
B = Paper Birch	K = Rock	P = Lowland Poplar	UM = Upland Mix Forest
C = Cedar	L = Lowland Brush	Q = Mixed Swamp Conifer	V = Bog or Marsh
D = Treed Bog	LM = Lowland Mix Forest	R = Red Pine	W = White Pine
E = Swamp Hardwoods	M = Maple, Beech, Birch	S = Black Spruce	X = Non Stocked
F = Spruce/Fir	MC = Mixed Conifer	T = Tamarack	Y = Sand
G = Grass	MD = Mixed Deciduous	Z = Water	
H = Hemlock	N = Marsh		

Density

0 = Non Stocked	5 = Pole Timber Medium
1 = Seedling Sapling Poor	6 = Pole Timber Well
2 = Seedling Sapling Medium	7 = Saw Timber Poor
3 = Seedling Sapling Well	8 = Saw Timber Medium
4 = Pole Timber Poor	9 = Saw Timber Well

PU #	Acres
1	42.8
2	49.7

Choppenheimer
92.6 Acres
Compartment 268, 269

Locator Map (1:200,000)

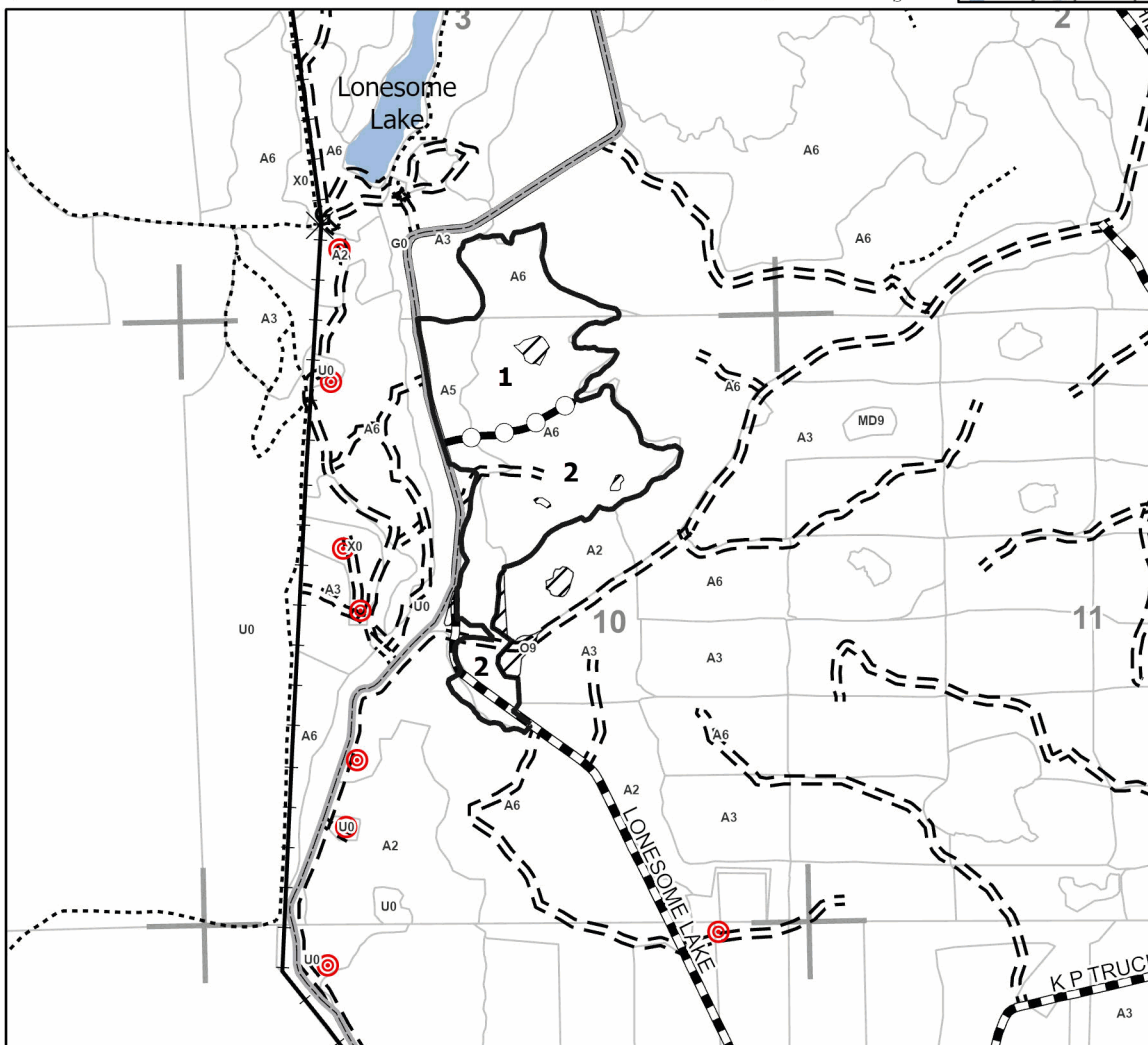
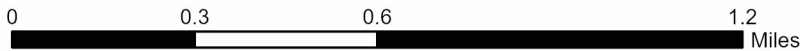
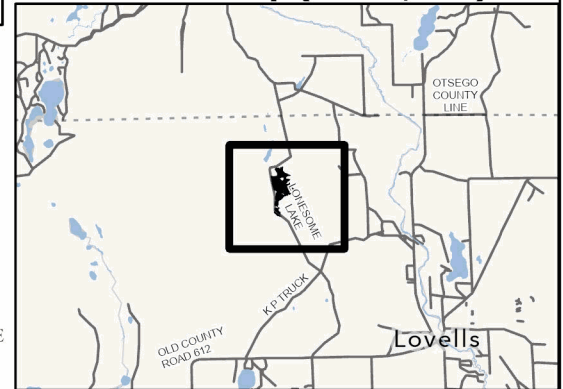

Legend

- Against State (Red/Unmarked Rd)
- Payment Unit (Yellow)
- Stand
- Retention Area
- Primary Forest Road
- Forest Access Route
- Administrative Access Only
- Paved Road
- Government Gravel/Dirt
- Private Gravel/Dirt
- CampGraylingGates
- CampGraylingFence
- CampGraylingFiringPoint
- Lakes and Rivers
- MIRIS Section Corner

Use QR Code to open Map in App

