



**DEPARTMENT OF NATURAL RESOURCES  
STATE OF MICHIGAN  
TIMBER SALE PROSPECTUS #7602**

SCHEDULED SALE DATE AND TIME: **9:00 a.m. (local time) on March 24, 2025.**

LOCATION: **GRAYLING MGMT UNIT, 1955 HARTWICK PINES ROAD, GRAYLING, MI 49738.**

CONTACT NAME: Scott McClarren

PHONE NUMBER: (989) 348-6371

PROSPECTUS NOTE: The bidder is advised to inspect the sale area and review the location, estimated volumes, operating costs and contract terms of proposed sales. Please be aware that some landowners may request 60 days or more notice for access across their land.

Notice is hereby given that bids will be received by the Unit Manager, GRAYLING MANAGEMENT UNIT, for certain timber on the following described lands:

Missin' Merle Mix (72-630-24) / T28N, R02W, SEC. 29, W1/2NW,NWSW.

T28N, R02W, SEC. 30, S1/2NW,SENE,N1/2SW,N1/2SE,SWSE.

Crawford County, Advertised Price \$48,190.65, 89.2 Acres, Hardwood, Red Pine.

SALE NOTE: Timber/composite mats required if trucking wood from Payment Unit 3 due to road crossing through lowland drain. Corduroyed slash may be used if skidding wood from Payment Unit 3 into Payment Unit 4 with Sale Administrator approval. Material must be cleaned out of drain and left rut free after wood has been skidded out.

Sale not on certified land. Military land, chipping required, contains standard military specs. Contract has 4-year duration due to military timing restrictions. Soft Oak wilt timing restrictions applied for Payment Units 3-5 however, the DNR may deny any requests to operate during the restricted time frame.

# TIMBER SALE INFORMATION

Missin' Merle Mix (72-630-24)

T28N, R02W, SEC. 29; T28N, R02W, SEC. 30.

Crawford County (Advertised Price \$48,190.65)

SALE NOTE: Timber/composite mats required if trucking wood from Payment Unit 3 due to road crossing through lowland drain. Corduroyed slash may be used if skidding wood from Payment Unit 3 into Payment Unit 4 with Sale Administrator approval. Material must be cleaned out of drain and left rut free after wood has been skidded out.

Sale not on certified land. Military land, chipping required, contains standard military specs. Contract has 4-year duration due to military timing restrictions. Soft Oak wilt timing restrictions applied for Payment Units 3-5 however, the DNR may deny any requests to operate during the restricted time frame.

A timber sale contract for this lump sum, sealed bid timber sale will be awarded to the responsible bidder offering the highest sealed bid price. All units of volume listed below were estimated using the Inventory Manager computer program and the new Michigan taper model. Bids must be at or above the following advertised price for each product and species:

<u>PRODUCTS &amp; SPECIES</u>	<u>ESTIMATED UNITS*</u>		<u>ADVERTISED PRICE</u>
Sawtimber			
Black/Red (Hybrid) Oak	56.8	MBF	\$ 138.00 / MBF
Pulpwood			
Balsam Fir	24	Cords	\$ 24.10 / Cord
Jack Pine	66	Cords	\$ 23.35 / Cord
Mixed Aspen	195	Cords	\$ 26.15 / Cord
Mixed Hardwood	24	Cords	\$ 32.15 / Cord
Mixed Oak	450	Cords	\$ 24.80 / Cord
Red Pine	314	Cords	\$ 48.15 / Cord
White Pine	296	Cords	\$ 20.55 / Cord

\* The total volume is statistically estimated within plus (+) or minus (-) 14.26 percent. There are an estimated 1,502 cords on this timber sale, plus or minus 214 cords at the 95% confidence level. The estimated units are final and not subject to adjustment. Prospective bidders are urged to examine this timber and to make their own estimates of quantity and quality.

**BOND AND PAYMENT SCHEDULE:**

1. A bond in the amount of \$2,409.53 to insure faithful performance of the conditions of the contract will be deposited by the successful bidder within 21 days of the sale award.
2. Cutting in any sale or unit without the required advance payment would be considered a trespass.
3. Total payment must be paid in advance or according to the following schedule :
  - (a) Ten percent (10%) of the sale value must be paid within 21 days of the sale award.
  - (b) The 10% down payment will be credited towards the first unit cut.
  - (c) Payment for each of the following units must be made before cutting begins in that unit:

PAYMENT UNIT NUMBER	PERCENT OF TOTAL SALE VALUE
01	22.7%
02	25.2%
03	9.1%
04	17.6%
05	25.4%

4. If no cutting takes place, the 10% down payment will not be refunded.
5. Operations on the contract issued will terminate on 03/31/2029.

**SALE STATISTICS**

Volumes were calculated in cubic feet using the Michigan taper model. Cubic foot volume includes all wood inside bark for the product indicated. For display purposes, cubic feet were converted to cords and MBF using a simple conversion factor, e.g. 79 cubic feet per cord and 185 cubic feet per MBF. The cubic foot volumes are precise; the cords and MBF volumes are not. Cubic foot volume cannot be directly converted to cords or boards with precision.

**SALE VOLUMES**

The total estimated sale volume may not equal the sum of the species/products due to the nature of statistical calculations associated with double sampling methodology.

VOLUME			STATISTICAL RANGE IN CORDS	
TOTAL CUBIC FEET	TOTAL CORDS	PERCENT ERROR	MINIMUM	MAXIMUM
118,684	1,502	14.26%	1,288	1,717

**VDU VOLUMES**

A VDU is a Volume Determination Unit. Volumes and their associated statistics are calculated at the VDU level and summarized to the sale level. There is often a one to one relationship between a VDU and a Payment Unit, but not always, depending on the cruise design. Refer to the VDU TO PAYMENT UNIT table.

	VOLUME			RANGE IN CORDS	
VDU	TOTAL CUBIC FEET	TOTAL CORDS	PERCENT ERROR	MINIMUM	MAXIMUM
11	54,837	694	24.30%	525	863
27	9,977	126	35.38%	82	171
39	53,870	682	19.11%	552	812
<b>TOTAL:</b>	<b>118,684</b>	<b>1,502</b>		<b>1,159</b>	<b>1,846</b>

**VDU TO PAYMENT UNIT**

When a VDU is associated with more than one Payment Unit (PU), the VDU volumes are assigned to the PU based on acres of the VDU within the PU.

VDU	VDU ACRES	PU	PU ACRES
11	21.2	1	10.1
11	21.2	2	11.1
27	15.7	3	15.7
39	52.3	4	21.3
39	52.3	5	31.0
<b>TOTAL:</b>	<b>162.7</b>		<b>89.2</b>

**DESCRIPTION OF TIMBER BY PU (PU)**

PU	MARKET GROUP	PRODUCT	QUANTITY	UNIT	ACRES	ADVERTISE PRICE
1	Balsam Fir	Pulpwood	10	Cords	10.1	\$10,937.95
	<i>Balsam Fir</i>		10	<i>Cords</i>		
	Jack Pine		22	Cords		
	Mixed Aspen		81	Cords		
	<i>B. T. Aspen</i>		40	<i>Cords</i>		
	<i>Quaking Aspen</i>		41	<i>Cords</i>		
	Mixed Hardwood		8	Cords		
	<i>Paper Birch</i>		1	<i>Cords</i>		
	<i>Red Maple</i>		7	<i>Cords</i>		
	Mixed Oak		5	Cords		
	<i>/Red (Hybrid) Oak</i>		5	<i>Cords</i>		
	Red Pine		128	Cords		
	White Pine		74	Cords		
	<i>White Pine</i>		74	<i>Cords</i>		
2	Balsam Fir	Pulpwood	12	Cords	11.1	\$12,149.00
	<i>Balsam Fir</i>		12	<i>Cords</i>		
	Jack Pine		25	Cords		
	Mixed Aspen		91	Cords		
	<i>B. T. Aspen</i>		45	<i>Cords</i>		
	<i>Quaking Aspen</i>		46	<i>Cords</i>		
	Mixed Hardwood		10	Cords		
	<i>Paper Birch</i>		2	<i>Cords</i>		
	<i>Red Maple</i>		8	<i>Cords</i>		
	Mixed Oak		6	Cords		
	<i>/Red (Hybrid) Oak</i>		6	<i>Cords</i>		
	Red Pine		140	Cords		
	White Pine		82	Cords		
	<i>White Pine</i>		82	<i>Cords</i>		
3	Black/Red (Hybrid)	Sawtimber	15.9	MBF	15.7	\$4,371.85
	Balsam Fir	Pulpwood	2	Cords		
	<i>Tamarack</i>		2	<i>Cords</i>		
	Jack Pine		3	Cords		
	Mixed Aspen		9	Cords		
	<i>Quaking Aspen</i>		9	<i>Cords</i>		
	Mixed Hardwood		6	Cords		
	<i>Black Cherry</i>		1	<i>Cords</i>		
	<i>Paper Birch</i>		5	<i>Cords</i>		
	Mixed Oak		55	Cords		
	<i>/Red (Hybrid) Oak</i>		55	<i>Cords</i>		
	White Pine		13	Cords		
	<i>White Pine</i>	Sawtimber	2.9	<i>MBF</i>		
	<i>White Pine</i>	Pulpwood	7	<i>Cords</i>		
4	Black/Red (Hybrid)	Sawtimber	16.7	MBF	21.3	\$8,477.20
	Jack Pine	Pulpwood	7	Cords		
	Mixed Aspen		6	Cords		
	<i>Quaking Aspen</i>		6	<i>Cords</i>		
	Mixed Oak		156	Cords		
	<i>White Oak</i>	Sawtimber	0.2	<i>MBF</i>		
	<i>/Red (Hybrid) Oak</i>	Pulpwood	154	<i>Cords</i>		
	<i>White Oak</i>		2	<i>Cords</i>		
	Red Pine		19	Cords		
	White Pine		52	Cords		
	<i>White Pine</i>		52	<i>Cords</i>		
5	Black/Red (Hybrid)	Sawtimber	24.2	MBF	31.0	\$12,254.65
	Jack Pine	Pulpwood	9	Cords		

**DESCRIPTION OF TIMBER BY PU (PU), CON'T**

PU	MARKET GROUP	PRODUCT	QUANTITY	UNIT	ACRES	ADVERTISE PRICE
5 con't	Mixed Aspen	Pulpwood	8	Cords		
	<i>Quaking Aspen</i>		8	<i>Cords</i>		
	Mixed Oak		228	Cords		
	<i>White Oak</i>	<i>Sawtimber</i>	0.3	<i>MBF</i>		
	<i>/Red (Hybrid) Oak</i>	<i>Pulpwood</i>	223	<i>Cords</i>		
	<i>White Oak</i>		4	<i>Cords</i>		
	Red Pine		27	Cords		
	White Pine		75	Cords		
	<i>White Pine</i>		75	<i>Cords</i>		
TOTAL:			56.8	MBF		
TOTAL:			1,369	Cords		

## Sale Specific Conditions & Requirements

Sale Name: Missin' Merle Mix

Sale Number: 72-630-24 Seq#: 2

### 1 - Sale Area

#### 1.2 - Boundaries

##### 1.2.1 - Painted Boundaries (9/19)

The sale boundary and Payment Unit boundaries are marked and identified by blue, red and yellow paint, as well as roads. Exterior sale boundary lines against private property are marked with blue paint. Exterior sale boundary lines against state are marked with red paint. Interior Payment Unit boundaries are marked with yellow paint, with the exception of some sale boundaries that are unpainted and designated by existing roads as shown on the Timber Sale Map. Retention patches are marked with red paint; no harvesting activities may occur within these areas. The painted boundary line trees are not Included Timber and are to be protected. Yellow painted trees designating an interior Payment Unit boundary are only to be cut when all surrounding Payment Units have been paid.

### 2 - Timber Specifications

#### 2.1 - Included Timber

##### 2.1.1 - Clearcut Unit(s) with Unmerchantable Trees (6/14)

Within Payment Unit(s) 1, 2, 4, and 5, cut all trees that are two (2) inches or more at DBH, except do not cut trees that are 26 inches or more at DBH.

Special protection trees identified in accordance with condition 3.4.2. within clearcutting unit boundaries, are not included timber and are to be protected.

##### 2.1.5 - Overstory Removal Unit(s) (8/11)

Within Payment Unit(s) 3, all trees which meet minimum piece specifications in 2.2 Utilization, are designated for cutting.

Special protection trees identified in accordance with condition 3.4.2, within clearcutting unit boundaries, are not Included Timber and are to be protected.

#### 2.2 - Utilization

##### 2.2.2 - Chipping required (2/18)

This area, Payment Unit(s) 1-5, must be chip harvested to meet National Guard requirements. However, the chipping requirement could be waived with military approval, if chip markets are depressed. The Purchaser has the option to produce sawlogs or pulpwood bolts, but the remaining portion of the trees must be chipped and hauled. The requirement to retain approximately 1/6 to 1/3 of tree tops and limbs less than four inches in diameter does not apply (G.C. & R. 2.2). This is because this is non-certified military land.

##### 2.2.3 - Stump heights (4/07)

Stump heights within the Sale Area shall not exceed 6 inches for all trees. This is in order to facilitate military requirements.

### 3 - Payments

#### 3.4 - Damaged Timber

##### 3.4.1 - Damaged timber (7/16)

General Condition and Requirement 3.4 Damaged Timber, defines liquidated damages for undesignated live merchantable trees which are cut or injured. In addition, care should be taken to avoid damage to tree seedlings and saplings. Within Payment Unit 3, if more than 30% of the tree seedlings or saplings (1/4" to 4.5" DBH) within a specified portion of the Sale Area are damaged, liquidated damages will be assessed at \$400 per acre for all acreage within that specified portion of the Sale Area that was damaged. Trees cut cleanly for skid trails will not count as damaged.

##### 3.4.2 - Special Protection Trees (1/25)

The Purchaser shall not cut live or dead special protection trees within cutting units or clearings. Special protection trees are

marked with orange paint or any trees over 26" DBH. If Purchaser's operations have cut or damaged special protection trees through carelessness, the Purchaser shall pay \$500 as fixed, agreed and liquidated damages for each special protection tree cut or damaged. Such payment does not constitute ownership of the undesignated timber.

## **4 - Transportation**

### 4.1 - Construction

#### 4.1.3 - Slash and Earthen Piles (8/04)

Piles or windrows of earth along roads and landings that have been widened or constructed shall be leveled. Slash from road maintenance or construction, including stumps, shall be chipped, utilized, or otherwise removed from the sale.

#### 4.1.6 - Road Construction (4/24)

Improvements of existing roads shall be done in such a way as to minimize the environmental and visual impacts. Merchantable trees shall be cut and utilized unless otherwise directed. Non-merchantable trees shall be severed and laid flat on the ground. Slash shall be chipped, utilized, or otherwise removed from the sale. Stumps shall be set upright, not left on edge, and be moved at least 10 feet away from the road edge. Disturbed soil shall be feathered into the woods and not left in berms or windrows.

#### 4.1.7 - Road Closure (10/11)

All new roads built into the sale must be blocked to vehicle traffic upon completion of the sale. Overgrown roads that are reopened shall be considered new roads. Some existing roads may also need to be closed. In general, this will require constructing a four (4') foot high berm of stumps and logs covered with earth. These roads must be rendered impassable to cars and trucks. All stumps from road building and landing construction must be reserved to block any newly constructed roads upon completion of the sale. These stumps must be scattered along the road system to prohibit vehicular movement. Temporary berms may be required if no sale activity occurs for 30 or more consecutive days. Contact the Sale Administrator for specific details of design and placement.

### 4.2 - Maintenance

#### 4.2.1 - Hauling Restriction (12/08)

Hauling may be restricted on forest roads by the Unit Manager or his/her representative. The restriction may be placed on forest road accessing Payment Unit 3 from the east, and may occur during wet weather conditions.

## **5 - Operations**

### 5.1 - Notification

#### 5.1.4 - Post-Sale Conference (10/16)

A post-sale conference on site between the Purchaser and sale administrator is required 5 days prior to the completion of active logging operations to determine clean-up and repair of landings, road edges, and the fulfillment of other contract specifications.

#### 5.1.5 - National Guard notification (2/15)

This sale is upon lands utilized for training by the Michigan National Guard - Camp Grayling. A minimum of five (5) business days prior to opening this sale, the producer must request that the sale administrator contact the military for information regarding training plans that may impact sale operations.

#### 5.1.6 - Utility R.O.W. (4/19)

It is the responsibility of the Purchaser to obtain permission from the utility company to utilize the power line R.O.W. for operations.

### 5.2 - Conduct of Operations

#### 5.2.2 - Hazard Trees/Snags

##### 5.2.2.1 - Den Trees (10/16)

Obvious hollow and/or den trees shall be protected and left standing unless they are a safety hazard.

#### 5.2.3 - Operating Restrictions

#### 5.2.3.5 - Oak Wilt Restriction (1/18)

Within Payment Unit(s) 3-5, unless changed by written agreement, cutting, skidding, hauling within the sale and brushing of access roads to the sale are not permitted during the period of April 15 to July 15. Operations may be allowed if specific steps are taken to prevent damaging uncut oak during the high-risk period. Those steps may include completing all road brushing before April 15 and clearing a tree-length buffer along uncut oak cover before April 15. This is necessary to reduce the spread of oak wilt. For more information, contact the Unit Manager or his/her representative.

#### 5.2.3.7 - National Guard training restriction (1/09)

Operations on this contract may not be allowed during National Guard training operations. Typically, the restricted period is from May 1 to October 31. The contractor must check with the Unit Manager who will coordinate the cutting schedule with the Military.

#### 5.2.4 - Dead and Down Creation

##### 5.2.4.4 - Dead and Down Creation, Grouse (6/18)

To encourage grouse and other wildlife, in Payment Unit(s) 1 and 2 leave one 12-inch or larger diameter (or largest diameter trees within stand) whole tree on the ground for every 2 acres, preferably a hardwood species such as oak or maple or if no hardwoods are present, a pine species (white or red). These trees will be evenly scattered throughout the unit, preferably at least two chains from any roads, two-tracks, or trails open to vehicles. This can be an unmerchantable piece or a full tree.

#### 5.2.17 - Timber Mats and Interlocking Composite Mats (5/23)

Some roads or skid trails may require extra protection such as that afforded by timber mats, interlocking composite mats, or another approved system. Approximately 75 feet of road or trail may need extra protection in Aspen stand between Payment Units 3 and 4. If available, mats may be borrowed from the DNR. A Timber Sale Contract Amendment will be used to document the Purchaser's use of the DNR's mats. Contact the Sale Administrator regarding availability and pick-up. Timber mats are available from various field offices. Composite mats are only available from the Grayling field office and the Marquette ICC. The Purchaser is responsible for picking up and hauling the mats to and from the site. The composite mats will require DNR staff onsite for installation and removal. Contact the Sale Administrator to schedule at least 30 days before desired install/removal date. All mats must be cleaned prior to drop off. This may include, but is not limited to, power washing and brushing to remove mud and debris. A charge of \$700.00 per timber mat and \$2,000.00 per composite mat will be assessed for all damaged or non-returned mats. Damage for the crane/timber mats is defined as three or more broken cants. Damage for the composite mats is defined as cracked or broken mats.

#### 5.2.29 - Shrub Protection (1/20)

Reasonable care should be taken to avoid cutting hawthorn, dogwood or junberry. These woody-shrub plants are highly beneficial to various wildlife species.

#### 5.2.32 - Decking/Landing Restoration (9/13)

All decking and landing areas must have the surface area restored to a condition equal to or better than before. This is to ensure the proper regeneration of the stand. Wood debris, chips and "cookies" from trimmings must be removed or scattered away from landing and loading areas and may not be windrowed on the edge.

#### 5.2.43 - Opening Protection (2/21)

No activities are permitted in openings marked on the Timber Sale Map with the letter "G". Any damage to the openings shall be repaired according to specifications of the Unit Manager or his/her representative.

#### 5.8 - Protection of Endangered Species

##### 5.8.5 - Protection of Raptor Nests (3/13)

All trees with raptor nests will be protected if found during harvesting operations. Notification will be made to the Unit Manager or his/her representative who will notify the Wildlife Biologist so an onsite evaluation and recommendation can be made, if necessary.

## 6 - Safety and Fire Prevention

#### 6.2 - Signing

##### 6.2.1 - Road Posting (10/20)

The Purchaser is responsible for posting and maintaining caution signs on County Road 612 and Kinney Road prior to



beginning operations. The road must be posted at appropriate distances from the Sale Area to warn of logging activity and truck traffic. Signs must be removed when harvest operations are suspended or completed. The Purchaser will provide these signs.

## **7 - Other Conditions**

### 7.10 - Certified Timber

#### 7.10.1 - Non-Certified Timber (2/16)

The area encompassed by this timber sale is not certified to the standards of the Forest Stewardship Council (FSC) or the Sustainable Forestry Initiative (SFI). Forest products from this sale may not be delivered to the mill as "FSC and / or SFI certified". The lands within this sale are managed for military training.



**TIMBER SALE MAP**

This information provided by authority of Part 525, 1994 PA 451, as amended.

Sale Number <b>72-630-24</b>	Date <b>01/15/2025</b>	
Scale <b>1:10,000</b>	Page <b>1</b>	Of <b>1</b>

Forest Management Unit Grayling Mgt Unit	County Crawford	Mapped By: Porteous Cruised By: Porteous
---	--------------------	---

Township 28N	Range 02W	Section(s) and Subdivision(s) Sec. 29 W1/2NW,NWSW; Sec. 30 S1/2NW,SENE,N1/2SW,N1/2SE,SWSE;
-----------------	--------------	---

Cover Type			
A = Aspen	J = Jack Pine	O = Oak	U = Upland Brush
B = Paper Birch	K = Rock	P = Lowland Poplar	UM = Upland Mix Forest
C = Cedar	L = Lowland Brush	Q = Mixed Swamp Conifer	V = Bog or Marsh
D = Treed Bog	LM = Lowland Mix Forest	R = Red Pine	W = White Pine
E = Swamp Hardwoods	M = Maple, Beech, Birch	S = Black Spruce	X = Non Stocked
F = Spruce/Fir	MC = Mixed Conifer	T = Tamarack	Y = Sand
G = Grass	MD = Mixed Deciduous	Z = Water	
H = Hemlock	N = Marsh		

Density	
0 = Non Stocked	5 = Pole Timber Medium
1 = Seedling Sapling Poor	6 = Pole Timber Well
2 = Seedling Sapling Medium	7 = Saw Timber Poor
3 = Seedling Sapling Well	8 = Saw Timber Medium
4 = Pole Timber Poor	9 = Saw Timber Well

**Missin' Merle Mix**  
89.2 Acres

PU #	Acres	PU #	Acres
1	10.1	4	21.3
2	11.1	5	31.1
3	15.7		

**LEGEND**

- ◇ Field Grade Corner
- ⊙ Military Firing Point
- - - Forest Road
- ▬ County Road
- ⋯ Administrative Access Road
- Powerline
- MIRIS Section Corner
- ▬▬▬ Lowland Drain
- ▬ Lakes and Rivers
- ▨ Maintained Wildlife Opening

**Sale Boundary**

- ▬ Against State (Red)
- ▬ Against State (Road)
- ▬ Private Line (Blue)
- Payment Unit (Yellow)
- Payment Unit (Road)
- ▨ Retention Areas

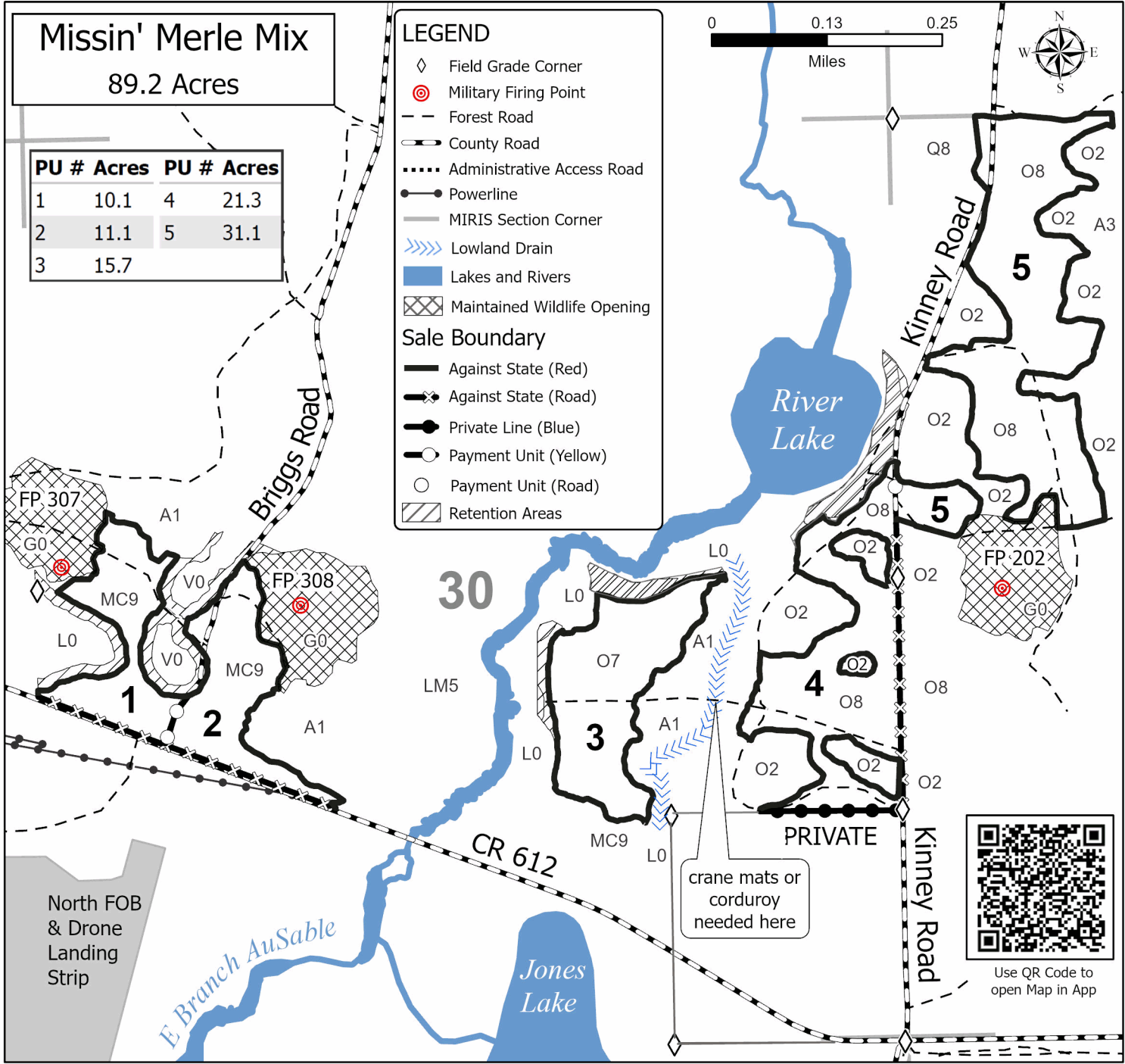
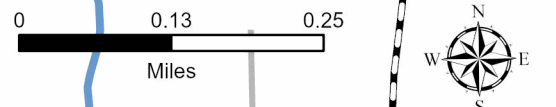

Use QR Code to open Map in App