



**DEPARTMENT OF NATURAL RESOURCES  
STATE OF MICHIGAN  
TIMBER SALE PROSPECTUS #7602**

**SCHEDULED SALE DATE AND TIME: 9:00 a.m. (local time) on March 24, 2025.**

**LOCATION: GRAYLING MGMT UNIT, 1955 HARTWICK PINES ROAD, GRAYLING, MI 49738.**

**CONTACT NAME: Scott McClarren**

**PHONE NUMBER: (989) 348-6371**

**PROSPECTUS NOTE:** The bidder is advised to inspect the sale area and review the location, estimated volumes, operating costs and contract terms of proposed sales. Please be aware that some landowners may request 60 days or more notice for access across their land.

Notice is hereby given that bids will be received by the Unit Manager, GRAYLING MANAGEMENT UNIT, for certain timber on the following described lands:

Red Shouldered Pine Re-Do (72-004-25) / T28N, R03W, SEC. 31, S1/2NW,SW.  
T28N, R03W, SEC. 33, E1/2NE,NESE.

Crawford County, Advertised Price \$57,250.35, 76.9 Acres, Red Pine.

SALE NOTE: Timber sale contains bark beetle and bark slippage restrictions.

Payment Unit 3 is a mortality pocket where all red pine (dead and alive) must be cut and removed regardless of merchantability.

No operations are to take place from March 15-July 15 within Payment Unit 4 due to the presence of a hawk nest.

Opening adjacent to Payment Unit 1 as show on timber sale map must be protected and may not be used for a landing.

If operations take place along pipeline east of Payment Unit 1, contact DTE at (231) 258-3750.

An adjacent landowner uses the road through Payment Unit 1 for access year-round and maintains the road through an existing easement. This road must be maintained in 2-wheel drive condition and remain open throughout the duration of the contract.

# TIMBER SALE INFORMATION

Red Shouldered Pine Re-Do (72-004-25)  
 T28N, R03W, SEC. 31; T28N, R03W, SEC. 33.  
 Crawford County (Advertised Price \$57,250.35)

SALE NOTE: Timber sale contains bark beetle and bark slippage restrictions .

Payment Unit 3 is a mortality pocket where all red pine (dead and alive) must be cut and removed regardless of merchantability.

No operations are to take place from March 15-July 15 within Payment Unit 4 due to the presence of a hawk nest.

Opening adjacent to Payment Unit 1 as show on timber sale map must be protected and may not be used for a landing.

If opertions take place along pipeline east of Payment Unit 1, contact DTE at (231) 258-3750.

An adjacent landowner uses the road through Payment Unit 1 for access year-round and maintains the road through an existing easement. This road must be maintained in 2-wheel drive condition and remain open throughout the duration of the contract.

A timber sale contract for this lump sum, sealed bid timber sale will be awarded to the responsible bidder offering the highest sealed bid price . All units of volume listed below were estimated using the Inventory Manager computer program and the new Michigan taper model. Bids must be at or above the following advertised price for each product and species:

<u>PRODUCTS &amp; SPECIES</u>	<u>ESTIMATED UNITS*</u>	<u>ADVERTISED PRICE</u>
Pulpwood		
Red Pine	1,189 Cords	\$ 48.15 / Cord

\* The total volume is statistically estimated within plus (+) or minus (-) 14.31 percent. There are an estimated 1,189 cords on this timber sale, plus or minus 170 cords at the 95% confidence level. The estimated units are final and not subject to adjustment. Prospective bidders are urged to examine this timber and to make their own estimates of quantity and quality.

**BOND AND PAYMENT SCHEDULE:**

1. A bond in the amount of \$2,862.52 to insure faithful performance of the conditions of the contract will be deposited by the successful bidder within 21 days of the sale award.
2. Cutting in any sale or unit without the required advance payment would be considered a trespass.
3. Total payment must be paid in advance or according to the following schedule :
  - (a) Ten percent (10%) of the sale value must be paid within 21 days of the sale award.
  - (b) The 10% down payment will be credited towards the first unit cut.
  - (c) Payment for each of the following units must be made before cutting begins in that unit:

PAYMENT UNIT NUMBER	PERCENT OF TOTAL SALE VALUE
01	53.7%
02	22.8%
03	6.3%
04	17.2%
4. If no cutting takes place, the 10% down payment will not be refunded.
5. Operations on the contract issued will terminate on 09/30/2026.

**SALE STATISTICS**

Volumes were calculated in cubic feet using the Michigan taper model. Cubic foot volume includes all wood inside bark for the product indicated. For display purposes, cubic feet were converted to cords and MBF using a simple conversion factor, e.g. 79 cubic feet per cord and 185 cubic feet per MBF. The cubic foot volumes are precise; the cords and MBF volumes are not. Cubic foot volume cannot be directly converted to cords or boards with precision.

**SALE VOLUMES**

The total estimated sale volume may not equal the sum of the species/products due to the nature of statistical calculations associated with double sampling methodology.

VOLUME		STATISTICAL RANGE IN CORDS		
TOTAL CUBIC FEET	TOTAL CORDS	PERCENT ERROR	MINIMUM	MAXIMUM
93,946	1,189	14.31%	1,019	1,359

**VDU VOLUMES**

A VDU is a Volume Determination Unit. Volumes and their associated statistics are calculated at the VDU level and summarized to the sale level. There is often a one to one relationship between a VDU and a Payment Unit, but not always, depending on the cruise design. Refer to the VDU TO PAYMENT UNIT table.

VDU	VOLUME		PERCENT ERROR	RANGE IN CORDS	
	TOTAL CUBIC FEET	TOTAL CORDS		MINIMUM	MAXIMUM
8	50,384	638	18.32%	521	755
37	37,669	477	24.26%	361	592
38	5,894	75	75.82%	18	131
<b>TOTAL:</b>	<b>93,946</b>	<b>1,189</b>		<b>900</b>	<b>1,478</b>

**VDU TO PAYMENT UNIT**

When a VDU is associated with more than one Payment Unit (PU), the VDU volumes are assigned to the PU based on acres of the VDU within the PU.

VDU	VDU ACRES	PU	PU ACRES
8	42.9	1	42.9
37	32.6	2	18.5
37	32.6	4	14.1
38	1.4	3	1.4
<b>TOTAL:</b>	<b>109.5</b>		<b>76.9</b>

**DESCRIPTION OF TIMBER BY PU (PU)**

PU	MARKET GROUP	PRODUCT	QUANTITY	UNIT	ACRES	ADVERTISE PRICE
1	Red Pine	Pulpwood	638	Cords	42.9	\$30,719.70
	<i>Red Pine</i>		638	<i>Cords</i>		
2	Red Pine	Pulpwood	271	Cords	18.5	\$13,048.65
	<i>Red Pine</i>		270	<i>Cords</i>		
	<i>Scotch Pine</i>		1	<i>Cords</i>		
3	Red Pine	Pulpwood	75	Cords	1.4	\$3,611.25
	<i>Red Pine</i>		75	<i>Cords</i>		
4	Red Pine	Pulpwood	205	Cords	14.1	\$9,870.75
	<i>Red Pine</i>		205	<i>Cords</i>		
<b>TOTAL:</b>			1,189	Cords		

## Sale Specific Conditions & Requirements

Sale Name: Red Shouldered Pine Re-Do

Sale Number: 72-004-25 Seq#: 1

### 1 - Sale Area

#### 1.2 - Boundaries

##### 1.2.1 - Painted Boundaries (9/19)

The sale boundary and Payment Unit boundaries are marked and identified by blue, red and purple paint. Exterior sale boundary lines against private property are marked with blue paint. Exterior sale boundary lines against state are marked with red paint except for a portion of Payment Unit 4 is identified with purple paint around the 330' stick nest buffer as identified on the Timber Sale Map. Interior Payment Unit boundary for Payment Unit 3 was marked with red X's and the interior Payment Unit boundary for Payment Unit 4 was marked with purple paint as identified on the Timber Sale Map. Retention patches are marked with red paint; no harvesting activities may occur within these areas. The painted boundary line trees are not Included Timber and are to be protected unless marked with orange paint.

### 2 - Timber Specifications

#### 2.1 - Included Timber

##### 2.1.3 - Cut Tree Marked Unit(s) (12/08)

Within Payment Unit(s) 1, 2, and 4, all trees are designated for cutting when marked with orange paint above and below stump height, regardless of merchantability.

##### 2.1.4 - Designated Timber Unit(s) (6/17)

Within Payment Unit(s) 3, red pine, dead or alive, is designated for cutting, regardless of merchantability.

##### 2.1.11 - Description of Timber Note (2/04)

Note that a minor component of aspen was marked to cut in Payment Unit 1 that was not captured in the cruise volume.

#### 2.2 - Utilization

##### 2.2.3 - Stump Heights (12/24)

Stump heights within the Sale Area shall not exceed six (6) inches for all trees. A written waiver of this requirement may be obtained if wet summer weather makes winter logging necessary.

##### 2.2.5 - Limbed Tree Skidding (12/24)

The skidding of whole trees or tree segments with limbs attached is prohibited, unless approved by the Unit Manager or his/her representative.

### 3 - Payments

#### 3.3 - Pre-measured Sales

##### 3.3.4 - Dividing Payment Units (7/14)

Payment Unit(s) 1 may be divided at the request of the Purchaser and upon approval of the Unit Manager. Dividing Payment Units is a contract modification which requires a Timber Sale Contract Amendment.

#### 3.4 - Damaged Timber

##### 3.4.1 - Damaged Timber (12/24)

General Condition and Requirement 3.4 Damaged Timber, defines liquidated damages for undesignated live merchantable trees which are cut or injured. In addition, within Payment Unit 3 reasonable care should be taken to avoid damage to tree seedlings and saplings.

No damage is acceptable to undesignated live merchantable trees. Within the Sale Area, if more than 10% of trees (> 4.5" DBH) within a specified area of the sale are damaged, liquidated damages will be assessed for all trees damaged. Rates will be in accordance with General Condition and Requirement 3.4 Damaged Timber.

## 4 - Transportation

### 4.1 - Construction

#### 4.1.6 - Road Construction (4/24)

Construction of new roads or improvements of existing roads shall be done in such a way as to minimize the environmental and visual impacts. Merchantable trees shall be cut and utilized unless otherwise directed. Non-merchantable trees shall be severed and laid flat on the ground. Slash shall be scattered, not left in windrows, and kept a minimum of 10 feet back from the road edge. Stumps shall be set upright, not left on edge, and be moved at least 10 feet away from the road edge. Disturbed soil shall be feathered into the woods and not left in berms or windrows.

#### 4.1.7 - Road Closure (10/11)

All new roads built into the sale must be blocked to vehicle traffic upon completion of the sale. Overgrown roads that are reopened shall be considered new roads. In general, this will require constructing a four (4') foot high berm of stumps and logs covered with earth. Stumps and brush must be placed along the remainder of the trail. These roads must be rendered impassable to cars and trucks. All stumps from road building and landing construction must be reserved to block any newly constructed roads upon completion of the sale. These stumps must be scattered along the road system to prohibit vehicular movement. Contact the Sale Administrator for specific details of design and placement.

#### 4.1.11 - Permits (2/12)

The Purchaser will secure any necessary permits that may be required.

### 4.2 - Maintenance

#### 4.2.5 - Two Wheel Drive Condition (2/04)

All existing trail roads on and adjacent to the Sale Area must be passable by two-wheel drive traffic for the duration of the sale.

## 5 - Operations

### 5.1 - Notification

#### 5.1.3 - Well Heads and Natural Gas Pipelines (11/15)

The Purchaser is responsible for contacting the gas or pipeline company prior to operating equipment in the vicinity of well heads or natural gas pipelines. Contact DTE at (231) 258-3750 to coordinate operations if needs to operate within the cleared pipeline corridor on the east edge of Payment Unit 1.

### 5.2 - Conduct of Operations

#### 5.2.3 - Operating Restrictions

##### 5.2.3.1 - Operating Restrictions (9/11)

Within Payment Unit(s) 4, unless changed by written agreement, cutting, skidding, and hauling are not permitted during the period of March 15 to July 15. This restriction is because an of the presence of an occupied hawk nest.

##### 5.2.3.3 - Bark Slippage Restriction (3/09)

Within Payment Unit(s) 1, 2, and 4, unless approved by the Sale Administrator, cutting and skidding are not permitted during the period of April 15 to July 15. This restriction is because of bark slippage.

##### 5.2.3.6 - Bark Beetle Restriction (1/25)

In the event drought creates a high risk of pine bark beetle infestation, pine is not to be cut during the period March 1 through July 1, unless all portions of trees greater than two (2) inches in diameter are removed from the Sale Area, reduced to chips, or treated to the satisfaction of the Unit Manager or his/her representative, within 15 days of being severed from the stump. Pine log decks, pulpwood piles and treetops that are piled for chipping in the fall or winter within a 1/4 mile of susceptible sites must be removed before March 15. Residual slash must not be placed in piles or rows and must be spread over the site for quick drying. The Department of Natural Resources will exercise this specification if the risk of damage warrants.

#### 5.2.32 - Decking/Landing Restoration (9/13)

All decking and landing areas must have the surface area restored to a condition equal to or better than before. This is to

ensure the proper regeneration of the stand. Wood debris, chips and "cookies" from trimmings must be removed or scattered away from landing and loading areas and may not be windrowed on the edge.

#### 5.2.38 - No Decking Against Live Trees (2/04)

Cut products may not be decked against unmarked or designated leave trees.

#### 5.2.43 - Opening Protection (2/21)

No activities are permitted in opening near Payment Unit 1 as identified on the Timber Sale Map. Any damage to the openings shall be repaired according to specifications of the Unit Manager or his/her representative.

### 5.8 - Protection of Endangered Species

#### 5.8.3 - Red-shouldered Hawk or Goshawk (1) (1/25)

In the event that an active red shoulder hawk or goshawk nest is found, the contract may be amended to protect the nest site until the nest is determined to be inactive. The value of the trees in this excluded area will be refunded or credited to the Purchaser. The nest will be buffered with a five-chain radius (eight acre) protection area, centered on the nest tree, in which there will be no cutting or new roads constructed. Avoid human disturbance, including loading and skidding, in the protection area.

An additional zone of five chains (ten chains centered on the active nest tree) will be established in which there is no management activity from March 15 to July 15. Limit biomass harvesting and chipping operations within this ten-chain zone, retain the maximum one-third of residues per the Woody Biomass Harvesting Guidelines (Michigan DNR 2010). Nests determined to be inactive will be protected with a one-chain no-harvest buffer.

## 6 - Safety and Fire Prevention

### 6.2 - Signing

#### 6.2.1 - Road Posting (10/20)

The Purchaser is responsible for posting and maintaining caution signs on County Road 612 and forest roads prior to beginning operations. The road must be posted at appropriate distances from the Sale Area to warn of logging activity and truck traffic. Signs must be removed when harvest operations are suspended or completed. The Purchaser will provide these signs.

## 7 - Other Conditions

### 7.2 - Extensions

#### 7.2.4 - Limited Extensions (4/17)

Given justification, only one extension may be granted if the contract has been paid in full. The contract duration is less than 2 years due to the old fading paint, however, justification for an extension is valid if operations are delayed due to raptor timing restrictions in Payment Unit 4. This requires Unit Manager approval.



### TIMBER SALE MAP

This information provided by authority of Part 525, 1994 PA 451, as amended.

Sale Number  
**72-004-25**

Date  
**02/04/2025**

Forest Management Unit	County	Mapped By: Derek Nellis
Grayling Mgt Unit	Crawford	Cruised By: Scott McClarren

Scale	Page	Of
1:7,920	1	2

Township	Range	Section(s) and Subdivision(s)
28N	03W	Sec. 31 S1/2NW,SW; Sec. 33 E1/2NE,NESE;

#### Cover Type

A = Aspen	J = Jack Pine	O = Oak	U = Upland Brush
B = Paper Birch	K = Rock	P = Lowland Poplar	UM = Upland Mix Forest
C = Cedar	L = Lowland Brush	Q = Mixed Swamp Conifer	V = Bog or Marsh
D = Treed Bog	LM = Lowland Mix Forest	R = Red Pine	W = White Pine
E = Swamp Hardwoods	M = Maple, Beech, Birch	S = Black Spruce	X = Non Stocked
F = Spruce/Fir	MC = Mixed Conifer	T = Tamarack	Y = Sand
G = Grass	MD = Mixed Deciduous	Z = Water	
H = Hemlock	N = Marsh		

#### Density

0 = Non Stocked	5 = Pole Timber Medium
1 = Seedling Sapling Poor	6 = Pole Timber Well
2 = Seedling Sapling Medium	7 = Saw Timber Poor
3 = Seedling Sapling Well	8 = Saw Timber Medium
4 = Pole Timber Poor	9 = Saw Timber Well

Use QR Code to open Map in App



Payment Unit Number	Acres
1	42.9
2	18.5
3	1.4
4	14.1

## Red Shouldered Pine Re-Do

**Comp 216**  
**76.9 Acres**

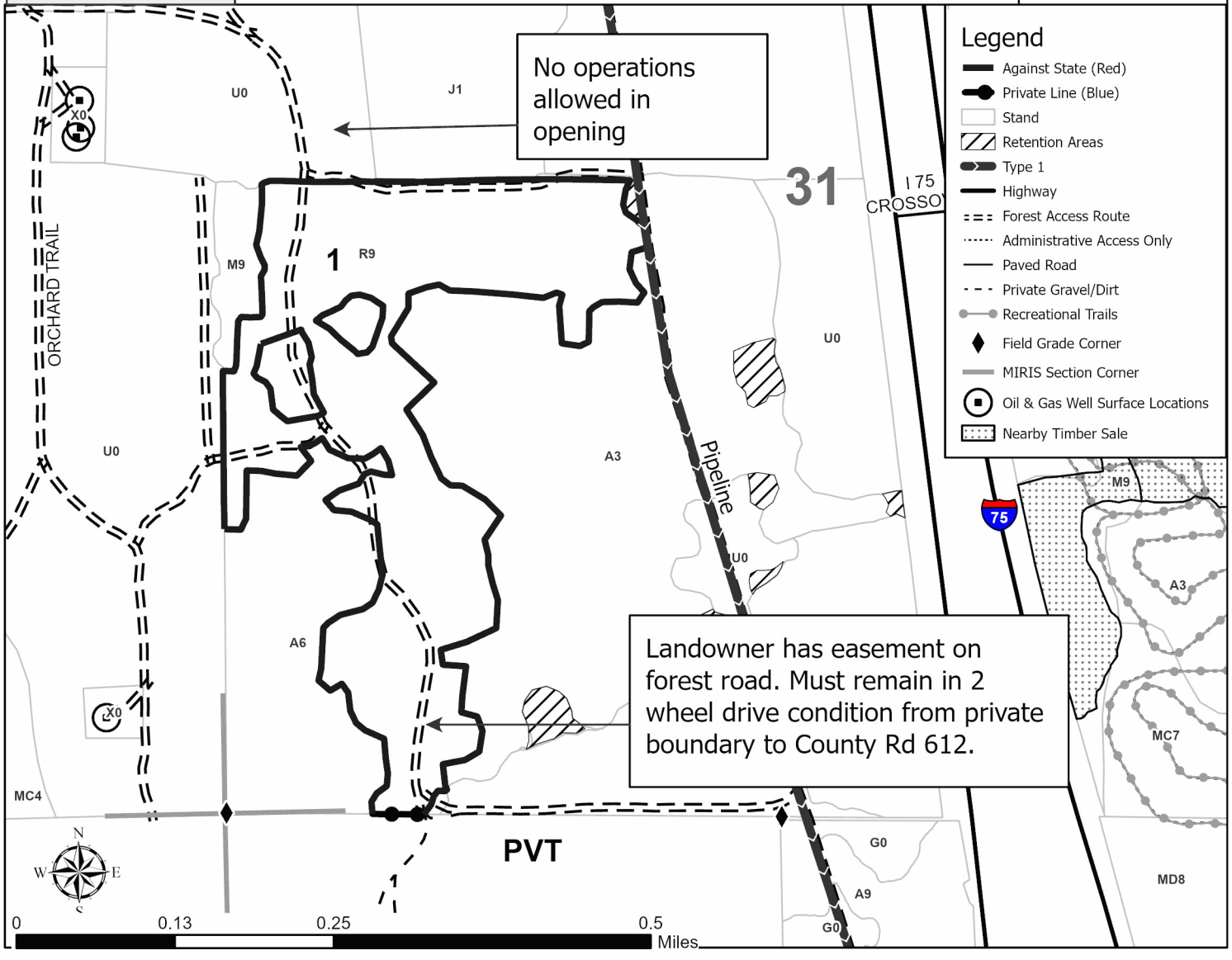



### TIMBER SALE MAP

This information provided by authority of Part 525, 1994 PA 451, as amended.

Sale Number  
**72-004-25**

Date  
**02/04/2025**

Forest Management Unit	County	Mapped By: Derek Nellis
Grayling Mgt Unit	Crawford	Cruised By: Scott McClarren

Scale	Page	Of
1:7,920	2	2

Township	Range	Section(s) and Subdivision(s)
28N	03W	Sec. 31 S1/2NW,SW; Sec. 33 E1/2NE,NESE;

#### Cover Type

A = Aspen	J = Jack Pine	O = Oak	U = Upland Brush
B = Paper Birch	K = Rock	P = Lowland Poplar	UM = Upland Mix Forest
C = Cedar	L = Lowland Brush	Q = Mixed Swamp Conifer	V = Bog or Marsh
D = Treed Bog	LM = Lowland Mix Forest	R = Red Pine	W = White Pine
E = Swamp Hardwoods	M = Maple, Beech, Birch	S = Black Spruce	X = Non Stocked
F = Spruce/Fir	MC = Mixed Conifer	T = Tamarack	Y = Sand
G = Grass	MD = Mixed Deciduous	Z = Water	
H = Hemlock	N = Marsh		

#### Density

0 = Non Stocked	5 = Pole Timber Medium
1 = Seedling Sapling Poor	6 = Pole Timber Well
2 = Seedling Sapling Medium	7 = Saw Timber Poor
3 = Seedling Sapling Well	8 = Saw Timber Medium
4 = Pole Timber Poor	9 = Saw Timber Well

Payment Unit Number	Acres
1	42.9
2	18.5
3	1.4
4	14.1

## Red Shouldered Pine Re-Do

Comp 216

76.9 Acres

Use QR Code to open Map in App

