



**DEPARTMENT OF NATURAL RESOURCES
STATE OF MICHIGAN
TIMBER SALE PROSPECTUS #7841**

SCHEDULED SALE DATE AND TIME: 10:00 a.m. (local time) on June 15, 2026.

LOCATION: SAULT DNR CUSTOMER SERVICE CENTER, 4131 S. M-129, SAULT STE MARIE, MI 49783.

CONTACT NAME: Kenny Fanelli

PHONE NUMBER: (906) 287-1380

PROSPECTUS NOTE: The bidder is advised to inspect the sale area and review the location, estimated volumes, operating costs and contract terms of proposed sales. Please be aware that some landowners may request 60 days or more notice for access across their land.

Notice is hereby given that bids will be received by the Unit Manager, SAULT STE MARIE MANAGEMENT UNIT, for certain timber on the following described lands:

Island Hopper Spruce (45-006-25) / T44N, R01W, SEC. 6 , SENW,SWNE,NESW,NWSE,S1/2SE.
T44N, R02W, SEC. 12, NW,NE,SW,N1/2SE,SWSE.

Chippewa County, Advertised Price \$24,934.55, 266.8 Acres, Aspen, Spruce/Fir/Tamarack.

SALE NOTE: Lowland spruce will require multiple cold winters. Possible stream crossing.

A recreation site such as a trail, pathway, or campground is within the sale area or the vicinity.
Certain restrictions/specifications may be applicable including time restrictions. Access may be through private land.

TIMBER SALE INFORMATION

Island Hopper Spruce (45-006-25)
T44N, R01W, SEC. 6; T44N, R02W, SEC. 12.
Chippewa County (Advertised Price \$24,934.55)

SALE NOTE: Lowland spruce will require multiple cold winters. Possible stream crossing.

A recreation site such as a trail, pathway, or campground is within the sale area or the vicinity. Certain restrictions/specifications may be applicable including time restrictions. Access may be through private land.

A timber sale contract for this lump sum, sealed bid timber sale will be awarded to the responsible bidder offering the highest sealed bid price. All units of volume listed below were estimated using the Inventory Manager computer program and the new Michigan taper model. Bids must be at or above the following advertised price for each product and species:

<u>PRODUCTS & SPECIES</u>	<u>ESTIMATED UNITS*</u>	<u>ADVERTISED PRICE</u>
Pulpwood		
Balsam Fir	6 Cords	\$ 6.40 / Cord
Jack Pine	3 Cords	\$ 12.05 / Cord
Mixed Aspen	12 Cords	\$ 10.75 / Cord
Mixed Spruce	3,410 Cords	\$ 7.10 / Cord
Paper Birch	8 Cords	\$ 4.70 / Cord
Red Maple	8 Cords	\$ 10.80 / Cord
Tamarack	165 Cords	\$ 2.40 / Cord

* The total volume is statistically estimated within plus (+) or minus (-) 15.81 percent. There are an estimated 3,612 cords on this timber sale, plus or minus 571 cords at the 95% confidence level. The estimated units are final and not subject to adjustment. Prospective bidders are urged to examine this timber and to make their own estimates of quantity and quality.

BOND AND PAYMENT SCHEDULE:

1. A bond in the amount of \$1,994.76 to insure faithful performance of the conditions of the contract will be deposited by the successful bidder within 21 days of the sale award.
2. Cutting in any sale or unit without the required advance payment would be considered a trespass.
3. Total payment must be paid in advance or according to the following schedule:
 - (a) Ten percent (10%) of the sale value must be paid within 21 days of the sale award.
 - (b) The 10% down payment will be credited towards the first unit cut.
 - (c) Payment for each of the following units must be made before cutting begins in that unit:

<u>PAYMENT UNIT NUMBER</u>	<u>PERCENT OF TOTAL SALE VALUE</u>
01	9.3%
02	11.4%
03	11.2%
04	9.3%
05	11.8%
06	8.0%
07	8.3%
08	11.4%
09	11.7%
10	4.4%
11	3.2%

4. If no cutting takes place, the 10% down payment will not be refunded.
5. Operations on the contract issued will terminate on 06/30/2030.

SALE STATISTICS

Volumes were calculated in cubic feet using the Michigan taper model. Cubic foot volume includes all wood inside bark for the product indicated. For display purposes, cubic feet were converted to cords and MBF using a simple conversion factor, e.g. 79 cubic feet per cord and 185 cubic feet per MBF. The cubic foot volumes are precise; the cords and MBF volumes are not. Cubic foot volume cannot be directly converted to cords or boards with precision.

SALE VOLUMES

The total estimated sale volume may not equal the sum of the species/products due to the nature of statistical calculations associated with double sampling methodology.

VOLUME			STATISTICAL RANGE IN CORDS	
TOTAL CUBIC FEET	TOTAL CORDS	PERCENT ERROR	MINIMUM	MAXIMUM
285,335	3,612	15.81%	3,041	4,183

VDU VOLUMES

A VDU is a Volume Determination Unit. Volumes and their associated statistics are calculated at the VDU level and summarized to the sale level. There is often a one to one relationship between a VDU and a Payment Unit, but not always, depending on the cruise design. Refer to the VDU TO PAYMENT UNIT table.

	VOLUME			RANGE IN CORDS	
VDU	TOTAL CUBIC FEET	TOTAL CORDS	PERCENT ERROR	MINIMUM	MAXIMUM
42	259,988	3,291	17.25%	2,723	3,859
47	25,347	321	25.09%	240	401
TOTAL:	285,335	3,612		2,964	4,260

VDU TO PAYMENT UNIT

When a VDU is associated with more than one Payment Unit (PU), the VDU volumes are assigned to the PU based on acres of the VDU within the PU.

VDU	VDU ACRES	PU	PU ACRES
TOTAL:			

DESCRIPTION OF TIMBER BY PU (PU)

PU	MARKET GROUP	PRODUCT	QUANTITY	UNIT	ACRES	ADVERTISE PRICE
1	Balsam Fir	Pulpwood	6	Cords	24.0	\$2,311.45
	Jack Pine		3	Cords		
	Mixed Aspen		12	Cords		
	<i>Quaking Aspen</i>		12	<i>Cords</i>		
	Mixed Spruce		281	Cords		
	<i>Black Spruce</i>		281	<i>Cords</i>		
	Red Maple		8	Cords		
	Tamarack		11	Cords		
2	Mixed Spruce	Pulpwood	392	Cords	30.4	\$2,833.50
	<i>Black Spruce</i>		392	<i>Cords</i>		
	Paper Birch		1	Cords		
	Tamarack		19	Cords		
3	Mixed Spruce	Pulpwood	388	Cords	30.1	\$2,805.10
	<i>Black Spruce</i>		388	<i>Cords</i>		
	Paper Birch		1	Cords		
	Tamarack		19	Cords		
4	Mixed Spruce	Pulpwood	320	Cords	24.8	\$2,315.10
	<i>Black Spruce</i>		320	<i>Cords</i>		
	Paper Birch		1	Cords		
	Tamarack		16	Cords		
5	Mixed Spruce	Pulpwood	406	Cords	31.5	\$2,935.30
	<i>Black Spruce</i>		406	<i>Cords</i>		
	Paper Birch		1	Cords		
	Tamarack		20	Cords		
6	Mixed Spruce	Pulpwood	276	Cords	21.4	\$1,997.90
	<i>Black Spruce</i>		276	<i>Cords</i>		
	Paper Birch		1	Cords		
	Tamarack		14	Cords		
7	Mixed Spruce	Pulpwood	285	Cords	22.1	\$2,061.80
	<i>Black Spruce</i>		285	<i>Cords</i>		
	Paper Birch		1	Cords		
	Tamarack		14	Cords		
8	Mixed Spruce	Pulpwood	392	Cords	30.4	\$2,833.50
	<i>Black Spruce</i>		392	<i>Cords</i>		
	Paper Birch		1	Cords		
	Tamarack		19	Cords		
9	Mixed Spruce	Pulpwood	408	Cords	31.8	\$2,951.90
	<i>Black Spruce</i>		408	<i>Cords</i>		
	Paper Birch		1	Cords		
	Tamarack		21	Cords		
10	Mixed Spruce	Pulpwood	151	Cords	11.7	\$1,088.90
	<i>Black Spruce</i>		151	<i>Cords</i>		
	Tamarack		7	Cords		
11	Mixed Spruce	Pulpwood	111	Cords	8.6	\$800.10
	<i>Black Spruce</i>		111	<i>Cords</i>		
	Tamarack		5	Cords		
TOTAL:			3,612	Cords		

Sale Specific Conditions & Requirements

Sale Name: Island Hopper Spruce

Sale Number: 45-006-25 Seq#: 1

1 - Sale Area

1.2 - Boundaries

1.2.1 - Painted Boundaries (9/19)

The sale boundary and Payment Unit boundaries are marked and identified by blue, red and yellow paint. Exterior sale boundary lines against private property are marked with blue paint. Exterior sale boundary lines against state are marked with red paint. Interior Payment Unit boundaries are marked with yellow paint. Retention patches are marked with red paint; no harvesting activities may occur within these areas. The painted boundary line trees are not Included Timber and are to be protected. Yellow painted trees designating an interior Payment Unit boundary are only to be cut when all surrounding Payment Units have been paid.

2 - Timber Specifications

2.1 - Included Timber

2.1.1 - Clearcut Unit(s) with Unmerchantable Trees (6/14)

Within Payment Unit(s) 1-11, cut all trees that are four (4) inches or more at DBH, except red and white pine.

3 - Payments

3.3 - Pre-measured Sales

3.3.4 - Dividing Payment Units (7/14)

Payment Unit(s) 1-11 may be divided at the request of the Purchaser and upon approval of the Unit Manager. Dividing Payment Units is a contract modification which requires a Timber Sale Contract Amendment. There will be only one division per Payment Unit.

4 - Transportation

4.1 - Construction

4.1.1 - Stream Crossings, General (1/25)

All stream crossing structures will be temporary and, therefore, shall be provided by the Purchaser and must be removed upon completion of the sale. All permits for stream crossings will be provided by the DNR.

4.1.3 - Slash and Earthen Piles (8/04)

Piles or windrows of earth along roads and landings that have been widened or constructed shall be leveled. Slash from road maintenance or construction, including stumps, shall be dispersed throughout the sale.

4.1.6 - Road Construction (4/24)

Construction of new roads or improvements of existing roads shall be done in such a way as to minimize the environmental and visual impacts. Merchantable trees shall be cut and utilized unless otherwise directed. Non-merchantable trees shall be severed and laid flat on the ground. Slash shall be scattered, not left in windrows, and kept a minimum of 10 feet back from the road edge. Stumps shall be set upright, not left on edge, and be moved at least 10 feet away from the road edge. Disturbed soil shall be feathered into the woods and not left in berms or windrows.

4.1.7 - Road Closure (10/11)

All new roads built into the sale must be blocked to vehicle traffic upon completion of the sale. Overgrown roads that are reopened shall be considered new roads. In general, this will require constructing double earthen berms at strategic locations. Stumps and brush must be placed along the remainder of the trail. These roads must be rendered impassable to cars and trucks. All stumps from road building and landing construction must be reserved to block any newly constructed roads upon completion of the sale. These stumps must be scattered along the road system to prohibit vehicular movement. Temporary berms may be required if no sale activity occurs for 30 or more consecutive days. Contact the Sale Administrator for specific details of design and placement.

4.2 - Maintenance

4.2.1 - Hauling Restriction (12/08)

Hauling may be restricted on forest roads by the Unit Manager or his/her representative. The restriction may occur during wet weather conditions.

4.2.4 - Grading (10/16)

For completion of the sale, state forest roads must be graded. In general, this will require a road grader or bulldozer to shape up the roads after forest products have been hauled off site. This includes cleaning of drainage areas, grading, crowning and filling with gravel, if necessary. The grading equipment to be used must be approved by the Unit Manager or his/her representative.

4.2.5 - Two Wheel Drive Condition (2/04)

All existing trail roads on and adjacent to the Sale Area must be passable by two-wheel drive traffic for the duration of the sale.

4.4 - Access

4.4.2 - Alternate route on private property (2/04)

It is the Purchaser's responsibility to obtain access across private land for any routes other than the route shown on the Timber Sale Map.

4.4.3 - Access gate (12/08)

The access gate must be locked at all times. This is to prevent someone other than the Purchaser from going through the gate and being locked in.

5 - Operations

5.2 - Conduct of Operations

5.2.2 - Hazard Trees/Snags

5.2.2.1 - Den Trees (10/16)

Obvious hollow and/or den trees shall be protected and left standing unless they are a safety hazard.

5.2.4 - Dead and Down Creation

5.2.4.3 - Dead and Down Creation, Dead Trees (6/07)

Except as provided for in General Condition and Requirement 5.2.2, no dead trees, standing or down, are to be cut, skidded, or processed.

5.2.17 - Timber Mats and Interlocking Composite Mats (5/23)

Some roads or skid trails may require extra protection such as that afforded by timber mats, interlocking composite mats, or another approved system. If available, mats may be borrowed from the DNR. A Timber Sale Contract Amendment will be used to document the Purchaser's use of the DNR's mats. Contact the Sale Administrator regarding availability and pick-up. Timber mats are available from various field offices. Composite mats are only available from the Grayling field office and the Marquette ICC. The Purchaser is responsible for picking up and hauling the mats to and from the site. The composite mats will require DNR staff onsite for installation and removal. Contact the Sale Administrator to schedule at least 30 days before desired install/removal date. All mats must be cleaned prior to drop off. This may include, but is not limited to, power washing and brushing to remove mud and debris. A charge of \$700.00 per timber mat and \$2,000.00 per composite mat will be assessed for all damaged or non-returned mats. Damage for the crane/timber mats is defined as three or more broken cants. Damage for the composite mats is defined as cracked or broken mats.

5.2.22 - Operating Caution

5.2.22.1 - Operating Caution (6/11)

It is recommended, but not required, that within Payment Unit(s) 1-11, cutting, skidding, and hauling occur during dry summer or frozen winter conditions. The reason for the recommendation is because of wet ground conditions.

5.2.32 - Decking/Landing Restoration (9/13)

All decking and landing areas must have the surface area restored to a condition equal to or better than before. This is to

ensure the proper regeneration of the stand. Wood debris, chips and "cookies" from trimmings must be removed or scattered away from landing and loading areas and may not be windrowed on the edge.

5.2.38 - No Decking Against Live Trees (2/04)

Cut products may not be decked against unmarked or designated leave trees.

5.2.41 - Snowmobile Trail Protection (9/11)

The snowmobile trail is shown on the Timber Sale Map. Do not cut or damage posts with orange trail markers or traffic control signs. If the trail is used, it must be maintained and restored to a condition equal to or better than before the sale. The road maintenance/restoration must be done prior to December 1. If the trail is used for hauling, it must be graded to the satisfaction of the Unit Manager or his/her representative prior to December 1. If the trail road is to be used for hauling during the snowmobile season, then a snow-covered base must be left on the trail. The snowmobile trail may only be crossed at right angles. Maintain a 20-foot-wide slash, debris, and rut free zone daily using the snowmobile trail as the centerline. No decking of forest products will be permitted along the snowmobile trail during the snowmobile season. All stumps within 5 feet of the snowmobile trail must be cut at ground level.

5.3 - Stream Protection

5.3.2 - Parking Equipment Near Water (10/23)

Within Payment Unit(s) 1-11 the parking of or storage of equipment is prohibited within 100 feet of water bodies or ground water supplies. All equipment, when not in use for harvest operations, must be parked a minimum of 100 feet away from water sources (streams, rivers, lakes, ponds, vernal pools, ground water sources) and 50 feet away from slopes leading to water sources and/or riparian areas. This restriction is for preventing unforeseen oil and/or fluid leaks from contaminating water bodies and/or ground water supplies.

6 - Safety and Fire Prevention

6.2 - Signing

6.2.2 - Snowmobile Trail Posting (10/20)

The Purchaser is responsible for posting and maintaining caution signs on the snowmobile trail prior to beginning operations during the snowmobile season (approximately December 1 to March 31). The trail must be posted at appropriate distances from the Sale Area to warn of logging activity and truck traffic. Signs must be removed when harvest operations are suspended or completed. The Purchaser will provide these signs.

7 - Other Conditions

7.2 - Extensions

7.2.5 - Weather-Related Extension (1/13)

If weather conditions during the operating period of this contract prevent harvesting, this sale may qualify for a weather-related extension. If approved, the normal extension fee would be waived. To qualify, there must be a documented attempt each year to harvest in the difficult portion of the sale.

7.5 - Loss

7.5.1 - Deteriorating Timber (7/09)

The Sale Area has received damage from ice and windthrow. The Purchaser should harvest the wood as soon as possible. The Department of Natural Resources is held free of responsibility of any further damage or deterioration due to delay in harvesting.



TIMBER SALE MAP

This information provided by authority of Part 525, 1994 PA 451, as amended.

Sale Number
45-006-25

Date
08/11/2025

Forest Management Unit: Sault Ste Marie Mgt Unit
 County: Chippewa
 Mapped By: Fanelli/Radecki, Gabler
 Cruised By: Fanelli/Gabler

Scale: 1:20,000
 Page: 1
 Of: 3

Township: 44N
 Range: 01W /
 Section(s) and Subdivision(s): Sec. 12 NW,NE,SW,N1/2SE,SWSE; Sec. 6 SENW,SWNE,NESW,NWSE,S1/2SE;

Cover Type

A = Aspen	J = Jack Pine	O = Oak	U = Upland Brush
B = Paper Birch	K = Rock	P = Lowland Poplar	UM = Upland Mix Forest
C = Cedar	L = Lowland Brush	Q = Mixed Swamp Conifer	V = Bog or Marsh
D = Treed Bog	LM = Lowland Mix Forest	R = Red Pine	W = White Pine
E = Swamp Hardwoods	M = Maple, Beech, Birch	S = Black Spruce	X = Non Stocked
F = Spruce/Fir	MC = Mixed Conifer	T = Tamarack	Y = Sand
G = Grass	MD = Mixed Deciduous	Z = Water	
H = Hemlock	N = Marsh		

Density

0 = Non Stocked	5 = Pole Timber Medium
1 = Seedling Sapling Poor	6 = Pole Timber Well
2 = Seedling Sapling Medium	7 = Saw Timber Poor
3 = Seedling Sapling Well	8 = Saw Timber Medium
4 = Pole Timber Poor	9 = Saw Timber Well

**Island Hopper Spruce
266.8 Acres**

Legend

- Payment Unit
- Against State (Red)
- Private Line (Blue)
- Payment Unit (Yellow)
- Recreational Trails
- Primary Forest Road
- Forest Access Route
- Administrative Access Only
- Government Gravel/Dirt
- Private Gravel/Dirt
- Field Grade Corner
- Survey Grade Corner
- Berm
- Gate

Payment Unit Number	Acres	Payment Unit Number	Acres
1	24	7	22.1
2	30.4	8	30.4
3	30.1	9	31.8
4	24.8	10	11.7
5	31.5	11	8.6
6	21.4		

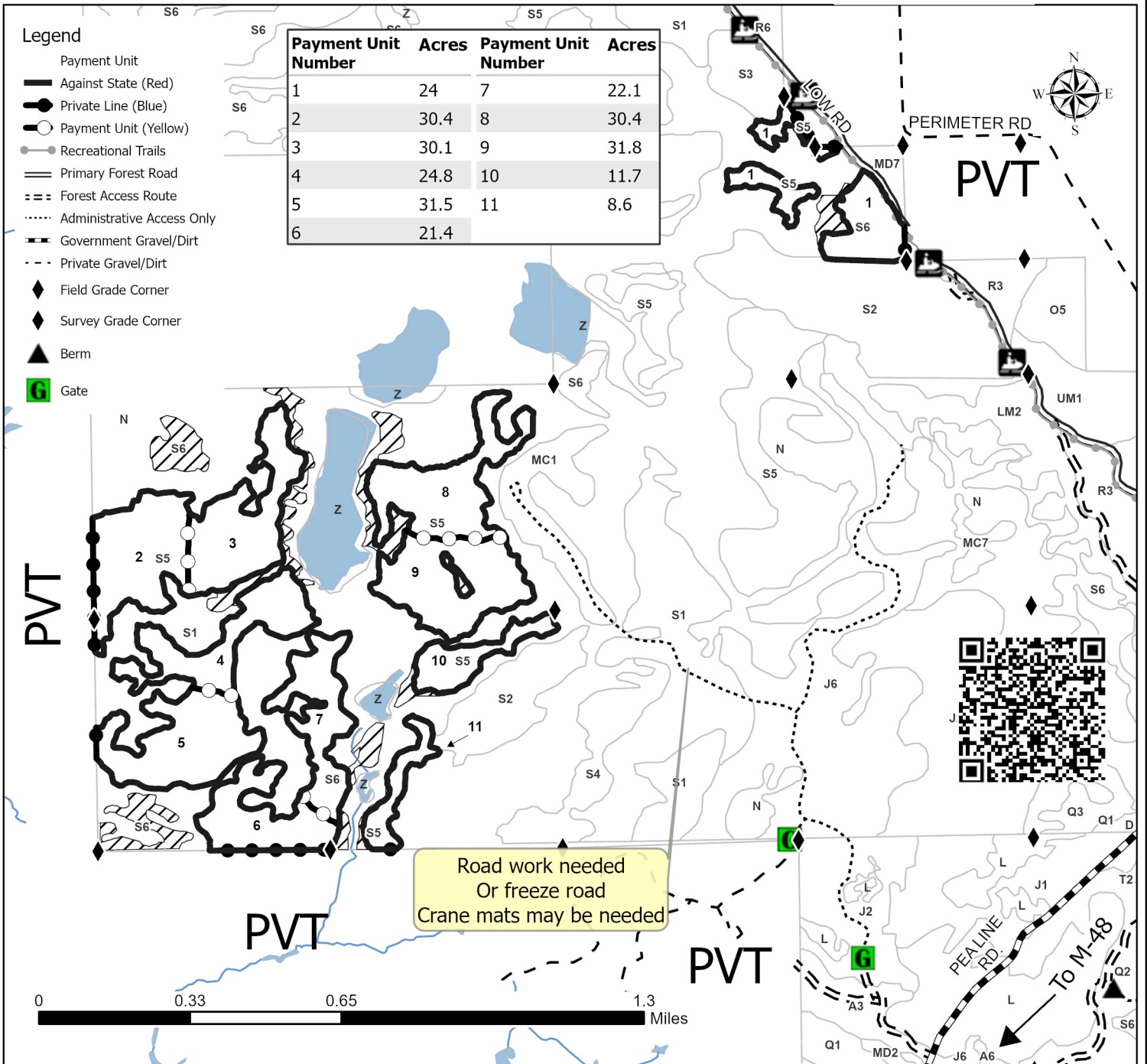



TIMBER SALE MAP

This information provided by authority of Part 525, 1994 PA 451, as amended.

Sale Number
45-006-25

Date
08/11/2025

Forest Management Unit	County	Mapped By: Fanelli/Radecki, Gabler
Sault Ste Marie Mgt Unit	Chippewa	Cruised By: Fanelli/Gabler

Scale	Page	Of
1:5,000	2	3

Township	Range	Section(s) and Subdivision(s)
44N	01W /	Sec. 12 NW,NE,SW,N1/2SE,SWSE; Sec. 6 SENW,SWNE,NESW,NWSE,S1/2SE;

Cover Type

A = Aspen	J = Jack Pine	O = Oak	U = Upland Brush
B = Paper Birch	K = Rock	P = Lowland Poplar	UM = Upland Mix Forest
C = Cedar	L = Lowland Brush	Q = Mixed Swamp Conifer	V = Bog or Marsh
D = Treed Bog	LM = Lowland Mix Forest	R = Red Pine	W = White Pine
E = Swamp Hardwoods	M = Maple, Beech, Birch	S = Black Spruce	X = Non Stocked
F = Spruce/Fir	MC = Mixed Conifer	T = Tamarack	Y = Sand
G = Grass	MD = Mixed Deciduous		Z = Water
H = Hemlock	N = Marsh		

Density

0 = Non Stocked	5 = Pole Timber Medium
1 = Seedling Sapling Poor	6 = Pole Timber Well
2 = Seedling Sapling Medium	7 = Saw Timber Poor
3 = Seedling Sapling Well	8 = Saw Timber Medium
4 = Pole Timber Poor	9 = Saw Timber Well

Island Hopper Spruce 266.8 Acres

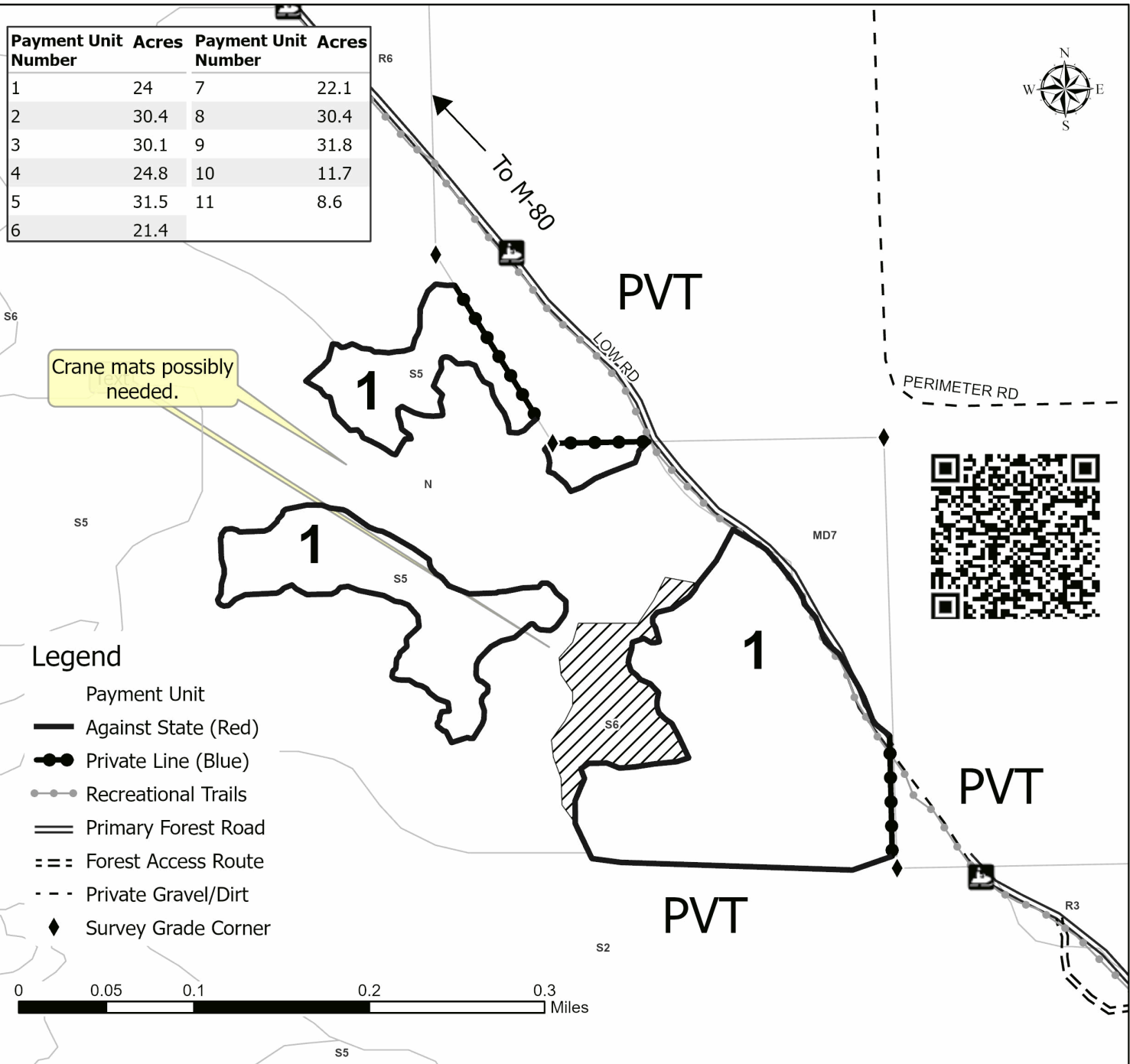



TIMBER SALE MAP

This information provided by authority of Part 525, 1994 PA 451, as amended.

Sale Number
45-006-25

Date
08/11/2025

Forest Management Unit	County	Mapped By: Fanelli/Radecki, Gabler
Sault Ste Marie Mgt Unit	Chippewa	Cruised By: Fanelli/Gabler

Scale	Page	Of
1:10,000	3	3

Township	Range	Section(s) and Subdivision(s)
44N	01W /	Sec. 12 NW,NE,SW,N1/2SE,SWSE; Sec. 6 SENW,SWNE,NESW,NWSE,S1/2SE;

Cover Type			
A = Aspen	J = Jack Pine	O = Oak	U = Upland Brush
B = Paper Birch	K = Rock	P = Lowland Poplar	UM = Upland Mix Forest
C = Cedar	L = Lowland Brush	Q = Mixed Swamp Conifer	V = Bog or Marsh
D = Treed Bog	LM = Lowland Mix Forest	R = Red Pine	W = White Pine
E = Swamp Hardwoods	M = Maple, Beech, Birch	S = Black Spruce	X = Non Stocked
F = Spruce/Fir	MC = Mixed Conifer	T = Tamarack	Y = Sand
G = Grass	MD = Mixed Deciduous		Z = Water
H = Hemlock	N = Marsh		

Density	
0 = Non Stocked	5 = Pole Timber Medium
1 = Seedling Sapling Poor	6 = Pole Timber Well
2 = Seedling Sapling Medium	7 = Saw Timber Poor
3 = Seedling Sapling Well	8 = Saw Timber Medium
4 = Pole Timber Poor	9 = Saw Timber Well

Island Hopper Spruce
266.8 Acres

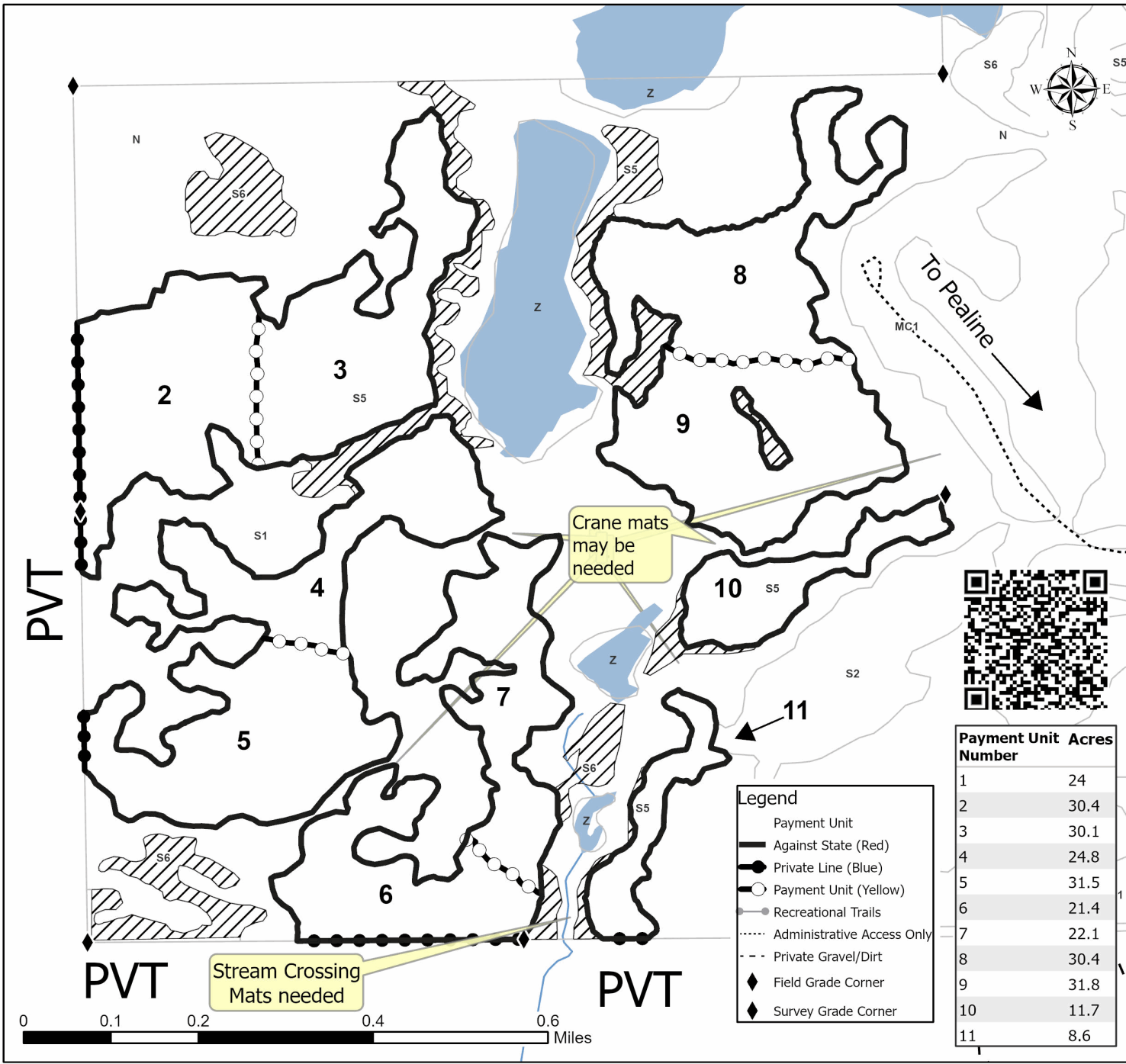

Payment Unit Number	Acres
1	24
2	30.4
3	30.1
4	24.8
5	31.5
6	21.4
7	22.1
8	30.4
9	31.8
10	11.7
11	8.6