



**DEPARTMENT OF NATURAL RESOURCES  
STATE OF MICHIGAN  
TIMBER SALE PROSPECTUS #7627**

SCHEDULED SALE DATE AND TIME: **2:00 p.m. (local time) on September 15, 2025.**

LOCATION: **GWINN MGMT UNIT, 410 WEST M 35, GWINN, MI 49841.**

CONTACT NAME: Mike Brodeur

PHONE NUMBER: (906) 346-9201

PROSPECTUS NOTE: The bidder is advised to inspect the sale area and review the location, estimated volumes, operating costs and contract terms of proposed sales. Please be aware that some landowners may request 60 days or more notice for access across their land.

Notice is hereby given that bids will be received by the Unit Manager, GWINN MANAGEMENT UNIT, for certain timber on the following described lands:

Triple Eh Pine (32-003-25) / T50N, R28W, SEC. 7, SENW, SW.

Marquette County, Advertised Price \$82,228.40, 141.4 Acres, Jack Pine, White Pine.

SALE NOTE: Triple A Rd is Class A for year-round trucking.

## TIMBER SALE INFORMATION

Triple Eh Pine (32-003-25)

T50N, R28W, SEC. 7.

Marquette County (Advertised Price \$82,228.40)

SALE NOTE: Triple A Rd is Class A for year-round trucking.

A timber sale contract for this lump sum, sealed bid timber sale will be awarded to the responsible bidder offering the highest sealed bid price. All units of volume listed below were estimated using the Inventory Manager computer program and the new Michigan taper model. Bids must be at or above the following advertised price for each product and species:

<u>PRODUCTS &amp; SPECIES</u>	<u>ESTIMATED UNITS*</u>	<u>ADVERTISED PRICE</u>
Pulpwood		
Balsam Fir	3 Cords	\$ 8.45 / Cord
Jack Pine	2,600 Cords	\$ 29.80 / Cord
Mixed Hardwood	129 Cords	\$ 9.90 / Cord
White Pine	159 Cords	\$ 15.65 / Cord
White Spruce	112 Cords	\$ 8.55 / Cord

\* The total volume is statistically estimated within plus (+) or minus (-) 13.49 percent. There are an estimated 2,943 cords on this timber sale, plus or minus 397 cords at the 95% confidence level. The estimated units are final and not subject to adjustment. Prospective bidders are urged to examine this timber and to make their own estimates of quantity and quality.

### **BOND AND PAYMENT SCHEDULE:**

1. A bond in the amount of \$8,222.84 to insure faithful performance of the conditions of the contract will be deposited by the successful bidder within 21 days of the sale award.
2. Cutting in any sale or unit without the required advance payment would be considered a trespass.
3. Total payment must be paid in advance or according to the following schedule:
  - (a) Ten percent (10%) of the sale value must be paid within 21 days of the sale award.
  - (b) The 10% down payment will be credited towards the first unit cut.
  - (c) Payment for each of the following units must be made before cutting begins in that unit:

PAYMENT UNIT NUMBER	PERCENT OF TOTAL SALE VALUE
01	20.8%
02	19.4%
03	20.2%
04	17.8%
05	21.8%
4. If no cutting takes place, the 10% down payment will not be refunded.
5. Operations on the contract issued will terminate on 06/30/2029.

### **SALE STATISTICS**

Volumes were calculated in cubic feet using the Michigan taper model. Cubic foot volume includes all wood inside bark for the product indicated. For display purposes, cubic feet were converted to cords and MBF using a simple conversion factor, e.g. 79 cubic feet per cord and 185 cubic feet per MBF. The cubic foot volumes are precise; the cords and MBF volumes are not. Cubic foot volume cannot be directly converted to cords or boards with precision.

### **SALE VOLUMES**

The total estimated sale volume may not equal the sum of the species/products due to the nature of statistical calculations associated with double sampling methodology.

VOLUME		PERCENT ERROR	STATISTICAL RANGE IN CORDS	
TOTAL CUBIC FEET	TOTAL CORDS		MINIMUM	MAXIMUM
232,478	2,943	13.49%	2,546	3,340

**VDU VOLUMES**

A VDU is a Volume Determination Unit. Volumes and their associated statistics are calculated at the VDU level and summarized to the sale level. There is often a one to one relationship between a VDU and a Payment Unit, but not always, depending on the cruise design. Refer to the VDU TO PAYMENT UNIT table.

	VOLUME			RANGE IN CORDS	
VDU	TOTAL CUBIC FEET	TOTAL CORDS	PERCENT ERROR	MINIMUM	MAXIMUM
15	230,425	2,917	13.61%	2,520	3,314
27	2,053	26	74.25%	7	45
TOTAL:	232,478	2,943		2,526	3,359

**VDU TO PAYMENT UNIT**

When a VDU is associated with more than one Payment Unit (PU), the VDU volumes are assigned to the PU based on acres of the VDU within the PU.

VDU	VDU ACRES	PU	PU ACRES
15	139.9	1	29.2
		2	27.2
		3	28.4
		4	24.3
		5	30.8
27	1.5	4	1.5
TOTAL:	141.4		141.4

**DESCRIPTION OF TIMBER BY PU (PU)**

PU	MARKET GROUP	PRODUCT	QUANTITY	UNIT	ACRES	ADVERTISE PRICE
1	Balsam Fir	Pulpwood	1	Cords	29.2	\$17,077.85
	Jack Pine		542	Cords		
	Mixed Hardwood		27	Cords		
	<i>Paper Birch</i>		18	<i>Cords</i>		
	<i>Red Maple</i>		9	<i>Cords</i>		
	White Pine		29	Cords		
	White Spruce		23	Cords		
2	Balsam Fir	Pulpwood	1	Cords	27.2	\$15,915.60
	Jack Pine		505	Cords		
	Mixed Hardwood		25	Cords		
	<i>Paper Birch</i>		17	<i>Cords</i>		
	<i>Red Maple</i>		8	<i>Cords</i>		
	White Pine		27	Cords		
	White Spruce		22	Cords		
3	Balsam Fir	Pulpwood	1	Cords	28.4	\$16,605.30
	Jack Pine		527	Cords		
	Mixed Hardwood		26	Cords		
	<i>Paper Birch</i>		18	<i>Cords</i>		
	<i>Red Maple</i>		8	<i>Cords</i>		
	White Pine		28	Cords		
	White Spruce		23	Cords		
4	Balsam Fir	Pulpwood	1	Cords	25.8	\$14,651.95
	Jack Pine		455	Cords		
	Mixed Hardwood		22	Cords		
	<i>Paper Birch</i>		15	<i>Cords</i>		
	<i>Red Maple</i>		7	<i>Cords</i>		
	White Pine		45	Cords		
	White Spruce		19	Cords		
5	Jack Pine	Pulpwood	571	Cords	30.8	\$17,986.15
	Mixed Hardwood		29	Cords		
	<i>Paper Birch</i>		20	<i>Cords</i>		
	<i>Red Maple</i>		9	<i>Cords</i>		
	White Pine		30	Cords		
	White Spruce		25	Cords		
TOTAL:			3,004	Cords		

## **Sale Specific Conditions & Requirements**

**Sale Name: Triple Eh Pine**

**Sale Number: 32-003-25 Seq#: 1**

### **1 - Sale Area**

#### **1.2 - Boundaries**

##### **1.2.1 - Painted Boundaries (9/19)**

The sale boundary and Payment Unit boundaries are marked and identified by blue, red and yellow paint, along with roads. Exterior sale boundary lines against private property are marked with blue paint. Exterior sale boundary lines against state are marked with red paint, with the exception of the boundaries along Triple A Road, which are unpainted and identified by the road. Interior Payment Unit boundaries are marked with yellow paint. The painted boundary line trees are not Included Timber and are to be protected. Yellow painted trees designating an interior Payment Unit boundary are only to be cut when all surrounding Payment Units have been paid.

### **2 - Timber Specifications**

#### **2.1 - Included Timber**

##### **2.1.1 - Clearcut Unit(s) with Unmerchantable Trees (6/14)**

Within Payment Unit(s) 1-5, cut all trees that are two (2) inches or more at DBH, except do not cut red pine, oak, or trees marked with green paint.

#### **2.2 - Utilization**

##### **2.2.3 - Stump Heights (12/24)**

Stump heights within the Sale Area shall not exceed six (6) inches for all trees. This is in order to facilitate planting operations.

##### **2.2.9 - No Chipping Permitted (12/08)**

Within Payment Unit(s) 1-5, tops may not be chipped.

### **3 - Payments**

#### **3.4 - Damaged Timber**

##### **3.4.1 - Damaged Timber (12/24)**

General Condition and Requirement 3.4 Damaged Timber, defines liquidated damages for undesignated live merchantable trees which are cut or injured. No damage is acceptable to undesignated live merchantable trees. Within the Sale Area, if more than 5% of trees (> 4.5" DBH) within a specified area of the sale are damaged, liquidated damages will be assessed for all trees damaged. Rates will be in accordance with General Condition and Requirement 3.4 Damaged Timber.

### **4 - Transportation**

#### **4.1 - Construction**

##### **4.1.4 - Timber Removed for Construction (3/23)**

Trees cut or damaged in the process of pre-approved road, landing, or skid trail construction will be decked in an area separate from other Designated Timber and not removed until measured by the Sale Administrator. Payment will be made at contract prices or average prices, if not on the contract.

#### **4.2 - Maintenance**

##### **4.2.1 - Hauling Restriction (12/08)**

Hauling may be restricted on forest roads by the Unit Manager or his/her representative. The restriction may occur during spring breakup or during wet weather conditions.

##### **4.2.2 - Fill Material (4/07)**

To maintain roads, fill material may be needed in areas where "holes" exist or may be expected to develop. This fill material

should be placed before trucking begins. Contact the Sale Administrator regarding the availability of onsite sand or gravel from adjacent State-owned lands.

#### 4.2.3 - Road maintenance (8/13)

The following road maintenance may be needed: Within 60 days of completion of hauling, or if no hauling occurs for 60 days, the road may need to be maintained and graded. This includes cleaning of drainage areas, grading, crowning and filling with gravel, if necessary. Damages will be assessed if grading/repair does not occur.

## 5 - Operations

### 5.1 - Notification

#### 5.1.1 - Pre-sale Conference (10/16)

A pre-sale conference between the Purchaser and Sale Administrator is required prior to beginning any operations. The Unit Manager or his/her representative must be contacted at least 5 days in advance to schedule the conference.

### 5.2 - Conduct of Operations

#### 5.2.1 - Slash

##### 5.2.1.11 - Slash for Reforestation (3/21)

To facilitate reforestation, the Sale Area shall be left with slash evenly distributed. Bunched tops within the cutting area shall be broken up and scattered. Stumps shall be cut low to the ground. Processing sites shall not be left with a compacted layer of slash; tops from these sites shall be hauled back into the cut area and scattered.

#### 5.2.32 - Decking/Landing Restoration (9/13)

All decking and landing areas must have the surface area restored to a condition equal to or better than before. This is to ensure the proper regeneration of the stand. Wood debris, chips and "cookies" from trimmings must be removed or scattered away from landing and loading areas and may not be windrowed on the edge.

#### 5.2.38 - No Decking Against Live Trees (2/04)

Cut products may not be decked against unmarked or designated leave trees.

### 5.4 - Soil Protection

#### 5.4.1 - Rutting Restriction, General (7/16)

Operations are to cease immediately if equipment and weather conditions result in rutting of roads and/or skid trails which is 12 inches or greater in depth and 50 feet in length. The Unit Manager or his/her representative may restrict hauling and/or skidding if ruts exceed the specified depth. With the Unit Manager or his/her representative's approval, the Purchaser may return to the area when the risk of rutting has decreased.

## 6 - Safety and Fire Prevention

### 6.2 - Signing

#### 6.2.1 - Road Posting (10/20)

The Purchaser is responsible for posting and maintaining caution signs on Triple A Road prior to beginning operations. The road must be posted at appropriate distances from the Sale Area to warn of logging activity and truck traffic. Signs must be removed when harvest operations are suspended or completed. The Purchaser will provide these signs.

**TIMBER SALE MAP**

This information provided by authority of Part 525, 1994 PA 451, as amended.

Sale Number  
**32-003-25**Date  
**05/09/2025**Forest Management Unit  
Gwinn Mgt UnitCounty  
Marquette

Mapped By: Siler

Cruised By: Siler &amp; Gould

Scale  
**1:10,000**Page  
**1**Of  
**1**Township  
50N  
Range  
28W  
Section(s) and  
Subdivision(s) Sec. 7 SENW,SW;**Cover Type**

A = Aspen	J = Jack Pine	O = Oak	U = Upland Brush
B = Paper Birch	K = Rock	P = Lowland Poplar	UM = Upland Mix Forest
C = Cedar	L = Lowland Brush	Q = Mixed Swamp Conifer	V = Bog or Marsh
D = Treed Bog	LM = Lowland Mix Forest	R = Red Pine	W = White Pine
E = Swamp Hardwoods	M = Maple, Beech, Birch	S = Black Spruce	X = Non Stocked
F = Spruce/Fir	MC = Mixed Conifer	T = Tamarack	Y = Sand
G = Grass	MD = Mixed Deciduous		Z = Water
H = Hemlock	N = Marsh		

**Density**

0 = Non Stocked	5 = Pole Timber Medium
1 = Seedling Sapling Poor	6 = Pole Timber Well
2 = Seedling Sapling Medium	7 = Saw Timber Poor
3 = Seedling Sapling Well	8 = Saw Timber Medium
4 = Pole Timber Poor	9 = Saw Timber Well

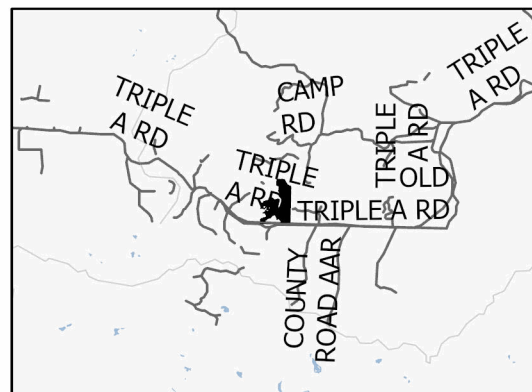
**Locator Map 1:200,000**

Payment Unit Number	Acres
1	29.2
2	27.2
3	28.4
4	25.8
5	30.8

## Triple Eh Pine

### 141.4 Acres

#### Compartment 205

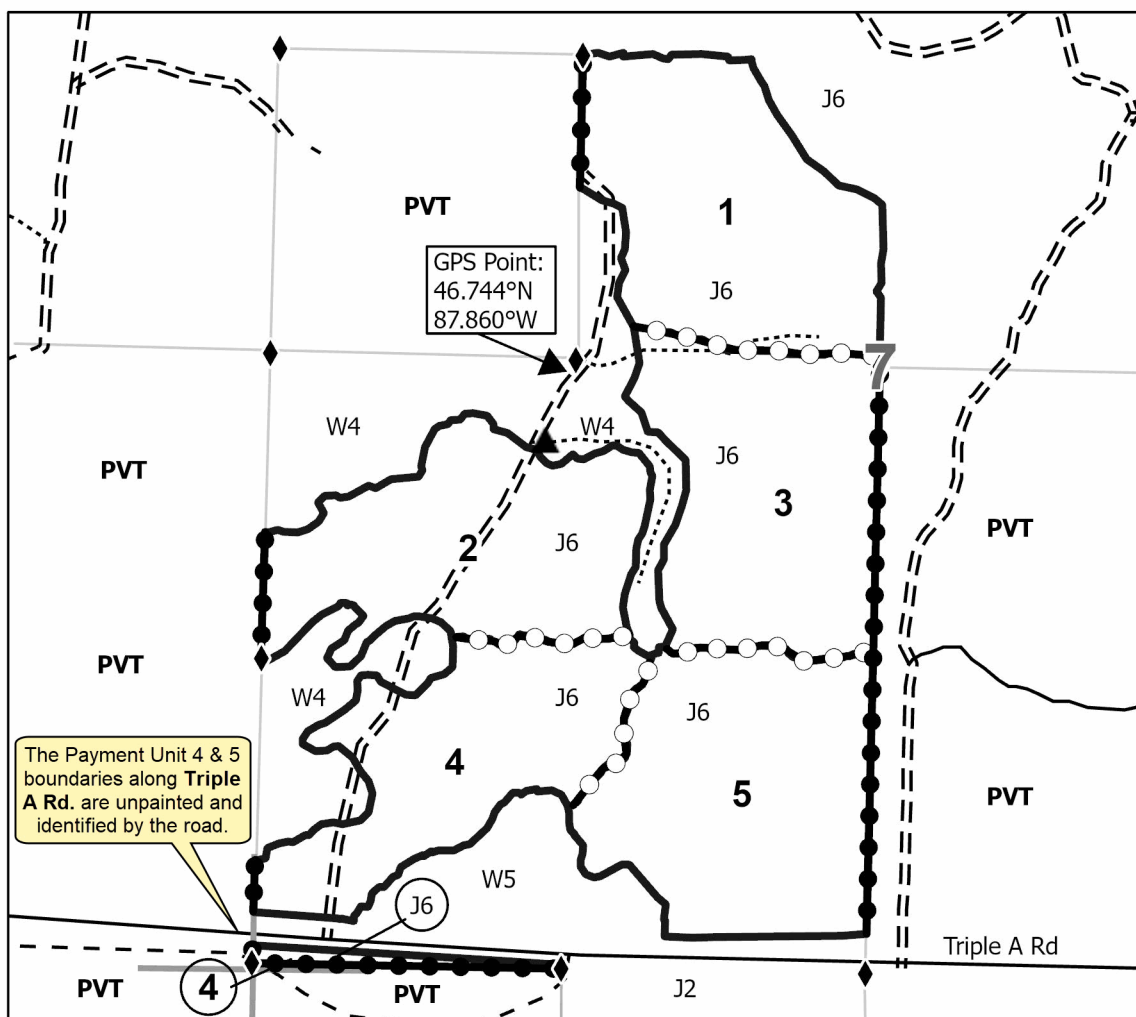

0 0.15 0.3 0.6 Miles

**Legend**

- Against State (Red)
- Private Line (Blue)
- Payment Unit (Yellow)
- Forest Access Route
- Administrative Access Only
- Paved Road
- Private Gravel/Dirt
- State Boundary
- Survey Grade Corner
- Berm
- Section Corner

