



**DEPARTMENT OF NATURAL RESOURCES
STATE OF MICHIGAN
TIMBER SALE PROSPECTUS #7567**

SCHEDULED SALE DATE AND TIME: 10:00 a.m. (local time) on June 27, 2025.

LOCATION: ATLANTA MGMT UNIT, 13501 M 33, ATLANTA, MI 49709.

CONTACT NAME: Matt Foster

PHONE NUMBER: (989) 619-5921

PROSPECTUS NOTE: The sale on this Prospectus has received damage from the Ice Storm in late March 2025. The Purchaser should harvest the wood as soon as possible.

The bidder is advised to inspect the sale area and review the location, estimated volumes, operating costs and contract terms of proposed sales. Please be aware that some landowners may request 60 days or more notice for access across their land.

Notice is hereby given that bids will be received by the Unit Manager, ATLANTA MANAGEMENT UNIT, for certain timber on the following described lands:

Ice Foch Lake Red Pine Salvage (54-015-25) / T31N, R02E, SEC. 29, N1/2NW.

T31N, R02E, SEC. 5 , E1/2NW,W1/2NE.

T32N, R01E, SEC. 28, NE,NWSE.

Montmorency County, Advertised Price \$2,002.00, 62.9 Acres, Red Pine.

SALE NOTE: This sale has been reduced due to "no bid" on previous advertisement.

This is a salvage sale resulting from ice storm damage. Volumes on this sale are a not a representation of actual volume. This is a scaled sale.

Scaling locations and a scaling schedule will be established at the pre-sale meeting.

This sale has received damage form an ice storm. It is a two-year scaled sale with no extensions.

A recreation site such as a trail, pathway, or campground is within the sale area or the vicinity. Certain restrictions/specifications may be applicable including time restrictions.

TIMBER SALE INFORMATION

Ice Foch Lake Red Pine Salvage (54-015-25)
T31N, R02E, SEC. 29; T31N, R02E, SEC. 5; T32N, R01E, SEC. 28.
Montmorency County (Advertised Price \$2,002.00)

SALE NOTE: This sale has been reduced due to "no bid" on previous advertisement.

This is a salvage sale resulting from ice storm damage. Volumes on this sale are a not a representation of actual volume . This is a scaled sale.

Scaling locations and a scaling schedule will be established at the pre-sale meeting.

This sale has received damage form an ice storm. It is a two-year scaled sale with no extensions.

A recreation site such as a trail, pathway, or campground is within the sale area or the vicinity. Certain restrictions/specifications may be applicable including time restrictions.

A timber sale contract for this scaled , sealed bid timber sale will be awarded to the responsible bidder offering the highest sealed bid price . All units of volume listed below were estimated using the Inventory Manager computer program and the new Michigan taper model. Bids must be at or above the following advertised price for each product and species:

<u>PRODUCTS & SPECIES</u>	<u>ESTIMATED UNITS*</u>	<u>ADVERTISED PRICE</u>
Pulpwood		
Red Pine	440 Cords	\$ 4.55 / Cord

* The estimated units are final and not subject to adjustment. Prospective bidders are urged to examine this timber and to make their own estimates of quantity and quality.

BOND AND PAYMENT SCHEDULE:

1. A bond in the amount of \$500.00 to insure faithful performance of the conditions of the contract will be deposited by the successful bidder within 21 days of the sale award.
2. Cutting in any sale or unit without the required advance payment would be considered a trespass.
3. Total payment must be paid in advance or according to the following schedule :
 - (a) Ten percent (10%) of the sale value must be paid within 21 days of the sale award.
 - (b) The 10% down payment will be credited towards the first unit cut.
 - (c) Payment for each of the following units must be made before cutting begins in that unit:

<u>PAYMENT UNIT NUMBER</u>	<u>PERCENT OF TOTAL SALE VALUE</u>
01	25.0%
02	30.0%
03	15.7%
04	29.3%
4. If no cutting takes place, the 10% down payment will not be refunded.
5. Operations on the contract issued will terminate on 06/30/2027.

SALE STATISTICS

Volumes were calculated in cubic feet using the Michigan taper model . Cubic foot volume includes all wood inside bark for the product indicated. For display purposes, cubic feet were converted to cords and MBF using a simple conversion factor, e.g. 79 cubic feet per cord and 185 cubic feet per MBF. The cubic foot volumes are precise; the cords and MBF volumes are not. Cubic foot volume cannot be directly converted to cords or boards with precision.

SALE VOLUMES

The total estimated sale volume may not equal the sum of the species/products due to the nature of statistical calculations associated with double sampling methodology.

<u>VOLUME</u>			<u>STATISTICAL RANGE IN CORDS</u>	
<u>TOTAL CUBIC FEET</u>	<u>TOTAL CORDS</u>	<u>PERCENT ERROR</u>	<u>MINIMUM</u>	<u>MAXIMUM</u>
34,680	439	0.00%	439	439

VDU VOLUMES

A VDU is a Volume Determination Unit. Volumes and their associated statistics are calculated at the VDU level and summarized to the sale level. There is often a one to one relationship between a VDU and a Payment Unit, but not always, depending on the cruise design. Refer to the VDU TO PAYMENT UNIT table.

	VOLUME			RANGE IN CORDS	
VDU	TOTAL CUBIC FEET	TOTAL CORDS	PERCENT ERROR	MINIMUM	MAXIMUM
9	5,418	69	0.00%	69	69
26	10,197	129	0.00%	129	129
40	8,663	110	0.00%	110	110
74	10,402	132	0.00%	132	132
TOTAL:	34,680	439		439	439

VDU TO PAYMENT UNIT

When a VDU is associated with more than one Payment Unit (PU), the VDU volumes are assigned to the PU based on acres of the VDU within the PU.

VDU	VDU ACRES	PU	PU ACRES
TOTAL:			

DESCRIPTION OF TIMBER BY PU (PU)

PU	MARKET GROUP	PRODUCT	QUANTITY	UNIT	ACRES	ADVERTISE PRICE
1	Red Pine	Pulpwood	110	Cords	15.7	\$500.50
2	Red Pine	Pulpwood	132	Cords	18.9	\$600.60
3	Red Pine	Pulpwood	69	Cords	9.8	\$313.95
4	Red Pine	Pulpwood	129	Cords	18.5	\$586.95
TOTAL:			440	Cords		

Sale Specific Conditions & Requirements

Sale Name: Ice Foch Lake Red Pine Salvage

Sale Number: 54-015-25 Seq#: 3

1 - Sale Area

1.2 - Boundaries

1.2.1 - Painted Boundaries (9/19)

The sale boundary and Payment Unit boundaries are marked and identified by red paint, roads, or by cover type change (see Timber Sale Map). Exterior sale boundary lines against state are marked with red paint or designated by cover type change, or roads. The painted boundary line trees are not Included Timber and are to be protected unless marked with orange paint.

2 - Timber Specifications

2.1 - Included Timber

2.1.4 - Designated Timber Unit(s) (6/17)

Within Payment Unit(s) 1-4, all red pine trees and stems are designated for cutting that were damaged by the ice storm and are bent over, lying on the ground, snapped off, or missing over 40% of their live crown, regardless of merchantability.

2.1.11 - Description of Timber Note (2/04)

Note that this is an ice storm salvage sale. All Payment Units will be scaled by Sale Administrator. Chipping of Sale Area will not be required but is encouraged. If sale is chipped, the Purchaser must provide electronic confirmation of scale tickets at a minimum of once per week. To convert red pine chip weight to cords, we will use a conversion of 1 cord = 1.9 tons or 1 cord = 3,800 pounds. This is from the USDA's Timber Management Field Book, 2008 Edition table 2.10 Weight Table for Various Woods.

Timber prices for other minor species found within the Sale Area are:

Jack Pine: \$13.50/cord

Mixed Hardwood: \$14.00/cord

Mixed oak: \$7.50/cord

Mixed aspen: \$16.50/cord

White Pine: \$19.00/cord

2.2 - Utilization

2.2.3 - Stump Heights (12/24)

Stump heights within the sale area shall not exceed six (6) inches for all trees. This is in order to facilitate planting operations.

2.2.5 - Limbed Tree Skidding (12/24)

The skidding of whole trees or tree segments with limbs attached is prohibited, unless approved by the Unit Manager or his/her representative.

3 - Payments

3.2 - Scaled Sales

3.2.1 - Scale Location (2/04)

Forest products will be placed for measurement in an area identified by the Sale Administrator. In addition, negotiate with the Sale Administrator to determine the frequency of the scaling. Hauling of these products will only be allowed once permission is given from the Sale Administrator.

3.6 - Payment Unit Cutting Schedule

3.6.2 - One Active Unit (1/25)

Each Payment Unit must be completed to the satisfaction of the Unit Manager or his/her representative before the next Payment Unit may be opened. The Purchaser must give a one-week notice before finishing a Payment Unit to allow for inspection.

4 - Transportation

4.1 - Construction

4.1.3 - Slash and Earthen Piles (8/04)

Piles or windrows of earth along roads and landings that have been widened or constructed shall be leveled. Slash from road maintenance or construction, including stumps, shall be dispersed throughout the sale.

4.1.6 - Road Construction (4/24)

Construction of new roads or improvements of existing roads shall be done in such a way as to minimize the environmental and visual impacts. Merchantable trees shall be cut and utilized unless otherwise directed. Non-merchantable trees shall be severed and laid flat on the ground. Slash shall be scattered, not left in windrows, and kept a minimum of 10 feet back from the road edge. Stumps shall be set upright, not left on edge, and be moved at least 10 feet away from the road edge. Disturbed soil shall be feathered into the woods and not left in berms or windrows.

4.1.7 - Road Closure (10/11)

All new roads built into the sale must be blocked to vehicle traffic upon completion of the sale. Overgrown roads that are reopened shall be considered new roads. In general, this will require constructing a four (4') foot high berm of stumps and logs covered with earth. Stumps and brush must be placed along the remainder of the trail. These roads must be rendered impassable to cars and trucks. Temporary berms may be required if no sale activity occurs for 30 or more consecutive days. Contact the Sale Administrator for specific details of design and placement.

4.2 - Maintenance

4.2.5 - Two Wheel Drive Condition (2/04)

All existing trail roads on and adjacent to the Sale Area must be passable by two-wheel drive traffic for the duration of the sale.

5 - Operations

5.1 - Notification

5.1.1 - Pre-sale Conference (10/16)

A pre-sale conference on site between the Purchaser and Sale Administrator is required prior to beginning any operations to determine landing and road locations. The Unit Manager or his/her representative must be contacted at least five (5) days in advance to schedule the conference.

5.1.3 - Well Heads and Natural Gas Pipelines (11/15)

The Purchaser is responsible for contacting the gas or pipeline company at least five (5) days prior to operating equipment in the vicinity of well heads or natural gas pipelines.

5.1.4 - Post-Sale Conference (10/16)

A post-sale conference on site between the Purchaser and sale administrator is required five (5) days prior to the completion of active logging operations to determine clean-up and repair of landings, road edges, and the fulfillment of other contract specifications.

5.2 - Conduct of Operations

5.2.1 - Slash

5.2.1.10 - No Slash in Openings (5/10)

No brush or logging debris is to be left in the adjacent open stands. Some of these adjacent stands are likely to be treated with prescribed fire in the upcoming years. Any damage to the opening shall be repaired according to specifications of the Unit Manager or his/her representative.

5.2.32 - Decking/Landing Restoration (9/13)

All decking and landing areas must have the surface area restored to a condition equal to or better than before. This is to ensure the proper regeneration of the stand. Wood debris, chips and "cookies" from trimmings must be removed or scattered away from landing and loading areas and may not be windrowed on the edge. If landings are located in adjacent open stands, the site may be required to be revegetated with a seed mixture specified by the Unit Manager and his/her representative.

5.2.33 - Gas Well Revegetation (12/08)

In the event that the gas well is utilized for a landing, the site must be revegetated with a seeding mixture specified by the Unit Manager or his/her representative.

5.2.38 - No Decking Against Live Trees (2/04)

Cut products may not be decked against unmarked or designated leave trees.

5.8 - Protection of Endangered Species

5.8.8 - Protected Species, Other (2/12)

Within Payment Unit 1, no harvest activities (cutting, forwarding, hauling, etc.) shall occur unless the ground is frozen or dry and firm. This restriction is to protect the Eastern Massasauga Rattlesnake and its habitat.

6 - Safety and Fire Prevention

6.2 - Signing

6.2.1 - Road Posting (10/20)

The Purchaser is responsible for posting and maintaining caution signs on unnamed forest roads running through/adjacent to Payment Units 1 and 2, County road 622 for Payment Unit 2, and Black River Road for Payment Unit 4 prior to beginning operations. The road must be posted at appropriate distances from the Sale Area to warn of logging activity and truck traffic. Signs must be removed when harvest operations are suspended or completed. The Purchaser will provide these signs.

7 - Other Conditions

7.2 - Extensions

7.2.2 - No Extensions (3/09)

There will be no extensions granted on this contract.

7.5 - Loss

7.5.1 - Deteriorating Timber (7/09)

The Sale Area has received damage from the ice storm in late March 2025. The Purchaser should harvest the wood as soon as possible. The Department of Natural Resources is held free of responsibility of any further damage or deterioration due to delay in harvesting.



TIMBER SALE MAP

This information provided by authority of Part 525, 1994 PA 451, as amended.

Sale Number
54-015-25

Date
05/16/2025

Forest Management Unit
Atlanta Mgt Unit

County
Montmorency

Mapped By:
Cruised By:

Scale
1:12,000

Page
3

Of
3

Township | Range | Section(s) and Subdivision(s)
31N / 32N | 01E / 02E | Sec. 28 NE,NWSE; Sec. 29 N1/2NW; Sec. 5 E1/2NW,W1/2NE;

Cover Type

A = Aspen	J = Jack Pine	O = Oak	U = Upland Brush
B = Paper Birch	K = Rock	P = Lowland Poplar	UM = Upland Mix Forest
C = Cedar	L = Lowland Brush	Q = Mixed Swamp Conifer	V = Bog or Marsh
D = Treed Bog	LM = Lowland Mix Forest	R = Red Pine	W = White Pine
E = Swamp Hardwoods	M = Maple, Beech, Birch	S = Black Spruce	X = Non Stocked
F = Spruce/Fir	MC = Mixed Conifer	T = Tamarack	Y = Sand
G = Grass	MD = Mixed Deciduous		Z = Water
H = Hemlock	N = Marsh		

Density

0 = Non Stocked	5 = Pole Timber Medium
1 = Seedling Sapling Poor	6 = Pole Timber Well
2 = Seedling Sapling Medium	7 = Saw Timber Poor
3 = Seedling Sapling Well	8 = Saw Timber Medium
4 = Pole Timber Poor	9 = Saw Timber Well

Payment Unit Number	Acres
1	15.7
2	18.9
3	9.8
4	18.5

Ice Foch Lake Red Pine Salvage
62.9 Acres
Compartments 40, 43, & 59



0 0.13 0.25 0.5 Miles

Locator Map 1:100,000

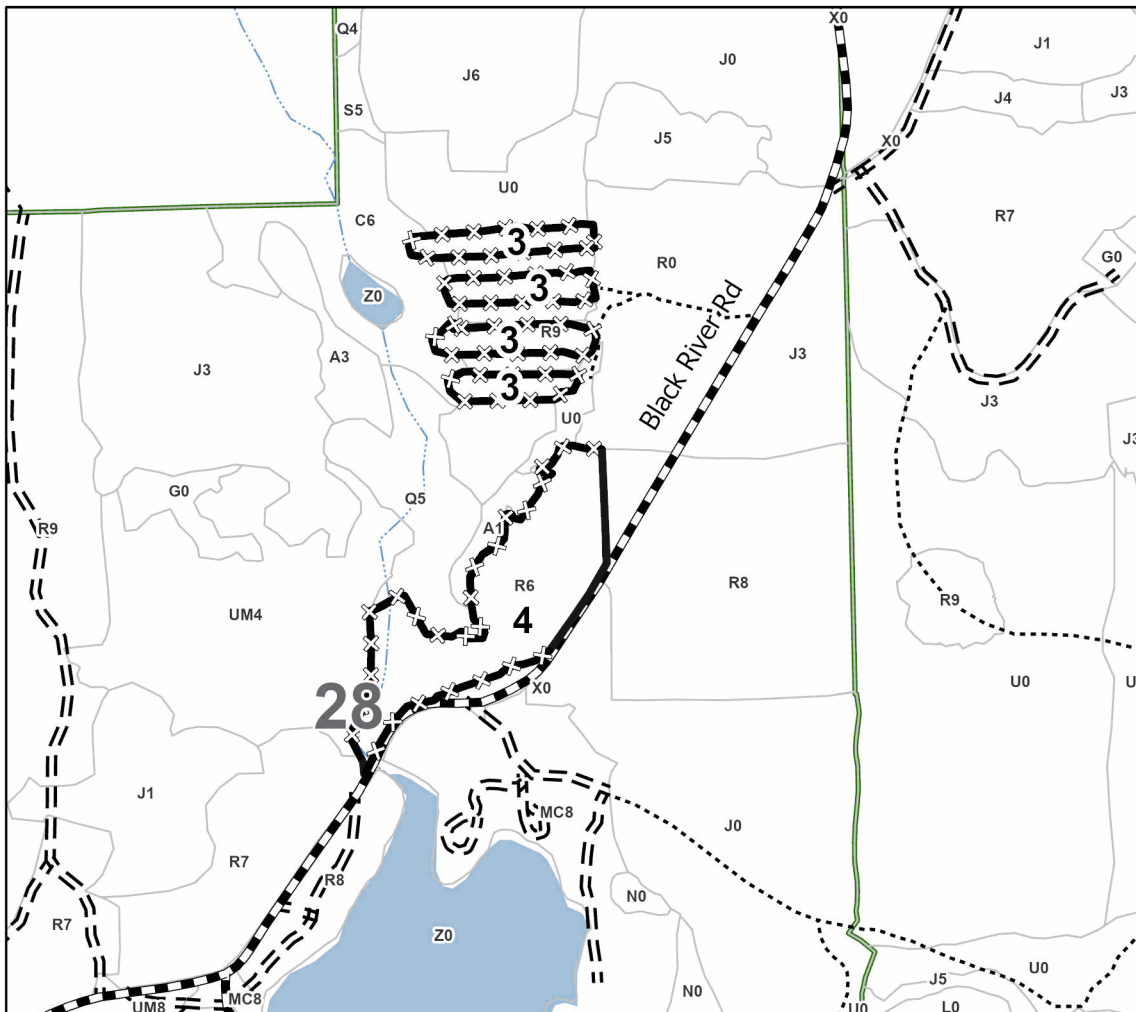
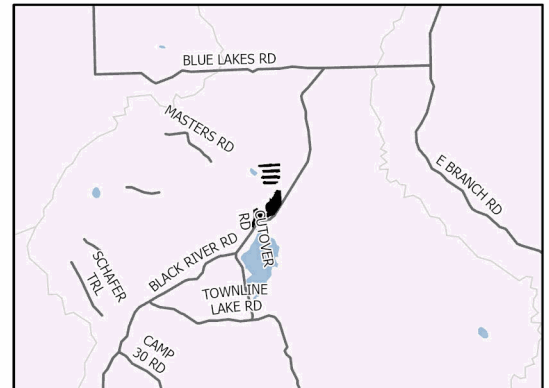

Legend

- Against State (Red)
- Against State (Unpainted)
- Primary Forest Road
- - - Forest Access Route
- ... Administrative Access Only
- Paved Road
- - - Government Gravel/Dirt
- - - Private Gravel/Dirt
- Retention Areas
- Nearby Timber Sale

Use QR Code to open Map in App





TIMBER SALE MAP

This information provided by authority of Part 525, 1994 PA 451, as amended.

Forest Management Unit Atlanta Mgt Unit	County Montmorency	Mapped By:	Scale 1:12,000	Page 2	Of 3
		Cruised By:			

Township	Range	Section(s) and Subdivision(s)
31N / 32N	01E / 02E	Sec. 28 NE,NWSE; Sec. 29 N1/2NW; Sec. 5 E1/2NW,W1/2NE;

Cover Type

A = Aspen	J = Jack Pine	O = Oak	U = Upland Brush
B = Paper Birch	K = Rock	P = Lowland Poplar	UM = Upland Mix Forest
C = Cedar	L = Lowland Brush	Q = Mixed Swamp Conifer	V = Bog or Marsh
D = Treed Bog	LM = Lowland Mix Forest	R = Red Pine	W = White Pine
E = Swamp Hardwoods	M = Maple, Beech, Birch	S = Black Spruce	X = Non Stocked
F = Spruce/Fir	MC = Mixed Conifer	T = Tamarack	Y = Sand
G = Grass	MD = Mixed Deciduous		Z = Water
H = Hemlock	N = Marsh		

Density

0 = Non Stocked	5 = Pole Timber Medium
1 = Seedling Sapling Poor	6 = Pole Timber Well
2 = Seedling Sapling Medium	7 = Saw Timber Poor
3 = Seedling Sapling Well	8 = Saw Timber Medium
4 = Pole Timber Poor	9 = Saw Timber Well

Payment Unit Number	Acres
1	15.7
2	18.9
3	9.8
4	18.5

Ice Foch Lake Red Pine Salvage
62.9 Acres
Compartments 40, 43, & 59

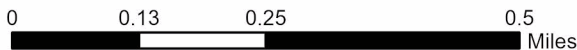

Locator Map 1:100,000

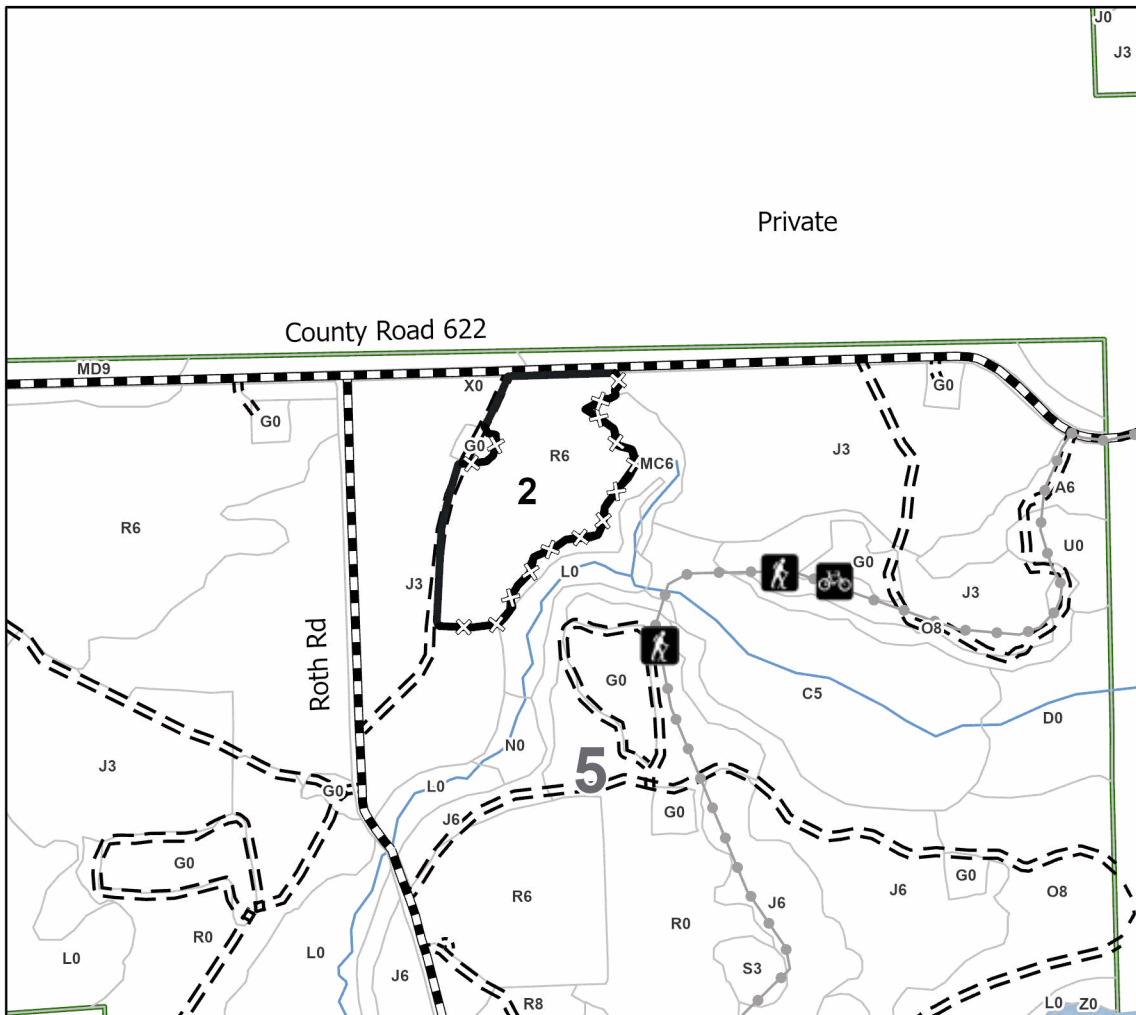
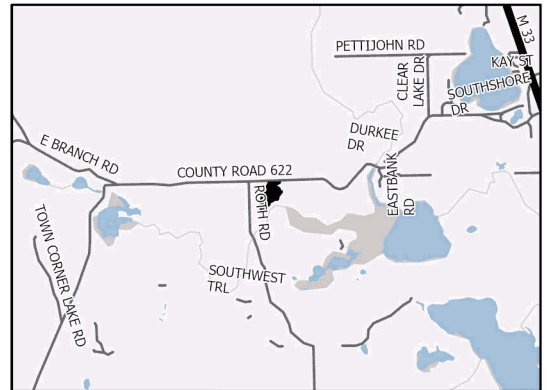

Legend

- Against State (Red)
- Against State (Unpainted)
- Recreational Trails
- Primary Forest Road
- Forest Access Route
- Administrative Access Only
- Paved Road
- Government Gravel/Dirt
- Private Gravel/Dirt
- Retention Areas
- Nearby Timber Sale

Use QR Code to open Map in App





TIMBER SALE MAP

This information provided by authority of Part 525, 1994 PA 451, as amended.

Sale Number

54-015-25

Date

05/16/2025

Forest Management Unit

Atlanta Mgt Unit

County

Montmorency

Mapped By:

Cruised By:

Scale

1:12,000

Page

1

Of

3

Township

31N / 32N

Range

01E / 02E

Section(s) and

Subdivision(s) Sec. 28 NE,NWSE; Sec. 29 N1/2NW; Sec. 5 E1/2NW,W1/2NE;

Cover Type

A = Aspen	J = Jack Pine	O = Oak	U = Upland Brush
B = Paper Birch	K = Rock	P = Lowland Poplar	UM = Upland Mix Forest
C = Cedar	L = Lowland Brush	Q = Mixed Swamp Conifer	V = Bog or Marsh
D = Treed Bog	LM = Lowland Mix Forest	R = Red Pine	W = White Pine
E = Swamp Hardwoods	M = Maple, Beech, Birch	S = Black Spruce	X = Non Stocked
F = Spruce/Fir	MC = Mixed Conifer	T = Tamarack	Y = Sand
G = Grass	MD = Mixed Deciduous	Z = Water	
H = Hemlock	N = Marsh		

Density

0 = Non Stocked	5 = Pole Timber Medium
1 = Seedling Sapling Poor	6 = Pole Timber Well
2 = Seedling Sapling Medium	7 = Saw Timber Poor
3 = Seedling Sapling Well	8 = Saw Timber Medium
4 = Pole Timber Poor	9 = Saw Timber Well

Payment Unit
Number

Acres

1	15.7
2	18.9
3	9.8
4	18.5

Ice Foch Lake Red Pine Salvage

62.9 Acres

Compartments 40, 43, & 59



0 0.13 0.25 0.5 Miles

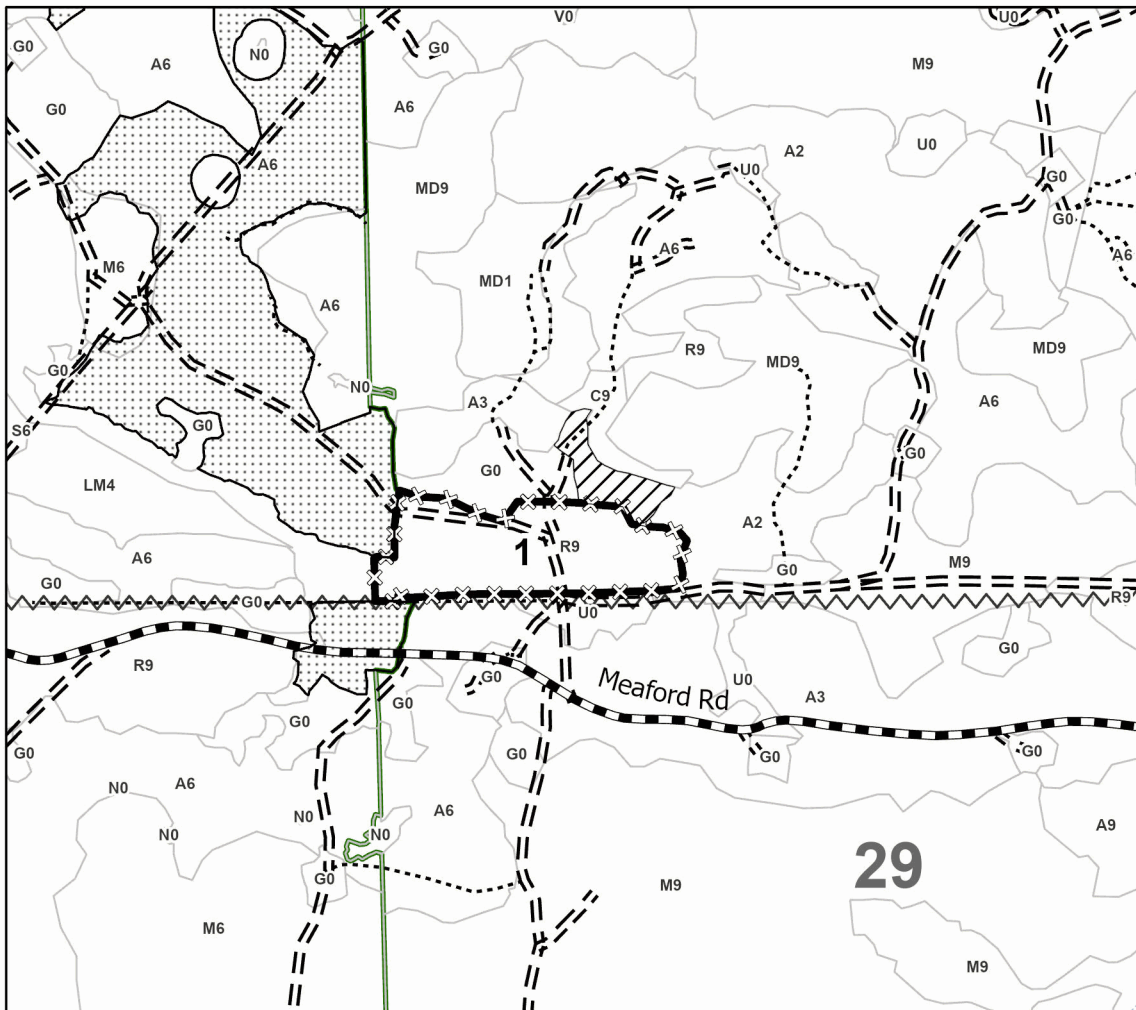
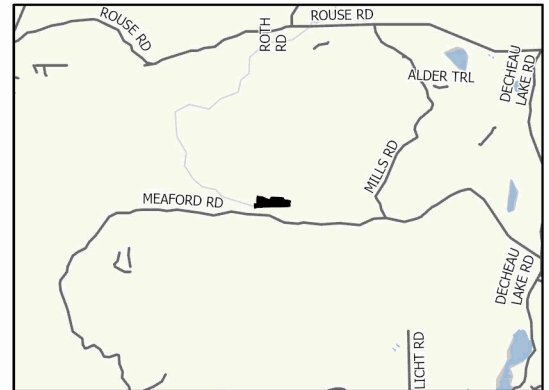

Legend

- Against State (Red)
- Against State (Unpainted)
- Abandoned Railroad
- Primary Forest Road
- Forest Access Route
- Administrative Access Only
- Paved Road
- Government Gravel/Dirt
- Private Gravel/Dirt
- Retention Areas
- Nearby Timber Sale

Use QR Code to
open Map in App

