



**DEPARTMENT OF NATURAL RESOURCES
STATE OF MICHIGAN**

TIMBER SALE PROSPECTUS #7754

REVISION NOTICE #1 - November 25, 2025

SCHEDULED SALE DATE AND TIME: 10:00 a.m. (local time) on Monday, December 15, 2025

LOCATION: SAULT DNR CUSTOMER SERVICE CENTER, 4131 S. M-129, Sault Ste Marie, MI 49783

This prospectus has been modified with the following changes.

The sale map(s) for the D.I. Deep Abyss timber sale (45-011-25) has been updated. The map which was originally advertised was missing payment unit labels. Please use the attached sale map(s) when bidding on this sale and disregard the original sale map(s) sent with the prospectus.

We apologize for any inconvenience this may have caused. If you need assistance, please contact Josh Brinks at 906-203-0210.



TIMBER SALE MAP

This information provided by authority of Part 525, 1994 PA 451, as amended.

Sale Number
45-011-25

Date
08/29/2025

Forest Management Unit

County

Mapped By: Fanelli

Scale

Page

Of

Sault Ste Marie Mgt Unit

Chippewa

Cruised By: Fanelli

1:15,840

1

1

Township
41N

Range
06E

Section(s) and
Subdivision(s) Sec. 10 NW; Sec. 11 N1/2SW; Sec. 9 E1/2NE;

Cover Type

A = Aspen	J = Jack Pine	O = Oak	U = Upland Brush
B = Paper Birch	K = Rock	P = Lowland Poplar	UM = Upland Mix Forest
C = Cedar	L = Lowland Brush	Q = Mixed Swamp Conifer	V = Bog or Marsh
D = Treed Bog	LM = Lowland Mix Forest	R = Red Pine	W = White Pine
E = Swamp Hardwoods	M = Maple, Beech, Birch	S = Black Spruce	X = Non Stocked
F = Spruce/Fir	MC = Mixed Conifer	T = Tamarack	Y = Sand
G = Grass	MD = Mixed Deciduous	Z = Water	
H = Hemlock	N = Marsh		

Density

0 = Non Stocked	5 = Pole Timber Medium
1 = Seedling Sapling Poor	6 = Pole Timber Well
2 = Seedling Sapling Medium	7 = Saw Timber Poor
3 = Seedling Sapling Well	8 = Saw Timber Medium
4 = Pole Timber Poor	9 = Saw Timber Well

Payment Unit Number	Acres
1	32.7
2	34.1
3	15.8

D.I. Deep Abyss 82.6 Acres

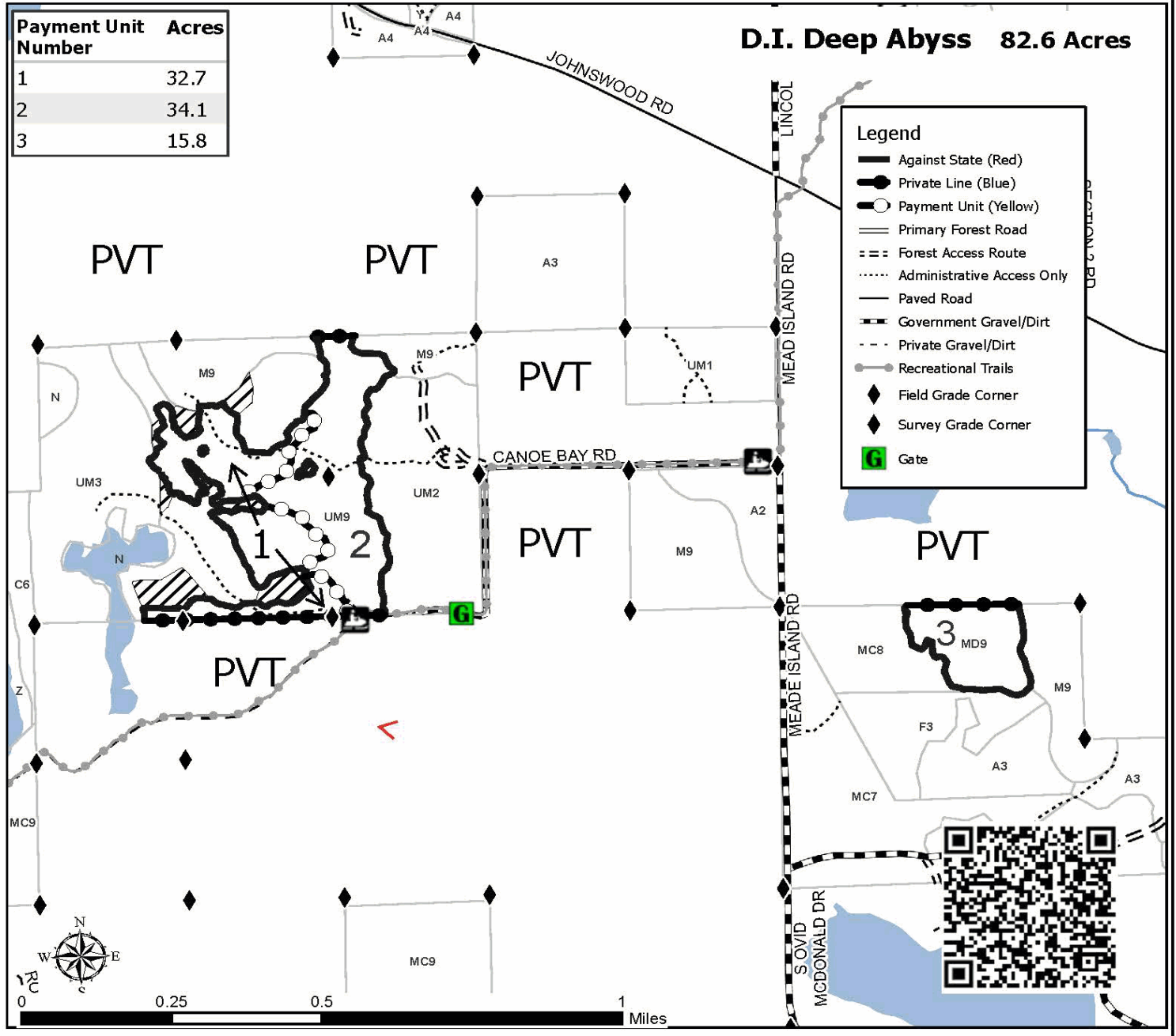



**DEPARTMENT OF NATURAL RESOURCES
STATE OF MICHIGAN
TIMBER SALE PROSPECTUS #7754**

SCHEDULED SALE DATE AND TIME: 10:00 a.m. (local time) on December 15, 2025.

LOCATION: SAULT DNR CUSTOMER SERVICE CENTER, 4131 S. M-129, SAULT STE MARIE, MI 49783.

CONTACT NAME: Josh Brinks

PHONE NUMBER: (906) 203-0210

PROSPECTUS NOTE: The bidder is advised to inspect the sale area and review the location, estimated volumes, operating costs and contract terms of proposed sales. Please be aware that some landowners may request 60 days or more notice for access across their land.

Notice is hereby given that bids will be received by the Unit Manager, SAULT STE MARIE MANAGEMENT UNIT, for certain timber on the following described lands:

DI Backyard Boards (45-013-25) / T41N, R06E, SEC. 4 , NWNW.

T41N, R06E, SEC. 5 , NENE.

T41N, R06E, SEC. 6 , NENW,NWNE.

T42N, R06E, SEC. 31, SESW,SWSE.

T42N, R06E, SEC. 32, NESW,W1/2SE.

Chippewa County, Advertised Price \$8,365.85, 69.8 Acres, Aspen, Hardwood.

SALE NOTE: This sale will require access through private property.

Access may be through private land.

TIMBER SALE INFORMATION

DI Backyard Boards (45-013-25)

T41N, R06E, SEC. 4; T41N, R06E, SEC. 5; T41N, R06E, SEC. 6; T42N, R06E, SEC. 31; T42N, R06E, SEC. 32.
Chippewa County (Advertised Price \$8,365.85)

SALE NOTE: This sale will require access through private property.

Access may be through private land.

A timber sale contract for this lump sum, sealed bid timber sale will be awarded to the responsible bidder offering the highest sealed bid price . All units of volume listed below were estimated using the Inventory Manager computer program and the new Michigan taper model. Bids must be at or above the following advertised price for each product and species:

<u>PRODUCTS & SPECIES</u>	<u>ESTIMATED UNITS*</u>	<u>ADVERTISED PRICE</u>
Sawtimber		
Sugar Maple	18.5 MBF	\$ 139.00 / MBF
Pulpwood		
Balsam Fir	62 Cords	\$ 6.60 / Cord
Mixed Aspen	256 Cords	\$ 8.50 / Cord
Mixed Hardwood	340 Cords	\$ 7.50 / Cord
N. White Cedar	157 Cords	\$ 2.55 / Cord
Paper Birch	23 Cords	\$ 5.80 / Cord
White Spruce	19 Cords	\$ 6.60 / Cord

* The total volume is statistically estimated within plus (+) or minus (-) 16.70 percent. There are an estimated 900 cords on this timber sale, plus or minus 150 cords at the 95% confidence level. The estimated units are final and not subject to adjustment. Prospective bidders are urged to examine this timber and to make their own estimates of quantity and quality.

BOND AND PAYMENT SCHEDULE:

1. A bond in the amount of \$669.27 to insure faithful performance of the conditions of the contract will be deposited by the successful bidder within 21 days of the sale award.
2. Cutting in any sale or unit without the required advance payment would be considered a trespass.
3. Total payment must be paid in advance or according to the following schedule :
 - (a) Ten percent (10%) of the sale value must be paid within 21 days of the sale award.
 - (b) The 10% down payment will be credited towards the first unit cut.
 - (c) Payment for each of the following units must be made before cutting begins in that unit:

PAYMENT UNIT NUMBER	PERCENT OF TOTAL SALE VALUE
01	20.7%
02	55.5%
03	23.8%
4. If no cutting takes place, the 10% down payment will not be refunded.
5. Operations on the contract issued will terminate on 06/30/2029.

SALE STATISTICS

Volumes were calculated in cubic feet using the Michigan taper model. Cubic foot volume includes all wood inside bark for the product indicated. For display purposes, cubic feet were converted to cords and MBF using a simple conversion factor, e.g. 79 cubic feet per cord and 185 cubic feet per MBF. The cubic foot volumes are precise; the cords and MBF volumes are not. Cubic foot volume cannot be directly converted to cords or boards with precision.

SALE VOLUMES

The total estimated sale volume may not equal the sum of the species/products due to the nature of statistical calculations associated with double sampling methodology.

VOLUME		STATISTICAL RANGE IN CORDS		
TOTAL CUBIC FEET	TOTAL CORDS	PERCENT ERROR	MINIMUM	MAXIMUM
71,087	900	16.70%	750	1,050

VDU VOLUMES

A VDU is a Volume Determination Unit. Volumes and their associated statistics are calculated at the VDU level and summarized to the sale level. There is often a one to one relationship between a VDU and a Payment Unit, but not always, depending on the cruise design. Refer to the VDU TO PAYMENT UNIT table.

VDU	VOLUME		PERCENT ERROR	RANGE IN CORDS	
	TOTAL CUBIC FEET	TOTAL CORDS		MINIMUM	MAXIMUM
3	28,370	359	22.49%	278	440
19	25,210	319	25.14%	239	399
30	17,507	222	45.86%	120	323
TOTAL:	71,087	900		637	1,162

VDU TO PAYMENT UNIT

When a VDU is associated with more than one Payment Unit (PU), the VDU volumes are assigned to the PU based on acres of the VDU within the PU.

VDU	VDU ACRES	PU	PU ACRES
TOTAL:			

DESCRIPTION OF TIMBER BY PU (PU)

PU	MARKET GROUP	PRODUCT	QUANTITY	UNIT	ACRES	ADVERTISE PRICE
1	Balsam Fir	Pulpwood	29	Cords	12.7	\$1,733.00
	Mixed Aspen		129	Cords		
	<i>B. T. Aspen</i>		14	Cords		
	<i>Quaking Aspen</i>		115	Cords		
	Mixed Hardwood		45	Cords		
	<i>Basswood</i>		2	Cords		
	<i>Sugar Maple</i>		21	Cords		
	<i>White Ash</i>		22	Cords		
	Paper Birch		14	Cords		
	White Spruce		4	Cords		
2	Sugar Maple	Sawtimber	18.5	MBF	43.1	\$4,641.50
	Mixed Hardwood	Pulpwood	276	Cords		
	<i>Beech</i>		84	Cords		
	<i>Ironwood</i>		1	Cords		
	<i>Sugar Maple</i>		191	Cords		
3	Balsam Fir	Pulpwood	33	Cords	14.0	\$1,991.35
	Mixed Aspen		127	Cords		
	<i>Balsam Poplar</i>		3	Cords		
	<i>Quaking Aspen</i>		124	Cords		
	Mixed Hardwood		19	Cords		
	<i>Beech</i>		1	Cords		
	<i>Red Maple</i>		14	Cords		
	<i>Striped Maple</i>		2	Cords		
	<i>Sugar Maple</i>		2	Cords		
	N. White Cedar		157	Cords		
	Paper Birch		9	Cords		
White Spruce	15	Cords				
TOTAL:			18.5	MBF		
TOTAL:			857	Cords		

Sale Specific Conditions & Requirements

Sale Name: DI Backyard Boards

Sale Number: 45-013-25 Seq#: 1

1 - Sale Area

1.2 - Boundaries

1.2.1 - Painted Boundaries (9/19)

The sale boundary and Payment Unit boundaries are marked and identified by blue and red paint. Exterior sale boundary lines against private property are marked with blue paint. Exterior sale boundary lines against state are marked with red paint. The painted boundary line trees are not Included Timber and are to be protected unless marked with orange paint.

2 - Timber Specifications

2.1 - Included Timber

2.1.1 - Clearcut Unit(s) with Unmerchantable Trees (6/14)

Within Payment Unit(s) 1 & 3, cut all trees that are two (2) inches or more at DBH, except do not cut pine, hemlock, yellow birch, oak, or elm. In addition, within Payment Unit 1, do not cut cedar or beech.

2.1.3 - Cut Tree Marked Unit(s) (12/08)

Within Payment Unit(s) 2, all trees are designated for cutting when marked with orange paint above and below stump height, regardless of merchantability.

2.1.9 - Harvest Exception (12/24)

Do not cut any cedar trees in Payment Unit 1 other than those that are necessary to remove in order to operate within the Sale Area. Every effort must be made to preserve the existing cedar and to leave an intact stand upon sale completion. All cut cedar shall be piled separately by product and scaled in the woods, unless other scaling arrangements are agreed to by the Unit Manager or his/her representative. Stumpage price for cedar shall be \$20.00 per cord.

2.1.15 - Hazard Trees Near Roads (12/24)

Cut and remove all standing dead trees within 75 feet of the cleared portion of S. Walding Rd. These trees may be utilized or must be scattered back into the Sale Area.

2.2 - Utilization

2.2.3 - Stump Heights (12/24)

Stump heights within the Sale Area shall not exceed 24 inches for trees greater than 10 inches at DBH and multi-stemmed trees, and twelve (12) inches for trees smaller than 10 inches at DBH.

3 - Payments

3.3 - Pre-measured Sales

3.3.4 - Dividing Payment Units (7/14)

Payment Unit(s) may be divided at the request of the Purchaser and upon approval of the Unit Manager. Dividing Payment Units is a contract modification which requires a Timber Sale Contract Amendment. There will be only one division per Payment Unit. When paint or flagging is used to mark the divisions of Payment Units, the trees identifying the Payment Unit may only be harvested once both Payment Units have been paid for.

3.4 - Damaged Timber

3.4.1 - Damaged Timber (12/24)

General Condition and Requirement 3.4 Damaged Timber, defines liquidated damages for undesignated live merchantable trees which are cut or injured.

No damage is acceptable to undesignated live merchantable trees. Within the Sale Area, if more than 5% of trees (> 4.5" DBH) within a specified area of the sale are damaged, liquidated damages will be assessed for all trees damaged. Rates will be in accordance with General Condition and Requirement 3.4 Damaged Timber.

4 - Transportation

4.1 - Construction

4.1.3 - Slash and Earthen Piles (8/04)

Piles or windrows of earth along roads and landings that have been widened or constructed shall be leveled. Slash from road maintenance or construction, including stumps, shall be dispersed throughout the sale.

4.1.6 - Road Construction (4/24)

Construction of new roads or improvements of existing roads shall be done in such a way as to minimize the environmental and visual impacts. Merchantable trees shall be cut and utilized unless otherwise directed. Non-merchantable trees shall be severed and laid flat on the ground. Slash shall be scattered, not left in windrows, and kept a minimum of 10 feet back from the road edge. Stumps shall be set upright, not left on edge, and be moved at least 10 feet away from the road edge. Disturbed soil shall be feathered into the woods and not left in berms or windrows.

4.1.7 - Road Closure (10/11)

All new roads built into the sale must be blocked to vehicle traffic upon completion of the sale. Overgrown roads that are reopened shall be considered new roads. In general, this will require constructing double earthen berms at strategic locations. Stumps and brush must be placed along the remainder of the trail. These roads must be rendered impassable to cars and trucks. Contact the Sale Administrator for specific details of design and placement.

4.4 - Access

4.4.1 - Private property access (3/11)

Permission for access across private land is the responsibility of the Purchaser. Should the Purchaser desire to cross private land, a copy of the written permission from the private landowner may be required by the DNR.

5 - Operations

5.2 - Conduct of Operations

5.2.1 - Slash

5.2.1.8 - Slash Height (12/08)

No slash or tree tops may exceed 24 inches in height.

5.2.2 - Hazard Trees/Snags

5.2.2.1 - Den Trees (10/16)

Obvious hollow and/or den trees shall be protected and left standing unless they are a safety hazard.

5.2.3 - Operating Restrictions

5.2.3.1 - Operating Restrictions (9/11)

Within Payment Unit(s) 1 & 3, unless changed by written agreement, cutting, skidding, and hauling are limited to the period of December 1 to March 31. This restriction is to provide food resources for wintering deer.

5.2.3.3 - Bark Slippage Restriction (3/09)

Within Payment Unit(s) 2, unless changed by written agreement, cutting and skidding are not permitted during the period of May 1 to July 1. This restriction is because of bark slippage.

5.2.4 - Dead and Down Creation

5.2.4.6 - Dead and Down Creation, Other (9/09)

In Payment Unit 3, create hare habitat by leaving slash in piles measuring 6' tall and 12' in diameter throughout the Payment Unit. Leave one pile every 2 acres.

5.2.32 - Decking/Landing Restoration (9/13)

All decking and landing areas must have the surface area restored to a condition equal to or better than before. This is to ensure the proper regeneration of the stand. Wood debris, chips and "cookies" from trimmings must be removed or scattered away from landing and loading areas and may not be windrowed on the edge.

5.2.37 - No Decking Areas (12/08)

No decking is allowed within 50 feet of S. Walding Rd.

5.2.38 - No Decking Against Live Trees (2/04)

Cut products may not be decked against unmarked or designated leave trees.

5.8 - Protection of Endangered Species

5.8.5 - Protection of Raptor Nests (3/13)

All trees with raptor nests will be protected if found during harvesting operations. Notification will be made to the Unit Manager or his/her representative who will notify the Wildlife Biologist so an onsite evaluation and recommendation can be made, if necessary.

6 - Safety and Fire Prevention

6.2 - Signing

6.2.1 - Road Posting (10/20)

The Purchaser is responsible for posting and maintaining caution signs on S. Walding Rd. prior to beginning operations. The road must be posted at appropriate distances from the Sale Area to warn of logging activity and truck traffic. Signs must be removed when harvest operations are suspended or completed. The Purchaser will provide these signs.

TIMBER SALE MAP

This information provided by authority of Part 525, 1994 PA 451, as amended.

Sale Number
45-013-25

Date
09/18/2025

Forest Management Unit	County	Mapped By: Louis Radecki
Sault Ste Marie Mgt Unit	Chippewa	Cruised By: Louis Radecki

Scale	Page	Of
1:20,000	1	1

Township	Range	Section(s) and Subdivision(s)
41N / 42N	06E	Sec. 31 SESW,SWSE; Sec. 32 NESW,W1/2SE; Sec. 4 NWNW; Sec. 5 NENE; Sec. 6 NENW,NWNE;

Cover Type

A = Aspen	J = Jack Pine	O = Oak	U = Upland Brush
B = Paper Birch	K = Rock	P = Lowland Poplar	UM = Upland Mix Forest
C = Cedar	L = Lowland Brush	Q = Mixed Swamp Conifer	V = Bog or Marsh
D = Treed Bog	LM = Lowland Mix Forest	R = Red Pine	W = White Pine
E = Swamp Hardwoods	M = Maple, Beech, Birch	S = Black Spruce	X = Non Stocked
F = Spruce/Fir	MC = Mixed Conifer	T = Tamarack	Y = Sand
G = Grass	MD = Mixed Deciduous		Z = Water
H = Hemlock	N = Marsh		

Density

0 = Non Stocked	5 = Pole Timber Medium
1 = Seedling Sapling Poor	6 = Pole Timber Well
2 = Seedling Sapling Medium	7 = Saw Timber Poor
3 = Seedling Sapling Well	8 = Saw Timber Medium
4 = Pole Timber Poor	9 = Saw Timber Well

Payment Unit Number	Acres
1	12.7
2	43.1
3	14

DI Backyard Boards

69.8 Acres

Locator Map 1:100,000

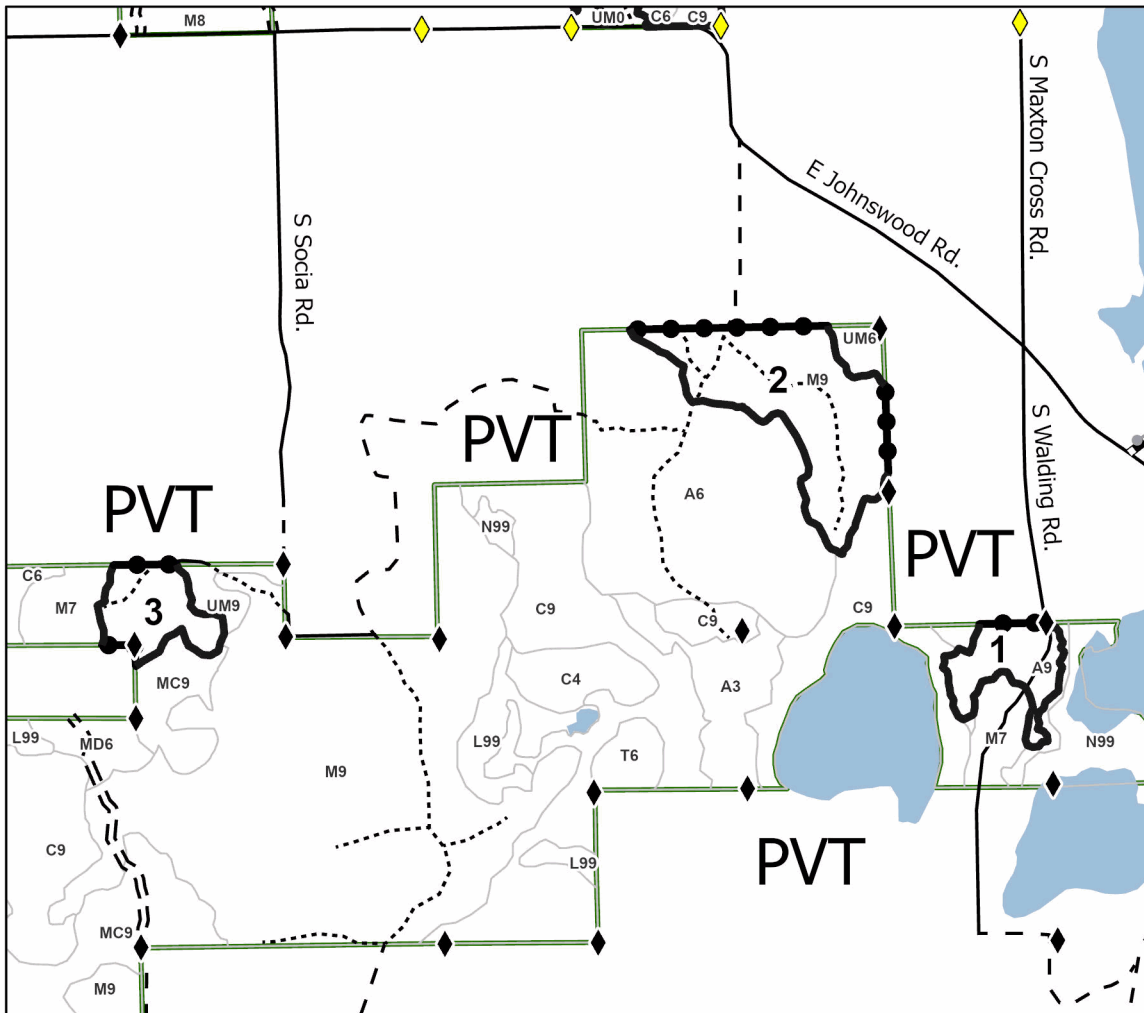

Legend

- Against State (Red)
- Private Line (Blue)
- Forest Access Route
- Administrative Access Only
- Paved Road
- Government Gravel/Dirt
- Private Gravel/Dirt
- Field Grade Corner
- Survey Grade Corner

Use QR Code to open Map in App

