



**DEPARTMENT OF NATURAL RESOURCES
STATE OF MICHIGAN
TIMBER SALE PROSPECTUS #7793**

SCHEDULED SALE DATE AND TIME: 9:00 a.m. (local time) on February 12, 2026.

LOCATION: ATLANTA MGMT UNIT, 13501 M 33, ATLANTA, MI 49709.

CONTACT NAME: Matt Foster

PHONE NUMBER: (989) 619-5921

PROSPECTUS NOTE: The bidder is advised to inspect the sale area and review the location, estimated volumes, operating costs and contract terms of proposed sales. Please be aware that some landowners may request 60 days or more notice for access across their land.

Notice is hereby given that bids will be received by the Unit Manager, ATLANTA MANAGEMENT UNIT, for certain timber on the following described lands:

Ice James Rd Red Pine Salvage (54-008-26) / T31N, R05E, SEC. 23, N1/2NE.
Alpena County, Advertised Price \$4,652.55, 6.2 Acres, Red Pine.

SALE NOTE: -This is an ice storm damaged salvage sale. Refer to timber sale specs 2.1.11, 7.2.2, and 7.5.1 for details.

-The use of a feller buncher is not allowed for the protecting of regeneration. Refer to timber sale specs 2.2.6 and 3.4.1 for details.

-Any questions related to this ice storm damage salvage sale can be directed to MI DNR Forester Dale Parris at (989) 590-1204 or parrisd2@michigan.gov.

TIMBER SALE INFORMATION

Ice James Rd Red Pine Salvage (54-008-26)

T31N, R05E, SEC. 23.

Alpena County (Advertised Price \$4,652.55)

SALE NOTE: -This is an ice storm damaged salvage sale. Refer to timber sale specs 2.1. 11, 7.2.2, and 7.5.1 for details.

-The use of a feller buncher is not allowed for the protecting of regeneration. Refer to timber sale specs 2.2.6 and 3.4.1 for details.

-Any questions related to this ice storm damage salvage sale can be directed to MI DNR Forester Dale Parris at (989) 590-1204 or parrisd2@michigan.gov.

A timber sale contract for this lump sum, sealed bid timber sale will be awarded to the responsible bidder offering the highest sealed bid price. All units of volume listed below were estimated using the Inventory Manager computer program and the new Michigan taper model. Bids must be at or above the following advertised price for each product and species:

<u>PRODUCTS & SPECIES</u>	<u>ESTIMATED UNITS*</u>	<u>ADVERTISED PRICE</u>
Sawtimber		
Red Pine	48.3 MBF	\$ 59.00 / MBF
Pulpwood		
Austrian Pine	10 Cords	\$ 14.90 / Cord
Misc. Species 2	45 Cords	\$ 5.00 / Cord
Misc. Species 3	8 Cords	\$ 5.00 / Cord
Red Pine	47 Cords	\$ 29.55 / Cord

* The total volume is statistically estimated within plus (+) or minus (-) 28.90 percent. There are an estimated 224 cords on this timber sale, plus or minus 65 cords at the 95% confidence level. The estimated units are final and not subject to adjustment. Prospective bidders are urged to examine this timber and to make their own estimates of quantity and quality.

BOND AND PAYMENT SCHEDULE:

1. A bond in the amount of \$1,000.00 to insure faithful performance of the conditions of the contract will be deposited by the successful bidder within 21 days of the sale award.
2. Cutting in any sale or unit without the required advance payment would be considered a trespass.
3. Total payment must be paid in advance or according to the following schedule:
 - (a) Ten percent (10%) of the sale value must be paid within 21 days of the sale award.
 - (b) The remainder is due before cutting begins.
 - (c) Payment for each of the following units must be made before cutting begins in that unit:

PAYMENT UNIT NUMBER	PERCENT OF TOTAL SALE VALUE
01	100.0%
4. If no cutting takes place, the 10% down payment will not be refunded.
5. Operations on the contract issued will terminate on 06/30/2028.

SALE STATISTICS

Volumes were calculated in cubic feet using the Michigan taper model. Cubic foot volume includes all wood inside bark for the product indicated. For display purposes, cubic feet were converted to cords and MBF using a simple conversion factor, e.g. 79 cubic feet per cord and 185 cubic feet per MBF. The cubic foot volumes are precise; the cords and MBF volumes are not. Cubic foot volume cannot be directly converted to cords or boards with precision.

SALE VOLUMES

The total estimated sale volume may not equal the sum of the species/products due to the nature of statistical calculations associated with double sampling methodology.

VOLUME			STATISTICAL RANGE IN CORDS	
TOTAL CUBIC FEET	TOTAL CORDS	PERCENT ERROR	MINIMUM	MAXIMUM
17,697	224	28.90%	159	289

VDU VOLUMES

A VDU is a Volume Determination Unit. Volumes and their associated statistics are calculated at the VDU level and summarized to the sale level. There is often a one to one relationship between a VDU and a Payment Unit, but not always, depending on the cruise design. Refer to the VDU TO PAYMENT UNIT table.

	VOLUME			RANGE IN CORDS	
VDU	TOTAL CUBIC FEET	TOTAL CORDS	PERCENT ERROR	MINIMUM	MAXIMUM
21	17,697	224	28.91%	159	289
TOTAL:	17,697	224		159	289

VDU TO PAYMENT UNIT

When a VDU is associated with more than one Payment Unit (PU), the VDU volumes are assigned to the PU based on acres of the VDU within the PU.

VDU	VDU ACRES	PU	PU ACRES
TOTAL:			

DESCRIPTION OF TIMBER BY PU (PU)

PU	MARKET GROUP	PRODUCT	QUANTITY	UNIT	ACRES	ADVERTISE PRICE
1	Red Pine	Sawtimber	48.3	MBF	6.2	\$4,652.55
	Austrian Pine	Pulpwood	10	Cords		
	Austrian Pine	Sawtimber	1.8	MBF		
	Austrian Pine	Pulpwood	4	Cords		
	Scotch Pine		2	Cords		
	Misc. Species 2		45	Cords		
	Misc. Species 3		8	Cords		
	Red Pine		47	Cords		
TOTAL:			48.3	MBF		
TOTAL:			110	Cords		

Sale Specific Conditions & Requirements

Sale Name: Ice James Rd Red Pine Salvage

Sale Number: 54-008-26 Seq#: 1

1 - Sale Area

1.2 - Boundaries

1.2.1 - Painted Boundaries (9/19)

The sale boundaries are marked and identified with red paint and James Road. Exterior sale boundary lines against state are marked with red paint and James Road. The painted boundary line trees are not included timber with the exception of red pine, Austrian Pine, and Scotch pine boundary line trees. Red pine, Austrian pine, and Scotch pine red painted boundary line trees are included timber and are to be harvested.

2 - Timber Specifications

2.1 - Included Timber

2.1.1 - Clearcut Unit(s) with Unmerchantable Trees (6/14)

Within Payment Unit(s) 1, cut all trees that are two (2) inches or more at DBH, except protect and do not cut sub-merchantable oak and pine in accordance with sale spec 3.4.1.

2.1.11 - Description of Timber Note (2/04)

Note that this is an ice storm salvage sale.

All timber standing, fallen, snapped, and/or broken timber is designated for harvest, except those trees designated for leave as detailed in timber sale specs 2.1.1 and 3.4.1.

This sale was cruised, and timber volumes estimated, using standard methods used by the Michigan DNR. Advertised prices were reduced accordingly, to reflect the current ice storm damaged condition of the stand.

Misc. species 2 is standing damaged red pine with minimal to no remaining foliage to promote future tree growth and prevent decay.

Misc. species 3 is standing damaged Austrian pine with minimal to no remaining foliage to promote future tree growth and prevent decay.

All merchantable tree volume, whether standing, snapped off, or fallen, is included timber and is to be harvested and removed from the sale site.

All general timber determined to be dead before the ice storm of late March 2025 was not included in the cruised timber volume.

2.2 - Utilization

2.2.6 - Roundwood Operation Required (3/21)

The skidding of whole trees or tree segments with limbs attached is prohibited. All products must be produced as roundwood and forwarded to existing roads or landing areas in final product length. Trees must be harvested with a processor (the use of a feller buncher will not be allowed) in order to retain existing understory.

3 - Payments

3.4 - Damaged Timber

3.4.1 - Damaged Timber (12/24)

General Condition and Requirement 3.4 Damaged Timber, defines liquidated damages for undesigned live merchantable trees which are cut or injured. In addition, extreme care should be taken to avoid damage to tree seedlings and saplings.

Within the Sale Area, if more than 25% of the oak and/or pine tree seedlings or saplings (1/4" to 4.5" DBH) within a specified portion of the Sale Area are damaged, liquidated damages will be assessed at \$250 per acre for all acreage within that specified portion of the Sale Area that was damaged.

4 - Transportation

4.1 - Construction

4.1.3 - Slash and Earthen Piles (8/04)

Piles or windrows of earth along roads and landings that have been widened or constructed shall be leveled. Slash from road maintenance or construction, including stumps, shall be dispersed throughout the sale.

4.1.6 - Road Construction (4/24)

Improvements of existing roads shall be done in such a way as to minimize the environmental and visual impacts. Merchantable trees shall be cut and utilized unless otherwise directed. Non-merchantable trees shall be severed and laid flat on the ground. Slash shall be scattered, not left in windrows, and kept a minimum of 10 feet back from the road edge. Stumps shall be set upright, not left on edge, and be moved at least 10 feet away from the road edge. Disturbed soil shall be feathered into the woods and not left in berms or windrows.

4.1.12 - No New Roads (1/12)

No new roads will be permitted in any Payment Unit. All operations are limited to existing roads. Only Skid trails will be allowed.

4.2 - Maintenance

4.2.5 - Two Wheel Drive Condition (2/04)

All existing trail roads on and adjacent to the Sale Area must be passable by two-wheel drive traffic for the duration of the sale.

5 - Operations

5.1 - Notification

5.1.1 - Pre-sale Conference (10/25)

A pre-sale conference on site between the Purchaser and Sale Administrator is required prior to beginning any operations a Payment Unit to determine landing and road locations. The Unit Manager or his/her representative must be contacted at least 5 days in advance to schedule the conference.

5.1.4 - Post-Sale Conference (10/16)

A post-sale conference on site between the Purchaser and sale administrator is required 5 days prior to the completion of active logging operations to determine clean-up and repair of landings, road edges, and the fulfillment of other contract specifications.

5.2 - Conduct of Operations

5.2.1 - Slash

5.2.1.10 - No Slash in Openings (5/10)

No brush or logging debris is to be left in the maintained wildlife opening which is indicated by G on the Timber Sale Map. Any damage to the opening shall be repaired according to specifications of the Unit Manager or his/her representative.

5.2.2 - Hazard Trees/Snags

5.2.2.1 - Den Trees (10/16)

Obvious hollow and/or den trees shall be protected and left standing unless they are a safety hazard.

5.2.3 - Operating Restrictions

5.2.3.11 - Coppice Regeneration Protection (4/10)

Timber harvesting in any Payment Unit must be completed before significant tree sprouting occurs in that Payment Unit, so as to minimize damage to the new regeneration. Any post-harvest operations, such as chipping, must be completed before sprouting of regeneration occurs. If it is anticipated that chipping will be delayed, then tops shall be carried to one

central location or left unchipped. The Unit Manager or his/her representative may cease such operations if sprouting occurs before the operation is complete.

5.2.32 - Decking/Landing Restoration (9/13)

All decking and landing areas must have the surface area restored to a condition equal to or better than before. This is to ensure the proper regeneration of the stand. Wood debris, chips and "cookies" from trimmings must be removed or scattered away from landing and loading areas and may not be windrowed on the edge.

5.2.38 - No Decking Against Live Trees (2/04)

Cut products may not be decked against unmarked or designated leave trees.

5.4 - Soil Protection

5.4.1 - Rutting Restriction, General (7/16)

Operations are to cease immediately if equipment and weather conditions result in rutting of roads and/or skid trails which are 12 inches or greater in depth and 50 feet in length. The Unit Manager or his/her representative may restrict hauling and/or skidding if ruts exceed the specified depth. With the Unit Manager or his/her representative's approval, the Purchaser may return to the area when the risk of rutting has decreased.

5.8 - Protection of Endangered Species

5.8.5 - Protection of Raptor Nests (3/13)

All trees with raptor nests will be protected if found during harvesting operations. Notification will be made to the Unit Manager or his/her representative who will notify the Wildlife Biologist so an onsite evaluation and recommendation can be made, if necessary.

6 - Safety and Fire Prevention

6.2 - Signing

6.2.1 - Road Posting (10/20)

The Purchaser is responsible for posting and maintaining caution signs on forest roads prior to beginning operations. The road must be posted at appropriate distances from the Sale Area to warn of logging activity and truck traffic. Signs must be removed when harvest operations are suspended or completed. The Purchaser will provide these signs.

7 - Other Conditions

7.2 - Extensions

7.2.2 - No Extensions (3/09)

There will be no extensions granted on this contract. Ice storm damaged timber must be processed and utilized in a timely manner for minimizing deterioration of wood product.

7.5 - Loss

7.5.1 - Deteriorating Timber (7/09)

The Sale Area has received damage from the late March 2025 Ice Storm. The Purchaser should harvest the wood as soon as possible. The Department of Natural Resources is held free of responsibility of any further damage or deterioration due to delay in harvesting.

**TIMBER SALE MAP**

This information provided by authority of Part 525, 1994 PA 451, as amended.

Forest Management Unit		County	Mapped By: D. Parris	Scale 1:7,920	Page 1	Of 1
Atlanta Mgt Unit		Alpena	Cruised By: D. Parris			
Township 31N	Range 05E	Section(s) and Subdivision(s) Sec. 23 N1/2NE;				

Cover Type

A = Aspen	J = Jack Pine	O = Oak	U = Upland Brush
B = Paper Birch	K = Rock	P = Lowland Poplar	UM = Upland Mix Forest
C = Cedar	L = Lowland Brush	Q = Mixed Swamp Conifer	V = Bog or Marsh
D = Treed Bog	LM = Lowland Mix Forest	R = Red Pine	W = White Pine
E = Swamp Hardwoods	M = Maple, Beech, Birch	S = Black Spruce	X = Non Stocked
F = Spruce/Fir	MC = Mixed Conifer	T = Tamarack	Y = Sand
G = Grass	MD = Mixed Deciduous		Z = Water
H = Hemlock	N = Marsh		

Density

0 = Non Stocked	5 = Pole Timber Medium
1 = Seedling Sapling Poor	6 = Pole Timber Well
2 = Seedling Sapling Medium	7 = Saw Timber Poor
3 = Seedling Sapling Well	8 = Saw Timber Medium
4 = Pole Timber Poor	9 = Saw Timber Well

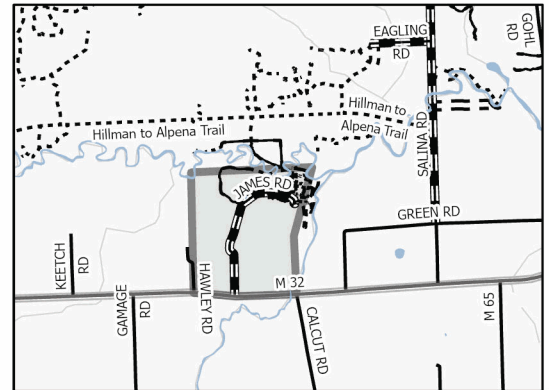
Locator Map 1:100,000

Payment Unit Number	Acres
1	6.2

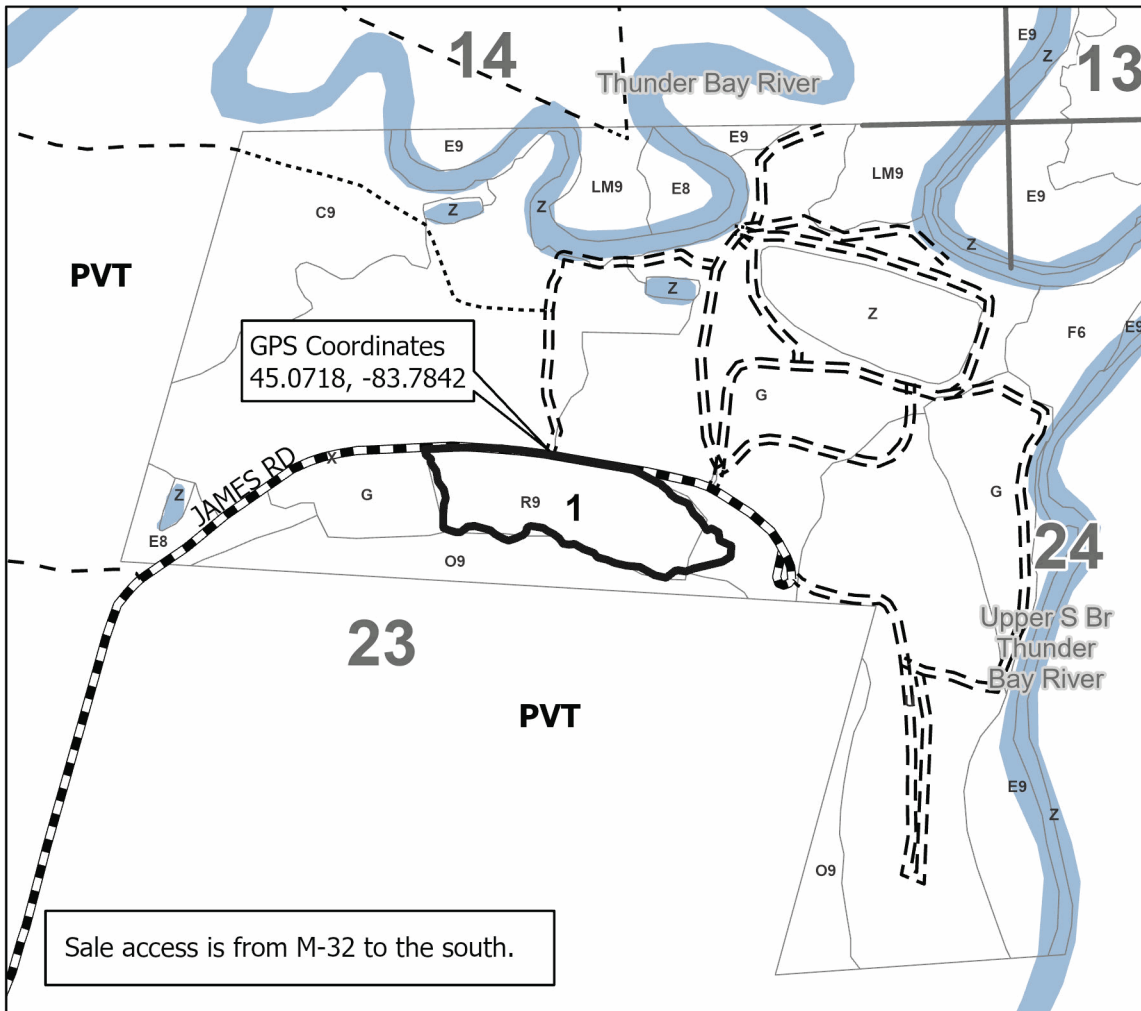
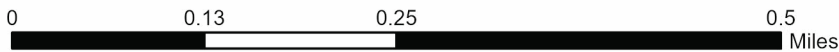
**Ice James Rd
Red Pine
Salvage****Compartment 98****6.2 Acres****Legend**

- Payment Unit
- Sale Boundary**
 - Against State (Red)
 - Stand Boundaries
 - Lakes and Rivers
 - Streams
 - Forest Access Route
 - Administrative Access Only
 - Government Gravel/Dirt
 - Private Gravel/Dirt
 - Section Corners

Use QR Code to
open Map in App