



**DEPARTMENT OF NATURAL RESOURCES
STATE OF MICHIGAN
TIMBER SALE PROSPECTUS #7872**

SCHEDULED SALE DATE AND TIME: **9:00 a.m. (local time) on July 14, 2026.**

LOCATION: **GAYLORD MGMT UNIT, 1732 WEST M 32, GAYLORD, MI 49735.**

CONTACT NAME: Lucas Merrick

PHONE NUMBER: (989) 732-3541

PROSPECTUS NOTE: The bidder is advised to inspect the sale area and review the location, estimated volumes, operating costs and contract terms of proposed sales. Please be aware that some landowners may request 60 days or more notice for access across their land.

Notice is hereby given that bids will be received by the Unit Manager, GAYLORD MANAGEMENT UNIT, for certain timber on the following described lands:

Ice Slugger Aspen (52-008-26) / T29N, R03W, SEC. 21, SWSE.

T29N, R03W, SEC. 28, NENW,NWNE.

Otsego County, Advertised Price \$14,939.50, 45.9 Acres, Aspen, Hardwood.

SALE NOTE: This is an aspen salvage harvest with a 2-year contract maximum. There is excellent access to this stand off Class A road. There is a lot of heavy canopy damage in this stand but limited bole snap.

TIMBER SALE INFORMATION

Ice Slugger Aspen (52-008-26)

T29N, R03W, SEC. 21; T29N, R03W, SEC. 28.

Otsego County (Advertised Price \$14,939.50)

SALE NOTE: This is an aspen salvage harvest with a 2-year contract maximum. There is excellent access to this stand off Class A road. There is a lot of heavy canopy damage in this stand but limited bole snap.

A timber sale contract for this lump sum, sealed bid timber sale will be awarded to the responsible bidder offering the highest sealed bid price. All units of volume listed below were estimated using the Inventory Manager computer program and the new Michigan taper model. Bids must be at or above the following advertised price for each product and species:

<u>PRODUCTS & SPECIES</u>	<u>ESTIMATED UNITS*</u>	<u>ADVERTISED PRICE</u>
Sawtimber		
Red Maple	8.9 MBF	\$ 45.00 / MBF
Red Oak	3.4 MBF	\$ 94.00 / MBF
Red Pine	31.3 MBF	\$ 53.00 / MBF
Sugar Maple	5.9 MBF	\$ 91.00 / MBF
White Pine	5.2 MBF	\$ 35.00 / MBF
Pulpwood		
Mixed Aspen	1,104 Cords	\$ 7.20 / Cord
Mixed Hardwood	67 Cords	\$ 7.00 / Cord
Red Maple	449 Cords	\$ 7.00 / Cord
Red Pine	54 Cords	\$ 5.20 / Cord

* The total volume is statistically estimated within plus (+) or minus (-) 20.90 percent. There are an estimated 1,802 cords on this timber sale, plus or minus 377 cords at the 95% confidence level. The estimated units are final and not subject to adjustment. Prospective bidders are urged to examine this timber and to make their own estimates of quantity and quality.

BOND AND PAYMENT SCHEDULE:

1. A bond in the amount of \$1,000.00 to insure faithful performance of the conditions of the contract will be deposited by the successful bidder within 21 days of the sale award.
2. Cutting in any sale or unit without the required advance payment would be considered a trespass.
3. Total payment must be paid in advance or according to the following schedule :
 - (a) Ten percent (10%) of the sale value must be paid within 21 days of the sale award.
 - (b) The remainder is due before cutting begins.
 - (c) Payment for each of the following units must be made before cutting begins in that unit:

PAYMENT UNIT NUMBER	PERCENT OF TOTAL SALE VALUE
01	100.0%
4. If no cutting takes place, the 10% down payment will not be refunded.
5. Operations on the contract issued will terminate on 12/31/2028.

SALE STATISTICS

Volumes were calculated in cubic feet using the Michigan taper model. Cubic foot volume includes all wood inside bark for the product indicated. For display purposes, cubic feet were converted to cords and MBF using a simple conversion factor, e.g. 79 cubic feet per cord and 185 cubic feet per MBF. The cubic foot volumes are precise; the cords and MBF volumes are not. Cubic foot volume cannot be directly converted to cords or boards with precision.

SALE VOLUMES

The total estimated sale volume may not equal the sum of the species/products due to the nature of statistical calculations associated with double sampling methodology.

VOLUME		STATISTICAL RANGE IN CORDS		
TOTAL CUBIC FEET	TOTAL CORDS	PERCENT ERROR	MINIMUM	MAXIMUM
142,359	1,802	20.90%	1,425	2,179

VDU VOLUMES

A VDU is a Volume Determination Unit. Volumes and their associated statistics are calculated at the VDU level and summarized to the sale level. There is often a one to one relationship between a VDU and a Payment Unit, but not always, depending on the cruise design. Refer to the VDU TO PAYMENT UNIT table.

VDU	VOLUME		PERCENT ERROR	RANGE IN CORDS	
	TOTAL CUBIC FEET	TOTAL CORDS		MINIMUM	MAXIMUM
7	142,359	1,802	20.91%	1,425	2,179
TOTAL:	142,359	1,802		1,425	2,179

VDU TO PAYMENT UNIT

When a VDU is associated with more than one Payment Unit (PU), the VDU volumes are assigned to the PU based on acres of the VDU within the PU.

VDU	VDU ACRES	PU	PU ACRES
TOTAL:			

DESCRIPTION OF TIMBER BY PU (PU)

PU	MARKET GROUP	PRODUCT	QUANTITY	UNIT	ACRES	ADVERTISE PRICE	
1	Red Maple	Sawtimber	8.9	MBF	45.9	\$14,939.50	
	Red Oak		3.4	MBF			
	Red Pine		31.3	MBF			
	Sugar Maple		5.9	MBF			
	White Pine		5.2	MBF			
	Mixed Aspen		Pulpwood	1,104			Cords
	<i>B. T. Aspen</i>			484			Cords
	<i>Quaking Aspen</i>			620			Cords
	Mixed Hardwood			67			Cords
	<i>Beech</i>			4			Cords
	<i>Black Cherry</i>	17		Cords			
	<i>Ironwood</i>	3		Cords			
	<i>Paper Birch</i>	2		Cords			
	<i>Red Oak</i>	8		Cords			
	<i>Cherry (Juneberry)</i>	2		Cords			
	<i>Sugar Maple</i>	31	Cords				
	Red Maple	449	Cords				
	Red Pine	54	Cords				
	<i>Red Pine</i>	52	Cords				
	<i>White Pine</i>	2	Cords				
TOTAL:			54.7	MBF			
TOTAL:			1,674	Cords			

Sale Specific Conditions & Requirements

Sale Name: Ice Slugger Aspen

Sale Number: 52-008-26 Seq#: 1

1 - Sale Area

1.2 - Boundaries

1.2.1 - Painted Boundaries (9/19)

The sale boundaries are marked and identified by blue and red paint except along Kenyon Trail where the boundary is unpainted and defined by the road. Exterior sale boundary lines against private property are marked with blue paint. Exterior sale boundary lines against state are marked with red paint. Retention patches are marked with teal green paint; no harvesting activities may occur within these areas. The painted boundary line trees are not Included Timber and are to be protected. There are several witness trees in the NW and SW corners. The Witness Trees are marked with red & blue paint on the trunks and are not included timber and not to be harvested.

2 - Timber Specifications

2.1 - Included Timber

2.1.1 - Clearcut Unit(s) with Unmerchantable Trees (6/14)

Within Payment Unit(s) 1, cut all trees that are two (2) inches or more at DBH except DO NOT CUT ANY OF THE FOLLOWING: retention islands designated with teal-green paint (spec 3.4.1); trees marked with a pink band of paint (spec 5.2.4.1), and hemlock of any size.

3 - Payments

3.4 - Damaged Timber

3.4.1 - Damaged Timber (12/24)

General Condition and Requirement 3.4 Damaged Timber, defines liquidated damages for undesignated live merchantable trees which are cut or injured.

No damage is acceptable to undesignated live merchantable trees in retention areas. Within the Sale Area, if any damage occurs to trees in a retention area, liquidated damages will be assessed for all trees damaged. Rates will be in accordance with General Condition and Requirement 3.4 Damaged Timber. Specified Rates will be at \$250 per sawtimber tree and \$100 per pulp tree.

4 - Transportation

4.1 - Construction

4.1.3 - Slash and Earthen Piles (8/04)

Piles or windrows of earth along roads and landings that have been widened or constructed shall be leveled. Slash from road maintenance or construction, including stumps, shall be dispersed throughout the sale.

4.1.12 - No New Roads (1/12)

No new roads will be permitted in any Payment Unit. All operations are limited to existing roads. Only Skid trails will be allowed.

4.2 - Maintenance

4.2.4 - Grading (10/16)

For completion of the sale, state forest roads must be graded. In general, this will require a road grader or bulldozer to shape up the roads after forest products have been hauled off site. This includes cleaning of drainage areas, grading, crowning and filling with gravel, if necessary. The grading equipment to be used must be approved by the Unit Manager or his/her representative.

4.2.5 - Two Wheel Drive Condition (2/04)

All existing trail roads on and adjacent to the Sale Area must be passable by two-wheel drive traffic for the duration of the

sale.

5 - Operations

5.1 - Notification

5.1.1 - Pre-sale Conference (10/25)

A pre-sale conference on site between the Purchaser and Sale Administrator is required prior to beginning any operations to determine landing and road locations. The Unit Manager or his/her representative must be contacted at least 3 days in advance to schedule the conference.

5.1.3 - Well Heads and Natural Gas Pipelines (11/15)

The Purchaser is responsible for contacting the MISS DIG HOTLINE prior to operating equipment in the vicinity of well heads or natural gas pipelines.

5.2 - Conduct of Operations

5.2.1 - Slash

5.2.1.2 - Slash Removal

5.2.1.2.6 - Slash Removal, General (7/05)

All slash must be removed from gas well and edges, and the landings.

5.2.1.8 - Slash Height (12/08)

No slash or tree tops may exceed 24 inches in height.

5.2.2 - Hazard Trees/Snags

5.2.2.1 - Den Trees (10/16)

Obvious hollow and/or den trees shall be protected and left standing unless they are a safety hazard.

5.2.3 - Operating Restrictions

5.2.3.11 - Coppice Regeneration Protection (4/10)

Timber harvesting in any Payment Unit must be completed before significant aspen sprouting occurs in that Payment Unit, so as to minimize damage to the new regeneration. Any post-harvest operations, such as chipping, must be completed before sprouting of regeneration occurs. If it is anticipated that chipping will be delayed, then tops shall be carried to one central location or left unchipped. The Unit Manager or his/her representative may cease such operations if sprouting occurs before the operation is complete.

5.2.4 - Dead and Down Creation

5.2.4.1 - Dead and Down Creation, Marked Trees (10/13)

All trees marked with a band of pink paint must be left until all merchantable timber has been cut. At which time, they are to be cut, felled, and left on the ground. This will facilitate snowshoe hare and grouse habitat. These trees have been taken off the timber tally.

5.2.29 - Shrub Protection (1/20)

Do not cut or damage hawthorn, witch-hazel, dogwood or juneberry. These woody-shrub plants are highly beneficial to various wildlife species.

5.2.32 - Decking/Landing Restoration (9/13)

All decking and landing areas must have the surface area restored to a condition equal to or better than before. This is to ensure the proper regeneration of the stand. Wood debris, chips and "cookies" from trimmings must be removed or scattered away from landing and loading areas and may not be windrowed on the edge. Any bermed earthen mounds, slash piles, and other uneven ground from trucking, skidding, or erosion, must be leveled off and may require a dozer to perform the work.

5.2.38 - No Decking Against Live Trees (2/04)

Cut products may not be decked against unmarked or designated leave trees.

5.4 - Soil Protection

5.4.1 - Rutting Restriction, General (7/16)

Operations are to cease immediately if equipment and weather conditions result in rutting of roads and/or skid trails which are 12 inches or greater in depth and 50 feet in length. The Unit Manager or his/her representative may restrict hauling and/or skidding if ruts exceed the specified depth. With the Unit Manager or his/her representative's approval, the Purchaser may return to the area when the risk of rutting has decreased.

5.4.5 - Soil Caution (11/04)

Care must be taken to minimize soil damage due to the sandy soils.

5.8 - Protection of Endangered Species

5.8.5 - Protection of Raptor Nests (3/13)

All trees with raptor nests will be protected if found during harvesting operations. Notification will be made to the Unit Manager or his/her representative who will notify the Wildlife Biologist so an onsite evaluation and recommendation can be made, if necessary.

6 - Safety and Fire Prevention

6.2 - Signing

6.2.1 - Road Posting (10/20)

The Purchaser is responsible for posting and maintaining caution signs on Marlette Road and Kenyon Trail prior to beginning operations. The road must be posted at appropriate distances from the Sale Area to warn of logging activity and truck traffic. Signs must be removed when harvest operations are suspended or completed. The Purchaser will provide these signs.

7 - Other Conditions

7.2 - Extensions

7.2.2 - No Extensions (3/09)

There will be no extensions granted on this contract. The purpose of this sale is to salvage wood damaged during the massive 2025 ice storm.

7.5 - Loss

7.5.1 - Deteriorating Timber (7/09)

The Sale Area has received damage from a massive spring ice storm in 2025. The Purchaser should harvest the wood as soon as possible. The Department of Natural Resources is held free of responsibility of any further damage or deterioration due to delay in harvesting.



TIMBER SALE MAP

This information provided by authority of Part 525, 1994 PA 451, as amended.

Sale Number
52-008-26

Date
05/20/2026

Forest Management Unit Gaylord Mgt Unit	County Otsego	Mapped By: Morris Cruised By: Morris
--	------------------	---

Scale 1:9,500	Page 1	Of 1
------------------	-----------	---------

Township 29N	Range 03W	Section(s) and Subdivision(s) Sec. 21 SWSE; Sec. 28 NENW,NWNE;
-----------------	--------------	---

Cover Type			
A = Aspen	J = Jack Pine	O = Oak	U = Upland Brush
B = Paper Birch	K = Rock	P = Lowland Poplar	UM = Upland Mix Forest
C = Cedar	L = Lowland Brush	Q = Mixed Swamp Conifer	V = Bog or Marsh
D = Treed Bog	LM = Lowland Mix Forest	R = Red Pine	W = White Pine
E = Swamp Hardwoods	M = Maple, Beech, Birch	S = Black Spruce	X = Non Stocked
F = Spruce/Fir	MC = Mixed Conifer	T = Tamarack	Y = Sand
G = Grass	MD = Mixed Deciduous	Z = Water	
H = Hemlock	N = Marsh		

Density	
0 = Non Stocked	5 = Pole Timber Medium
1 = Seedling Sapling Poor	6 = Pole Timber Well
2 = Seedling Sapling Medium	7 = Saw Timber Poor
3 = Seedling Sapling Well	8 = Saw Timber Medium
4 = Pole Timber Poor	9 = Saw Timber Well

Payment Unit Number	Acres
1	45.9

Ice Slugger Aspen

45.9 Acres

Locator Map 1:100,000

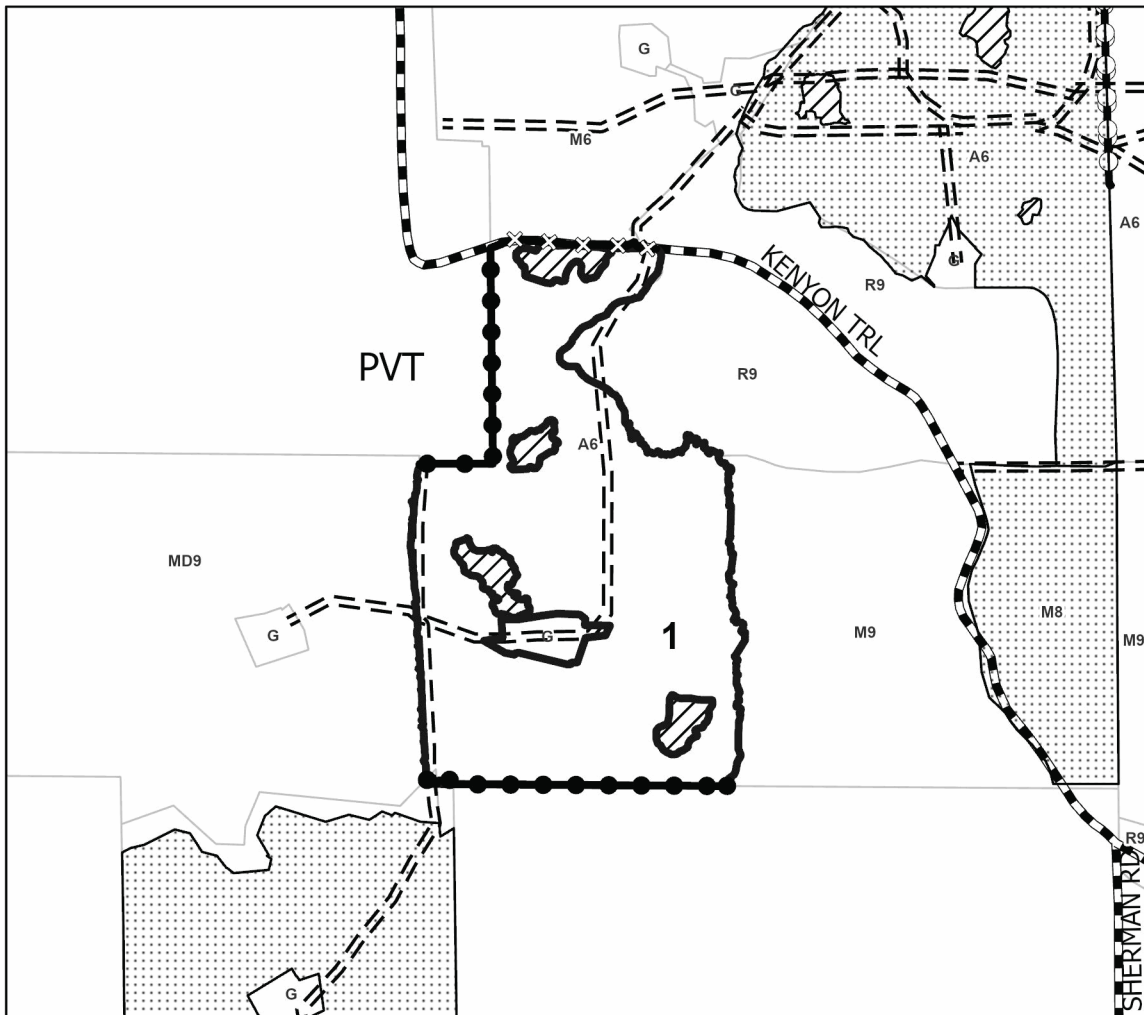
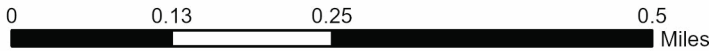
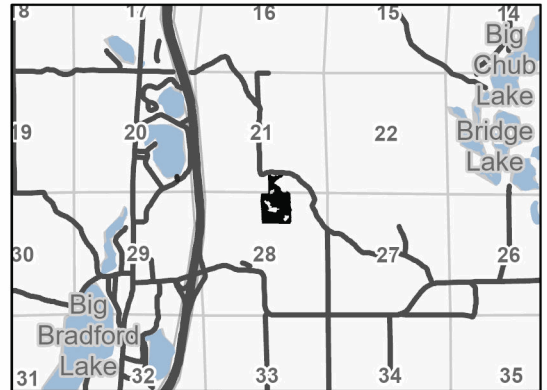

Legend

- Against State (Red)
- Retention Areas
- Against State (Unpainted)
- Private Line (Blue)
- Payment Unit (Yellow)
- Forest Access Route
- Government Gravel/Dirt
- Nearby Timber Sale selection

TREE LIST



MAP

